



K103R

Rechargeable Wireless Mechanical Keyboard

無線機械鍵盤

Model No. : IRK103R

Quick Installation Guide

產品名稱：無線機械鍵盤

PACKAGE CONTENTS

- Keyboard x 1
- USB Dongle
- USB-C Cable x 1
- Puller for Switch & Keycap x 1
- Extra Switches x 4
- Quick Installation Guide x 1

SYSTEMS REQUIREMENTS

- Microsoft Windows® 10, Windows® 11 and above
- macOS 10.14 and above
- Available USB Port

FEATURES

- Gasket structure and multi-layer sound-dampening structure providing a soft and unified typing experience
- iRocks pre-lubed switches and hot-swappable switch sockets
- Compatible with Windows and macOS operating systems
- Wheel with switchable modes, customizable in Windows 10 and 11 for volume control, scrolling, zooming, and more
- Supports Bluetooth, 2.4GHz wireless and USB-C wired connectivity
- Vibrant RGB backlighting with static or dynamic effects

KEYBOARD SPECIFICATIONS

- Interface : Wired (USB Full Speed)
Wireless (2.4GHz & Bluetooth 5.2)
- Key number : 81 Keys
- Switch type : Mechanical switch with hotswap sockets
- N-Key rollover (NKRO)
- Multimedia keys : 12keys
- Backlight effective keys : 4 keys
- Voltage : DC 5V ,500mA

- Charging interface : USB C
- Rechargeable li-ion battery : 3750 mAh
- Cable length : approx. 180 cm
- Weight : approx. 810 g
- Dimension : 331 (L) X 144(W) X 44(H) mm

RECEIVER SPECIFICATIONS

- Interface: USB
- Dimension: 18.6(L) X 14.5(W) X 6.1 (H) mm

HARDWARE INSTALLATION

- First-time Use and Charging Instructions

When the red light flashes, the battery is low and needs charging. The light will stay solid red while charging and turn off when fully charged.

For the initial use or if the keyboard has been unused for an extended period, it is important to charge the battery to ensure proper keyboard and battery functionality. Prolonged periods of non-use can gradually reduce battery voltage. Therefore, it is recommended to fully charge the battery every few months (approximately 4-5 months) before use to extend battery lifespan.

Charging Method

Please do not use a fast charger to charge this product to avoid potential damage.

1. Connect the USB cable to your computer or a USB DC5V charger.
2. Plug the other end into the keyboard for charging.
3. Charging is completed when the screen on your keyboard indicates 99% ~ 100% battery level.

Note: It is advisable to turn off the backlight function during charging to shorten charging time.

- Keyboard linking

This keyboard has three connection modes wired 、 wireless and Bluetooth. Follow the steps below to set up your keyboard.

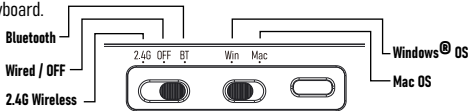

• Wired Connection

1. Flip the connection switch to " OFF " for wired mode
2. Turn on your computer and plug USB cable into an available USB port on your computer and keyboard.
3. Your computer will automatically detect the keyboard
4. You may use the keyboard after detection
5. When your keyboard is not in use, switching to Off/wired mode (connection switch OFF) is recommended.
6. Switch the keyboard to specific mode depending on your system (Windows® or macOS)

• RF2.4G Wireless Connection

The device is pre-paired at the factory, so users do not need to pair it. The connection method is as follows :

1. Power on the computer and plug USB receiver into a USB port on your computer.
2. Flip the connection switch to 2.4G for 2.4 Ghz wireless mode
3. Your computer will automatically detect the receiver and connect with the keyboard
4. Switch the keyboard to specific mode depending on your system (Windows® or macOS)

• Bluetooth Connection

Before using keyboard via Bluetooth connection for the first time, you need to pair it with your PC and use FN + Q (W/E) to connect and switch between 3 different Bluetooth devices.

1. Flip the connection switch to BT for Bluetooth mode
2. Press and hold Fn+Q (W/E) for 3 seconds to enter pairing mode and the key will blink rapidly and is discoverable by your PC
3. Navigate to Bluetooth settings on your PC and add Bluetooth device. Look for device labeled "K103R Keyboard" and pair it with your PC.
4. Switch the keyboard to specific mode depending on your system (Windows® or macOS)

• Keyboard sleep mode settings

1. Under wireless mode, the backlight of your keyboard will be automatically turned off after 1.5 minute of keyboard inactivity. To turn backlight back on, press any key.
To set idle timeout for keyboard's Energy Saving Mode under wireless mode
FN + CTRL + 0 : Fully disable Energy Saving Mode
FN + CTRL + 1 : 1.5 minutes (default, key 1 will blink 3 times when enabled)
FN + CTRL + 2 : 5 minutes (key 2 will blink 3 times when enabled)
FN + CTRL + 3 : 10 minutes (key 3 will blink 3 times when enabled)

2. Under wired mode, Press FN+Ctrl+S to enable or disable Energy Saving Mode. When the mode is enabled, backlight of your keyboard will automatically be turned off after 5 minutes of keyboard inactivity and turned back on after pressing any key. Energy Saving Mode in wired mode is disabled by default.

• Hot-swappable Switch Replacement

KEYCAP PULLER

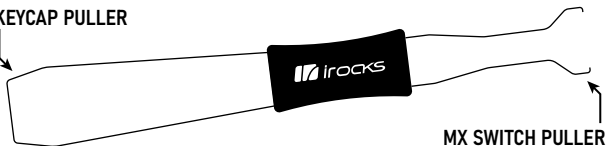

Step 01

Remove the keycap with key puller side of 2-in-1 tool coming with your keyboard.

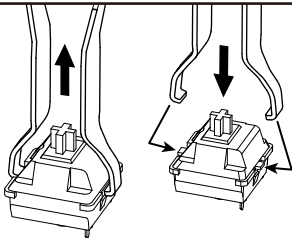

Step 02

Remove the switch with switch puller side of the tool.

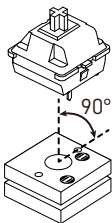

Step 03

Gently push in replacement switch

- make sure the pins of the switch are aligned with the pin holes before pushing it in.

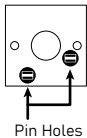

Push from the top of the switch

- to avoid pin damage, do not push on the side of the switch.

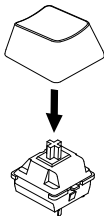

Step 04

Push back the keycap.



Still can't use

Visit iRocks official website for tutorial video.

PRODUCT INFORMATION

• LED Indicator

A : Caps Lock Indicator

W : Windows lock

⚡ : Power low Indicator

Backlight with only Esc key on: The keyboard is full key locked. Press Fn+Esc to lock or unlock.

• Function Keys

Press and hold 'Fn' key, then press desired function key to use hotkeys.

1. Setting Hotkeys

FN + **CTRL** + **G** : N-Key Rollover anti-ghosting function (default)

FN + **CTRL** + **N** : 6-Key Rollover anti-ghosting & standard USB settings

FN + **CTRL** + **P** : Factory reset (Press and hold for 5 seconds)

2. Multimedia & Function Hotkeys

FN + **Esc** : Lock entire keyboard

(Only the ESC key is red backlit when keyboard is locked.)

Windows®

| KEY | PRESS | FN + PRESS |
|-----|-------|-----------------------------|
| F1 | F1 | Show Desktop |
| F2 | F2 | Lock PC |
| F3 | F3 | Search for files or folder |
| F4 | F4 | Launch Calculator |
| F5 | F5 | Open my Computer |
| F6 | F6 | Open E-Mail |
| F7 | F7 | Open the internet browser |
| F8 | F8 | Media player |
| F9 | F9 | Play/pause |
| F10 | F10 | Backward |
| F11 | F11 | Stop play |
| F12 | F12 | Forward |
| Win | Win | Turn Windows lock on or off |



| KEY | PRESS | FN + PRESS |
|-----|----------------------------|------------|
| F1 | Decrease Screen Brightness | F1 |
| F2 | Increase Screen Brightness | F2 |
| F3 | Mission Control | F3 |
| F4 | Spotlight | F4 |
| F5 | Search | F5 |
| F6 | No function | F6 |
| F7 | Previous Track | F7 |
| F8 | Play / Pause | F8 |
| F9 | Next Track | F9 |
| F10 | Mute | F10 |
| F11 | Volume Down | F11 |
| F12 | Volume Up | F12 |

3. Keyboard Backlight

FN + **▲** or **▼** : Adjust brightness backlight (4 levels)

FN + **◀** or **▶** : Adjust backlight effect speed (depending on backlight effects)

FN + **CTRL** + **{** : Adjust backlight color (depending on backlight effects)

FN + **CTRL** + **}** : Show the custom backlighting for software lighting effects mode



PRESS THE KEY : Wheel - Volume Control Mode

FN + **THE KEY** : Turn off the backlight



PRESS THE KEY : Wheel - Smart Wheel Mode

FN + **THE KEY** : Exchange backlight effects

4. Smart wheel function

Use the scroll wheel and the two buttons next to it to switch between two scroll wheel functions (volume control/smart scroll). The introduction is as follows :

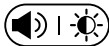

: Wheel - Volume Control Mode

Wheel clockwise : Increase volume

Wheel counterclockwise : Decrease volume

Wheel button : Mute / Unmute



: Wheel - Smart Wheel Mode

Only works on PC with Windows®10/11

Go to Windows®10/11 Settings -> Devices -> Wheel for customization

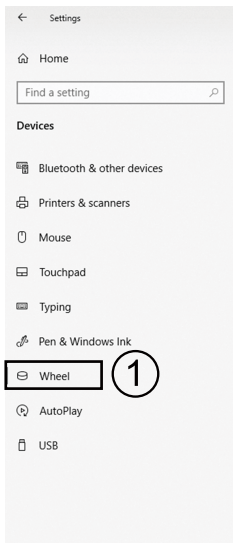

Wheel

Wheel settings

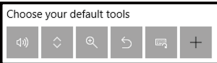

Vibrate

On

Custom tool

Choose keyboard shortcuts to use as your custom tool.

Rotate right shortcut

+

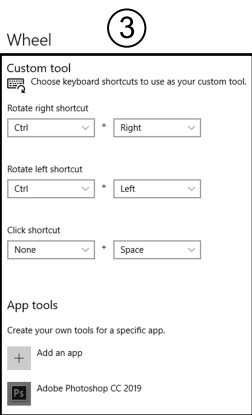
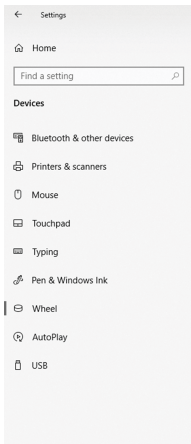

SOFTWARE

The keyboard software requires the keyboard to be in wired mode, as it directly saves most of settings to the keyboard's onboard memory. Saved keyboard settings will be applied under both wired and wireless mode. Please visit iRocks official website to download and install latest software for backlight, macro, multimedia keys configuration and more.

1. Double click the installation software downloaded from iRocks, and follow the instructions.
2. Plug in the keyboard after installation, the software will start to identify your keyboard.
3. Launch the software. It will take some time to synchronize the memory parameter and setting of the keyboard.

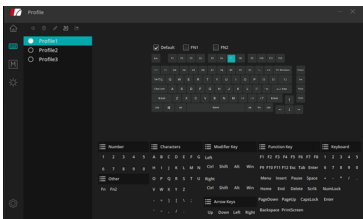

Attention : The keyboard has to be switched to wired mode for software configuration.

TROUBLESHOOTING & CAUTIONS

If your wireless keyboard does not work normally :

- Ensure the keyboard is switched to the correct mode - wired · BT or 2.4GHz wireless mode.
- Check the USB receiver is connected to your computer's USB port correctly - unplug and plug it back.
- Check if the keyboard has sufficient battery power.
- Metal objects close to or in between the keyboard may reduce wireless performance.
Try moving metal objects away from the keyboard °
- This keyboard has 2.4GHz wireless connection, using USB 3.x and 2.4GHz wireless devices at the same time may cause radio frequency interference and affect normal functionality of the wireless device. Try to reduce radio interference of the USB 3.x device to your wireless keyboard, Plug the receiver into the USB 2.0 port or other locations as far away as possible from the USB 3.x port or use USB hub / USB extension cable to re-position your wireless receiver to a location away from the USB 3.x port.
- For saving power, the keyboard goes into sleep mode when it's not in use for a while. Press any key and wait for 1 to 3 seconds to bring the keyboard out of sleep mode.
- When not using the keyboard for an extended period, please switch off the keyboard and charge it periodically. Avoid letting the battery remain at low voltage for too long to ensure the battery's proper operation and extend its lifespan.
- Avoid putting your keyboard under high moisture condition or direct sun.
- Do not expose your keyboard to extreme temperatures, heat, fire or liquid.

WIRELESS ID PAIRING

The 2.4G wireless keyboard is pre-paired with included receiver before shipment. It saves the need to pair and is ready to use out of the box. When you need to re-pair your keyboard and receiver manually to prevent signal interference or other issues,

Please follow the steps below :

1. Make sure the keyboard is in wireless mode.
2. Press and hold Fn + P for 3 seconds to enter pairing mode (P key will flash).
3. Unplug and plug the USB receiver back into your computer's USB port.
4. Move the keyboard to close the USB receiver within 15cm, the ID setting process will start automatically. (It will take about 4-8 seconds)
5. Your keyboard should be ready to use
6. The above steps need to be completed within 1 minute, If the keyboard doesn't work properly, please remove the USB receiver from computer's USB port, then proceed to step 2-4 again.

FCC Warning Statement

Changes or modifications not expressly approved by the party responsible for compliance could void the user's authority to operate the equipment. This equipment has been tested and found to comply with the limits for a Class B digital device, pursuant to Part 15 of the FCC Rules. These limits are designed to provide reasonable protection against harmful interference in a residential installation. This equipment generates uses and can radiate radio frequency energy and, if not installed and used in accordance with the instructions, may cause harmful interference to radio communications. However, there is no guarantee that interference will not occur in a particular installation. If this equipment does cause harmful interference to radio or television reception, which can be determined by turning the equipment off and on, the user is encouraged to try to correct the interference by one or more of the following measures :

- Reorient or relocate the receiving antenna.
- Increase the separation between the equipment and receiver.
- Connect the equipment into an outlet on a circuit different from that to which the receiver is connected.
- Consult the dealer or an experienced radio/TV technician for help.

This device complies with part 15 of the FCC Rules. Operation is subject to the following two conditions :

(1) This device may not cause harmful interference, and (2) this device must accept any interference received, including interference that may cause undesired operation.

The device has been evaluated to meet general RF exposure requirement.
The device can be used in portable exposure condition without restriction.

包裝內容

- 無線機械鍵盤 x1 (型號IRK103R)
- 2.4GHz無線接收器x1(型號DG103R)
- USB-C 連接線 x1
- 多功能拔軸拔鍵器 x1
- 備用替換開關 X 4
- 快速安裝手冊 x1

系統需求

- 微軟的視窗系統 Windows® 8.1, Windows® 10, Windows® 11.
- Mac OS 10.14以上系統
- 可用的USB傳輸埠

產品特色

- Gasket 均衡支撐及多層消音結構設計，提供軟彈溫潤的打感
- 全鍵區採用iRocks自有特色預潤軸體，可自行替換鍵軸
- 可切換功能的旋鈕，於Windows®10與11下可自訂滾輪功能為音量、滾動、縮放等功能
- 支援 Windows 及 macOS 作業系統
- 藍牙 / 2.4G / 有線USB-C三介面選擇
- 多彩RGB背光，支援動態特效功能

鍵盤規格

- 產品名稱：無線機械鍵盤
- 產品型號：IRK103R
- 介面：有線(USB) & 無線(2.4GHz & 藍牙5.2)
- 按鍵數：81 鍵
- 開關形式：可插拔預潤機械開關
- 全區防鬼鍵設計 (NKRO)
- 多媒體鍵：12 鍵
- 背光特效鍵：4 鍵
- 電壓：DC 5V ,500mA

- 充電接口：USB-C
- 可充式鋰電池容量：3750 mAh
- USB 線長：約180 公分
- 產品重量：約 810 g 公克
- 產品尺寸：331 (L) X 144(W) X 44(H) mm

接收器規格

- 介面：USB
- 產品尺寸：18.8(L) X 14.5(W) X 6.3 (H) mm

硬體安裝

· 首次使用及充電說明

指示燈紅燈閃爍時，表示低電壓請進行充電，充電時燈號會變為紅燈常亮，充電飽時紅色指示燈會熄滅。

首次使用或長時間不使用時，電池需進行充電，確保鍵盤功能正常。若長時間不使用，電池的電壓會緩慢降低，請務必一段時間(4-5個月)及使用前，為電池充滿電，以延長電池使用壽命。

充電方式

本產品請勿使用快充充電器進行充電，避免產品損壞。

1. 連接所附的USB線於電腦端或USB DC5V的充電器
2. 另一端連接鍵盤進行充電，充電指示燈會紅燈亮起
3. 完成充電，紅燈會熄滅

註：充電時建議將背光功能關閉，以便節省充電時間

· 鍵盤連結說明

此鍵盤提供有線、藍牙跟2.4Ghz無線三種介面，可透過鍵盤撥鈕進行介面切換。

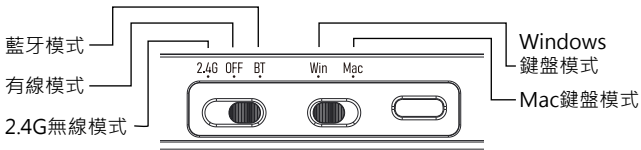

· 有線鍵盤安裝及說明

1. 將鍵盤開關撥到有線/OFF介面
2. 開啟電腦電源
3. 將所附的USB傳輸線USB Type A 接於電腦端，USB Type C 接於鍵盤端
4. 電腦會自動偵測到鍵盤裝置
5. 安裝完成
6. 切換鍵盤的作業系統開關到所需要的作業系統 (Windows®或macOS)

· 2.4G無線鍵盤安裝及說明

出廠時已完成配對，使用者不需進行配對，連接方式如下：

1. 開啟電腦電源，將無線接收器的USB接頭插入電腦的USB連接埠
2. 將鍵盤開關撥到2.4G 無線介面
3. 電腦會自動偵測到無線接收器並與鍵盤進行連接
4. 安裝完成
5. 切換鍵盤的作業系統開關到所需要的作業系統 (Windows®或macOS)

· 藍牙無線鍵盤安裝及說明

電腦裝置第一次使用此鍵盤進行藍牙連線時，要進行藍牙配對程序，透過FN+Q (W/E) 分別可連接及切換3組藍牙電腦裝置。

1. 將鍵盤開關撥到藍牙無線介面
2. 同時長按鍵盤的FN跟Q 鍵 (W/E)約3秒，進入對碼模式，Q鍵(W/E)背光會白燈持續閃爍，表示已進入對碼模式
3. 開啟電腦電源，進入藍牙模式，進行藍牙裝置搜索，於藍牙裝置中尋找“K103R Keyboard”裝置進行配對
4. 連線成功後指示燈熄滅
5. 切換鍵盤的作業系統開關到所需要的作業系統 (Windows®或macOS)

· 鍵盤休眠設定

1.在無線藍牙或2.4G模式下，一段時間沒使用鍵盤，為求省電，鍵盤會自動進入省電模式(無線功能進入低耗電休眠狀況及關閉鍵盤背光)，按任一鍵亮起，使用者可自行設定進入省電模式的時間如下：

FN+CTRL+0: 不啟動省電模式(0鍵閃3次)

FN+CTRL+1: 約1.5分鐘無動作時，啟動省電模式(內定值, 1鍵閃3次)

FN+CTRL+2: 約5分鐘無動作時，啟動省電模式(2鍵閃3次)

FN+CTRL+3: 約10分鐘無動作時，啟動省電模式(3鍵閃3次)

2. 在有線模式下 FN+CTRL+S 可切換背光省電模式

關閉鍵盤背光休眠模式(預設 / S鍵閃爍2次): 背光恆亮

開啟鍵盤背光休眠模式(S鍵閃爍3次): 5分鐘無動作時, 背光自動關閉以節約能源, 按任一鍵喚醒

· 軸體更換

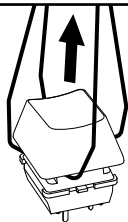
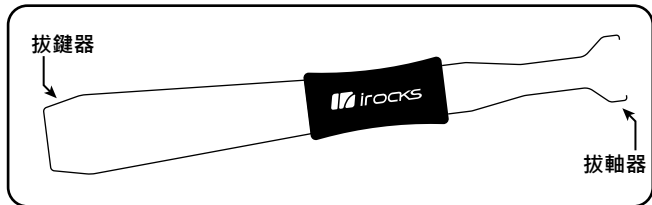

Step 01

用所附贈的拔軸拔鍵器的拔鍵端, 先將預更換軸的鍵帽拔除

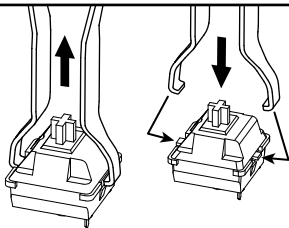

Step 02

再用另一拔軸端將軸體拔出
· 拔出時拉力要均衡向上

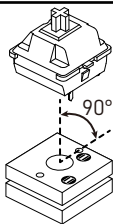

Step 03

插入預更換的軸體，軸體的腳位跟鍵盤板上軸孔座的位置和方向要確認對應後才插入，壓入時要正壓不可以側壓，避免軸體端子腳歪斜彎曲

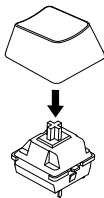
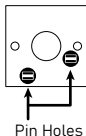

Step 04

將鍵帽裝上，完成更換



仍然還是不會操作？

可以參考iRocks官方網站的教學影片

產品資訊

· LED 指示燈

A : 大小寫指示燈

W : Win鍵鎖

⚡ : 低電壓指示燈

單ESC背光鍵亮時, 表示全部按鍵在鎖鍵狀態(Fn+ESC)

· 快捷鍵功能

同時按壓FN鍵跟下列按鍵產生對應的快捷功能

1. 設定鍵

FN + **CTRL** + **G** : N-Key Rollover 全區防衝突功能 (鍵盤內定值)

FN + **CTRL** + **N** : 6-Key Rollover USB標準規範輸出功能

FN + **CTRL** + **P** 長按5秒 : 將鍵盤所有功能回復出廠設定

2. 多媒體及功能快捷鍵

FN + **Esc** : 開啟跟關閉全部鍵盤鎖鍵功能
(所有背光功能熄滅 · 單單ESC鍵背光亮起)

Windows®

| 按鍵 | 按壓 | FN鍵 + 按壓 |
|-----|-----|-----------------------------|
| F1 | F1 | 顯示桌面 |
| F2 | F2 | 鎖定電腦 |
| F3 | F3 | 搜尋檔案或資料夾 |
| F4 | F4 | 計算機 |
| F5 | F5 | 我的電腦 |
| F6 | F6 | 開啟 E-Mail 軟體 |
| F7 | F7 | 開啟網路瀏覽器 |
| F8 | F8 | 多媒體呼叫 |
| F9 | F9 | 播放/暫停 |
| F10 | F10 | 回上一首 |
| F11 | F11 | 停止 |
| F12 | F12 | 回下一首 |
| Win | Win | 開啟跟關閉鎖Windows/Application 鍵 |

mac OS

| 按鍵 | 按壓 | FN鍵 + 按壓 |
|-----|-----------------|----------|
| F1 | 減少螢幕亮度 | F1 |
| F2 | 增加螢幕亮度 | F2 |
| F3 | Mission Control | F3 |
| F4 | Spotlight | F4 |
| F5 | 搜尋 | F5 |
| F6 | 無 | F6 |
| F7 | 上一首 | F7 |
| F8 | 播放/暫停 | F8 |
| F9 | 下一首 | F9 |
| F10 | 靜音/取消靜音 | F10 |
| F11 | 降低音量 | F11 |
| F12 | 提高音量 | F12 |

3. 背光功能快捷鍵

- FN** + **▲** or **▼** : 調整按鍵背光明亮度 (四階)
- FN** + **◀** or **▶** : 選擇按鍵背光特效速度 (依背光特效而定)
- FN** + **CTRL** + **{** : 更改背光顏色 (特定背光有效)
- FN** + **CTRL** + **}** : 呼叫軟體燈效模式的自定義背光



直接按壓：滾輪音量調整功能

FN + 此按鍵：關閉按鍵背光



直接按壓：微軟智慧滾輪功能

FN + 此按鍵：背光特效循環切換

4. 智慧滾輪功能

透過滾輪跟滾輪旁的2組按鍵可切換選擇二種滾論功能(音量調整/智慧滾輪)介紹如下:

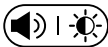

: 滾輪音量調整模式

滾輪順時針: 調整音量大聲

滾輪逆時針: 調整音量小聲

按壓滾輪: 音量靜音



: 智慧滾輪功能 (如下圖)

此模式須在Windows® 10/11系統才有此功能

請至Windows®10 > 裝置 > 滾輪 選項進行相關滾輪功能設定

請至Windows®11 > 藍牙與裝置 > 滾輪 選項進行相關滾輪功能設定



轉輪

轉輪設定



選擇您的預設工具



震動

開啟

自訂工具

選擇鍵盤快速鍵以做為您的自訂工具使用。

向右旋轉快速鍵

Ctrl + +

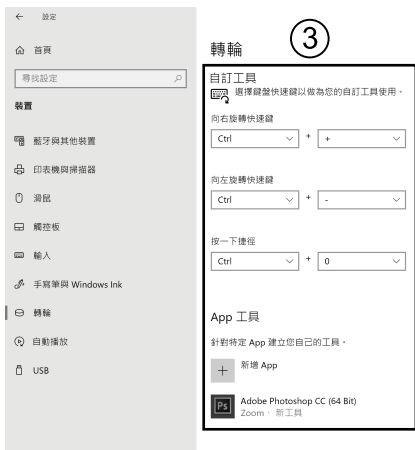

應用程式

此軟體只能對應於有線介面下執行操作，當設定完成，設定參數值會儲存於鍵盤，後續可套用於無線模組，請至iRocks 官網下載此機種最新的應用軟體及進行下列步驟安裝，此軟體支援背光、巨集、多媒體等設定。

1. 雙擊所下載的軟體並依安裝步驟進行軟體安裝
2. 將鍵盤切換到有線模式，軟體會自動辨識
3. 啟動軟體，軟體會與鍵盤進行連接，這會花一點時間

注意：鍵盤要切換到有線模式，軟體才能正常使用。

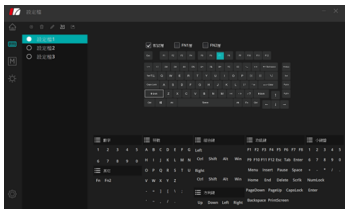

疑難排解及注意事項

若鍵盤在無線模式下無法正常動作，或有任何疑問，請嘗試下面步驟說明：

- 確認鍵盤是否切換到正確的有線或2.4G介面模式。
- 重新插拔連接線或進行對碼。
- 確認鍵盤電量是否足夠。
- 無線產品使用時，若中間有金屬等干擾源，將會影響無線接收距離。
- 此無線鍵盤採用2.4GHz頻率連線，有時會受周邊的裝置如USB3.X Hub 或Wifi 等的干擾，導致有時打字輸出斷訊，此時請將接收器換插USB2.0連接埠或USB集線器/USB延長線，鍵盤盡可能靠近無線接收器避開干擾源。
- 無線鍵盤在一段時間內不使用，為了省電將會自動進入休眠，按任意鍵即可喚醒，無線連結將自動恢復。
- 長時間不使用鍵盤，請將鍵盤開關，並適時對鍵盤進行充電，勿讓電池低於低電壓過久，以確保電池正常運作及延長使用壽命。
- 請避免鍵盤在潮濕環境下使用或放置陽光直射的地方。
- 請勿將鍵盤暴露於過高或過低的溫度，並勿靠近火源。

ID辨識碼設定

每款無線鍵盤出廠時都完成ID設定碼，使用者只需將硬體安裝完成插入電腦的USB連接埠之後即可立即使用。此ID設定的功能在於防止電腦與鍵盤間之無線訊號被其他在同一環境下的無線產品所影響或更換接收器時，才須進行設定。

請依照下列的步驟重新設定ID。

1. 確定鍵盤切換到2.4G無線介面連接
2. 同時按壓鍵盤FN+P約3秒鐘，讓鍵盤進入對碼模式(P鍵會閃爍)。
3. 重新插拔USB接收器。
4. 移動鍵盤靠近USB接收器，距離約15公分以內；此時鍵盤會自行與接收器連結進行ID辨識碼的設定。
(這段ID設定過程完成需4-8秒鐘的設定時間)
5. 完成ID設定可使用。
6. 對碼程序要在1分鐘內完成，如果鍵盤仍然無法正常運作，請將USB接收器從電腦的USB連接埠移出，然後再重複1或4安裝程序。

安全規範

· IRK103R限用物質查詢網址：<https://www.i-rocks.com.tw/uploads/root/IRK103R.JPG>

NCC警語

「取得審驗證明之低功率射頻器材，非經核准，公司、商號或使用者均不得擅自變更頻率、加大功率或變更原設計之特性及功能。低功率射頻器材之使用不得影響飛航安全及干擾合法通信；經發現有干擾現象時，應立即停用，並改善至無干擾時方得繼續使用。前述合法通信，指依電信管理法規定作業之無線電通信。低功率射頻器材須忍受合法通信或工業、科學及醫療用電波輻射性電機設備之干擾。」

警告

「如果更換不正確之電池型式會有爆炸的風險，請依照製造商說明書處理用過之電池」



i-Rocks Technology Co., Ltd.

Headquarter Office

7F., No. 786, Zhongzheng Rd., Zhonghe Dist.,

New Taipei City 23586, Taiwan

Tel : +886-2-2225-5080

Fax : +886-2-2228-1712

www.i-rocks.com

i-Rocks Korea

www.i-rocks.co.kr

i-Rocks Malaysia

57-A, Jalan SS21/1A, Damansara Utama, 47400,

Petaling Jaya, Selangor, Malaysia

Tel : +603-77339233

www.i-rocks.com



線上產品註冊登入

- 1.至會員專區
- 2.加入或登入會員
- 3.完成產品註冊

www.i-rocks.com.tw

IRK103R