

Bluetooth Earphones

M/N: SX-810

User manual

For user's safety, please read this manual before using the headset.

The following matters should be paid attention to when using headset:

Please avoid long-term use of high volume mode, because it will lead to hearing loss caused by noise.

If you are in bad condition of potential danger, please stop using headset, in order to ensure safety.

Users should reasonably control the volume and time when listening to the headset.

The volume should not be too high, otherwise you can't hear the voice around. If volume is too high that may appear tinnitus, please lower down the volume.

Don't listen to the music while driving.

Use dry soft cloth to clean the headset! Should avoid the headset into the water, that will cause headset damage.

If you feel obvious discomfort, stimulation, or other adverse reaction when using the headset, stop using it immediately.

The headset should not be stored or used in temperature below 15 c(5 F) or higher than 55 c(131 F), otherwise will reduce the battery life.

Charging and Battery:

Before charge this headset with charging cable, please check whether the charge cable is original.

Warning :

Please charge the headsets with original charging cable, it may damage the battery or the headset if you are using improper charging cable. This headset has built-in rechargeable battery, so do not attempt to remove the battery from the headset to avoid damaging it.

1. Before charging, it's best to turn off the headset.

2. Insert the USB charging cable to earpiece jack, the other end of the USB port into the USB charger or any other devices to start charging. The headphones red light flashing means it is charging.

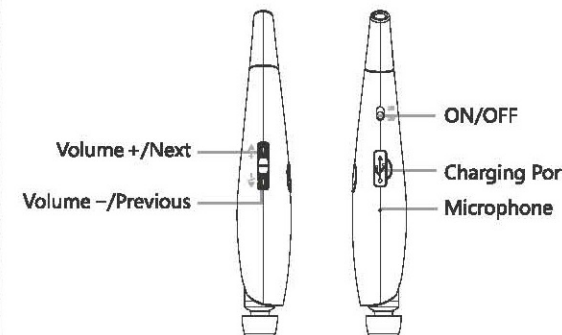

3. The headset need about 3.5 hours for fully charging, the red light goes off when fully charged.

Package content:

- Headset 1pcs
- Earbud 2pcs
- USB charging cable 1pcs
- User Manual 1pcs

ON/OFF

1. Switch to "ON", the headset will prompts "Power ON" with vibration; if red and blue light flashing alternately means it's ready for pairing with your device.

1. Switch to OFF to turn off the headset, it will prompts "power OFF".

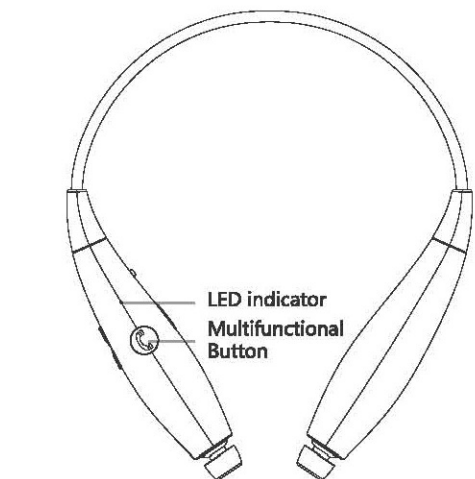

Bluetooth connection steps:

1. Please keep your headset and mobile phone as close as you can, within 1 meter.

2. Switch to "ON", it will prompts "Enter pairing" after 5 seconds, and then red and blue lights flashing alternately when headset is and ready for pairing.

3. Turn on "Bluetooth" in setting (your device) and find headset name SX-810.

4. Click SX-810, Bluetooth headset gets connected with your device automatically and it will prompt "Your headset is connected". Some may require pass code which is 0000.

Pair the headset with 2 mobile phones

1. After successfully paired with a mobile phone, close the Bluetooth function of the mobile phone, and switch the button of SX-810 to OFF.

2. Same procedure to get the 2nd mobile phone paired with the Bluetooth headset.

3. Turn on the Bluetooth function of the 1st mobile phone, choose "SX-810" to finish the pairing status with the 2nd mobile phones.

Note :

1. With your previously paired device's Bluetooth turned on and in range, turn on SX-810. The headset will automatically reconnect to the same Bluetooth device that connected last time. If you have a previously paired device that does not auto-reconnect, navigate to the Bluetooth settings menu on your device, turn on the Bluetooth feature, and select "SX-810" from your list of paired Bluetooth devices.

2. Pairing time exceeds 3 minutes, the headset will automatically shut down; in 3 minutes back to the effective distance can automatically reconnect with the last connected device.

3. If connected with two mobile phones, only one mobile phone supports wireless music. Pause music on one mobile phone, the music on another mobile will play again. You can start conversation on both mobile phones. Battery check up through iPhone.

Answer & End call / Incoming call vibration remind

Answer phone call :

When there is an incoming call, the headset will prompt "Incoming call" with vibration, Phone number "134.....578" will be broadcasted. Click MFB to answer, or just operate your mobile phone.

End Call :

Press the multifunctional button to hang up calls, or directly hang up your phone call.

Reject call :

When there is an incoming call, headset will broadcast the phone number with vibration. Double click the MFB to reject, or just reject it on your mobile phone.

Last number redial :

Double click MFB.

Call Transfer :

Double click the volume "-" to transfer calling between phone and headset.

Voice Dial :

Unlock the mobile phone and double click the volume "+" to launch the voice dial, and then just speak the people name you want to call. This function can work only if your mobile phone support it.

Hang up the phone call and answer the incoming call

If there is an incoming call when you are answering the phone call, and you want to answer the incoming call, double click the MFB button, you can hang up the phone call, and answer the incoming call.

EQ Shift :

Double click the volume "-" when playing music to have different sound effect (low bass boost, normal, high pitch boost). Default setting is high bass boost. Choose your favorite sound effect base on your habit and music style.

Chinese/English Shift :

Long press volume "+" and "-" simultaneously for 2 seconds.

Play/Pause

During music playing, single click MFB to pause music, and click again MFB to back to play.

During music playing, single click "+ / -" to change songs.

During the call or listening to music, long press "+" or "-" button to adjust the volume.

power prompt :

Each time turning on SX-810, it will report headset battery power remaining, such as "battery full", "battery level high", "battery level medium", "battery level low", "recharge headset".

Mobile phone anti-lost indicator

When the headphone connected to smart phone, if the distance between device and headset exceed 10 m, headset will prompt "Beyond the range of connections". If coming back to the working distance within 3 min, headset will reconnect automatically. If not coming back to the working distance in 10 min, headset will be power off, please switch the button to OFF and switch ON to the power on mode, headset will back to work.

Restore Factory Settings

Turn off the headset and in charge state, long press "MFB" button for three seconds, the blue light flashes three times, it will back to Factory setting.

Technical Index

- Correspond with : Bluetooth V4.0
- Transmittig Power : Class2
- Working Distance : ≤10m
- Frequency Range : 2.402GHz-2.480GHz
- Charging Time : ≤ 3.5hours
- Talk Time : ≥16 hours
- Music Time : ≥13 hours
- Standby time:≥138 hours

Tips:

Correct way of setting back the wire

In order to prolong the working life of the headset, please setback the wire slowly, and follow the steps shown below.

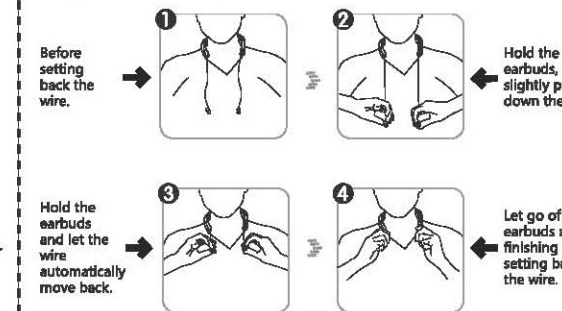

Wrong way of setting back the wire

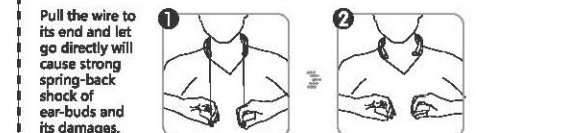

FCC Statement

This device complies with part 15 of the FCC Rules. Operation is subject to the following two conditions:

(1) This device may not cause harmful interference, and (2) this device must accept any interference received, including interference that may cause undesired operation.

Any Changes or modifications not expressly approved by the party responsible for compliance could void the user's authority to operate the equipment.

Note: This equipment has been tested and found to comply with the limits for a Class B digital device, pursuant to part 15 of the FCC Rules. These limits are designed to provide reasonable protection against harmful interference in a residential installation. This equipment generates uses and can radiate radio frequency energy and, if not installed and used in accordance with the instructions, may cause harmful interference to radio communications. However, there is no guarantee that interference will not occur in a particular installation. If this equipment does cause harmful interference to radio or television reception, equipment generates, uses and can radiate radio frequency energy and, if not installed and used in accordance with the instructions, may cause harmful interference to radio communications. However, there is no guarantee that interference will not occur in a particular installation. If this equipment does cause harmful interference to radio or television reception,

- Reorient or relocate the receiving antenna.
- Increase the separation between the equipment and receiver.
- Connect the equipment into an outlet on a circuit different from that to which the receiver is connected.
- Consult the dealer or an experienced radio/TV technician for help.

FCC RF Radiation Exposure Statement

The device has been evaluated to meet general RF exposure requirement. The device can be used in portable exposure condition without restriction.