

User Guide



SP500

Table Of Contents

FOR SAFE OPERATION	7
INFORMATION FOR SAFE OPERATION	7
ABOUT STORAGE AND MAINTENANCE	7
MENU	8
MEASUREMENT OF RADIO FREQUENCY EXPOSED (ABSORBED SPECIAL RATE INFORMATION SAR)	8
COMMUNICATION NETWORK SERVICE	9
SAFETY ON THE ROAD	9
SAFETY IN HOSPITAL	10
SAFETY IN FLIGHT	10
SAFETY IN PLACES WHERE EXPLOSION IS PREDICTABLE	10
ELECTRICAL EQUIPMENT	11
BATTERY AND PARTS	12
INSIDE THE PACKAGE	13
HANDSET DESCRIPTION	14
CELLULAR PHONE	15
IN THE BEGINNING	15
INSTALIMENT OF SIM CARD	15
BATTERY CHARGE	17
USING THE MICRO SD CARD	18
INSTALLING THE MICRO SD CARD	18
REMOVING THE MICRO SD CARD	18
REMOVABLE MEMORY STORAGE FUNCTIONALITY	19
PHONE ON/OFF	20
START	20
STAND-BY SCREEN	21
CALLS	26
MAKING A CALL	26
ANSWERING THE PHONE	26
WHOLE MENUS	27
COMMON SCREENS AND SYSTEM IN VARIOUS MENUS	28
INPUT PHONE NUMBER	28
WRITER	28
WRITER OF PHONE NUMBER	29

Table Of Contents

WRITER OF NUMBER	29
WRITER OF TEXT	29
SMART INPUT	30
TEXT SELECTOR	31
1. CALLS	32
ALL	33
MISSED	34
RECEIVED	36
DIALED	37
CALL SETTINGS	39
CALLER ID	40
CALL WAITING	40
CALL FORWARDING	40
CALL RESTRICTION	41
CALL TIME REMINDER	42
AUTO REDIAL	42
CALL TIME	43
CALL COST	44
SMS COUNTER	45
GPRS COUNTER	46
DELETE CALL LOG	47
2. PHONE BOOK	48
QUICK SEARCH	50
SEARCH ENTRY	52
ADD NEW ENTRY	53
CALLER GROUP	55
CALLER GROUP DETAILS	55
SPEED DIAL	57
SETTING SPEED DIAL NUMBER	58
OWNER NUMBER	60
EXTRA NUMBER	61
MANAGEMENT	62
3. MESSAGE	63

Table Of Contents

MESSAGES.....	64
SEND NEW SMS	64
SEND NEW MMS.....	65
INBOX OF SMS	68
INBOX OF MMS	70
OUTBOX OF SMS.....	70
OUTBOX OF MMS	71
SENT OF SMS.....	71
SENT OF MMS	72
DRAFT OF SMS	72
DRAFT OF MMS	73
DELETE FOLDER	73
TEMPLATE FOR SMS	74
TEMPLATE FOR MMS	74
SMS MESSAGE SETTINGS	74
MMS MESSAGE SETTINGS.....	75
CHAT.....	77
VOICE MAIL SERVER	78
EDIT.....	78
CONNECT TO VOICE	78
BROADCAST MESSAGE	79
4. SERVICE.....	81
WAP	81
DATA ACCOUNT.....	83
5. MULTIMEDIA.....	84
CAMERA.....	84
CAMERA OPTIONS.....	86
AUDIO PLAYER	87
IMAGE VIEWER	89
IMAGE OPTIONS	89
VIDEO RECORDER.....	90
RECORD VIDEO	90
VIDEO PLAYER	92
VIDEO PLAYER OPTIONS	92

Table Of Contents

PHOTO EDITOR	94
SOUND RECORDER	95
RECORD SOUND	95
RECORDING OPTIONS	96
6. ENTERTAINMENT	97
JAVA	98
JAVA CONTENTS	98
JAVA SETTING	98
MY GAMES	99
GREETING TEXT	100
HEALTH	101
BMI	101
MENSTRUAL	102
MELODY COMPOSER	102
CREATE MELODY	103
7. EXTRA	104
CALENDAR	105
ADD EVENTS	105
JUMP TO DATE	106
ALARM	106
ADD ALARM	106
CALCULATOR	107
UNIT CONVERTER	109
STOPWATCH	110
TYPICAL STOPWATCH	110
NWAY STOPWATCH	112
WORLD CLOCK	113
8. SETTING	114
PHONE SETTING	115
USER PROFILES	116
DISPLAY	117
LANGUAGE	117
PREFERRED INPUT MODE	118

Table Of Contents

AIRPLANE MODE	118
NETWORK SETTING	119
SELECT MODE	119
PREFERRED	119
GPRS CONNECTION	120
SECURITY SETTING	121
PIN LOCK	122
SIM LOCK	122
PHONE LOCK	122
AUTO KEYPAD LOCK	122
FIXED DIAL	123
BARRED DIAL	123
CHANGE PASSWORD	123
CALL SETTINGS	124
CALLER ID	125
CALL WAITING	125
CALL FORWARDING	125
CALL RESTRICTION	126
FIXED DIAL	127
CALL TIME REMINDER	127
AUTO REDIAL	127
TEXT MESSAGE	128
PROFILE SETTING	129
COMMON SETTING	129
MEMORY STATUS	129
PREFERRED STORAGE	129
PREF.BEARER	129
TIME AND DATE	130
BLUETOOTH	132
INITIALIZE USER SETTING	133
 9. FILE MANAGER	 134
 TECHNICAL SPECIFICATION	 135

● Information For Safe Operation

Please read the following user manual carefully to keep from injuries.

● About Storage And Maintenance

Do not try to disassemble or repair the phone.

Avoid wet and damp places.

Do not use harmful detergent or harmful chemical materials to wash the phone.

Instead, use soft cloth to rub its appearance.

Do not inflict strong shock on the appliance.

The appliance shall be situated near the electronic switch for hands to reach easily when the battery is charged. Do not put the phone in high temperature environment, which may cause defects on the phone.

The warranty on this phone will be invalid if it is repaired by an unauthorized person. And its maker does not take responsibility for the breakdown caused afterward.

Never extract the battery from the phone while turned on, which will cause defects on the phone.

Contact the agency you joined if the phone or its parts (charger, battery, and so on) malfunction.

● Menu

1. Calls
2. Phone Book
3. Message
4. Service
5. Multimedia
6. Entertainment
7. Extra
8. Setting
9. File Manager

● Measurement Of Radio Frequency Exposed (Absorbed Special Rate Information SAR)

This phone is a communication appliance with low-output electric wave. Complying with EU standard requirements related with radio wavelength exposure, the phone has been designed and made not exceeding the energy exposure limit of the radio frequency as recommended by European Union board of directors. The limit specified above is a frequency allowable in general as a world standard.

World standard value was developed, based on thorough and regular scientific researches and estimation (examination) by an independence research institution. The limit is a standard to search for safety of all, regardless of age or present state of health.

Standard value of the phone exposure is displayed in unit of Specific absorption index (SAR).

● Communication Network Service

The mobile conforms to the communication standard laws of GSM900, DCS1800, PCS1900 and GPRS.

Read this user manual thoroughly to understand and learn the functions of this appliance.

Customers should know that the Tri-Band (900-1800-1900) is a feature coming from the communication network.

Make sure that this feature is available via the RED exchange service personnel.

Additional RED services are available for this phone.

For these services, however, customers are required to join the exchange service.

For further information on How To Join, see below.

● Safety On The Road

Please remember that using a mobile phone during driving is prohibited.

Follow the rules as applicable in each country.

Stop the car in a safe place if you need to answer or use the phone.

Please always remember the following before using the phone in emergencies.

Focus on driving only.

Remember the most considerable thing is nothing but your safety.

If you want a Hands-Free device on vehicles, let it installed by an authorized engineer.

● Safety In Hospital

The mobile phone since designed to transmit electric waves can disturb functions of electric or medical appliances.

Remember to turn the phone off always in hospital.

● Safety In Flight

Remember the phone if used in the airplane can disturb functions of electric wave equipment of the airplane.

Therefore, the use of the phone is illegal in the airplane.

Remember to turn the phone off always during flight.

● Safety In Places Where Explosion Is Predictable

In such places as gas stations or chemical factories where explosion is predictable, the use of any electric wave equipment is illegal and prohibited.

Turn off the phone and avoid the use near any gas station.

● Electrical Equipment

Most electric appliances are secured and protected against the effect of the phone radio frequency.

Nevertheless, there are some products that are not protected against.

A person who works in a manufacturing company of those products, wearing heart pulsimeter is desired to keep at least 15cm away from the phone to avoid the electric wave.

If applicable problems still occur as before to the person with heart pulsimeter, then the phone shall be turned off.

The phone can disturb functions of some kind of microphones.

In this case, please contact the manufacturing factory of such microphones for further information.

Since the radio frequency signal generated from this phone may have an influence on electric equipment of a car (air bag, brake, and so on), please be well informed thereof via its maker.

● Battery And Parts

This phone uses a rechargeable battery of Li-ion Technology.

The battery if completely recharged is usable to call for a duration of 162 minutes and available for standing-by for a duration of 171 hours.

Do not use any charger or battery if damaged or worn out.

Do not touch any circuit of the battery. It will cause damage thereon.

If the battery is kept in hot temperature, its function and duration may be deteriorated.

Keep temperature always as similar as possible.

The phone if kept in too high or too low temperature may not operate from time to time even if the battery completely recharged.

Time required to recharge the battery may be different according to several factors such as capacity left, type of battery and charger, and so on.

For the better performance of recharge, keep suitable temperature.

The battery although completely recharged can be discharged of itself as the time elapses.

Unplug the switch of the charger if not used.

For effective operation of the phone, please stand the phone always lengthwise.

Do not throw the battery in a ditch or a fire.

The battery shall be recycled according to its related laws.

Use only the battery, charger and parts attached to the phone just as provided from the factory.

Parts shall be compatible to be used.

If not, its warranty will be invalid.

If some parts need replacement, contact the agency you joined to order.

Fill up the battery to the maximum prior to its first operation.

For pluggable equipment, the socket-outlet shall be installed near the equipment and shall be easily accessible.

Inside The Package



Handset



USB Cable

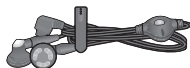

Earphone



User Manual



Battery

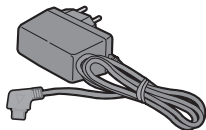

Travel Charger

Handset Description

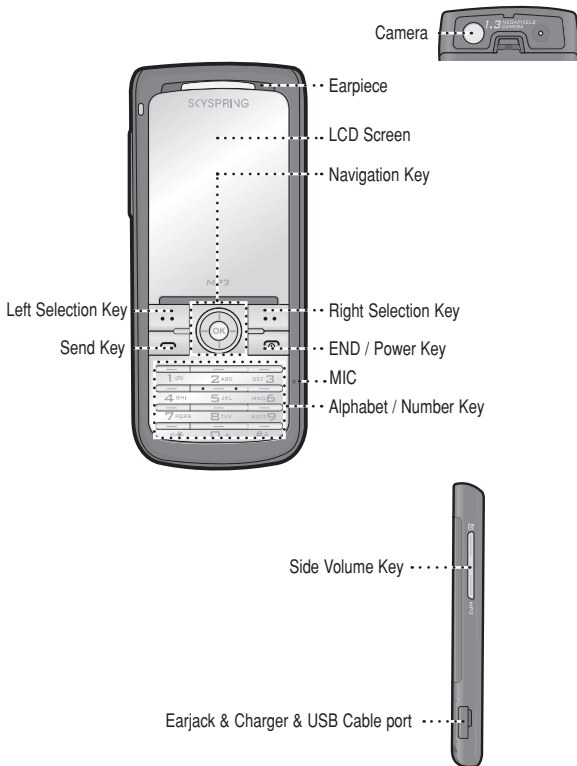

In The Beginning

Installment of SIM card

To answer the phone or to call, the mobile needs a available SIM card, which the communication company may have installed already.

Note If the mobile is used, installation state of the SIM card will be displayed. If the SIM card is not installed, a confirmation paragraph will be displayed.

1. Remove the battery after pulling the hook outward with the mobile turned off. The battery since adhered to the cover will come out as one component.

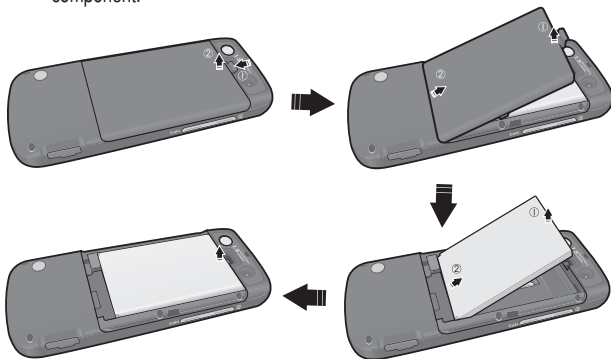

2. After the battery is removed, insert the SIM card to the hole. At this moment, make sure the corner of card fits well on the rim of the hole so to insert the card, checking the remaining aspect. Insert SIM card as shown in the following figure.

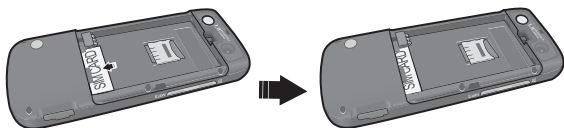

3. As for the two holes, make sure the cover on the rear fits well to insert the battery. Finally, keep pressing the lower of the cover till it sounds Tic.

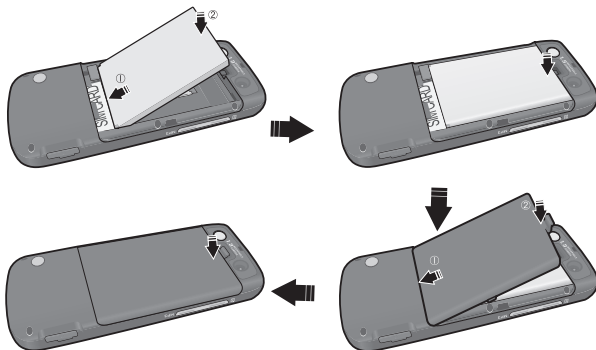

4. Pull the hook and insert the cover and the battery.

Note: Follow these procedures or some defects may occur on the support parts of the entrance, which will not be guaranteed.

Battery Charge

1. Insert the charger as shown in the figure. The screen will display the Battery is being charged while the phone is turned on for several seconds before returning to the previous step. (your phone is available even during the battery is charged). If the phone is turned off, display of Battery is being charged will be continuously displayed.
2. If the charge is completed, the screen will be as shown in the figure. To remove the charger hold and press the both ends to extract.



Warning Do not connect the Charger(or such accessories) up side down. It can be possible to damage the Phone.

● Using the Micro SD Card

Installing the Micro SD Card

1. Open the card hole cover, and insert the Micro SD card like the arrow indicates.

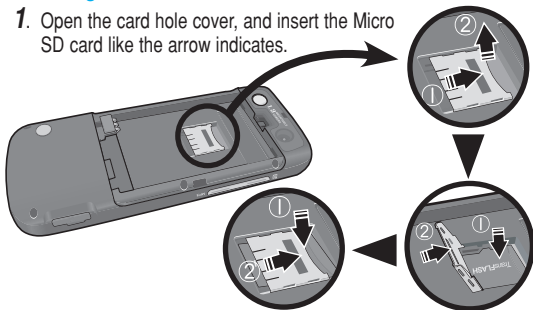

Removing the Micro SD Card

1. To remove the Micro SD card, press and release the card so that it is disengaged from the slot. Then slide it out.

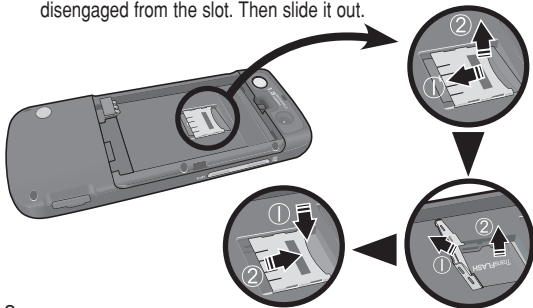

- When you insert Micro SD card, make sure contact terminals face down.
- Memory used for the mobile phone is not the general SD card but the Micro SD cards.
- Do not remove the Micro SD card while reading or writing files. Otherwise it could be damaged.
- “Micro SD” card is recognized as a mobile disk when connected to a personal computer.
- When disconnecting from PC, please remove the USB storage equipment on your PC. Otherwise, the stored files on the Micro SD card could be damaged.

Removable memory storage functionality

The Phone Guarantee only less 1G bytes Memory Card.

● Phone ON/OFF

Keep on pressing the End Key for 5 seconds to turn on the phone. This function is designed to avoid unintentional ON or OFF of the phone when kept in a pocket or luggage.

Start

If PIN enable setting on after the phone is turned on, you will be required to input 4-digit password. Input correct password and press OK (Center_Direction) Key.



Note: If password is not input, only emergency call will be available with SOS Key.

In case the phone has been off for long, you may be asked to make sure if date and time are correct.

If they are not correct, press edit Key.

If the date is correct, press OK(Center_Direction) Key.

If the date is not correct, input new date using the number on the Key pad and then if the time is not correct, input new time and then press OK(Center_Direction) Key. Select daylight saving on or off.



Stand-by Screen

Note For about few seconds after the phone is on, it's image and menu may be displayed a little slower than usual. This delayed time is for environmental setting of the menu. And the menu will not be displayed during this duration. After this duration, the speed will be back to normal. Stand-by screen is displayed when the phone is available to answer or use to call.



- **Central part:** The Main service indicators will be display on top of the Main screen.
- **Lower part:** On the upper, day, month, year and present time will be displayed. On the bottom, optional menu will be displayed as a Left_selection Key. Name menu will be displayed as a Right_selection Key.



- Press the Left_selection Key located below the menu in stand-by screen to display the main menu.
- Press the Right_selection Key in stand-by screen to display the Name menu.
- Press the Upper of the direction Key in stand-by screen to display the Calendar menu.
- Press the Lower of the direction Key in stand-by screen to display the Tone setup menu.
- Press the Left of the direction Key in stand-by screen to display the Message inbox menu.
- Press the Right of the direction Key in stand-by screen to display the Shortcuts menu.
- Press and hold the Upper of the Sidevolume Key in stand-by screen to display the Camera menu.
- Press and hold the Lower of the Sidevolume Key in stand-by screen to display the Audio Player menu.

The direction Key will be used mainly to appropriate functions of the phone.













- Keep on pressing End Key in stand-by screen state to turn off the phone.
- When the screen is in a normal state, press Send Key to display the call record.
- In order to make a call, press number first in stand-by screen state and the call Key next. Keep on pressing one number among 2 and 9 and a call to the number as input will be made. In the following table, various functions are described as applicable when number keys are pressed for short or long in stand-by screen state.

They are company mode and individual mode, where a relevant SIM card mode will appear if any password is input in stand-by screen state.

Company mode and individual mode have their own numbering system respectively.

	Short	Long
1	No.1	Call connected to voicemail box
2	No.2	Speed Dial
3	No.3	Speed Dial
4	No.4	Speed Dial
5	No.5	Speed Dial
6	No.6	Speed Dial
7	No.7	Speed Dial
8	No.8	Speed Dial
9	No.9	Speed Dial
0	No.0	Symbol +
*	Symbol*	Manner Mode on/off
#	Symbol#	Keypad Lock/Unlock

Dual SIM card: Dual SIM card has 2 passwords and 2 relevant modes respectively.

Icon	Name	Description
	Antenna	Always displayed to show service area if reached.
	Service available level	Always displayed to show service available level (0 to 6) in a bar graph.
	Service available level A	The greatest service available level with the maximum bars.
	Bell mode	There are 5 bell modes available (Ring, Vibration Only, Vibra and Ring, Vibra then Ring, Light Only) on the menu and Silent mode on Idle screen.
	Mute	Ringer volume is set to off.
	New SMS	This will be displayed when a new SMS message is received.
	Phone Lock	Phone is locked.
	Battery	Displayed approximately to show the actual capacity of the battery state
	Alarm	Displayed if alarm is set via the calendar.
	Ear Jack	A headset is connected.
	Roaming state	Displayed while user is in other service area or receiving a call abroad.
	Missed Calls	

● Calls

Making a Call

To make a call, press desired phone number in stand-by screen state and then Call Key .

If you input wrong number, Clear Key to delete the last number input.

In order to delete a specific number, move the cursor right behind the number to delete and then press End Key.

Press End Key to finish the call.

In the stand-by state of the phone, input number to display the following screen.



If the inputted phone number is displayed, just press menu(Left_selection) Key and specify a save folder.

If SIM card or the memory of the phone is displayed automatically, specify a related type of the phone too. (Refer to the user manual for more detailed procedures.)









Answering the Phone

Press Call (receive) Key to answer the phone call.

Press End Key not to answer the phone call.

● Whole Menus

In the stand-by state, press the menu(Left_selection) Key to go to standard menu. Press the direction (up/down/left/right) Key to get into menu desired. While pressing the OK(Center_Direction) Key, press relevant number to get into the category applicable. Figures of the icons, names of the categories, brief description of each menu and short-cut keys are as in the following table;

Icon	Menu	Description
	Calls	To look through call record and voice messages sent and received.
	Phone Book	To save phone numbers and setting speed dial, owner, extra number.
	Message	To read and write messages.
	Service	To move to service menu.
	Multimedia	To deal with camera and image album, videos, audio, etc.
	Entertainment	Play games, edit greeting text, health and melody composer
	Extras	To use calendar, alarm, world clock, calculator, unit converter, currency converter, stopwatch.
	Setting	To specify volume, calling melody, background image and other environment of the phone.
	File Manager	To edit file.

Common Screens And System In Various Menus

Input Phone Number

When you start inputting number in stand-by state, the number will be displayed, moving from right to left as it is inputted. If the number input reaches the end of the right, the number will move to the lower line to prepare a space for the next numbers to input.

During inputting number, the screen will be as shown below.

In order to insert a number between numbers just entered, use the direction Key (up/down/left/right) to move the cursor.

Press Clear Key to delete the number on the left of the cursor.



Writer

Writer is used to input phone number, text or number.

All kinds of writers (phone number, number, text) have their own functions respectively.

Writer of Phone Number

It is used to input phone number from the phonebook. Above all, press number in stand-by screen state to get into the screen of writer function. 0 ~ 9 are available to enter, which has the following features.

- Press <*> and <#> to input characters of <*> and <#> respectively.
- Press Clear Key to delete the last number input. Keep on pressing Clear Key to delete the whole number input (whole number) and to return to stand-by screen state.
- Press Lower Key (menu displayed on the left of the screen) to go to next step. Press Previous Key to go back to the previous step of the screen.

Writer of Number

It is used to input password 1, password 2 and call-restricted password. Press the following keys to make use of its functions specified.

- Use the keys 0 to 9 to press such number 0 to 9 as applicable.
- <*> and <#> Key has no function.
- Press Clear Key to delete the last number input. Keep on pressing Clear Key to delete the whole number input.
- Press OK(Center_Direction) Key to go to next screen.
Press Back(Right_selection) Key to go back to the previous screen.

Writer of text

It is used to input text of names or messages. There are 3 input methods for text writer.

- **[ABC] Capital English letter input**

Displays all the input text in capital letters. This can be used together with Multi Input and Smart Input which will be later described.

- **[abc] Small english letter input**

Displays all the input text in small letters. This can be used together with Multi Input and Smart Input.

- **[123] Number Input**

Number input is available fast. (Press number 0 to 9 to display 0 to 9 as applicable).

Note: Press <+> shortly to change input sequence as follows; ABC, abc, Abc 123.



Smart Input

This makes fast text input available. With the improved technology of (Press and Expect), a function to expect is realized, making use of the dictionary prepared in the language specified. In this way the writer provides the serial expected characters of text when the user presses the Key once.

- **[eZiABC] The Capital English e-Zi letter input**

For example, to write a letter 'HELLO', just press numeric key 4(GHI), 3(DEF), 5(JKL), 5(JKL) and 6(MNO).

- **[eZiabc] The Small English e-Zi letter input**

For example, to write a letter 'hello', the method is same as eZiABC, but it will display the small English Character.

- **[eZiES] The Capital Spanish e-Zi letter input**

For example, to write a letter 'Hola', just press numeric key 4(GHI), 6(MNO), 5(JKL) 2(ABC).

- **[eZies] The Small Spanish e-Zi letter input**

For example, to write a letter 'hola', the method is same as eZiES, but it will display the small Spanish Character.

- **[eZiFR] The Capital French e-Zi letter input**

For example, to write a letter 'BONJOUR', just press numeric key 2(ABC), 6(MNO), 6(MNO), 5(JKL) 6(MNO).

- **[eZifr] The Small French e-Zi letter input**

For example, to write a letter 'bonjour', the method is same as eZiUFR, but it will display the small French Character.

Text selector

Press 0 Key shortly in the screen of text mode to display text selector which can display special characters which are not available in general text mode. Move the direction Key (up/down/left/right) on the text desired to select those special characters.

If you select the special character.

Press OK(Center_Direction) Key to input applicable character.

Characters available are as follows;

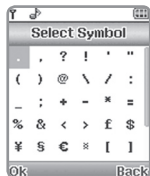

Note: Press <#> shortly to input a Space on text editor.

Through this Calls menu, you can move to call Logs, voice mail and mainly used number list.

1. In stand-by state, press menu(Left_selection) Key to display main menu option.
2. Use the direction Key to select Calls menu then press OK (Center_Direction) Key.



Option list related with Calls menus will be displayed as shown below;

- All
- Missed
- Received
- Dialed
- Call Settings
- Call Time
- Call Cost
- SMS Counter
- GPRS Counter
- Delete Call Log

All

1. In stand-by state, press menu(Left_selection) Key to display main menu option.
2. Use the direction Key to select Calls menu then press OK (Center_Direction) Key.
3. On calls screen, select All and press select to display the following information.

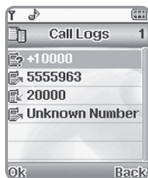

Select a call desired and press OK(Left_selection) Key to display call information in detail.

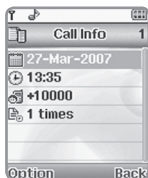

Press option(Left_selection) Key to display new menu with the following options;

- **Delete:** Deletes a selected phone number.
- **Save to Phone book:** Save selected phone number to the Phonebook.
- **Dial:** Tries a call to the selected phone number.
- **Edit:** Edit phone number.
- **Send SMS:** Send the SMS to selected phone number.
- **Send MMS:** Send the MMS to selected phone number.

Missed

1. In stand-by state, press menu(Left_selection) Key to display main menu option.
2. Use the direction Key to select Calls menu then press OK (Center_Direction) Key.
3. On calls screen, select Missed and press select to display the following information.



Select a call desired and press OK(Left_selection) Key to display call information in detail.



Press option(Left_selection) Key to display new menu with the following options;

- **Delete:** Deletes a selected phone number in Missed folder.
- **Save to Phone book:** Save selected phone number to the Phonebook.
- **Dial:** Tries a call to the selected phone number.
- **Edit:** Edit phone number.
- **Send SMS:** Send the SMS to selected phone number.
- **Send MMS:** Send the MMS to selected phone number.

Received

1. In stand-by state, press menu(Left_selection) Key to display main menu option.
2. Use the direction Key to select Calls menu then press OK (Center_Direction) Key.
3. On calls screen, select Received and press select to display the following information.



Select a call desired and press OK(Left_selection) Key to display call information in detail.



Press option(Left_selection) Key to display new menu with the following options;

- **Delete:** Deletes a selected phone number in Received folder.
- **Save to Phone book:** Save selected phone number to the Phonebook.
- **Dial:** Tries a call to the selected phone number.
- **Edit:** Edit phone number.
- **Send SMS:** Send the SMS to selected phone number.
- **Send MMS:** Send the MMS to selected phone number.

Dialed

1. In stand-by state, press menu(Left_selection) Key to display main menu option.
2. Use the direction Key to select Calls menu then press OK (Center_Direction) Key.
3. On calls screen, select Dialed and press select to display the following information.



Select a call desired and press OK(Left_selection) to display call information in detail.



Press option(Left_selection) Key to display new menu with the following options;

- **Delete:** Deletes a selected phone number in Dialed folder.
- **Save to Phone book:** Save selected phone number to the Phonebook.
- **Dial:** Tries a call to the selected phone number.
- **Edit:** Edit phone number.
- **Send SMS:** Send the SMS to selected phone number.
- **Send MMS:** Send the MMS to selected phone number.

● Call Settings

1. In stand-by state, press menu(Left_selection) Key to display main menu option.
2. Use the direction Key to select Calls menu then press OK (Center_Direction) Key.
3. On calls screen, select Call Settings and press select to display the following information.



The following is to describe the option.

- **Caller ID**
- **Call Waiting**
- **Call Forwarding**
- **Call Restriction**
- **Call Time Reminder**
- **Auto Redial**

Caller ID

This service is used to make to display the Caller's ID(number or Name) when incoming call is coming.

- **Set By Network:** Send or Hide by Network.
- **Hide ID:** Do not send a ID to Network
- **Send ID:** Send a ID to Network

Call Waiting

This service is used to make other call to stand by while a first call is connected, which can be applied or cancelled as necessary.

- **Activate:** Activates Call Waiting option.
- **Deactivate:** Deactivates Call Waiting option.
- **Query Status:** Query status of Call Waiting option.

Call Forwarding

It allows you to make received Call to go to other phone number. Select this option and press OK(Center_Direction) Key to use this function, which has sub-menus as follows;

- **Divert All Voice Calls:** Forwards all voice call.
- **Divert If Unreachable:** Forwards all calls in no service area.
- **Divert If No Answer:** Forwards all calls in absence, the mode will activate if call is not answered.
- **Divert If Busy:** Forwards all calls during connected with other phone.
- **Divert All Data Calls:** Forwards all data calls.
- **Cancel All Divert:** Deactivates all Call Forwarding.

Call Restriction

This service makes a calls be sent and received only under the specified conditions. Select this option menu to make use of this service.

- **Outgoing Calls:**
 - **All Outgoing:** Restricts all outgoing calls, which is controlled by password.
 - **International Outgoing:** Restricts all outgoing calls to abroad, which is controlled by password.
 - **International Expect Home**
- **Incoming Calls:**
 - **All Incoming:** Restricts all incoming calls which is controlled by password.
 - **When Roam:** Restricts a call when in a Roaming state.
- **Cancel All:** Cancel all the pre-set restricts, which is controlled by password.
- **Change Password:** In order to change password for call Restriction, select change password option and press OK(Center_Direction) Key then input the correct existing password first and then new password twice(it is to confirm that the new password is correct).

Call Time Reminder

- **Off**
- **Single:** You can easily set the single alert time. (1~3000Sec.)
- **Periodic:** You can easily set the periodic alert time. (30~60Sec.)

Auto Redial

If this function is selected, dialing will repeats automatically if the connection has failed since in absence or not answered. In 5 seconds, the phone will try to make a call to the number again automatically. If you do not want to use this function, press On(Left_selection) Key, or press OK(Center_Direction) Key to select Off.

● Call Time

This menu informs a calling time which has Sent or Receive.

1. In stand-by state, press menu(Left_selection) Key to display main menu option.
2. Use the direction Key to select Calls menu then press OK (Center_Direction) Key.
3. On calls screen, select Call Time and press OK(Center_Direction) to display the following information.



The following is to describe the option.

- **Last Call Time:** Used call time for the last call.
- **Total Sent:** Used total call time for all sent calls.
- **Total Received:** Used total call time for all received calls.
- **Reset All Time:** Reset all call time.

● Call Cost

This menu informs a cost of called which has Sent or Receive.

1. In stand-by state, press menu(Left_selection) Key to display main menu option.
2. Use the direction Key to select Calls menu then press OK (Center_Direction) Key.
3. On calls screen, select Call Cost and press OK(Center_Direction) to display the following information.



The following is to describe the option.

- **Last Call Cost:** Informs a call cost of last call.
- **Total Cost:** Informs a call cost of total call.
- **Reset Cost:** Reset all call cost.
- **Max Cost:** Fix a limitation of call cost. It can not be use if the call cost has reached the limitation.
- **Price Per Unit:** Fix a price per unit of call cost.

SMS Counter

This menu informs a quantity of SMS which has Sent or Received.

1. In stand-by state, press menu(Left_selection) Key to display main menu option.
2. Use the direction Key to select calls menu then press OK (Center_Direction) Key.
3. On calls screen, select SMS Counter and press OK(Center_Direction) to display the following information.



The following is to describe the option.

- Sent
- Received

GPRS Counter

This menu informs a quantity of MMS which has Sent or Received.

1. In stand-by state, press menu(Left_selection) Key to display main menu option.
2. Use the direction Key to select calls menu then press OK (Center_Direction) Key.
3. On calls screen, select GPRS Counter and press OK(Center_Direction) to display the following information.



The following is to describe the option.

- Last Sent
- Last Received
- All Sent
- All Received
- Reset Counter

Delete Call Log

This option is used for you to erase all the call lists through call option menu. (Missed, Received, Dialed, All). It will erase all the record of calls with ease.

1. In stand-by state, press menu(Left_selection) Key to display main menu option.
2. Use the direction Key to select Calls menu then press OK (Center_Direction) Key.
3. On calls screen, select Delete Call Log and press OK(Center_Direction) Key to display the following information.

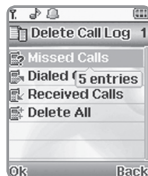

The following is to describe the option.

- **Missed Calls:** Deletes all absence calls saved.
- **Dialed Calls:** Deletes all sent calls saved.
- **Received Calls:** Deletes all received calls saved.
- **Delete All:** Deletes all the lists of calls saved.

2. Phone Book

In Phonebook, phone number, name and other information are saved and displayed.

1. In stand-by state, press menu(Left_selection) Key to display main menu option.
2. Use the direction Key to select Phone Book menu then press OK(Center_Direction) Key.





Option list related with Phone Book menus will be displayed as shown below;

- Quick Search
- Search Entry
- Add New Entry
- Caller Group
- Speed Dial
- Owner Number
- Extra Number
- Management

There are two points of contact in address book.

- 1. To SIM:** Information related with contact is saved in SIM memory only.
- 2. To phone:** Information is saved in phone memory only.

A special icon represents each contact.

In this way, duplicate contact uses SIM contact uses SIM card-shaped icon  , and the next icon  is used for phone contact.

The followings are several rules used in address book.

- As specified, address book displays whole address book on the screen to show all contacts.

Group will be represented by a special icon.

- Information in the phone book is displayed in alphabetic order. Phone number correspondent to each name is marked on the right of the line under the screen.
- Up to 30-character and 40-digit input can be saved in the phone book. (If the first text input is some symbol to represent international call, up to 41 is available)
- Up to 4 phone numbers are available for a name.
- Up to 250 addresses can be saved in SIM memory. (The number of addresses available differs from each other according to card capacity)
- Up to 500 entries can be saved in phone memory.
- If all the information of a name can not be displayed at a time on screen, press the direction Key to move the information vertically to display and read the rest on screen (being accordingly changed) to the end.

“.....” if displayed in the end of the screen means that there is more information to come.

Quick Search

In this menu you can find the Phone number Quickly which has stored in the Phone or SIM.

1. In stand-by state, press menu(Left_selection) Key to display main menu option.
2. Use the direction Key to select phone Book menu then press OK (Center_Direction) Key.
3. On calls screen, select Quick Search and press OK(Center_Direction) to display the following information.



4. On the Bottom, input characters up to 5 to find the contact name.

Select Quick Search and press Option(Left_selection) Key to display its options as follows;

- **View:** Shows details on contact being selected.
 - Name (it appears on the upper of the screen)
 - Number
 - Home Number
 - Company Name
 - Email Address
 - Office Number
 - Fax Number
 - Birthday
 - Associate Picture
 - Associate Video
 - Associate Sound
 - Caller Group
- **Edit:** Change the information of the name selected.
- **Delete:** Delete contact.
- **Copy:** Copy to SIM or Phone memory.
- **Move:** Move to SIM or Phone memory.
- **Duplicate:** To Duplicates contact.
- **Send SMS:** Send the SMS to selected phone number.
- **Send MMS:** Send the MMS to selected phone number.
- **Send vCard:** Sends vcard.

This option is used to search for other contacts on the contact list. Select Search option to display Search by name screen.

● Search Entry

Searches a Contact as written.

1. In stand-by state, press menu(Left_selection) Key to display main menu option.
2. Use the direction Key to select phone Book menu then press OK (Center_Direction) Key.
3. On calls screen, select Search Entry and press OK(Center_Direction) to display the following information.

This option is used to search for other contacts on the contact list. Select Search option to display Search by name screen. On the screen write characters up to 10 to find the contact name.

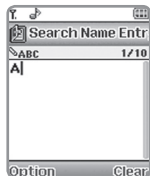

If written, the applicable name with the same characters is displayed. Now you may search up and down to find the name on the list. For example, press No.2 Key to fast reach names with the first character of C. If there is no name with such a character, the Key will show names with the next character (in alphabetical order).

Add New Entry

Adds entry to SIM or Phone.

1. In stand-by state, press menu(Left_selection) Key to display main menu option.
2. Use the direction Key to select phone Book menu then press OK (Center_Direction) Key.
3. On calls screen, select Add New Entry and press OK(Center_Direction) to display the following information.



This option adds new contact to address book. To store the new contact, the storage should be selected first as following.

- **To SIM:** Input name and number then press OK(Left_selection) Key. Select yes to save contact in SIM memory.



2. Phone Book

- **To Phone:** Input name, number, home number, company name, email address, office number, fax number, birthday, associate picture, associate video, associate sound and caller group then press Done(Right_selection) Key. Select yes to save contact in Phone memory.



A screenshot of a mobile phone's contact entry form. The form is titled "Company Name" and contains several input fields with icons to their left: a person icon for "JT", a phone icon for "58888", a house icon for "088999", a document icon for "TJTW", an envelope icon for "Email Address", and a briefcase icon for "Office Number". At the bottom of the form are two buttons: "Edit" on the left and "Done" on the right.

Field	Value
Company Name	JT
Phone Number	58888
Home Number	088999
Company Name	TJTW
Email Address	
Office Number	

● Caller Group

By using the Caller Group, you can easily distribute a contact into Group.

1. In stand-by state, press menu(Left_selection) Key to display main menu option.
2. Use the direction Key to select phone Book menu then press OK (Center_Direction) Key.
3. On calls screen, select Caller Group and press OK(Center_Direction) to display the following information.



Caller Group Details

Select group press OK(Center_Direction) to display its options as follows;



Rename Group

It is used to change selected group name. Select group name on Caller Group details screen and press Edit(Left_Direction) Key to display Write Rename group screen. Use alphabet/number buttons to change to new name. Press OK(Center_Direction) Key then select done to finish.

Group Ringer

It is used to change select group ringer. Select ringer on Caller Group details screen. Use Left/Right direction Key to select group ringer.

Group Picture

It is used to change select group picture. Select picture on Caller Group details screen. Use Left/Right direction Key to select group picture or select View(Left_selection) Key then use Upper/Lower direction Key to select group picture.

Group Color Pattern

It is used to change select group color pattern. Select Color Pattern on Caller Group details screen. Use Left/Right direction Key to select None or Color pattern 1~6.

Associate video

It is used to change select associate video. Select Video on Caller Group details screen. Use Left/Right direction Key to select None, Video 1 or From File.

Add Member

It is used to add member in group. Select Member List on Caller Group details screen. Press OK or option(Left_selection) Key and select Add. Select contact and press Add(Left_selection) then select Yes(Left_selection) to finish.

● Speed Dial

1. In stand-by state, press menu(Left_selection) Key to display main menu option.
2. Use the direction Key to select phone Book menu then press OK (Center_Direction) Key.
3. On calls screen, select Speed Dial and press OK(Center_Direction) to display the following information.

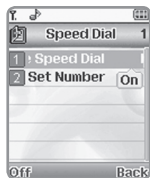

4. Select Enable Speed Dial on Speed Dial screen to Speed Dial On/Off.

If this option is applied, you can use a fast call. Select number and then press it to make a fast call thereto in stand-by state. How to make it available is as follows;

Setting Speed Dial Number

In the mobile, individual phone number can be set to each number Key of 2 to 9. For example, if you want to set Key No.7 for certain fast dial number, the procedures below shall be followed.

1. In stand-by state, press menu(Left_selection) Key to display main menu option.
2. Use the direction Key to select Phone Book menu then press OK(Center_Direction) Key.
3. On Phonebook screen, select Speed Dial and press OK (Center_Direction) to display the Speed dial menu.
4. Select the Speed dial on to enable.
5. Select Set Number and press OK(Center_Direction) Key to go into speed dial setup window.



6. Select 7 and press Option(Left_selection) Key then select Edit.



2. Phone Book

7. Select any contact number you want to connect with Key No.7 and press OK(Center_Direction) Key.



8. Press option(Left_selection) Key and select Edit or Delete if you want to Edit or Delete the fast call connection.



If the fast dial number is presently activated, keep pressing Key No.7 till the call connects.

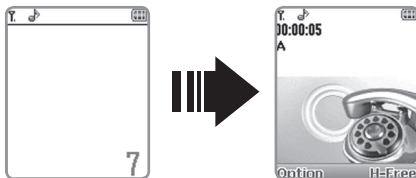

Owner Number

The number of owner number can vary (up to 4) depending on the SIM.

1. In stand-by state, press menu(Left_selection) Key to display main menu option.
2. Use the direction Key to select phone Book menu then press OK(Center_Direction) Key.
3. On calls screen, select Owner Number and press OK(Center_Direction) to display the following information.



4. Press option(Left_selection) Key and select Edit or Erase.
 - **Edit:** Edit an Owner Number.
 - **Erase:** Deletes an Owner Number.

● Extra Number

1. In stand-by state, press menu(Left_selection) Key to display main menu option.
2. Use the direction Key to select phone Book menu then press OK (Center_Direction) Key.
3. On calls screen, select Extra Number and press OK(Center_Direction) to display the following information.



The following is to describe the option.

- **Service Dial Number:** The list of numbers in the SDN (Service Dial Number) appears. Select service Numbers then press Call Key.
- **SOS Number:** The list of numbers in the SOS Number. Select SOS Number then press Call Key.

● Management

In Management menu, you can easily change the Storage or Copy and Delete and several other functions.

1. In stand-by state, press menu(Left_selection) Key to display main menu option.
2. Use the direction Key to select phone Book menu then press OK (Center_Direction) Key.
3. On calls screen, select Management and press OK(Center_Direction) to display the following information.



The following is to describe the option.

- **Memory Status:** Used to confirm the capacity and the condition of SIM card or phone memory.
- **Preferred Storage:** Select SIM or Phone.
- **Copy All:** Copy all from SIM to Phone or Phone to SIM.
- **Delete All:** Delete all from SIM, Phone or One By One.
- **Fields:** Setting Contact fields.
- **My vCard:** Edit and Send My Card.

This function allows you to create, send, read and save a message using the Short Message Service (SMS: text messages), Multimedia Message Service (MMS: messages supporting presentation of various media types, such as full color images and polyphonic ring tones) provided by your network operator. Voice mails are also available.

1. In stand-by state, press menu(Left_selection) Key to display main menu option.
2. Use the direction Key to select Message Center menu then press OK(Center_Direction) Key.

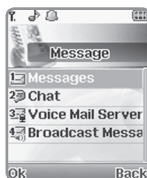

Option list related with Message menus will be displayed as shown below;

- **Messages**
- **Chat**
- **Voice Mail Server**
- **Broadcast Message**

Messages

1. In stand-by state, press menu(Left_selection) Key to display main menu option.
2. Use the direction Key to select Message Center menu then press OK(Center_Direction) Key.
3. On Message Center screen, Select Message and press OK (Center_Direction) Key to display the following information.

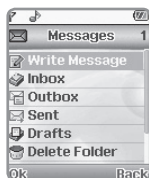

Send New SMS

1. On Write Message screen, Select Text Message and press OK (Center_Direction) Key to display the following information.
2. Input message.
3. Press option(Left_selection) Key.



The following is to describe the option.

- **Done:**
 - **Send Only:** Send message.
 - **Save and Send:** Save message then send message.
 - **Save:** Save the message.
 - **Send To Many:** Send message to many people.
 - **Send By Group:** Send message to group.
- **Use Template:** Insert a clause stored in Template.
- **Insert Object:** Allows user to insert some object in a message.
For example, picture (simple static picture), animation (small moving picture), melody (music), sound (simple bell).
- **Format Text:**
 - **Text Size:** Select Small, Medium or Large.
 - **Text Style:** Select On or Off for Bold, Italics, Underline and Strikethrough.
 - **Alignment:** Save message.
 - **New Paragraph:** Send message to many people.
- **Insert PHB Number:** Can input the number from Phonebook to SMS editor.
- **Insert PHB Name:** Can input the name from Phonebook to SMS editor.
- **Input Method:** Select Input method. (Alphabetic/Numeric/Symbols)

Send New MMS

1. On MMS screen, Select Write Message and press OK(Center_Direction) Key to display the following information.
 - **To:** Where main receiver's phone number or E-mail addresses will be surely specified. Up to 60 characters are available for E-mail and up to 40 numbers for the phone number.

- **Cc:** Where other receiver's contact will be displayed to receive copy of message. How to select receivers is as described previously. You may input several phone numbers or E-mail addresses to send a message to many receivers at a time through address book screen.
- **Bcc:** Where other receiver's contact will be displayed to receive copy of message. How to select receivers is as described previously. You may input several phone numbers or E-mail addresses to send a message to many receivers at a time through address book screen.
- **Subject:** Where title of message will be displayed. Select this option and press Edit(Left_Direction) Key to go to Subject screen described previously to input up to 40 characters.
- **Edit Content:** Where details of message are written. Press Edit (Left_Direction) Key to go to Subject screen described previously to input up to 612 characters.
 - **Done:** To send or Save Message.
 - **Input Method:** Select Multitap ABC, Multitap abc, Numeric, Smart ABC, Smart abc, Smart ES, Smart es, Smart FR, Smart fr or Insert Symbols.
 - **Add Image:** It is used to attach picture or image already saved in the phone.
 - **Add Audio:** It is used to add desired sound to MMS. (You may select the sound saved in the phone or the sound being recorded to the phone using the microphone.)
 - **Add Video:** It is used to add desired Video to MMS. (You may select the Video saved in the phone or the Video being recorded to the phone using the video recorder.)
 - **Add Attachment:** It is used to add desired Attachment to MMS.
 - **Insert New Slide:** Adds a new slide page to create more slides. You can move to each slide page using the Left/Right direction key on the message composer screen.
 - **Preview:** Displays the appearance of the present messages page.
 - **Slide Timing:** Set the time duration that the received messages displayed. The display the display Automatically scrolls to the next slide page after the specified time.

2. Press Done(Right_Direction) Key to display the following information.

- **Send Only:** Send message.
- **Save and Send:** Save then send message.
- **Send to Drafts:** Saves the written multimedia message in Draft MMS folder. Alphabetic or numeric mode: You may select a mode to input messages.
(Capital letters, small letters, etc.)
- **Send Options:**
 - **Validity period:** Maximum period can be specified as necessary to make message sent. If once the period is over, the message will be automatically deleted. 1 hour, 12 hours, 1 Day, 1 week and the maximum are available for the period. The maximum has been previously established by its service provider. However, the minimum is 1 hour as described above.
 - **Delivery Report:** If this function is executed, the message sender will have information on message transfer from MMS service center, through which the message sender can be sure if the message has been read by the receiver or still saved in MMS service center. This information includes the receivers phone number, message details, present state (if transferred or kept in MMS service center), transfer time and date.
 - **Read Report:** If this option is executed, you can be sure if its receiver has read the message or not. Once the receiver read the message, the time and date when the message was read will be sent to its sender. No option is available for this function. It lets you be sure if the message has been read by the receiver or not.
 - **Priority:** Displays priority of multimedia messages sent.
(Normal, High, Low)
- **Exit:** To exit write message.

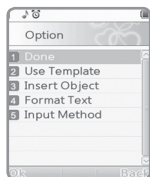

Inbox of SMS

In Inbox, all the received SMS will be stored. It can be stored up to 100. If a message is received, separately specified sound of bell will operate. And as shown below, an image will be displayed on the screen.



View Saved Message Not Read Yet

Follow the procedures below to read new message saved.

- a. **Read Text Message:** Select text message option to display text message list, received. Each message has an icon and sender's number, date. There are two kinds of icons;
 -  This icon means that the message in the Inbox is not read yet.
 -  This icon means that the message in the Inbox is read already.

Select a text message to read now and press option(Left_selection) Key.



- **Reply:** Displays Write Text Screen to replay to the message received. Write message as desired. If you want to know how to write and send text message (SMS), refer to <Send New SMS>.
- **Forward:** Delivers the received message to others. Input the phone number directly thereon or select a receiver on address book. Then press OK(Center_Direction) Key.
- **Edit:** Edit the message.
- **Delete:** Delete the SMS.
- **Delete All:** Deletes all the SMS.
- **Use Number:** Use dial or save to phonebook.
- **Use URL:** Use URL which is in a Message.
- **Chat:** Select Start New and send message.
- **Advanced:**
 - **Copy to SIM/Phone:** Copy the Selected Message to Phone or SIM.
 - **Move to SIM/Phone:** Move the Selected Message to Phone or SIM.
 - **Copy All text Messages:** Copies all the Selected Message.
 - **Move All Text Messages:** Moves all the Selected Message.

Inbox of MMS

MMS received and saved. Select message to read and press option (Left_selection) Key to display various option menus.

- **View:** Viewing all information related with the message.
- **Reply:** Reply the MMS Message to Sender's number.
- **Reply by SMS:** Reply the MMS Message to Sender's number by SMS.
- **Reply to all:** Reply the MMS Message to Sender's and CC, BCC number.
- **Forward:** Forwards the Message to others receiver.
- **Edit:** Edits all information related with the message.
- **Delete:** Delete draft message.
- **Delete All:** Delete all draft messages.
- **Properties:** Shows the message as it appears on the recipient's phone.
- **Use Number:** Use dial or save to phonebook.

Outbox of SMS

Outbox stores messages that you have failed to send, or canceled.

- **Send:** Send draft message.
- **Edit:** Edits all information related with the message.
- **Delete:** Delete draft message.
- **Delete All:** Delete all draft messages.
- **Use Number:** Use dial or save to phonebook.
- **Use URL:** Use URL which is in a Message.
- **Advanced:**
 - **Copy to SIM/Phone:** Copy the Selected Message to Phone or SIM.
 - **Move to SIM/Phone:** Move the Selected Message to Phone or SIM.
 - **Copy All text Messages:** Copies all the Selected Message.
 - **Move All Text Messages:** Moves all the Selected Message.

Outbox of MMS

Outbox stores messages that you have failed to sent .

- **View:** Viewing all information related with the message.
- **Send:** Send draft message.
- **Edit:** Edits message and the receiver number.
- **Delete:** Delete draft message.
- **Delete All:** Delete all draft messages.
- **Properties:** Shows the message as it appears on the recipient's phone.
- **Save Object:** Save object which is attached in Message.
- **Use Number:** Use dial or save to phonebook.

Sent of SMS

- **Forward:** Forwards sent message to other receiver.
- **Edit:** Edits all information related with the message.
- **Delete:** Delete draft message.
- **Delete All:** Delete all draft messages.
- **Use Number:** Use dial or save to phonebook.
- **Use URL:** Use URL which is in a Message.
- **Advanced:**
 - **Copy to SIM/Phone:** Copy the Selected Message to Phone or SIM.
 - **Move to SIM/Phone:** Move the Selected Message to Phone or SIM.
 - **Copy All text Messages:** Copies all the Selected Message.
 - **Move All Text Messages:** Moves all the Selected Message.

Sent of MMS

Outbox stores messages that you have sent, or failed to send, or canceled.

- **View:** Viewing all information related with the message.
- **Edit:** Edits all information related with the message.
- **Forward:** Forwards sent message to other receiver.
- **Edit:** Edits message and the receiver.
- **Delete:** Delete draft message.
- **Delete All:** Delete all draft messages.
- **Properties:** Shows the message as it appears on the recipient's phone.
- **Save Object:** Save object which is attached in Message.
- **Use Number:** Use dial or save to phonebook.

Draft of SMS

Select Save to save a SMS to Draft box.

- **Send:** Send draft message.
- **Edit:** Edits message and receiver's number.
- **Delete:** Delete draft message.
- **Delete All:** Delete all draft messages.
- **Use Number:** Use dial or save to phonebook.
- **Use URL:** Use URL which is in a Message.
- **Advanced:**
 - Copy to SIM/Phone:** Copy the Selected Message to Phone or SIM.
 - Move to SIM/Phone:** Move the Selected Message to Phone or SIM.
 - Copy All text Messages:** Copies all the Selected Message.
 - Move All Text Messages:** Moves all the Selected Message.