

DMC-CM1 FCC ID Label and Location

FCC ID : UCE314062A

The FCC ID is displayed on non-removable label tray with stopper structure according to below drawings.

The description how to check the nameplate displayed on the label tray is in the operation manual, and the user can access the nameplate.

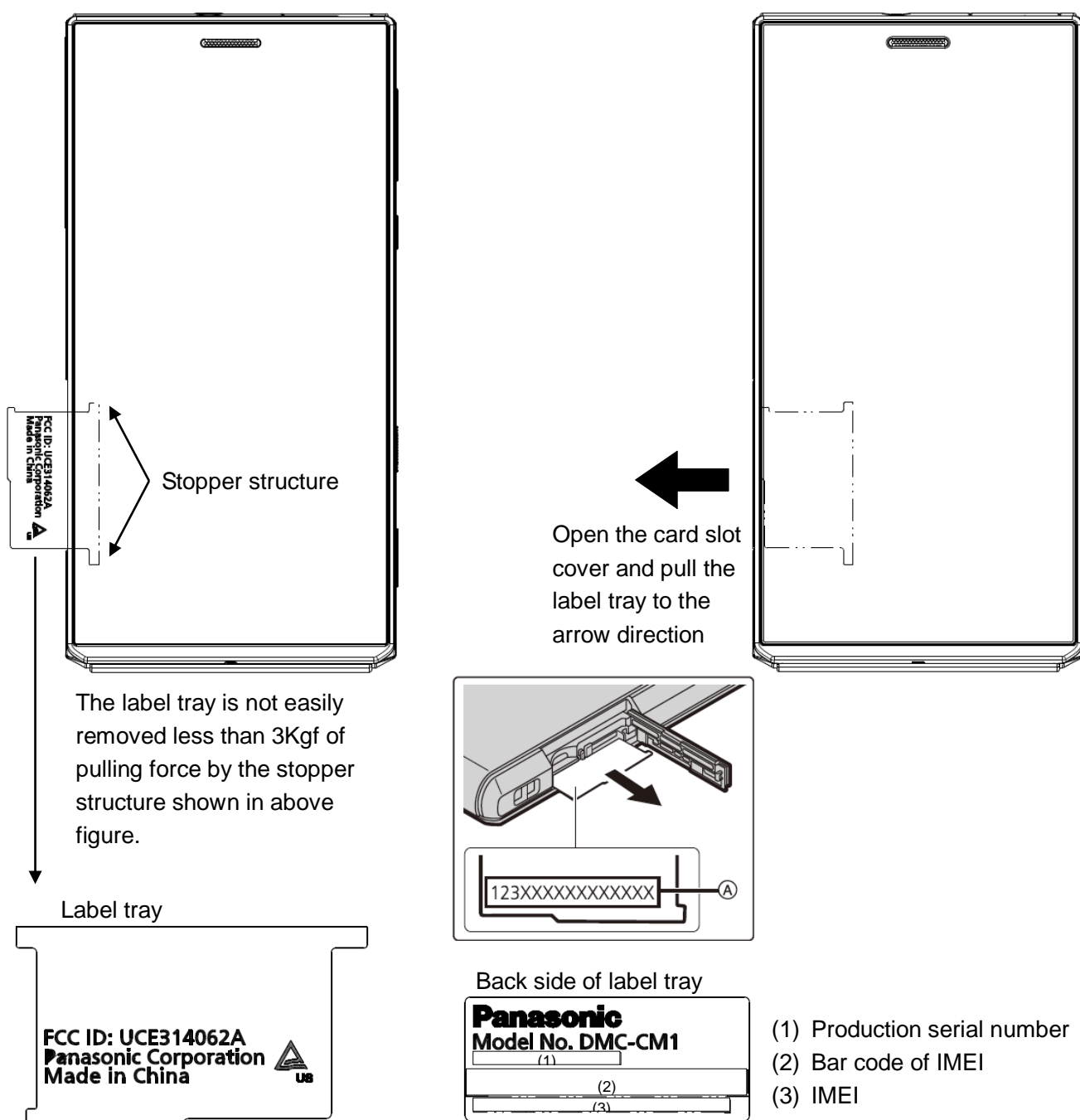

This device complies with part 15 of the FCC Rules. Operation is subject to the following two conditions:

- (1) This device may not cause harmful interference, and
- (2) this device must accept any interference received, including interference that may cause undesired operation.

The above description is display in the operation manual because it is difficult to display above description on the camera lens face and also LCD face of this device, and there is no space for the description on the label tray.