

Setup Instructions

Quick Setup

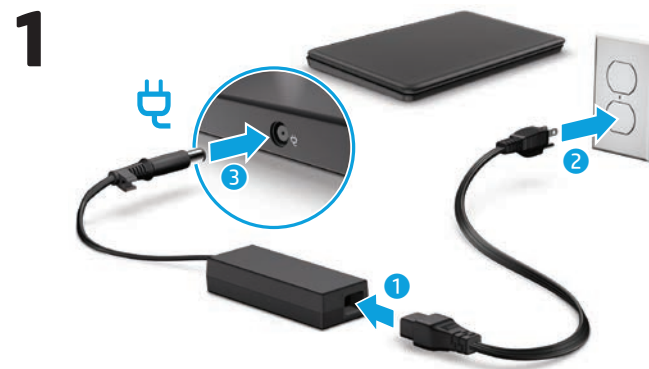

NOTE: Your computer has a preinstalled battery. Before you press the power button to turn on the computer for the first time, make sure that the AC adapter is connected to the computer.



How to change your notebook into an entertainment stand



Raise the display, and then rotate the display backward to a stand position (about 315 degrees).

How to change your notebook into a tablet



Raise the display, and then rotate the display backward until the display back is flush with the computer bottom (360 degrees).

Your computer is protected by a free subscription to McAfee LiveSafe™ service for a limited time from the first time you use the computer. You will have the option to purchase McAfee LiveSafe service upon expiration of the subscription. McAfee LiveSafe service helps protect your identity, your data, and your devices with a single subscription.*

* Select products only.

Regulatory Model Number and Simplified Declaration of Conformity

The Regulatory Model Number (RMN) for this equipment is TPN-W112. This RMN is located on the bottom of the computer.

Hereby, HP declares that this equipment is in compliance with the essential requirements and other relevant provisions of Directive 1999/5/EC. To view the Declaration of Conformity for this equipment, go to www.hp.eu/certificates and search using this equipment's RMN.

Quick Tour

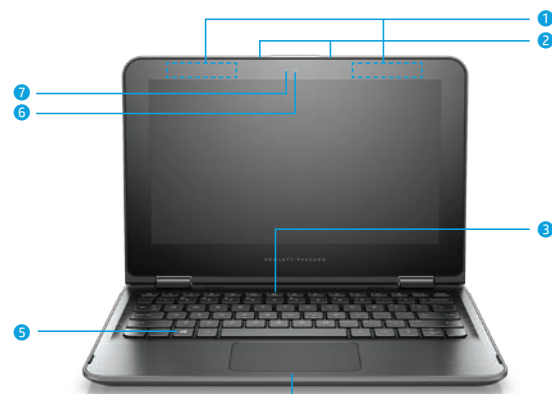

- 1 WLAN antennas (1 or 2 depending on model)
- 2 Internal microphones (2)
- 3 Mute key and light
- 4 TouchPad
- 5 Windows® key (displays the Start menu)
- 6 Webcam
- 7 Webcam light

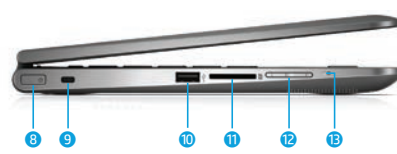

- 8 Power button
- 9 Security cable slot
- 10 USB port
- 11 Memory card reader
- 12 Volume button - +
- 13 Hard drive light



- 14 SIM slot*
- 15 Audio-out (headphone) and Audio-in (microphone) jack
- 16 Windows® button
- 17 USB ports (2)
- 18 HDMI port
- 19 RJ-45 (network) jack
- 20 AC adapter and battery light
- 21 Power connector



- 22 Speakers (2)

NOTE: Computer color, features, and accessories may vary.

* Select products only.

Software terms

By installing, copying, downloading, or otherwise using any software product preinstalled on this computer, you agree to be bound by the terms of the HP End User License Agreement (EULA). If you do not accept these license terms, your sole remedy is to return the entire unused product (hardware and software) within 14 days for a full refund subject to the refund policy of your seller.

For any further information or to request a full refund of the price of the computer, please contact your seller.

Limited Warranty

You can find your HP Limited Warranty located with the user guides on your product and/or on the CD or DVD provided in the box. In some countries or regions, HP may provide a printed warranty in the box. For countries or regions where the warranty is not provided in printed format, you can request a copy from <http://www.hp.com/go/orderdocuments>. For products purchased in Asia Pacific, you can write to HP at Hewlett Packard, P.O. Box 200, Alexandra Post Office, Singapore 911507. Include your product name, and your name, phone number, and postal address.

Go wireless

Select the network icon in the lower-right corner of the taskbar, and then connect to one of the available networks.

– or –

Type **wireless** in the taskbar search box, and then select **Connect to a network**.

NOTE: To set up a WLAN and connect to the Internet, you need a broadband modem (either DSL or cable) (purchased separately), high-speed Internet service purchased from an Internet service provider, and a wireless router (purchased separately).

Locate system information

Depending on your product, a service label is either affixed to the bottom of the computer or is located inside the battery bay or beneath the service door.

In Windows, briefly press the **fn+esc** key combination to display the System Information screen.

Find more information

Windows products To learn more about Windows and to access help topics, select the **Start** button , and then select the **Get started** app.

To access the user guides, type **support** in the taskbar search box, select **HP Support Assistant**, select **My PC**, select the **Specifications** tab, and then select **User guides**.

Linux products Double-click the **HP Documents** icon on the desktop.

FreeDOS products On the Boot Menu, select **HP Documents**.

NOTE: You do not need to connect to the Internet to access the user guides.

NOTE: A *User Guides* disc is included with some products.

Feedback on this document

To help us improve this document, please send any suggestions, comments, or errors to doc.feedback@hp.com. Include the document part number (located near the bar code) when submitting your feedback.

Contact support

To resolve a hardware or software problem, go to <http://www.hp.com/support>. Use this site to get more information about your product, including links to discussion forums and instructions on troubleshooting. You can also find information on how to contact HP and open a support case.

Replace this box with PI statement as per spec.



824307-001



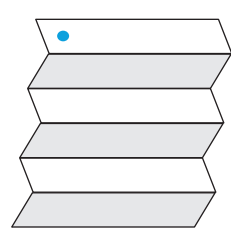

Navigating the Windows Start screen

The Windows Start screen provides a central location where you can access your information and email, browse the Web, stream videos, view photos, and access your social media websites. Depending on your product, you can use a keyboard and mouse, a TouchPad, or a touch screen to navigate the Windows Start screen.

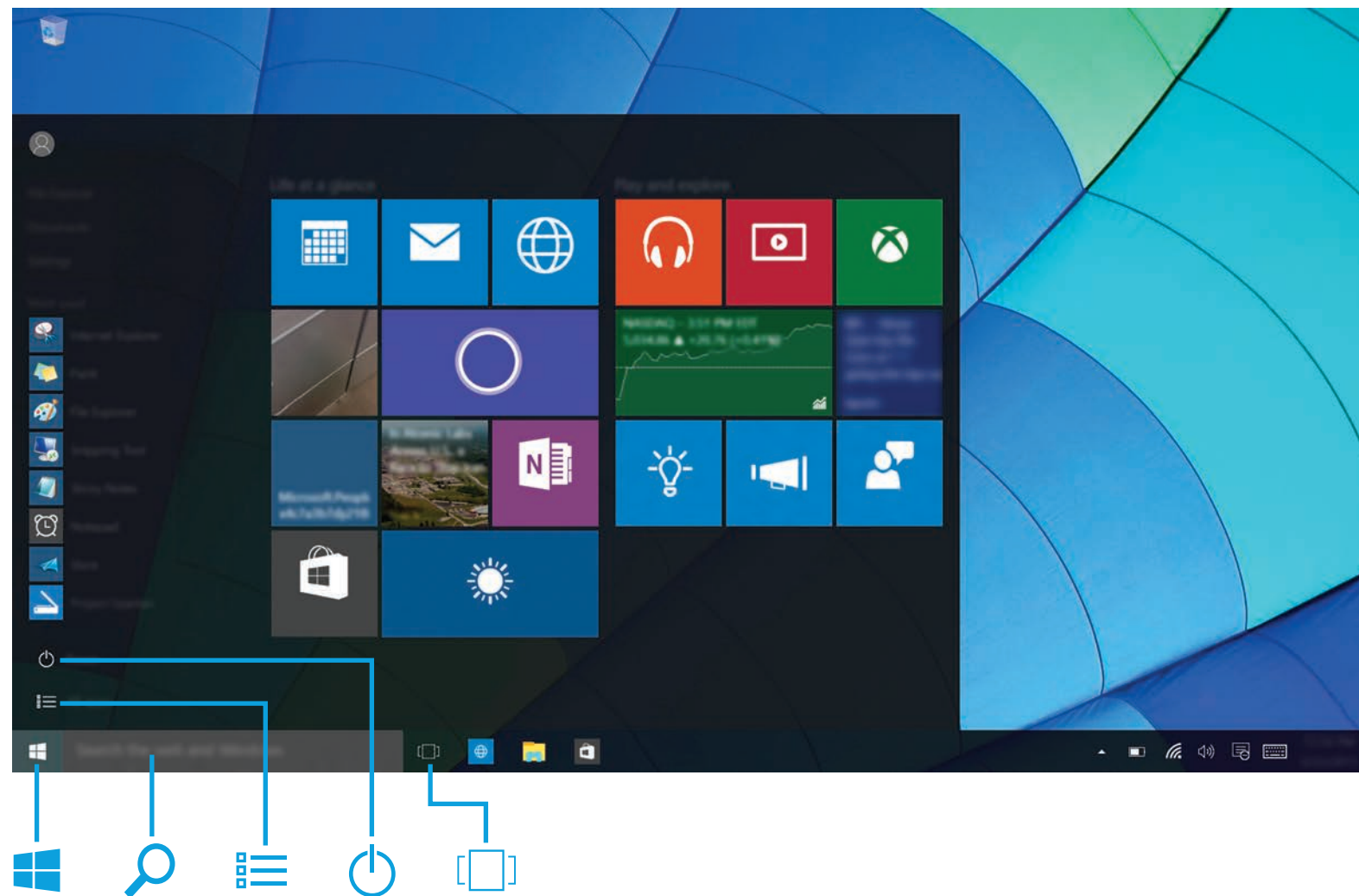

Display the Start menu
 Select the **Start** button  in the lower-left corner of the taskbar.

Search
 In the taskbar search box, begin typing the name of an app, setting, file, or Internet topic.

List your apps
 Select the **Start** button , and then select **All apps** .

Shut down your computer
 Select the **Start** button , select the **Power** icon , and then select **Shut down**.

Switch between open apps
 Select the **Task view** icon  in the taskbar.

NOTE: The appearance of the Windows screen may vary.

Touch Gestures

Use these common touch gestures with the TouchPad and, on select products, with a touch screen. For information about additional gestures, refer to the user guide included with your computer. To locate the user guide, see the "Find more information" section of this poster.



Tap or double-tap to select

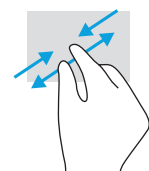

Two-finger pinch zoom



Two-finger click
(TouchPad only. Same as right-clicking with mouse.)

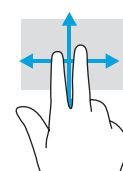

Two-finger scroll
(TouchPad only)

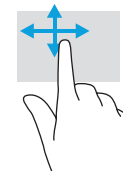

One-finger slide
(touch screen only)

NOTE: Some computers, apps, and files do not support all touch gestures.

WARNING: To reduce the risk of electric shock or damage to the equipment:

- Plug the power cord into an AC outlet that is easily accessible at all times.
- Disconnect power from the computer by unplugging the power cord from the AC outlet.
- If provided with a 3-pin attachment plug on the power cord, plug the cord into a grounded (earthed) 3-pin outlet. Do not disable the power cord grounding pin, for example, by attaching a 2-pin adapter. The grounding pin is an important safety feature.

For more safety and regulatory information, and for battery disposal information, refer to the *Regulatory, Safety and Environmental Notices* provided with your user guides. To locate the user guides for your computer, see the "Find more information" section of this poster.

WARNING: To reduce the risk of serious injury, read the *Safety & Comfort Guide* provided with your user guides. It describes proper workstation setup, and proper posture, health, and work habits for computer users. The *Safety & Comfort Guide* also provides important electrical and mechanical safety information. The *Safety & Comfort Guide* is also available on the Web at <http://www.hp.com/ergo>.

WARNING: To reduce the possibility of heat-related injuries or of overheating the computer, do not place the computer directly on your lap or obstruct the computer air vents. Use the computer only on a hard, flat surface. Do not allow another hard surface, such as an adjoining optional printer, or a soft surface, such as pillows or rugs or clothing, to block airflow. Also, do not allow the AC adapter to contact the skin or a soft surface, such as pillows or rugs or clothing, during operation. The computer and the AC adapter comply with the user-accessible surface temperature limits defined by the International Standard for Safety of Information Technology Equipment (IEC 60950-1).

Product description
 This product is a lightweight notebook computer and features a thin-panel display, TouchPad, processor, keyboard, RAM, integrated battery pack, hard drive or solid-state drive, and an external AC adapter. The printed *Setup Instructions* identify the hardware components of your computer. Depending on your product, the AC adapter has a rating of 100–240 V ac, 50/60 Hz, 2.3–4.6 A.

To access the latest user guide, go to <http://www.hp.com/support>, and select your country. Select **Drivers & Downloads**, and then follow the on-screen instructions.

© Copyright 2015 HP Development Company, L.P.

McAfee LiveSafe is a trademark of McAfee, Inc. in the United States and other countries. Windows is a trademark of the Microsoft group of companies.

Not all features are available in all editions of Windows. This computer may require upgraded and/or separately purchased hardware, drivers, and/or software to take full advantage of Windows functionality. See <http://www.microsoft.com> for details.

The information contained herein is subject to change without notice. The only warranties for HP products and services are set forth in the express warranty statements accompanying such products and services. Nothing herein should be construed as constituting an additional warranty. HP shall not be liable for technical or editorial errors or omissions contained herein.

First Edition: September 2015