







E-YOOSO®
Category : 2.4GHz Wireless Keyboard
Model: E-787 Rating: 3V = 3.0mA
S/N: 231102696
Service Email: Eyoososervice@163.com
FCC ID: TUVET-8804A
This device complies with Part 15 of the FCC Rules. Operation is subject to the following two conditions:
(1) this device may not cause harmful interference, and
(2) this device must accept any interference received, including interference that may cause undesired operation.



MADE IN CHINA

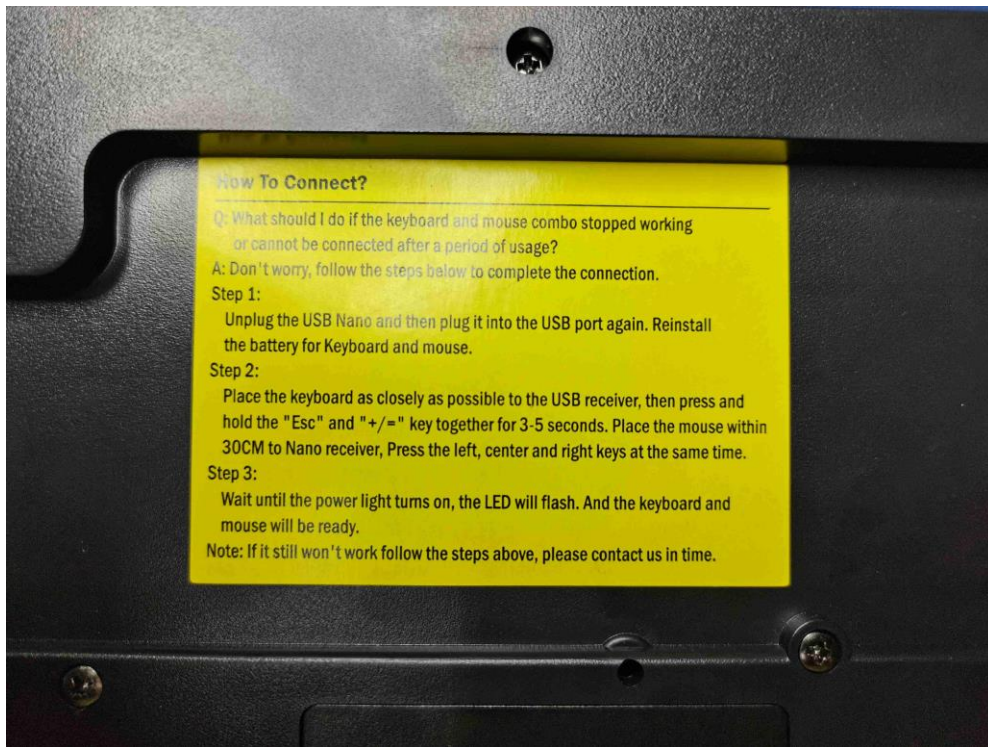

How To Connect?
Q: What should I do if the keyboard and mouse combo stopped working or cannot be connected after a period of usage?
A: Don't worry, follow the steps below to complete the connection.
Step 1:
Unplug the USB Nano and then plug it into the USB port again. Reinstall the battery for Keyboard and mouse.
Step 2:
Place the keyboard as closely as possible to the USB receiver, then press and hold the "Esc" and "+/=" key together for 3-5 seconds. Place the mouse within 30CM to Nano receiver, Press the left, center and right keys at the same time.
Step 3:
Wait until the power light turns on, the LED will flash. And the keyboard and mouse will be ready.
Note: If it still won't work follow the steps above, please contact us in time.

Step 3:

Wait until the power light turns on, the LED will flash. And the keyboard and mouse will be ready.

Note: If it still won't work follow the steps above, please contact us in time.

