

Product Feature

- 2.4G wireless connection, operating range 10 meters.
- IR light tracing technology, work with many of surface.
- 5 switchable DPI 800/1200/1600/2000/2400 settings.
- Ergonomic design.
- Compatibility with Windows/Mac operating system.
- Plug & play Nano receiving adapter.

Before use:

1. Find the wireless mouse and keyboard and one Nano receiver in the box. Please note that nano receiver is placed into inne box.

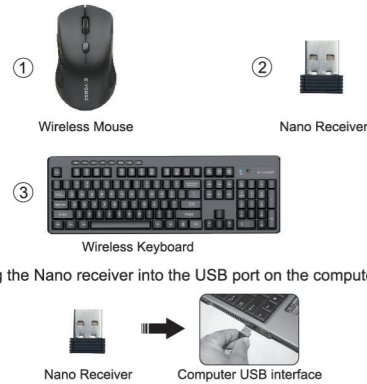

2. Plug the Nano receiver into the USB port on the computer.

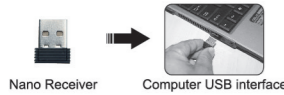

3. Install 1x AA battery into the Mouse, install 2x AAA batteries into the keyboard.



4. The LED indicator on the mouse and keyboard will flash for a few seconds, and indicate that the products are now working.

Product specification

1. DPI adjustable function

5 level DPI DPI 800/1200/1600/2000/2400, Default 1200DPI, press the DPI key, available to switch between the five gears till you like. During the switching process, the LED indicator will flash once for 800DPI, twice for 1200DPI, three times for 1600DPI, four times for 2000DPI and five times for 2400DPI.



2. Low power alarm function

The LED indicator on keyboard and the mouse will be flash in RED when the battery is going to out of work, please replace new battery in time.

3. power saving mode

If you mouse is stay out of work for 8 minutes, it will turn to power saving mode, press any button to restart it.

4. Keyboard :FN key function

Press FN + F1~F12 for multi-media functions.

5. Reprogramming the devices

Keyboard and Mouse and receiver need to reconnect under the condition of High temperature, high magnetic, strong vibrate Power outages.

Mouse connection:

1. Plug the Nano receiver into the USB port.
2. Mouse within 50CM to Nano receiver, reinstall the battery, Press any key to reconnect, the above operation must be completed in 15 seconds.
3. Your mouse should now be synced.



Keyboard connection:

1. Plug the Nano receiver into the USB port.
2. Press and hold the ESC key and K key for 3 seconds.
3. The Keyboard will be ready once the LED flashes for 3 seconds



● Caution

This mouse uses 2.4GHz radio waves to transmit data with a working distance of 10m. Ensure that there are no large objects between the mouse and the Nano receiver.

Tip: Remove the battery if the mouse is not going to be used for long periods of time.



Remark

This equipment complies with Class B rules in digital apparatus and complies with Part 15 of the FCC Rules.

Warranty

The warranty period of our products is 12 months from purchase.If a defective is found due to qualified problems of the product, please contact us;
Service Email: Eyoososervice@163.com

Package content

Wireless Mouse Wireless Keyboard
Nano Receiver User Manual

Eastern Times Technology Co.,Ltd.

Add: Building D,Nan An Industrial Area,Youganpu Village, Fenggang Town, Dongguan City,Guangdong,China
TEL:86-769-86800666 Service Phone Number:400-865-9898
Fax:86-769-86800338 Welcome to Address: www.eyspc.cn

Changes or modifications not expressly approved by the party responsible for compliance could void the user's authority to operate the equipment.This equipment has been tested and found to comply with the limits for a Class B digital device, pursuant to Part 15 of the FCC Rules. These limits are designed to provide reasonable protection against harmful interference in a residential installation. This equipment generates uses and can radiate radio frequency energy and, if not installed and used in accordance with the instructions, may cause harmful interference to radio communications. However, there is no guarantee that interference will not occur in a particular installation. If this equipment does cause harmful interference to radio or television reception, which can be determined by turning the equipment off and on, the user is encouraged to try to correct the interference by one or more of the following measures:-- Reorient or relocate the receiving antenna.

- Increase the separation between the equipment and receiver.
 - Connect the equipment into an outlet on a circuit different from that to which the receiver is connected.
 - Consult the dealer or an experienced radio/TV technician for help
- This device complies with part 15 of the FCC rules. Operation is subject to the following two conditions (1)this device may not cause harmful interference, and (2) this device must accept any interference received, including interference that may cause undesired operation.

MADE IN CHINA



Quick Start Guide

Model: E-777
2.4Ghz Wireless Keyboard and Mouse Combo

产品特点

- 2.4G工作频率,通用性强,无遮挡传输距离远达10米。
- 使用红外线作为移动寻迹光源,耗电率低,过面能力强。
- 分辨率5档可调 800/1200/1600/2000/2400DPI。
- 人体工程学原理的外形设计理念。
- 系统支持 Windows/Mac。
- 微型(Nano)接收器,即插即用。

产品安装

- 1.从包装盒里取出无线键盘,鼠标及接收器。



- 2.把超微型(Nano)接收器插入主机的USB接口。



- 3.把2节 AAA碱性干电池按正确极性装入键盘内部,把1PCS AA碱性干电池按正确极性装入鼠标内部。



- 4.键盘LED指示灯及鼠标DPI处的LED灯会闪烁几秒,现在您即可使用本产品了。

产品高级功能

1. DPI 调节功能

鼠标具有 800/1200/1600/2000/2400 五档 DPI 调节。上电默认的是 1200CPI,如果您想切换其他的速度,请按 DPI 键切换 DPI,即可以在这三档之间切换,一直到您喜欢的速度为止。切换过程中,LED 指示灯会 800DPI 闪烁 1 次,1200DPI 闪烁 2 次,1600DPI 闪烁 3 次,2000DPI 闪烁四次,2400DPI 闪烁五次。



2. 电池低电压提醒功能

键盘和鼠标上的LED指示灯出现红色闪烁时,请及时更换新的电池。

3.自动休眠和完全关机功能

如果您8分钟不使用鼠标,鼠标将进入自动休眠的关机状态,以便节省电能。重新开机使用您只要随意按任意键即可。

4. 键盘:FN键功能

按FN + F1~F12进行多媒体功能。

5. 重新连接

键鼠在高温、强磁场、振动、断电的情况下识别码将消失,需要重新连接才可以使用,方法如下:
无线鼠标连接:

- 1.将Nano接收器插入USB端口。
- 2.将鼠标离接收器30CM重新装入电池按任意键即可连接成功。
- 3.对码成功,便可使用无线鼠标了。



无线键盘连接:

- 1.将Nano接收器插入USB端口。
- 2.同时按住ESC键和K键3秒。
- 3.当LED灯闪烁3秒后,LED闪亮后即对码成功,便可使用无线键盘了。



● 注意事项

本产品使用2.4GHz无线电波传送数据,无遮挡使用距离为10米内,确保鼠标和Nano接收器之间有较大的障碍物,环境干扰,使用距离将减少,在凹凸不平,反光等桌面上可能影响鼠标的的使用。

提示:如果键鼠长时间不使用,请取出电池,以免腐蚀机件。



备注

此设备必须符合FCC第15条的规定。

保修

我们的产品保修期为12个月。如因产品存在质量问题而发现缺陷,请与我们联系;
电子邮件服务: Eyoososervice@163.com

包装内容

无线鼠标 无线键盘
USB接收器 用户手册

东莞市丰润计算机有限公司

地址:广东省东莞市凤岗镇油甘埔村南岸工业区D栋
电话: 86-769-86800666 传真: 86-769-86800338
服务电话: 400-865-9898 网址: www.eyspc.cn
鼠标引用国标: GB/T 26245-2010 键盘引用国标: GB/T 14081-2010
中国制造

为满足中国电子电气产品有害物质限制相关的法律和其它要求,对本产品中有害物质,按部件分类,声明如下。

部件名称	有害物质					
	铅(Pb)	汞(Hg)	镉(Cd)	六价铬(Cr(VI))	多溴联苯(PBB)	多溴二苯醚(PBDE)
印刷电路板组件	X	O	O	O	O	O
外壳及附件	O	O	O	O	O	O

本表格依据SJ/T 11364的规定编制。
O: 表示该有害物质在该部件所有均质材料中的含量均在GB/T 26572规定的限量要求以下。
X: 表示该有害物质至少在该部件的某一均质材料中的含量超出GB/T 26572规定的限量要求。
表中标记“X”的部件,皆因全球技术发展水平限制而无法实现有害物质的替代。
印刷电路板组件: 包括印刷电路板及其零部件,电子元器件等根据产品型号不同,您所购买的产品可能不会含有以上所有部件

10 在中华人民共和国境内销售的电子电气产品必须标识此标志,标志内的数字代表在正常的使用状态下的产品的环保使用期限。

《废弃电器电子产品回收处理管理条例》

E元素倡导环保和低碳的消费体验,建议拥有该产品的用户在不需此产品时,应遵守国家废弃电器电子产品回收处理相关法律法规,将其交给当地具有国家认可的回收处理资质的厂商进行回收处理,降低资源浪费,保护地球自然环境。



快速入门指南

型号: E-777
2.4Ghz无线键鼠套装

型号	E-777-8418+2750	备注: 尺寸: L75*W105mm
名称	说明书	材质: 80g书写纸
日期	2022-1-16	印刷: 单黑双面印刷
页码	1 OF 5	文件编号
绘图	何周平	审核
		核准
		版本
		A.0