

BeoPlay A3, BeoPlay A8, Beolit 12, BeoPlay A9, Beo4  
BeoPlay A8 remote control, BeoPlay H3, BeoPlay H6  
Form 2i

**Important**

**Viktigt**

**Viktigt**

**Tärkeää**

**Wichtiger Hinweis**

**Important**

**Importante**

**Importante**

**Belangrijk**

**Importante**

**Σημαντικό**

**Внимание!**

**중요**

**重要**

**重要事項**

**注意**

For additional information, see (link provides content with regulatory conformance guidelines):

Se yderligere oplysninger på:

Mer information finns på:

Lisätietoja saat seuraavista osoitteista:

Für weitere Informationen, siehe:

Pour plus d'informations, visitez (lien fournit du contenu aux directives de conformité réglementaires):

Si desea obtener más información, visite el sitio web:

Per ulteriori informazioni, vedere:

Voor meer informatie, zie:

Para obter mais informações, consulte:

Για περισσότερες πληροφορίες, δείτε:

Дополнительную информацию см. по адресу:

詳細資訊，請參閱：

詳細については、次をご覧ください：

자세한 내용은 다음을 참조하십시오.

如需了解更多详情，请参见：

[www.bang-olufsen.com/guides/important\\_information](http://www.bang-olufsen.com/guides/important_information)

[www.beoplay.com/important\\_information](http://www.beoplay.com/important_information)

- *English – English*
- 繁體中文 – *Traditional Chinese*
- 한국어 – *Korean*
- 简体中文 – *Simplified Chinese*

## *Important safety instructions*

Read these instructions.

Keep these instructions.

Heed all warnings.

Follow all instructions.

Do not use this apparatus near water.

Clean only with dry cloth.

Do not block any ventilation openings. Install in accordance with the manufacturer's instructions.

Do not install near any heat sources such as radiators, heat registers, stoves, or other apparatus (including amplifiers) that produce heat.

Do not defeat the safety purpose of the polarized or grounding-type plug. A polarized plug has two blades with one wider than the other. A grounding type plug has two blades and a third grounding prong. The wide blade or the third prong are provided for your safety. If the provided plug does not fit into your outlet, consult an electrician for replacement of the obsolete outlet.

Protect the power cord from being walked on or pinched particularly at plugs, convenience receptacles, and the point where they exit from the apparatus.

Only use attachments/accessories specified by the manufacturer.



Use only with the cart, stand, tripod, bracket, or table specified by the manufacturer, or sold with the apparatus. When a cart is used, use caution when moving the cart/apparatus combination to avoid injury from tip-over.

Unplug this apparatus during lightning storms or when unused for long periods of time.

Refer all servicing to qualified service personnel. Servicing is required when the apparatus has been damaged in any way, such as power-supply cord or plug is damaged, liquid has been spilled or objects have fallen into the apparatus, the apparatus has been exposed to rain or moisture, does not operate normally, or has been dropped.

Do not expose batteries or battery packs to excessive heat such as sunshine, fire or the like.

**WARNING:** to reduce the risk of fire or electric shock, do not expose this appliance to rain or moisture.

The product can only be switched off completely by disconnecting it from the mains socket. The mains socket must always be accessible.

No naked flame sources, such as lighted candles should be placed on the apparatus.

Follow the instructions to ensure correct and safe installation and interconnection of equipment in multimedia systems.

Make sure the cable connection between the product and the router does not exit the building to avoid contact with high voltage.



The lightning flash with arrowhead symbol within an equilateral triangle, is intended to alert the user to the presence of uninsulated "dangerous voltage" within the product's enclosure that may be of sufficient magnitude to constitute a risk of electric shock to persons.



The exclamation point within an equilateral triangle is intended to alert the user to the presence of important operating and maintenance (servicing) instructions in the literature accompanying the product.

This equipment complies with FCC RF radiation exposure limits set forth for an uncontrolled environment at a separation distance of at least 20 cm from all persons.

This device complies with part 15 of the FCC Rules. Operation is subject to the following two conditions: (1) This device may not cause harmful interference, and (2) this device must accept any interference received, including interference that may cause undesired operation.

Note: This equipment has been tested and found to comply with the limits for a Class B digital device, pursuant to part 15 of the FCC Rules. These limits are designed to provide reasonable protection against harmful interference in a residential installation. This equipment generates, uses and can radiate radio frequency energy and, if not installed and used in accordance with the instructions, may cause harmful interference to radio communications. However, there is no guarantee that interference will not occur in a particular installation. If this equipment does cause harmful interference to radio or television reception, which can be determined by turning the equipment off and on, the user is encouraged to try to correct the interference by one or more of the following measures:

- Reorient or relocate the receiving antenna.
- Increase the separation between the equipment and receiver.
- Connect the equipment into an outlet on a circuit different from that to which the receiver is connected.
- Consult the dealer or an experienced radio/TV technician for help.



## **CAUTION**

Intended for indoor use only.

To see the BeoPlay A8 product label, remove the back cover. Pull out the cover at the bottom to release the locks, then lift it off.

To prevent electric shock hazard, do not connect to mains power supply while grille is removed.



廢棄的電池請回收。

## 경고

발열, 화재, 폭발 등의 위험을 수반할 수 있으니 다음 사항을 지켜주시기 바랍니다.

- a) 육안으로 식별이 가능할 정도의 부풀음이 발생된 전지는 위험할 수 있으므로 제조자 또는 판매자로 즉시 문의할 것
- b) 지정된 정품 충전기만을 사용할 것
- c) 화기에 가까이 하지 말 것(전자레인지에 넣지 말 것)
- d) 여름철 자동차 내부에 방치하지 말 것
- e) 찜질방 등 고온다습한 곳에서 보관, 사용하지 말 것
- f) 이불, 전기장판, 카펫 위에 올려놓고 장시간 사용하지 말 것(휴대 컴퓨터용 전지가 아닌 경우 생략 가능)
- g) 전원을 켜 상태로 밀폐된 공간에 장시간 보관하지 말 것
- h) 전지 단자에 목걸이, 동전, 열쇠, 시계 등 금속 제품이 닿지 않도록 주의할 것(휴대 컴퓨터용 전지가 아닌 경우 생략 가능)
- i) 휴대 기기, 제조업체가 보증한 리튬 2차 전지를 사용할 것
- j) 분해, 압착, 관통 등의 행위를 하지 말 것
- k) 높은 곳에서 떨어뜨리는 등 비정상적 충격을 주지 말 것.
- l) 60°C 이상의 고온에 노출하지 말 것
- m) 습기에 접촉되지 않도록 할 것



Kolon B&S Inc.

BeoPlay A3

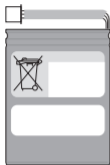



仅适用于海拔 2000m 以下地区安全使用。



仅适用于非热带气候条件下安全使用。

如果在热带地区使用, 房间内必须有空调。

接入本设备的有线网络天线必须 与保护接地隔离, 否则可能会引起着火等危险.



## 电子信息产品污染控制管理方法

部件名称:	有毒有害物或元素					
	铅 (Pb)	汞 (Hg)	镉 (Cd)	铬[六价] (Cr[VI])	多溴联苯 (PBB)	多溴二苯醚 (PBDE)
装饰带	×	0	0	0	0	0
印刷电路板组件	×	0	0	0	0	0

### 图表符号

- 表示有毒有害物在部件所有材料中的含量均在 ST/T 11363-2006 MCV 准定的限量要求以下。
- × 表示有毒有害物至少在部件的某一材料中的含量超出 SJ/T 11363-2006 准定的限量要求。



## 电子信息产品污染控制管理方法

部件名称:	有毒有害物或元素					
	铅 (Pb)	汞 (Hg)	镉 (Cd)	铬[六价] (Cr[VI])	多溴联苯 (PBB)	多溴二苯醚 (PBDE)
印刷电路板组件	×	0	0	0	0	0
扬声器	×	0	0	0	0	0
前方	×	0	0	0	0	0
圆环	×	0	0	0	0	0
脚架	×	0	0	0	0	0

### 图表符号

- 表示有毒有害物在部件所有材料中的含量均在 ST/T 11363-2006 MCV 准定的限量要求以下。
- × 表示有毒有害物至少在部件的某一材料中的含量超出 SJ/T 11363-2006 准定的限量要求。



## 电子信息产品污染控制管理方法

部件名称:	有毒有害物或元素					
	铅 (Pb)	汞 (Hg)	镉 (Cd)	铬[六价] (Cr[VI])	多溴联苯 (PBB)	多溴二苯醚 (PBDE)
印刷电路板组件	×	0	0	0	0	0
扬声器	×	0	0	0	0	0
电视机类产品	×	0	0	0	0	0

### 图表符号

- 表示有毒有害物在部件所有材料中的含量均在 ST/T 11363-2006 MCV 准定的限量要求以下。
- × 表示有毒有害物至少在部件的某一材料中的含量超出 SJ/T 11363-2006 准定的限量要求。



## 电子信息产品污染控制管理方法

部件名称:	有毒有害物或元素					
	铅 (Pb)	汞 (Hg)	镉 (Cd)	铬[六价] (Cr[VI])	多溴联苯 (PBB)	多溴二苯醚 (PBDE)
印刷电路板组件	×	0	0	0	0	0
扬声器	×	0	0	0	0	0
电视机类产品	×	0	0	0	0	0

### 图表符号

- 表示有毒有害物在部件所有材料中的含量均在 ST/T 11363-2006 MCV 准定的限量要求以下。
- × 表示有毒有害物至少在部件的某一材料中的含量超出 SJ/T 11363-2006 准定的限量要求。



## 电子信息产品污染控制管理方法

部件名称:	有毒有害物或元素					
	铅 (Pb)	汞 (Hg)	镉 (Cd)	铬[六价] (Cr[VI])	多溴联苯 (PBB)	多溴二苯醚 (PBDE)
封面	×	0	0	0	0	0
PCBA	×	0	0	0	0	0
LCD	0	×	0	0	0	0

### 图表符号

- 表示有毒有害物在部件所有材料中的含量均在 ST/T 11363-2006 MCV 准定的限量要求以下。
- × 表示有毒有害物至少在部件的某一材料中的含量超出 SJ/T 11363-2006 准定的限量要求。



## 电子信息产品污染控制管理方法

部件名称:	有毒有害物或元素					
	铅 (Pb)	汞 (Hg)	镉 (Cd)	铬[六价] (Cr[VI])	多溴联苯 (PBB)	多溴二苯醚 (PBDE)
遥控器	x	0	0	0	0	0

### 图表符号

- 表示有毒有害物在部件所有材料中的含量均在 ST/T 11363-2006 MCV 准定的限量要求以下。
- x 表示有毒有害物至少在部件的某一材料中的含量超出 SJ/T 11363-2006 准定的限量要求。



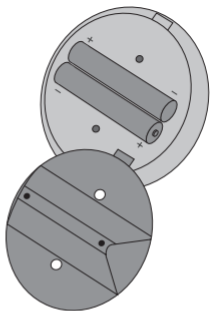

2 x LR61 (AAAA)

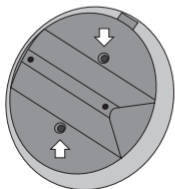



## 电子信息产品污染控制管理方法

部件名称:	有毒有害物或元素					
	铅 (Pb)	汞 (Hg)	镉 (Cd)	铬[六价] (Cr[VI])	多溴联苯 (PBB)	多溴二苯醚 (PBDE)
线缆组件(插头)	×	0	0	0	0	0
电子元件	×	0	0	0	0	0
铜制零件	×	0	0	0	0	0

### 图表符号

- 表示有毒有害物在部件所有材料中的含量均在 ST/T 11363-2006 MCV 准定的限量要求以下。
- × 表示有毒有害物至少在部件的某一材料中的含量超出 SJ/T 11363-2006 准定的限量要求。



## 电子信息产品污染控制管理方法

部件名称:	有毒有害物或元素					
	铅 (Pb)	汞 (Hg)	镉 (Cd)	铬[六价] (Cr[VI])	多溴联苯 (PBB)	多溴二苯醚 (PBDE)
线缆组件(插头)	×	0	0	0	0	0
电子元件	×	0	0	0	0	0
铜制零件 (镶嵌件)	×	0	0	0	0	0

### 图表符号

- 表示有毒有害物在部件所有材料中的含量均在 ST/T 11363-2006 MCV 准定的限量要求以下。
- × 表示有毒有害物至少在部件的某一材料中的含量超出 SJ/T 11363-2006 准定的限量要求。



## 电子信息产品污染控制管理方法

部件名称:	有毒有害物或元素					
	铅 (Pb)	汞 (Hg)	镉 (Cd)	铬[六价] (Cr[VI])	多溴联苯 (PBB)	多溴二苯醚 (PBDE)
线缆组件(插头)	×	0	0	0	0	0
电子元件	×	0	0	0	0	0
铜制零件	×	0	0	0	0	0

### 图表符号

- 表示有毒有害物在部件所有材料中的含量均在 ST/T 11363-2006 MCV 准定的限量要求以下。
- × 表示有毒有害物至少在部件的某一材料中的含量超出 SJ/T 11363-2006 准定的限量要求。