

# Mounting Instruction



Rev Date 2006-03-21	Rev. 1.0	Document ID 108167
Prepared by Harald Rygge	Subject Resp. Agnar Kopperud	Approved by Ole Christian Sørli
Antenna Unit Label Placement of label		

## 1. GENERAL

Placement and quantities of labels described in this document.

Label number	Label ID <sup>1</sup>	Quantity <sup>2</sup>
105039	A	1

## 2. PLACEMENT

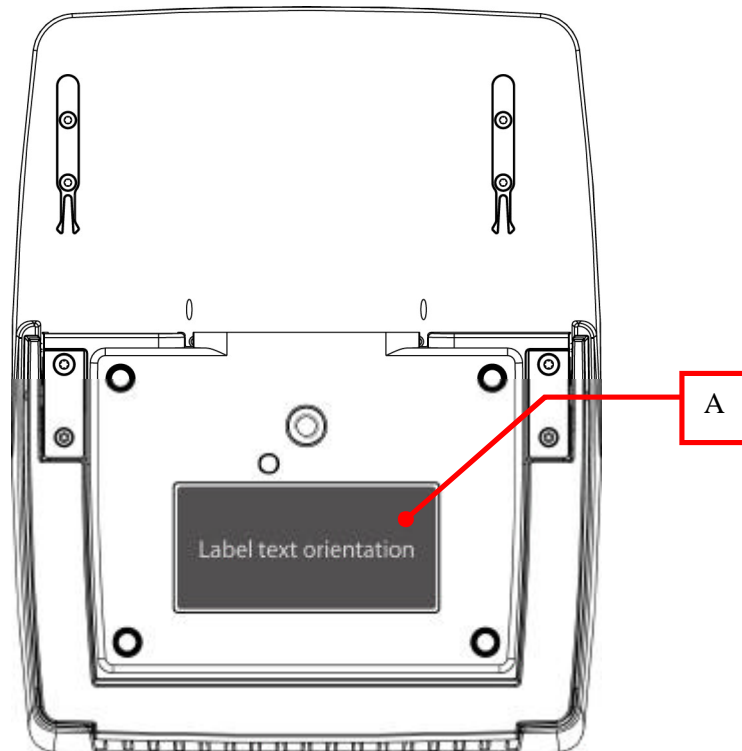

**Figure 1 - Placement of Label A**

The label A should be placed and oriented as shown in Figure 1 - Placement of Label A. Observe; The entire label should be centred horizontally, and vertically into the recess in plastic part. The entire label should fit into the recess, and no geometry of the label must exceed the edges of the recess.

(Label text: See actual "Marking Drawing")

## 3. PRE TREATMENT.

Ensure that all surfaces, where labels are placed, are clean, dry and without fat. The label should be mounted without leaving "air bubbles" underneath.

<sup>1</sup> - ID used as references in this document (see figures).

<sup>2</sup> - Information only – complete BOM from PDM system