

# APEX™

A NEW WAY TO *DRIVE-THRU*

## OPERATING INSTRUCTIONS

**Base Station**  
Model No.  
**APXBA**

Model No.  
**APXHS**



Before attempting to connect or operate this product, please read these instructions carefully and save this manual for future use.

# Contents

Power On/Off Headset.....	2
Replace the Headset Battery.....	2
Headset Volume Up/Down.....	3
Battery Charger.....	3
Logging into Base Station.....	4
Logging into Base Station.....	5
Setting up Base Station to Register Headset....	5
Set Headset into Registration Mode.....	6
Completion of Registering Headset.....	7
Headset Hands Push To Talk or Hands free.....	7
Headset Hands Push To Talk or Hands free.....	8
Single Lane.....	9
Dual Lane Cross Lane.....	10
Dual Lane Team Mode.....	11
Tandem Operation.....	12
Dual Lane Home Screen.....	13
Dual Lane Cross Lane Home Screen.....	14
Auto Greeter.....	15
Auto Greeter.....	16
Alert.....	17
Alert.....	18
Reminder.....	19
Reminder.....	20
Set Inbound/Outbound Volumes.....	21
Set Inbound/Outbound Volumes.....	22
Noise Suppression.....	23
Lane Setting.....	24
Lane Setting.....	25
Speed Team/Vehicle Override.....	25
Speed Team/Vehicle Override.....	26
Manager.....	26
Import/Export/Engineer Settings.....	26
Help Icon.....	27
FCC.....	28
Industry Canada.....	29

## Power On/Off

- Insert battery into headset until the battery clicks in. A blue light will appear below the RF logo on the front of the headset and a light will appear on the microphone tip.

*Note: Battery will only insert one way. Do not force in.*



## Replace The Battery

- Press the red battery latch down (towards the ear pad) and the will eject



- If a battery is already on the headset, pick the headset up to turn on. A blue light will appear underneath the RF logo and light on the microphone tip will appear

*Note: If the light on the microphone boom is blinking red, need to program the headset.*



**Power OFF:** Headset will turn off automatically after 10 minutes of no movement.

## Volume Up and Down

**VOLUME UP:** Press the “V” switch. Each time the switch is pressed, a short beep is heard and gets louder with each press of the switch



### **VOLUME DOWN:**

- After pressing the “V” switch six times, the headset will return to the lowest volume setting

## BATTERY CHARGER

### **Charging Status**

- Red light appears when battery is charging
- Green light appears when battery is fully charged
- Light will remain off when battery port is empty



# Logging Into the Base Station

- Press the settings, icon on the base station

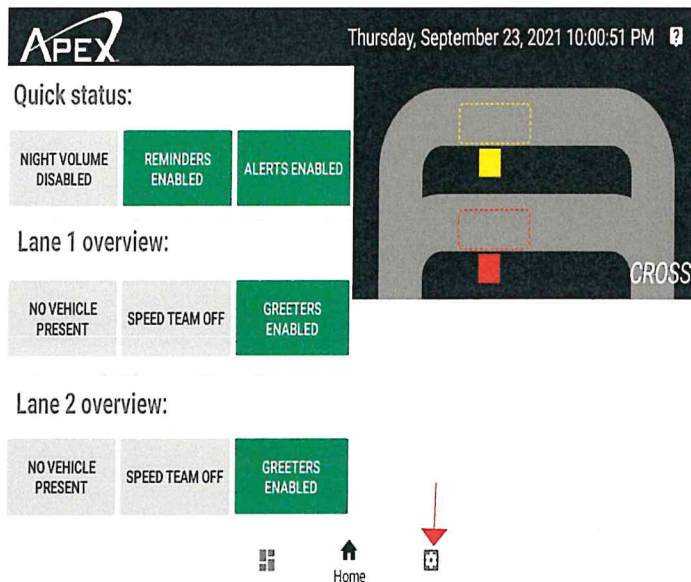

- Press the Login icon

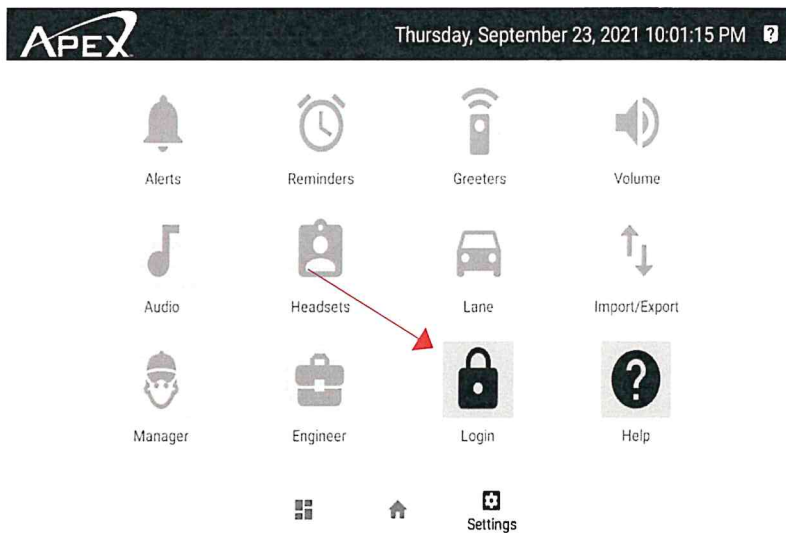



- Type in password RFT1989 (default) and then press LOGIN.

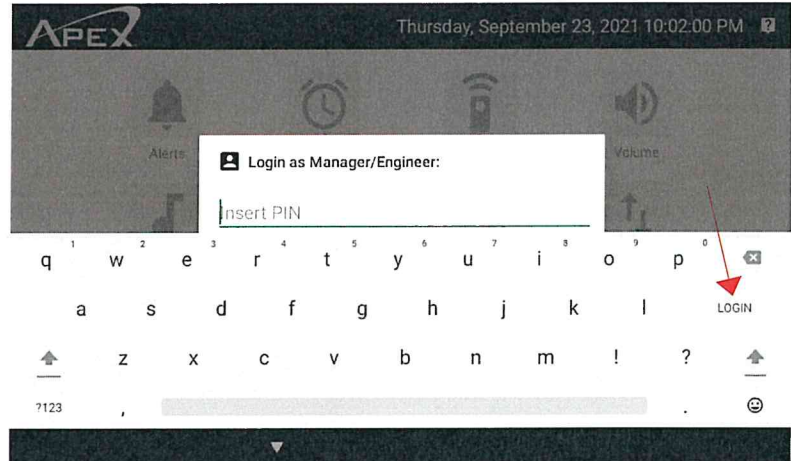

## REGISTER HEADSET:

- Turn on a headset by picking up or inserting a battery
- After logging in, press the Headsets icon

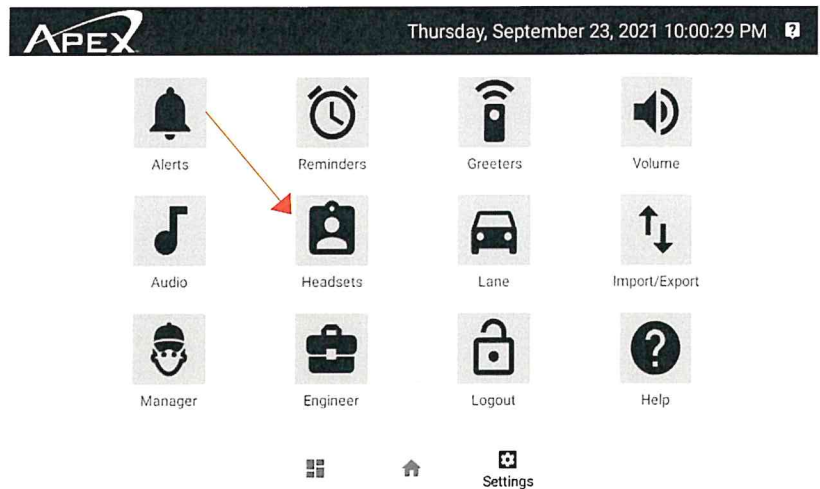

- Press Pair New Headset

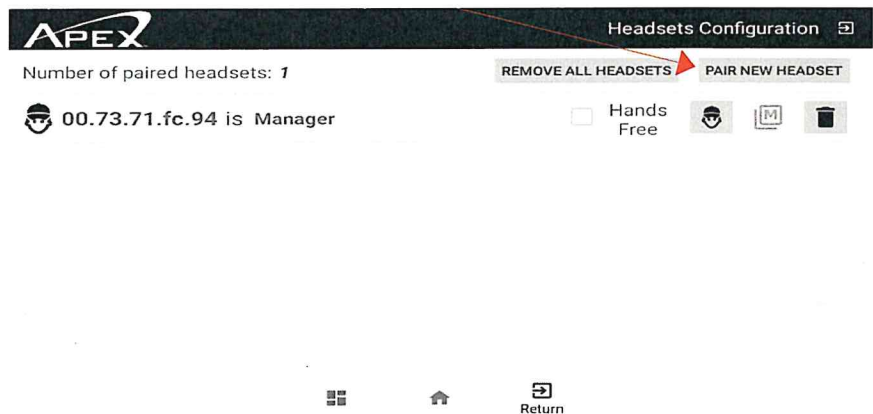

- Pair headsets message, you can now register headset (s)

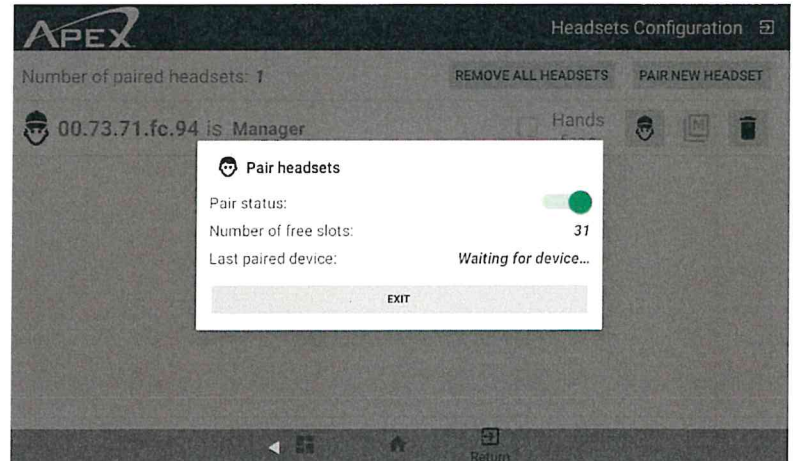

- **Register to Base Station** - Press and hold the “L1 and “P” switches until the headset starts to beep and the light on the microphone boom flashes green and yellow. Release “L1” and “P”. A long beep will be heard in the headset and the green and yellow light will stop flashing.

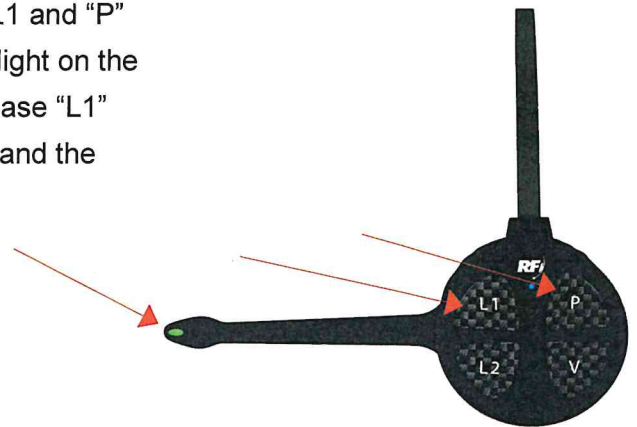

Note:

- *Can register up to 32 headsets*
- *Can register multiple headsets at the same time*
- *If the system is Dual Lane, follow the instruction above but press and hold “L2” and “P” switches.*
- *When headsets are registered, press exit then press the home icon*

- After programming a headset, the serial number will appear.

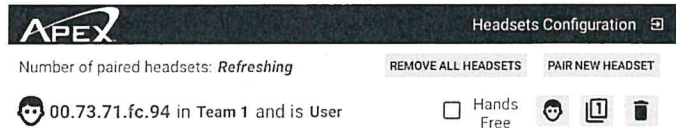

*Note: When in Dual Lane mode*



## PROGRAM HEADSET FOR PUSH TO TALK OR HANDS FREE (TALK LOCK)

- **Hands Free (Talk Lock)** Press and hold “L1” and “V” switches until the voice prompt says “Lane Talk Lock ON.”



- **Turn Off Hands Free (Talk Lock)** Press and hold “L1” and “V” switches until the voice prompt says “Talk Lock OFF.”





- **Turn On Page Hands Free (Talk Lock)** Press and hold “P” and “V” switches until the voice prompt says “Lane Page Talk Lock ON”



- **Turn Off Page Hands Free (Talk Lock)** Press and hold “P” and “V” switches until the voice prompt says “Lane Page Talk Lock OFF.”



## **SINGLE LANE**

### **Single Lane Drive-Thru Push to Talk Mode (PTT)**

- A single beep is heard in the headset alerting the user a car is present at the speaker post
- Press and hold either L1 or L2 switch to speak to the customer. The microphone boom tip will flash green
- Speak into the microphone to communicate with the customer
- After the customer leaves the speaker post, the headset will stop transmitting and the green light on the microphone boom tip will stop flashing.

### **Single Lane Drive-Thru Hands Free Mode (Talk Lock)**

- A single beep is heard in the headset alerting the user a car is present at the speaker post
- Press and release either L1 or L2 switch to speak to the customer. The microphone boom tip will flash green.
- Speak into the microphone to communicate with the customer
- To mute the microphone during the order, press either L1 or L2 once. The light on the microphone tip will stop flashing.
- Press and release either L1 or L2 to speak with the customer again. The microphone boom tip will flash green.
- After the customer leaves the speaker post, the headset will stop transmitting and the green light on the microphone boom tip will stop flashing.

### **Single Lane Drive-Thru with Auto Hands Free**

- A single beep is heard in the headset alerting the user a car is present at the speaker post or menu board.
- Do not press either T1 or T2. The microphone boom tip will flash green.
- Speak into the microphone to communicate with the customer
- If you would like to mute the microphone during the order, press either L1 or L2 once. The microphone boom tip will stop flashing.
- Press and release either L1 or L2 to speak with the customer again. The microphone boom tip flash green.
- After the customer leaves the speaker post or menu board, the headset will stop transmitting and the green light on the microphone boom tip will stop flashing.

## **Dual Lane Cross Mode**

*Note: In Cross Lane mode one headset will take orders for Lane 1 and Lane 2*

### **Push To Talk (PTT)**

- A single beep (for Lane 1) and a double beep (for Lane 2) is heard in the headset alerting the user a car is present at the speaker post or menu board.
- Press and hold L1 to speak to the customer in Lane 1. The microphone boom tip will flash green.
- Press and hold L2 to speak to the customer in Lane 2. The microphone boom tip will flash yellow.
- Speak into the microphone to communicate with the customer
- After the customer leaves the speaker post or menu board, the headset will stop transmitting and the green or yellow light on the microphone boom tip will stop flashing.

### **Hands Free Mode (Talk Lock)**

- A single beep (for Lane 1) and a double beep (for Lane 2) is heard in the headset alerting the user a car is present at the speaker post or menu board.
- Press and release L1 to speak to the customer in Lane 1. The microphone boom tip will flash green.
- Press and release L2 to speak to the customer in Lane 2. The microphone boom tip will flash yellow.
- Speak into the microphone to communicate with the customer
- To mute the microphone during the order, press L1 for Lane 1 and L2 for Lane 2. You will see the light on the microphone tip will stop flashing.
- To speak with the customer again press and release L1 for Lane 1. The microphone boom tip will flash green
- To speak with the customer again press and release L2 for Lane 2. The microphone boom tip will flash yellow.
- After the customer leaves the speaker post, the headset will stop transmitting and the light on the microphone boom tip will stop flashing.

### **Auto Hands Free**

- A single beep (for Lane 1) and a double beep (for Lane 2) is heard in the headset alerting the user a car is present at the speaker post or menu board.
- Speak to the customer without pressing any switch.
- Speak into the microphone to communicate with the customer
- To mute the microphone during the order, press L1 for Lane1 or L2 once. The light on the microphone tip will stop flashing.
- To speak with the customer again press and release L1 for Lane 1. The microphone boom tip will flash green

- To speak with the customer again press and release L2 for Lane 2. The microphone boom tip will flash yellow.
- After the customer leaves the speaker post, the headset will stop transmitting and the light on the microphone boom tip will stop flashing.

## **Dual Lane Team Mode**

*Note: In Team mode one headset will take orders for Lane 1 and the other headset will take orders Lane 2*

### **Dual Lane Drive- Thru Push To Talk (PTT)**

- A single beep (for Lane 1) and a double beep (for Lane 2) is heard in the headset alerting the user a car is present at the speaker post or menu board.
- Press and hold L1 to speak to the customer in Lane 1. The microphone boom tip will flash green.
- Press and hold L2 to speak to the customer in Lane 2. The microphone boom tip will flash yellow.
- Speak into the microphone to communicate with the customer
- After the customer leaves the speaker post or menu board, the headset will stop transmitting and the green or yellow light on the microphone boom tip will stop flashing.

### **Dual Lane Drive-Thru Hands Free Mode (Talk Lock)**

- A single beep (for Lane 1) and a double beep (for Lane 2) is heard in the headset alerting the user a car is present at the speaker post or menu board.
- Press and release L1 to speak to the customer in Lane 1. The microphone boom tip will flash green.
- Press and release L2 to speak to the customer in Lane 2. The microphone boom tip will flash yellow.
- Speak into the microphone to communicate with the customer
- To mute the microphone during the order, press L1 for Lane 1 and L2 for Lane 2. The microphone tip will stop flashing.
- To speak with the customer again press and release L1 for Lane 1 or L2 for Lane 2. The microphone boom tip will flash green for Lane 1 and yellow for Lane 2.
- After the customer leaves the speaker post, the headset will stop transmitting and the Green light on the microphone boom tip will stop flashing.

### **Dual Lane Drive-Thru with Auto Hands Free**

- A single beep (for Lane 1) and a double beep (for Lane 2) is heard in the headset alerting the user a car is present at the speaker post or menu board.
- Speak to the customer without pressing any switch. The microphone boom tip will flash green.



- Speak into the microphone to communicate with the customer
- If you would like to mute the microphone during the order, press either L1 or L2 once. You will see the light on the microphone tip will stop flashing.
- Press and release either L1 or L2 to speak with the customer again. You will see the microphone boom tip flash green. The microphone boom tip will flash green for Lane 1 and yellow for Lane 2.
- After the customer leaves the speaker post or menu board, the headset will stop transmitting and the green light on the microphone boom tip stop flashing.

## Tandem Operation

*Note: Tandem is one drive thru lane will multiple order points. If a car isn't present at Order point #1 and a car arrives at Order point #2 a message can play, "Please pull forward."*

*Headset operation is the same as dual lane operation.*

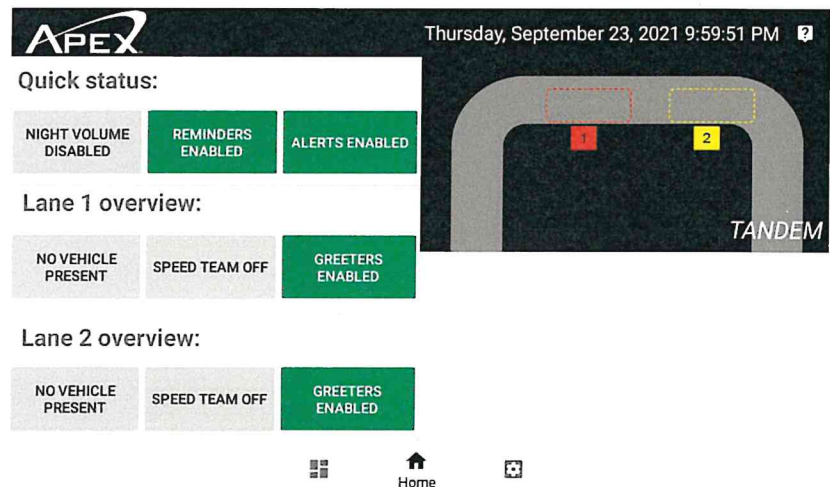



# DUAL LANE HOME SCREEN

- When a function is enabled it will appear green. If a function is disabled it will appear gray

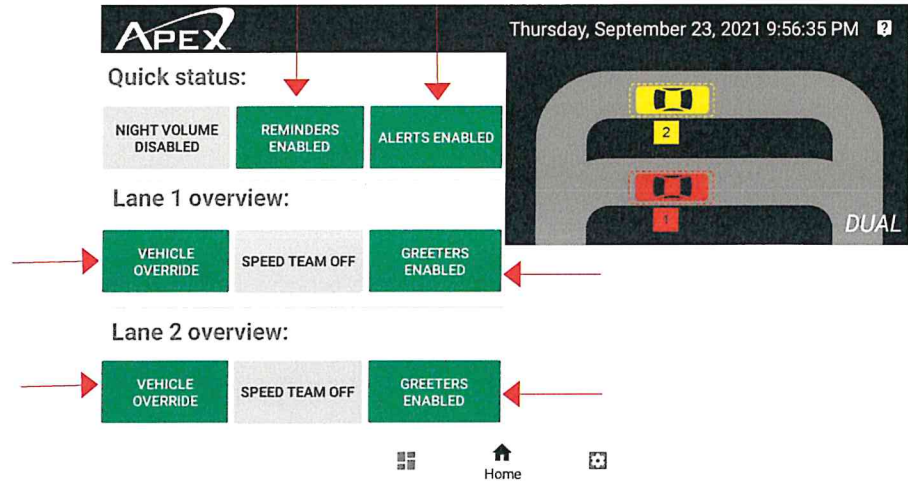

- When a car is present at Lane 1 or Lane 2 speaker post/ menu board

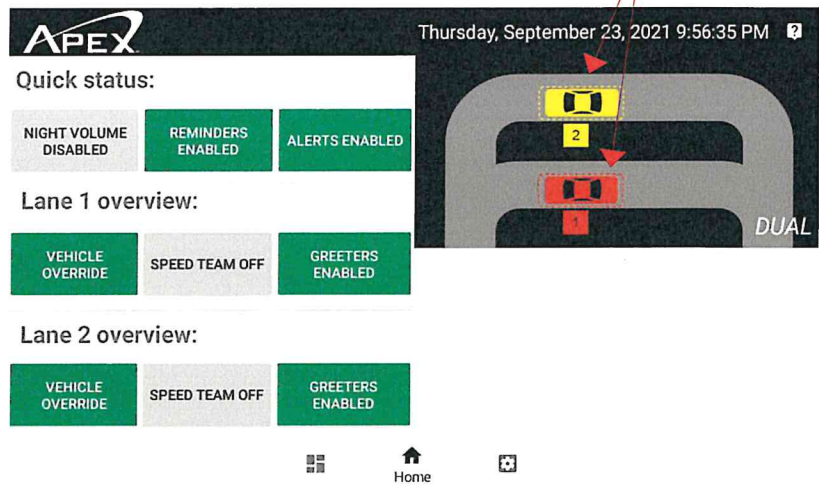

# DUAL LANE HOME SCREEN IN CROSS LANE

- System will alert when the headsets are setup for Cross Lane

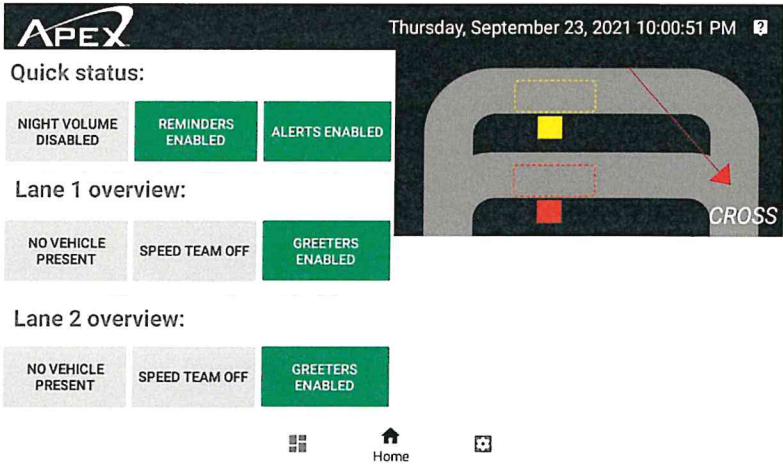

## Auto Greeter

- After logging in, press the Greeter icon

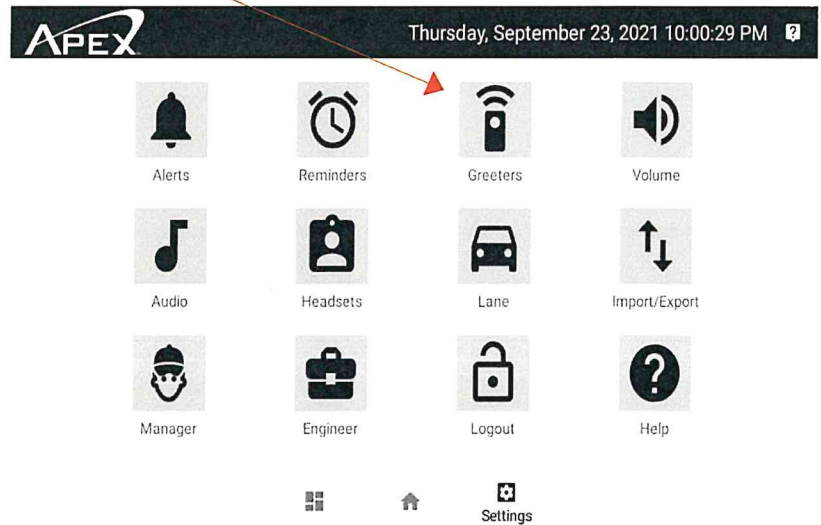

- Select which Greeter to program, then press the pencil icon

Note: There are 15 different greeters you can use.

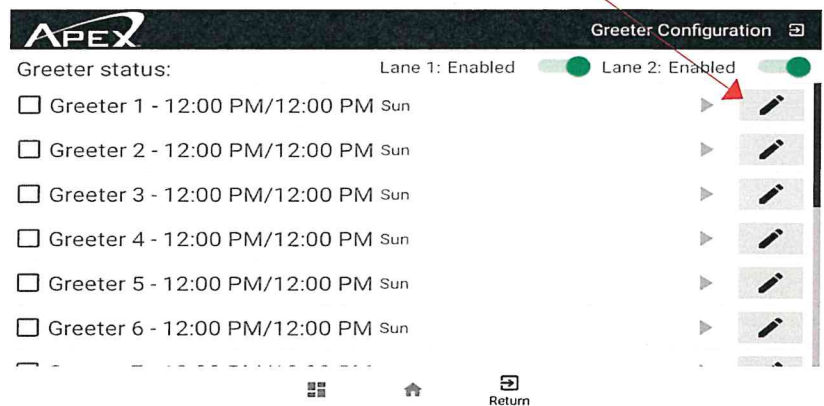

- Name greeter, select start time, end time, and select days to play

Note: To select certain days to play a Greeter, press the day and a green check mark will appear. If the greeter is to play every day, press Sun, Mon, Tue, etc. and this will check mark each day

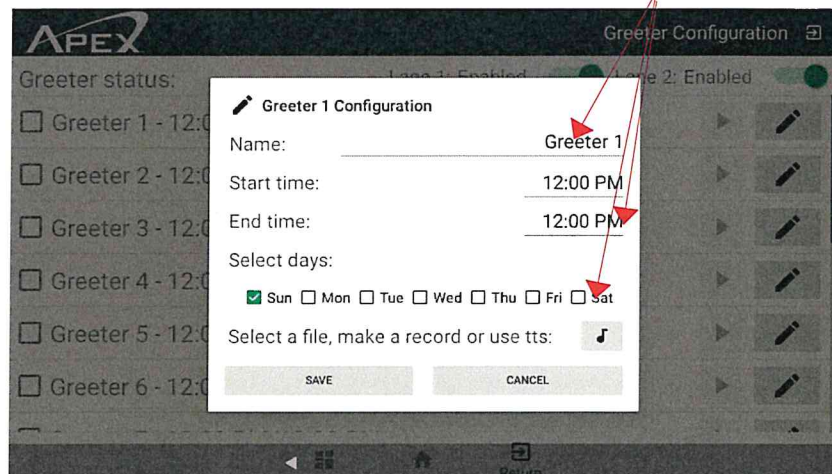

- Press the musical note icon to select to upload a message

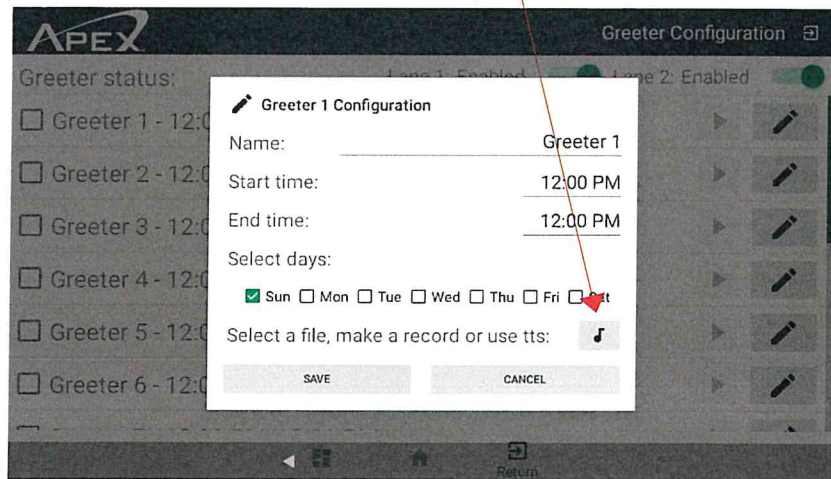

- Select how you would like to add a message

Note:

- *If File Picker is selected, a message can be uploaded via USB.*
- *If Record File is selected, a message can be recorded with a headset.*
- *If Text To Speech is selected, a message can be typed in.*

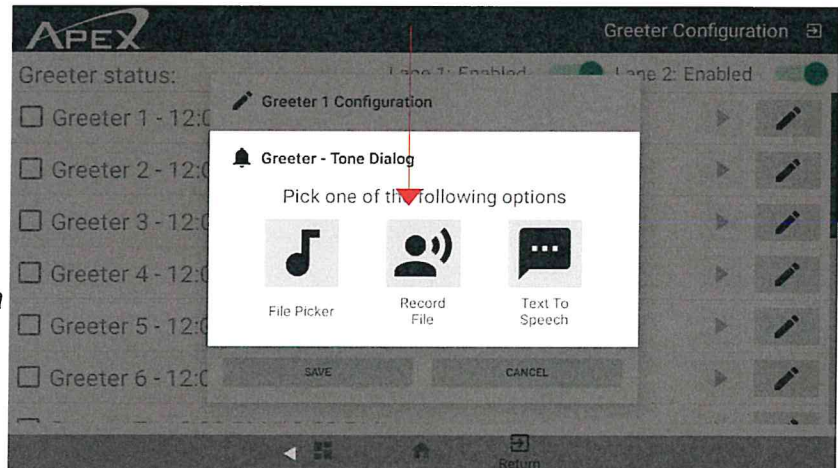

- After a message is added, press save.

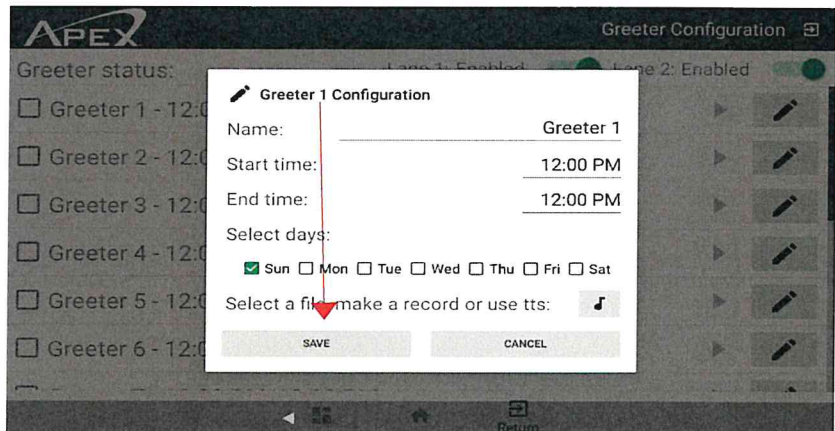



- **Select which Greeter to use and enable for Lane 1 or Lane 2**

*Note: To select which greeter(s) to use. Press the box next to the greeter(s) and a green check mark will appear*

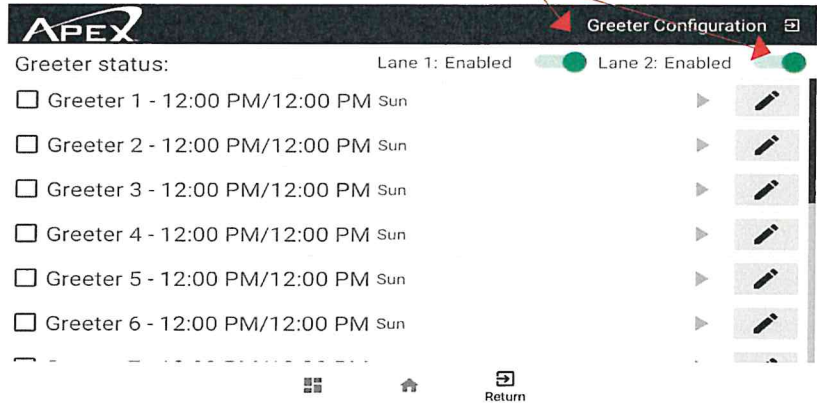

## Alerts

- After logging in, press the Alerts icon.

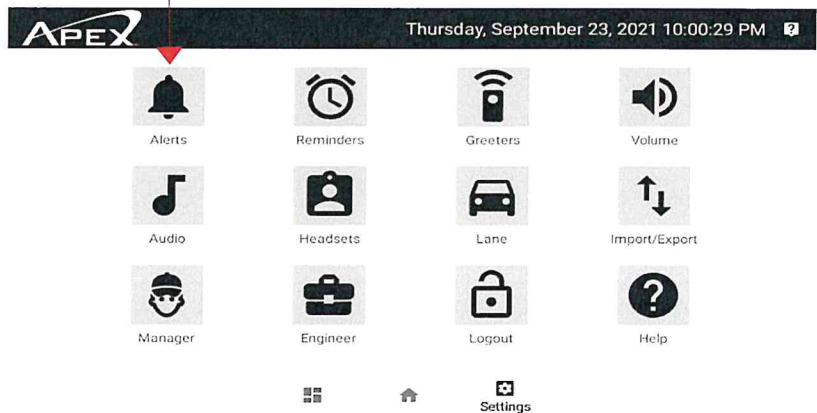

## **Program an Alert, press the pencil icon**

*Note: In order to use alerts a door contact is needed. Contact R.F. Technologies, Inc. for more information at 800.598.2370 or support@rftechno.com*

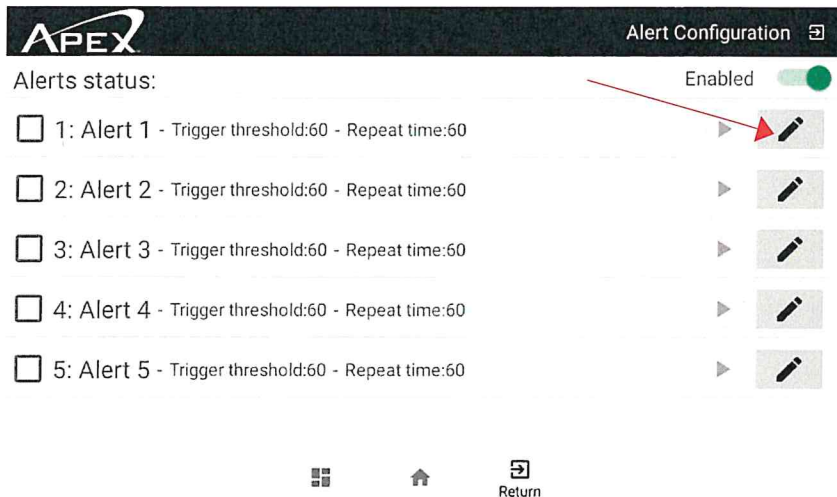



## Name the Alert

*Note: Trigger Threshold – The amount of time the enclosure is open before the alert will go off.*

*Repeat time – How many seconds before the alert will repeat in the headset until the alert is taken care of.*

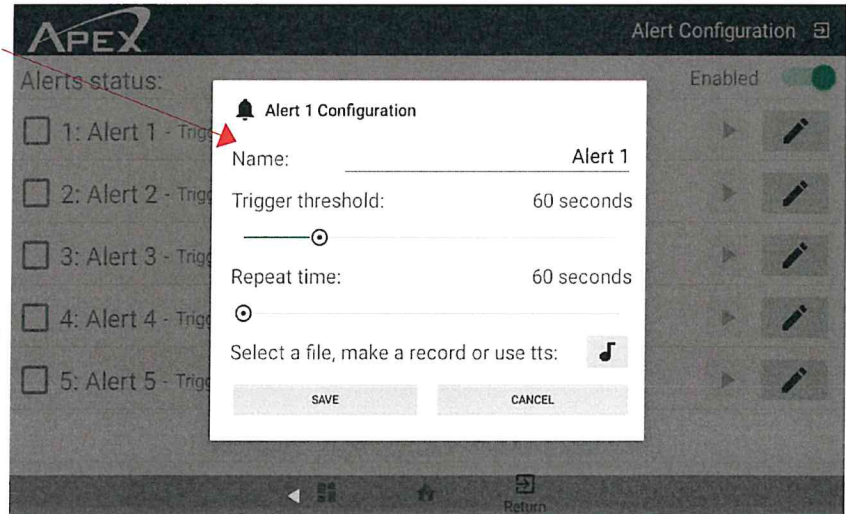

## Three ways to select a message for the alert.

### Note:

*If File Picker is selected, a message can be uploaded via USB.*

*If Record File is selected, a message can be recorded with a headset.*

*If Text To Speech is selected, a message can be typed in.*

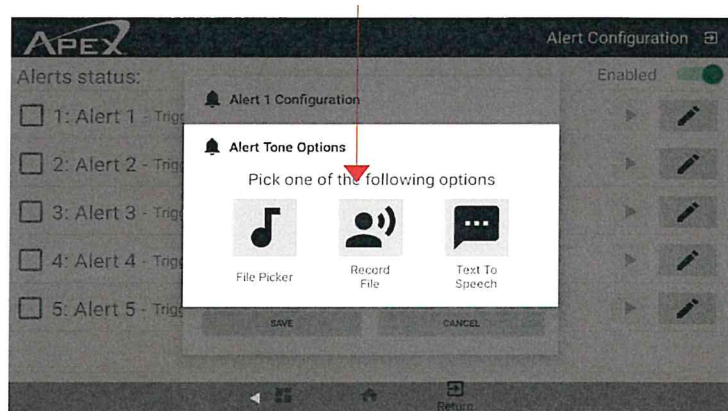

After programming Alerts, press save

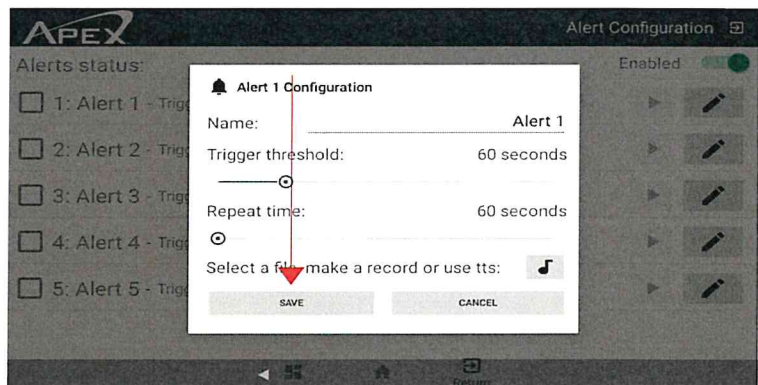

Select alert(s) and make sure alerts are enabled



## Set Reminders

- Program a Reminder. Press the pencil icon.

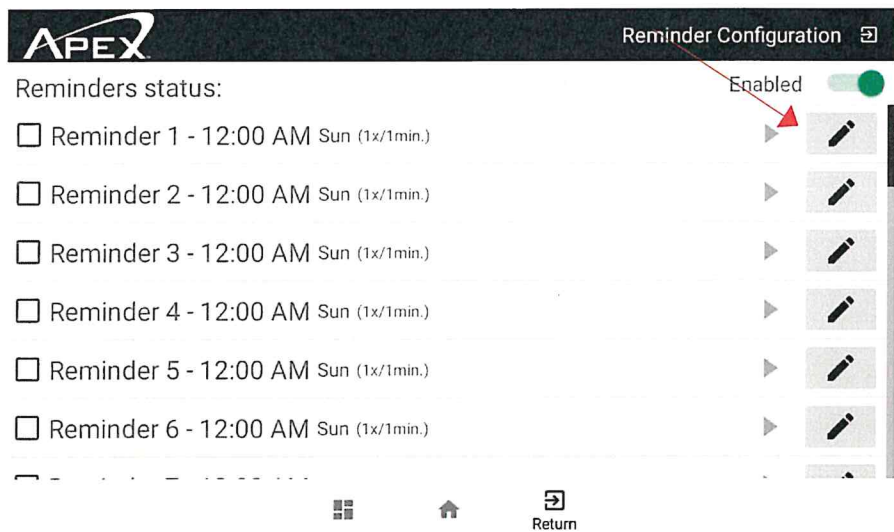

## Three ways to select a message for the Reminder

Note:

*If File Picker is selected, a message can be uploaded via USB.  
If Record File is selected, a message can be recorded with a headset.  
If Text To Speech is selected, a message can be typed in.*

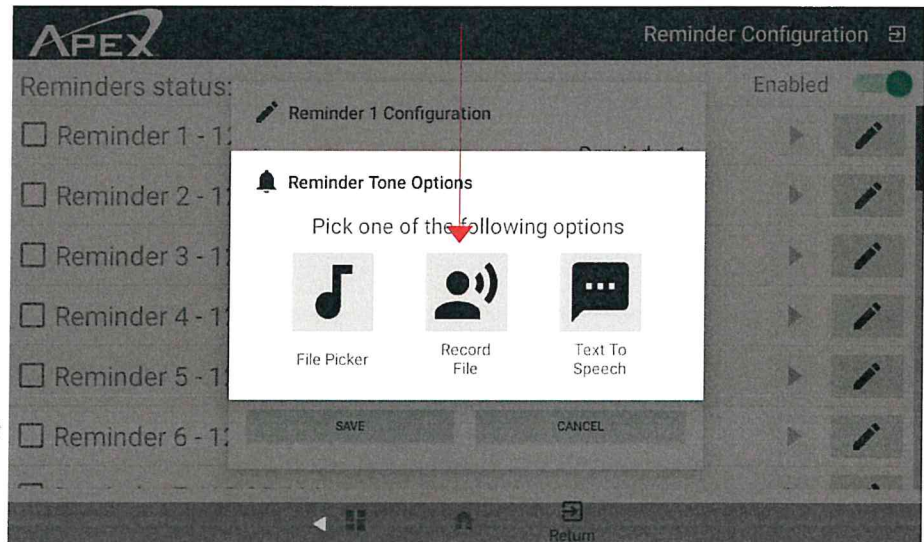

- After message is added, name the Reminder, select the Reminder time, Select what days to play, how many times to repeat and how often. Then press save

