

# APPROVAL SHEET

## (RoHS)

CUSTOMER : 海華科技股份有限公司  
CUSTOMER'S PART NO. :  
DESCRIPTION : METAL STAMPING ANTENNA ASSEMBLY  
PART NO. : MSA-4008-25GC1-A2  
DATE :  
AUTHORIZED BY : *Alvin Chen*

	FULLY APPROVED	PARTIALLY APPROVED	REJECTED
SIGN			
SUGGESTION			

美磊科技股份有限公司

MAG. LAYERS SCIENTIFIC-TECHNICS CO., LTD

No.270, Nanfeng Rd., Pingzhen Dist., Taoyuan City 324, Taiwan (R.O.C.)

TEL: +886-3-4159111 FAX: +886-3-4192255

<http://www.maglayers.com.tw>

E-mail : [info@maglayers.com.tw](mailto:info@maglayers.com.tw)



MAG.LAYERS

# Revisions

REV.	Description	Date	Prepared by	Approved by
V01	New Release	2016/05/24	Fehou	Alain

### PRODUCT IDENTIFICATION

MSA - 4008 - ###xx - A2 -

- ① Product Code
- ② Dimension Code
- ③ Series Type (### represents center frequency and xx represents material type)
- ④ Design Code
- ⑤ Inner Control Code

# Contents

Item	Description	Page
1. . . . .	Mechanical Specification	. . . . . 4
2. . . . .	Antenna Specification	. . . . . 5
3. . . . .	Test Report	. . . . . 6~7

株式会社  
磁気科学

# Mechanical Specification

RoHS COMPLIANT

## MECHANICAL

Body : SUS 430(鍍鎳) T=0.3mm  
 Cable : Coaxial Cable  $\phi$  1.13(Black)  
 Connector : IPEX-4 Compatible

## ELECTRICAL

Frequency : 2.4/5GHz

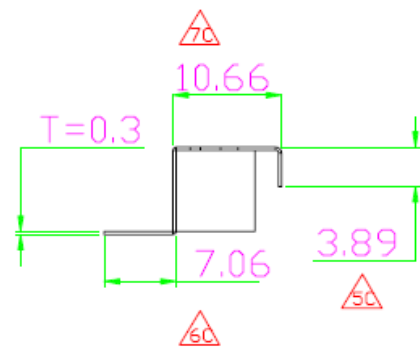
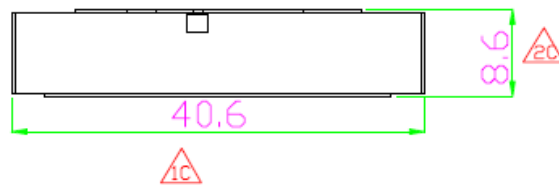
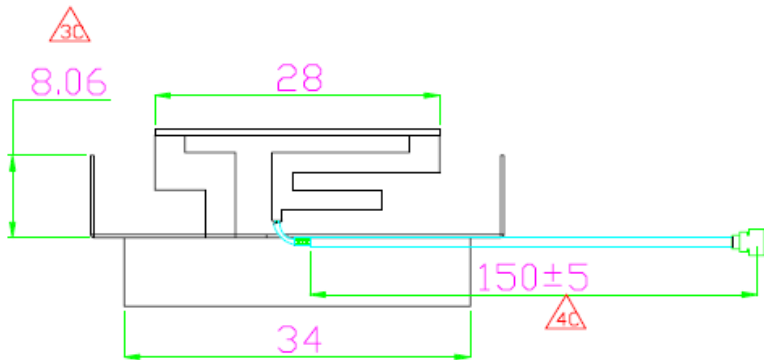
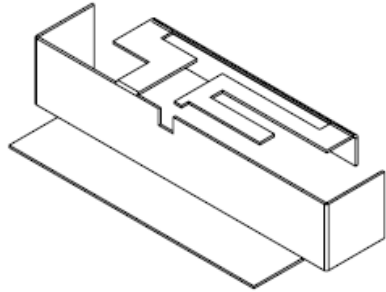

※凡標記△記號者, 為品管檢驗之尺寸

設計 DR. Fchou 2016/05/24	核准 APPD. Alvin 2016/05/24	容許公差 TOLERANCE .XXX ±0.1 .XX ±0.5 .X ±1.0 X ±3.0 ANG ±5	品名 ARTICLE MSA-4008-25GC1-A2
版本說明 REVISION NOTE			
<b>MAGLAYERS</b>			單位 UNIT mm
			比例 SCALE ****
			張數 SHEET 1
			版本 REV. A

# Antenna Specification

## ELECTRICAL PROPERTIES

- 1.1 Frequency Range..... 2.4~2.5GHz /4.9~5.9GHz
- 1.2 Impedance..... 50 Ohm Nominal
- 1.3 VSWR..... 2 (Max)
- 1.4 Return Loss..... -10dB (Max)
- 1.5 Radiation..... Directional
- 1.6 3D Peak Gain..... 2.98dBi(2.4~2.5GHz)  
5.16dBi(4.9~5.9GHz)
- 1.7 Polarization..... Linear Vertical
- 1.8 Admitted Power..... 1W

## PHYSICAL PROPERTIES

- 2.1 Antenna Material..... SUS430 鍍鎳
- 2.2 Cable..... Coaxial Cable  $\psi$  1.13(Black)
- 2.3 Connector..... IPEX-4 Compatible
- 2.4 Operating Temp..... -20°C ~ +65°C
- 2.5 Storage Temp..... -30°C ~ +75°C



# Test Report

## ELECTRICAL CHARACTERISTICS

P/NO: MSA-4008-25GC1-A2

Spec: 2.4~2.5GHz / 4.9~5.9GHz

S11

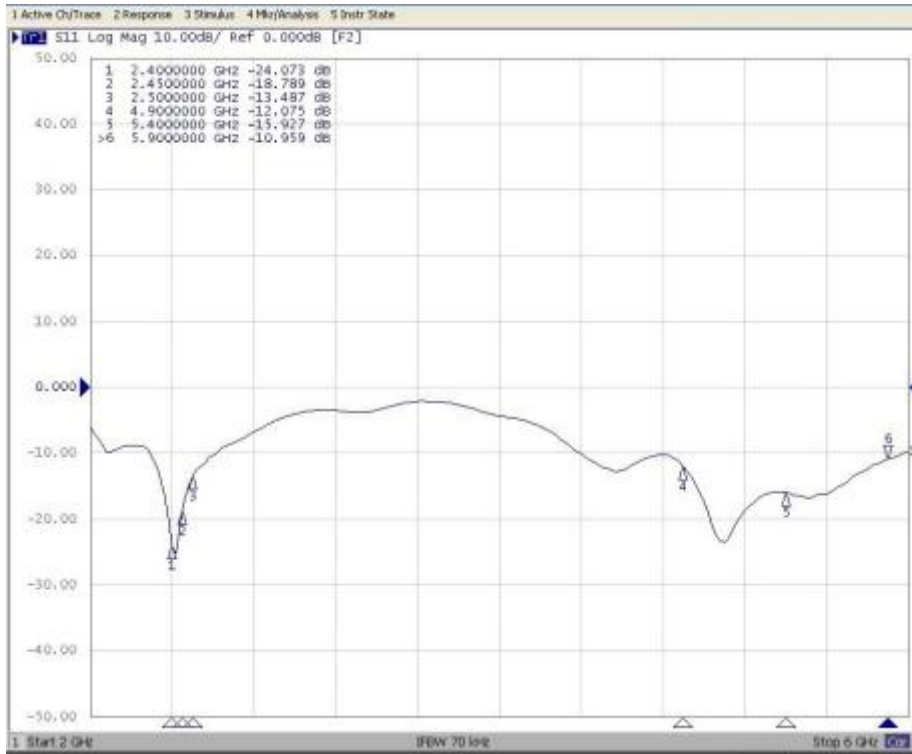

3D Pattern (2.4G)

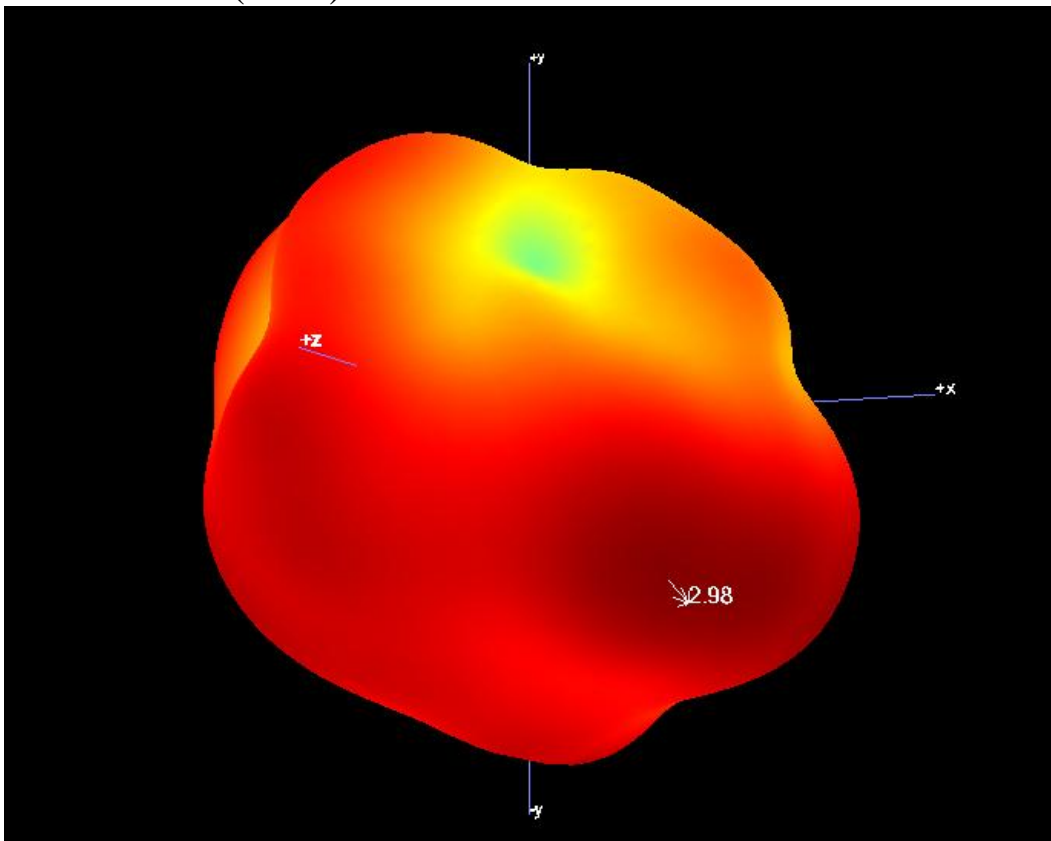

3D Pattern (5G)

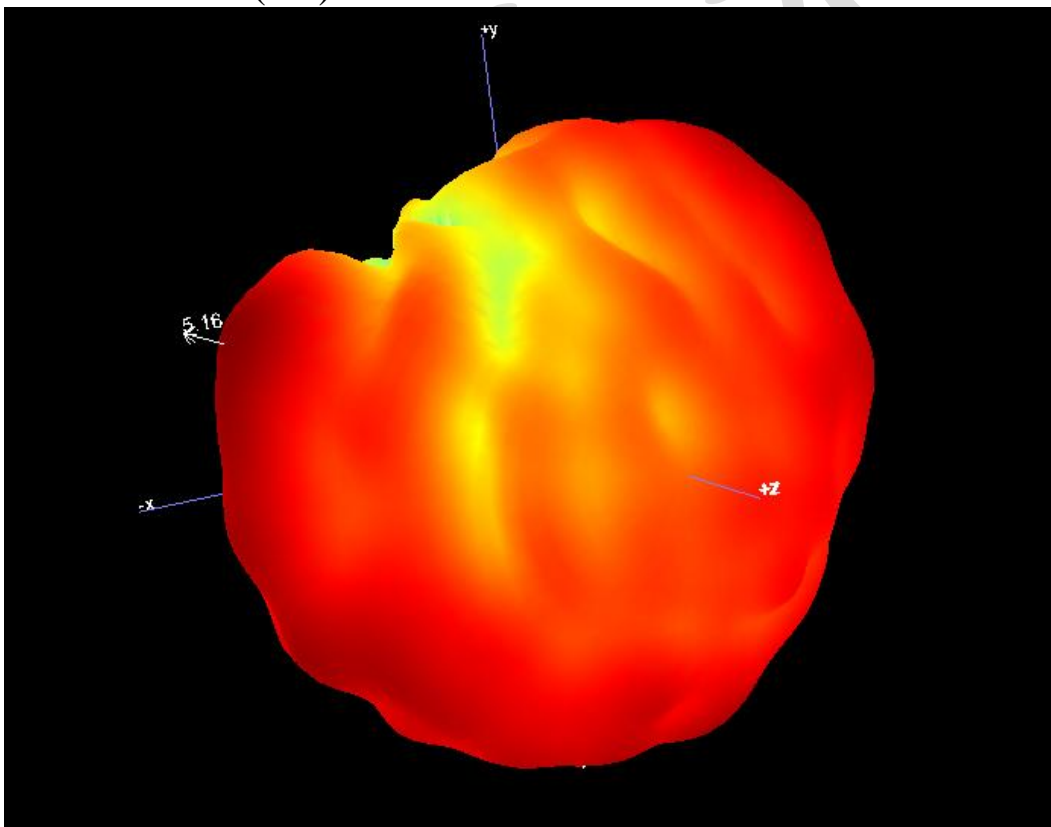

Peak Gain	2.4GHz~2.5GHz	4.9GHz~5.9GHz
	2.98 dBi	5.16 dBi