

**POWER BUTTON:**

Press and hold the button for 2 seconds to turn device ON/OFF.

**VOLUME UP +:**

Short press (< 0.5s) the button to turn up volume. Press and hold the button (2s) to go to the next track.

**VOLUME DOWN -:**

Short press (< 0.5s) the button to turn down volume. Press and hold (2s) the button to go to the previous track.

**INDICATOR LIGHT STATUS:**

*Power ON* – When the speaker is turned on, a solid blue light will appear momentarily.

*Bluetooth pairing indicator* – When the speaker is turned on, a flashing blue and red light indicates speaker is ready to pair. Once paired, the light will slowly pulse blue.

*Power OFF* – When the speaker is turned off, the indicator light will momentarily turn solid blue, then turn off.

*Battery charging* – While speaker is charging, the indicator light will turn solid red. Once speaker is fully charged, the light will turn off.

**SPEAKER PAIRING:**

To pair the speaker, follow these simple steps:

1. Make sure the smartphone, tablet, or computer you're using with the speaker has *Bluetooth*.
2. Turn on the speaker (press and hold the PLAY/PAUSE button for 2 seconds) and look for the little blinking light.
3. Look for the speaker in your device's *Bluetooth* list, or click YES. See list below for device pairing names.

The device and *Bluetooth* will find each other every time, so long as the speaker is set to *Bluetooth* and your device's *Bluetooth* is on. If you're connecting to a computer, you may have some extra steps on that end. You'll have to get that information from the computer company.

**DEVICE PAIRING NAMES:**

ONA18AA019 (Black): Onn SPKR A019

ONA18AA020 (Pink): Onn SPKR A020

ONA18AA021 (Blue): Onn SPKR A021

**Auto off:** If the speaker is on but is not connected to *Bluetooth*, it will shut down after 2 minutes. Once paired, if the speaker is paused for 15 minutes or more, it will automatically shut down.

**INTEGRATED CARRY STRAP:**

Integrated carry strap allows you to attach the speaker to luggage, backpacks, hang in a shower and more.

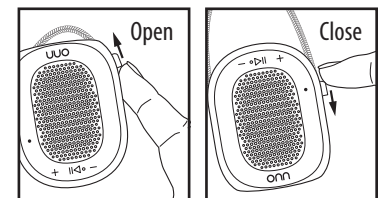

**DISCONNECTING DEVICE:**

Press + and – buttons at the same time for up to 4 seconds to disconnect the speaker from the device and enter into Pairing mode.

**CALL HANDLING:**

*INCOMING CALL:*

*Answering and hanging up a call* – When speaker is paired to your phone, short press the PLAY/PAUSE button to answer the call. To hang up, short press the PLAY/PAUSE button.

*Move call from speaker to device* – If you are on the call and wish to move the call from the speaker to your device, long press the PLAY/PAUSE button (3s).

*Reject an incoming call* – To reject an incoming call, long press the PLAY/PAUSE button (3s).

Situation	Short Press PLAY/PAUSE Button	Long Press PLAY/PAUSE Button
First incoming call	Pick up call	Reject call
On call	End call	Move call from speaker to device

**USB CABLE:**

25 cm Micro USB cable.

**FCC DISCLAIMER:**

Note: This device complies with Part 15 of the FCC Rules. Operation is subject to the following two conditions: (1) This device may not cause harmful interference, and (2) this device must accept any interference received, including interference that may cause undesired operation. Note: This equipment has been tested and found to comply with the limits for a Class B digital device, pursuant to Part 15 of the FCC Rules. These limits are designed to provide reasonable protection against harmful interference in a residential installation.

This equipment generates, uses, and can radiate radio frequency energy and, if not installed and used in accordance with the instructions, may cause harmful interference to radio communications. However, there is no guarantee that interference will not occur in a particular installation.

If this equipment does cause harmful interference to radio or TV reception, which can be determined by turning the equipment off and on, the user is encouraged to try to correct the interference by one or more of the following measures:

- Reorient or relocate the receiving antenna.
- Increase the separation between the equipment and the receiver.
- Connect the equipment into an outlet on a circuit different from that to which the receiver is connected.
- Consult the dealer or an experienced radio/TV technician for help.

Note: Changes or modifications not expressly approved by the party responsible for compliance could void the user's authority to operate this equipment.

**FCC SAR Evaluation:**

This equipment complies with FCC radiation exposure limits set forth for an uncontrolled environment. This transmitter must not be co-located or operating in conjunction with any other antenna or transmitter.

**IMPORTANT LEGAL INFORMATION****IMPORTANT SAFEGUARDS:**

When using an electrical product, basic precautions should always be followed, including the following:

**READ ALL INSTRUCTIONS BEFORE USING**

- **WARNING:** Listen responsibly. To avoid hearing damage, make sure the volume on your device is turned down before connecting to the speaker. After turning on your speaker, gradually turn up the volume until you reach a comfortable listening volume.
- Use this product only for its intended use as described in this manual. Do not use attachments not recommended by ONN.
- ONN is not liable for any damage caused to smartphones, iPod/MP3 players, or any other device.
- Do not place or store this product where it can fall or be dropped into a tub or sink.
- Do not place or drop into water or any other liquid.
- Not for use by children. THIS IS NOT A TOY.
- Never operate this product if it has a damaged cord, plug, cable, or housing.
- Keep away from heated surfaces.
- Only set on dry surfaces. Do not place on surfaces wet from water or cleaning solvents.

**Attention California Residents:**

**WARNING: This product contains chemicals known to the State of California to cause cancer, birth defects, and other reproductive harm.**

**A MESSAGE FROM THE ENVIRONMENT****WARNING:**

This product has an internal, non-replaceable lithium battery. Please dispose of in accordance with your local, state, province, and country guidelines.

This product contains small parts that may present a choking hazard for young children.

**CAUTION:** All servicing of this product must be performed by authorized service personnel only.