

MediaBridge

Digital Media Player



Model DMP3000

User's Guide



Important Information

WARNING

To reduce the risk of fire or electric shock, do not expose this product to rain or moisture. The apparatus shall not be exposed to dripping or splashing. No objects filled with liquids, such as vases, shall be placed on the apparatus.

CAUTION

RISK OF ELECTRIC SHOCK.
DO NOT OPEN.

Caution: To reduce the risk of electric shock, do not remove cover (or back). No user serviceable parts inside. Refer servicing to qualified service personnel.



This symbol indicates "dangerous voltage" inside the product that presents a risk of electric shock or personal injury.



This symbol indicates important instructions accompanying the product.

Caution: The power supply cord is used as the main disconnect device. Ensure that the socket-outlet is located/installed near the equipment and is easily accessible.

Operating Temperature: 40°F to 120°F (5°C to 50°C)

Storage Temperature: -5°F to 150°F (-20°C to 65°C)

Net Weight: 5.75 lbs (approx.)

CAUTION: To prevent electric shock, match the wide blade of the plug to the wide slot of the electrical outlet and fully insert.

FCC Regulations state that unauthorized changes or modifications to this equipment may void the user's authority to operate it.

CAUTION!

- Do not install or place this unit in a bookcase, built-in cabinet or in another confined space. Ensure the unit is well ventilated. To prevent risk of electric shock or fire hazard due to overheating, ensure that curtains and any other materials do not obstruct the ventilation vents.
- Do not obstruct the unit's ventilation openings with newspapers, tablecloths, curtains, and similar items.
- Do not place sources of naked flames, such as lighted candles, on the unit.
- Dispose of batteries in an environmentally-friendly manner.

Important Safety Instructions

1. Read these instructions.
2. Keep these instructions.
3. Heed all warnings.
4. Follow all instructions.
5. Do not use this apparatus near water.
6. Clean only with dry cloth.
7. Do not block any ventilation openings. Install in accordance with the manufacturer's instructions.
8. Do not install near any heat sources such as radiators, heat registers, stoves, or other apparatus (including amplifiers) that produce heat.

Important Information

9. Protect the power cord from being walked on or pinched particularly at plugs, convenience receptacles, and the point where they exit from the apparatus.
10. Unplug this apparatus during lightning storms or when unused for long periods of time.
11. Refer all servicing to qualified service personnel. Servicing is required when the apparatus has been damaged in any way, such as power-supply cord or plug is damaged, liquid has been spilled or objects have fallen into the apparatus, the apparatus has been exposed to rain or moisture, does not operate normally, or has been dropped.

NOTE: This product incorporates copyright protection technology that is protected by U.S. patents and other intellectual property rights. Use of this copyright protection technology must be authorized by Macrovision Corporation, and is intended for home and other limited consumer uses only unless otherwise authorized by Macrovision. Reverse engineering or disassembly is prohibited.

Specifications and features are subject to change without notice. Product may vary from that shown.

Logos are registered trademarks of their respective companies.

Product Registration

Please fill out the product registration card (packed separately) and return it immediately. Returning the card allows us to contact you if needed.

Product Information

Keep your sales receipt to obtain warranty parts and service and for proof of purchase. Attach it here and record the serial and model numbers in case you need them. These numbers are located on the product.

Model No.: _____

Serial No.: _____

Purchase Date: _____

Dealer/Address/Phone: _____

Important Information

FCC Declaration of Conformity

This device complies with Part 15 of the FCC Rules. Operation is subject to the following two conditions: (1) this device may not cause harmful interference, and (2) this device must accept any interference received, including interference that may cause undesired operation.

Trade Name: Acoustic Research

Model(s): DMP3000

Equipment Classification: TV/Computer Interface Device

Responsible Party:

Thomson Inc.

10330 N. Meridian Street

Indianapolis, IN 46290

Telephone: (317) 587-3569

This equipment has been tested and found to comply with the limits for a Class B digital device, pursuant to Part 15 of the FCC Rules. These limits are designed to provide reasonable protection against harmful interference in a residential installation. This equipment generates, uses, and can radiate radio frequency energy and, if not installed and used in accordance with the instructions, may cause harmful interference to radio communications. However there is no guarantee that interference will not occur in a particular installation. If this equipment does cause harmful interference to radio or television reception, which can be determined by turning the equipment off and on, the user is encouraged to try and correct the interference by one or more of the following measures:

- Reorient or relocate the receiving antenna.
- Increase the separation between the equipment and receiver.
- Connect this equipment into an outlet on a circuit different from that to which the receiver is connected.
- Consult the dealer or an experienced radio/TV technician for help.

FCC Radiation Exposure Statement

This equipment complies with FCC radiation exposure limits set forth for an uncontrolled environment. This equipment should be installed and operated with minimum distance 20cm between the radiator and your body.

Welcome to MediaBridge!

Your AR MediaBridge allows you to take digital music files, photos, and videos stored on your computer network and play them on a home entertainment system. Instead of crowding around a computer to look at pictures, watch them on your TV, even in HD. Listen to your music the way it was meant to be heard—on your home entertainment system.

You can even stream videos from your computer network to the TV by using the MediaBridge remote control. You can experience music, movies, or photos in the comfort of your living room, family room, or bedroom.

As the MediaBridge streams your digital files from your computer network, it leaves your computer free to perform other functions such as e-mail or surfing the web. Bridging the gap is seamless—wirelessly or wired—the choice is yours.

In This Guide ...

Welcome to MediaBridge!	5
Setting Up Your MediaBridge	8
Using Your MediaBridge	16
Using Your Remote Control.....	22
Troubleshooting	29
Limited Warranty	34

Welcome to MediaBridge!

What's in the Box

Before you start setting up, make sure your MediaBridge package includes the following parts:

- Acoustic Research Digital MediaBridge (DMP3000)
- Power supply and AC cable
- Remote control
- Two AA batteries for the remote
- Wireless networking antenna
- Composite video cable
- Analog audio cable
- Software installation CD
- Registration card

The first step in setting up your MediaBridge is installing the batteries in the remote.

IMPORTANT: Do not turn on your MediaBridge yet! Wait until you've connected it to your home entertainment system and computer network—connection instructions start on page 8.

Installing the Batteries in the Remote Control

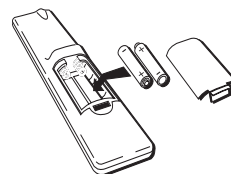

1. Remove the battery compartment cover from the back of the remote by pushing the tab and lifting off the cover.
2. Insert 2 “AA” fresh batteries. Make sure the polarities (+ and -) are aligned correctly.
3. Replace the cover.

Using the Remote to Operate Other Devices

The MediaBridge remote control is already programmed to operate the MediaBridge. You can program the remote to operate up to 5 other devices in your entertainment center. See pages 22-28 for instructions on how to program and use the remote.

Welcome to MediaBridge

Front of the MediaBridge

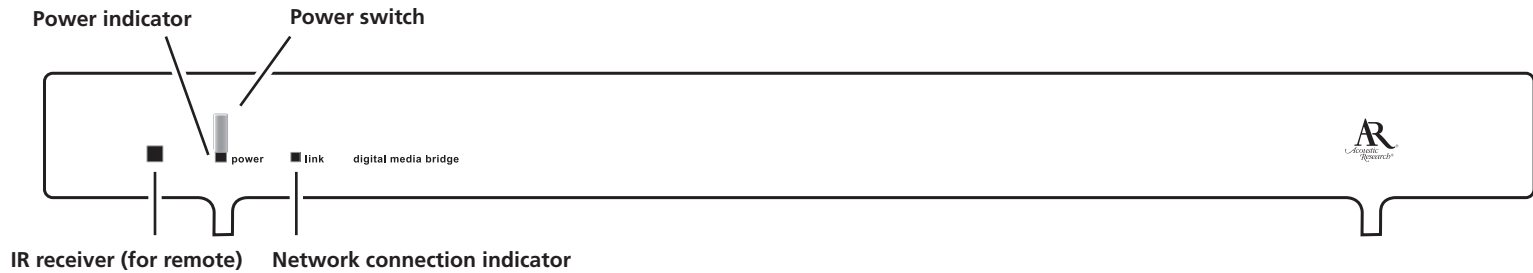

Back of the MediaBridge

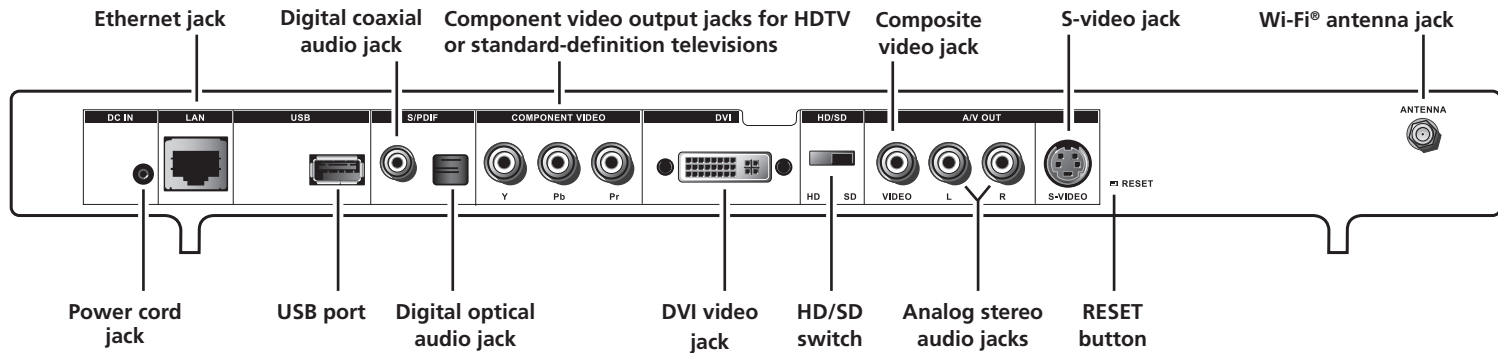

Wi-Fi is a registered trademark of the Wi-Fi Alliance.

Setting Up Your MediaBridge

There are four steps to setting up your MediaBridge:

1. Connect the MediaBridge to your Home Entertainment System.
2. Connect the MediaBridge to your Computer Network.
3. Install the Software on the PCs in your network.
4. Run the MediaBridge Setup Wizard.

Step 1: Connect the MediaBridge to your Home Entertainment System

You will need to make two connections between the MediaBridge and your entertainment system: one for video and one for audio.

Important: *The MediaBridge uses on-screen menus for guiding your selections, so you need to connect it either directly to a TV or to a video input on an A/V receiver. It is recommended that you use Acoustic Research cables for best picture and sound performance.*

Video Connection

The MediaBridge works with both High-Definition and Standard-Definition TVs. How you connect the MediaBridge to your TV depends upon the type of TV you have.

Note: *You must have a High-Definition television or monitor in order to watch video in High-Definition.*

Setting Up Your MediaBridge

Connecting the MediaBridge to an HDTV or HDTV Monitor



1. Move the HD/SD switch on the back of the MediaBridge to the HD position.

Note: When the switch is in the HD position, there will be no video signal from the composite or S-video jacks.

2. Using either component video cables or a DVI video cable, connect the MediaBridge to the corresponding input on your HDTV or A/V receiver (HD video is available through both component video and DVI connections).

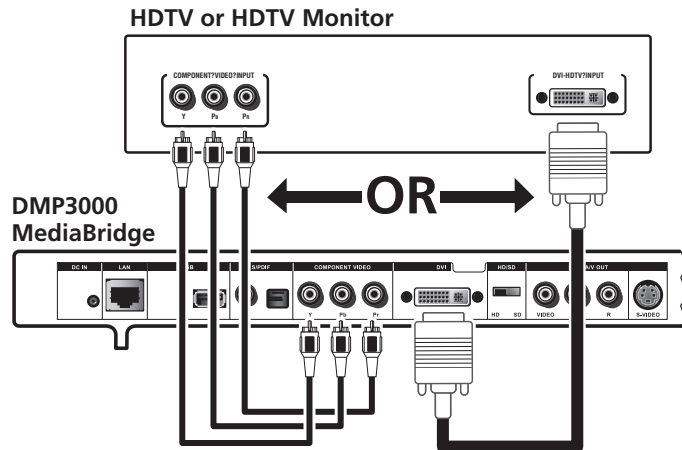

Connecting the MediaBridge to a Standard-Definition TV



1. Move the HD/SD switch on the back of the MediaBridge to the SD position.

Note: When the switch is in the SD position, there will be no video signal from the DVI connector.

2. Using one of the following connections to connect the MediaBridge to your TV:

- Component video (best quality)
- S-Video (better quality)
- Composite video (good quality)

Connect the cable from the back of the MediaBridge to the corresponding input on your TV or A/V receiver.

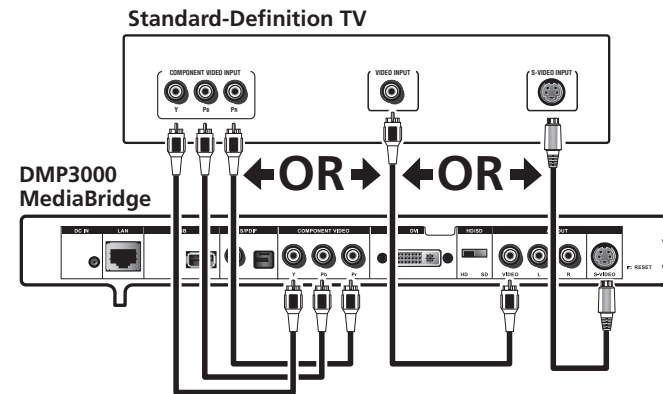

Setting Up Your MediaBridge

Audio Connections

Your MediaBridge offers three audio output options: two digital outputs and one pair of analog stereo outputs. These outputs can be used to play audio through your TV, an A/V receiver, or a dedicated amplifier. Any of these outputs can be used to connect the MediaBridge to your TV or A/V device. If your device has a digital input jack, use one of the digital connection options for the best sound quality.

Connection Options for Audio

The MediaBridge offers three types of audio connections:

- Digital Coaxial (excellent quality)
- Digital Optical (excellent quality)
- Analog Stereo (good quality)

When connecting the audio cables, remember to connect the AUDIO OUT jacks on the back of the MediaBridge to the AUDIO IN jacks on your device.

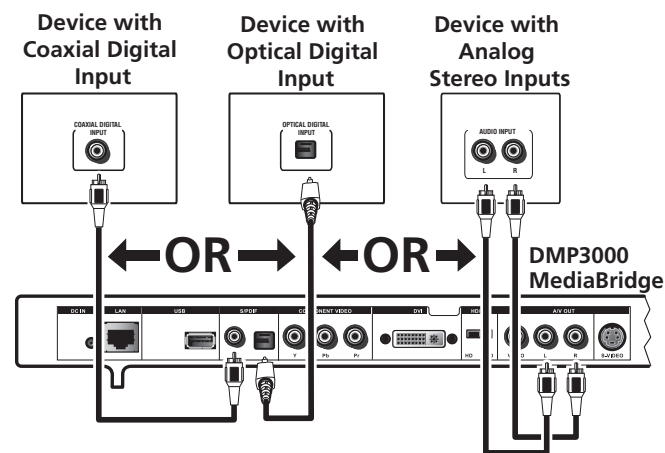

Setting Up Your MediaBridge

Step 2: Connecting the MediaBridge to your Computer Network

The MediaBridge must be connected to your computer or computer network in order to play your digital music, movies, and pictures.

You can connect the MediaBridge to your computer in one of two ways:

- **Using a wired network**

The MediaBridge can connect to a wired computer network using a standard Ethernet cable connected to the Ethernet port on the back of the unit.

- **Using a wireless network**

The MediaBridge has a built-in 802.11g wireless card and can work with an existing 802.11g or 802.11b wireless network.

Because wireless computer networks are subject to interference from devices like cordless phones, microwave ovens, and neighboring wireless networks, the quality of the connection between your MediaBridge and your computer can vary throughout the day. For the best performance, use the wired Ethernet connection, particularly when playing high-definition video.

***Note:** If you're using a wireless connection to the network, use the 802.11g-only option on your router, especially if you plan to use the MediaBridge for video streaming. See the users manual that came with your wireless router for more information.*

Connecting the MediaBridge using the wired Ethernet connection

To attach your MediaBridge to a wired computer network, connect a standard Ethernet cable (Cat5 or better) between the MediaBridge and your Ethernet hub/switch/router.

The following diagram shows a typical wired home network with a MediaBridge connected using a wired Ethernet connection. Please note that your wired network might be different.

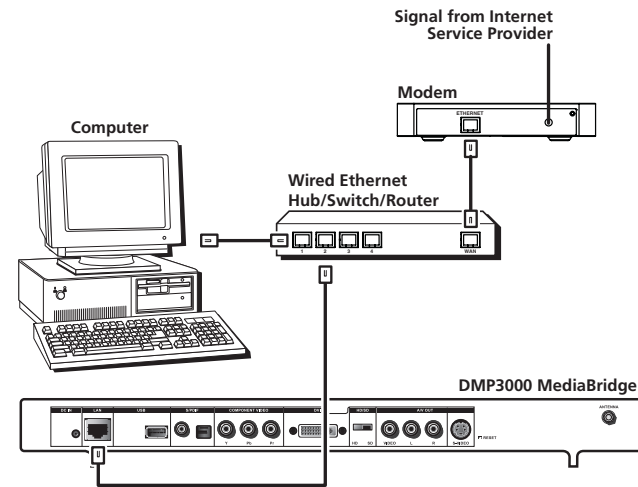

A sample wired network with a MediaBridge connected. This diagram shows a typical configuration—your network and devices might be different.

Setting Up Your MediaBridge

Connecting the MediaBridge using a wireless Ethernet connection

For the best reception, the MediaBridge includes an external antenna which must be attached to the unit before it can receive the wireless signal.

Connect the antenna to the ANTENNA jack on the back of the MediaBridge and place the antenna in an unobstructed location.

The following diagram shows a typical wireless home network with a MediaBridge. Please note that your network might be different.

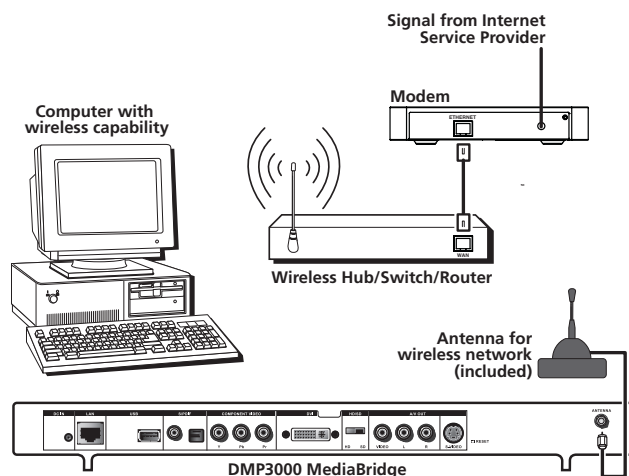

A sample wireless network with a MediaBridge. This diagram shows a typical configuration—your network and devices might be different.

Step 3: Install the Software

Once you've connected the MediaBridge to your computer network, you are ready to install the MediaBridge software.

You must install this software on your computer in order for the MediaBridge to work with your computer.

Turn on your computer and insert the software CD into the drive.

The setup program should start automatically after a few moments. (If it does not start automatically, browse to the top directory on the CD and double-click on the Setup icon.)

On-screen instructions will guide you through the setup process.

Important Notes

- The MediaBridge software is not compatible with Apple Macintosh® computers.
- When installing the MediaBridge, you must be logged in with administrator privileges on your computer. Otherwise, the software will not install correctly. You do not have to be an administrator to run the software once it's installed, but to install, you must have administrative privileges.
- The MediaBridge is not designed to work with VPN (Virtual Private Network) software. If VPN software is installed on a computer in the network, the MediaBridge may not be able to see that computer.

Macintosh is a registered trademark of Apple Computer, Inc.

Setting Up Your MediaBridge

Using the MediaBridge with a Firewall

If you have firewall software installed on your network, you may need to reconfigure the firewall software to allow the MediaBridge to access your network computers.

The MediaBridge software setup installs a background program on your computer called “MediaStreamer.exe.” It is safe to allow this program to operate on the network. If the MediaStreamer program is blocked, the MediaBridge will not see any computers on the network, so the MediaBridge’s media libraries will be empty.

If you’re still having problems getting the MediaBridge to work with your firewall software, try making the following adjustments to your firewall settings:

- Port 6070 must be open for UDP-type network traffic
- Port 40001 must be open for TCP-type network traffic
- Port 40002 must be open for TCP-type network traffic

Step 4: Run the MediaBridge Setup Wizard

The MediaBridge Setup Wizard takes you through the steps to get your MediaBridge up and running. The Setup Wizard lets you set the following options:

- Language
- Screen resolution
- Display type
- Network type

The last screen of the Setup Wizard confirms your Network Status information.

How to Use the Remote Control in the Menu System

To move around in the Setup Wizard and other on-screen menus, use the arrow buttons on the MediaBridge remote. When an item is highlighted, you can select it by pressing the OK button. If an item has arrows, you can use the left and right arrow buttons on the MediaBridge remote to change that item’s setting.

Press the HOME button to display the Main Menu. Use the GO BACK button to retrace your steps in the menu system.

Continues on the next page...

Setting Up Your MediaBridge

To run the Setup Wizard:

1. Press the MEDIA button on the MediaBridge remote to turn the MediaBridge on.
2. Turn on your TV or A/V tuner. Select the correct input on your TV or tuner to display the signal from your MediaBridge.

The first screen of the Setup Wizard should be displayed. Press OK to continue. If you see a different menu screen, you can start the Setup Wizard through the *Settings* menu. See page 21 for more information.

3. In each Setup Wizard screen, press the up or down arrow on the remote to highlight any settings you'd like to change. Then, use the left and right arrows to scroll through the options for that setting.

When you're done with a setting, press the up or down arrow to highlight *Continue*. Press OK to go to the next screen.

You can change any of these settings or run the Setup Wizard again through the *Settings* menu. See page 21 for more information.

Special Note for Wireless Network Users

The *Network Type* screen in the Setup Wizard lets you set up a wireless network if you have one. If you're using a wireless network, you must tell the MediaBridge the name of your wireless network. Also, if you're using encryption on your wireless network, you must enter your security key.

Note on Network Configuration: *The MediaBridge is configured to work with DHCP (Dynamic Host Configuration Protocol) servers incorporated in most routers. If you do not have a DHCP server in your router or elsewhere on your network, the MediaBridge will assign itself an IP address in the range of 169.254.xxx.xxx automatically.*

Note: *If you have turned on the encryption features of your wireless network, you need to have your WEP (Wired Equivalent Privacy) key before going any further. The MediaBridge only supports WEP. If you have turned off the broadcast of your SSID (Service Set Identifier), you also need that information before continuing.*

Setting Up Your MediaBridge

To configure the MediaBridge for your wireless network:

1. In the Setup Wizard's *Network Type* screen, use the remote's up and down arrows to highlight the *Network Type* option.
2. If the *Network Type* option is set to *Wireless*, you don't need to change it. Highlight *Continue* and press OK to continue.

If the *Network Type* option is set to *Wired*, highlight the *Network Type* option and use the left or right arrow buttons to change the option to *Wireless* (it may take a few seconds for the item to change on the screen).

Then, highlight *Continue* and press OK to continue.

3. The next screen in the Setup Wizard displays a list of wireless networks the MediaBridge can detect.
4. Select your network from the list.

Note: If you have disabled the SSID broadcast feature on your wireless access point, you need to select the *Private* option and type in the name of your network using the virtual keyboard. To use the virtual keyboard:

1. Press *MENU* on your remote to display the virtual keyboard.
2. Use the arrow buttons to highlight letters and numbers, and press OK to select them.
3. Press *MENU* again to remove the keyboard from the screen.
4. Highlight the on-screen *Continue* button and press OK to continue.

5. If you have enabled encryption on your wireless network, highlight *Encryption type*. Use the left and right arrows to select the type of encryption your network uses. Then, highlight *Continue* and press OK to continue.

6. Select the *Encryption Key* option and type in your WEP key or passphrase using the virtual keyboard. When you've finished, press the *MENU* button on your remote to remove the virtual keyboard from the screen.

Confirm that the "link" indicator on the front of the unit is lit. If it is, highlight the on-screen *Continue* button and press OK to continue.

The next screen of the Setup Wizard shows your network status. Select *Continue* to see the final screen of the Setup Wizard, or select *Back* to change your network settings.

Using Your MediaBridge

With the MediaBridge, you can play music from your hard drive, photos from your digital camera, or movies from your digital camcorder on your home entertainment system.

You can also access media files from USB devices via the USB port on the MediaBridge back panel.

The MediaBridge menu system displays all of the playable files available on your network. Files are listed by more than just their computer filenames—the MediaBridge menu system offers many ways of finding and sorting movies, music, and pictures.

At the bottom of the main menu, the MediaBridge offers Help and Off icons:

- Highlight and select the *Help* icon if you need directions or information on a specific screen.
- Highlight and select the *Off* icon to turn the MediaBridge off.

The Main Menu

To access the MediaBridge main menu, press the MEDIA button on the MediaBridge remote to put the remote control in MediaBridge mode. Then, press the HOME button.

The MediaBridge main menu has four options:

- **Watch Movies**
Browse through your library of movies.
- **Listen to Music**
Browse through your library of music.
- **View Pictures**
Browse through your library of pictures and picture albums.
- **Settings**
Change network and video settings and choose preferences.

Using Your MediaBridge

Watch Movies

The MediaBridge can play movies created by digital camcorders or created by PC-based tuner cards that record over-the-air digital broadcast television to your computer.

Note: *If you have more than one computer on your network, the first screen in the Video library will ask you to choose which computer you want to browse.*

The MediaBridge offers two ways of browsing through your video library:

- By the date the movie was recorded
- By the directory of folders on your computer

Choosing Files

You can play individual movies, or you can play all of the movies in a given folder or recorded in a given year. You can also tell the MediaBridge to play all of the movies in the library for the selected hard disc.

Use the arrow buttons and the OK button to navigate through your library. Then, press OK or PLAY to start playing a single movie or a group of movies (depending on what's highlighted).

Note: *A red exclamation mark next to a video file in the library means that the MediaBridge cannot play that particular file. There are several possible reasons for this—the file may have a name that the MediaBridge has trouble recognizing, or the file may be corrupt.*

Playing Files

You can use these remote control buttons during movie playback:

INFO	Displays available information for the current file.
PAUSE	Pauses the movie.
PLAY	Continues the movie after a pause.
PREV or NEXT	Go to the previous or next movie in the list.
REVERSE and FORWARD	Provide transport control for standard-definition videos.
STOP	Stops the movie and returns to the Video library.

Note: *If the movie you're playing on the MediaBridge has multi-channel audio, audio will only be available from the digital audio outputs. There will be no audio signal from the MediaBridge's other audio outputs.*

To hear multichannel audio, use one of the MediaBridge's digital audio outputs to connect it to multichannel-capable receiver.

More Options...

Press the GUIDE button to access more options for playback or browsing. Press GUIDE again to clear the option list from the screen.

Press the HOME button to go to the main menu from anywhere in the MediaBridge menu system.

Press the GO BACK button to retrace your steps in the menu system.

Using Your MediaBridge

Listen to Music

The MediaBridge offers five ways of browsing through your music library:

- By artist
- By album
- By genre
- Alphabetically, by song or file title
- By your computer's folder organization

The MediaBridge also lists any m3u or WPL playlists it finds in your network.

Note: *If you have more than one computer in your network, the first screen in the Music library will ask you to choose which computer you want to browse.*

Choosing Files

You can play individual songs, or you can play all of the songs by a given artist, on a given album, or in a given genre. You can also choose playlists that the MediaBridge finds in your network or tell the MediaBridge to play all of the songs in the library for the selected hard disc.

Use the arrow buttons and the OK button to navigate through your library. Then, press OK or PLAY to start playing a single song or a group of songs (depending on what's highlighted).

Playing Files

You can use these remote control buttons during music playback:

INFO

Displays available information for the current file.

PREV or NEXT

Go to the previous or next song in the list.

REVERSE, PLAY, FORWARD, STOP, and PAUSE

Provide transport control, just as they would with a CD player.

More Options...

Press the GUIDE button to access more options for playback or browsing. Press GUIDE again to clear the option list from the screen.

Press the HOME button to go to the main menu from anywhere in the MediaBridge menu system.

Press the GO BACK button to retrace your steps in the menu system.

Using Your MediaBridge

View Pictures

The MediaBridge offers three ways of browsing through your photos:

- By the date the photo was taken
- By the directory of folders on your computer
- Within picture albums you've created

Note: If you have more than one hard disc in your network, the first screen in the Picture library will ask you to choose which computer you want to browse.

The MediaBridge menu system displays thumbnails of your images to you help find pictures.

You can also create and view picture albums on your MediaBridge.

Choosing Pictures

You can view individual pictures, or you can start a slideshow with all of the pictures in the list or category on the screen (by date or by folder).

Use the arrow buttons and the OK button to navigate through your library. Then, press OK or PLAY to view a single picture or a slideshow of a group of pictures (depending on what's highlighted).

Note: A red exclamation mark next to a picture file's name means that the MediaBridge cannot play that particular file.

Special note for plasma monitor owners: To avoid uneven phosphor aging (or "burn-in"), avoid displaying the same image on your plasma monitor for a prolonged period of time. Do not turn the MediaBridge's screensaver off (by default the screensaver is on). See page 21 for more information about the MediaBridge's screensaver.

Viewing Pictures and Slideshows

You can use these remote control buttons while viewing individual pictures or during a slideshow:

CH+ or CH-	Zoom in on or out of the current picture.
CLEAR	Deletes the current picture from your network.
FORWARD or REVERSE	Rotate the current picture clockwise or counterclockwise.
INFO	Displays available information for the current file.
PAUSE	Pauses the slideshow.
PLAY	Continues the slideshow after a pause.
PREV or NEXT	Go to the previous or next picture.
STOP	Stops the slideshow and returns to the Picture library.

Note: The Rotate Picture function does not work with read-only content.

More Options...

Press the GUIDE button to access more options for playback or browsing. Press GUIDE again to clear the option list from the screen.

Press the HOME button to go to the main menu from anywhere in the MediaBridge menu system.

Press the GO BACK button to retrace your steps in the menu system.

Using Your MediaBridge

Creating and Viewing Picture Albums

From the Pictures menu you can browse through the picture albums you've already created, organize existing albums, or create a new one.

- Choose *View Picture Albums* to see the picture albums you've already created and play one as a slideshow.
- Choose *Organize Albums* to create a new picture album or organize an existing album.

To create a new picture album:

1. Choose *View Pictures* from the main menu. If you have more than one source for media in your network, choose the source you want to browse for pictures.
2. Choose *Organize Albums* from the Pictures menu.
3. Choose *Create new album* from the Organize Album menu.
4. Browse through your picture library by year and month—the menu shows you thumbnails of the images for that year and month.
5. Use the arrow buttons to highlight a thumbnail, and press OK to include that image in the album (a checkmark appears above the images in the album).

Note: If you want to customize your album's name, choose *Rename* this album from the Album browse screen. Then, press *MENU* and use the on-screen keyboard to enter a name—you'll need to delete the existing name first. Press *MENU* again to clear the keyboard from the screen. Then, press *GO BACK* to return to the Album browse screen.

6. Press the *GO BACK* button when you've finished compiling the pictures in your album. The album appears in the list of albums available for organizing or viewing.

Playing Slideshows with Music

You can have the MediaBridge play music while you watch a slideshow.

To start the music during the slideshow:

1. While a slideshow is running, press the *MUSIC* button on the remote to bring up the music menu.
2. Browse and select the music or playlist you want to play. Press *OK* to start playback of the file(s).
3. Press the *PICS* button.
4. Select *Resume Slideshow* and press *OK*.

You can also start the music playlist first and add the slideshow later. Start the playlist (steps 1 and 2 here). Then, press the *PICS* button, find the slideshow you want to see, and press *OK* or *PLAY* to select it.

Using Your MediaBridge

Settings

The Settings menu lets you customize your MediaBridge to fit your preferences and home entertainment/computer network configuration. There are three kinds of options you can set: General Settings, Library Settings, and System Settings.

General Settings

Select *General Settings* in the Settings menu to set your preferences for the following options:

- screensaver delay
- closed captioning
- language
- USB media auto-play
- menu system look and feel

The General Settings menu also lets you repeat the Setup Wizard, restore the MediaBridge's default settings, or update the MediaBridge's software.

Note: *The MediaBridge must have access to an internet connection in order to run the software update.*

To repeat the Setup Wizard:

1. Choose *Settings* from the main menu.
2. Choose *General Settings* from the Settings menu.
3. Choose *Repeat setup wizard* from the General Settings menu.
4. Follow the on-screen instructions to complete the Setup Wizard, or press the HOME button to exit.

Library Settings

Select *Library Settings* in the Settings menu if you want to scan a media library in your network.

System Settings

Select *System Settings* in the Settings menu to set your preferences for Display and Network Settings.

Accessing USB Devices

You can access the media from a USB storage device by connecting it to the USB port on the back of the MediaBridge.

The MediaBridge will recognize the device and scan it automatically—this will take a few moments.

A *Removable Media* menu item will appear in the movies, music, and pictures libraries until you disconnect the device. Choose this item to browse through the USB device's media contents.

Notes:

- *The MediaBridge recognizes only certain kinds of USB devices: USB thumb drives, USB memory card readers, and USB hard drives. Please note that not all USB devices are compatible with the MediaBridge.*
- *If you're connecting an RCA Lyra to the MediaBridge using a USB connection, make sure the Lyra's USB Protocol is set to Mass Storage Class.*
- *USB devices should be formatted as NTFS or FAT32 in order for the MediaBridge to play files from them. If your USB device is not recognized by the MediaBridge, check its formatting type.*

Using Your Remote Control

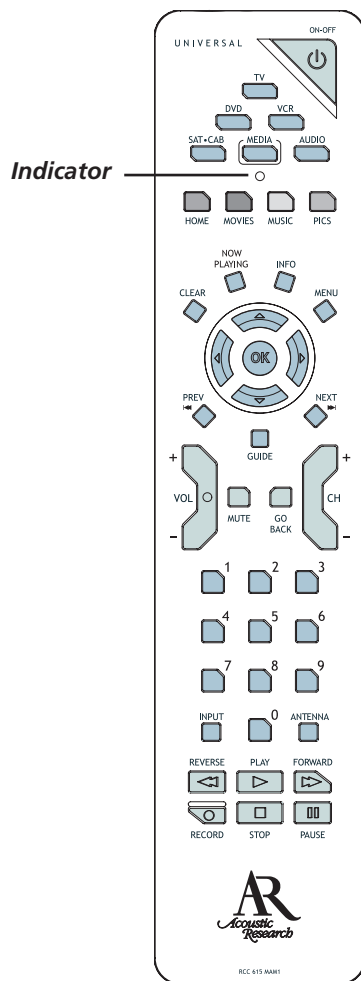

The Remote Control

The MediaBridge includes a 6-device universal remote control. The remote already operates the MediaBridge and many RCA, GE, and Proscan devices. It must be programmed to work with other devices (see pages 24-25 for more information on programming).

The Buttons on the Remote

(0-9) Number buttons You can enter some settings directly with the number buttons.

ANTENNA In VCR mode (if programmed), this button works as a TV/VCR button for some VCRs. In SAT•CAB mode (if programmed), this button works as a TV/SAT button for some satellite receivers.

Arrow buttons Used to navigate through on-screen menus and to highlight options.

CH + or CH - While viewing pictures from your MediaBridge, this button zooms in on or zooms out of the current picture. Changes channels in TV, VCR, or SAT•CAB mode.

CLEAR While viewing pictures from your MediaBridge, this button deletes the current picture from the network (except for read-only pictures). For some other devices, this button removes menus or displays from the screen.

Device buttons Device buttons are used to set the remote to operate a certain device. For example, if you want to use the MediaBridge, press the MEDIA button. This tells the remote you are using the MediaBridge, and the remote communicates with the MediaBridge.

AUDIO Puts the remote in Audio mode so the remote (if programmed) operates the audio device.

DVD Puts the remote in DVD mode so the remote (if programmed) operates the DVD player.

MEDIA Puts the remote in MediaBridge mode so the remote operates the MediaBridge.

SAT•CAB Puts the remote in satellite/cable box mode so the remote (if programmed) operates a satellite receiver or cable box.

TV Puts the remote in TV mode so the remote (if programmed) operates the TV.

VCR Puts the remote in VCR mode so the remote (if programmed) operates the VCR.

Using Your Remote Control

GO BACK Returns you to the previous menu or screen.

GUIDE When you're controlling the MediaBridge, this button accesses the options available for viewing pictures or movies or listening to music (press again to clear the options from the screen).

HOME Brings up the main menu for the MediaBridge from any point in the MediaBridge media system.

Indicator Flashes when you press a remote control button. Also flashes during the remote control programming procedure (see the following pages for more information).

INFO Displays available information for an image, song, or movie.

INPUT Press to toggle through the available input sources for TVs, satellite receivers, or VCRs.

MENU Brings up the MediaBridge's on-screen keyboard (when available). For some devices, this button accesses a main menu.

MOVIES Accesses the MediaBridge's Video Media Library screen or Videos Main Menu.

MUSIC Accesses the MediaBridge's Music Media Library screen or Music Main Menu.

MUTE Reduces volume to its minimum level. Press again to restore the volume.

NEXT In MediaBridge mode, goes to the next song/movie/

picture in a playlist or slideshow. In DVD mode, goes to the next chapter.

NOW PLAYING This button has no functionality with the MediaBridge.

OK When in the menu system, selects highlighted items.

ON•OFF Turns the MediaBridge on and off. If the remote is in another device mode (TV, DVD, etc.) and programmed to control that device, this button will turn the device on and off.

PICS Accesses the MediaBridge's Pictures Media Library screen or Pictures Main Menu.

PLAY, STOP, and PAUSE Provide transport control for movie, music, and slideshow playback. Also provides transport control for many DVD players and VCRs.

PREV (Previous) In MediaBridge mode, goes to the previous song/movie/picture in a playlist or slideshow. In DVD mode, goes to the previous chapter.

RECORD Starts recording for some VCRs, DVD recorders, or hard disk recorders.

REVERSE and FORWARD Provide transport control for music and standard-definition movie playback. Rotate pictures counterclockwise and clockwise (except for read-only pictures). Also provides transport control for many DVD players and VCRs.

VOL – or VOL + Decreases or increases the volume.

Using Your Remote Control

Using the Universal Remote with Other Devices

The universal remote can be programmed to operate many brands of remote controllable TVs, VCRs, audio devices, DVD players, cable boxes, satellite receivers, and other devices. This remote is already programmed to control many RCA, GE, and Proscan devices.

Find Out If You Need to Program the Remote

To determine whether the universal remote needs to be programmed to operate one of the devices in your home entertainment system:

1. Turn on the device (your TV, for example).
2. Point the remote at the device.
3. Press the corresponding device button (in this example, TV).
4. Press ON•OFF to see if the device responds. If the device doesn't respond, you need to program the remote to operate it.

Programming the Remote

There are two ways to program the remote control to operate other devices: Automatic Code Search and Direct Entry.

Using Automatic Code Search

The following instructions can be used to program the remote to operate each of your devices. If you want to stop the automatic code search without programming any of your devices, press and hold CLEAR until the indicator on the remote turns off.

1. Turn on the device you want to operate (VCR, DVD player, etc.).
2. Press and hold the device button you want to program (VCR, DVD, etc.). While holding the device button, press and hold ON•OFF until the indicator on the remote turns on, then release both buttons.
3. Point the remote at the device.
Important Note: *The remote may not be compatible with all models of all brands of devices. It also may not operate all functions of your device.*
4. Press and release PLAY, then wait 5 seconds or until the indicator stops flashing.

At this point the remote is searching for the correct code to program. If, after 5 seconds, the device you want to operate does not turn off, press PLAY again to tell the remote to search the next set of codes.

Using Your Remote Control

Continue pressing and releasing PLAY until the device turns off or you have searched through all of the codes. The indicator flashes when all codes have been searched; then, the indicator turns off, and the remote exits Automatic Code Search.

If the device you want to control *does* turn off:

1. Press and release REVERSE, then wait 2 seconds. Repeat this step until the device turns back on.
2. To finish, press and hold STOP until the indicator on the remote turns off.

Using Direct Entry

1. Turn on the device you want to operate (VCR, DVD player, etc.).
2. Look up the brand and code number(s) for the device on the code list on pages 26-28.
3. Press and hold the device button you want to program on the remote.
4. Enter the 4-digit code from the remote control code list on the following pages. If the indicator flashes, you have either entered an invalid code or the button isn't programmable.
5. Release the device button, point remote at device, and then press ON•OFF to see if the device responds to the command. If it doesn't, try pressing the device button and then ON•OFF again.

- If you get no response, repeat these steps using the next code listed for your brand, until the device responds to the remote commands.
- If you try all the codes for your device brand and none work, try the automatic code search method. If automatic code search doesn't find the code, the remote is not compatible with your device.

How to Use the Remote After You've Programmed It

Because this universal remote can control several different devices (TV, DVD, VCR, satellite receiver, etc.), the remote uses operational modes triggered by the device buttons.

1. Press the appropriate device button (DVD, TV, VCR, SAT•CABLE, AUDIO, AUX•HD) to set the remote to control the device.
2. Press ON•OFF to turn the device on or off.
3. Use the remote buttons that apply to that device.

Notes: *The remote control may not be compatible with all brands and models of devices.*

If you keep pressing buttons and nothing happens, the remote is probably in the wrong mode. You must press the device button that matches the device you want to operate (i.e., if you want to operate the VCR, press VCR on the remote control to put the remote in VCR mode).

Remote Control Codes

Audio Codes

Audio (General)

GE.....	4000
Proscan.....	4000
RCA.....	4000

Amplifier

GE.....	4003
Proscan.....	4003
RCA.....	4003

Audio Cassette

GE.....	4006
Proscan.....	4006
RCA.....	4006

CD

ADC.....	4055, 4056, 4066
Aiwa.....	4039, 4057
Akai.....	4058
Denon.....	4060
Emerson.....	4040
Fisher.....	4041, 4063, 4064
GE.....	4065
GE.....	4007
Hitachi.....	4042
JVC.....	4043
Kenwood.....	4044, 4067, 4068
Luxman.....	4069
Marantz.....	4046
MCS.....	4070
Mitsubishi.....	4071, 4072
NEC.....	4045
Onkyo.....	4047
Panasonic.....	4048
Pioneer.....	4049
Proscan.....	4007
RCA.....	4050, 4062
RCA.....	4007
Sears.....	4059
Sony.....	4051, 4061
Technics.....	4052
Toshiba.....	4073
Yamaha.....	4053, 4054

Phono

GE.....	4005
Proscan.....	4005
RCA.....	4005

Receiver/Tuner

Aiwa.....	4008, 4009, 4010, 4011, 4012, 4021
Denon.....	4027
Harman Kardon.....	4020
JBL.....	4020
JVC.....	4013
Kenwood.....	4014
Onkyo.....	4022
Optimus.....	4028
Panasonic.....	4023, 4024
Pioneer.....	4074
RCA.....	4015, 4029, 4030
Sherwood.....	4026
Sony.....	4016, 4017, 4025
Technics.....	4023, 4024
Yamaha.....	4018, 4019

Cable Box Codes

ABC.....	5002, 5003, 5004, 5006, 5045
Archer.....	5009, 5010
Cableview.....	5007
Contec.....	5015
Eastern.....	5016
GE.....	5002, 5003
Gemini.....	5017, 5018
General Instruments.....	5003
Hamlin.....	5019, 5020, 5021, 5026, 5033
Hitachi.....	5003
Jerrold.....	5003, 5017, 5022, 5023, 5039, 5045
Magnavox.....	5024
Motorola.....	5076
Movie Time.....	5025
NEC.....	5005
NSC.....	5025
Oak.....	5015, 5027
Panasonic.....	5041, 5044
Philips.....	5011, 5012, 5013, 5014, 5018, 5024, 5028, 5029, 5030
Pioneer.....	5031, 5032
Proscan.....	5002, 5003
RCA.....	5007, 5040, 5042, 5044
Realistic.....	5009
Samsung.....	5032
Scientific Atlanta.....	5006, 5034, 5035, 5036, 5073, 5074, 5075
Signature.....	5003
Sprucer.....	5044
Standard Component.....	5037, 5038
Starcom.....	5017, 5045
Stargate.....	5017
Tocom.....	5004, 5022
United Cable.....	5045
Universal.....	5008, 5009, 5010
View Star.....	5015, 5024, 5025
Zenith.....	5043

Combo Codes

DVD/VCR	DVD	VCR
Broksonic.....	3075.....	2075
Emerson.....	3076.....	2076
Go Video.....	3077, 3081.....	2077
JVC.....	3078.....	2078
RCA.....	3079.....	2079
Samsung.....	3080.....	2080, 2081
Sanyo.....	3082.....	2082
Sony.....	3083.....	2083
Zenith.....	3084.....	2084

TV/DVD

Broksonic.....	1143
Sansui.....	1149
Toshiba.....	1145

TV/DVD/VCR

Panasonic.....	1152, 1153
Sylvania.....	1154

TV/VCR

Broksonic.....	1151
----------------	------

DVD Codes

Aiwa.....	3010, 3021, 3022
Apex.....	3023, 3024
Broksonic.....	3027, 3075
Daewoo.....	3028
Denon.....	3029, 3030, 3031, 3042, 3062, 3063, 3064
Emerson.....	3032, 3033, 3076
Funai.....	3033
GE.....	3000, 3034
Go Video.....	3077, 3081
Hitachi.....	3009, 3067, 3068, 3069, 3070
JVC.....	3003, 3011, 3078
Kenwood.....	3071
Konka.....	3012, 3013
Lasonic.....	3087
Magnavox.....	3004, 3036
Memorex.....	3037
Mintek.....	3038
Mitsubishi.....	3005
NAD.....	3032
Norcent.....	3039, 3040
Onkyo.....	3041
Oritron.....	3047
Panasonic.....	3014
Philips.....	3004, 3020
Pioneer.....	3006, 3043, 3044, 3045
Proscan.....	3000, 3035, 3046, 3048

Remote Control Codes

DVD Codes (continued)

Qwestar.....	3047
RCA.....	3000, 3002, 3079, 3086
Samsung.....	3072, 3073, 3074, 3080
Sansui.....	3049
Sanyo.....	3015, 3082
Sharp.....	3050, 3052, 3053
Sony.....	3007, 3016, 3017, 3054, 3055, 3056, 3083
Sylvania.....	3033
Teac.....	3057
Technics.....	3058
Toshiba.....	3008, 3018, 3059, 3060, 3061
Zenith.....	3019, 3065, 3084

Portable DVD

Audiovox.....	3025, 3026
RCA.....	3066
Sharp.....	3051

Home-Theater-In-A-Box (HTIB) Codes

	Audio	DVD
JBL.....	4031.....	3088
JVC.....	4032.....	3089
Koss.....	4033.....	3085, 3090
Onkyo.....	4034.....	3091
Panasonic.....	4035.....	3092
Pioneer.....	4036.....	3093
RCA.....	4037.....	3094
Venturer.....	4038.....	3095

PVR Codes

RePlay.....	2086
Tivo.....	2085

Satellite Receiver Codes

Alphastar.....	5064
Chaparral.....	5046, 5047
Dishnet.....	5063
Drake.....	5048, 5049
EchoStar.....	5070
GE.....	5000, 5001, 5072
General Instruments.....	5050, 5051, 5052
Hitachi.....	5066, 5067
Hughes Network Systems.....	5062, 5071
JVC.....	5065
Panasonic.....	5060
Philips.....	5068
Primestar.....	5061

Proscan.....	5000, 5001, 5072
RCA.....	5000, 5001, 5072
Realistic.....	5053
Sony.....	5058
STS1.....	5054
STS3.....	5055
STS4.....	5056
Toshiba.....	5057, 5059
Uniden.....	5069

TV Codes

Admiral.....	1002, 1097, 1118
Aiko.....	1015
Akai.....	1003
Amtron.....	1026
Anam National.....	1004, 1026, 1110, 1111, 1112
AOC.....	1005, 1006, 1007, 1099, 1100, 1113
Apex.....	1140, 1148, 1150
Audiovox.....	1026
Bell & Howell.....	1002, 1029, 1045
Broksonic.....	1143, 1151
Celebrity.....	1003
Centurion.....	1009
Citizen.....	1005, 1007, 1008, 1015, 1026, 1045, 1063, 1095, 1119
Colortyme.....	1005, 1007, 1010
Contec/Cony.....	1011, 1012, 1013, 1026
Craig.....	1026
Crown.....	1026, 1038
Curtis Mathes.....	1001, 1005, 1007, 1014, 1029, 1045, 1063, 1095, 1119, 1130, 1157
Daewoo.....	1005, 1006, 1007, 1015, 1016, 1017, 1080, 1095, 1108
Daytron.....	1005, 1007, 1095
Dimensia.....	1001, 1130, 1157
Dumont.....	1005, 1084
Electroband.....	1003
Electrohome.....	1003, 1004, 1005, 1007, 1018, 1019, 1020
Emerson.....	1005, 1007, 1011, 1021, 1022, 1023, 1024, 1025, 1026, 1027, 1029, 1045, 1078, 1095, 1101, 1102, 1109, 1127, 1131, 1138
Envision.....	1005, 1007
Fisher.....	1028, 1029, 1030, 1045, 1103
Fujitsu.....	1027
Funai.....	1026, 1027
GE.....	1000, 1001, 1004, 1005, 1007, 1020, 1031, 1032, 1054, 1104, 1120, 1130, 1132, 1157, 1158
Goldstar.....	1005, 1006, 1007, 1011, 1018, 1033, 1034, 1035, 1087, 1088, 1095, 1096
Hallmark.....	1005, 1007
Hisense.....	1141
Hitachi.....	1005, 1007, 1011, 1012, 1013, 1036, 1037, 1102, 1126, 1134, 1135, 1136, 1137, 1138

Infinity.....	1038
Janeil.....	1098
JBL.....	1038
JC Penney.....	1001, 1005, 1006, 1007, 1008, 1012, 1020, 1031, 1032, 1034, 1035, 1044, 1054, 1062, 1063, 1081, 1095, 1096, 1104, 1130, 1132, 1147, 1157
Jensen.....	1005, 1007
JVC.....	1011, 1012, 1013, 1032, 1037, 1039, 1089, 1090, 1105, 1127, 1146
Kawasho.....	1003, 1005, 1007
Kenwood.....	1005, 1007, 1018
Kloss Novabeam.....	1026, 1040, 1041, 1098
KTV.....	1026, 1042, 1095, 1101
LG.....	1006
Loewe.....	1038
Logik.....	1002
Luxman.....	1005, 1007
LXI.....	1001, 1007, 1029, 1038, 1043, 1044, 1045, 1104, 1116, 1130, 1132, 1147, 1157
Magnavox.....	1005, 1007, 1008, 1018, 1038, 1040, 1041, 1046, 1047, 1048, 1055, 1082, 1083, 1124, 1125, 1129, 1139
Majestic.....	1002
Marantz.....	1005, 1007, 1036, 1038, 1049
Megatron.....	1007, 1036
Memorex.....	1002, 1006, 1007, 1029, 1045
MGA.....	1005, 1006, 1007, 1018, 1020, 1030, 1050, 1051
Mitsubishi.....	1005, 1006, 1007, 1018, 1020, 1030, 1050, 1051, 1052, 1079
Montgomery Ward.....	1002
Motorola.....	1004, 1097
MTC.....	1005, 1006, 1007, 1063
Multitech.....	1026
NAD.....	1007, 1043, 1044, 1106, 1126, 1147
NEC.....	1004, 1005, 1006, 1007, 1008, 1011, 1018, 1038, 1040, 1041, 1046, 1048
Nikko.....	1007, 1015
Onwa.....	1026
Optimus.....	1106, 1126
Optonica.....	1061, 1097
Orion.....	1025, 1109
Panasonic.....	1004, 1032, 1038, 1094, 1121, 1128, 1152, 1153
Philco.....	1004, 1005, 1006, 1007, 1008, 1011, 1018, 1038, 1040, 1041, 1046, 1048
Philips.....	1004, 1005, 1008, 1011, 1018, 1038, 1040, 1041, 1046, 1053, 1054, 1055, 1056
Pioneer.....	1005, 1007, 1057, 1058, 1059, 1102, 1106, 1126, 1138
Portland.....	1005, 1006, 1007, 1015, 1095
Price Club.....	1063
Prima.....	1142
Prism.....	1032
Proscan.....	1000, 1001, 1104, 1130, 1132, 1157, 1158
Proton.....	1005, 1007, 1011
Quasar.....	1004, 1032, 1042, 1060, 1121
Radio Shack.....	1029, 1045, 1130, 1157

Remote Control Codes

Radio Shack/Realistic	1001, 1005, 1007, 1011, 1026, 1029, 1045, 1061, 1095, 1096
RCA	1000, 1001, 1004, 1005, 1006, 1007, 1018, 1102, 1104, 1108, 1130, 1132, 1138, 1144, 1155, 1157, 1158
Realistic	1029, 1045, 1130, 1157
Runco	1084
Sampo	1005, 1007, 1095, 1096, 1156
Samsung	1005, 1006, 1007, 1011, 1014, 1018, 1062, 1063, 1064, 1095, 1096, 1114, 1133
Sansui	1109, 1149
Sanyo.....	1005, 1028, 1029, 1045, 1051, 1065, 1066, 1093, 1103
Scott	1005, 1007, 1011, 1021, 1025, 1026, 1027
Sears	1001, 1005, 1007, 1012, 1013, 1018, 1027, 1028, 1029, 1030, 1039, 1043, 1044, 1045, 1067, 1068, 1103, 1104, 1107, 1130, 1132, 1147, 1157
Sharp	1005, 1007, 1011, 1022, 1023, 1061, 1069, 1070, 1071, 1077, 1095, 1097
Signature	1002, 1072
Sony	1003, 1115, 1122, 1123
Soundesign	1005, 1007, 1008, 1026, 1027
Starlite	1026
Supre-Macy	1098
Sylvania	1005, 1007, 1008, 1018, 1038, 1040, 1041, 1046, 1047, 1048, 1055, 1073, 1092, 1154
Symphonic	1024, 1026, 1107
Tandy	1097
Tatung	1004
Technics	1032
Techwood	1005, 1007, 1032
Teknika	1002, 1005, 1006, 1007, 1008, 1011, 1012, 1013, 1015, 1026, 1027, 1047, 1063, 1094, 1095, 1121, 1128
Telecaption	1074
Toshiba	1029, 1043, 1044, 1045, 1063, 1067, 1074, 1075, 1091, 1092, 1145, 1147
Totevision	1095
Universal	1031, 1054
Wards	1001, 1002, 1005, 1006, 1007, 1018, 1021, 1024, 1027, 1031, 1038, 1040, 1041, 1046, 1047, 1054, 1055, 1061, 1076, 1130, 1157
Yamaha	1005, 1006, 1007, 1018
Zenith	1002, 1005, 1084, 1085, 1086, 1117

VCR Codes

Admiral.....	2068
Aiko	2023
Aiwa	2022
Akai	2002, 2003, 2004, 2057, 2058, 2059
Audiovox.....	2010
Bell & Howell	2007
Broksonic	2008, 2021, 2075
Calix	2010
Canon	2017, 2018
Capehart	2016, 2056

Carver.....	2037
CCE	2023, 2036
Citizen	2009, 2010, 2011, 2012, 2013, 2014, 2015, 2023
Colortyme	2005
Craig	2009, 2010, 2019, 2036
Curtis Mathes	2005, 2009, 2012, 2014, 2017, 2018, 2020, 2060
Daewoo.....	2011, 2013, 2015, 2021, 2022, 2023, 2056
Daytron	2056
Electrohome	2010, 2024
Emerson	2002, 2008, 2010, 2011, 2017, 2020, 2021, 2022, 2024, 2025, 2026, 2027, 2028, 2039, 2059, 2061, 2067, 2069, 2076
Fisher.....	2007, 2019, 2029, 2030
Fuji.....	2003, 2017, 2062
Funai	2022
Garrard	2022
GE	2000, 2001, 2009, 2017, 2018, 2060, 2063, 2072, 2073
Go Video.....	2074, 2077
Goldstar.....	2005, 2010, 2014, 2032, 2035
Gradiente	2022
Harman Kardon	2005
Harwood	2036
Hitachi	2033, 2034, 2035, 2053, 2057, 2063
JC Penney	2005, 2006, 2007, 2008, 2009, 2010, 2017, 2018, 2030, 2033, 2034, 2036, 2037, 2053
Jensen	2033, 2034, 2057
JVC	2005, 2006, 2007, 2014, 2057, 2064, 2078
Kenwood	2005, 2006, 2007, 2012, 2014, 2057, 2064
KLH	2036
Kodak	2010, 2017
LG	2010
Logik	2036
LXI	2010
Magnavox.....	2017, 2018, 2037, 2038, 2052, 2054, 2065
Marantz	2005, 2006, 2007, 2012, 2014, 2017, 2037
Matsushita	2017
Memorex	2007, 2009, 2010, 2017, 2019, 2022, 2052, 2068
MGA	2024, 2039, 2059
Minolta	2033, 2034, 2053
Mitsubishi.....	2024, 2033, 2034, 2039, 2040, 2041, 2059, 2064
Montgomery Ward	2068
Motorola	2017, 2068
MTC	2009
Multitech	2009, 2012, 2022, 2031, 2036
NEC	2005, 2006, 2007, 2012, 2014, 2057, 2064
Nikko.....	2010
Noblex	2009
Olympus.....	2017
Optimus	2010, 2068
Optonica	2047
Panasonic.....	2017, 2018, 2055, 2066
Pentax	2012, 2033, 2034, 2053, 2063
Pentex Research	2014
Philco	2017, 2018, 2037, 2038

Philips	2017, 2037, 2047, 2065
Pioneer.....	2006, 2033, 2042, 2064
Portland.....	2012, 2013, 2015, 2056
Proscan.....	2000, 2001, 2072, 2073
Quasar	2017, 2018, 2066
Radio Shack	2010, 2047, 2068
Radio Shack/Realistic	2007, 2009, 2010, 2017, 2018, 2019, 2022, 2024, 2029, 2047
Radix	2010
RCA	2000, 2001, 2002, 2009, 2017, 2033, 2034, 2043, 2044, 2045, 2053, 2060, 2063, 2066, 2070, 2072, 2073, 2079
Realistic	2007, 2009, 2010, 2011, 2017, 2018, 2019, 2022, 2024, 2029, 2047, 2068
Ricoh	2071
Runco	2052
Samsung.....	2004, 2009, 2011, 2027, 2031, 2058, 2080, 2081
Sansui	2006, 2046, 2057, 2064
Sanyo.....	2007, 2009, 2019, 2082
Scott	2008, 2011, 2021, 2026, 2028, 2039, 2061
Sears	2007, 2010, 2017, 2019, 2029, 2030, 2033, 2034, 2053
Sharp	2013, 2024, 2047, 2048, 2068
Shintom	2003, 2034, 2036, 2049
Signature	2068
Singer	2017, 2036, 2071
Sony	2003, 2049, 2050, 2062, 2083
STS.....	2017, 2053
Sylvania.....	2017, 2018, 2022, 2037, 2038, 2039, 2065
Symphonic	2022
Tandy	2007
Tashiko.....	2010
Tatung	2057
Teac	2022, 2057
Technics	2017, 2055
Teknika	2010, 2017, 2022, 2051
Toshiba.....	2011, 2029, 2030, 2033, 2039, 2059
Totevision.....	2009, 2010
Unitech.....	2009
Vector Research	2005, 2006, 2011, 2012
Video Concepts	2005, 2006, 2011, 2012, 2059
Wards	2009, 2010, 2011, 2017, 2019, 2022, 2024, 2033, 2034, 2036, 2047, 2053, 2061, 2068, 2070
XR-1000.....	2017, 2022, 2036
Yamaha	2005, 2006, 2007, 2014, 2057
Zenith	2003, 2049, 2052, 2062, 2071, 2084

Troubleshooting

Many problems you encounter with your MediaBridge can be resolved by consulting the following troubleshooting list.

Network problems

No connection to the wireless network.

Check to make sure the wireless antenna is properly attached to the back of the MediaBridge.

Also, check the “link” indicator on the front panel of the MediaBridge. If the “link” indicator is not lit, the MediaBridge has not obtained an IP address. Check your router and network settings.

The MediaBridge displays duplicate wireless network names.

Wireless access points come configured with a default wireless network name. For example, wireless routers and access points made by Linksys default to “linksys” as the network name. If the MediaBridge is displaying duplicate names, it is receiving a wireless signal from two different routers which happen to use identical names. Change the name of your wireless network, or try both networks.

Unsure which wireless network is yours.

Your wireless access point or wireless router determines the name of your wireless network. Refer to the manual of your access point or router to determine the network name (also called the SSID).

The MediaBridge can't find one of the computers in my network.

If VPN (Virtual Private Network) software is installed on a computer in your network, the MediaBridge may not be able to see that computer. The MediaBridge is not designed to work with VPN software.

Firewall problems

All of the MediaBridge media libraries are empty.

If you have firewall software installed on your network, you may need to reconfigure that firewall software to allow the MediaBridge to access your network computers.

The MediaBridge software setup installs a background program on your computer(s) called “MediaStreamer.exe.” It is safe to allow this program to operate on the network. If the MediaStreamer program is blocked, the MediaBridge will not see any computers on the network, so the MediaBridge’s media libraries will be empty.

If you’re still having problems getting the MediaBridge to work with your firewall software, try making the following adjustments to your firewall settings:

- Port 6070 must be open for UDP-type network traffic.
- Port 40001 must be open for TCP-type network traffic.
- Port 40002 must be open for TCP-type network traffic.

Troubleshooting

Remote control problems

Unit does not respond to remote.

Make sure the remote is in the right “mode” to control the MediaBridge: press the MEDIA button, then try using the remote with the MediaBridge.

If that doesn't work, check the following items:

- Make sure the batteries in the remote are fresh.
- Point the remote directly at the remote sensor on the front panel of the MediaBridge.
- Make sure the path between the remote control and the MediaBridge is clear.
- Try moving closer to the MediaBridge.

If the MediaBridge still does not respond, press the power button on the MediaBridge front panel to turn the MediaBridge off. Wait a minute or two, then press the power button on the front panel of the MediaBridge again to turn the MediaBridge on.

If the MediaBridge does not turn off, unplug the AC power cord from the wall outlet and wait a minute or two. Then, plug the unit back in and turn it back on.

MediaBridge problems

The MediaBridge power button doesn't turn the unit off.

Unplug the AC power cord from the wall outlet and wait a minute or two. Then, plug the unit back in and turn it back on.

USB device problems

The MediaBridge can't find my USB device.

It might take the MediaBridge a few moments to recognize and scan your USB device once you've connected it to the USB port.

If you're connecting an RCA Lyra to the MediaBridge using a USB connection, make sure the Lyra's USB Protocol is set to *Mass Storage Class*.

Please note that USB devices should be formatted as *NTFS* or *FAT32* in order for the MediaBridge to play files from them. If your USB device is not recognized by the MediaBridge, check its formatting type.

Not all USB devices are compatible with the MediaBridge. The MediaBridge recognizes only certain kinds of USB devices: USB thumb drives, USB memory card readers, and USB hard drives.

Media library problems

Files recently saved on networked media source don't appear on MediaBridge.

You may need to refresh the MediaBridge's browser.

First, press the HOME button on the MediaBridge's remote. From the main menu, select the library you want to browse. Then, look for the recently saved files again.

If these files still don't show up in the library, wait about 60 seconds and press the HOME button again. From the main menu, select the library you want to browse. Then, look for the recently saved files again.

If you still don't see the recently saved files in the library, restart the MediaBridge and browse the media library again.

If you still have trouble viewing files, make sure your files match the supported formats (see "My images, music files, or video files won't play or display").

File problems

My images, music files, or video files won't play or display

Make sure the MediaBridge supports the file format or encoding you're trying to play. The MediaBridge may not support all music and movie files purchased from online music or movie sites.

The MediaBridge supports the following types of file formats and codecs (in the next column):

File Container Formats

- MPEG Program (ISO 11172-1 and ISO/IEC 13818-1)
- MPEG Transport (ISO/IEC 13818-1)
- AVI (DivX® 3, 4, 5; DivX HD, XviD, MJPEG, DV Type 2)
- ASF, WMV (Windows Media® Video)
- ASX, WMA (Windows Media® Audio), MP3, WAV, M4A
- IFO, VOB

Video Codecs

- MPEG1 (ISO 11172-2) • MPEG2 (ISO 13818-2)
- MPEG4 (ISO/IEC 14496-2) • DV (requires wired link)
- MJPEG (requires wired link) • WMV (V7, V8 Partial, V9) (non-drm)

Audio Codecs

- MPEG1/2 Layers 1,2 and 3 (MP3) (ISO 11172-3)
- SPDIF passthru for Dolby® Digital and DTS® audio
- WMA (Standard, Pro and Lossless) (non-drm)
- WAV (LPCM)
- AAC (except for protected files from the iTunes® music store)

Image Formats

- JPEG w/ JFIF (ISO DIS10918-1) • BMP
- PNG (ISO 15948:2003) • Uncompressed TIFF

If higher-definition video does not play back over a wireless connection, try a wired connection.

DivX is a registered trademark of DivX Networks, Inc.

iTunes is a registered trademark of Apple Computer, Inc.

Windows Media is a registered trademark of the Microsoft Corporation in the United States and/or other countries.

Manufactured under license from Dolby Laboratories. "Dolby" and the double-D symbol are trademarks of Dolby Laboratories.

DTS is a registered trademark of Digital Theater Systems, Inc.

Troubleshooting

I can't hear the audio from my movie.

If the movie you're playing on the MediaBridge has multichannel audio, audio will only be available from the digital audio outputs. There will be no audio signal from the MediaBridge's other audio outputs.

To hear multichannel audio, use one of the MediaBridge's digital audio outputs to connect it to multichannel-capable receiver.

There's a red exclamation mark next to one of the video or picture files in my library.

The MediaBridge displays a red exclamation mark next to video or picture files it has tried unsuccessfully to play.

The red exclamation mark means that the MediaBridge cannot play that particular file. There are several possible reasons for this—the file may have a name that the MediaBridge has trouble recognizing, or the file may be corrupt.

Please note that Windows Media Center Edition PCs use a proprietary file format for recording, and the MediaBridge cannot play these files.

Display problems

Only the "AR" (Acoustic Research) screen appears when I turn on the MediaBridge. I don't see the main menu.

Make sure the SD/HD switch on the back of the MediaBridge is set to the right position for the type of connection you're using between the MediaBridge and your TV or monitor.

If you used the MediaBridge's VIDEO or S-VIDEO output jacks, set the SD/HD switch to SD.

If you used the MediaBridge's DVI output jack, set the SD/HD switch to HD.

If you used the MediaBridge's COMPONENT VIDEO jacks, set the SD/HD switch to match the kind of TV or monitor you have: SD for a standard-definition monitor or HD for a high-definition monitor.

Troubleshooting

Picture Appears, But Colors Are Wrong.

- If using an S-Video or a VGA connection, ensure that the cables are firmly connected to both the MediaBridge and the display.
- If using a component video connection, unplug each of the three (red, green, blue) connectors from the MediaBridge and verify that the color of the plug matches the color of the connector on the MediaBridge. Swapping the red and blue connectors accidentally will result in improper color display. If this does not solve the problem, do the same check on the display connectors.
- You may have a defective cable. Try another cable of the same type.

Problems going between media types

I am viewing images and would now like to listen to music. How do I go back to the Music Player?

Press the MUSIC button on the remote to access the Music Media Library. Use the arrow buttons and OK to browse through the library and choose the song(s) you want to hear.

To listen to music and view images at the same time, see the next troubleshooting item.

I am listening to music and would like to view images. How do I go back to the Picture Viewer?

With your music playing, press the PICS button on the remote to access the Pictures Media Library. Use the arrow buttons and OK to find the picture(s) you want to view (even in slideshow mode).

If you would like to view images without listening to music, press PAUSE while you're viewing the slideshow/pictures. Then, press MUSIC and press STOP while the Music Media Library is on the screen. Press PICS and then select *Resume Slideshow* to return to the pictures/slideshow.

Limited Warranty

Media Bridge LIMITED WARRANTY

What your warranty covers:

- Any defect in materials or workmanship.

For how long after your purchase:

- 1 Year - Unit exchange, which includes parts and labor.

What we will do:

- Exchange the defective portion of your Media Bridge with a new or, at our option, refurbished unit.

How you get service:

- Call 1-800 464 7022 and have your unit's date of purchase and model/serial number ready. The model/serial number information is on the back or bottom of your unit.
- A representative will troubleshoot your problem over the phone.
- If the representative determines that you should receive a replacement unit you will be provided with a Service Request (SR) number and instructions on how to obtain the exchange. No returns will be accepted without the SR number.

What your warranty does not cover:

- Acts of nature, such as but not limited to lightning damage.
- Damage from misuse or neglect.

- A unit that has been modified or incorporated into other products or is used for institutional or other commercial purposes.
- Batteries.
- Installation.
- Shipping damage if the unit was not packed and shipped in the manner prescribed by Thomson.

Product Registration:

- Please complete and mail the Product Registration Card packed with your unit. It will make it easier to contact you should it ever be necessary. The return of the card is not required for warranty coverage.

Limitation of Warranty:

- **THE WARRANTY STATED ABOVE IS THE ONLY WARRANTY APPLICABLE TO THIS PRODUCT. ALL OTHER WARRANTIES, EXPRESS OR IMPLIED (INCLUDING ALL IMPLIED WARRANTIES OF MERCHANTABILITY OR FITNESS FOR A PARTICULAR PURPOSE) ARE HEREBY DISCLAIMED. NO VERBAL OR WRITTEN INFORMATION GIVEN BY THOMSON INC., ITS AGENTS OR EMPLOYEES SHALL CREATE A WARRANTY OR IN ANY WAY INCREASE THE SCOPE OF THIS WARRANTY.**

Limited Warranty

- **REPAIR OR REPLACEMENT AS PROVIDED UNDER THIS WARRANTY IS THE EXCLUSIVE REMEDY OF THE CONSUMER. THOMSON INC. SHALL NOT BE LIABLE FOR INCIDENTAL OR CONSEQUENTIAL DAMAGES RESULTING FROM THE USE OF THIS PRODUCT OR ARISING OUT OF ANY BREACH OF ANY EXPRESS OR IMPLIED WARRANTY ON THIS PRODUCT. THIS DISCLAIMER OF WARRANTIES AND LIMITED WARRANTY ARE GOVERNED BY THE LAWS OF THE STATE OF INDIANA. EXCEPT TO THE EXTENT PROHIBITED BY APPLICABLE LAW, ANY IMPLIED WARRANTY OF MERCHANTABILITY OR FITNESS FOR A PARTICULAR PURPOSE ON THIS PRODUCT IS LIMITED TO THE APPLICABLE WARRANTY PERIOD SET FORTH ABOVE.**

How state law relates to warranty:

- Some states do not allow the exclusion nor limitation of incidental or consequential damages, or limitations on how long an implied warranty lasts, so the above limitations or exclusions may not apply to you.
- This warranty gives you specific legal rights, and you also may have other rights that vary from state to state.

If you purchased your product outside the United States:

- This warranty does not apply. See your dealer for warranty information.

The MediaBridge PC application, user's guide, and warranty are available for download at www.acoustic-research.com. All open-source GPL code that has been modified is also available at that website.

Thomson Inc.
10330 North Meridian Street
Indianapolis, IN 46290

© 2005 Thomson Inc.
Trademark(s) Registered
Marca(s) Registrada(s)

Printed in China

TOCOM 1662616C