

Tips and Tricks



Using voice commands

Press and hold the microphone button and say things like:

- “Play classic rock.”
- “Search for comedies.”
- “Launch The Roku Channel.”



Where to place your Roku Touch

Place it within listening distance of your speakers, like on a kitchen counter or entryway table.



Play music via Bluetooth®

- Turn your Roku TV on.
- Press and hold  on your remote for 5 seconds.
- Select **Bluetooth** in the menu, then follow the on-screen instructions.



Program a preset on Roku Touch

- Use the microphone button to say a command like “Play classic rock.”
- Press and hold a preset button, until you hear a tone to save the command.

For more, visit: [Go.roku.com/roktvspeakers](https://go.roku.com/roktvspeakers)

Need more help getting started?

go.roku.com/roktvspeakers



Video tutorials



Wireless help

Find tips, free trials and more.

blog.roku.com



Roku Blog



© 2018 Roku, Inc. All rights reserved. ROKU, ROKU TV, ROKU TOUCH and the ROKU logo are the trademarks or registered trademarks of Roku, Inc. All other trademarks and logos herein are the property of their respective owners.

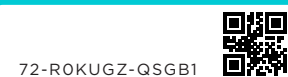

Just wait until you hear this

Roku TV™ Wireless Speakers Quick Start Guide

Get ready for premium sound with

Roku TV™ Wireless Speakers

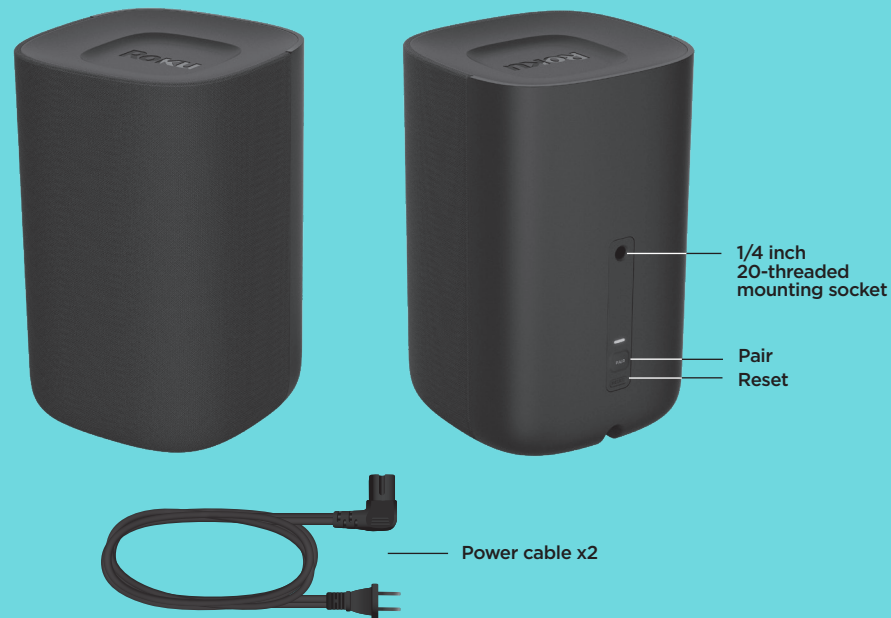

TV and speaker control with your new
Roku TV Voice Remote

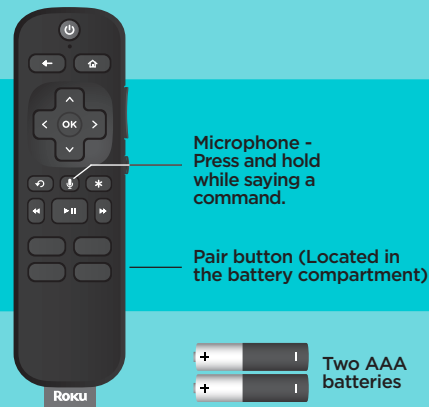

Plus, control music on your speakers from nearby with
Roku Touch™ tabletop remote

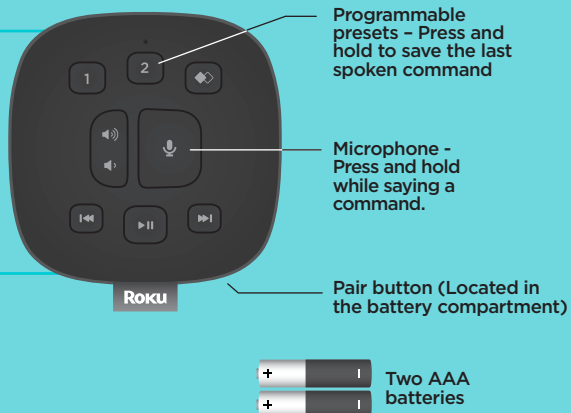

What you'll need

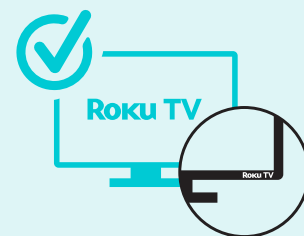

To get set up, you'll need:

- A Roku TV, connected to the internet
- Your existing Roku TV remote



Only works with Roku TV, not other TVs or Roku players.

Setup

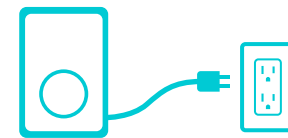

1. Power up your speakers

- Place your speakers to the left and right of your TV.
- Plug them into a power outlet.



2. Prepare your TV

- Turn on your Roku TV with your existing remote.
- Press and hold  for 5 seconds to get to the pairing menu.
- Select **Speaker**.

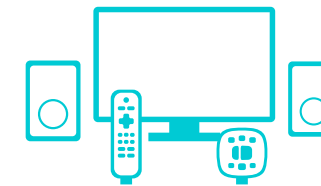

3. Follow the on-screen setup

- Your TV will automatically detect your speakers and begin pairing.
- Continue setup to pair both new remotes. You can keep your existing remote as a backup.

Enjoy your Roku TV
Wireless Speakers.



For returns, keep original packaging

Pack your Roku TV™ Wireless Speakers and accessories in their original packaging to help prevent damage.

[go.roku.com/returnpolicy](https://www.roku.com/returnpolicy)

Roku TV™ Wireless Speakers (“Speakers”, an Audio Device), including Roku Touch™ Tabletop Remote (“Controller”) and Roku TV Remote (“Remote”), collectively the “Product”

The Controller is compatible with Roku TVs that are running Roku® Operating System 8.2 or higher. The Controller may also be compatible with current generation Roku players. The Remote is compatible with most Roku TVs and players. For a list of current compatible TVs and players and their specific applicable features, visit [go.roku.com/rokovspeakers](https://www.roku.com/rokovspeakers).

Please read and keep all safety and use instructions.

Important Product Information Safety Precautions

Any electrical device, if used improperly, has the potential for causing fire, electrical shock, property damage or personal injury. To help ensure accident-free and enjoyable operation, follow these guidelines:

- Observe all warnings, precautions and instructions.
- Observe all signs and displays that require an electrical device or RF radio product to be switched off in designated areas.
- For more information on product safety and troubleshooting, please go to www.roku.com/support.

Use and Handling

- The Speakers contain magnetic material. Contact your physician if you have questions on whether this might affect the operation of your implantable medical device.
- The Product is not a toy. Keep out of reach of children.
- The Product packaging may include plastic bags, cable ties and fasteners. Dispose of these properly and keep them out of reach of children, as they could present a choking hazard.
- The Product should not be exposed to dripping, spraying, or splashing.
- Do not submerge in water or allow liquid to get into the Product.
- Do not touch the Speakers or connected cables during an electrical storm.

- Do not allow small particles or other foreign objects to get into the Product.
- Do not expose the Product to high temperatures, high humidity, direct sunlight, heat sources, smoke or steam.
- Do not place naked flame sources, such as lighted candles, on or near the Product.
- Do not place anything on top of your Speakers (except for the intended authorized Controller) or cover or place the Product in an enclosed cabinet or on a soft surface; it may cause the Product to get hot or overheat.
- Do not drop, crush or disassemble the Product.
- Do not clean with ammonia based cleaner. Use a soft, dry cloth.
- Do not place Speakers directly on oil or wax based wood finished surfaces.
- Do not attempt to repair the Product yourself. Disassembling the Product may cause damage not covered by the warranty.
- Use intended for indoors only.
- Dispose of the Product according to local standards and regulations.

Class II Equipment

This device meets the safety requirements specified for Class II equipment.



Important Tips About Battery Handling

Replacing batteries: Always replace dead batteries with two brand-new batteries from the same battery manufacturer. Never use damaged batteries.

Disposal of batteries: Always dispose of batteries following federal guidelines or local ordinances. Do not dispose of used batteries in an open fire.

Warning Signs: If your Product gets warm/hot during use, discontinue use and contact Roku Customer Support immediately at www.roku.com/support. There is a risk of explosion if a battery is replaced by an incorrect type.

The License Agreement

Use of the Product constitutes your agreement to the software license terms for the Product at www.roku.com/legal and the limited warranty set forth below for your country. If you disagree and you are within the allowable time period for returns under the return policy applicable to your Product, you may return the Product to the place where you obtained it for a refund, subject to the terms of the applicable return policy.

Limited Warranty & Warranty Service Process

Limited Warranty

For any Product purchased and delivered to end users in the US, go to www.roku.com/support for the warranty terms and conditions. You may also request a copy of such terms by mail by contacting us at 150 Winchester Circle, Los Gatos, CA 95032.

Additional Legal Notices

Federal Communication Commission Interference Statement

This equipment has been tested and found to comply with the limits for a Class B digital device, pursuant to Part 15

of the FCC Rules. These limits are designed to provide reasonable protection against harmful interference in a residential installation. This equipment generates, uses and can radiate radio frequency energy and, if not installed and used in accordance with the instructions, may cause harmful interference to radio communications. However, there is no guarantee that interference will not occur in a particular installation. If this equipment does cause harmful interference to radio or television reception, which can be determined by turning the equipment off and on, the user is encouraged to try to correct the interference by one of the following measures:

- Reorient or relocate the receiving antenna.
- Increase the separation between the equipment and receiver.
- Connect the equipment into an outlet on a circuit different from that to which the receiver is connected.
- Consult the dealer or an experienced radio/TV technician for help.

This device complies with Part 15 of the FCC Rules.

Operation is subject to the following two conditions: (1) This device may not cause harmful interference, and (2) this device must accept any interference received, including interference that may cause undesired operation.

FCC Caution: Any changes or modifications not expressly approved by Roku, Inc. could void the user's authority to operate this equipment.

IMPORTANT NOTE:

FCC Radiation Exposure Statement: This equipment complies with FCC radiation exposure limits set forth for an uncontrolled environment. This equipment should be installed and operated with a minimum distance of 20 cm between the radiator and your body. This transmitter must not be co-located or operating in conjunction with any other antenna or transmitter. The availability of some specific channels and/or operational frequency bands are country dependent and are firmware programmed at the factory to match the intended destination. The firmware setting is not accessible by the end user.

Copyright © 2018 Roku, Inc. All rights reserved.

End User License Agreement (FOR AUDIO DEVICE)

IMPORTANT: READ THIS END USER LICENSE AGREEMENT CAREFULLY BEFORE USING YOUR AUDIO DEVICE. ALSO REVIEW THE IMPORTANT PRODUCT INFORMATION THAT MAY HAVE BEEN PROVIDED WITH YOUR AUDIO DEVICE.

Overview

This End User License Agreement (“EULA”) governs your use of: (a) your audio device which uses the Roku platform to play digital content over the Internet (“**Audio Device**”), and (b) any firmware and software that Roku, Inc. (“**Roku**”) has pre-installed on the Audio Device, and the firmware

and software updates Roku provides to you for the Audio Device (collectively, the “**Software**”). By linking the Audio Device to your account on Roku's website (“**Roku Account**”) or pairing the Audio Device with other Roku device(s) (individually or collectively, as the case may be, “**Roku Device**”), which may be linked to your Roku Account, or using the Audio Device, you are agreeing to this EULA. If you are a resident of the European Economic Area, by agreeing to this EULA, you expressly agree to waive your right to withdraw.

If you do not agree to this EULA, you do not have the right to use the Audio Device. If you are within the allowable time period for returns under the applicable return policy, you may return the Audio Device to your seller for a refund, subject to the terms of such return policy. You should perform a factory reset before you return it to erase data that may be stored on the Audio Device. For instructions on how to reset your Audio Device, please visit: www.roku.com/support.

In this EULA, “**Channel**” means an application in the Roku Channel Store; “**Content**” means movies, television shows, music and other audio and visual materials and entertainment; “**Content Provider**” means any provider of Content; and “**Roku Channel Store**” means the storefront of applications provided by Roku via Roku Device's on-screen menu.

Changes to This EULA

Roku may amend this EULA at any time at its discretion. Such amendments shall be effective immediately upon posting of the amended EULA on Roku's website or your Roku Account, whichever occurs first. In its option, Roku may also notify you of the amended EULA by sending a notice to the last email address you have provided to Roku. You agree to provide accurate and complete information if and when you set up your Roku Account, and you agree to promptly update your account information (including contact information) to keep it accurate and complete. You can do this at any time by signing in to your Roku Account. Following such posting or notice by any of the methods described above, continued use of your Audio Device or Roku Account means you accept and agree to the amended EULA. If you do not agree to the amended EULA, Roku may not be able to provide updates, upgrades or enhancements to your Audio Device, and you may not be able to continue using your Audio Device or Roku Account.

Permitted Use and Restrictions

The Audio Device and the Software are for personal, non-commercial use only. Copying or redistribution of any Content delivered via the Audio Device is strictly prohibited and we may prevent or restrict you from copying or re-distributing any elements of the Software or Content using digital rights management or other technologies. The Audio Device and the Software are for use only in those countries specified on Roku's website and where Roku makes the Audio Device and Software available via its authorized distributors. If you are using the Audio Device and the Software outside of these countries, the rights granted under this EULA do not apply. Some of

the Content Providers use technologies to verify your geographic location, and you may not be able to use the Audio Device or the Software to access any Content outside of the country or location authorized by Roku or the Content Provider. Except as expressly provided under this EULA, you do not acquire any intellectual property or other proprietary rights in or to the Audio Device, the Software or the Content, including any rights in patents, inventions, improvements, designs, trademarks, database rights or copyrights, nor do you acquire any rights in any confidential information or trade-secrets. All rights not expressly granted to you in this EULA are reserved by Roku or its applicable licensors. You may not remove, obscure, alter or conceal any trademark, logo, copyright or other proprietary notice in or on any Audio Device, Software or Content.

The Software is proprietary to Roku or its third party licensors and may be used only with the Audio Device. Subject to this EULA and, where appropriate, the applicable third party licenses, you have a non-exclusive, non-transferable license to run the Software and any updated versions provided to you by Roku, only in and as incorporated in the Audio Device. This is a license and not a sale. You may not (a) copy, assign, sublicense, lease, sell or rent the Software, (b) distribute or otherwise transfer the Software except as incorporated in the Audio Device, provided that, you do not retain any copies of the Software and the recipient reads and agrees to this EULA (including all amendments); (c) modify, adapt, translate, or create derivative works of the Software (except only to the extent any of the foregoing restriction is prohibited by applicable law or as may be permitted by the license terms governing any Separately Licensed Code included with the Software); (d) decompile, disassemble, reverse engineer or otherwise derive source code from the Software, except to the extent such actions cannot be prohibited under applicable law because they are essential to achieve inter-operability of the Software with another software program, and provided that the information obtained by you during such activities is (i) used only to achieve such inter-operability; (ii) not disclosed without Roku's prior written consent; and (iii) not used to create any software that is substantially similar to the Software; (e) defeat, bypass, circumvent or interfere with any security mechanism or access control measures; or (f) have any of the foregoing done for you by a third party. This license does not include the right to receive Software upgrades or updates. Your right to use the Software will immediately terminate upon your breach of this EULA.

Software Updates

In its sole discretion, ROKU MAY PROVIDE UPDATES TO YOUR AUDIO DEVICE VIA the internet, including BUG FIXES AND UPDATES, CHANGES IN THE USER INTERFACE OR HOW YOU ACCESS CONTENT, AND OTHER CHANGES THAT MAY add, ALTER or remove functionalities and features. You acknowledge that these updates: (a) may happen automatically in the background at any time (and that they cannot be disabled by You); and (b) will require an INTERNET CONNECTION and You may incur additional data charges from the provider of the INTERNET

CONNECTION. You understand that these updates are necessary to maintain compatibility with other updates to ROKU'S products or services and may be required for security reasons. By using the Audio Device, you hereby AGREE to receive such updates.

Separately Licensed Code

Certain software components of the Software are provided under separate third party license terms ("Separately Licensed Code") and your right to use such components is governed by such license terms. Please visit <https://www.roku.com/separatelylicensedcode> for more information.

Voice Services

If your Roku Device supports voice services in your country of residence, certain voice remote compatible with your Roku Device may allow you to use your voice to control your Roku Device (e.g., search for content, switch inputs, launch channels, launch Smart Guide). When you choose to use your voice to control your Roku Device, you agree that Roku and third parties who fulfill your requests and/or provide services for us have your consent to record, process and store your voice inputs (e.g., a recording and the interpretation of what was said), and use such voice inputs with other information about your Roku Device (e.g., device identifier) to provide services to you, to improve the accuracy and quality of the service, and as described in Roku's Privacy Policy. To learn more about voice services, visit the FAQ pages of Roku's website at www.roku.com/support.

WARRANTY DISCLAIMER; LIMITATION OF LIABILITY TO THE MAXIMUM EXTENT PERMITTED BY APPLICABLE LAW:

(A) EXCEPT FOR THE LIMITED PRODUCT WARRANTY ACCOMPANYING YOUR AUDIO DEVICE, THE SEPARATELY LICENSED CODE AND THE SOFTWARE ARE PROVIDED "AS IS", WITH ALL FAULTS AND WITHOUT WARRANTY OF ANY KIND. ROKU DISCLAIMS ALL OTHER WARRANTIES AND CONDITIONS, INCLUDING THE IMPLIED WARRANTY OF MERCHANTABILITY, SATISFACTORY QUALITY, FITNESS FOR A PARTICULAR PURPOSE AND NON-INFRINGEMENT. ROKU DOES NOT GUARANTEE, REPRESENT, OR WARRANT THAT THE AUDIO DEVICE, THE SEPARATELY LICENSED CODE AND THE SOFTWARE WILL BE: (I) SECURE, VIRUS-FREE OR ERROR-FREE, OR (II) FREE FROM ATTACK OR SECURITY INTRUSION. Some jurisdictions do not allow exclusions or limitations on implied warranties, so the foregoing limitations of warranties may not apply to You. You may also have other rights that vary from jurisdiction to jurisdiction.

(B) IN NO EVENT SHALL ROKU, ITS DIRECTORS, OFFICERS OR EMPLOYEES BE LIABLE TO YOU FOR PERSONAL INJURY OR PROPERTY DAMAGE, OR ANY SPECIAL, INCIDENTAL, EXEMPLARY, PUNITIVE, INDIRECT OR CONSEQUENTIAL DAMAGES OF ANY KIND ARISING OUT OF ANY AUDIO DEVICE, THE SEPARATELY LICENSED CODE, THE SOFTWARE, OR YOUR USE THEREOF; AND

(C) YOU AGREE THAT THE TOTAL CUMULATIVE LIABILITY OF ROKU, ITS DIRECTORS, OFFICERS AND EMPLOYEES UNDER THIS EULA, INCLUDING LIABILITY RELATING TO ALL AUDIO DEVICES LINKED TO YOUR ROKU ACCOUNT AND THE SEPARATELY LICENSED CODE AND THE SOFTWARE IN SUCH AUDIO DEVICES, AND YOUR USE THEREOF, SHALL NOT EXCEED THE AMOUNT SET FORTH IN THE ROKU ACCOUNT TERMS AND CONDITIONS YOU AGREED TO FOR YOUR ROKU ACCOUNT. THE FOREGOING LIMITATIONS SHALL APPLY EVEN IF THE REMEDY PROVIDED HEREIN FAILS ITS ESSENTIAL PURPOSE AND EVEN IF ROKU IS ITS DIRECTORS, OFFICERS OR EMPLOYEES HAVE BEEN ADVISED OF THE POSSIBILITY OF SUCH LIABILITY.

Some jurisdictions do not allow exclusions OF CERTAIN WARRANTIES OR LIMITATIONS OF LIABILITY FOR CERTAIN TYPES OF DAMAGES, SO SOME OF THE ABOVE LIMITATIONS IN THIS SECTION MAY NOT apply to You. NOTHING IN THESE TERMS OF USE SHALL AFFECT ANY NON-WAIVABLE STATUTORY RIGHTS THAT APPLY TO YOU, AND You may also have other rights that vary from jurisdiction to jurisdiction.

Export Controls

You agree not to download any Content or Software, nor otherwise export or re-export any Audio Device or the Software into (or to a national or resident of) Cuba, Iraq, Libya, North Korea, Iran, Syria or any other country as to which the United States or your country has embargoed goods, or to anyone on the U.S. Treasury Department's List of Specially Designated Nationals or the U.S. Commerce Department's Table of Denial Orders or on similar restricted lists published by your government from time to time. By using any Audio Device or the Software, you are representing and warranting that you are not located in, under the control of, or a national or resident of any such country or on any such list.

Choice of Law; Dispute Resolution

A. If you are a consumer and a resident in any country in the European Economic Area where Roku directly sells the Audio Device or expressly authorizes the sale of the Audio Device through its distribution channel, this EULA does not apply to you.

B. In all other cases, including if you are a resident of the United States (and its possessions and territories), Mexico or Canada, you agree that this EULA shall be governed by the laws of the State of California without regard to any conflict of laws principles that may provide the application of the law of another jurisdiction; and:

1. You and Roku agree to be bound by the procedures set forth below to resolve any and all claims arising out of or relating to any aspect of this EULA, whether based in contract, tort, statute, fraud, misrepresentation or any other legal theory, including but not limited to, claims related to the Audio Device and the Software. Each such claim is referred to individually as "**Claim**" and collectively as "**Claims**".

2. YOU AND ROKU AGREE THAT, EXCEPT FOR THE CLAIMS IDENTIFIED IN PARAGRAPH 4 OF THIS SECTION BELOW, ANY AND ALL CLAIMS SHALL BE FINALLY SETTLED BY BINDING ARBITRATION. The arbitration shall take place in Santa Clara County, California and shall be administered by the American Arbitration Association ("AAA") pursuant to the AAA's then-current rules, including (if applicable) the AAA's Supplementary Procedures for Consumer-Related Disputes. Please be aware there is no judge or jury in arbitration. Arbitration procedures are simpler and more limited than the rules applicable in court, and review of the arbitrator's decision by a court is limited. **YOU AND ROKU FURTHER AGREE THAT EACH OF YOU MAY BRING CLAIMS AGAINST THE OTHER ONLY ON AN INDIVIDUAL BASIS AND NOT AS A PLAINTIFF OR CLASS MEMBER IN ANY PURPORTED CLASS OR REPRESENTATIVE ACTION OR PROCEEDING. The arbitrator may not consolidate or join more than one person's claim and may not preside over any consolidated, representative or class proceeding. Also, the arbitrator may award relief (including monetary, injunctive or declaratory relief) only on an individual basis and may not award any form of consolidated, representative or class-wide relief.** Notwithstanding any provision in these terms to the contrary, if the class-action waiver in this provision is deemed invalid or unenforceable, or if an arbitration is allowed to proceed on a class basis, then neither you nor Roku are entitled to arbitrate the Claims. This arbitration provision is subject to the Federal Arbitration Act. The arbitrator's award shall be binding on you and Roku, and may be entered in any court of competent jurisdiction.

3. Information on AAA and how arbitration is initiated can be found at www.adr.org or by calling 800-778-7879. For Claims of \$75,000 or less, you will be responsible for the initial arbitration filing fee, up to the amount of the initial filing fee if you were to initiate a lawsuit against Roku based on such Claims in court. If the arbitrator finds such Claims to be non-frivolous, Roku will pay any difference in such filing fees plus the arbitrator fees. For Claims in excess of \$75,000, if you are able to demonstrate that the costs of arbitration will be prohibitive as compared to the costs of litigation, Roku will pay as much of your actual filing fees and the arbitrator fees for the arbitration as the arbitrator deems necessary to prevent the arbitration from being cost-prohibitive as compared to the cost of litigation.

4. This agreement to arbitrate does not apply to any Claim (a) in which a party is attempting to protect its intellectual property rights (such as its patent, copyright, trademark, trade secret, or moral rights, but not including its privacy or publicity rights), or (b) that may be brought in small-claims court.

5. If the agreement to arbitrate in this provision is found to be invalid, unenforceable or inapplicable to a given Claim, then any and all proceedings to resolve such Claim must be brought exclusively in a federal court of competent jurisdiction in the Northern District of California or in a state court in Santa Clara County, California. You hereby

irrevocably consent to the exclusive jurisdiction and venue of such courts.

6. 30-Day Right to Opt Out: You have the right to opt out of this agreement to arbitrate by sending a written notice of your decision to opt out to the following address: Legal Department, Roku, Inc., 150 Winchester Circle, Los Gatos CA 95032, USA; provided that, such notice must be postmarked on or before the 30th day after the date you create your Roku Account if you do not already have one. If you have an existing Roku Account, all devices you choose to link to your Roku Account, and all services provided by Roku which are accessed using these devices, will be subject to this agreement to arbitrate. Your notice should include your full name, your current postal address, telephone number and email address, the product name and serial number for your Audio Device, and a copy of the original proof of purchase for your Audio Device. If you timely send a notice in compliance with this paragraph 6, the agreement to arbitrate will not apply to either you or Roku. If you do not timely send this notice, then you agree to be bound by this agreement to arbitrate.

7. Notwithstanding any provision in this EULA to the contrary, you agree that, if Roku seeks to delete or materially modify the agreement to arbitrate described herein, any such deletion or modification will not apply to any individual Claim of which you have notified Roku prior to such modification.

Miscellaneous

Roku may transfer its rights and obligations under this EULA to another organization. You may only transfer your rights or your obligations under this EULA to another person if Roku agrees in writing. This EULA is between you and Roku. No other person shall have any rights to enforce these terms. Each of the paragraphs of this EULA operates separately. If any court or relevant authority decides that any of them are unlawful, the remaining paragraphs will remain in full force and effect. If Roku fails to insist that you perform any of your obligations under this EULA, or if Roku does not enforce its rights against you, or if Roku delays in doing so, that will not mean that Roku has waived its rights against you, or that you do not have to comply with those obligations. If Roku does waive a default by you, Roku will only do so in writing, but that will not mean that Roku will automatically waive any later default by you.

70-ROKUGZ-P1FB1



410000497_4