

Bluetooth Audio Stereo Dongle

Ancilla Duet

User's Manual

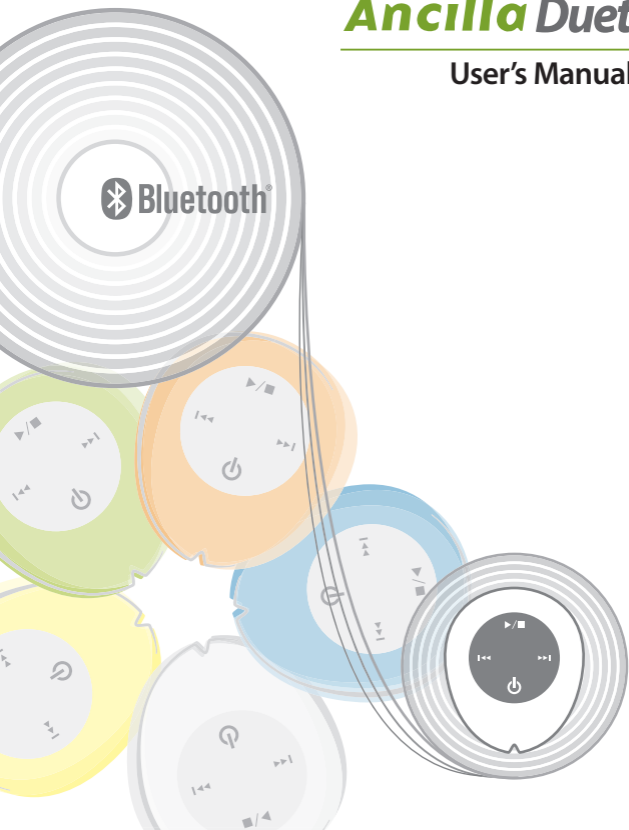

Ancilla Duet Features



Enjoy hi fidelity stereo sound!

With Duet you can listen to your favorite songs stored in Bluetooth devices on your home or car stereo.



Lose the cables!

With Bluetooth technology, Duet can be used wirelessly within a 10m (30ft) range setting you free from the cumbersome cables.



One touch switch!

Simply press the  button and Duet switches to the Bluetooth device of your choice. Duet can switch among 4 paired devices.

Table of Contents

▶ Getting Started

■ Safety Precautions	4
■ What is in your Duet package	6
■ Duet Overview	6
■ Button functions	7
■ Status LED	7
■ Setting-up Duet before use	8
■ Turning On/Off	9

▶ Using Duet

■ Pairing Duet with Bluetooth devices	10
■ Connecting Duet to Bluetooth devices	12
■ Switching among devices	13
■ Operating Duet	14

▶ Others

■ Troubleshooting	15
■ FCC	16
■ Warranty	17
■ Specifications	18



Safety Precautions

Take the following safety precautions when using Duet.



Do not disassemble, repair or alter Duet yourself.

► You risk electric shock and damaging the internal circuit board of Duet.



Make sure that no sharp-edged items such as knife, nails come into contact with Duet.



Avoid putting Duet and AC adapter in contact with water or liquid.

► You risk electric shock and damaging Duet. If Duet gets wet, make sure to unplug it and wipe off with a soft cloth immediately.



Use Duet with Bluetooth devices within a 10m (30ft) range.



Operate Duet in a place at temperatures between -10°C (14°F) and 50°C (122°F).



Keep away from children's reach.



Do not use the AC adapter if the cord or plug is exposed, damaged or loose.

➤ It may cause fire or electric shock.



Do not pull or bend the AC adapter cord excessively.

➤ It may cause electric shock.



Using Duet in proximity to RF emitting equipment (i.e., TV, wireless LAN, microwaves) may cause interference with Duet.



Do not use Duet in highly explosive areas as it may generate sparks.



Do not place any heavy items on Duet.

➤ It may cause malfunction or permanent damage.



Sound quality may differ from analog devices.



What is in your Duet package

Actual products may look different from the illustration shown below.



**Bluetooth Audio dongle
Ancilla Duet (1)**



AC Adapter (1)



Audio cable(1)



RCA cable(1)



User's manual (1)





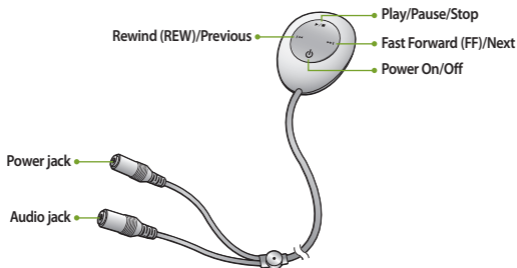

Duet Overview

- Status LED: indicates Duet status
- Power jack: plug the AC adapter
- Audio jack: plug the Audio cable or RCA cable





Button functions

Button	Operation	
	Power on	Press and hold for approximately 1 second
	Power off	Press and hold for approximately 3 seconds
	Connect device	Short press
	Disconnect device	Press and hold for approximately 1 second
	Play	Short press
	Pause	Short press
	Stop	Press and hold for approximately 1 second
	Go to the next track	Short press
	Fast Forward	Press and hold while music is playing
	Return to the previous track	Short press
	Rewind	Press and hold while music is playing



Short Press



Press and hold for approximately 1 second



Press and hold for approximately 3 seconds



Status LED

Duet's LED signals indicate the status of Duet.

What you see	Status
Blue	Duet is playing.
Blue blinking	Duet is connected to a device.
Red	Duet is on standby mode, ready to be connected to a device.
Red blinking	Duet is in pairing mode.
Purple blinking	Duet is being turned on or turned off.
Off	Power is off.



Setting-up Duet before use

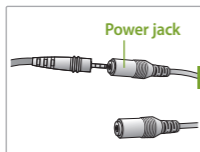

- 1** Connect the included AC adapter to the Power jack of Duet as shown, then plug the AC adapter into an electrical outlet.

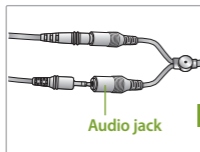

- 2** Connect the audio cable provided to the Audio jack of Duet as shown.

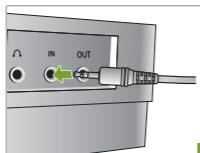

- 3** Connect the other end of the audio cable to the input outlet of your audio system.



Reference

- The audio input outlet on your stereo may be indicated as IN, LINE IN, AUDIO IN or AUX depending on the model of the stereo. Refer to the user's manual of the stereo for more information.
- To increase the length of the audio-duet connection, you should purchase compatible RCA or audio extension cables.



Caution

- Please verify that the local power supply voltage is suitable for the AC adapter provided with Duet before plugging the AC adapter into the electrical outlet.
 - Only use the AC adapter provided in this package by Prime Entertainment.
- The use of non-original adapter may result in loss of performance and damage to Duet.



NOTE

- ◆ Duet does not have an internal battery. Always make sure that Duet is connected to a power supply using the included AC adapter.





Turning On/Off

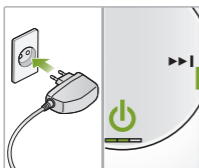

Turning On





 Press and hold the  button for approximately 1 second after plugging the AC adapter into the electrical outlet.

- Duet will beep and the status LED will first blink in purple and then stay lit in red (standby mode).



Turning Off



 Press and hold the  button for approximately 3 seconds.

- The status LED will blink in purple and beep before turning Duet off.



NOTE

- ◆ If you have unplugged the AC adapter of the Duet without having turned it off, Duet will be automatically on when you plug it back in.



Pairing Duet with Bluetooth devices

Pairing creates a wireless link between two Bluetooth devices. To pair any Bluetooth device to Duet, the following steps must be performed.



- 1 Press and hold the ►/■ and ►►| buttons at the same time for approximately 3 seconds.**

➤ Duet is now in pairing mode and the status LED will blink in red.



- 2 In the device to be paired with Duet, select the device search function from the Bluetooth setting menu. (Consult the user's manual of the device for Bluetooth functions.)**

➤ The device will search for Bluetooth devices within a 10m(30ft) range.



- 3 Once Ancilla Duet appears on the device list, select it.**

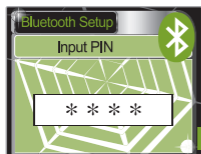

- 4 When the device asks for a PIN code, enter '0000' (default pin code) or a PIN code specific to the device.**



5 Duet is paired with the device.



Reference

The user interface illustrations shown in this manual may differ from the actual Bluetooth device you are using. Always consult the user's manual of the particular device.

Resetting Duet

This function resets Duet to its default setting. Current settings will be lost.

- ① Press and hold the ►/■ and ►►| buttons at the same time for approximately 3 seconds.
 - The status LED will blink in red.
- ② Press and hold the ►/■ and |◄◄ buttons at the same time for approximately 3 seconds.
 - All current pairings in your Duet will be deleted.



- The deleted devices cannot be recovered after resetting.
You must go through the pairing steps to pair the devices again.

NOTE

- ◆ You cannot pair Duet to Bluetooth devices while Duet is playing. If you want to pair Duet with Bluetooth devices, Duet must be set to pairing mode.
- ◆ If no device is paired with Duet within 3 minutes, Duet will end the pairing mode. To go back in pairing mode, press and hold the ►/■ and ►►| buttons at the same time for approximately 3 seconds.
- ◆ Duet can pair with up to 8 devices. Additional pairing will automatically delete the earliest paired devices.



Connecting Duet to Bluetooth devices

For Duet to connect to a Bluetooth device, the two must first be paired. Refer to the Pairing Duet with Bluetooth devices section of this manual (pages 10 to 11).



1 When the status LED stays lit in red, it indicates standby mode.

- Duet is ready to connect with a device.



2 Press the  button shortly.

- Duet will connect to the last device used if that device is available. If it fails to do so, it will automatically search for the next available paired device. (Duet will search for the last 4 devices used in sequence.)
- When connected to a device, the status LED will change from red to blue.

First automatic connection

When Duet is turned on, it will automatically attempt to connect to the last device used if that device is available. It will attempt this once. If it fails, the status LED will stay lit in red to indicate standby mode. Press the  button to try the connection again (refer to step 2 above).



Switching among devices

Duet keeps in memory the last 4 devices used and can switch connections among them.

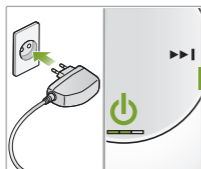

1 Turn on Duet.

- When the status LED is red, it indicates that Duet is ready to connect to devices.



2 Press the button shortly.

- Duet will connect to most recently used device that is available. If the connection is successful, the status LED will change to blue.
- If the connection fails, Duet will automatically search for the next available paired device. (Duet will search for the last 4 devices used in sequence.)



3 To switch the connection to another device, press the button shortly.

- You can switch to another device while Duet is playing (status LED blue).
- Keep pressing the  button until you connect to the device of your choice.



NOTE

- ◆ To facilitate the switching of devices Duet keeps in memory the last 4 devices connected. Duet can be paired with up to 8 Bluetooth devices, which can be readily connected.



Operating Duet

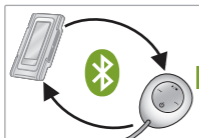

Operate the device you want to use.

- Once Duet is connected to a device of your choice, you can operate the device remotely from Duet. The remote function of Duet only works with devices which have AVRCP.



Reference

- What is AVRCP ?

AVRCP is designed to provide a standard interface and is used to allow a single remote control (or other device) to control all the Audio/Video equipment that a user has access to. AVRCP defines how to control characteristics of streaming media. This includes pausing, stopping, and starting playback as well as other types of remote control operations.

Button	Operation	
▶/■	Play	Short press
	Pause	Short press
	Stop	Press and hold for approximately 1 second
▶▶	Go to the next track	Short press
	Fast Forward	Press and hold while music is playing
◀◀	Return to the previous track	Short press
	Rewind	Press and hold while music is playing



Troubleshooting

Problem	Check point / Solution
Duet cannot be paired with a Bluetooth device	<ul style="list-style-type: none">■ Check that Duet is in pairing mode. The device can be paired to Duet only when Duet is in pairing mode.■ Check that the entered PIN code is correct. The default PIN code is '0000'.■ Check that the AC adapter is plugged properly.
The sound is broken with noise	<ul style="list-style-type: none">■ Radio Frequency interferences and physical obstacles such as high/thick walls may affect the wireless sound transmission and cause noise and the devices to malfunction. If so, turn devices off and turn them back on after a few minutes or change the location of the devices.
The sound suddenly cuts off	<ul style="list-style-type: none">■ Duet can communicate with compatible devices within a 10m (30ft) range. Check that the devices are not out of range.
There is no sound from the speakers	<ul style="list-style-type: none">■ Check the volume of the speakers.■ Check that the audio cables or RCA cables are connected to the input of speakers correctly.
Duet is not responding to the buttons I press	<ul style="list-style-type: none">■ Turn off Duet by pressing the  button for approximately 3 seconds and then turn it back on.■ Check that Duet and the Bluetooth device you want to use are properly paired.
Duet is not connecting to my lap top, PC or PDA	<ul style="list-style-type: none">■ Duet will only work with devices which are compliant with Bluetooth version 1.1 or higher. Check that the device you want to use is Bluetooth enabled.
The status LED does not change colors	<ul style="list-style-type: none">■ Make sure that you are pressing the buttons properly. Do not press too hard or too quickly. You may have to press the button a few times for certain devices to register the order.



FCC

This device complies with part 15 of the FCC Rules. Operation is subject to the following two conditions:

(1) This device may not cause harmful interference, and (2) this device must accept any interference received, including interference that may cause undesired operation.

This equipment has been tested and found to comply with the limits for a Class B digital device, pursuant to part 15 of the FCC Rules. These limits are designed to provide reasonable protection against harmful interference in a residential installation. This equipment generates, uses and can radiate radio frequency energy and, if not installed and used in accordance with the instructions, may cause harmful interference to radio communications. However, there is no guarantee that interference will not occur in a particular installation. If this equipment does cause harmful interference to radio or television reception, which can be determined by turning the equipment off and on, the user is encouraged to try to correct the interference by one or more of the following measures:

- Reorient or relocate the receiving antenna
- Increase the separation between the equipment and receiver
- Connect the equipment into an outlet on a circuit different from that to which the receiver is connected
- Consult the dealer or an experienced radio/TV technician for help

The device and its antenna must not be co-located or operating in conjunction with any other antenna or transmitter.

Users are not permitted to make changes or modify the device in any way. Changes or modifications not expressly approved by **Prime Entertainment** will void the user's authority to operate the equipment.



Warranty

Prime Entertainment warrants this product against defects in material and workmanship under normal use for one year from the original date of purchase.

Retain the dated sales receipt as evidence of the date of purchase. You will need it for any warranty service.

In order to keep this warranty in effect, the product must have been handled and used as prescribed in the instructions accompanying this product.

What is not covered under this warranty?

1. Damage or malfunction caused by misuse or mishandling of the product by the user.
2. Damage cause to the product by repair service performed by an unauthorized distributor.
3. Damage or malfunction beyond the warranty period.

For more information on the warranty, contact Prime Entertainment Quality Control Service:

Woolim Lions Bldg C #811, 425 Chungchun-dong, Bupyung-gu
Inchon, South Korea

Tel: +82-32-623-6471

Fax: +82-32-623-6472



Specifications

Bluetooth	Version 1.2, Class2
Supported Bluetooth Profiles	A2DP (Advanced Audio Distribution profile) AVRCP (Audio/Video Remote Control profile) GAVDP (Generic Audio/Video Distribution profile)
Range	Up to 10 meters (30ft)
Adapter Input	AC 100 ~ 240V, 50/60Hz
Adapter Output	DC5V, 500mA
Operating Temperature	-10°C (14°F) to 50°C (122°F)
Frequency Range	2.402 ~ 2.480 GHz
Consumption current	0.25 ~ 2.5mW
Dimensions	60mm (W) × 50mm (H) × 11mm (D)
Weight	

