

Setting the Date and Time

When the power is turned on for the first time, the date/time setting screen appears.

1 Press the ▲▼◀▶ buttons to set the year, month, date and time.

- Change the value with ▲▼ and move the frame with ▶◀.

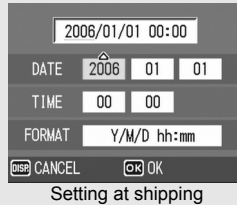

2 In [FORMAT], choose the date and time format.

- Select the date and time format with ▲▼.

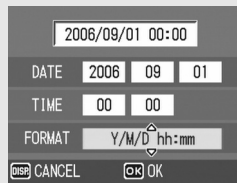

3 Check the display and then press the MENU/OK button.

- The date is set.
- Pressing the DISP. button on this screen allows you to cancel the setting.



Note

- If the battery is removed for more than one week, the date and time settings will be lost. These settings must be made again.
- To retain the date and time settings, load a battery with adequate remaining power for more than two hours.
- The set date and time can be changed later. (ⓘ P.119)
- The date and time can be inserted into images. (ⓘ P.77)

If you are using the camera for the first time, read this section.

Basic Shooting

Now you are ready.

Holding the Camera

Hold the camera as shown below for best results.

If you are using the camera for the first time, read this section.

- 1** Hold the camera with both hands and lightly press both elbows against your body.

Shooting while viewing
the LCD monitor



Shooting while using
the viewfinder



- 2** Put your finger on the shutter release button.

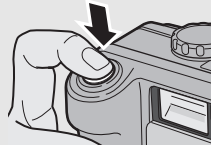

Caution

- When you are shooting, be careful not to obstruct the lens or flash with your fingers, hair, or the strap.
- Be careful not to obstruct the Bluetooth® antenna with your fingers when communicating. (P.154)



Preventing Camera Shake

If you move the camera when pressing the shutter release button, the still image might not come out clearly due to camera shake.

Camera shake tends to occur in the following cases:

- When shooting in a dark place without using the flash
- When using the zoom function
- When shooting using long time exposure (ⓘ P.73)

When the  mark appears on the LCD monitor, this indicates that camera shake may occur. To prevent camera shake, try any of the following.

- Using the antiblur function (ⓘ P.63)
- Set the flash to [AUTO] or [FLASH ON]. (ⓘ P.39)
- Raising the ISO setting (ⓘ P.81)
- Using the self-timer (ⓘ P.45)

If you are using the camera for the first time, read this section.

Shooting

The shutter release button works in two steps. You can press the shutter release button halfway down (half-press) and press it all the way down (full-press).

Quickly Shooting Pictures (Full-press)

Full-press the shutter release button for quick focusing, so as not to miss a shooting opportunity.

- 1 Press the power button to turn the camera on, and turn the mode dial to /CAL.S.

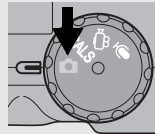

- 2 Compose your shot by looking at the LCD monitor or through the viewfinder, make sure the subject is centered, and gently press the shutter release button fully.

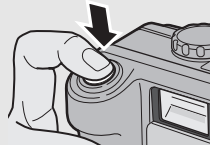

- The still image you have taken appears momentarily on the LCD monitor and is recorded to the internal memory or SD memory card.



Caution

Full-press is likely to cause the camera to shake. Hold the camera firmly with both hands and shoot.



Note

You can set the time the still image you have taken appears on the LCD monitor. You can also set the image not to appear after it is taken. (P.116)

If you are using the camera for the first time, read this section.

Checking the Focus and Shooting (Half-press/Focus Lock)

When you press the shutter release button halfway (Half-press), the auto-focus function is triggered to determine the focal distance. Next, press it all the way down (Full-press) to shoot. When your subject is not in the center of your composition, compose your photo after focusing. (Focus Lock)

- 1 Press the power button to turn the camera on, and turn the mode dial to /CALS.

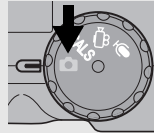

- 2 Put the subject of your photo in the center of the screen and press the shutter release button halfway.

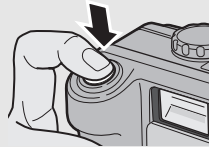

- The camera focuses on the subject and the exposure is fixed.
- If automatic focusing fails, the frame in the center of the LCD monitor turns red and the auto focus/flash lamp in the upper right of the LCD monitor blinks in green.
- The focal distance is measured at a maximum of five points. Green frames appear to indicate the positions that are in focus.

Auto Focus/Flash Lamp

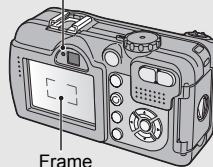

Frame

If you are using the camera for the first time, read this section.

3 To take a picture with the subject in the foreground in focus against a background, half-press the shutter release button to focus on the subject, and then compose your shot.

Subject to be focused on

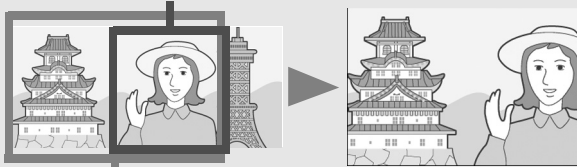

Shooting range

4 Gently press the shutter release button all the way.

- The still image you have taken appears momentarily on the LCD monitor and is recorded to the internal memory or SD memory card.

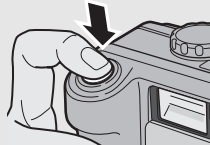

Focusing

The frame in the center of the LCD monitor and the auto focus/flash lamp indicate whether the subject is in or out of focus.

| Focus Status | Frame Color | Auto Focus/Flash Lamp |
|----------------------|--------------|-----------------------|
| Before focusing | White | Off |
| Subject in focus | Green | On (green) |
| Subject not in focus | Blinks (red) | Blinks (green) |



Note

- Press the shutter release button gently to prevent camera shake.
- The  mark indicates that camera shake may occur. Hold the camera still and focus the camera again. You can also turn on the antiblur function to minimize blurring. (P.63)
- The flash fires twice to increase the AE/AF (Auto Exposure/Auto Focus) accuracy.

If you are using the camera for the first time, read this section.

Using the Zoom Function

Pressing the **[+]** (Wide-angle) button allows you to take a wide-angle picture. Pressing the **[A]** (Telephoto) button allows you to take a close-up picture of the subject.

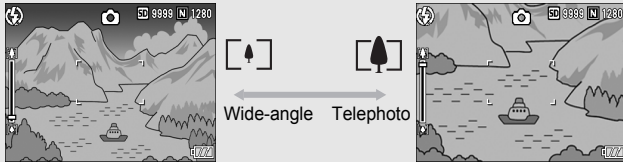

- 1 With the camera ready to shoot, press the **[+]** (Wide-angle) button or the **[A]** (Telephoto) button.

- You can check the zoom status on the zoom bar of the LCD monitor.

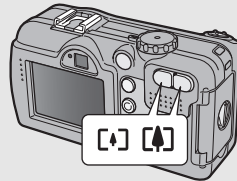

- 2 Compose your picture and half-press the shutter release button.

- 3 Full-press the shutter release button.



Using the Digital Zoom

Digital zooming enables you to enlarge the subject more than the maximum magnification of the optical zoom (3.0 \times) specified by pressing the **[A]** (Telephoto) button (up to 4.0 \times).

For digital zooming, release the **[A]** button once when the zoom reaches the limit on the **[A]** (Telephoto) end on the zoom bar, and then hold the **[A]** button down again.

If you are using the camera for the first time, read this section.



Shooting Close-Ups (Macro Shooting)

Using the  (Macro) button allows you to take a tight close-up of the subject. (Macro shooting)

This is good for shooting small subjects because you can shoot up to approximately 5 mm (0.2 in.) (from the very front of the camera) away.

If you are using the camera for the first time, read this section.

- 1 With the camera ready to shoot, press the  (Macro) button.**

-  is displayed momentarily at the center of the LCD monitor and then a  is displayed at the top of the screen.

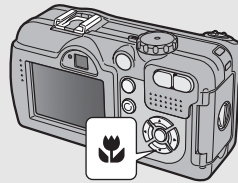

- 2 Compose your picture and half-press the shutter release button.**

- 3 Full-press the shutter release button.**

- To cancel macro mode, press the  (Macro) button again.



Note

- When using the zoom, you can shoot close-ups within the following distances:





| | Distance | Shooting range |
|------------|--|--|
| Wide-Angle | About 5 mm (from the very front of the camera) | Approx. 27 mm × 20 mm |
| Telephoto | About 10 cm (from the very front of the camera) | Approx. 51 mm × 38 mm (when digital zoom is not used) |
| | | Approx. 12.8 mm × 9.5 mm (when 4.0× digital zoom is used) |



- The AF target shift function enables you to lock the focus for macro shooting with the simple touch of a button without moving the camera. This function is useful for shooting on a tripod. (P.58)
- To take a further close-up picture during macro shooting, use [ZOOM MACRO] in scene mode. (P.40)

Using the Flash

Press the  (Flash) button to change the flash mode. At the time of purchase, the camera is set to [FLASH OFF]. From the front edge of the lens, the flash light reaches about 0.2 to 10.0 m (7.9 in. to 32.8 ft.) (Wide-angle) or about 0.2 to 6.5 m (7.9 in. to 21.3 ft.) (Telephoto) when the ISO setting is set to [AUTO].

Flash Modes

| | | |
|---|----------------|---|
|  | FLASH OFF | The flash will not fire. |
|  | AUTO | The flash fires automatically when the subject is poorly lit or backlit. |
|  | RED-EYE FLASH | Reduces the red-eye phenomenon, in which people's eyes appear red in pictures. |
|  | FLASH ON | The flash fires regardless of the lighting conditions. |
|  | FLASH SYNCHRO. | The flash fires with the shutter speed slowed. This is useful when taking portrait pictures in a nightscape. Camera shake may occur, so the use of a tripod is recommended. |

- 1** Turn the mode dial to /CAL.S.
- 2** Press the  (Flash) button to change the flash mode.

- The flash mode mark is displayed momentarily at the center of the LCD monitor and then a smaller mark is displayed at the upper left of the screen.
- The auto focus/flash lamp blinks while the flash charges. Once the flash is charged, the lamp turns off and the camera is ready to shoot.

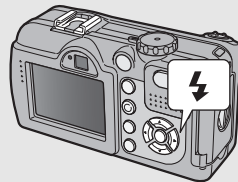

Note

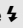





- The flash mode setting is saved until you press the  (Flash) button again.
- The flash does not fire when shooting movies or in Multi-shot mode.
- The flash fires a pre-flash to increase the AE/AF (Auto Exposure/Auto Focus) accuracy.
- When shooting close-ups with the flash, there may be a shadow in the lower left part of the picture due to the convex lens.

If you are using the camera for the first time, read this section.

Shooting with Optimal Settings According to Shooting Conditions

You can use scene mode to select from among five still image modes and shoot with settings automatically optimized for shooting conditions.

Scene Modes

| | |
|--|---|
|  HIGH SENS | <p>Use when taking pictures in dimly lit places. The LCD monitor also becomes brighter.</p> |
|  FIREFIGHTING | <p>Use to capture images under difficult conditions such as the scene of a fire. The focal length is fixed to 2.5 m, allowing you to take clear pictures in a situation where the auto focus would normally produce blurred images due to flames, smoke and water vapor. Increasing the ISO sensitivity extends the range of the flash, and prevents camera shake by controlling the shutter speed even when the flash is not used. The sharpness level is also increased in this mode and the LCD monitor becomes brighter and is suited for firefighting.</p> |
|  SKEW COR MODE | <p>Use to straighten a rectangular object, such as a message board or business card, shot at an angle to make it look as if it were shot squarely. For detailed operations, see P.42.</p> <div style="text-align: center;">  </div> <p>In skew correction mode, choose from [F1280], [N1280], and [N640] for [PIC QUALITY/SIZE]. (☞ P.61)</p> |
|  TEXT MODE | <p>Use when capturing text images, for example notes written on a whiteboard at a meeting. You can also change the shading of text. (☞ P.57) You can set the image size to either 3264 × 2448 or 2048 × 1536 pixels. (☞ P.61)</p> |
|  ZOOM MACRO | <p>Use when taking a further close-up picture during macro shooting. Using the digital zoom allows you to take a larger close-up than with normal macro shooting. For detailed operations, see P.43. The optical zoom cannot be used in this mode. You can shoot close-ups within the following distances. When digital zoom is not used: About 5 mm from the very front of the camera (Shooting range: Approx. 27 mm × 20 mm) When 4.0× digital zoom is used: About 5 mm from the very front of the camera (Shooting range: Approx. 6.8 mm × 5 mm)</p> |



Note

For information on Shooting Setting menu items and function restrictions in scene mode, see "Appendices". (☞ P.240)

If you are using the camera for the first time, read this section.

1 Turn the mode dial to .

2 Press the **SCENE** button.

- The scene mode selection screen appears.

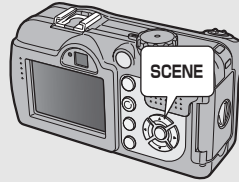

3 Press the **▲▼** buttons to select the scene mode.



4 Press the **MENU/OK** button.

- The scene mode type is displayed at the top of the LCD monitor.

5 Press the shutter release button to shoot the picture.

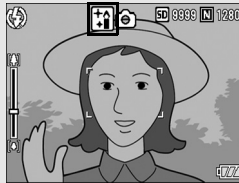

Changing Scene Mode

Press the **SCENE** button to display the scene mode selection screen, and select a different scene mode.

Returning to Normal Shooting Mode

1 Press the **SCENE** button to display the scene mode selection screen.

2 Press the **▲▼** buttons to select **[NRML SHT]**.

3 Press the **MENU/OK** button.

If you are using the camera for the first time, read this section.

If you are using the camera for the first time, read this section.

Using the Skew Correction Mode

1 Turn the mode dial to .

2 Press the SCENE button.

- The scene mode selection screen appears.

3 Press the   buttons to select [SKEW COR MODE].

4 Press the MENU/OK button.

5 Press the shutter release button to shoot the picture.

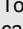
- The display indicates that the image is being corrected and the area recognized as the correction range is displayed with an orange frame. Up to five areas can be recognized.
- If the target area cannot be detected, an error message appears. The image before correction remains recorded.
- To select another correction area, move the orange frame to the target area by pressing the  button.
- To cancel skew correction, press the  button. Even if you cancel skew correction, the image before skew correction remains recorded.

6 Press the MENU/OK button.

- The display indicates that the image is being recorded and the corrected image is recorded. The image before correction is also recorded.



Caution

When [SKEW COR MODE] is selected, note the following:

- To shoot the subject as large as possible, position it so that the entire portion of the subject is visible on the LCD monitor.
- The camera may fail to recognize the subject in the following cases:
 - When the image is out of focus
 - When four edges of the subject are not clearly visible
 - When it is hard to distinguish between the subject and background
 - When the background is complicated
- Two images, one before correction and the other after correction, are recorded. If the number of remaining shots is less than two, you cannot shoot the subject.

Shooting in Zoom Macro Mode

- 1** Turn the mode dial to .
- 2** Press the **SCENE** button.
 - The scene mode selection screen appears.
- 3** Press the **▲▼** buttons to select **[ZOOM MACRO]**.
- 4** Press the **MENU/OK** button.
- 5** Press the **[+]** (**Wide-angle**) or **[−]** (**Telephoto**) button.
 - The zoom level appears on the LCD monitor.
- 6** Compose your picture and half-press the shutter release button.
- 7** Full-press the shutter release button.

If you are using the camera for the first time, read this section.

Shooting in CALS Mode

In CALS mode, [PIC QUALITY/SIZE] is fixed at [N1280] (Normal 1280 × 960) suitable to be submitted as official public works pictures (based on Japanese standards).

With simple operation of the mode dial, you can shoot photos in a construction environment without being distracted by setting the picture quality mode or image size.

If you are using the camera for the first time, read this section.

1 Turn the mode dial to CALS.

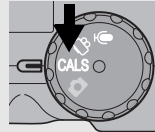

- The symbol appears on the screen.



2 Press the shutter release button to shoot the picture.

- Images are recorded with [PIC QUALITY/SIZE] set to [N1280].
- When the mode dial is set to a mode other than **CALS**, [PIC QUALITY/SIZE] returns to the setting in the previous mode.



Note

When shooting with S-CONT or M-CONT in CALS mode, [PIC QUALITY/SIZE] is fixed at [N3264] (Normal 3264 × 2448).

Using the Self-Timer

You can set the Self-timer to shoot after either two or ten seconds. A setting of two seconds is useful for preventing camera shake.

1 Turn the mode dial to **CAL.S**.

2 Press the **(Self-timer)** button.

- The Self-timer symbol appears on the screen.
- The [10] to the right of the symbol indicates the number of seconds. In this case, if you press the shutter release button, the camera will shoot after 10 seconds.
- Each press of the **(Self-timer)** button changes the self-timer setting in the following order: 10 sec, 2 sec, and Self-timer Off.



3 Press the shutter release button.

- The focus is locked, and the AF auxiliary light blinks when the self-timer starts.



Note

- Once the picture is taken, the self-timer turns off.
- When the self-timer is set to 2 seconds, the AF auxiliary light does not blink.

If you are using the camera for the first time, read this section.

Playing Back Images

Reviewing the Image You Just Took (Quick Review)





You can view the image you just took on the LCD monitor. If you are not pleased with the way the photo came out, you can delete it then and there.

If you are using the camera for the first time, read this section.

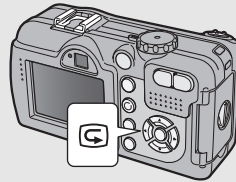
1 In shooting mode, press the (Quick Review) button.

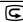
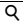
- The last image you took is displayed on the LCD monitor.

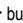
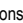

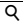
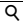
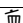
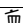
| In Quick Review | |
|--|--|
|  Button | Returns to shooting mode. |
|  Button | Enlarges the displayed still image. You can move the displayed still image by pressing the     buttons. |
|  Button | Reduces the displayed still image enlarged by pressing the  button. |
| MENU/OK Button | Enlarges the displayed still image enlarged by pressing the  button to the maximum available magnification. Pressing this again returns the still image to its original size. |
|  Button | Deletes the currently displayed file. When the  button is pressed, a warning message about deleting the file appears. Select [DELETE] and press the MENU/OK button. |



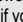
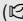

Note

- Once the power is turned off, the image you took cannot be displayed in still image mode even if you press the  (Quick Review) button.
- If you use Quick Review to view the image taken in [TEXT MODE] of scene mode ( P.40), the displayed image may have a slightly lower quality than the recorded one.

Viewing Your Images

In playback mode, you can check still images you have taken. You can also delete or zoom in on the images.

1 Press the (Playback) button.

- The camera switches to playback mode and the last still image you took is displayed.
- You can view your pictures in order by using the   buttons.
- To switch the camera from playback mode to shooting mode (or voice memo mode), press the  (Playback) button again.

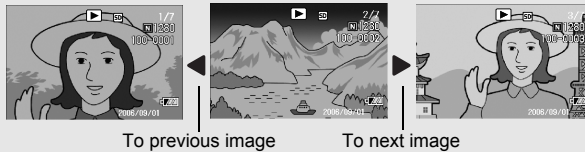
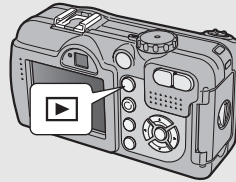

Turning on the camera in playback mode-----

When the camera is off, pressing the  (Playback) button for more than one second turns the camera on. (The camera starts up in playback mode.)

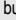
When the camera has been turned on with the  (Playback) button, pressing the  (Playback) button again switches playback mode to shooting mode.

Where images are played back from-----

When no SD memory card is loaded, the camera plays back from the internal memory.

When an SD memory card is loaded, it plays back from the SD memory card.

If you are using the camera for the first time, read this section.

Three-frame View/List View (Thumbnail Display)

When playing back images on the LCD monitor, the playback screen can be divided into three frames (three-frame view) or 12 frames (list view). The three-frame view and list view allow you to select a still image to enlarge or delete.

The playback screen changes as follows:

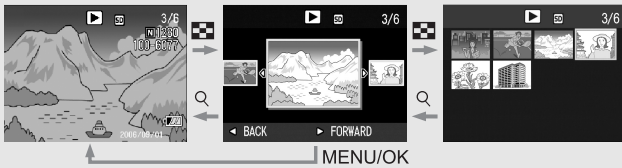

If you are using the camera for the first time, read this section.

1 Press the (Playback) button.

- The last image you took is displayed.

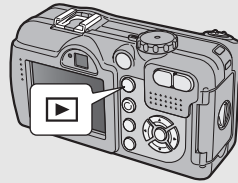

2 Press the (Thumbnail Display) button.

- The screen changes to three-frame view. The large frame at the center of the screen displays the currently selected still image.

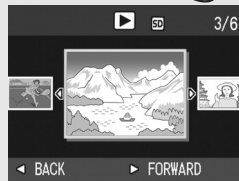
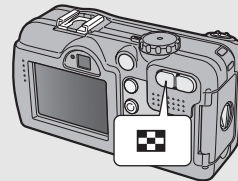

3 Press the (Thumbnail Display) button again during three-frame view.

- The screen is divided into 12 frames and the list of still images is displayed.

Selected still image

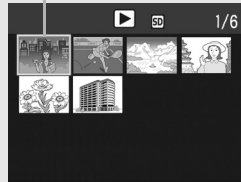

Switching to Single-Picture Display

- In three-frame view

1 Press the   buttons to select a still image.

2 Press the  (Enlarged View) button or the MENU/OK button.

- In list view

1 Press the    buttons to select a still image.

2 Press the  (Enlarged View) button twice.



Note

If any of the following operations is performed in the three-frame view, the display returns to the ordinary playback screen (single-picture display) and the operation is executed.

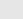
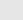
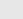
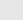
- Deletion ( P.51)
- Menu display ( P.88)
- Movie playback ( P.85)
- Sound playback ( P.87)

If you are using the camera for the first time, read this section.

Magnifying Images

You can enlarge a still image displayed on the LCD monitor.

| Image Size | Enlarged View (maximum magnification) |
|---------------------------------------|---------------------------------------|
| 3264 × 2448, 2592 × 1944, 2048 × 1536 | 8 times |
| 1280 × 960 | 6.7 times |
| 640 × 480 | 3.4 times |

If you are using the camera for the first time, read this section.

1 Press the (Playback) button.





- The last image you took is displayed.

2 Press the buttons to display the still image you want to enlarge.

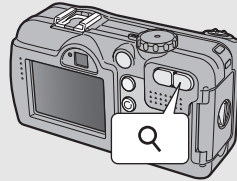
3 Press the (Enlarged View) button.

- The still image is enlarged.

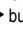

| In Enlarged View | |
|--|--|
|  Button | Enlarges the displayed still image. You can move the displayed still image by pressing the    buttons. |
|  Button | Returns the enlarged still image to its original size. |
| MENU/OK Button | Displays the still image at the maximum magnification. Pressing this again returns the still image to its original size. |



Note

- Enlarged view is also available in the quick review mode.
- Movies cannot be enlarged.

Deleting Files

You can delete unwanted or failed files from the SD memory card or internal memory.

Deleting a File

- 1** Press the  (Playback) button.
- 2** Press the   buttons to display the file you want to delete.
- 3** Press the  (Delete) button.
- 4** Press the   buttons to select [DELETE ONE].
 - You can change the image for deletion with the  buttons.
- 5** Press the MENU/OK button.
 - The display indicates that the files are being deleted; once finished, it returns to the screen in Step 4.

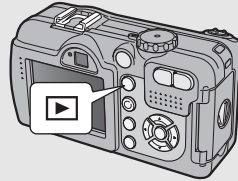

If you are using the camera for the first time, read this section.

Deleting All Files

- 1** Press the  (Playback) button.
- 2** Press the  (Delete) button.

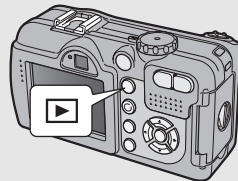

If you are using the camera for the first time, read this section.

3 Press the ▲▼ buttons to select [DELETE ALL].

4 Press the MENU/OK button.

- You will be prompted to confirm that you want to delete all images. If so, press the ► button to select [YES], and then press the MENU/OK button.

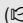

Note

You can also delete files by pressing the  (Delete) button during three-frame view ( P.48).

Deleting Multiple Files at One Time

1 Press the  (Playback) button.

2 Press the  (Thumbnail Display) button twice.

- The screen is divided into 12 frames and thumbnails are displayed.

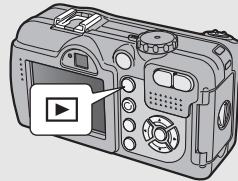

3 Press the ▲▼◀▶ buttons to select the file you want to delete and press the  (Delete) button.

- The trash symbol is displayed in the upper left corner of the file.

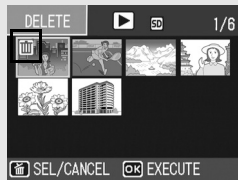

4 Repeat Step 3 to select all the files you want to delete.

- If you selected a file by mistake, you can deselect it by selecting the file and pressing the  (Delete) button.

5 Press the MENU/OK button.

6 Press the ◀▶ buttons to select [YES] and then press the MENU/OK button.

- The display indicates that the files are being deleted; once finished, it returns to the thumbnail display screen.

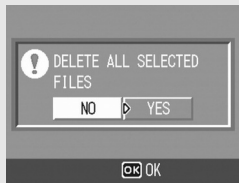

If you are using the camera for the first time, read this section.

Changing the Display with the DISP. Button

Pressing the DISP. button allows you to change the screen display mode and toggle the information displayed on the LCD monitor. Each time you press the DISP. button, the display changes in the following order: Grid Guide, No Display, LCD Monitor Off, and Normal Symbol Display.

If you are using the camera for the first time, read this section.

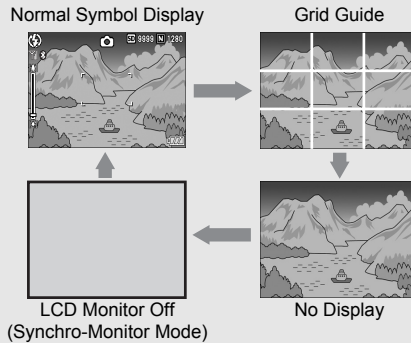

Grid Guide

This displays auxiliary lines on the LCD monitor to help you compose your picture. These lines are not recorded with images.

Synchro-Monitor Mode

This turns the LCD monitor off except when the camera is operated. This mode is effective for saving power consumption. In this mode, pressing the shutter release button halfway turns the LCD monitor on. Subsequently, pressing the shutter release button fully displays the shot image on the LCD monitor and then turns the LCD monitor off.

Maximizing the LCD Monitor Brightness

Hold the DISP. button down to maximize the display brightness. When the brightness is at the maximum setting, holding the DISP. button down returns the brightness to the level set in [LCD BRIGHTNESS] (P.111).

Advanced Operations

Read this section when you want to learn more about the different camera functions.

| | | |
|----|--|-----|
| 1 | Various Shooting Functions | 56 |
| 2 | Shooting/Playing Back Movies | 83 |
| 3 | Recording/Playing Back Sound | 86 |
| 4 | Other Playback Functions | 88 |
| 5 | Direct Printing..... | 98 |
| 6 | Changing Camera Settings | 106 |
| 7 | Downloading Images to Your Computer | 128 |
| 8 | Using the Bluetooth® Function | 154 |
| 9 | Using the GPS Function | 180 |
| 10 | Using the Wireless LAN Function (Only for Caplio 500SE-W)..... | 191 |
| 11 | Appendices | 221 |

1

2

3

4

5

6

7

8

9

10

11

1 Various Shooting Functions

Using the ADJ. Button

1 Various Shooting Functions

You can use the ADJ. button to adjust the exposure compensation, white balance, and other settings with fewer operations. Two functions other than exposure compensation and white balance can also be assigned to the ADJ. button. Use the SETUP menu to assign functions to the ADJ. button. (P.112) By assigning a frequently used function to the ADJ. button, you can more easily set that function with fewer button operations.

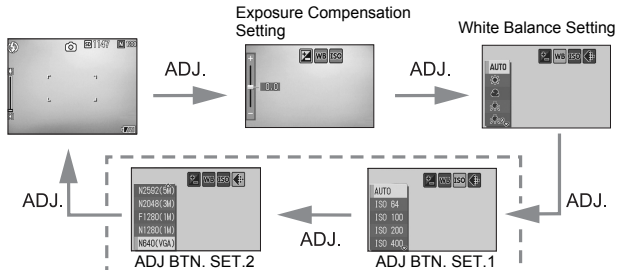

The screenshots above are examples of the screen display when functions are assigned to [ADJ. BTN. SET.1] and [ADJ. BTN. SET.2]. Press the ADJ. button until the screen with the desired function appears. Adjust the settings with the ▲▼ buttons and press the MENU/OK button to set.

Settings by Mode

The settings that can be made with the ADJ. button differ among scene mode, movie mode and still image mode. The following settings can be made with the ADJ. button.

| Mode | Available Settings |
|-------------------------------------|---|
| Still Image Mode | Exposure compensation, white balance, functions assigned to the ADJ. button |
| Movie Mode | White balance |
| Scene Mode ([TEXT MODE]) | Text density |
| Scene Mode (other than [TEXT MODE]) | Exposure compensation, white balance |

Functions That Can Be Assigned to the ADJ. Button

ISO (ISO SETTING), QUALITY (PIC QUALITY/SIZE), FOCUS, SHARP (SHARPNESS), METERING (PHOTOMETRY), CONT. MDE (CONT.MODE), ANTIBLUR (Default setting for [ADJ. BTN.SET.1])

Note

When using a camera memo, the settings on P.56 cannot be set with the ADJ. button. (☞ “Software User Guide”)

Changing the Text Density (SCENE)

You can change the shading of text for shooting with [TEXT MODE] (☞ P.40) in scene mode.

You can select from [DEEP], [NORMAL] and [LIGHT].

To change the setting, use the Shooting Setting menu or the ADJ. button. This section explains easy ways to change the shading setting with the ADJ. button.

To use the Shooting Setting menu, see “Using the Menu” (☞ P.60) and “Shooting Setting Menu Items by Scene Mode” (☞ P.240).

- 1 Turn the mode dial to .**
- 2 Press the SCENE button.**
 - The scene mode selection screen appears.
- 3 Press the ▲▼ buttons to select [TEXT MODE] and then press the MENU/OK button.**
- 4 Press the ADJ. button.**
 - The text density menu appears.
- 5 Press the ▲▼ buttons to select the desired density setting.**
 - You can also press the shutter release button to shoot the picture.
- 6 Press the MENU/OK button.**
 - The text density setting does not appear on the screen.



Richo Company, Ltd. is a world-
famous manufacturer of office
information equipment. Our
products include copiers, printers, fax
machines, personal computers, CD-
recordable and CD-R/Writable
drives and media, and related
peripherals.

Richo offers a range
of advanced solutions to
business needs, what
you are looking for stand-alone
products, printing, faxing, scanning
multifunctional products
rely on our technology
your business ahead!

Richo offers a range of advanced solutions to business needs, what you are looking for stand-alone products, printing, faxing, scanning multifunctional products rely on our technology your business ahead!

Shifting the AF Target (Macro)

You can press the ADJ. button during macro shooting and then use the \blacktriangle \blacktriangledown \blacktriangleleft buttons to shift the AF target without moving the camera. You can then lock the focus (P.35) at the position of the AF target and shoot the picture. This function is useful for shooting on a tripod.

1 Various Shooting Functions

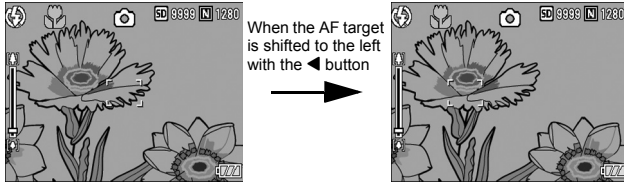

1 With the camera ready to shoot, press the Macro button.

- The macro symbol appears on the screen.

2 Press the ADJ. button.

3 Press the \blacktriangleleft buttons until the AF target shift function screen (cross-mark in the middle of the screen) appears.



4 Shift the cross-mark to the subject you want the camera to focus on with the \blacktriangle \blacktriangledown \blacktriangleleft buttons.

5 Press the MENU/OK button.

6 Half-press the shutter release button.

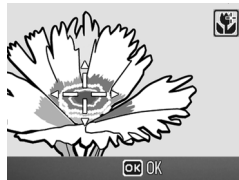

- The camera focuses on the area at the position of the cross-mark.

7 Gently press the shutter release button all the way.

- The AF target shift function automatically focuses the camera on the set position until macro mode is canceled.

Shooting Setting Menu

Press the MENU/OK button in shooting mode to display the Shooting Setting menu. The Shooting Setting menu can be used to set the following shooting settings.

When Mode Dial is Set to /CAL

| Setting | Options [Default Settings] | Refer to |
|------------------|--|----------|
| PIC QUALITY/SIZE | F3264(8M), N3264(8M), N2592(5M), N2048(3M), F1280(1M), [N1280(1M)], N640(VGA) | P.61 |
| ANTI BLUR | [OFF], ON | P.63 |
| FOCUS | [MULTI AF], SPOT AF, MF, SNAP, ∞ | P.64 |
| PHOTOMETRY | [MULTI], CENTER, SPOT | P.67 |
| SHARPNESS | SHARP, [NORMAL], SOFT | P.68 |
| CONT. MODE | [OFF], S-CONT, M-CONT | P.69 |
| COLOR DEPTH | VIVID, [NORMAL], NEUTRAL, B&W | P.72 |
| TIME EXPOSURE | [OFF], 1 SEC., 2 SEC., 4 SEC., 8 SEC. | P.73 |
| INTERVAL | [0 s], 30 seconds to 3 hours | P.74 |
| IMAGE WITH SOUND | [OFF], ON | P.76 |
| DATE IMPRINT | [OFF], DATE, TIME | P.77 |
| EXPOSURE COMP. | -2.0 to +2.0 | P.78 |
| WHITE BALANCE | [AUTO], (OUTDOORS), (CLOUDY), (INCANDESCENT LAMP), (INCANDESCENT LAMP2), (FLUORESCENT LAMP), (MANUAL SETTINGS) | P.79 |
| ISO SETTING | [AUTO], ISO 64, ISO 100, ISO 200, ISO 400, ISO 800, ISO 1600 | P.81 |
| RESTORE DEFAULTS | _____ | P.82 |

- The settings that can be selected during scene mode are restricted. (P.240).

When Mode Dial is Set to

| Setting | Options [Default Settings] | Refer to |
|---------------|--|----------|
| MOVIE SIZE | [320], 160 | P.61 |
| FRAME RATE | [30FPS], 15FPS | P.84 |
| FOCUS | [MULTI AF], SPOT AF, MF, SNAP, ∞ | P.64 |
| WHITE BALANCE | [AUTO], (OUTDOORS), (CLOUDY), (INCANDESCENT LAMP), (INCANDESCENT LAMP2), (FLUORESCENT LAMP), (MANUAL SETTINGS) | P.79 |



Note

The SETUP menu (P.106) and EXP SET menu (P.155) can be accessed from within the Shooting Setting menu.

Using the Menu

This explains how to make the settings.

Use the **▲▼▶** buttons and MENU/OK button to select and set an item.

1 Press the MENU/OK button in shooting mode.

- The Shooting Setting menu is displayed.

The menu items are provided on three screens.

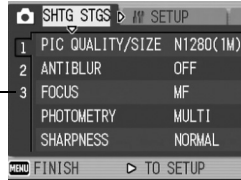

2 Press the ▲▼ buttons to select the desired menu item.

- Press the ▼ button at the bottom item to display the next screen.

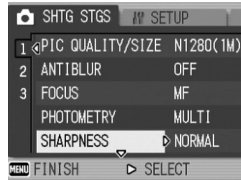

3 Press the ▶ button.

- The menu item settings are displayed.

4 Press the ▲▼ buttons to select the setting.

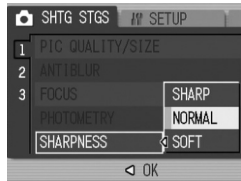

5 Press the MENU/OK button, or ◀ button and press the MENU/OK button.

- The setting is set.
- The Shooting Setting menu disappears and the camera is ready to shoot.

Changing the display

- You can select a screen by the screen number:
 - Press the ◀ button to select a screen number on the left of the screen.
 - Press the ▲▼ buttons to change screens.
 - Press the ▶ button to return to menu item selection.

