

TABULATION				
	ASSEMBLY	ITEM 1	ITEM 4	ITEM 6
CLUB	17178	17208	17205	17211
HOME	17179	17210	17205	17211
TRAINER	17180	17210	17207	17845

REVISIONS				
REV.	DESCRIPTION	APPR	DATE	
A	PRODUCTION RELEASE. ADDED DATE CODE, TAPE NOTE, CHANGED NOTE 2 AND 3, REMOVED FCC DECAL, ADDED FCC ID TO BATTERY DOOR	MAD	4/5/07	
B	CORRECTED ITEM CALLOUT BY SWITCHING ITEM #4 AND #6. ADDED BATTERIES (ITEM 10) TO ASSEMBLY.	MAD	4/26/07	
C	ECN1508, REMOVED FCC/ICE DECAL FROM ALL UNITS. REMOVED ITEM 3 AND 6 FROM TABULATION, ADDED ITEM 9. ASSEMBLY 17179 ITEM 4 WAS 17209, REMOVED ITEM VIEWS 3 AND 6 ADDED ITEM 9 TO PAGE 2	MAD	7/24/07	
D	ECN# 1531-REMOVED FCC NUMBERS FROM ITEM 6, REMOVED ITEM 8 FROM TABULATION. DELETED ITEM 6, DETAILS ON SHEET 2. ADDED FCC/IC NUMBERS TO ITEM 6, CREATED NEW CASE BOTTOM USED ON TRAINER. ADDED ITEM 9 TO TABULATION, ADDED ITEM 6 DETAILS ON PAGE 2	MAD	8/31/07	
E	CORRECTED TABULATION CALLOUT FOR THE HOME CONSOLE, 17179 WAS 17178	MAD	9/14/07	
F	ADDED "CONTAINS" TO FCC PAD PRINT ON TRAINER MODEL	JTI	9/10/08	

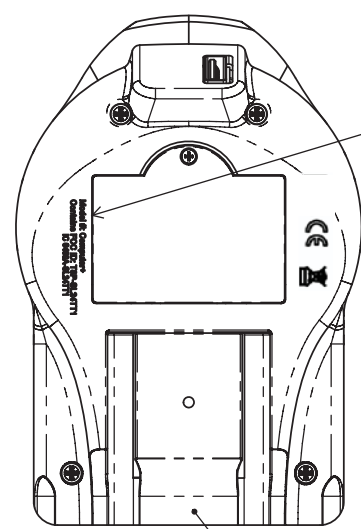

PAD PRINT:  
Model #: Computer+  
Contains FCC ID: T8P-SL24TT1  
IC: 6459A-SL24TT1

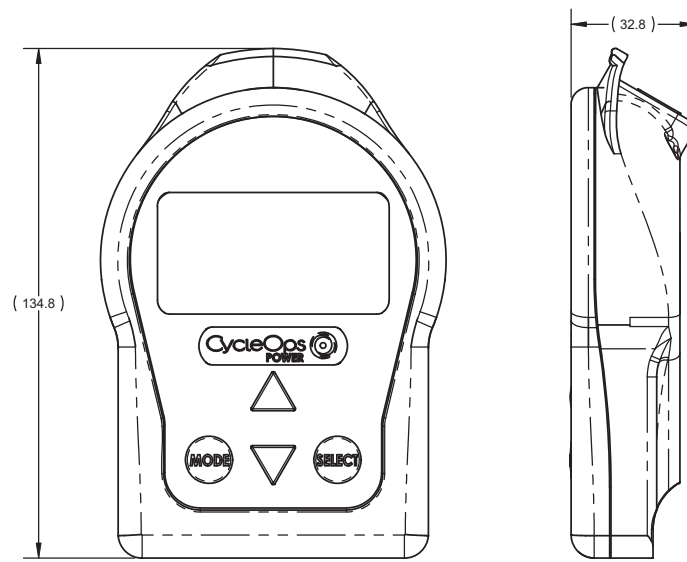
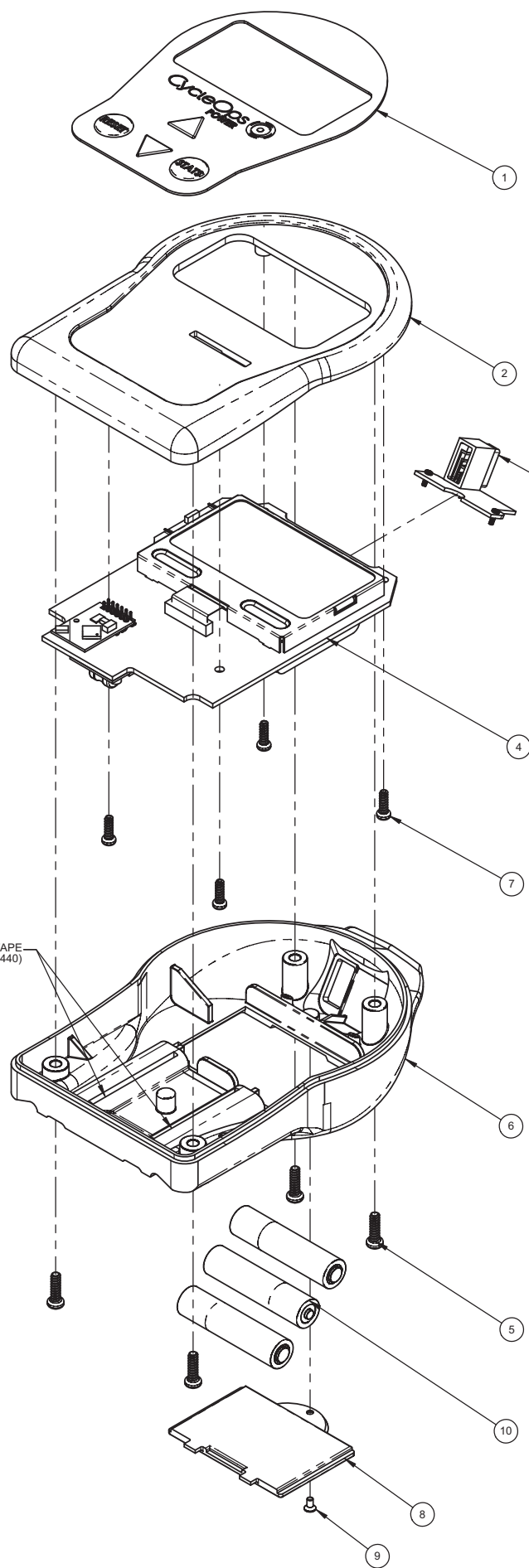

COVER BOTH SLOTS WITH TAPE  
(SEE SARIS WORK INSTRUCTION 17440)

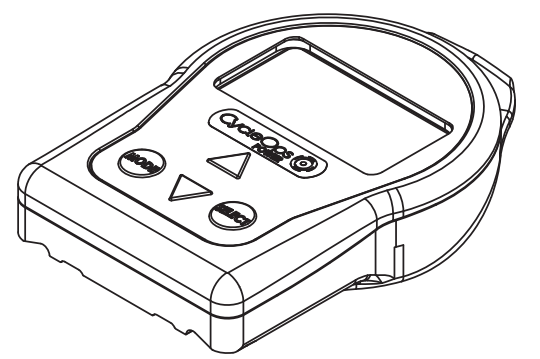

ASSEMBLED ISOMETRIC VIEW

- NOTE:
- ALL PLASTIC PARTS MUST FIT FREELY TOGETHER WITHOUT CAUSING DEFORMATION TO MATING PARTS.
  - UNIT TO BE ASSEMBLED PER SARIS CYCLING GROUP WORK INSTRUCTION 17441.
  - ASSEMBLY TO MEET SARIS CYCLING GROUP SPECIFICATION 17440.
  - ALL COMPONENTS ON ITEM 3 TO BE SEALED USING DOW CORNING 3140 RTV COATING, GE TSE397-C OR SARIS ENGINEERING APPROVED EQUIVALENT.

ITEM NO.	PART NUMBER	DESCRIPTION	17178/QTY.
1	SEE TABULATION	CONSOLE OVERLAY, INTERIM	1
2	16045	CASE, TOP, CONSOLE	1
3	17181	FLEX PCB; CONSOLE CONNECTORS	1
4	SEE TABULATION	CONSOLE CPU, INTERIM, TRAINER	1
5	16063	SCREW, M3X.4X10 CONSOLE	4
6	SEE TABULATION	CASE, BOTTOM, CONSOLE, TRAINER	1
7	16074	SCREW, M3X.5X8, STL LCD PCB MOUNTING	4
8	16046	HATCH, BATTERY, CONSOLE	1
9	16064	BATTERY HATCH SCREW	1
10	16444	BATTERY, AAA, ALKALINE	3

VENDOR REPRESENTATIVE: \_\_\_\_\_ DATE: \_\_\_\_\_

UNLESS OTHERWISE SPECIFIED MATERIAL: \_\_\_\_\_

UNLESS OTHERWISE SPECIFIED DIMENSIONS ARE IN METRIC: \_\_\_\_\_

UNLESS OTHERWISE SPECIFIED TOLERANCES ARE: \_\_\_\_\_

DO NOT SCALE DRAWING

SEE BILL OF MATERIAL

METRIC: X mm = .50, .XX mm = .25, .XXX mm = .100

FINISH: NONE

APPROVALS: N. SWANSON, DATE: 4/25/06

CHECKED: \_\_\_\_\_

REWORKS: \_\_\_\_\_

PROJ. REP: \_\_\_\_\_

CAD GENERATED DRAWING: \_\_\_\_\_

DATE: 4/25/06

TITLE: ASSEMBLY, CLUB IC CONSOLE

SARIS CYCLING GROUP  
5333 VERONA RD., MADISON, WI, 53711  
4800-783-7257 / 1-800-274-1702  
WWW.SARIS.COM

THE INFORMATION CONTAINED IN THIS DRAWING IS THE SOLE PROPERTY OF SARIS CYCLING GROUP. ANY REPRODUCTION IN PART OR WHOLE WITHOUT THE WRITTEN PERMISSION OF SARIS CYCLING GROUP IS PROHIBITED.

SCALE: 1:1 SIZE: D DWG. NO.: 17178 REV: F SHEET: 1 OF 2