

Switch™ Core Installation Instructions

BEFORE YOU BEGIN:

It is critical to ensure that **Switch™ Core** is compatible with your **Lock Hardware**. Please carefully review page 4 and page 5 of this document [**Switch™ Core Compatibility Guide**] to ensure that you are installing **Switch™ Core** into appropriate **Lock Hardware**.

OVERVIEW

Compatible Devices: Android™ 5+ iOS: 11.0+

- | | |
|------------------------|-------------------------------|
| A Lever Handle | G Battery Cap |
| B Throw Member* | H Hex Key 1/16" |
| C Core 7-Pin | I Battery Removal Tool |
| D Control Key | |
| E Switch™ Core | |
| F Battery | |

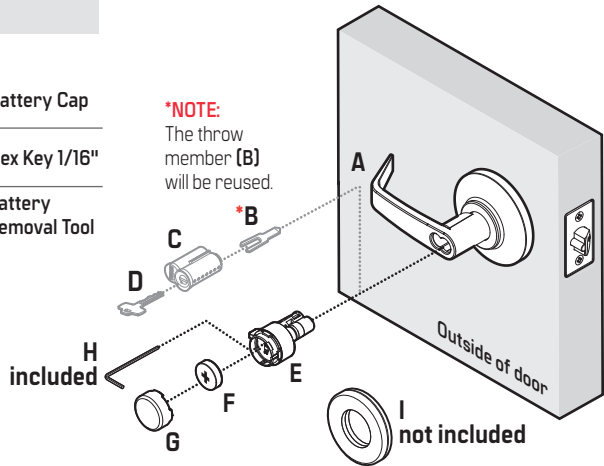

Switch™ Core Installation Instructions

1 DISENGAGE CONTROL LUG

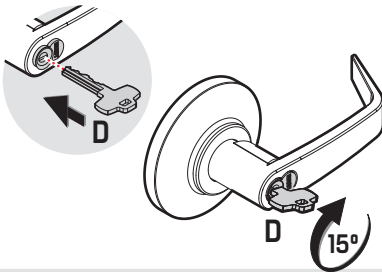

Insert the control key (D), and rotate 15° clockwise to disengage the control lug.

2 REMOVE CORE AND THROW MEMBER

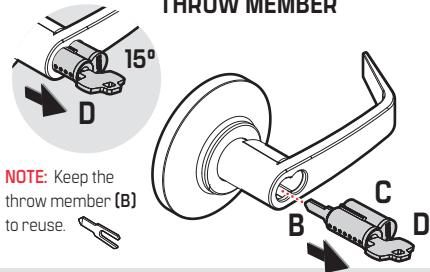

NOTE: Keep the throw member (B) to reuse.

With the control key (D) rotated 15°, remove the core (C) and the throw member (B). If the throw member (B) or the throw pins do not come out with the core (C), leave them in the lock.

Switch™ Core Installation Instructions

3 CORE ORIENTATION

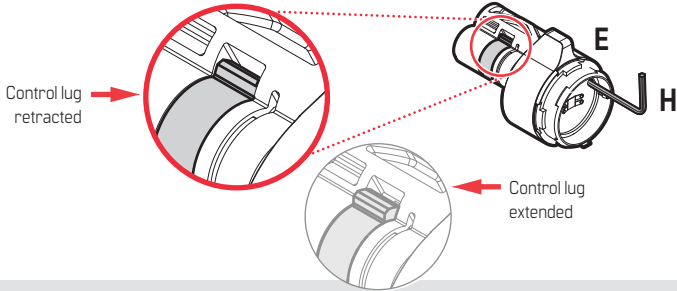

The hex key (H) should come inserted in the core (E) with the control lug retracted. If so, go to **step 5**. Otherwise, go to **step 4** to retract the control lug.

4 RETRACT CONTROL LUG

NOTE: The core (E) must be in installation mode for the hex key (H) to access the control lug. If not, the hex key (H) cannot be rotated. If this is the case, please reference the Switch™ Tech user guide for further instructions. <https://support.bestaccess.com/hc/en-us/articles/360036366673>

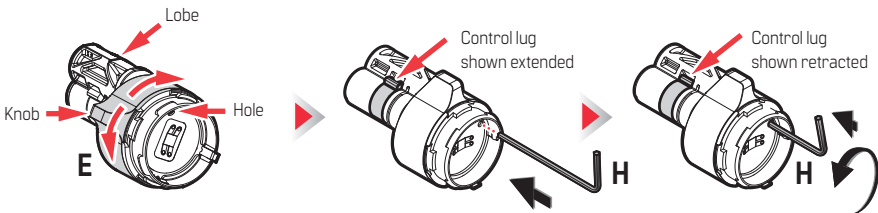

Rotate the knob to align the hole in the circuit board with the control access hole in the core (E).

Insert the hex key (H). Then gently push and rotate the hex key (H) counterclockwise to retract the control lug.

5 INSERT CORE

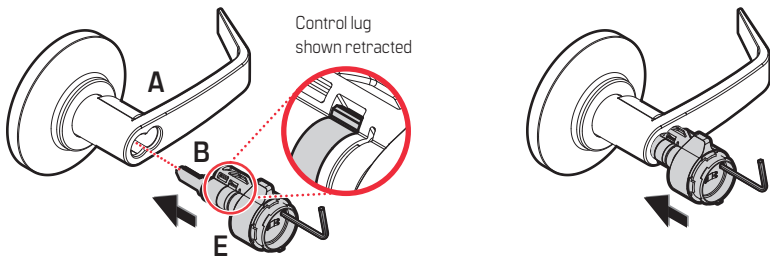

Align the throw member (B) with the lock and insert the core (E).

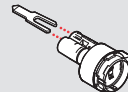

NOTE: Insert throw member (B) in core if needed.

Switch™ Core Installation Instructions

6 ENGAGE CONTROL LUG

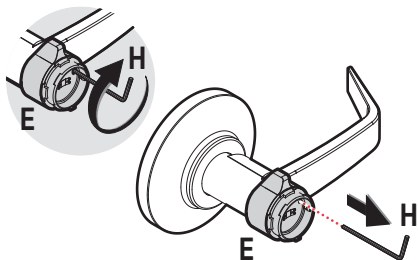

Rotate the hex key (H) clockwise to extend and engage the control lug. Remove the hex key (H). Gently pull on the knob to ensure that the core (E) is properly installed.

7 INSERT BATTERY

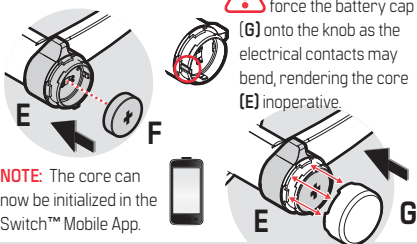

NOTE: The core can now be initialized in the Switch™ Mobile App.

Insert the battery (F) with the positive polarity facing out. Carefully align the battery cap (G) with the knob and gently press until the battery cap (G) SNAPS securely into place.



COMPLETE

Battery Tool Instructions

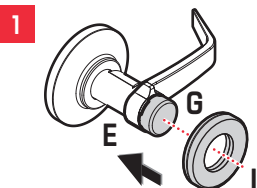
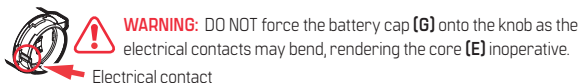

Slide the battery tool (I) over the battery cap (G).

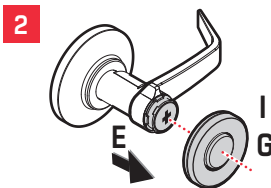

Remove the battery tool (I) and the battery cap (G).

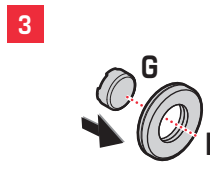

Separate the battery tool (I) and the battery cap (G).

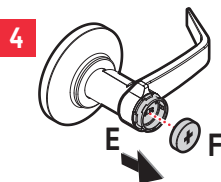

Remove the old battery (F).

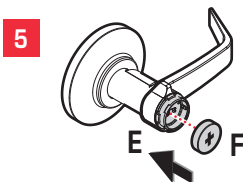

Insert the new battery (F) with the positive polarity facing out.

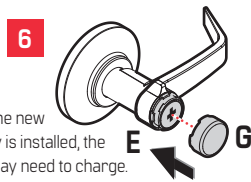

NOTE: Once the new battery is installed, the core may need to charge.

Carefully align the battery cap (G) with the knob and gently press until it SNAPS securely into place.



COMPLETE

Product Care Instructions

CAUTION: Handle the product with care. Do not spray product with foreign materials.

CAUTION: Use a clean dry or barely dry damp cloth to clean product.

SWITCH™ CORE COMPATIBILITY GUIDE



WARNING: Installing **Switch™ Core** into non-compatible hardware can result in improper lock functioning, which could present a risk to users.

Please carefully review lock compatibility prior to installation. Improper applications may prevent egress and present a danger. If you are unable to confirm compatibility or have additional questions, please contact BEST at 1-855-365-2407 or a local authorized reseller.

Is my hardware compatible with the Switch™ Core?

1.

7-pin SFIC



Is your lock fitted with a 7-pin small format interchangeable core?

YES

NO

If your answer is **YES**, proceed to question 2.

If your answer is **NO**, contact BEST at 1-855-365-2407 or a local authorized reseller.

2.

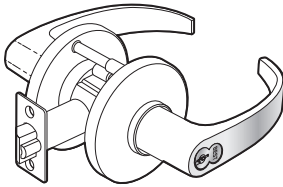

CORRECT: Face is flush with the hardware.

When installed, does the face of the core fit flush with the hardware?

YES

NO

If your answer is **YES**, proceed to **Checking Functional Compatibility** on page 5.

If your answer is **NO**, contact BEST at 1-855-365-2407 or a local authorized reseller.

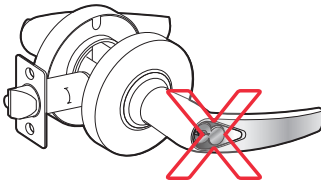

INCORRECT: Face is **NOT** flush with the hardware.

NOTE: Not recommended for some lock types. Be sure to fully check the functionality of the lock in all states [e.g. push button pressed/deadbolt thrown]. To ensure mechanical fit into your application, check an actual **Switch™ Core** or representative physical sample to ensure the **Switch™ Core** does not interfere with the normal operation of the **Lock Hardware** into which it is installed.

Checking Functional Compatibility

If your hardware has an egress lever:

Using your existing hardware and an operate key, insert the operate key into the core. Slowly rotate the operate key clockwise through the hardware's full range of operation while simultaneously and frequently checking the egress lever for any issues that could impede free egress. Repeat the procedure while rotating the operate key counterclockwise through the full range of operation. Always ensure that the **Switch™ Core** does not affect egress.

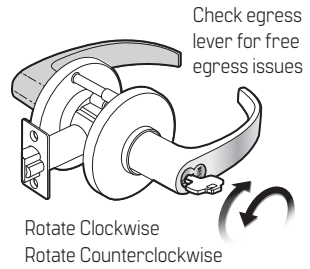

If your hardware has a thumb turn or a pushbutton:

Using your existing hardware and an operate key, insert the operate key into the core. Slowly rotate the operate key clockwise through the hardware's full range of operation while simultaneously and frequently checking the thumb turn or pushbutton for any functional issues such as jamming, catching, or the lock not functioning as designed (e.g. pressing in the pushbutton does not lock the exterior lever). Repeat the procedure while rotating the operate key counterclockwise through the full range of operation.

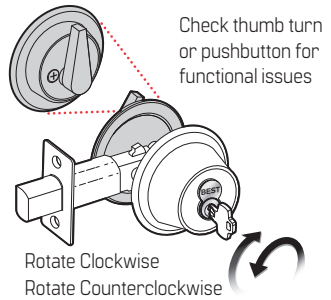

DO NOT use Switch™ Core with:

Please carefully review lock compatibility prior to installation. Improper applications may prevent egress and present a danger. If you are unable to confirm compatibility or have additional questions, please contact BEST at 1-855-365-2407 or a local authorized reseller.

Double keyed locks

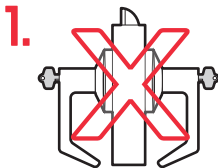

BEST 45H mortise lock with deadbolt

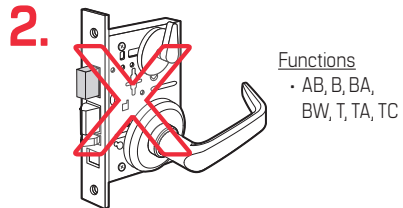

Cam lock

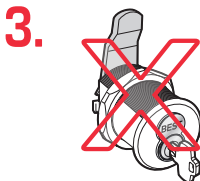

Hardware that relies on the core being held in a fixed position while secure (e.g. cam lock). Do not use in applications that require the core to hold a cam or other locking member in a fixed position to maintain security.

If you still have questions, please contact BEST at 1-855-365-2407 or a local authorized reseller.

Statement

This device complies with Part 15 of the FCC Rules. Operation is subject to the following two conditions:

- (1) This device may not cause harmful interference, and
- (2) This device must accept any interference received, including interference that may cause undesired operation.

Statement

This equipment has been tested and found to comply with the limits for Class B Digital Device, pursuant to Part 15 of the FCC Rules. These limits are designed to provide reasonable protection against harmful interference in a residential installation. This equipment generates and can radiate radio frequency energy and, if not installed and used in accordance with the instructions, may cause harmful interference to radio communications. However, there is no guarantee that interference will not occur in a particular installation. If this equipment does cause harmful interference to radio or television reception, which can be determined by turning the equipment off and on, you can try to correct the interference by taking one or more of the following measures.

- Reorient or relocate the receiving antenna.
- Increase the separation between the equipment and receiver.
- Connect the equipment into an outlet on a circuit different from that to which the receiver is connected.
- Consult the dealer or an experienced radio/TV technician for help.

Statement

THIS DEVICE COMPLIES WITH INDUSTRY CANADA LICENCE-EXEMPT RSS STANDARD(S).

Operation is subject to the following two conditions:

- (1) This device may not cause interference and
- (2) This device must accept any interference,

including any interference that may cause undesired operation of the device.

This Class [B] digital apparatus meets all requirements of the Canadian Interference-Causing Equipment Regulations.

CET APPAREIL EST CONFORME À LA NORME RSS INDUSTRIE CANADA EXEMPT DE LICENCE.

Son fonctionnement est soumis aux deux conditions suivantes:

- (1) Cet appareil ne doit pas provoquer d'interférences et
- (2) Cet appareil doit accepter toute interférence, y compris les interférences pouvant causer un mauvais fonctionnement du dispositif.

Cet appareil numérique de la classe [B] respecte toutes les exigences du Règlement sur le matériel brouilleur du Canada.



WARNING: Changes or modifications not expressly approved by **dormakaba** could void the user's authority to operate the equipment.

WARNING

 **WARNING:** This manufacturer advises that no lock can provide complete security by itself. This lock may be defeated by forcible or technical means, or evaded by entry elsewhere on the property. No lock can substitute for caution, awareness of your environment, and common sense. Builder's hardware is available in multiple performance grades to suit the application. In order to enhance security and reduce risk, you should consult a qualified locksmith or other security professional.

 **WARNING:** The **Switch™ Core** contains a CR2477 lithium battery. If the lithium battery is swallowed, it can cause severe internal burns in just 2 hours and can lead to death. Keep new and used lithium batteries away from children. If you think the lithium battery might have been swallowed or placed inside of the body, seek immediate medical attention.

 **WARNING:** This product ships with a CR2477 lithium battery. When returning this product, please follow proper lithium battery shipment guidelines.

FOR PRODUCT RETURNS:

All product returns must complete the following steps.

1. Contact dormakaba Customer Service at **1-855-365-2407** to initiate the product return process.
2. Remove the product battery prior to shipping and dispose of in accordance with local, state or federal regulatory requirements. Do not ship batteries to dormakaba USA Inc.



 **WARNING: Cancer and Reproductive Harm**
www.P65Warnings.ca.gov

 **WARNING: Perchlorate Material-special handling may apply**
<http://www.dtsc.ca.gov/hazardouswaste/perchlorate>

CAUTION

 **CAUTION:** Install a new CR2477 lithium battery from the list of suppliers recommended by BEST. Not all CR2477 lithium batteries are dimensionally and electrically compatible.

 **CAUTION:** Danger of explosion if the lithium battery is incorrectly installed. Only install a CR2477 lithium battery.



For Complete Online Instructions Visit: **BEST**
<https://support.bestaccess.com/hc/en-us/articles/360036366673>

Android is a trademark of Google LLC.
iPhone is a trademark of Apple Inc., registered in the U.S. and other countries and regions. App Store is a service mark of Apple Inc.

For Assistance or Warranty Information:
Call 1-855-365-2407 or visit
www.bestaccess.com