

P 214 – wireless headphone

User Instruction

Version: 1.0
Date: 2011-07-19
Edit: S. Voegele

HBAS Description	HBAS PN	Daimler PN
HEADPH. MB 2CH. KLEER_TECHN. P214	2115395	A212 870 47 89

HAD Type No.: 9079

Content

1	USER INFORMATION	3
1.1	Purpose	3
2	MAIN FEATURES	3
2.1	Product Description	3
3	TECHNICAL CONCEPT	4
3.1	Acoustic	4
3.2	Application	4
3.3	Design.....	4
3.4	Size Adjustment.....	4
3.5	Storage	4
3.6	Battery compartment	4
3.7	Power Supply.....	5
4	USER INTERFACE	5
4.1	On/Off Button.....	5
4.2	Source Selection.....	6
4.3	Volume Control.....	6
4.4	Status Indication LED	7
4.5	Function and Battery Status	7
5	TECHNICAL INFORMATION.....	7
5.1	Mechanical Features	7
5.2	Materials	7
5.3	Declaration of Conformity to EC regulation R&TTE	8
5.4	FCC statements (North America)	9
5.5	Industry Canada (IC) statement.....	9
5.6	Environmental information	10

1 User Information

1.1 Purpose

This document describes the features, functionality and usage of the P 214 headphone featured by Klear technology. It contains and specifies all relevant information about the headphone's appearance and the environment it is designated to be used in.

2 Main Features

- ❖ Lossless digital audio wireless transmission
- ❖ Rich sound through 40 mm transducer
- ❖ Folding mechanism for easy storage
- ❖ Comfortable through ergonomic fit and gimbaled earphones
- ❖ Adjustable from children to adults



2.1 Product Description

P214 is wireless stereo headphones, featuring Klear technology for lossless digital audio transmission and operates in 2.4GHz ISM band. They are designed for individual entertainment in vehicles and meets the relevant requirements, such as widened operating temperature range, low battery consumption for longer battery life and low signal latency for lip-sync. The channel switch provides the facility to select between two different sources.

P214 is powered with two AAA batteries. Both, disposable and rechargeable can be used. An LED indicates the functional state, but also turns from green to red when the batteries' voltage reaches the low level to signalize that they have to be changed soon.

Acoustical characteristic is semi-closed with supra-aural earphones. Sound radiation to the environment is low, so that other passengers will not be disturbed.

The mechanic design guarantees comfortable wearing constantly for several hours.

3 Technical Concept

3.1 Acoustic

Acoustic characteristic is semi-closed with supra-aural earphones.

Sound radiation to the environment is low, so that other passengers will not be disturbed. Radiation at comfortable listening level is below car background noise, based on noise-level of modern cars.

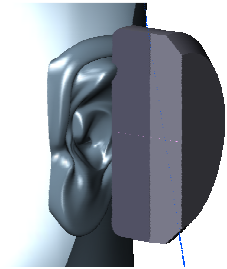

3.2 Application

The headphones will be used in Daimler vehicles with audio/video systems for max. 5 seats and 4 individual stereo audio programs at the same time (= 4 transmitter).

A broadcasting capability of each transmitter up to maximum four receivers is granted.

3.3 Design

P 214 is designed to combine the comfort and acoustical performance of high class headphones and the requirements for automotive headphones that share a common mechanical and acoustical basis.

Comfort is provided by ergonomic adjustment features. The head-bow slider covers head sizes from children to adult. Gimbaled ear cups adjust to individual head-shapes and ear-position.

3.4 Size Adjustment

The headphones are designed for children and adults. Size adjustment is realized through sliders in the head-bow. The sliding mechanism has several latches to remember the individual position.

3.5 Storage

The headphone can be folded for storage purposes.

3.6 Battery compartment

The battery compartment has a child-proof lock that can easily be opened with a coin, credit-card or something similar.



Image 3.6-1

- to open the battery compartment - flip battery compartment cover upwards. As you do so, hold the left-hand side of the headphones to prevent the batteries from falling out.
- Remove the discharged batteries from the tray
- Insert the new batteries. Observe the polarity markings on the batteries and battery tray when doing so.
- To close the battery compartment – press battery compartment cover downwards until it engages into place. If the batteries have been inserted correctly, the indicator lamp will light up green when the headphones are switched on.

3.7 Power Supply

The headphone is powered with two AAA batteries*. Both, disposable and rechargeable can be used. Auto-off-feature ensures that the headphone will turn off after 3 min. of no receiving RF signal to avoid unintended discharge of batteries.

* Recommended: Energizer EN92 (included in delivery)

At low battery level the power-LED changes from green to red (see also [Status Indication LED](#)).

4 User Interface

4.1 On/Off Button

The On/Off button is positioned on the left ear cup and toggles between ON and OFF status. The button is recessed from the surface to avoid unintended operation.



Image 4.1-1

When powered on, the headphone automatically starts in enrollment mode to get connected to the Source (SRC sound transmitter) selected by the channel switch. If there should be no SRC found to connect to, the headphone turns off after 3min (\approx Enrollment Time-Out) to save the battery.

4.2 Source Selection

P214 has a sliding switch on the right ear-cup for selecting the SRC, user wants to connect to. The two available switch positions are marked with “L” for left and “R” for right position on the rear seat. On switching the source while operating, the connection to the current SRC gets terminated and another one to the other SRC is established.



Image 4.2-1

4.3 Volume Control

Volume power can be adjusted with an analog rotary potentiometer placed on the right ear-cup. Before putting on the headphones, make sure that the volume has not been set too high!



Image 4.3-1

NOTE:

“Using headphones at high volume levels, particularly over extended periods of time, may damage your hearing.”

4.4 Status Indication LED

A red/green LED provides the information of the functional status as illustrated in following table.



Image 4.4-1

4.5 Function and Battery Status Indication		Functional Status Indication			
		• Powered booting	• Powered, Enrollment Mode *	• Powered, Connected	• Long Press, Association Mode *
Battery Status Indication	Battery OK (>2.1V)	LED glows green	LED is flashing at 5Hz	LED glows green	LED is flashing (ON/OFF = 1/5)
	Battery Low (≤2.1V)	LED glows red	LED is flashing at 5Hz	LED glows red	LED is flashing (ON/OFF = 1/5)

Table 4.4-1 Status indication table

Image 4.4-2

5 Technical Information

5.1 Mechanical Features

- P214 is adjustable in size to fit from children to adults
- Foldable for easy storage
- When placed on the seat, the product will withstand an adult person accidentally sitting on it.
- The headphone features round edges to prevent injury.
- The design of the headphone bears the customer logo, printed on both ear cups.

5.2 Materials

P214 is in compliance with the latest releases of directives RoHS (2002/95/EC) and ELV (2000/53/EC), and also the REACH regulation (EC) No. 1907/2006.

Marking of polymer parts acc. to VDA 260 respectively EN ISO 1043.



No.	Part	Material
1	Bow	PBT
2	Bow pad	
3	Earcups	ABS
4	Outer plug left+right	ABS
5	Battery cover	ABS
5	Battery door hook	PA
5	Battery-contact bridge	
6	ON Button	ABS
	Channel Switch	ABS

Table 5.2-1

5.3 Declaration of Conformity to EC regulation R&TTE



Česky [Czech]:	HARMAN tímto prohlašuje, že tento P214-Headphone je ve shodě se základními požadavky a dalšími příslušnými ustanoveními směrnice 1999/5/ES.
Dansk [Danish]:	Undertegnede HARMAN erklærer herved, at følgende udstyr P214-Headphone overholder de væsentlige krav og øvrige relevante krav i direktiv 1999/5/EF.
Deutsch [German]:	Hiermit erklärt HARMAN, dass sich das Gerät P214-Headphone in Übereinstimmung mit den grundlegenden Anforderungen und den übrigen einschlägigen Bestimmungen der Richtlinie 1999/5/EG befindet.
Eesti [Estonian]:	Käesolevaga kinnitab HARMAN seadme P214-Headphone vastavust direktiivi 1999/5/EÜ põhinõuetele ja nimetatud direktiivist tulenevatele teistele asjakohastele sätetele.
English:	Hereby, HARMAN, declares that this P214-Headphone is in compliance with the essential requirements and other relevant provisions of Directive 1999/5/EC.
Español [Spanish]:	Por medio de la presente HARMAN declara que el P214-Headphone cumple con los requisitos esenciales y cualesquiera otras disposiciones aplicables o exigibles de la Directiva 1999/5/CE.
Ελληνική [Greek]:	ΜΕ ΤΗΝ ΠΑΡΟΥΣΑ ΗΛΩΝΕΙ ΟΤΙ Ρ214-Headphone ΣΥΜΜΟΡΦΩΝΕΤΑΙ ΠΡΟΣ ΤΙΣ ΟΥΣΙΩΔΕΙΣ ΑΠΑΙΤΗΣΕΙΣ ΚΑΙ ΤΙΣ ΛΟΙΠΕΣ ΣΧΕΤΙΚΕΣ ΔΙΑΤΑΞΕΙΣ ΤΗΣ ΟΔΗΓΙΑΣ 1999/5/ΕΚ.
Français [French]:	Par la présente HARMAN déclare que l'appareil P214-Headphone est conforme aux exigences essentielles et aux autres dispositions pertinentes de la directive 1999/5/CE.
Italiano [Italian]:	Con la presente HARMAN dichiara che questo P214-Headphone è conforme ai requisiti essenziali ed alle altre disposizioni pertinenti stabilite dalla direttiva 1999/5/CE.
Latviski [Latvian]:	Ar šo HARMAN deklarē, ka P214-Headphone atbilst Direktīvas 1999/5/EK būtiskajām prasībām un

	ciem ar to saistītajiem noteikumiem.
Lietuvių [Lithuanian]:	Šiuo HARMAN deklaruoja, kad šis P214-Headphone atitinka esminius reikalavimus ir kitas 1999/5/EB Direktyvos nuostatas.
Nederlands [Dutch]:	Hierbij verklaart HARMAN dat het toestel P214-Headphone in overeenstemming is met de essentiële eisen en de andere relevante bepalingen van richtlijn 1999/5/EG.
Malti [Maltese]:	Hawnhekk, HARMAN, jiddikjara li dan P214-Headphone jikkonforma mal-htigijiet essenzjali u ma provvedimenti oħrajn relevanti li hemm fid-Dirrettiva 1999/5/EC.
Magyar [Hungarian]:	Alulírott, HARMAN nyilatkozom, hogy a P214-Headphone megfelel a vonatkozó alapvető követelményeknek és az 1999/5/EC irányelv egyéb előírásainak.
Polski [Polish]:	Niniejszym HARMAN oświadcza, że P214-Headphone jest zgodny z zasadniczymi wymogami oraz pozostałymi stosownymi postanowieniami Dyrektywy 1999/5/EC
Português [Portuguese]:	HARMAN declara que este P214-Headphone está conforme com os requisitos essenciais e outras disposições da Directiva 1999/5/CE.
Slovensko [Slovenian]:	HARMAN izjavlja, da je ta P214-Headphone v skladu z bistvenimi zahtevami in ostalimi relevantnimi določili direktive 1999/5/ES.
Slovensky [Slovak]:	HARMAN týmto vyhlasuje, že P214-Headphone spĺňa základné požiadavky a všetky príslušné ustanovenia Smernice 1999/5/ES.
Suomi [Finnish]:	HARMAN vakuuttaa täten että P214-Headphone tyyppinen laite on direktiivin 1999/5/EY oleellisten vaatimusten ja sitä koskevien direktiivin muiden ehtojen mukainen.
Svenska [Swedish]:	Härmed intygar HARMAN att denna P214-Headphone står i överensstämmelse med de väsentliga egenskapskrav och övriga relevanta bestämmelser som framgår av direktiv 1999/5/EG.
Íslenska [Icelandic]:	Hér með lýsir HARMAN yfir því að P214-Headphone er í samræmi við grunnkröfur og aðrar kröfur, sem gerðar eru í tilskipun 1999/5/EC
Norsk [Norwegian]:	HARMAN erklærer herved at utstyret P214-Headphone er i samsvar med de grunnleggende krav og øvrige relevante krav i direktiv 1999/5/EF.

5.4 FCC statements (North America)

(§15.19)

"This device complies with Part 15 of the FCC Rules. Operation is subject to the following two conditions:

- (1) this device may not cause harmful interference, and**
- (2) this device must accept any interference received, including interference that may cause undesired operation"**

and (§15.21)

"CAUTION TO USERS" / "FCC WARNING"

"Changes or modifications not expressly approved by the party responsible for compliance could void the user's authority to operate the equipment "

5.5 Industry Canada (IC) statement

This Class B digital apparatus complies with Canadian ICES-003.

Cet appareil numérique de la classe B est conforme à la norme NMB-003 du Canada.

5.6 Environmental information

Batteries contain harmful substances. Please don't throw into household trash. Use environmental disposal.