

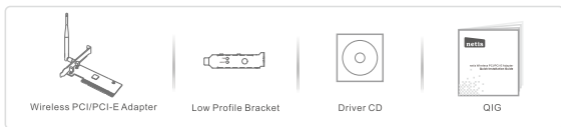

netis Wireless PCI/PCI-E Adapter
Quick Installation Guide

Model No. WF2166
WF2117
WF2118
WF2113

1.Package Contents



*The product model shown in this QIG is WF2117, as an example.

2.Hardware Connection

- 2.1. Turn off your computer and open the case.
- 2.2. Plug the wireless PCI (/PCI-E) adapter into an available PCI (/PCI-E) slot.
- 2.3. Close the case and turn on your computer.

Tip: If your computer is with a small case that the fixed full height profile bracket doesn't match, please use the attached low profile bracket instead.

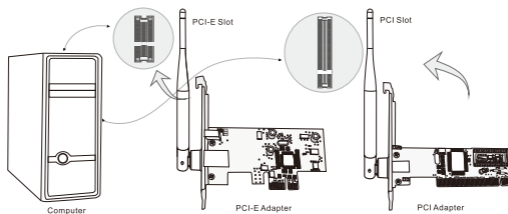

3.Driver Installation

- 3.1. Insert the netis Driver CD into your CD-ROM drive.

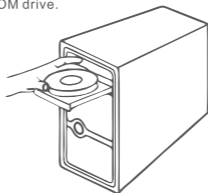

3.2. Install the provided driver from the CD.

For Windows 8/7/Vista/XP

The **Setup Wizard** on the CD will guide you through the driver installation procedures.

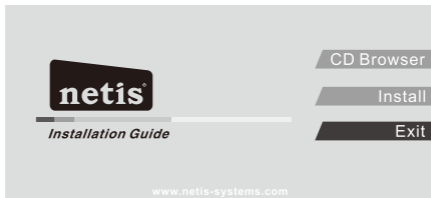

Simply click "**Install**". The netis smart driver assistant will choose the correct driver program automatically based on your Windows operating system.

The **InstallShield Wizard** window will appear, then please click "**Next**" and follow the step by step procedures to finish the driver installation.

For Linux (WF2117/WF2118/WF2113)

You may get the available driver files from the "**Driver**" > "**Linux**" folder in the CD.

Tip: For further steps, please visit netis website at www.netis-systems.com.

4. Connect to the Wireless Network

For Windows 8/7/Vista/XP

(Here we take Windows 7 for example.)

After driver installation, please click on the wireless network connection icon in the lower right corner of the task bar. Choose the available wireless network, and click on the "**Connect**" button to setup a wireless connection.

If the wireless network is secured, enter the security key/ password in the next popup window.

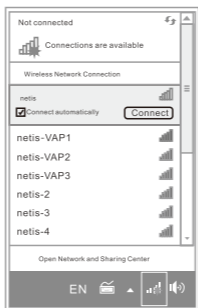

For Linux (WF2117/WF2118/WF2113)

(Here we take Ubuntu for example.)

Choose the available wireless network to setup a wireless connection.

If the wireless network is secured, enter the password in the popup window.

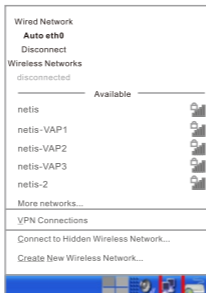

Technical Support:

USA/Canada:

Toll Free:+1 866 71 network(+1866 716 3896)

E-mail:usa_support@netis-systems.com

Other Regions:

E-mail:support@netis-systems.com



Adaptador de red inalámbrica netis PCI/PCI-E
Guía de Instalación Rápida

Model No. WF2166
WF2117
WF2118
WF2113

1.Contenido del empaque



2.Conexión del Hardware

- 2.1. Apague el ordenador y abra la caja.
- 2.2. Enchufe la PCI/PCI-E inalámbrico del adaptador en una ranura disponible de PCI/PCI-E .
- 2.3. Cierre la caja y encienda el ordenador.

Consejo: Si el ordenador está con una caja pequeña que no coincide con el soporte perfil largo, por favor, utilice en su lugar el soporte de perfil bajo adjunto aquí.

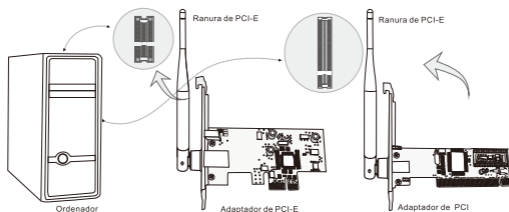

3.Instalación del Driver

- 3.1.Introduzca el CD del Driver netis en la unidad del CD-ROM.

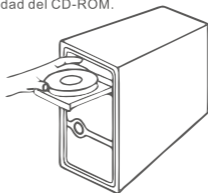

3.2. Instale el driver que está en el CD.

Para Windows 8/7/Vista/XP

El **Asistente de Instalación** en el CD le indicará los procedimientos de instalación del controlador.

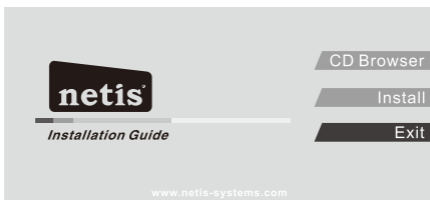

Simplemente haga clic en **“Install” (Instalar)**. El asistente del smart driver netis elegirá automáticamente el correcto programa del driver en función de su sistema operativo de Windows.

Aparecerá la ventana del **Asistente de Instalación**, a continuación, haga clic en **“Siguiete”** y siga las instrucciones paso a paso de los procedimientos para finalizar la instalación del driver.

Para Linux (WF2117/WF2118/WF2113)

Puede encontrar los archivos de los driver disponibles en la carpeta del **“Driver”> “Linux”** que está en el CD.

Consejo: Para más pasos, por favor visite el sitio web de netis www.netis-systems.com.

4. Conectar a la red inalámbrica

Para Windows 8/7/Vista/XP

(Nosotros tomamos como ejemplo el Windows 7.)

Después de la instalación del driver, haga clic en el icono de conexión de red inalámbrica en la esquina inferior derecha de la barra de tareas. Seleccione la red inalámbrica disponible, y para configurar una conexión inalámbrica haga clic en el botón **“conectar”(Connect)**.

Si la red inalámbrica está protegida, introduzca en la siguiente ventana emergente la clave de seguridad / contraseña.

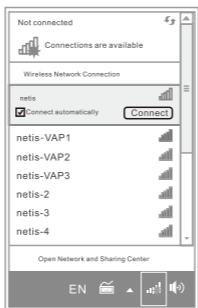

Para Linux (WF2117/WF2118/WF2113)

(Nosotros tomamos como ejemplo Ubuntu.)

Seleccione la red inalámbrica disponible para configurar una conexión inalámbrica.

Si la red inalámbrica está protegida, introduzca en la ventana emergente la contraseña.



Soporte Técnico: support@netis-systems.com



Adaptador PCI/PCI-E Wireless da netis
Guia de Instalação Rápida

A decorative graphic in the bottom-left corner consisting of a grid of small squares. The squares are arranged in a pattern that tapers to the right, with some squares missing, creating a fragmented, pixelated effect. The squares are in shades of gray.

Model No. WF2166
WF2117
WF2118
WF2113

1. Conteúdos da Embalagem



2. Conexão de Hardware

- 2.1. Desligue o seu computador e abra a torre/caixa do computador.
- 2.2. Ligue o adaptador PCI (/PCI-E) wireless a uma ranhura PCI (/PCI-E) disponível.
- 2.3. Feche a torre e ligue o seu computador.

Dica: Se o seu computador tem uma torre pequena e o perfil longo fixo não encaixa, utilize o de baixo perfil anexado.

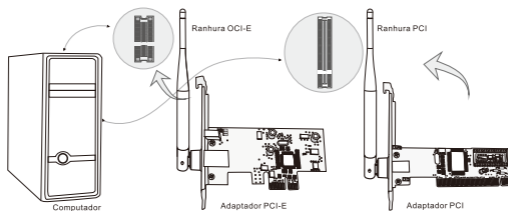

3. Instalação do Driver

- 3.1. Insira o CD de Driver da netis no leitor de CD-ROM.

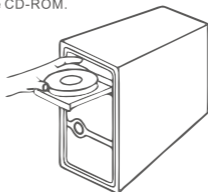

3.2. Instale o driver fornecido no CD.

Para Windows 8/7/Vista/XP

O **Assistente de Configuração** do CD irá guiar através dos passos de instalação do driver.

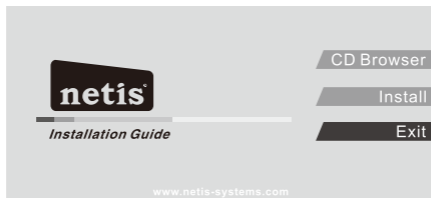

Clique em **“Install”(Instalar)**. O assistente de driver inteligente da netis irá escolher o programa de driver correcto automaticamente baseado no seu sistema operativo Windows. A janela de **Assistente de Instalação** irá aparecer. Clique em **“Seguinte”** e siga os passos para concluir a instalação do driver.

Para Linux (WF2117/WF2118/WF2113)

Pode obter os ficheiros de driver disponíveis na pasta **“Driver”** > **“Linux”** do CD.

Dica: Para os seguintes passos, visite o website da netis em www.netis-systems.com.

4. Conexão à Rede Wireless

Para Windows 8/7/Vista/XP

(Aqui utilizamos o Windows 7 como exemplo.)

Após a instalação do driver, clique no ícone de conexão de rede wireless no canto inferior direito da barra de tarefas. Escolha a rede wireless disponível, e clique no botão **“Ligar” (Connect)** para definir a conexão wireless.

Se a rede wireless for segura, introduza a chave de segurança/palavra passe na janela seguinte.

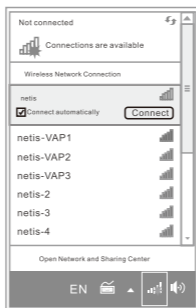

Para Linux (WF2117/WF2118/WF2113)

(Aqui utilizamos Ubuntu como exemplo.)

Escolha a rede wireless disponível para definir a conexão wireless.

Se a rede wireless for segura, introduza a palavra passe na janela seguinte.



Apoio Técnico: support@netis-systems.com



CARTE RÉSEAU PCI/ PCI-E WI-FI GUIDE D'INSTALLATION RAPIDE



Model No. WF2166
WF2117
WF2118
WF2113

1-Contenu de la boites



2-Connexion du materiel

- 2.1-Eteignez votre ordinateur et ouvrez le boîtier.
- 2.2-Branchez la carte réseau PCI/ PCI-Express dans un slot correspondant disponible.
- 2.3-Refermez le boîtier et allumez l'ordinateur.

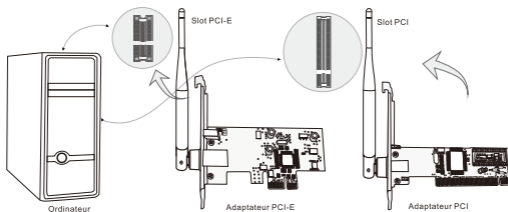

3-Installation du pilote

- 3.1-Insérez le CD fourni dans votre lecteur.

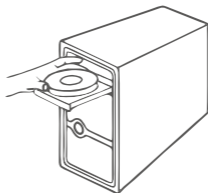

3.2- Installation du pilote.

Sous Windows 8/7/Vista/XP

L'assistant qui se trouve sur le CD vous guide tout au long de l'installation.

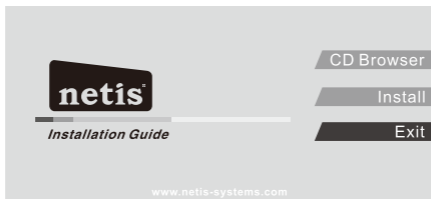

Cliquez sur **Install [Installer]**. L'assistant vous aide à sélectionner le pilote adapté à votre système d'exploitation.

Une boîte de dialogue **InstallShield Wizard** s'affiche à l'écran. Cliquez sur **Next [Suivant]** et suivez les étapes comme indiqué à l'écran.

Sous Linux (WF2117/WF2118/WF2113)

Sur le CD, allez dans **Driver > Linux**.

Pour plus de détails, allez sur www.netis-systems.com.

4-Connexion au réseau sans fil

Sous Windows 8/7/Vista/XP

Une fois le pilote installé, cliquez sur l'icône des connexions sans fil qui se trouve dans la barre des tâches. Sélectionnez le réseau sans fil disponible auquel vous souhaitez vous connecter et cliquez sur le bouton **Connect [connexion]** pour paramétrer la connexion sans fil.

Si la connexion sans fil est sécurisée, entrez le code dans le champ correspondant.

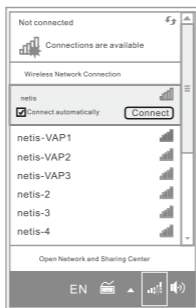

Sous Linux (WF2117/WF2118/WF2113)

Sélectionnez le réseau sans fil disponible auquel vous souhaitez vous connecter. Si l'icône indique une connexion sécurisée, entrez le mot de passe dans le champ correspondant.



Support technique : support@netis-systems.com



Appendix: FCC Statement

This equipment has been tested and found to comply with the limits for a Class B digital device, pursuant to part 15 of the FCC Rules. These limits are designed to provide reasonable protection against harmful interference in a residential installation. This equipment generates uses and can radiate radio frequency energy and, if not installed and used in accordance with the instructions, may cause harmful interference to radio communications. However, there is no guarantee that interference will not occur in a particular installation. If this equipment does cause harmful interference to radio or television reception, which can be determined by turning the equipment off and on, the user is encouraged to try to correct the interference by one or more of the following measures:

- Reorient or relocate the receiving antenna.
- Increase the separation between the equipment and receiver.
- Connect the equipment into an outlet on a circuit different from that to which the receiver is connected.
- Consult the dealer or an experienced radio/TV technician for help.

FCC Radiation Exposure Statement

This device complies with FCC radiation exposure limits set forth for an uncontrolled environment and it also complies with Part 15 of the FCC RF Rules. This transmitter must not be co-located or operating in conjunction with any other antenna or transmitter. This equipment should be installed and operated with a minimum distance of 20 centimeters between the radiator and your body.

This device complies with Part 15 of the FCC Rules. Operation is subject to the following two conditions:

- (1) this device may not cause harmful interference, and
- (2) this device must accept any interference received, including interference that may cause undesired operation.

Caution!

Any changes or modifications not expressly approved by the party responsible for compliance could void the user's authority to operate the equipment.

Operations in the 5150 to 5250MHz band are restricted to indoor use only.

NETIS SYSTEMS CO., LTD.
www.netis-systems.com
MADE IN CHINA

PKUM05426

