

# Blue Line TriTech Motion Detector ISC-BDL2-W12

CE EN 50131-2-4 Grade 2  
EN 50130-5 Environmental Class II  
IP30 IK04 (EN 60529, EN 50102)



Solo il modello ISC-BDL2-W12 è certificato IMQ – Sistemi di sicurezza al primo livello di prestazione. La certificazione IMQ – Sistemi di sicurezza del MODELLO ISC-BDL2-W12 decade nel caso di installazione del rilevatore con gli snodi opzionali B328, B338, B335.

### FCC and RSS-210

This device complies with Part 15 of the FCC Rules and with RSS-210 of Industry and Science Canada. Operation is subject to two conditions:

1. This device cannot cause harmful interference.
2. This device must accept any interference, including interference that might cause undesired operation.

Changes or modifications not expressly approved by Bosch Security Systems can void the user's authority to operate the equipment.

### UL

Use only a Listed limited-power source.

### SELV

Connect all wiring to a safety extra-low voltage (SELV) circuit only.

Sluit alle bedrading uitsluitend aan op een circuit met een extra lage veiligheidsspanning.

Prenez soin de connecter tous les câbles à un circuit à très basse tension de sécurité (TBTS).

Alle Drähte sind ohne Ausnahme an Niederspannung anzuschließen.

Collegare tutti i cavi esclusivamente a un circuito SELV (circuito di sicurezza a bassissima tensione).

Ligue todas as cablagens apenas a um circuito de segurança de tensão extra baixa (SELV).

Conecte el cableado únicamente a un circuito de seguridad para voltajes muy bajos (SELV).



✓  
2,2 m - 2,75 m  
(7.5 ft - 9 ft)

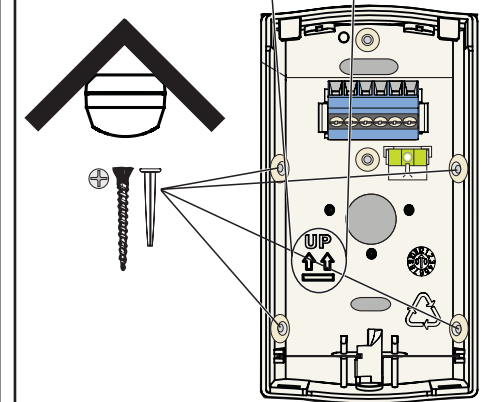
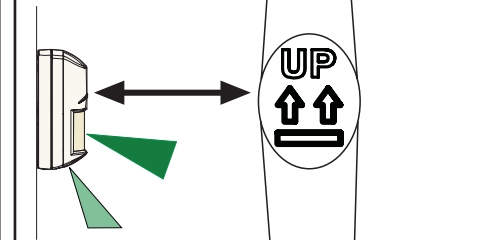
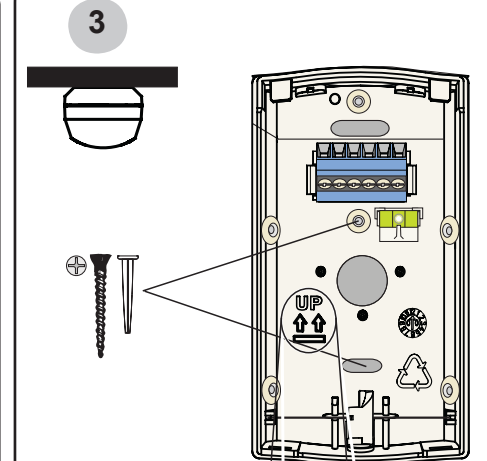
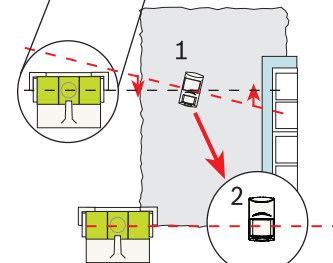
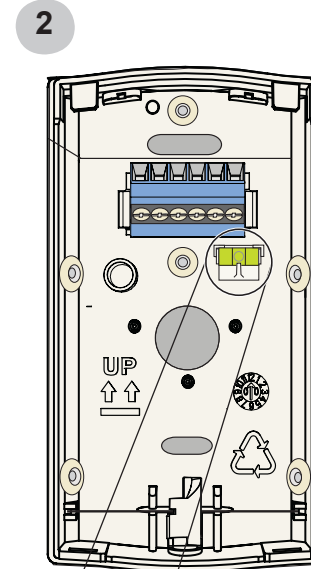
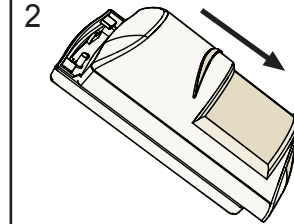
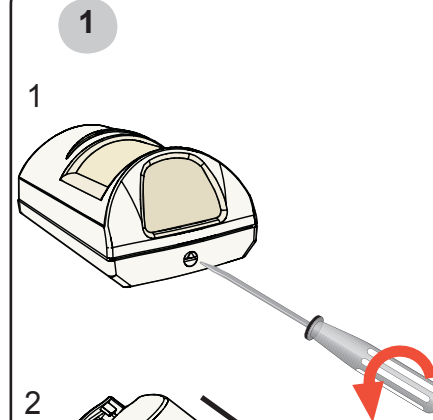
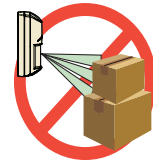
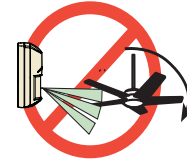
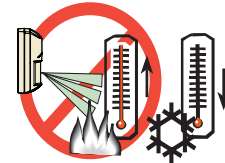
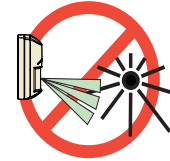
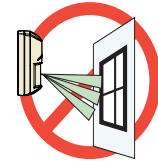
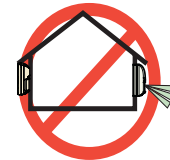
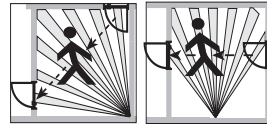
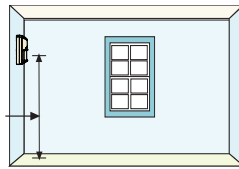

www.boschsecurity.com

© 2009 Bosch Security Systems, Inc.  
F01U140813-01

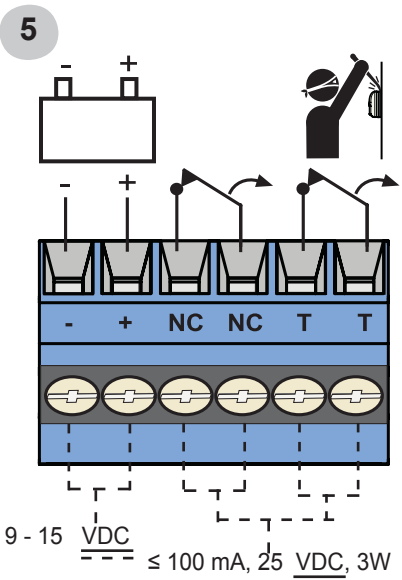
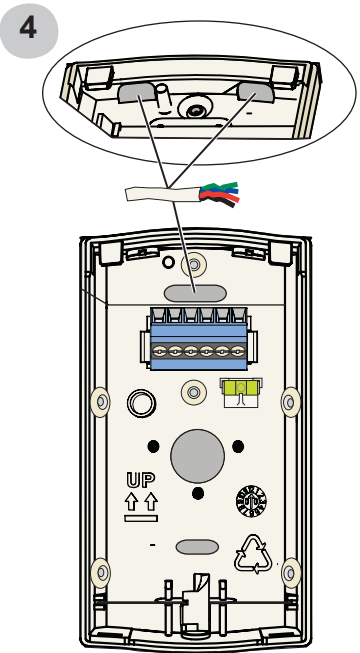

10 mA @ 12 VDC  
 NF 10-15 Vcc  
 10 mA @ 12 Vcc en veille/  
 en alarme, source limitée en puissance,  
 ondulation résiduelle 1 V.  
 UL Listed product installations, provide 4 h (40 mAh)  
 standby power from the control unit or by a UL Listed  
 burglary power supply.

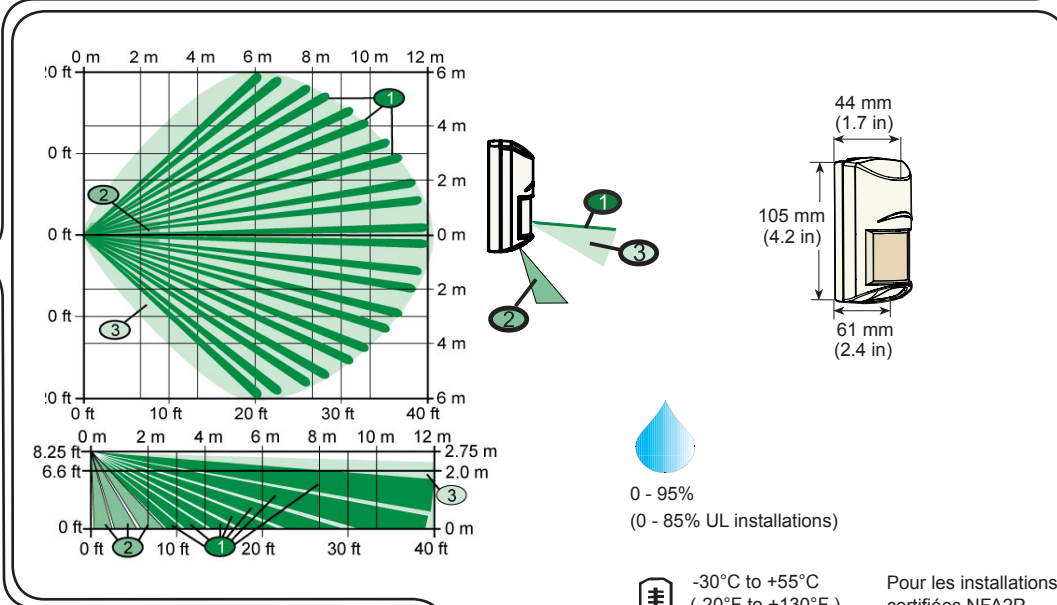
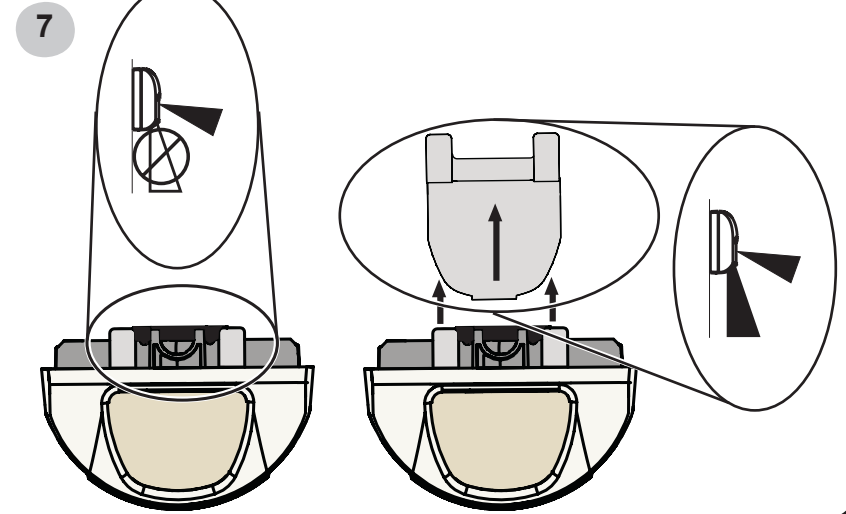
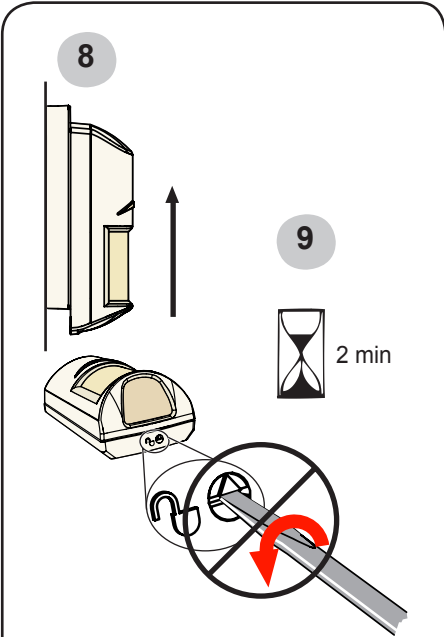
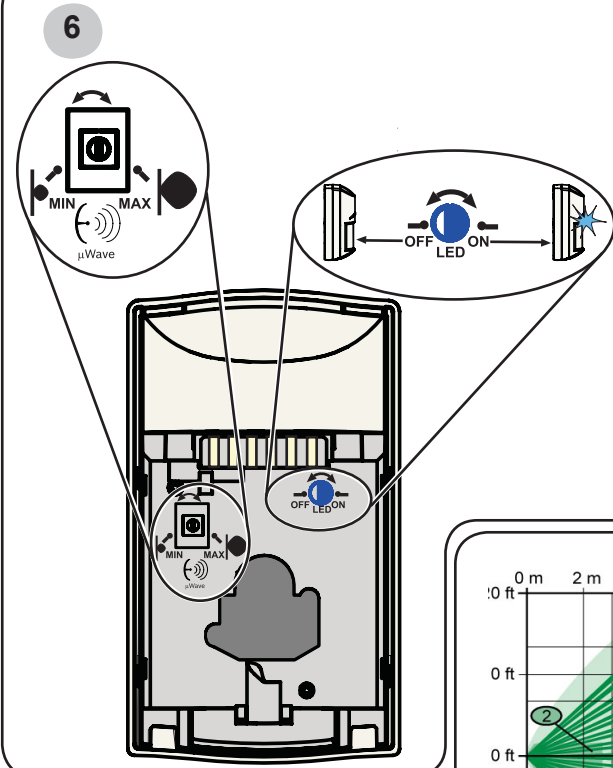

0 - 95%  
 (0 - 85% UL installations)

-30°C to +55°C  
 (-20°F to +130°F)  
 UL Listed installations,  
 range is 0°C to +49°C  
 (+32°F to +120°F)

Pour les installations  
 certifiées NFA2P,  
 Température de  
 fonctionnement  
 -10°C à +55°C

? → [www.boschsecurity.com](http://www.boschsecurity.com)

© 2009 Bosch Security Systems, Inc.  
 F01U140813-01

