

Yealink

Certified for
Microsoft Teams

zoomrooms

Yealink MeetingBar A20 Teams&Zoom Kit



English | 简体中文

Quick Start Guide (v15.1)
快速入门指南

Package Contents

• Standard accessories



MeeingBar A20



3m Ethernet Cable

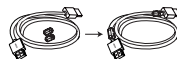

1.8m HDMI Cable x2
(for the display device)



Cable Tix5

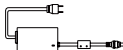

Power Adapter

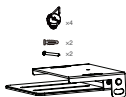

Mounting Bracket and Accessories



Silicone Pad x2



Quick Start Guide

• Optional accessories

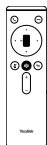

VCR20-Teams



AAA Battery x2

Remote Control Package (only Teams edition)



CTP18



7.5m Ethernet Cable

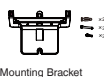

Mounting Bracket and Accessories



Screwdriver



Cable Lock Box

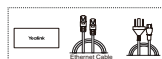

PoE Adapter

Touch Panel Package



VCH51



Interface Protective Cover



7.5m Ethernet Cable



0.6m HDMI Cable



0.6m USB Type-C Cable

VCH51 Sharing Kit



WPP20

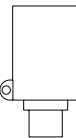

Type-C Adapter

Wireless Presentation Pod

Endpoint Connection

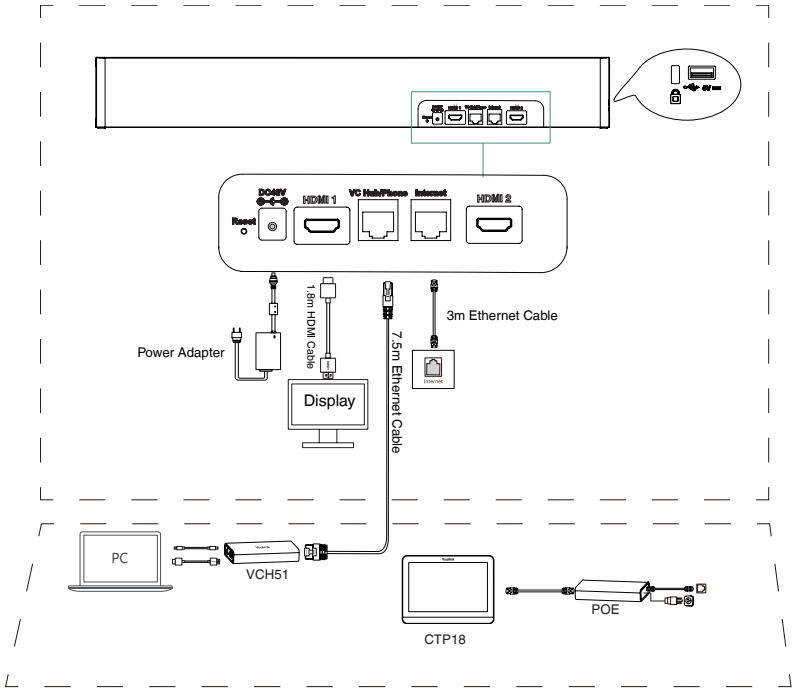

CTP18 Connection

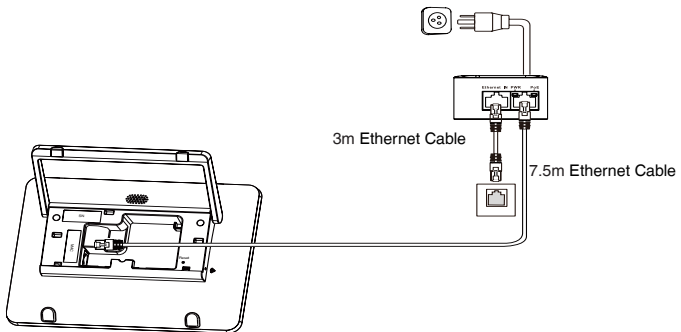

Wireless Sharing

You can use Yealink WPP20 wireless presentation pod for wireless content sharing.

1. Connect the WPP20 to the USB port of the A20.
2. Wait for 3 seconds, the WPP20 LED indicator glows solid green after flashing twice.

The WPP20 is paired with the A20 successfully.

3. Connect the WPP20 to the PC.

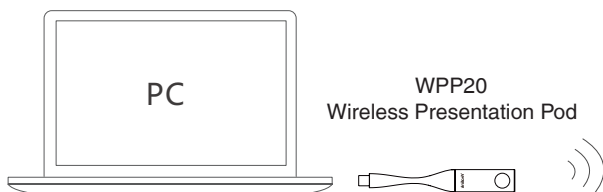

Remote Control and Cable Ties Installation

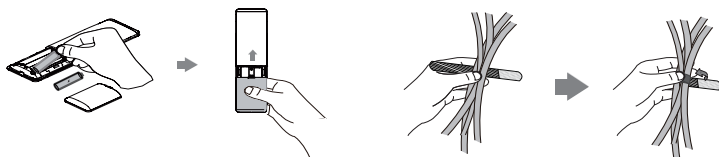

VCR20-Teams Remote Control Introduction(Teams)

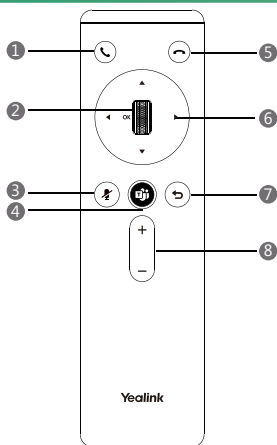

- 1 Answer Key**
Press to answer a call.
- 2 Scroll Wheel/OK Key**
 - Scroll up to increase the focal length of the camera.
 - Scroll down to decrease the focal length of the camera.
 - Press to confirm the action.
- 3 Mute Key**
Press to mute or unmute microphone.
- 4 Teams Key**
Press to join meeting.
- 5 End Call Key**
Press to leave a meeting.
- 6 Navigation Key**
Navigate through menu items.
- 7 Back Key**
Press to return to the previous menu.
- 8 Volume Up/Down Key**
Press to increase/decrease the volume.

Camera Settings

You can configure your camera.

Go to (Teams: **More > Settings > Device Settings**)

(Zoom: **Settings > System Settings**)

Select **Exposure Settings**, **White Balance Settings** and **Graphics** to configure exposure, white balance and so on.

Go to (Teams: **More > Settings > Device Settings > Others**)

(Zoom: **Settings > System Settings > Others**)

1. Select **Manual**, **Auto Framing** and **Speaker Tracking** in **Framing Mode** field.
2. Select **Reset** to reset camera settings.

For more information, see related documentations, including User Guide and Administrator Guide, on your phone's Support page: <http://support.yealink.com/>. You can also contact the Yealink technical support team for help.

包装清单

· 标准配件



MeetingBar A20



3米网线

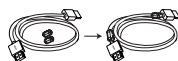

1.8米HDMI线 ×2
(用于接显示设备)



束线带 ×5

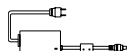

电源适配器

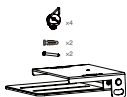

支架配件
(用于安装主机)



硅胶垫 ×2



快速入门指南

· 可选配件



VCR20-Teams 遥控器
7号电池 ×2

遥控器



CTP18



7.5米网线



挂墙架配件



螺丝刀



USB锁线盒 3M魔术贴

USB锁线盒



PoE 电源

触控平板



VCH51



接口保护罩



7.5米网线



0.6米HDMI线



0.6米USB Type-C线

有线投屏盒子



WPP20

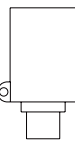

Type-C 转接头

无线传屏助手

连接终端

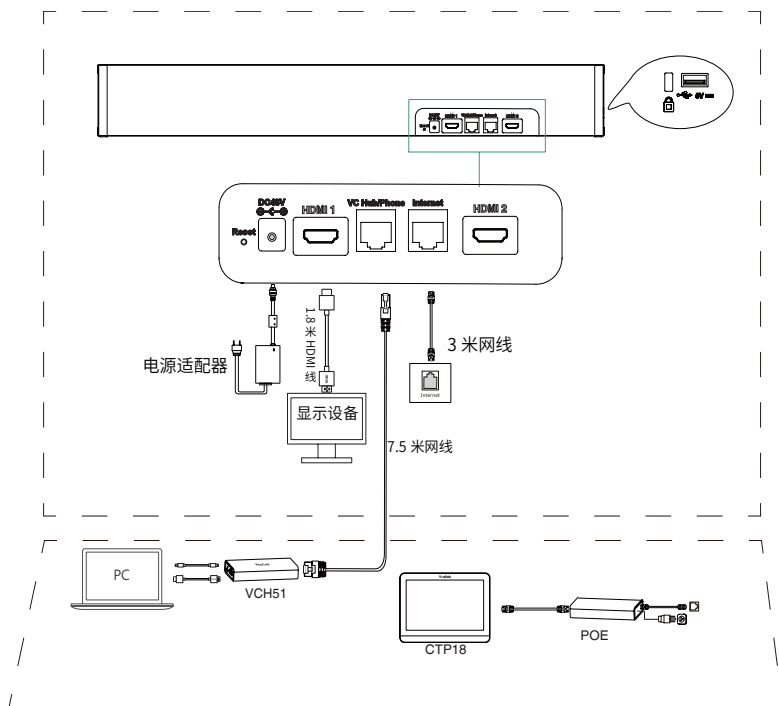

连接 CTP18

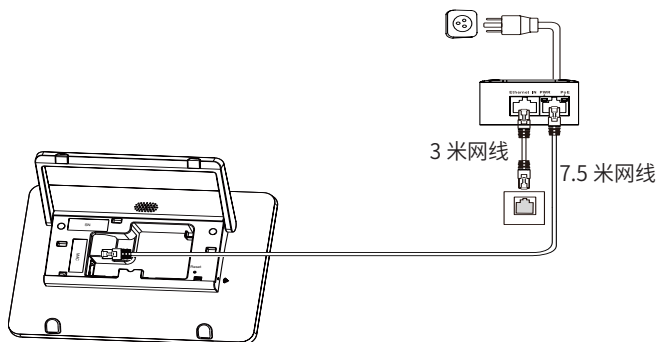

无线辅流分享内容

你可以使用 WPP20 无线传屏助手进行无线辅流分享内容。

1. 将 WPP20 连接到 A20 的 USB 口。
2. 约 3 秒后，WPP20 指示灯闪烁 2 次并保持绿色常亮。
WPP20 与 A20 配对成功。
3. 将 WPP20 连接到电脑上。

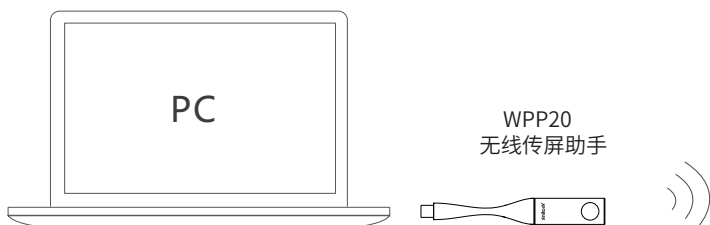

安装遥控器电池和使用束线带

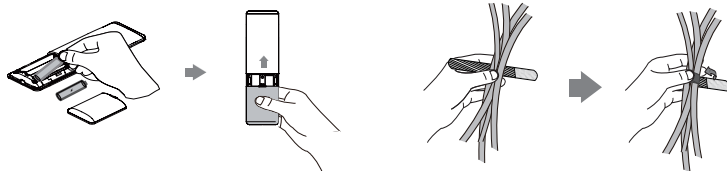

遥控器介绍 (Teams)

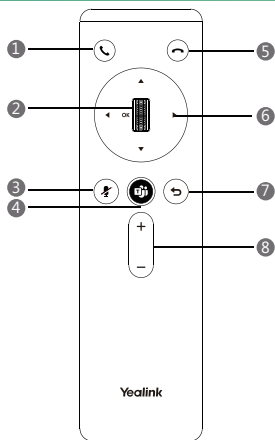

- 1 接听键**
接听来电。
- 2 滚轮 / OK 键**
 - 向上滑动放大摄像机画面。
 - 向下滑动缩小摄像机画面。
 - 按下以确认执行操作。
- 3 静音键**
麦克风静音 / 取消静音。
- 4 Teams 键**
按下按键加入会议。
- 5 挂断键**
按下按键离开会议。
- 6 导航键**
导航菜单项。
- 7 返回键**
返回上一级菜单。
- 8 音量加减键**
提高 / 降低音量。

摄像机设置

你可以对摄像机进行设置：

进入（Teams: **更多** > **设置** > **设备设置**）

（Zoom: **设置** > **系统设置**）

选择**曝光设置**，**白平衡设置**和**图像**设置曝光，白平衡等。

进入（Teams: **更多** > **设置** > **设备设置** > **其他**）

（Zoom: **设置** > **系统设置** > **其他**）

1. 选择**手动**，**自动框全景**和**语音追踪**在**智能框**选中。

2. 选择**重置**重置摄像机设置。

更多详细信息，请参阅技术支持网站（<http://support.yealink.com/>）上相关的用户指南和管理员指南。或者你也可以联系亿联技术支持团队。

Regulatory Notices

Operating Ambient Temperatures

- Operating temperature: +32 to 104°F (0 to 40°C)
- Relative humidity: 5% to 90%, noncondensing
- Storage temperature: -22 to +160°F (-30 to +70°C)

Warranty

Our product warranty is limited only to the unit itself, when used normally in accordance with the operating instructions and the system environment. We are not liable for damage or loss resulting from the use of this product, or for any claim from a third party. We are not liable for problems with Yealink device arising from the use of this product; we are not liable for financial damages, lost profits, claims from third parties, etc., arising from the use of this product.

Explanation of the symbols

•DC symbol

⎓ is the DC voltage symbol.

•WEEE Warning symbol



To avoid the potential effects on the environment and human health as a result of the presence of hazardous substances in electrical and electronic equipment, end users of electrical and electronic equipment should understand the meaning of the crossed-out wheeled bin symbol. Do not dispose of WEEE as unsorted municipal waste and have to collect such WEEE separately.

•Restriction of Hazardous Substances Directive (RoHS)

This device complies with the requirements of the EU RoHS Directive. Statements of compliance can be obtained by contacting support@yealink.com.

•Safety Instructions

Save these instructions. Read these safety instructions before use!

⚠ General Requirements

- Before you install and use the device, read the safety instructions carefully and observe the situation during operation.
- During the process of storage, transportation, and operation, please always keep the device dry and clean, avoid collision and crash.
- Please attempt not to dismantle the device by yourself. In case of any discrepancy, please contact the appointed maintenance center for repair.
- Please refer to the relevant laws and statutes while using the device. Legal rights of others should be respected as well.

⚠ Environmental Requirements

- Place the device at a well-ventilated place. Do not expose the device under direct sunlight.
- Keep the device dry and free of dusts.
- Do not place the device on or near any inflammable or fire-vulnerable object, such as rubber-made materials.
- Keep the device away from any heat source or bare fire, such as a candle or an electric heater.

⚠ Operating Requirements

- Do not let a child operate the device without guidance.
- Do not let a child play with the device or any accessory in case of accidental swallowing.
- Please use the accessories provided or authorized by the manufacturer only.
- The power supply of the device shall meet the requirements of the input voltage of the device. Please use the provided surge protection power socket only.
- Before plugging or unplugging any cable, make sure that your hands are completely dry.
- Do not spill liquid of any kind on the product or use the equipment near water, for example, near a bathtub, washbowl, kitchen sink, wet basement or near a swimming pool.
- During a thunderstorm, stop using the device and disconnect it from the power supply. Unplug the power plug and the Asymmetric Digital Subscriber Line (ADSL) twisted pair (the radio frequency cable) to avoid lightning strike.
- If the device is left unused for a rather long time, disconnect it from the power supply and unplug the power plug.
- When there is smoke emitted from the device, or some abnormal noise or smell, disconnect the device from the power supply, and unplug the power plug immediately.
- Contact the specified maintenance center for repair.
- Do not insert any object into equipment slots that is not part of the product or auxiliary product.
- Before connecting a cable, connect the grounding cable of the device first. Do not disconnect the grounding cable until you disconnect all other cables.

⚠ Operating Requirements

- Before cleaning the device, disconnect it from the power supply.
- Use a piece of soft, dry and anti-static cloth to clean the device.
- Keep the power plug clean and dry.

About Yealink

Yealink is a global leading provider of enterprise communication and collaboration solutions, offering video conferencing service to world-wide enterprises. Focusing on research and development, Yealink also insists on innovation and creation. With the outstanding technical patents of cloud computing, audio, video and image processing technology, Yealink has built up a panoramic collaboration solution of audio and video conferencing by merging its cloud services with a series of endpoints products. As one of the best providers in more than 140 countries and regions including the US, the UK and Australia, Yealink ranks No.1 in the global market share of SIP phones shipments.

Technical Support

Visit Yealink WIKI (<http://support.yealink.com/>) for the latest firmware, guides, FAQ, Product documents, and more. For better service, we sincerely recommend you to use Yealink Ticketing system (<https://ticket.yealink.com/>) to submit all your technical issues.

Troubleshooting

The unit cannot supply power to the device other than Yealink device. There is a bad connection with the plug.

1. Clean the plug with a dry cloth.
2. Connect it to another wall outlet.

The usage environment is out of operating temperature range.

1. Use in the operating temperature range.

The cable between the unit and the Yealink device is connected incorrectly.

1. Connect the cable correctly.

You cannot connect the cable properly.

1. You may have connected a wrong Yealink device.

2. Use the correct power supply.

Some dust, etc., may be in the port.

1. Clean the port.

Contact your dealer or authorized service facility for any further questions.

FCC Statement

This device complies with part 15 of the FCC Rules. Operation is subject to the following two conditions: (1) this device may not cause harmful interference, and (2) this device must accept any interference received, including interference that may cause undesired operation.

Any Changes or modifications not expressly approved by the party responsible for compliance could void the user's authority to operate the equipment.

Note: This equipment has been tested and found to comply with the limits for a Class B digital device, pursuant to part 15 of the FCC Rules. These limits are designed to provide reasonable protection against harmful interference in a residential installation. This equipment generates uses and can radiate radio frequency energy and, if not installed and used in accordance with the instructions, may cause harmful interference to radio communications. However, there is no guarantee that interference will not occur in a particular installation. If this equipment does cause harmful interference to radio or television reception, which can be determined by turning the equipment off and on, the user is encouraged to try to correct the interference by one or more of the following measures:

- Reorient or relocate the receiving antenna.
- Increase the separation between the equipment and receiver.
- Connect the equipment into an outlet on a circuit different from that to which the receiver is connected.
- Consult the dealer or an experienced radio/TV technician for help.

IC Statement

This device complies with Industry Canada's licence-exempt RSSs. Operation is subject to the following two conditions:

- (1) this device may not cause interference; and
- (2) this device must accept any interference, including interference that may cause undesired operation of the device. CAN ICES-3(B)

Le présent appareil est conforme aux CNR d'Industrie Canada applicables aux appareils radio exempts de licence. L'exploitation est autorisée aux deux conditions suivantes :

- (1) l'appareil ne doit pas produire de brouillage;
- (2) l'utilisateur de l'appareil doit accepter tout brouillage radioélectrique subi, même si le brouillage est susceptible d'en compromettre le fonctionnement. NMB-3(B)

Radiation Exposure Statement

This equipment complies with FCC and IC radiation exposure limits set forth for an uncontrolled environment. This equipment should be installed and operated with minimum distance 20cm between the radiator and your body. Cet émetteur ne doit pas être Co-placé ou ne fonctionnant en même temps qu'aucune autre antenne ou émetteur. Cet équipement devrait être installé et actionné avec une distance minimum de 20 centimètres entre le radiateur et votre corps.

RF exposure warning (FCC & IC)

This equipment must be installed and operated in accordance with provided instructions and the antenna(s) used for this transmitter must be installed to provide a separation distance of at least 20 cm from all persons and must not be co-located or operating in conjunction with any other antenna or transmitter. End-users and installers must be provide with antenna installation instructions and transmitter operating conditions for satisfying RF exposure compliance.

FCC & IC warning statement:

The 5.15-5.25 GHz band are restricted to indoor usage only.



YEALINK(XIAMEN) NETWORK TECHNOLOGY CO.,LTD.

Web: www.yealink.com

Copyright©2020 YEALINK(XIAMEN) NETWORK TECHNOLOGY CO.,LTD.All rights reserved.