

21" inches

3.5" inches

2.125" inches

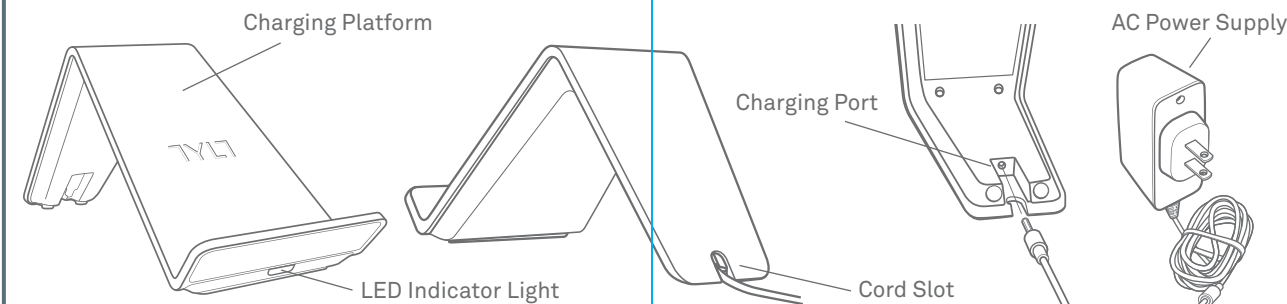

**CARE AND MAINTENANCE:**

- Place charger on a hard flat surface.
- When cleaning the charger, use a soft damp cloth only. Do not wet the exposed metal part of the charging unit. Do not use solvents or scouring agents as they may mark the LED and casing.
- Do not submerge in water or rinse under faucet.
- Keep the device dry. Precipitation, humidity, liquids and moisture can contain minerals that corrode electronic circuits.
- If the device gets wet, immediately unplug it and allow it to dry
- Do not disassemble or make any repair attempts to the unit.
- Do not store the device in high or low temperatures.

**CAUTIONS:**

1. The VÜ is for charging wireless charging enabled and Qi™ Charging Standard compatible smartphones only.
2. The charging unit should only be used at normal indoor room conditions.
3. Place charger on a hard flat surface.
4. Never use any power cable and transformer other than those originally supplied with the charging unit.
5. The VÜ may become hot during charging. Avoid direct contact with highly flammable materials. Avoid contact with fine furniture finishes.

**Included:**

- VÜ Pad
- AC Power Supply
- Users guide

**Specifications:**

- Input: 12V / 750mA
- Output: 5W



For more information on the VÜ, wireless charging, Qi™ Charging Standard and a list of compatible smartphones, please visit: [www.TYLT.com/VÜ](http://www.TYLT.com/VÜ)

©2013 TYLT. All rights reserved.  
TYLT® and the TYLT® logo are registered trademarks of Foreign Trade Corp. Other marks are the property of their respective owners. IC2094B



**VÜ WIRELESS CHARGING PAD**  
User Guide

**1** Power-up the VÜ by attaching the charging cord to the charging port located on the underside of the unit. Plug the charger into a wall socket for power.

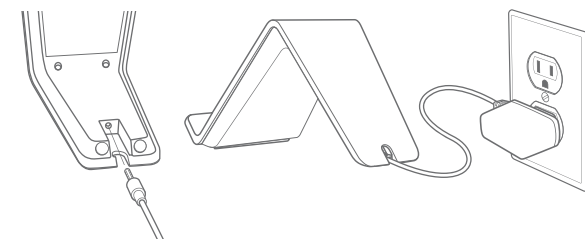

**2** Place your Qi™ compatible device on the VÜ pad to begin charging.

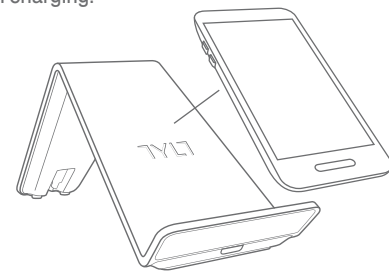

**3** While the VÜ pad is charging a device, the Green LED will turn on. Upon completion of charge, the LED will turn off.

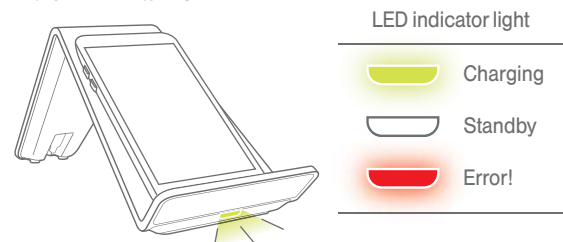

**4** Under any type of error condition, the Red LED will turn on. In case of an error condition, remove the phone and place it back on the pad. If this does not solve the problem, unplug the VÜ from the AC charger and re-connect it.

NOTE: If the Red LED blinks and does not stay solid, the error condition has been automatically resolved

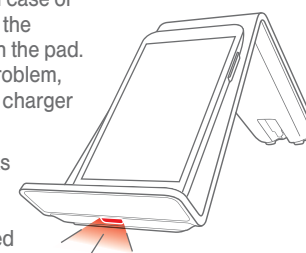

**FCC Information**

This equipment has been tested and found to comply with the limits for a Class B digital device, pursuant to Part 15 of the FCC Rules. These limits are designed to provide reasonable protection against harmful interference in a residential installation. This equipment generates, uses and can radiate radio frequency energy and, if not installed and used in accordance with the instructions, may cause harmful interference to radio communications. However, there is no guarantee that interference will not occur in a particular installation.

If this equipment does cause harmful interference to radio or television reception, which can be determined by turning the equipment off and on, the user is encouraged to try to correct the interference by one or more of the following measures:

- Reorient or relocate the receiving antenna.
- Increase the separation between the equipment and receiver.
- Connect the equipment into an outlet on a circuit different from that to which the receiver is connected.

• Consult the dealer or an experienced radio/TV technician for help.

This device complies with Part 15 of the FCC Rules [and with RSS-210 of Industry Canada].

Operation is subject to the following two conditions:

1. This device may not cause harmful interference.
2. This device must accept any interference received, including interference that may cause undesired operation.

To comply with FCC and other RF exposure requirements, please maintain a distance of 20cm between the charger and your body when in use.

This transmitter must not be co-located or operating in conjunction with any other antenna or transmitter.

Changes or modifications made to this equipment not expressly approved by the manufacturer may void the FCC authorization to operate this equipment.

FCC ID: SQZ-T101

2 Sided 6 panel folded User Guide

4/4 (CMYK)