

1. Safety information

Note: Please read this information before you use the headset.

Electronics Devices

To avoid electromagnetic interference, please turn off the headset in any place where posted notices instruct you to do so.

Note: Most modern electronic devices are susceptible to electromagnetic interference (EMI) if inadequately shielded, designed, or otherwise configured for electromagnetic compatibility.

Aircraft

Turn off the headset when on board an aircraft. The use of this headset might interfere with the electrical system of an aircraft.

Medical Instruments

If you use a medical device, such as a pacemaker, consult the manufacturer of your medical device to determine if it is adequately shielded from electromagnetic interference. Your physician can assist you in obtaining this information.

Power Adapter

Only use the supplied power adapter with the headset.

Placement

You are advised to put the headset in a safe place where it will not be bent or crushed when not in use otherwise it may bring harm to human body.

Children

Keep the headset away from children. Some small or detachable parts might be swallowed and result in harm.

Repair or Service

Any attempt to modify or remove of any part of the headset will void the warranty.

2. General Descriptions

GBH722 is a low cost Bluetooth mono headset, which through polish and matt interlaced design to get realistic feel. GBH722 adheres to the Bluetooth V2.1+EDR specifications and supports the Headset, Hands-free Bluetooth profiles.

3. Getting started

3.1 Identifying parts

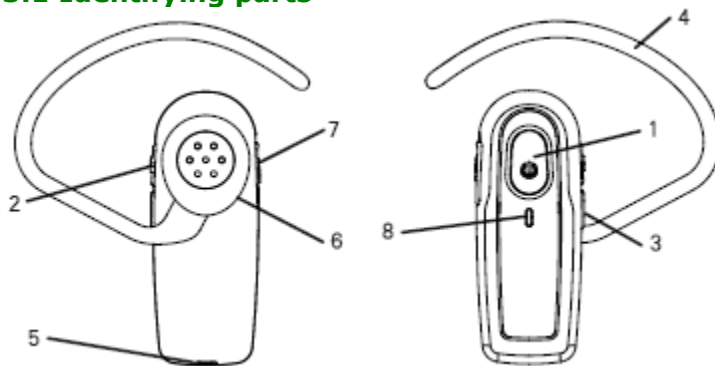

1. Multi-Function Button
2. Volume Up Button
3. Volume Down Button
4. Earloop
5. Mic
6. Receiver
- 7 Charging interface.
8. Indicator Light

3.2 Adjusting the headset for comfort

The light weight GBH722 can be worn comfortably on either ear. Adjust the headset according to the following figures.

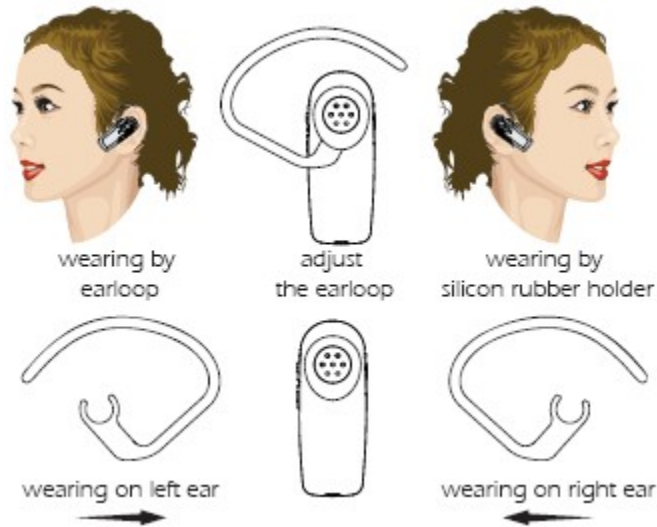

Note: You can adjust the earloop for comfortable wearing, but please be careful in not to break the clip.

3.3 Status LED

| Headset Status | Description |
|-------------------|---|
| Powering on | Blue LED Steady light for 1s |
| Powering off | Red LED Steady light for 1s then off |
| Pairing Mode | Red LED and Blue LED flash alternately |
| Standby Mode | Blue LED flashes once every 5s |
| Ringing | Red and Blue LED Flash once together every 1s |
| Ongoing Call | Blue LED flashes once every 2s |
| Low Battery | Red LED flashes |
| Charging | Red LED steady light |
| Charging complete | Off |

3.4 Charging the built-in battery

GBH722 has a built-in battery, which must be charged fully before using the headset. Charging takes about 2 hours. You can charge the headset through the AC adapter (optional) or USB connector on computer.

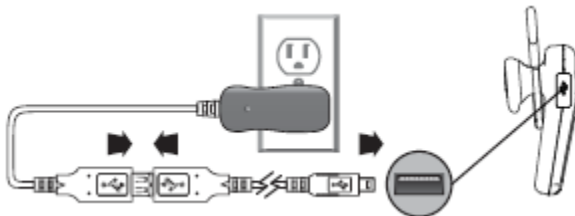

Using USB charging adapter

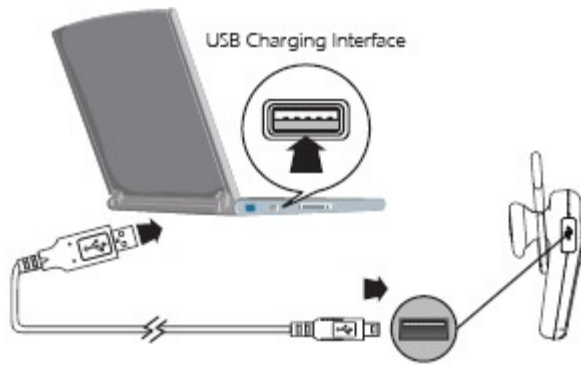

Using USB cable

Note:

- (1) Please make sure the max. Output voltage (including noise) of Adapter is $\leq 6V$ (including empty load and full load), otherwise the damage is not responsible.
- (2) GBH722 is reset when charging. The red LED is steady light when charging.

4.The function at a glance

In this guide, "Short press" refers to a time period of less than 1 second during which a functional button is being pressed. "Long press" refers to a time period of more than 3 second during which a functional button is being pressed. "Press and hold" refers to a time period of more than 5 second during which a functional button is being pressed.

4.1 Phone operation Pairing the headset with a phone

Before you can use the headset to make calls, you must pair the headset with your phone. Pairing creates a secure link between your phone and the unique ID of the headset. You only have to pair devices once.

- (1) To put the headset in pairing mode, press and hold (over 5 seconds) the Multi-function button until the LED flash red/blue.
- (2) Scroll to the Bluetooth menu in you phone and search for active devices. (Refer to you phone's user manual for details)
- (3) When the search completes, a list of devices found is displayed. (The screen examples here are from a Nokia 6230)

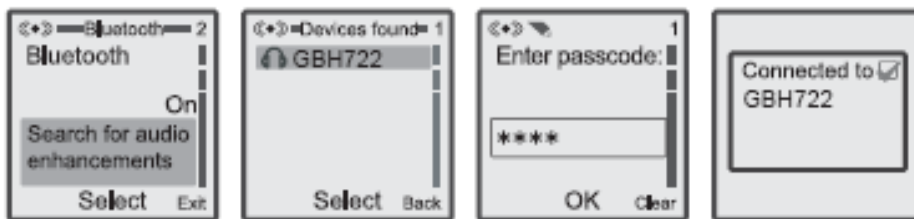

- (4) Select "GBH722" and when prompted input the default passkey (0000). When successfully paired, the red/blue LED on the headset changes to flashing blue.

Note: You can pair the headset with up to eight Bluetooth devices. When you pair the device with a ninth device, the oldest-paired device is deleted.

Phone functions at glance

| Headset Function | Headset Status | Button Operation |
|---|-----------------------|------------------------------|
| Power on | Power off | Long press MFB |
| Power off | Power on | Very long press MFB |
| Pairing | Power off | Very long press MFB |
| Answer the call | Incoming call | Short press MFB |
| Reject the call | Incoming call | Long press MFB |
| End the call | Ongoing call | Short press MFB |
| Volume up/down | Ongoing call | Short press Vol+/Vol- button |
| Transfer the voice between Mobile phone and headset | Ongoing call | Long press MFB |
| Voice dial | Connected and standby | Long press MFB |
| Cancel voice dial | Dialing | Long press MFB |
| Last number redial | Connected and standby | Double Short press MFB |
| Connecting actively | Standby | Short press MFB |

4.2 Make internet phone calls

There are many internet phone services (VoIP) that let you make calls from your computer. You must add a new connection for this function.

- (1) To put the headset in pairing mode, press and hold (over 5 seconds) **Multi-function button** until the LED flashes red/blue.
- (2) Right-click the **Bluetooth Manager** icon in the system tray and click **Add New Connection** (fig 1).
- (3) Select the **Custom Mode** radio button and click **Next**. The wizard searches for device and the following screen appears, select the GBH722 and click Next (fig 2).
- (4) Type in the passkey (**0000**) and click **OK** (fig 3).



(fig 1) | (fig 2)
(fig 3)

(5) Under Service Class, select headset and click **Next** (fig 4).



(fig 4-1)



(fig 4-2)

(6) When you hear a signal tone on the headset, short-press **Multi-function button** (fig 5).



(fig 5)

(7) Click **Next**.

(8) A registration confirmation screen appears, Click **Finish** to complete the connection. The new connection is shown in the Bluetooth Settings window (fig 6).

(9) Right-click the headset icon and click **Connect** (fig 7).

(10) When you hear a single tone on the headset, short-press **Multi-function button**. Once connected the icon changes to a handshake (fig 8).



(fig 6) | (fig 7-1)
 (fig 7-2) | (fig 8)

Now you can make an internet phone call by using GBH722.

Note: The headset only controls volume, Use the Skype interface for all call functions.

5. Specifications

| | |
|------------------|---|
| Battery capacity | 80 mAh |
| Talk time | up to 5hours |
| Standby time | up to 110 hours |
| Weight | 9 g |
| Size | 46.89*18.18*9.53 mm(not include earpiece) |

6. FCC RF Radiation Exposure Statement

This device complies with Part 15 of the FCC Rules. Operation is subject to the condition that this device does not cause harmful interference.

15.105(b)

This equipment has been tested and found to comply with the limits for a Class B digital device, pursuant to part 15 of the FCC rules. These limits are designed to provide reasonable protection against harmful interference in a residential installation. This equipment generates, uses and can radiate radio frequency energy and, if not installed and used in accordance with the instructions, may cause harmful interference to radio communications. However, there is no guarantee that interference will not occur in a particular installation. If this equipment does cause harmful interference to radio or

television reception, which can be determined by turning the equipment off and on, the user is encouraged to try to correct the interference by one or more of the following measures:

- Reorient or relocate the receiving antenna.
- Increase the separation between the equipment and receiver.
- Connect the equipment into an outlet on a circuit different from that to which the receiver is connected.
- Consult the dealer or an experienced radio/TV technician for help.

15.19 Warning Statement

THIS DEVICE COMPLIES WITH PART 15 OF THE FCC RULES. OPERATION IS SUBJECT TO THE FOLLOWING TWO CONDITIONS①) THIS DEVICE MAY NOT CAUSE HARMFUL INTERFERENCE.AND (2) THIS DEVICE MUST ACCEPT ANY INTERFERENCE RECEIVED, INCLUDING INTERFERENCE THAT MAY CAUSE UNDESIRE OPERATION.

15.21 Warning Statement

NOTE: THE MANUFACTURER IS NOT RESPONSIBLE FOR RADIO OR TV INTERFERENCE CAUSED BY UNAUTHORIZED MODIFICATIONS TO THIS EQUIPMENT. SUCH MODIFICATIONS COULD VOID THE USER'S AUTHORITY TO OPERATE THE EQUIPMENT.