

SMART DOOR & WINDOW SENSOR

IMPORTANT SAFETY INSTRUCTIONS AND INSTALLATION GUIDE



Works with
Feit Electric app



Only supports
2.4GHz Wi-Fi
Networks

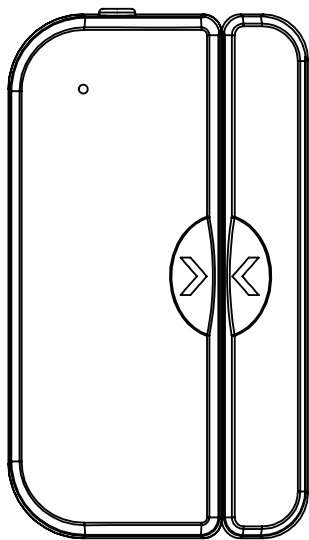

READ BEFORE INSTALLATION
SAVE THESE INSTRUCTIONS

Questions, problems, missing parts? Before returning to the store,
call Feit Electric Customer Service
8 a.m. - 5 p.m., PST, Monday - Friday

1-866-326-BULB (2852)

FEIT.COM

Table of Contents

| | |
|-----------------------------|---|
| Table of Contents | 2 |
| Safety Information | 2 |
| Warranty | 2 |
| FCC Statement | 2 |
| Pre-Installation | 3 |
| Description | 3 |
| Screw Installation | 4 |
| Adhesive Installation | 5 |
| App Setup | 6 |
| Need Help? | 6 |
| Troubleshooting | 6 |

Safety Information

SAVE THESE INSTRUCTIONS

IMPORTANT SAFEGUARDS:

ALWAYS FOLLOW BASIC SAFETY PRECAUTIONS WHEN USING ELECTRICAL PRODUCTS, ESPECIALLY WHEN CHILDREN ARE PRESENT.



CAUTION: Please read all information carefully before installation.



CAUTION: Intended for indoor use.



CAUTION: This product is NOT a toy.



CAUTION: Do not install directly on or near any metal objects that can interfere with the magnet or may weaken the Wi-Fi signal strength.

Limited Warranty

This product is warranted to be free from defects in workmanship and materials for up to 1 year from date of purchase. If the product fails within the warranty period, please contact Feit Electric at info@feit.com, visit feit.com/contact-us or call 1-866-326-BULB (2852) for instructions on replacement or refund. REPLACEMENT OR REFUND IS YOUR SOLE REMEDY. EXCEPT TO THE EXTENT PROHIBITED BY APPLICABLE LAW, ANY IMPLIED WARRANTIES ARE LIMITED IN DURATION TO THE DURATION OF THIS WARRANTY. LIABILITY FOR INCIDENTAL OR CONSEQUENTIAL DAMAGES IS HEREBY EXPRESSLY EXCLUDED. Some states and provinces do not allow the exclusion of incidental or consequential damages, so the above limitation or exclusion may not apply to you. This warranty gives you specific legal rights, and you may also have other rights which vary from state to state or province to province.

FCC STATEMENT

This device complies with part 15 of the FCC Rules. Operation is subject to the following two conditions: (1) This device may not cause harmful interference, and (2) this device must accept any interference received, including interference that may cause undesired operation. Note: This equipment has been tested and found to comply with the limits for a Class B digital device, pursuant to part 15 of the FCC Rules. These limits are designed to provide reasonable protection against harmful interference in a residential installation. This equipment generates, uses and can radiate radio frequency energy and, if not installed and used in accordance with the instructions, may cause harmful interference to radio communications. However, there is no guarantee that interference will not occur in a particular installation. If this equipment does cause harmful interference to radio or television reception, which can be determined by turning the equipment off and on, the user is encouraged to try to correct the interference by one or more of the following measures: Reorient or relocate the receiving antenna. Increase the separation between the equipment and receiver. Connect the equipment into an outlet on a circuit different from that to which the receiver is connected. Consult the dealer or an experienced radio/TV technician for help. Any changes or modifications not expressly approved by the manufacturer could void the user's authority to operate the equipment.

Warning: Changes or modifications to this unit not expressly approved by the part responsible for compliance could void the user's authority to operate the equipment.

The device has been evaluated to meet general RF exposure requirement.
The device can be used in mobile (min 7.87 in.) exposure condition without restriction.

Supplier's Declaration of Conformity:
47 CFR § 2.1077 Compliance Information

Responsible Party:
Feit Electric Company
4901 Gregg Road,
Pico Rivera, CA 90660, USA
562-463-2852

Unique Identifier:
MOT/DOOR/WIFI/BAT



TOOLS REQUIRED TO MOUNT SENSOR

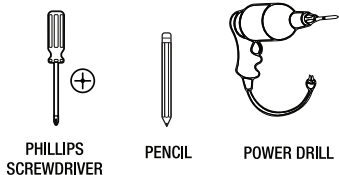

HARDWARE INCLUDED



NOTE: Hardware not shown to actual size.

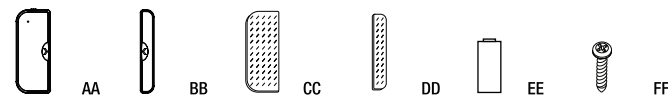

| Part | Description | Quantity |
|------|----------------------------------|----------|
| AA | Door/Window Sensor | 1 |
| BB | Magnet | 1 |
| CC | Double-Sided Tape for the Sensor | 1 |
| DD | Double-Sided Tape for the Magnet | 1 |
| EE | 1.5V AAA Alkaline Batteries | 2 |
| FF | Mounting Screws | 4 |

Description

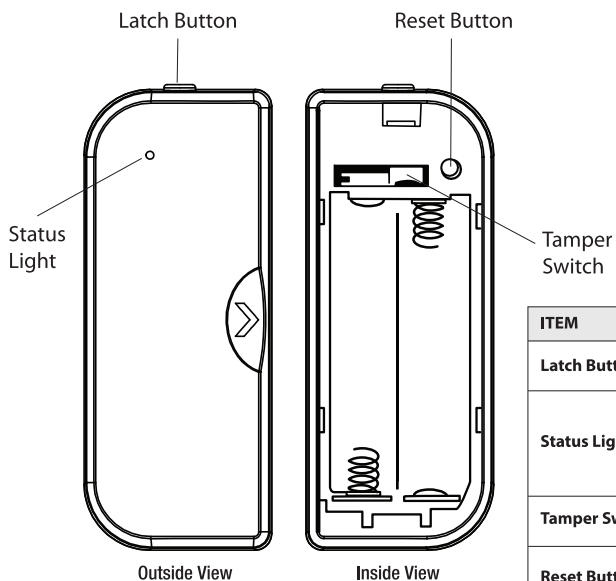

| ITEM | DESCRIPTION |
|----------------------|---|
| Latch Button | Press to release the lock |
| Status Light | <ul style="list-style-type: none"> • Blinking BLUE: Pairing Mode • Blinking BLUE 3 Times: Opening/Closing Detected • Blinking RED 3 Times: Low Battery |
| Tamper Switch | Sends a notification in-app when the sensor is being tampered. |
| Reset Button | Press and hold for 5 seconds to reset the sensor. |

1 Remove Backplate

- Remove the backplate from the Door/Window Sensor (AA) by pressing the latch button on top and gently pulling the backplate until it releases.
- Remove the backplate from the Magnet (BB) by grasping it from the middle and gently pulling the backplate until it releases.

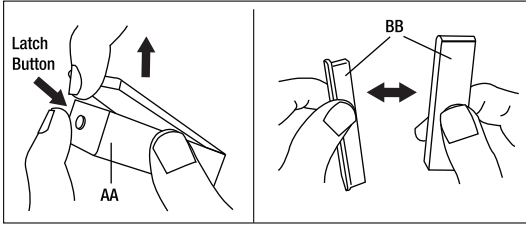

2 Install Backplates with Screws

- Mark screw positions using the Door/Window Sensor (AA) backplate on your door frame or window frame and Magnet (BB) backplate on your door or window, or vice versa.
- Use the Mounting Screws (FF) to attach the backplates to the wall.

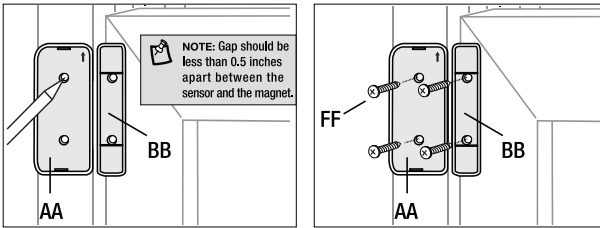

3 Insert Batteries or Remove Tag

- Insert two 1.5V AAA Alkaline Batteries (EE) or remove tag if batteries are already present in the open Door/Window Sensor (AA).
- Turn on the Door/Window Sensor (AA) by pushing on the RESET button. Follow the steps in the APP Setup on page 6.

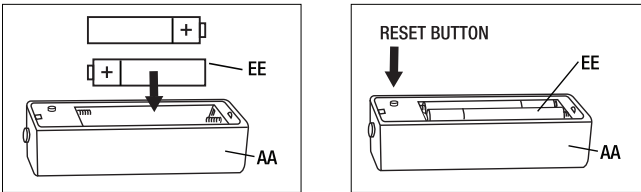

4 Attach Door/Window Sensor and Magnet to Backplates

- Attach the Door/Window Sensor (AA) and Magnet (BB) to the appropriate Backplates until they lock in place.
- Door/Window Sensor (AA) and Magnet (BB) Arrows should align.

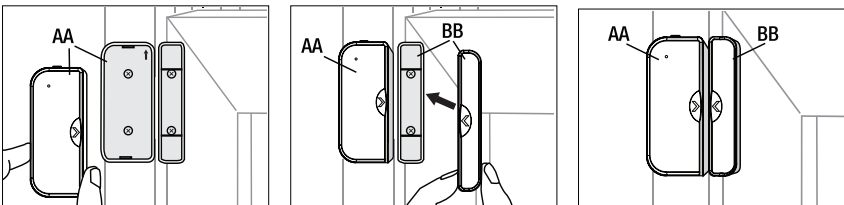

1 Remove Backplate

- Remove the backplate from the Door/Window Sensor (AA) by pressing the latch button on top and gently pulling the backplate until it releases.
- Remove the backplate from the Magnet (BB) by grasping it from the middle and gently pulling the backplate until it releases.

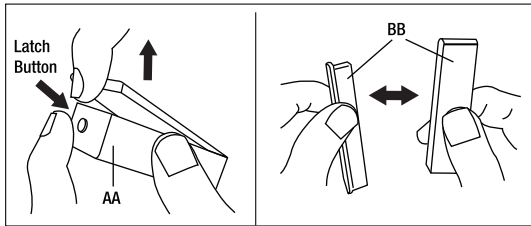

2 Install Backplates with Double-Sided Tape

- Clean the mounting area thoroughly (surface must be free of dust, dirt or grease).
- Stick Double-Sided Tape for the Sensor (CC) to the backside of the Door/Window Sensor (AA) backplate. Stick Double-Sided Tape for the Magnet (DD) to the backside of the Magnet (BB) backplate.
- Peel the Double-Sided Tape (CC) (DD) and place the Door/Window Sensor (AA) backplate on your door frame or window frame and Magnet (BB) backplate on your door or window, or vice versa.

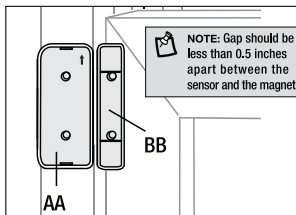
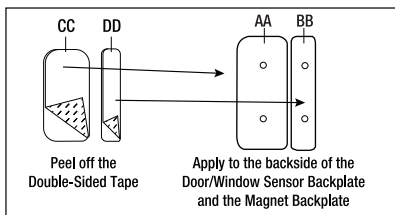

3 Insert Batteries or Remove Tag

- Insert two 1.5V AAA Alkaline Batteries (EE) or remove tag if batteries are already present in the open Door/Window Sensor (AA).
- Turn on the Door/Window Sensor (AA) by pushing on the RESET button. Follow the steps in the APP Setup on page 6.

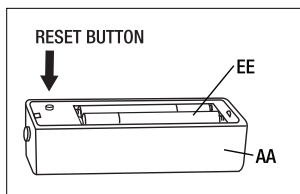
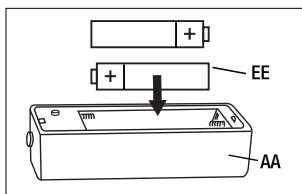

4 Attach Door/Window Sensor and Magnet to Backplates

- Attach the Door/Window Sensor (AA) and Magnet (BB) to the appropriate Backplates until they lock in place.
- Door/Window Sensor (AA) and Magnet (BB) Arrows should align.

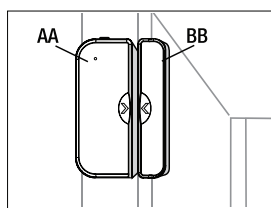
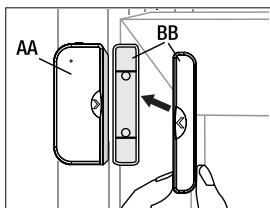
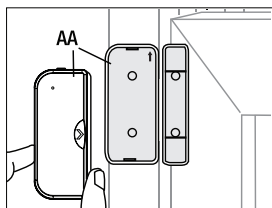

Download and install the Feit Electric app

- Search for the Feit Electric app in the App Store or Google Play Store.
- Download and install the Feit Electric app on your smart device.



Set up the Smart Door & Window Sensor using the Feit Electric app

Check to be sure the Sensor is in pairing mode. The BLUE indicator light must be blinking rapidly to connect. If not already blinking, press and hold the Reset button for five seconds. Use the Feit Electric app to complete the set up.

- Tap Add Device or the + sign, then select Sensor and confirm. You will be prompted to enter your Wi-Fi network and password.

Be sure to connect to a 2.4 GHz Wi-Fi network that covers your installation location.

Need Help?

FAQs and the latest versions of user guides can be found at feit.com/help and feit.com/smart.

To reach customer support please visit feit.com/contact-us

Troubleshooting Tips

If you are having difficulty connecting:

- Make sure the Wi-Fi network is a 2.4 GHz network. Smart Door and Window Sensor will not connect to a 5 GHz network.
- Test your Wi-Fi network with other devices such as your phone to make sure it is operating properly.
- The Wi-Fi connection may not have good coverage during set up. Try moving the Smart Door and Window Sensor closer to your Wi-Fi router.
- Your Wi-Fi network password is case sensitive, make sure you are entering it correctly.

Please also check the App User Guide for more information.