

NO	ECN No.	DESCRIPTION	ISSUER	DATE
1.				
2.				

1 FIT DIMMER BESIDE THE WALL-COOK

- 1. Check the dimmer against your wall. If necessary, use the provided mounting holes to drill into the wall.

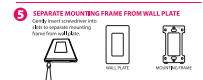

2 SEPARATE MOUNTING FRAME FROM WALL PLATE

- 2. Remove the mounting frame from the wall plate. This step is necessary to ensure the dimmer is properly aligned with the wall plate.



3 INSTALL MOUNTING FRAME

- 3. Mount the mounting frame onto your wall. Use the provided screws to secure it in place.



4 INSTALL WALL PLATE

- 4. Mount the wall plate onto the mounting frame. Use the provided screws to secure it in place.



5 DIMMER OPERATION

- 5. After installation, the dimmer is ready for use. Refer to the user manual for detailed instructions on how to operate the dimmer.



3 ENABLE SMART FEATURES

- 3. Download and install the **FEIT ELECTRIC APP** on your smartphone. This app allows you to control the dimmer remotely.



OPTIONAL CONNECT TO GOOGLE ASSISTANT OR ALEXA USING THE APP CLICK

- 4. Use the app to connect the dimmer to Google Assistant or Alexa. This allows for voice control of the dimmer.



SET YOUR DIMMING RANGE AND TROUBLESHOOT FLICKERING

- 5. Adjust the dimming range and troubleshoot any flickering issues. Refer to the user manual for more information.



LIGHT LEVEL INDICATOR LIGHTS

- 6. The dimmer features light level indicator lights that provide feedback on the current light level.



Need Help?

Check the dimmer against your wall. If necessary, use the provided mounting holes to drill into the wall.

WARNING: This product may contain a possible risk of fire hazard if incorrectly installed. Please check the installation instructions carefully. Do not use the dimmer in areas with high humidity or high voltage.

CAUTION: FIRE HAZARD. Do not use the dimmer in areas with high humidity or high voltage.

PARTS INCLUDED: Dimmer, Mounting Frame, Wall Plate, Screws, and Screws for Wall Plate.

TROUBLESHOOTING TIPS: Check the dimmer against your wall. If necessary, use the provided mounting holes to drill into the wall.

Light level flickering: Check the dimmer against your wall. If necessary, use the provided mounting holes to drill into the wall.

Replace light bulbs: Use only the recommended light bulbs for this dimmer. Refer to the user manual for more information.

NOTE: This dimmer is not suitable for use in areas with high humidity or high voltage.

FEIT electric

ORDER NUMBER: BPOVM-SMARTZ2

Wi-Fi Smart Dimmer Installation Guide

Installation Requires a Neutral Wire

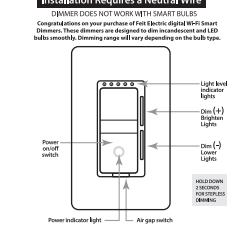

120V AC, 60Hz
450Watt MAX Incandescent
150Watt MAX dimmable LED

WARNING: This dimmer is not suitable for use in areas with high humidity or high voltage. It is not intended for use in areas with high humidity or high voltage.

FEIT ELECTRIC COMPANY Pico Rivera, CA, USA
www.feit.com

IMPORTANT: RETAIN FOR FUTURE REFERENCE: READ CAREFULLY

INSTALLING THE SMART DIMMERS

NOTE: INSTALLATION OF THE SMART DIMMER REQUIRES A NEUTRAL WIRE. IF A NEUTRAL WIRE IS NOT CONNECTED, THE DIMMER WILL NOT WORK. CONSULT A QUALIFIED ELECTRICIAN.

1 WARNING TO AVOID FIRE, SHOCK, OR DEATH, TURN OFF POWER AT CIRCUIT BREAKER OR FUSE AND TEST THAT POWER IS OFF BEFORE WIRING.

NOTE: For the best results, please refer to the wiring diagram provided in the user manual.

2 IDENTIFY YOUR WIRING: SINGLE POLE OR 2-WAY

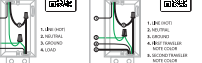

SINGLE POLE: This wiring configuration is used for standard single-pole dimming.

2-WAY: This wiring configuration is used for 2-way dimming, allowing for multiple switches to control the same load.

3 PREPARE AND CONNECT WIRE BUNDLES

1. Turn off power at the circuit breaker.
2. Remove the cover of the existing switch.
3. Identify the hot, neutral, and ground wires.
4. Connect the hot wire to the dimmer's hot terminal.
5. Connect the neutral wire to the dimmer's neutral terminal.
6. Connect the ground wire to the dimmer's ground terminal.

NOTICE: THE STEPS BELOW IF YOU ARE NOT CERTAIN YOU HAVE THE WIRING CORRECT. CONSULT A QUALIFIED ELECTRICIAN FOR ASSISTANCE.

3a SINGLE POLE One Smart Dimmer on a Circuit

1. Turn off power at the circuit breaker.
2. Remove the cover of the existing switch.
3. Identify the hot, neutral, and ground wires.
4. Connect the hot wire to the dimmer's hot terminal.
5. Connect the neutral wire to the dimmer's neutral terminal.
6. Connect the ground wire to the dimmer's ground terminal.



3b 2-WAY One Smart Dimmer with a Switch on the Same Circuit

1. Turn off power at the circuit breaker.
2. Remove the cover of the existing switch.
3. Identify the hot, neutral, and ground wires.
4. Connect the hot wire to the dimmer's hot terminal.
5. Connect the neutral wire to the dimmer's neutral terminal.
6. Connect the ground wire to the dimmer's ground terminal.

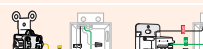

3c 2-WAY Two Smart Dimmers on the Same Circuit

1. Turn off power at the circuit breaker.
2. Remove the cover of the existing switch.
3. Identify the hot, neutral, and ground wires.
4. Connect the hot wire to the dimmer's hot terminal.
5. Connect the neutral wire to the dimmer's neutral terminal.
6. Connect the ground wire to the dimmer's ground terminal.

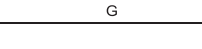
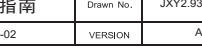
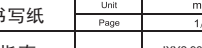
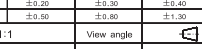
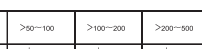
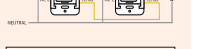
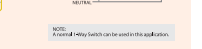
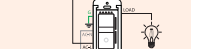

技术要求 Technical Requirements

1. 60g书写纸, 双面四色印刷;
60g writing paper, double side single black color printing;
2. 对折再对折, 后包心折, 边沿平齐, 折叠后尺寸约110x58mm。
Fold in half and half, size:110x58mm;
3. 尺寸公差±0.5mm。
Tolerance ±0.5mm
4. 材料需符合ROHS及欧盟包装指令9462EC。
The material complies with RoHS requirements.

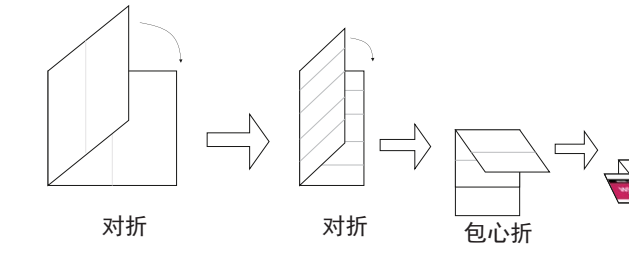

ANGLE	RANGE	>0-5	5-20	20-50	50-100	100-200	>200-500	>500
± 0.1°	A	±0.05	±0.10	±0.15	±0.20	±0.30	±0.40	±0.60
	B	±0.10	±0.20	±0.30	±0.50	±0.80	±1.30	±2.00
SIZE	N/A	SCALE 1:1				View angle		
WEIGHT	N/A	Material Color&Finish				Unit	m m	
DESIGNED	邹福英	2021-03-09				Page	1/1	
CHECKED		Part Name				快速指南	Drawn No.	JXY2.938.100S.171
APPROVED		Project Name				SD06-02	VERSION	A0

Caution:

This device complies with Part 15 of the FCC rules and Industry Canada license-exempt RSS standard(s). Operation is subject to the following two conditions: (1) this device may not cause harmful interference, and (2) this device must accept any interference received, including interference that may cause undesired operation.

The manufacturer is not responsible for any radio or TV interference caused by unauthorized modifications or change to this equipment. Such modifications or change could void the user's authority to operate the equipment.

This radio transmitter (identify the device by certification number or model number if Category II) has been approved by Industry Canada to operate with the antenna types listed below with the maximum permissible gain indicated. Antenna types not included in this list, having a gain greater than the maximum gain indicated for that type, are strictly prohibited for use with this device.

This equipment has been tested and found to comply with the limits for a Class B digital device, pursuant to part 15 of the FCC Rules. These limits are designed to provide reasonable protection against harmful interference in a residential installation. This equipment generates, uses and can radiate radio frequency energy and, if not installed and used in accordance with the instructions, may cause harmful interference to radio communications. However, there is no guarantee that interference will not occur in a particular installation. If this equipment does cause harmful interference to radio or television reception, which can be determined by turning the equipment off and on, the user is encouraged to try to correct the interference by one or more of the following measures:

- Reorient or relocate the receiving antenna.
- Increase the separation between the equipment and receiver.
- Connect the equipment into an outlet on a circuit different from that to which the receiver is connected.
- Consult the dealer or an experienced radio/TV technician for help.

The device has been evaluated to meet general RF exposure requirement.

To maintain compliance with FCC's RF exposure guidelines, this equipment should be installed and operated with a minimum distance of 20cm between the radiator and your body.