

Gsou[®]

USER MANUAL

Refine your music experience



H100 Bluetooth[®] Speaker

Content

Content	1
Preface	2
Warnings and Cautions	2
FCC Warnings	3
Names and Contents of Toxic or Hazardous Substances or Elements	4
Standard Accessories	4
Structure Introduction	5
Applicable Environment	6
Operation Steps	6
Connect Bluetooth®-enabled audio device with your speaker	8
For iPad/Iphone	8
For Andriod smart phone and Tablet PC	9
For Windows Phone	10
For Windows PC	11
For Mac system	11
Aux in mode- For non-Bluetooth® stereo devices	12
Charge your personal battery powered devices	13
Specifications	14
Trouble Shooting	15
Cleaning	16
Limited Warranty	17
Statement	17

Preface

Thanks for purchasing Gsou Bluetooth® speaker!

Please take the time to follow the instructions in this User manual carefully. It will help you to properly use your new Gsou product and enjoy its features.

Please save this user manual for future reference. If you have any query, please call our national service hotline: 400-0985-400.

Warnings and Cautions ⚠

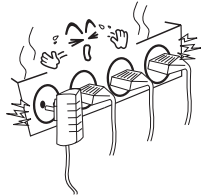

1、 To reduce the risk of fire or electric shock, be sure the electrical circuits are not overloaded.

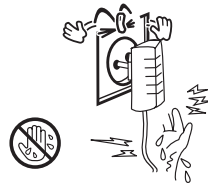

2、 To reduce the risk of electronic shock, Do not plug the adapter with wet hands.

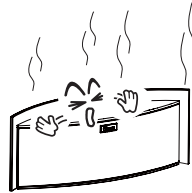

3、 Unplug the power cable if your device is smoking or abnormal and seek professional help to your nearest service centre, Do not detach the device yourself.



4、 To reduce the risk of fire or electric shock, do not expose this product to rain or moisture. Liquids can cause a failure and/or a fire hazard.



5、 The power cable and audio cable can not be twisted or dragged in case of short circuit.



6、 Do not place any naked flame sources, such as lighted candles, on or near the apparatus.

FC Warnings ⚠

This device complies with Part 15 of the FCC Rules. Operation is subject to the following two conditions: (1) this device may not cause harmful interference, and (2) this device must accept any interference received, including interference that may cause undesired operation.

Changes or modifications not expressly approved by the party responsible for compliance could void the user's authority to operate the equipment.

NOTE: This equipment has been tested and found to comply with the limits for a Class B digital device, pursuant to Part 15 of the FCC Rules.

These limits are designed to provide reasonable protection against harmful interference in a residential installation. This equipment generates, uses and can radiate radio frequency energy and, if not installed and used in accordance with the instructions, may cause harmful interference to radio communications. However, there is no guarantee that interference will not occur in a particular installation.

If this equipment does cause harmful interference to radio or television reception, which can be determined by turning the equipment off and on, the user is encouraged to try to correct the interference by one or more of the following measures:

- Reorient or relocate the receiving antenna.
- Increase the separation between the equipment and receiver.
- Connect the equipment into an outlet on a circuit different from that to which the receiver is connected.
- Consult the dealer or an experienced radio/TV technician for help.

FCC RF warning statement: The device has been evaluated to meet general RF exposure requirement. The device can be used in portable exposure condition without restriction.

Names and Contents of Toxic or Hazardous Substances or Elements

Part Name	Toxic or Hazardous Substances and Elements					
	Lead (Pb)	Mercury (Hg)	Cadmium (Cd)	Hexavalent (CR(VI))	Polybrominated Biphenyl (PBB)	Polybrominated Diphenylether (PBDE)
PCBs	X	O	O	O	O	O
Metal Parts	O	O	O	O	O	O
Plastic Parts	O	O	O	O	O	O
Speakers	O	O	O	O	O	O
Cables	O	O	O	O	O	O

O: Indicates that this toxic or hazardous substance contained in all of the homogeneous materials for this part is below the limit requirement in SJ/T 11363-2006.

X: Indicates that this toxic or hazardous substance contained in at least one of the homogeneous materials used for this part is above the limit requirement in SJ/T 11363-2006.

Standard Accessories



3.5mm Audio cable 1 pc



Power adapter 1 unit



User manual 1pc



Gsou H100 Bluetooth® speaker 1 unit

Structure Introduction

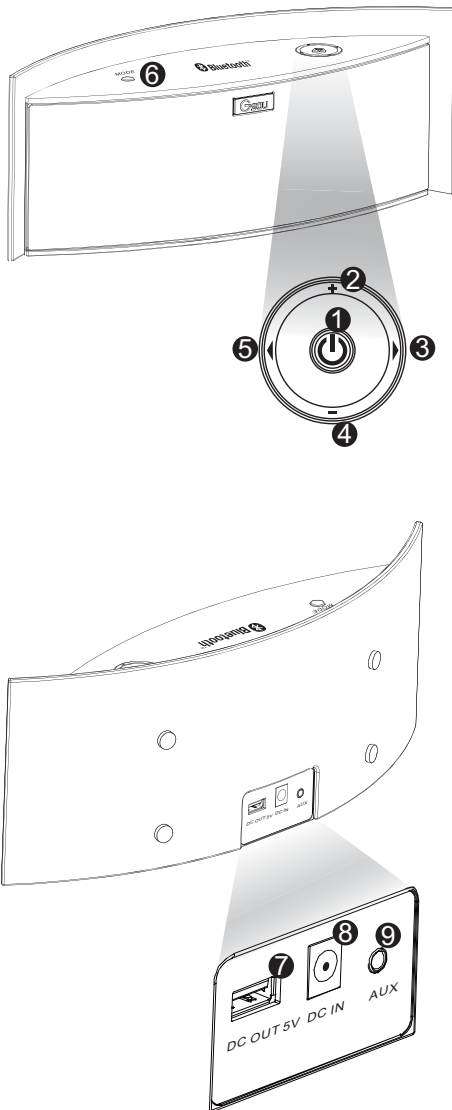

- ❶ Power on/ off . Play/Pause " ⏻ "
 (Note: long press for power on/off, short press for pause or play)
- ❷ + Plus Increase speaker volume " + "
- ❸ Next track " ▶ "
- ❹ - Minus Decrease speaker volume " - "
- ❺ Previous track " ◀ "
- ❻ Mode switch/disconnect "MODE"
 (* Mode Switch: Bluetooth® mode and aux in mode switch, Press and hold for 3 seconds to choose audio source from Bluetooth® device or AUX in device.
 *Disconnect: Short press for 1 second to set the speaker to discoverable mode and allow pairing with another Bluetooth device.
- ❼ DC Out USB port (5V)
 (The USB port allow you to charge your mobile phone, tablet PC ,MP3,MP4 and other 5V input voltage rechargeable devices.)
- ❽ DC in jack
- ❾ Aux in jack(3.5mm)

Applicable Environment

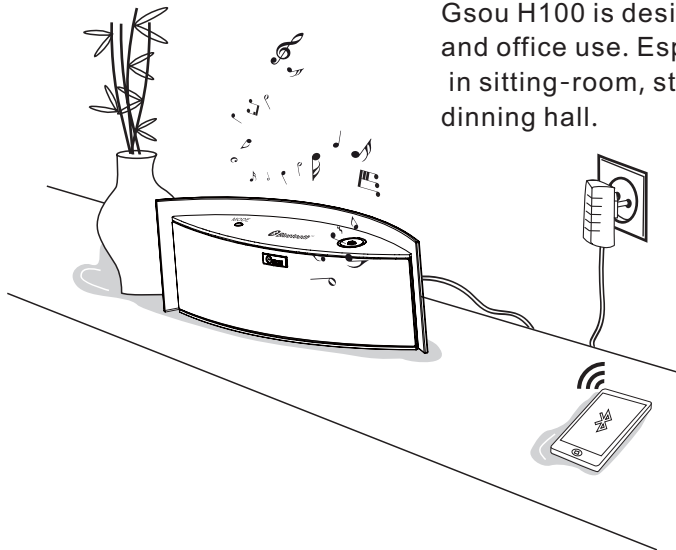

Gsou H100 is designed for home and office use. Especially for using in sitting-room, study, bedroom, dining hall.

Operation Steps

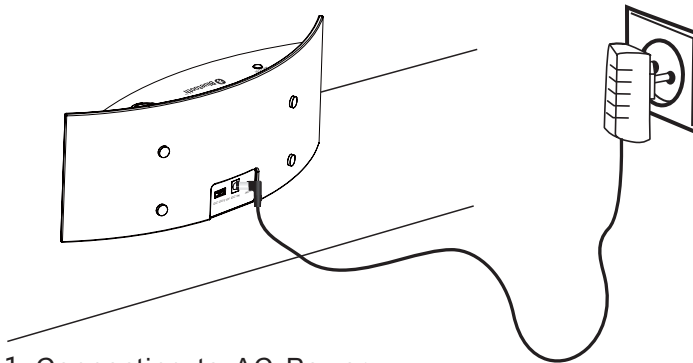

1. Connecting to AC Power

Plug the DC power cord on the power supply into the DC connector on the Gsou Bluetooth® speaker. Plug the power supply into a live AC(mains) outlet. (*Please use Gsou standard accessories.)

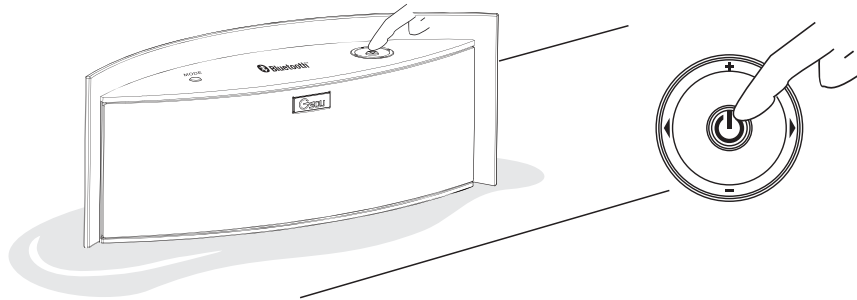

2. Press and hold the button for 3 seconds to start Gsou Bluetooth speaker, The default mode is Bluetooth® source mode. red light and blue light flash alternatively every second. Press and hold the button for 3 seconds. The speaker will power off. (See above image)

Auto power off reminder: Your bluetooth speaker will be power off automatically if it is in standby mode over 15 minutes.

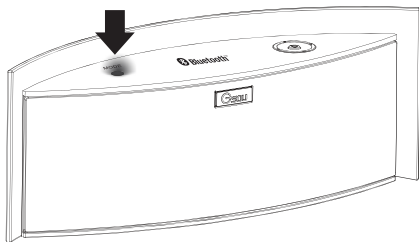

Mode indicator	Speaker status
Red and blue indicator flashes alternatively	Unconnected to bluetooth®
Blue indicator remains steadily on	Connected to Bluetooth source successfully
Red indicator remains steadily on	Connected to AUX in source successfully
Blue indicator flashes once every second	Pairing mode. Ready for pairing.

3. ①Press and hold the mode button for 3 seconds to switch between Bluetooth® mode and Aux in mode. Please make sure your audio cable is inserted into the AUX in jack properly,if you did not insert the audio cable,you can not switch into AUX in mode.②Default mode is Bluetooth® source mode when power on the speaker, red light and blue light flash alternatively before pairing with Bluetooth® device. The blue indicator will remains steadily on after pairing successfully ③The red indicator remains steadily on after connecting with AUX in source successfully. ④Short press the mode button to disconnect the existing Bluetooth® connection, and allow pairing with another Bluetooth® device.

Connect Bluetooth®-enabled audio device with your speaker

1. For iPad/Iphone

- ①. Go to “settings”.
- ②. Go to “General” settings.
- ③. Go to “Bluetooth”
- ④. Go to “Bluetooth” settings and enable your Bluetooth® on
- ⑤. Select “Gsou H100” in the list of Bluetooth® devices (Make sure the speaker is in pairing mode)
- ⑥. Input password “0000 (*four zero)” if required.
- ⑦. Blue led indicator will stop flash and remain steadily on once connected successfully. Your device is ready to use.

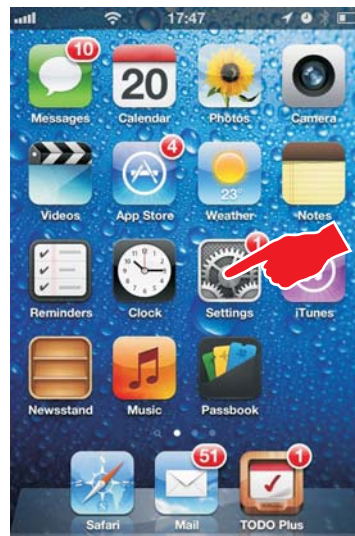

2. For Andriod smart phone and Tablet PC.

- ①. Go to “settings”.
- ②. Go to “Wireless and Network”
- ③. Go to “Bluetooth® settings”
- ④. Go to “Bluetooth® settings’and enable your Bluetooth® visible
- ⑤. Select “Gsou H100”in the list of Bluetooth® devices(Make sure the speaker is in pairing mode)
- ⑥. Input password“0000(*four zero)”if required.
- ⑦. Blue led indicator will stop flash and remain steadily on once connected successfully. Your device is ready to use.

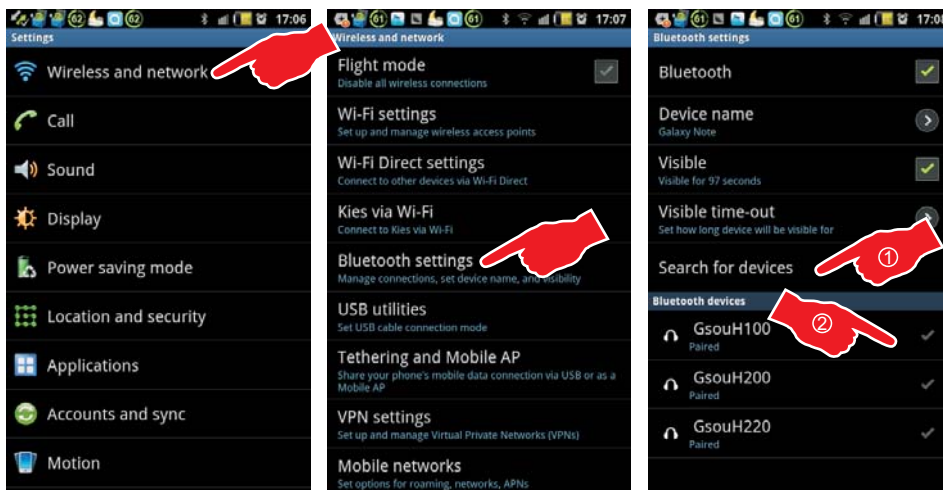

3. For Windows Phone

- ①. Go to “settings”.
- ②. Go to “Bluetooth”
- ③. Tap to turn On your Bluetooth®
- ④. Select “Gsou H100” in the list of Bluetooth® devices (Make sure the speaker is in pairing mode)
- ⑤. Input password “0000(*four zero)” if required.
- ⑥. Blue led indicator will stop flash and remain steadily on once connected successfully. Your device is ready to use.

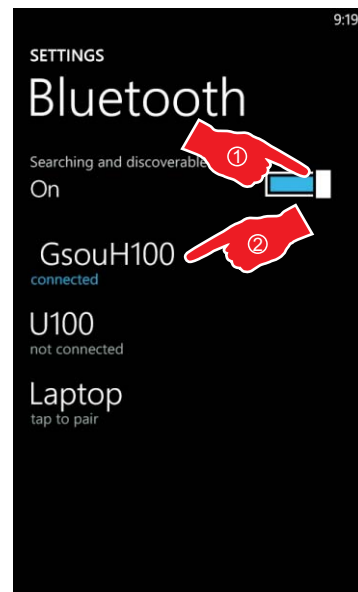
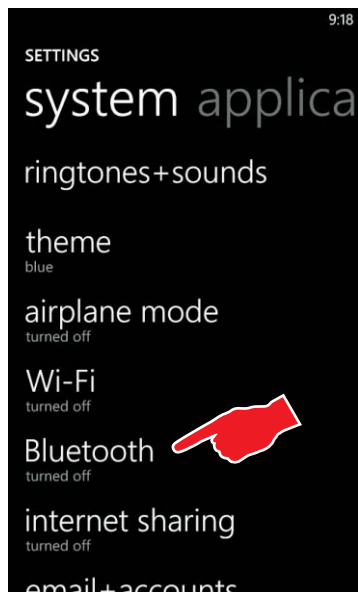
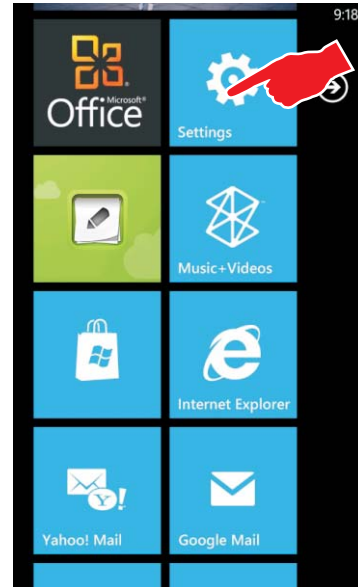

4. For Windows PC

- ① Open the taskbar icon
- ② Click on the Bluetooth® icon
- ③ Click on “add a device”
- ④ Select “Gsou H100” in the list of Bluetooth® devices (Make sure the speaker is in pairing mode) Input password “0000 (*four zero)” if required.
- ⑤ When the device is successfully added, Blue led indicator will stop flash and remain steadily on once connected successfully. your device is ready to use.
- ⑥ Right click the speaker icon in the taskbar
- ⑦ Open the “Playback devices”
- ⑧ Set the “Gsou H100” device as your default device.

5. For Mac system

- ① Click on the Bluetooth® icon in the taskbar
- ② Make sure Bluetooth® is on
- ③ Go to “set up a Bluetooth® device”
- ④ Select “Gsou H100” in the list of Bluetooth® devices (Make sure the speaker is in pairing mode)
- ⑤ Click on “continue”
- ⑥ If the pairing attempt was unsuccessful, Go to “passcode options”
- ⑦ Select “Use a specific passcode”
- ⑧ Input passcode “0000 (*four zero)” Then Click on “OK”
- ⑨ Click on “Continue”
- ⑩ Your device is ready to use

Aux in mode- For non-Bluetooth® stereo devices

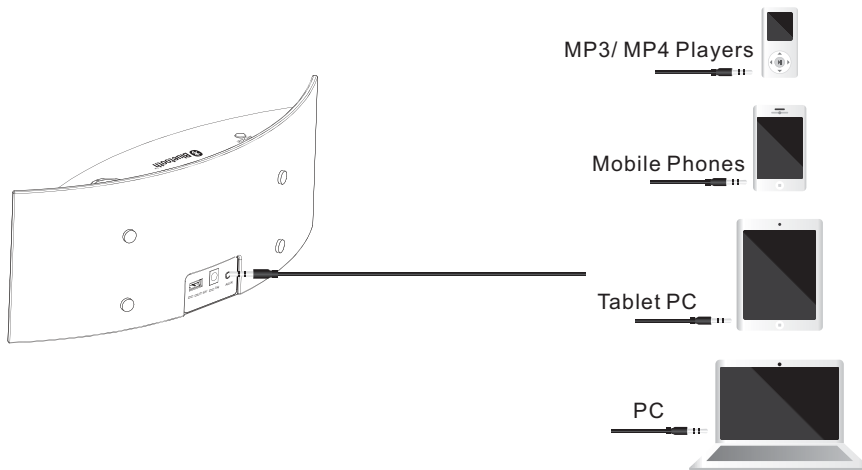

1. Gsou H100 speaker comes with a standard 3.5mm Aux in jack for connecting with other non-Bluetooth® audio device.eg mobile phones, MP3, MP4 players,PC.tablet PC and etc. Plug one end of the audio cable to the AUX in jack in the speaker and the other end connect to audio source.
2. Press and hold the mode button for 3 seconds to switch to Aux in mode.The red indicator will remain steadily on.
3. Now your device is ready to use. You can control your music by both your playback device and buttons on the bluetooth speaker.

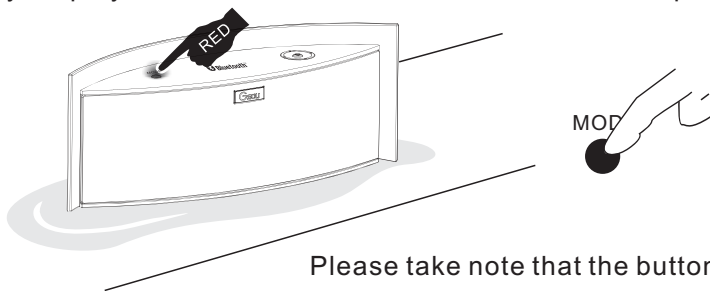

Please take note that the buttons "pre" "next" will not function properly under AUX in mode.

Charge your personal battery powered devices

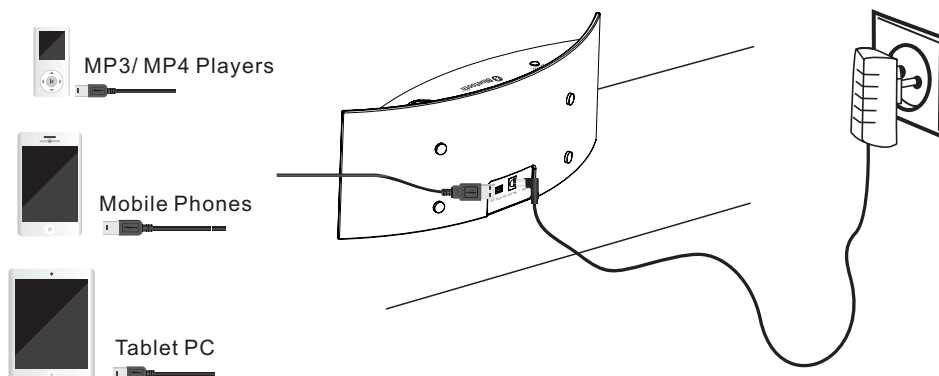

Gsou H100 Speakers comes with an extra USB port for charging your personal devices.

1. Connect your device to Gsou H100 via USB cable.
2. Make sure the input power is 5V for your device.

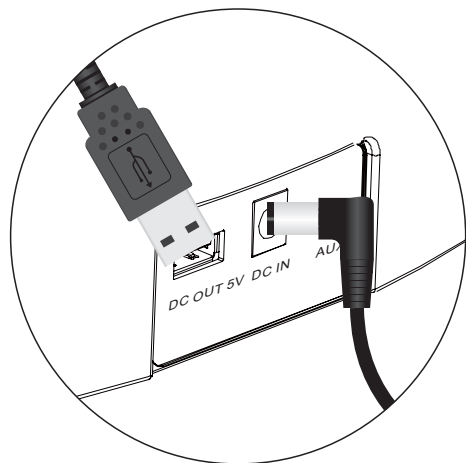

Note: The USB cable is not standard accessory of GsouH100.

Specifications

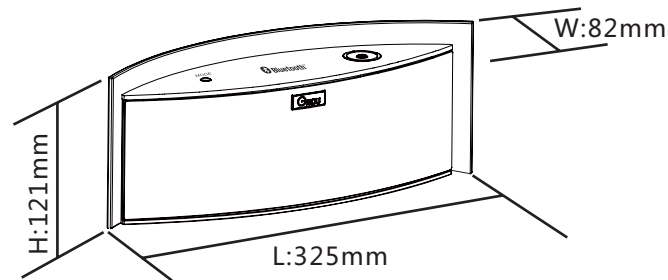

ENGLISH

Channels	2.1 Channel
Speaker	2*3W speaker
Woofer	5W
Bluetooth® chipset	CSR BC05
Bluetooth® version	2.0
Supported protocol and profile	A2DP,AVRCP,HFE,HFP
Working current	Max < 1.6 A
Frequency	2.402-2.480GHz
Effective range	≤10m or 33 feet
Bluetooth® receiver Sensitivity	< -82dBm. BER < 0.1%
Sensitivity	85db
S/N	≥75db
Distortion	≤0.3%
Working temperature	-10°C-55°C
Frequency response	80Hz-10KHz
DC output	DC 5V/1.5A
Power adapter	Input 100-240V.50-60Hz 0.6A
Size :	L325*W82*H121mm
Net Weight:include power adapter and audio cable0	1400g or about 3.08 pounds

Trouble Shooting

Problem	Solution
Speaker will not turn on	<ul style="list-style-type: none"> ◆ Make sure your system is connected to a working AC(mains)outlet
Paired Bluetooth® device will not connect	<ul style="list-style-type: none"> ◆ If your device requires a pass code, make sure to input “0000”four zero. ◆ Turn the Gsou H100 speaker off and back on ◆ Remove the Gsou H100 speaker from the pairing list on your Bluetooth® device pairing list (consult the device owner’s manual for assistance). Then pair the device and the speaker again.
Speaker indicates a connection, but it not playing music	<ul style="list-style-type: none"> ◆ Turn off or disable Bluetooth® on all other paired devices nearby and reconnect the device you want to listen. ◆ Turn the Gsou H100 speaker off and back on.
Can not pair the Gsou H100 with my Bluetooth® device	<ul style="list-style-type: none"> ◆ Make sure your speaker is discoverable ◆ Your Bluetooth® device maybe out of range-try to move closer to your speaker ◆ Make sure your Bluetooth® device supports the transfer of audio ◆ Reset your Bluetooth® speaker
No audio from a Bluetooth® device	<ul style="list-style-type: none"> ◆ Make sure your Gsou H100 is not muted and the volume is up. ◆ Make sure your Bluetooth® device is playing audio and volume is up ◆ Your Bluetooth® device may be out of range, move closer and try ◆ Turn your Bluetooth® speaker off and back on

Problem	Solution
Poor sound quality from a Bluetooth® device	<ul style="list-style-type: none"> ◆Your Bluetooth® device may be out of range, move closer and try again ◆Move your Bluetooth® device and /or Gsou H100 speaker from any device that generates electromagnetic interference, such as another Bluetooth® device, cordless phone, microwave oven or wireless router. ◆Try to turning off WIFI to improve audio quality ◆Make sure your music file is not poor quality. ◆Turn your Bluetooth® speaker off and back on.
No Audio from AUX source	<ul style="list-style-type: none"> ◆make sure your connected device is on and playing ◆Make sure you speaker is in AUX in mode ◆Make sure the audio cable is correctly inserted ◆Increase the volume level on the device and speaker
Poor sound quality from AUX source	<ul style="list-style-type: none"> ◆Reduce the volume level on the AUX source ◆Make sure the 3.5mm audio cable is fully inserted into the speaker and device. ◆Make sure your audio source and music file is not of poor quality

Cleaning

To clean the exterior surface of your speaker, you can wipe it using a soft, dry cloth.

- ◆Do not use solvents, chemicals, or sprays.
- ◆Do not allow liquid to spill or objects to drop into any openings.

Limited Warranty

Your Gsou H100 bluetooth® speaker is covered by a limited warranty. It is backed by 1 year performance warranty against any manufacturing defects in material or workmanship from the date of original purchase, This warranty entitles the purchaser to get the product repaired or replaced under the following conditions:

- ◆The warranty applies to the original purchaser, Proof of original purchase is required
- ◆The warranty does not cover the damage caused by misuse, abuse or improper storage.
- ◆In no event shall Gsou be responsible for any direct, incidental, consequential or other damages of any kind

Contacting Customer Service

For questions about the Gsou H100 Bluetooth® speaker, contact your local Gsou dealer.

To contact Gsou directly, send your E-mail to tech@gsou.cn

Service hotline: [+86-755-83266570](tel:+86-755-83266570)

Toll free [400-0985-400](tel:400-0985-400)

Website: www.gsoutech.com

Statement

The Gsou trademark and logo are registered trademarks of Gsou Technology(Shenzhen)Co.,Ltd All Rights Reserved. All other trademarks, logos or service marks are the property of their respective owners.

Gsou Technology(ShenZhen)Co.,LTD

Add: 14C,Block A,First World plaza,No.7002 West Hongli Road,
Futian District, Shenzhen, China.

Tel: 0086-755-83266570 **Fax:** 0086-755-8325 5400

E-mail: sales@gsou.cn **Website:** www.gsoutech.com

