

# AFi-ALN Quick Start Guide



## Package Contents



Router



MeshPoint

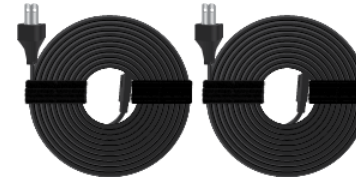

Power Cables (Qty. 2)



Ethernet Cable

## Hardware Overview

### Router

## AFi-ALN Quick Start Guide

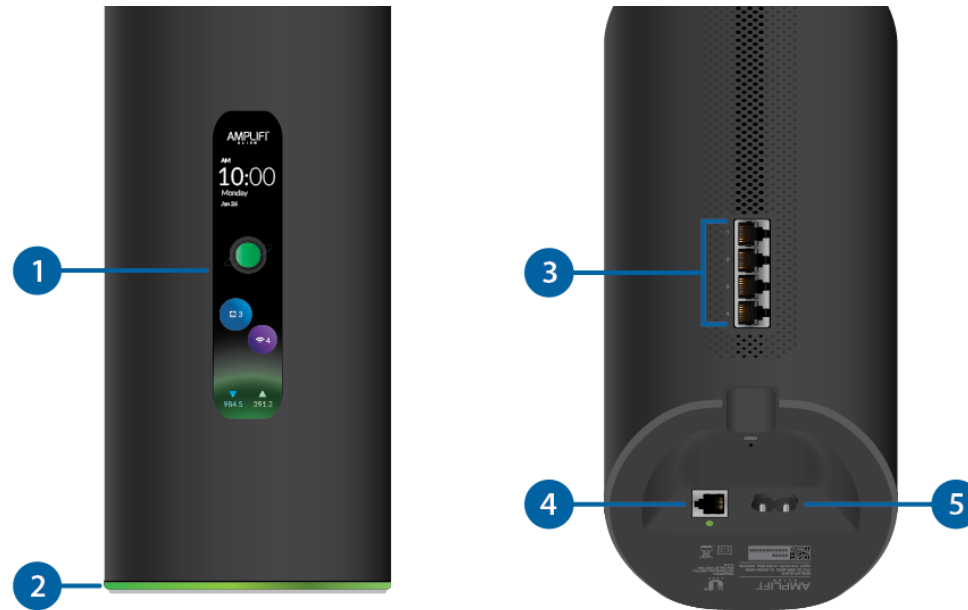

### 1 Touchscreen Display

The front of the AmpliFi Router features a touchscreen display.

### 2 Adjustable LED

The bottom of the AmpliFi Router features an adjustable LED that is fully lit by default when the Router is configured and ready for use.



The brightness settings of the touchscreen and LED are configurable using the AmpliFi app.

### 3 Ethernet Ports

(4) Gigabit Ethernet ports available to connect 10/100/1000 Mbps wired network device to the internet.

## AFi-ALN Quick Start Guide

Connects to the broadband modem provided by your ISP (Internet Service Provider).

**5** Power Port

The Power Cable connects to this port.

## MeshPoint

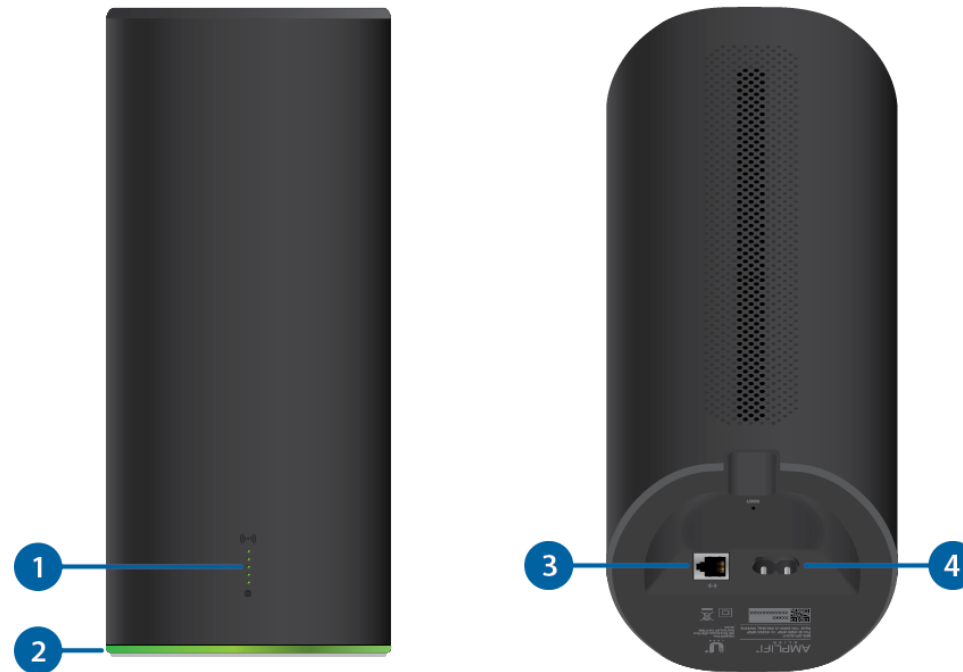
**1** Signal LEDs

The Signal LEDs will reflect signal strength once the MeshPoint is connected to the Router.

**2** Adjustable LED

## AFi-ALN Quick Start Guide

default when the Router is configured and ready for use.



The brightness settings of the touchscreen and LED are configurable using the AmpliFi app.

### 3 Ethernet Port

Gigabit Ethernet port available to connect a 10/100/1000 Mbps wired network device to the internet.

### 4 Power Port

The Power Adapter connects to this port.

## Installation

The AmpliFi Router can be installed using one of the following methods:

- [App Users](#) AmpliFi app for iPhone or Android™
- [Non-App Users](#) Connect to default AmpliFi wireless network (SSID) from a computer or tablet.

## App Users

1.

# AFi-ALN Quick Start Guide

AMPLIFI



2.

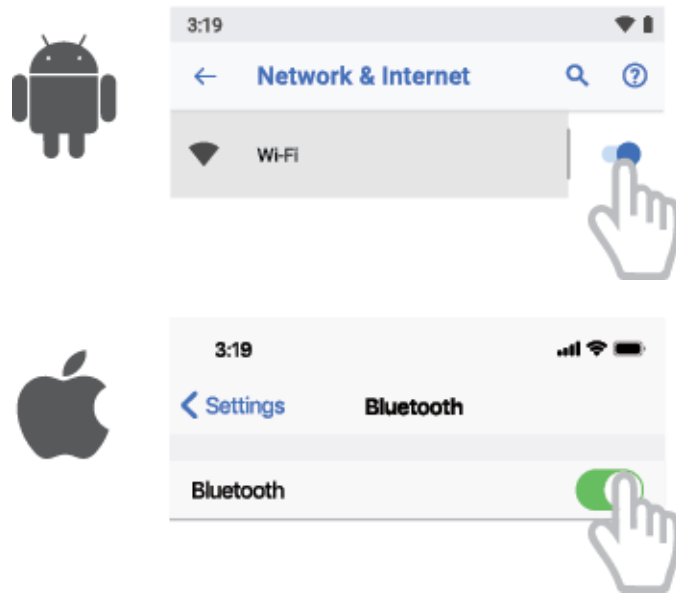

# AFi-ALN Quick Start Guide



3.

# AFi-ALN Quick Start Guide

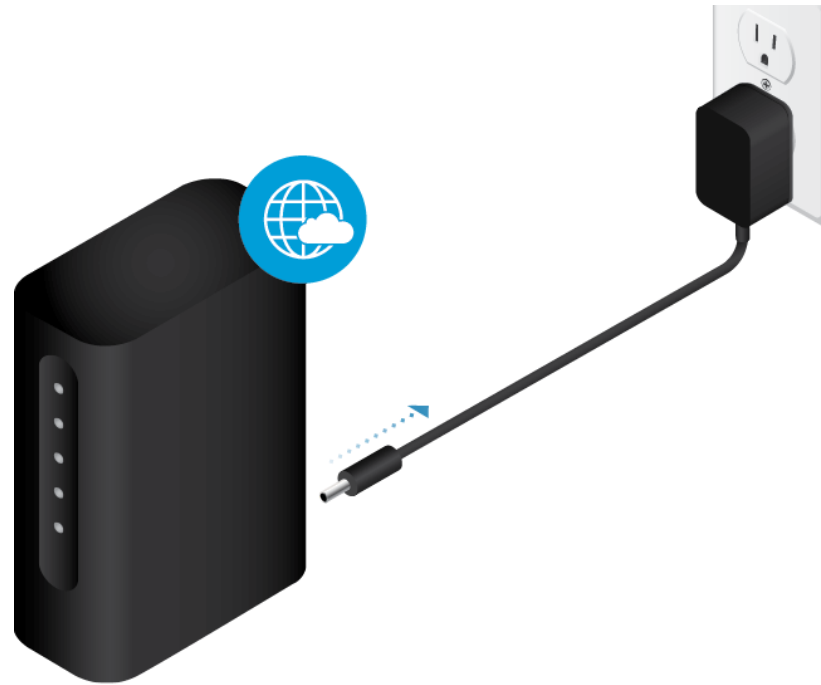

4.



# AFi-ALN Quick Start Guide



6.



# AFi-ALN Quick Start Guide



7.



# AFi-ALN Quick Start Guide

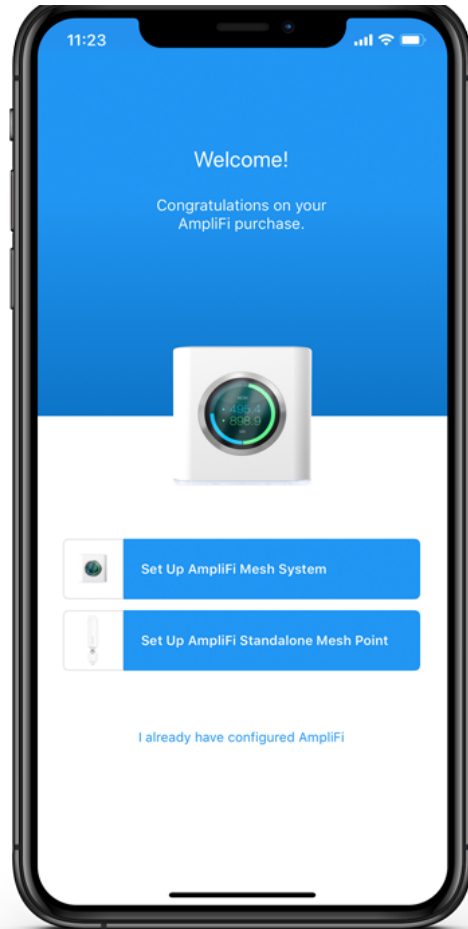

## Non-App Users

- 1.

# AFi-ALN Quick Start Guide

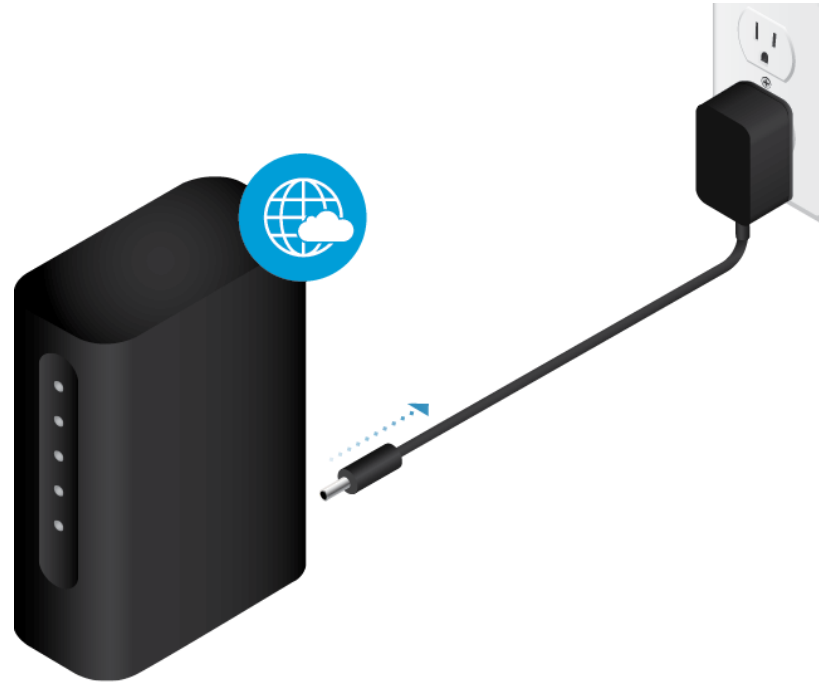

2.



# AFi-ALN Quick Start Guide



4.

# AFi-ALN Quick Start Guide



5.

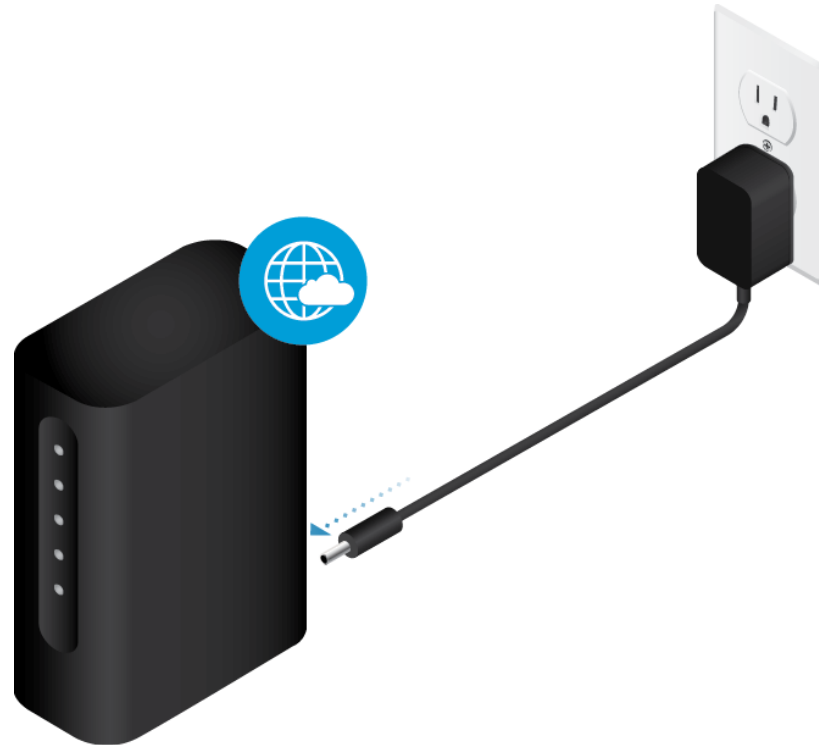

# AFi-ALN Quick Start Guide



7.

# AFi-ALN Quick Start Guide



8.

# AFi-ALN Quick Start Guide

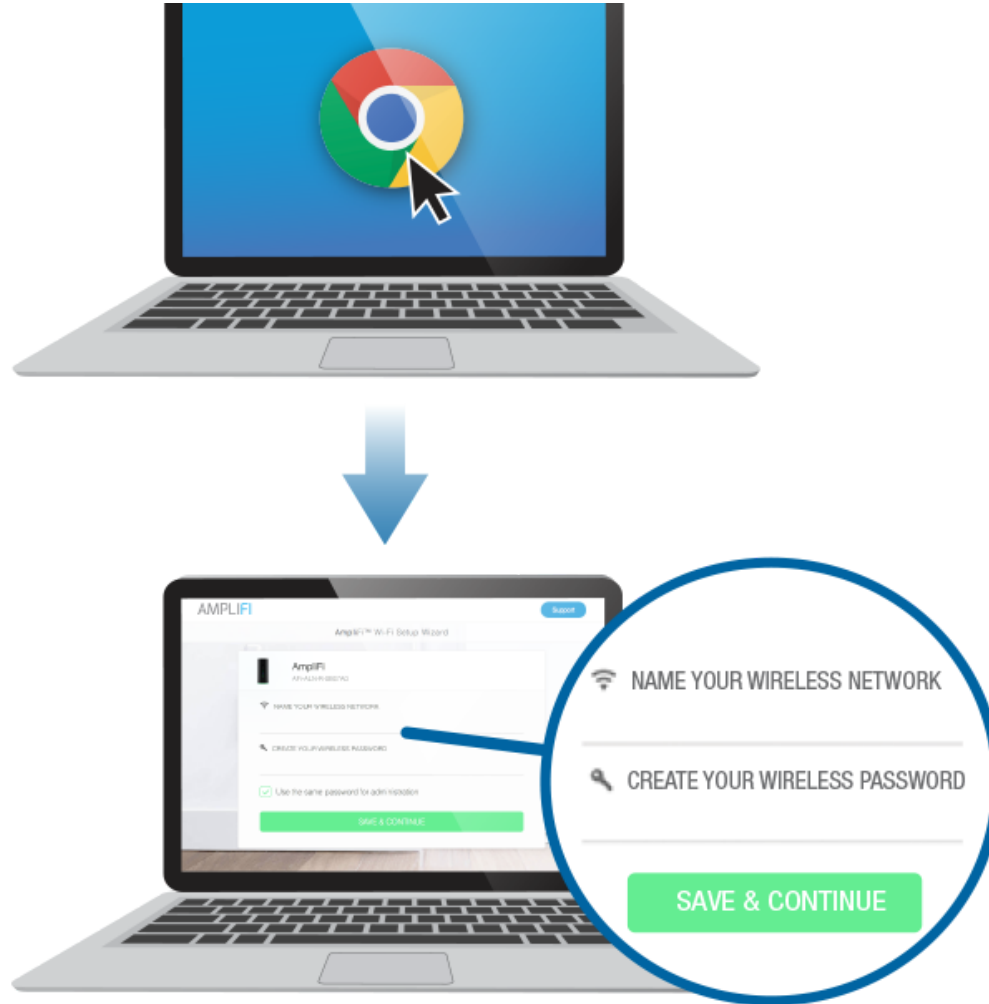

9. Connect to the new wireless network that you've created.



## AFi-ALN Quick Start Guide



## Installing the MeshPoint

1.

# AFi-ALN Quick Start Guide



2.

## AFi-ALN Quick Start Guide

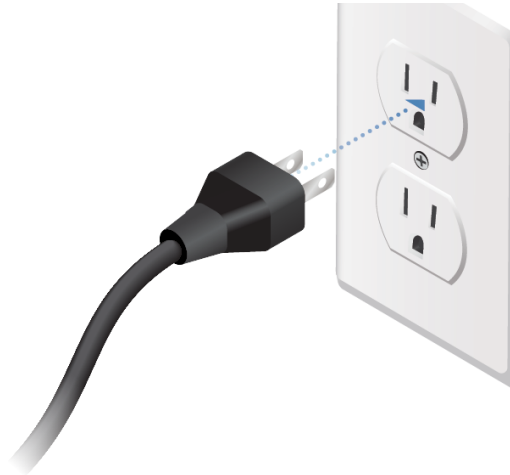

## App Features



System

The system dashboard is displayed in the System window. It provides an overview of the AmpliFi Wi-Fi system including network status, number of connected clients, and active download/upload speeds. Tap devices to display/edit settings.



Performance

Tap Start Test on the Performance screen to run a speed test that will provide your download speed, upload speed, and connection ping time. Swipe left on the throughput section to view additional data. A history of recent tests is displayed at the bottom.



Guest

To provide guest access, determine the number of guests, select a time limit for their access, and tap Start. Guests simply connect to your wireless network named with the -guest label. No password is required. As guests connect, the number of users connected will be displayed in the app. Tap Stop at any time to turn off the guest network.

The Family Profiles feature allows you to create profiles for family members, groups, or areas of your home. Assign devices to the profile,

## AFi-ALN Quick Start Guide



The Diagnose option will check your WAN link, IP settings, internet connection, and MeshPoint status.

## Side Menu - 24/7 Live Chat Support

Tap  in the upper left of the app to access the side menu. Tap Live Support for 24/7 live chat support. Remote Access can also be enabled from this menu.

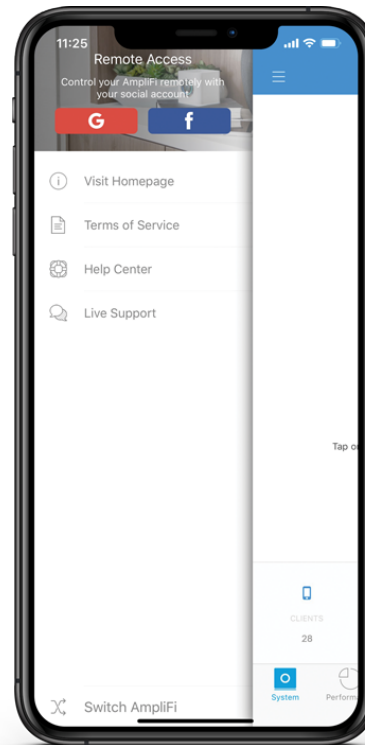

## AFi-ALN Quick Start Guide

If the AmpliFi Router administration password is lost, factory default settings can be restored.



### 1 Router Reset

Use an object such as a straightened paper clip to press Reset located on the bottom of the AmpliFi Router for approximately 10 seconds until the LED turns off.

## System Specifications

---

## AFi-ALN Quick Start Guide

Weight	Router: 1.2 kg ( 2.65 lb), MeshPoint 1.09 kg ( 2.40 lb)
Max. TX Power	2.4 GHz: 23 dBm per chain, 5 GHz 19 dBm per chain (low band)/ 20 dBm per chain (high band):
MIMO	2.4 GHz: 4x4, 5 GHz: 4x4 (low-band) + 8x8 (high band)
Speeds	2.4 GHz: 1150 Mbps, 5 GHz: 1700 Mbps (low band)/ 4800 Mbps (high band)
Range	21,000 sq. ft
Max. Power Consumption	Router: 35W, MeshPoint: 34W
Power Method	AC
Power Supply	AC Outlet Directly
Supported Power Voltage	100-240V
ESD/EMP Protection	± 24kV Air/Contact
Buttons	Reset
Antennas	(2) Internal Dual-Band Metal Stamp with 12 Polarity
Antenna Gain	2.4 GHz: 4 dBi, 5 GHz: 3.5 dBi
Wi-Fi Standard	Up to Wi-Fi 6
Power Save	Yes
Wireless Security	WPA2, WPA3, OWE
Operating Temperature	14 to 113° F (-10 to 45° C)
Operating Humidity	5 to 95% Noncondensing
Certifications	FCC / IC

## Supported Data Rates

802.11a	54 Mbps
---------	---------

## AFi-ALN Quick Start Guide

802.11g	54 Mbps
802.11n	600 Mbps + 600 Mbps
802.11ac	1733 Mbps+ 800 Mbps
802.11ax (Backbone)	4800 Mbps Router-Mesh Connection
802.11ax (Available to Clients)	1148 Mbps

## Operating Frequency

US/CA		2412 - 2462
	U-NII-1	5150 - 5250
	U-NII-3	5725 - 5850

## Safety Notices

1. Read, follow, and keep these instructions.
2. Heed all warnings.
3. Only use attachments/accessories specified by the manufacturer.



**WARNING:** Do not use this product in location that can be submerged by water.



**WARNING:** Avoid using this product during an electrical storm. There may be a remote risk of electric shock from lightning.

## Limited Warranty

[ui.com/support/warranty](http://ui.com/support/warranty)

The limited warranty requires the use of arbitration to resolve disputes on an individual basis, and, where applicable, specify arbitration instead of jury trials or class actions.

## AFi-ALN Quick Start Guide

### FCC

Changes or modifications not expressly approved by the party responsible for compliance could void the user's authority to operate the equipment.

This device complies with Part 15 of the FCC Rules. Operation is subject to the following two conditions.

1. This device may not cause harmful interference, and
2. This device must accept any interference received, including interference that may cause undesired operation.

This equipment has been tested and found to comply with the limits for a Class B digital device, pursuant to Part 15 of the FCC Rules. These limits are designed to provide reasonable protection against harmful interference in a residential installation. This equipment generates, uses, and can radiate radio frequency energy and, if not installed and used in accordance with the instructions, may cause harmful interference to radio communications. However, there is no guarantee that interference will not occur in a particular installation. If this equipment does cause harmful interference to radio or television reception, which can be determined by turning the equipment off and on, the user is encouraged to try to correct the interference by one or more of the following measures:

- Reorient or relocate the receiving antenna.
- Increase the separation between the equipment and receiver.
- Connect the equipment into an outlet on a circuit different from that to which the receiver is connected.
- Consult the dealer or an experienced radio/TV technician for help.

The AmpliFi Router and MeshPoint have been approved by FCC under FCC ID: SWX-AFAR (for Router); FCC ID: SWX-AFAP (for MeshPoint).

### ISED Canada

#### CAN ICES-3(B)/NMB-3(B)

This device complies with ISED Canada licence-exempt RSS standard(s). Operation is subject to the following two conditions:



## AFi-ALN Quick Start Guide

operation of the device.

The AmpliFi Router and MeshPoint have been approved by ISED Canada under IC: 6545A-AFAR (for Router); IC: 6545A-AFAP (for MeshPoint).

The device for operation in the band 5150-5250 MHz is only for indoor use to reduce the potential for harmful interference to co-channel mobile satellite systems.

### CAN ICES-3(B)/NMB-3(B)

Le présent appareil est conforme aux CNR d'ISDE Canada applicables aux appareils radio exempts de licence. L'exploitation est autorisée aux deux conditions suivantes :

1. l'appareil ne doit pas produire de brouillage;
2. l'appareil doit accepter tout brouillage radioélectrique subi, même si le brouillage est susceptible d'en compromettre le fonctionnement.

Le AMPLIFI Router et MeshPoints ont été approuvés par ISDE Canada ISED Canada en vertu IC : 6545A-AFAR ( pour le routeur ) ; IC : 6545A-AFAP ( pour MeshPoint ).

Les dispositifs fonctionnant dans la bande 5150-5250 MHz sont réservés uniquement pour une utilisation à l'intérieur afin de réduire les risques de brouillage préjudiciable aux systèmes de satellites mobiles utilisant les mêmes canaux.

### IMPORTANT NOTE:

#### Radiation Exposure Statement:

- This equipment complies with radiation exposure limits set forth for an uncontrolled environment.
- This equipment should be installed and operated with minimum distance 27 cm between the radiator and your body.
- This transmitter must not be co-located or operating in conjunction with any other antenna or transmitter.

### AVIS IMPORTANT :

#### Déclaration sur l'exposition aux rayonnements :

## AFi-ALN Quick Start Guide

- Lors de l'installation et de la mise en fonctionnement de l'équipement, assurez-vous qu'il y ait une distance minimale de 27 cm entre l'élément rayonnant et vous.
- Cet émetteur ne doit être installé à proximité d'aucune autre antenne ni d'aucun autre émetteur, et ne doit être utilisé conjointement à aucun autre de ces appareils.

## [RoHS/WEEE Compliance Statement](#)

## [Declaration of Conformity](#)

## Online Resources

