

INTEX® OWNER'S MANUAL

FLOATING POOL SPEAKER WITH LED LIGHT

Model FLS625 IPX7

337
PO

READ AND FOLLOW ALL INSTRUCTIONS BEFORE USING THIS PRODUCT

WARNING

- This product is not a toy, keep away from children.
- Do not dispose of batteries in regular trash, municipal waste stream or by fire as battery may leak or explode.
- Do not stare directly at the light emitted by this product.
- This product is resistant to water, but it is not designed to be completely submerged. Submersion could cause water to enter the product causing damage to the electronics.
- Do not sit, straddle, step or exert pressure on the product.

FOLLOW THESE RULES AND ALL INSTRUCTIONS TO AVOID PROPERTY DAMAGE OR OTHER INJURY.

Caution:

This device complies with Part 15 of the FCC Rules. Operation is subject to the following two conditions: (1) this device may not cause harmful interference, and (2) this device must accept any interference received, including interference that may cause undesired operation.

Changes or modifications not expressly approved by the party responsible for compliance could void the user's authority to operate the equipment.

This equipment has been tested and found to comply with the limits for a Class B digital device, pursuant to part 15 of the FCC Rules. These limits are designed to provide reasonable protection against harmful interference in a residential installation. This equipment generates uses and can radiate radio frequency energy and, if not installed and used in accordance with the instructions, may cause harmful interference to radio communications. However, there is no guarantee that interference will not occur in a particular installation. If this equipment does cause harmful interference to radio or television reception, which can be determined by turning the equipment off and on, the user is encouraged to try to correct the interference by one or more of the following measures:

- Reorient or relocate the receiving antenna.
- Increase the separation between the equipment and receiver.
- Connect the equipment into an outlet on a circuit different from that to which the receiver is connected.
- Consult the dealer or an experienced radio/TV technician for help.

 **INTEX® SAVE THESE INSTRUCTIONS**

337-PO-R0-1807

MPE Reminding

To satisfy FCC RF exposure requirements, a separation distance of 20 cm or more should be maintained between the antenna of this device and persons during device operation.

To ensure compliance, operations at closer than this distance is not recommended.

General Information and Maintenance Instructions:

- **Bluetooth open air transmission range: 25-30 m (82-98 ft).**
- This product operates on three (3) AA size batteries (not included).
- Alkaline batteries are recommended. Rechargeable batteries are okay to use.
- **Remove batteries if speaker is not to be used for an extended period of time.**
- Do not mix old and new batteries. Do not mix alkaline, standard (Carbon - Zinc), or rechargeable (Nickel - Cadmium) batteries.
- Dry any water on the product prior to battery installation. Remove used batteries promptly. Replace all 3 batteries at the same time.
- Always purchase the correct size and grade of battery most suitable for the intended use. Ensure batteries are installed correctly with regard to polarity (+ and -). Clean the battery contacts and also those of the device prior to battery installation.
- To clean the product, use only a damp cloth. Avoid strong cleaner, excessive water and abrasive brush.
- **Do not use needle or any sharp object to clean the speaker mesh surface as this will damage the waterproof layer.**
- **Store the product indoors when not in use.**



©2017 Intex Marketing Ltd. - Intex Development Co. Ltd. - Intex Trading Ltd. - Intex Recreation Corp. All rights reserved/Tous droits réservés/Todos los derechos reservados/Alle Rechte vorbehalten.

Printed in China/Imprimé en Chine/Impreso en China/Gedruckt in China.

®™ Trademarks used in some countries of the world under license from®™ Marques utilisées dans certains pays sous licence de/Marcas registradas utilizadas en algunos países del mundo bajo licencia de/Warenzeichen verwendet in einigen Ländern der Welt in Lizenz von/Intex Marketing Ltd. to/a/an Intex Trading Ltd., Intex Development Co. Ltd., G.P.O Box 28829, Hong Kong & Intex Recreation Corp., P.O. Box 1440, Long Beach, CA 90801 • Distributed in the European Union by/Distribué dans l'Union Européenne par/Distribuido en la unión Europea por/Vertrieb in der Europäischen Union durch/Intex Trading B.V., Venneveld 9, 4705 RR Roosendaal - The Netherlands
www.intexcorp.com

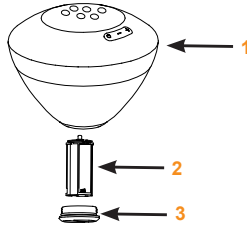

SAVE THESE INSTRUCTIONS

Parts reference:

REF. NO.	DESCRIPTION	QTY.	SPARE PART NO.
1	SPEAKER BODY	1	12553
2	BATTERY HOUSING	1	12401
3	HOUSING COVER	1	12400

Due to a policy of continuous product improvement, Intex reserves the right to change specifications and appearance, which may result in updates to the instruction manual without notice.

To install or replace the batteries:

1. Dry product completely. **Unscrew the housing cover (3) and take out the battery housing (2)** (see Fig 1).
2. **Insert 3 AA size batteries following the orientation shown on the battery housing (2)** (see Fig 2).
3. **Reinstall the battery housing (2) and securely tighten the housing cover (3) by hand only** (see Fig 3).

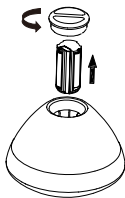

Fig 1

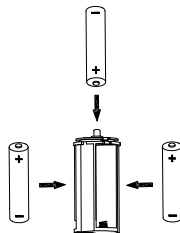

Fig 2

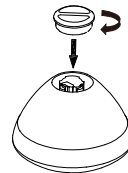



Fig 3

Note: When the batteries are low in power, the device will flash a red light for about 10 seconds and then switch off automatically. Replace the batteries promptly.

SAVE THESE INSTRUCTIONS

Operation instructions:

- 1. Turn ON:** Press  button for 2 seconds, the device will emit a sound and flash a blue light for 1 second. For first time after purchase, a blue light will flash indicating the speaker is in pairing mode. See below "Pairing and Connecting" section for details.

Turn OFF: Press  button for 2 seconds, the device will emit a sound and flash a red light for 1 second.



- 2. Pause / Play:**

When the speaker is playing the music, press  button once to pause the music, press  again to continue playing the music.

- 3. Volume adjustment:**

Press and hold  button to increase the volume.
Press and hold  button to decrease the volume.

- 4. Changing song:**

When the speaker is playing the music, short press  button to switch to the "last" song, short press  button to switch to the "next" song.

- 5. Pairing and connecting with a Bluetooth device:**

Pairing is required to mutually register the information on Bluetooth devices. It is necessary to pair a device with the speaker to be able to make a Bluetooth connection for the first time. The speaker can be paired with one Bluetooth device only. Before operating the speaker do the following:

- Place the Bluetooth device within 1 m (3 ft) of the speaker.
- Make sure the speaker's batteries are new and stop playback on the Bluetooth device.
- Prepare the operating instructions supplied with the Bluetooth device for reference.
 - a) Turn on the speaker. When the speaker is turned on for the first time after purchase, a blue light will begin to flash and the speaker goes into pairing mode automatically by just turning on the speaker.
 - b) Perform the pairing procedure on the Bluetooth device; it will display a list of detected devices, select "**FLS625**".
 - c) The Bluetooth device will make the Bluetooth connection, when the connection is established the speaker flashing blue light will go away and the multi-color changing lights will light up.

Note:

- Whenever the speaker is turned on, the speaker tries to make a Bluetooth connection with the last connected Bluetooth device. If the device is nearby and its Bluetooth function is on, the Bluetooth connection is established automatically and the multi-color changing light is lit.
- When you want to connect another Bluetooth device, terminate the current Bluetooth connection by operating the currently connected Bluetooth device.
- If the Bluetooth connection is not established within 10 minutes, the speaker will turn off automatically.

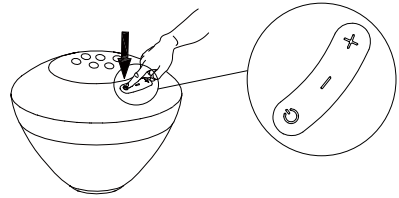

SAVE THESE INSTRUCTIONS

Troubleshooting guide:

- Q.** What should I do if the product does not light up?
- A.** 1. Check the **battery housing** to ensure 3 **AA** batteries are installed correctly with regard to polarity (+ and -).
2. **Check that the battery housing is snug (hand tightened).**
3. Replace the batteries.
- Q.** What should I do if the light emitted by this product is too weak?
- A.** 1. **Clean outside surface of the shade using mild soapy solution.**
2. Replace all batteries with 3 new **AA** batteries.
- Q.** What should I do if the device is flashing red light?
- A.** Replace the batteries.
- Q.** What should I do if the speaker sound is blurry, not as loud and clear as before?
- A.** 1. **Make sure the speaker mesh surface is clean and dry, use a dry cloth to wipe out any water.**
2. **Check and adjust the volume and sound settings on your Bluetooth device.**
- Q.** Why my Bluetooth device no longer connects to the speaker automatically after the speaker is turn on?
- A.** **Activate the Bluetooth on your device. Make sure the speaker (FLS625) information is stored in your Bluetooth device, if deleted repeat the "Pairing and connecting with a Bluetooth device" steps.**

This equipment has been tested and found to comply with the limits for a Class B digital device, pursuant to part 15 of the FCC Rules. These limits are designed to provide reasonable protection against harmful interference in a residential installation. This equipment generates, uses and can radiate radio frequency energy and, if not installed and used in accordance with the instructions, may cause harmful interference to radio communications. However, there is no guarantee that interference will not occur in a particular installation. If this equipment does cause harmful interference to radio or television reception, which can be determined by turning the equipment off and on, the user is encouraged to try to correct the interference by one or more of the following measures:

- Reorient or relocate the receiving antenna.
- Increase the separation between the equipment and the receiver.
- Connect the equipment into an outlet on a circuit different from that to which the receiver is connected.
- Consult the dealer or an experienced radio/TV technician for help.

This device complies with part 15 of the FCC Rules. Operation is subject to the following two conditions: (1) This device may not cause harmful interference, and (2) this device must accept any interference received, including interference that may cause undesired operation.

CAN ICES-005 (B)/NMB-005 (B)

SAVE THESE INSTRUCTIONS

Limited Warranty

Your **FLOATING POOL SPEAKER WITH LED LIGHT** has been manufactured using the highest quality materials and workmanship. All Intex products have been inspected and found free of defects prior to leaving the factory. This Limited Warranty applies only to the **FLOATING POOL SPEAKER WITH LED LIGHT**.

The provisions of this Limited Warranty apply only to the original purchaser and is not transferable. This Limited Warranty is valid for a period of one (1) year from the date of the initial retail purchase. Keep your original sales receipt with this manual, as proof of purchase will be required and must accompany warranty claims or the Limited Warranty is invalid.

If a manufacturing defect is found within this one (1) year period, please contact the appropriate Intex Service Center listed in the separate "Authorized Service Centers" sheet. The Service Center will determine the validity of the claim. If the Service Center directs you to return the product, please carefully package the product and send with shipping and insurance prepaid to the Service Center. Upon receipt of the returned product, the Intex Service Center will inspect the item and determine the validity of the claim. If the provisions of this warranty cover the item, the item will be repaired or replaced at no charge.

Any and all disputes regarding the provisions of this Limited Warranty shall be brought before an informal dispute settlement board and unless and until the provisions of these paragraphs are carried forth, no civil action may be instituted. The methods and procedures of this settlement board shall be subject to the rules and regulations set forth by the Federal Trade Commission (F.T.C.). **IMPLIED WARRANTIES ARE LIMITED TO THE TERMS OF THIS WARRANTY AND IN NO EVENT SHALL INTEX, THEIR AUTHORIZED AGENTS OR EMPLOYEES BE LIABLE TO THE BUYER OR ANY OTHER PARTY FOR DIRECT OR CONSEQUENTIAL DAMAGES OR LIABILITIES.** Some states, or jurisdictions do not allow the exclusion or limitation of incidental or consequential damages, so the above limitation or exclusion may not apply to you.

This Limited Warranty does not apply if the product is subject to negligence, abnormal use or operation, accident, improper operation, improper voltage or current contrary to operating instructions, or to damage by circumstances beyond Intex's control, including but not limited to, ordinary wear and tear and damage caused by exposure to fire, flood, freezing, rain, or other external environmental forces. This Limited Warranty applies only to those parts and components sold by Intex. The Limited Warranty does not cover unauthorized alterations, repairs or disassembly by anyone other than Intex Service Center personnel.

DO NOT GO BACK TO THE PLACE OF PURCHASE FOR RETURN OR REPLACEMENT. IF YOU ARE MISSING PARTS OR NEED ASSISTANCE, PLEASE CALL US TOLL-FREE (FOR U.S. AND CANADIAN RESIDENTS): 1-800-234-6839.

Proof of Purchase must accompany all returns or the warranty claim will be invalid.

SAVE THESE INSTRUCTIONS