

THE INFORMATION CONTAINED IN THIS DRAWING IS THE SOLE PROPERTY OF HANSONG(NANJING) TECHNOLOGY CO.,LTD. ANY REPRODUCTION IN PART OR WHOLE WITHOUT THE WRITTEN PERMISSION OF HANSONG(NANJING) TECHNOLOGY CO.,LTD.IS PROHIBITED

STAGE	CONFIRM	REVISIONS		
VC		REV	CHANGE DETAIL	ECR NO
PP		B	结构件调整, 丝印对应调整	RD17-2023020226 Poppy
MP	✓	C	IN2 改为OUT1;OUT改为OUT2	RD17-2024050029 Poppy 20240425

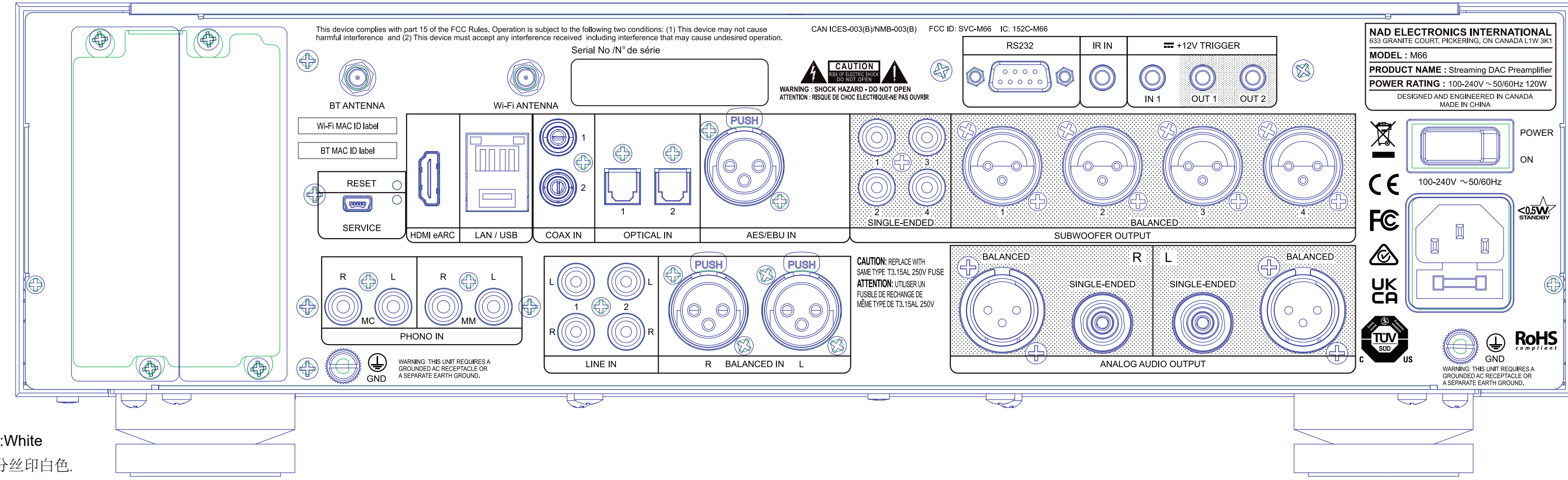

UV-inks:White
黑色部分丝印白色.

仅参考丝印位置, 不用作丝印制版

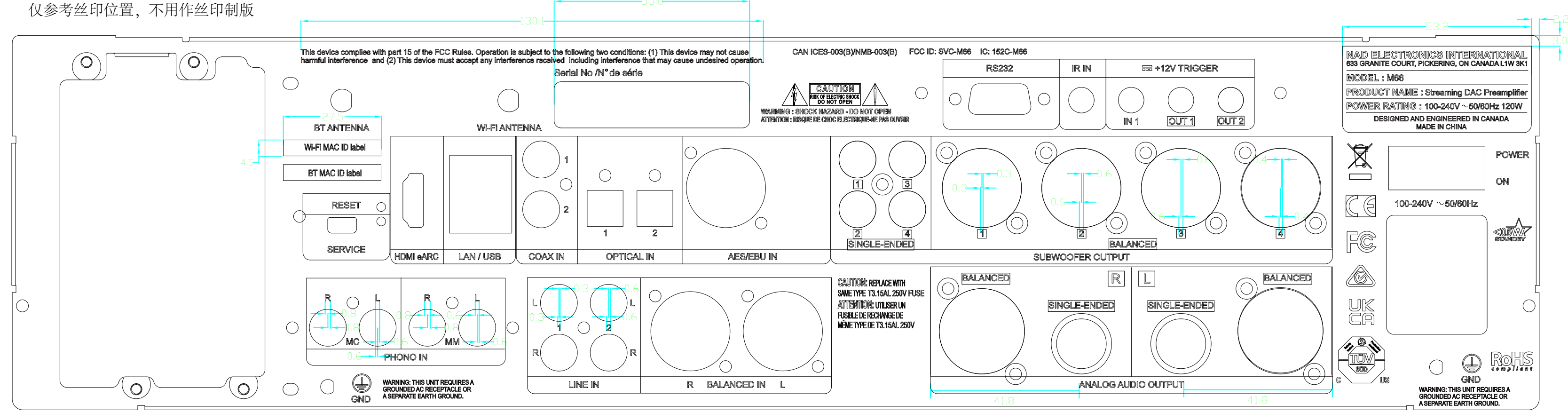

ITEM	PART OR IDENTIFYING NO.	NOMENCLATURE OR DESCRIPTION	QTY REQD	COMMENT
PART LIST				
Material		CAD generated drawing Don't manually update	HANSONG(NANJING) TECHNOLOGY CO.,LTD NO.HS/QR-RD-26	
Finish		APPROVALS Drawn by ME Poppy Checked by Group Leader Lydia	DATE 2024/05/13	PART NAME M66后背板丝印文件
		VIEW 3RD ANGLE PROJECTION (Max) D=3L/1000	Checked by Team leader Michael Checked Compliance/ME Manager	NO 63-3-118801-2C
			DWG NO	HS40-1188-B12V1-SR01C
			SCALE	1:1
			REV	C
			A3 SIZE	SHEET1 OF 1

丝印定位公差表			
	整体左右偏移 LOGO	整体上下偏移 LOGO	整体倾斜偏移 LOGO
塑料件/铝件/ 钣金件/硅胶件	±0.2mm	±0.2mm	0.2mm
木箱	±1mm ±0.2mm(孔中心对齐)	±1mm ±0.2mm(孔中心对齐)	0.2mm
玻璃件/透明塑料 平板件	±0.15mm	±0.15mm	0.2mm