

Klipsch

KLIPSCH.COM

Klipsch Group Europe B.V., 3502 Woodview Trace
Kapteynstraat 1, 2201 BB Indianapolis, IN, USA
Noordwijk, the Netherlands

Model: the One
with Google Assistant

This device complies with Part 15 of the FCC Rules. Operation is subject to the following two conditions:

- (1) this device may not cause harmful interference, and
- (2) this device must accept any interference received, including interference that may cause undesired operation.

CAN ICES-3 (B)/NMB-3(B)

FCC ID: STI-ONEGVA
IC: 5788A-ONEGVA

Serial No.

MAC ID

RESET



Designed with pride in Indianapolis

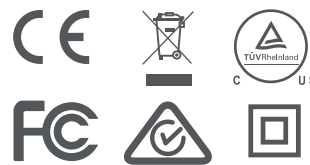

AVIS: RISQUE DE CHOC ELECTRIQUE-NE PAS OUVRIR

Made in China

Compliant with US EPA TSCA Title VI & CARB P2

the One

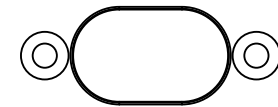

AC IN
100-240V~50/60Hz,
50W



Label Location