

IT-313H Monitor

A *smarter* approach to RTLS. CenTrak's ITK-313H Monitor is a key component for delivering room-level certainty for RTLS through the use of CenTrak's Gen2IR™.



ITK-313H Monitor



ITK-313H Mounted to Ceiling

- CenTrak Gen2IR Technology for accurate room-level location
- Battery powered
- Can be configured and monitored over-the-air by central server for superior control
- Simple to install ceiling tile mounting bracket, no in-room wiring required

The Monitor is an IR (infrared) signaling unit which enables room level certainty for CenTrak's suite of asset, staff and patient tags. Each Monitor transmits an infrared pulse pattern containing a unique location code.

About CenTrak Gen2IR Technology

The CenTrak proprietary IR protocol achieves a marked improvement over conventional IR protocols that were designed for remote control applications. It provides superior resilience to fluorescent and other common indoor interference sources.

Since infrared is light, and light cannot penetrate walls, Gen2IR enables room-level certainty for the CenTrak RTLS system. Gen2IR does not need line of sight for effective communication. IR signals bounce effectively from structures and walls and flood the entire room including locations that are not in direct line of sight to the monitor.

The battery operation and the extremely simple mounting mechanism allows for the quick and low cost installation.

IT-313H Monitor

Technical Specifications



IT-313H Monitor



IT-313H Mounted to Ceiling

Operation

FCC Operating Frequency Range	902-928 MHz
CE Operating Frequency Range	868-870 MHz

Reach

Maximum Room Size	20' square rooms (400 square feet)
Maximum Range	Up to 60'

Enclosure

Diameter	6.5 in (165.1 mm)
Height	2.25 in (57.15 mm)
Weight	18 oz (.51 kg) without batteries
Mounting	Ceiling tile clip, wall-mount, desktop operation
Monitor Mounting Plate	ITA-352
Mounting Accessories	Various items detailed on page 3

Environmental

Operating Temperature	-20 C to +70 C
Storage temperature	-25 C to +80 C
Operating Humidity	Splash resistant or optional weatherproof case

Power

Battery option	Pre-installed Lithium
Wired option	7.5 DC Volt, 500 mA

Available features may vary based upon the mode of operation.

This component complies with part 15 of the FCC Rules. Operation is subject to the following two conditions: 1) The device may not cause harmful interference, and 2) this device must accept any interference received, including interference that may cause undesired operation. Modifying or tampering with the transceiver's or receiver's internal components can cause a malfunction, invalidate the warranty, and will void FCC authorization to use these products. This product or its systems are covered by one or more of the following U.S. patents: 5,917,425, 7,061,428, 7,378,964, 7,619,532.

L' utilisation de ce dispositif est autorisée seulement aux conditions suivantes : (1) Il ne doit pas produire de brouillage et (2) l' utilisateur du dispositif doit être prêt à accepter tout brouillage radioélectrique reçu, même si ce brouillage est susceptible de compromettre le fonctionnement du dispositif.

IT-313H Monitor Accessories

Ceiling Attachments



IT-313H Monitor



IT-313H Mounted to Ceiling



ITA-361 Monitor Metal Ceiling Attachment (9/16 inch)



ITA-362 Monitor Metal Ceiling Attachment (15/16 inch)



ITA-363 Monitor Metal Ceiling Attachment (5/16 inch)



ITA-353 Ceiling Tile Attachment (standard)



ITA-352 Monitor Mounting Plate (standard)

Power



ITA-356 D Cell Lithium Battery (2) (for illustration purposes only)



ITA-351 Monitor Power Adapter

Enclosure



ITA-377 Monitor Flush Mounting Plate (Monitor not included)



ITA-374-M Monitor Weather-Proof Protective Dome (Monitor not included)

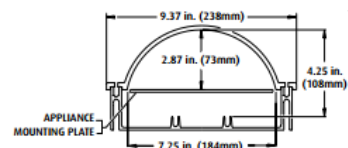

Construction:
UV Stabilized Polycarbonate

IC Statement per the requirements in RSS-Gen Section 8.4 and RSP-100 Section 4.

English:

This component complies with Industry Canada 's license-exempt RSSs. Operation is subject to the following two conditions:

(1) This device may not cause interference; and

(2) This device must accept any interference, including interference that may cause undesired operation of the device.

French:

Le présent appareil est conforme aux CNR d'Industrie Canada applicables aux appareils radio exempts de licence. L'exploitation est autorisée aux deux conditions suivantes : (1) l'appareil ne doit pas produire de brouillage, et (2) l'utilisateur de l'appareil doit accepter tout brouillage radioélectrique subi, même si le brouillage est susceptible d'en compromettre le fonctionnement.