

Karaoke USA

PORTABLE KARAOKE PLAYER

User's Guide



MODEL:
SD517

Smart Device
Not Included.



Before operating this product, please read these instructions.

Contents

Thank you for purchasing our product. For operation and security, read this manual carefully and keep it handy for future reference.

Contents.....	01
Features.....	01
Warnings and Precautions.....	02
Important Safety Instructions.....	03
100 Songs Included with Player Stored in Memory.....	04
What's in the Box.....	05
Location of Controls.....	06
Download Introduction.....	07
Operation.....	08-16
Play Bluetooth Music.....	13-14
Troubleshooting.....	17-18

Features

- 100 Songs (Internal Flash Memory)
- 3.5" Lyrics Display Screen
- SD Slot (SD Card not included)
- Vocal Cancel
- 2 Microphone Input Jacks (6.3mm) (1/4")
- Supports Bluetooth
- Audio Input Jack
- Removeable Cradle for Smart Devices
- AC/DC Power (3 "C" Batteries - Not included)
- Clock, Date, Time
- Auto Power Off (Programmable)

Warnings and Precautions

WARNING: To reduce the risk of fire or electric shock, do not expose this unit to rain or moisture.

CAUTION: Use of controls or adjustments or performance of procedures other than those specified may result in hazardous radiation exposure.

“**Caution Marking and Rating Label**” is affixed under the lid or on the bottom of the unit with a mass not exceeding 7kg.

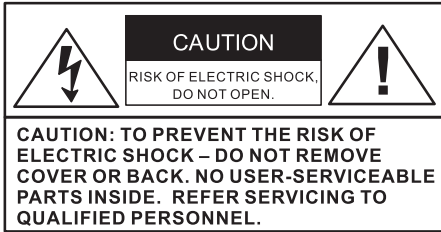

This symbol is intended to alert you to the presence of uninsulated, dangerous voltage within the unit's enclosure that might be of a sufficient magnitude to constitute a risk of electric shock. **DO NOT OPEN THE UNITS CASE.**



This symbol is intended to inform you that important operating and maintenance instructions are included in the literature accompanying this product.

SAFETY

For units with an insertable AC Power Adapter cordset:

- The power adapter should remain operable for its intended use. Disconnect the AC Power Adapter if you are not intending to use the unit for a long period of time.
- When connecting or disconnecting the AC Power Adapter Cord, grip the plug and not the cord itself. Pulling the cord may cause damage and create a hazard.

For units with a Rechargeable Battery:

- Do not expose batteries to excessive conditions – extreme cold, heat, sun or fire.

MOISTURE AND CONDENSATION

If the unit is exposed to moisture and extreme cold temperatures and moved to a warm environment, condensation may form on the units internal components. Under these circumstances, turning the power “ON” may cause damage to the unit or cause harm to the user. Allow the unit to stand in a warm environment for 1 to 3 hours and allow the unit to air dry safely.

WHEN IN USE

- Do not use this unit in conditions that are extreme – hot, cold, dusty or humid.
- Do not restrict the air flow of the unit by placing it on a soft surface like a bed, carpet or covering.

FCC IMPORTANT

This device complies with Part 15 of the FCC Rules. Operation is subject to the following two conditions: (1) this device may not cause harmful interference, and (2) this device must accept any interference received, including interference that may cause undesired operation.

NOTE: This equipment has been tested and found to comply with the limits for a Class B digital device, pursuant to Part 15 of the FCC Rules. These limits are designed to provide reasonable protection against harmful interference in a residential installation. This equipment generates, uses and can radiate radio frequency energy and, if not installed and used in accordance with the instructions, may cause harmful interference to radio communications. However, there is no guarantee that interference will not occur in a particular installation.

If this equipment does cause harmful interference to radio or television reception, which can be determined by turning the equipment off and on, the user is encouraged to try to correct the interference by one or more of the following measures:

- Reorient or relocate the receiving antenna.
- Increase the separation between the equipment and receiver.
- Connect the equipment into an outlet on a circuit different from that to which the receiver is connected.
- Consult the dealer or an experienced radio/TV technician for help.

CAUTION: Changes or modifications not expressly approved by the party responsible for compliance could void the user's authority to operate the equipment.

The distance between user and products should be no less than 20cm



Double insulation.
This is a Class II apparatus.

Important Safety Instructions

1. Read These Instructions: All safety and operations manual should be read before the product is operated.

2. Keep These Instructions: The safety and operations manual should be retained for future reference.

3. Heed All Warnings: All warnings applicable to the unit and in the operations manual should be adhered to.

4. Follow All Instructions: All operations manual should be followed.

5. Water and Moisture: Do not use this unit near water. For example, do not use near a bath tub, wash bowl, kitchen sink, or laundry tub. Do not use this unit in a wet basement or near a swimming pool or similar location. The unit shall not be exposed to dripping or splashing and no objects filled with liquids (ex: vases), shall be placed on or near this unit.

6. Cleaning: Clean the unit only with a dry cloth. Unit must be unplugged from the wall outlet before cleaning. Do not use liquid cleaners or aerosol cleaners on the unit.

7. Ventilation: Slots and openings in the cabinet of the unit are provided to ensure reliable operation and ventilation and to protect the unit from overheating. The openings must not be covered and should never be blocked by placing the product on a soft surface like a bed, sofa, or rug. This unit should not be placed in a built-in installation like a bookcase or rack, unless proper ventilation is provided.

8. Heat: Do not install the unit near any heat source like a radiator, heat register, stove or other device that produces heat, including amplifiers.

9. Grounding or Polarization: If applicable, do not disable or circumvent the polarized or grounding-type plug. A polarized plug has 2 blades with 1 wider than the other. A grounding-type plug has 2 blades and a 3rd grounding plug. The wide blade, or the 3rd prong, is provided for your safety. If the provided plug does not fit into an outlet, consult a qualified electrician for replacement of this outlet.

10. Power Cord Protection: Protect the power cord from being walked on, pinched or cut or damaged in any

way. If any damage occurs, consult with a trained technician for repair.

11. Accessories: Only use accessories specified and approved by the manufacturer. Do not place this unit on an unstable cart, stand, tripod, bracket or table that has not been previously approved by the manufacturer. This unit may fall, causing serious injury to a child, adult or to the unit itself. Any mounting of the unit should be done within the manufacturer's guidelines.

12. Transporting: If a pre-approved device is used to transport this unit, caution and care must be observed and practiced to avoid damages. Make sure the device and unit together are stable before moving.



PORTABLE
CART
WARNING

13. Lightning: Unplug this unit and disconnect the antenna or cable system during lightning storms or when unused for long periods of time. This will help prevent damage to the unit due to lightning and power line surges.

14. Servicing: Do not attempt to service this unit yourself. Opening or removing covers may expose you to dangerous voltage or other hazards. Refer all servicing to a qualified service technician.

15. Power Sources: Only connect to the type of household power supply as indicated in the operations manual and "Caution Marking and Rating Label." If you are not sure of the type of power supplied to your home (or location of the outlet the unit is being plugged into), consult with the local power company. For units intended to operate from battery power, or other sources, refer to the manufacturer's operations manual.

16. Overloading: Do not overload wall outlets or extension cords. This can result in a risk of fire or electric shock and may be hazardous.

17. Foreign Material: Protect this unit from intrusion of any foreign substances like dirt, water, moisture and insects. Do not force any foreign materials or chemicals into this unit. This could result in a risk of fire or electric shock and may be hazardous.

18. Replacement Parts and Safety Check: When replacement parts are required, be sure the service technician has used replacement parts specified and approved by the manufacturer. Ask the service technician to perform safety checks to ensure the proper operation to avoid possible fire, electric shock or other hazards.

19. Outdoor Antenna Grounding: If an outside antenna or cable system is connected to the unit, be sure the antenna or cable system is grounded to provide some protection against voltage surges and built-up static charges. If there is any doubt to the proper grounding of these systems, contact a qualified electrician to inspect your location.

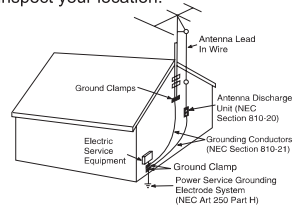

20. Wall or Ceiling Mounted: The unit should be mounted to a wall or a ceiling only as recommended by the manufacturer.

21. Disconnect Device: Make sure all disconnect devices are in proper working condition and readily available in the event of an emergency or if power "off" is needed quickly.

22. Protective Attachment Plug: If applicable, this unit may be equipped with an attachment plug having overload protection. This is a safety feature. See the operations manual for replacement or resetting of this protective device. If replacement of the plug is required, be sure the qualified service technician has used a replacement plug specified by the manufacturer that has the same overload protection as the original plug.

23. Power Lines: An outside antenna system should not be located in the vicinity of overhead power lines or other electric light or power circuits, or where it can fall into such power lines or circuits. When installing an outside antenna system, extreme care should be taken to keep from touching such power lines or circuits, as contact with them may be fatal. Always consult with your local power company before installing an outside antenna.

100 Songs Included with Player Stored in Memory

Download your Favorite MP3.LRC SONGS from **SingtheHits.com**
and load them into your SD517 Karaoke Player All Songs include on Screen Lyric.

1. Alexanders Ragtime Band
2. Amazing Grace
3. America (My Country Tis Of Thee)
4. Angels From The Realms Of Glory
5. Angels We Have Heard On High
6. Auld Lang Syne
7. Away In A Manger
8. Battle Hymn Of The Republic
9. Bill Bailey Wont You Come Home
10. Blessed Assurance
11. Camptown Races
12. Church in The Wildwood
13. Clementine
14. Come O Come Emanuel
15. Crawdad Song
16. Daddy Sang Bass
17. Deck The Halls
18. Down By The Riverside
19. Dry Bones
20. First Noel The
21. For Hes A Jolly Good Fellow
22. For Me And My Gal
23. Frankie And Johnny
24. Frosty The Snowman
25. Girls And Boys Come Out To Play
26. Git Along Little Dogies
27. Give My Regards To Broadway
28. Go Tell It On The Mountain
29. Greensleeves
30. Ground Hog
31. Hail Hail The Gangs All Here
32. Hark! The Herald Angels Sing
33. Harrigan
34. Hes Got The Whole World In His Hand
35. Home On The Range
36. How Great Thou Art
37. Hunting We Will Go A
38. I Love You Truly
39. Ill Be Home For Christmas
40. In The Good Old Summertime
41. It Came Upon A Midnight Clear
42. Its Raining Its Pouring
43. I've Been Working On The Railroad
44. Jeanie With The Light Brown Hair
45. Jimmy Crack Corn
46. Jingle Bells (Childrens)
47. Joy To The World
48. La Bamba
49. Let Me Call You Sweetheart
50. Little Jack Horner
51. London Bridge Falling Down
52. MacNamaras Band
53. Michael Row The Boat Ashore
54. Midnight Special The
55. My Bonnie Lies Over The Ocean
56. My Old Kentucky Home
57. My Wild Irish Rose
58. O Holy Night
59. Oh Christmas Tree
60. Oh Come All Ye Faithful
61. Oh Susanna
62. Oh When The Saints Go Marching In
63. Oh You Beautiful Doll
64. Ol Woman Who Lived In A Shoe
65. Old MacDonald Had A Farm
66. Old Time Religion
67. On Top Of Old Smokey
68. Onward Christian Soldiers
69. Peace In The Valley
70. Precious Memories
71. Rock Island Line
72. Rock Of Ages
73. Rock-A-My Soul
74. Rockin Robin
75. Row Row Row Your Boat
76. Shell Be Coming Around The Mountain
77. Shoo Fly Dont Bother Me
78. Sixteen Tons
79. Skip To My Lou
80. Sloop John B
81. Swanee River
82. Sweet By And By
83. Swing Low Sweet Chariot
84. Take Me Out To The Ball Game
85. The House Of The Rising Sun
86. The Lords Prayer
87. The Old Gray Mare
88. This Little Light Of Mine
89. This Old Man
90. Tisket A Tasket A
91. Turkey In The Straw
92. Wabash Cannonball The
93. Waltzing Matilda
94. We Wish You A Merry Christmas
95. Wedding Song (There Is Love)
96. Whispering Hope
97. Who Threw The Overalls In Mrs Murphys Chowder
98. Will The Circle Be Unbroken
99. Yankee Doodle
100. Yellow Rose Of Texas

What's in the Box

SD517 KARAOKE SYSTEM



Microphone



100 Songs Stored in
Memory (SD Card
not included)



Device Cradle



AC/DC Adaptor



3.5mm Headphone
Jack AUX-IN Cable
Connector



User's Manual



Warranty Card

Location of Controls

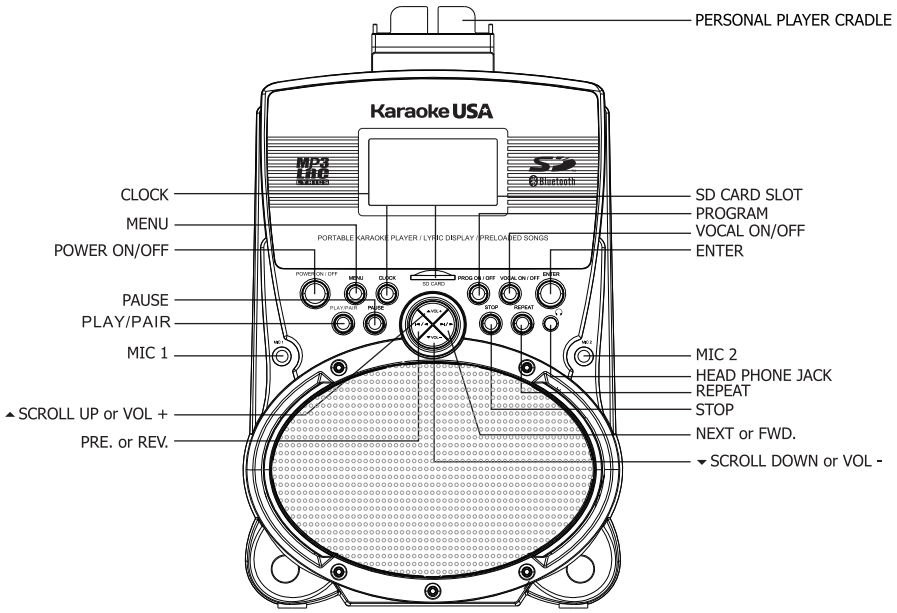

FUNCTION:

Power On/Off

- Press ON/OFF key once to set On or Off;
- When the unit is turned on, it will display the main song list;

MENU - Press MENU button once to enter the selection screen, using Up and Down buttons. Press ENTER to select a desire function;

CLOCK - Press this button will display the clock

Prog. On/Off - Press PROGRAM ON/OFF button to start the program. Select your favorite song and Press Enter (song bookmark). The song you selected will be blinking on the screen. Press Enter again to remove it from bookmark list. After mark all songs, press PLAY those selected songs.

VOL+ and VOL- Press VOLUME + or VOL - to adjust the volume level

ENTER - To Confirm your selection or play

PLAY/PAIR - Press the PLAY starts to play the music. In Bluetooth mode, press and hold this button to disconnect any paired devices in order to pair another device.

PAUSE - Temporarily suspends player. Lyric motion freezes and audio reproduction stops

STOP - Press STOP button to stop playing and go to the song list

REPEAT - Press REPEAT button one time to re-play the current song while playing. Press repeat twice to repeat all songs on HD or SD card, press three times to eliminate the repeat function. (Double Function Button)

VOCAL ON/OFF - Press this button when playing songs to turn on or off the lead vocal from the music. This allows singer to learn the song and practice with vocal until they can remember lyric timing.

Download Introduction

WORKING WITH MP3 AND LRC FILES

MP3 files may be intimidating to some. They are nothing more than computer files that can be moved, copied, stored and deleted. When made available for an MP3 player to access, great sound is the result. MP3 files are the most common format of downloadable music on the internet.

Your player comes with 100 songs preloaded. See page 4 for song listing. Additional songs are available for downloading on the internet. Using your computer and your SD Card, songs can be downloaded, copied onto your SD Card (up to 16GB), then insert SD Card into player. Songs will show on the player menu for selection.

NOTE: To see song lyrics, you must download and use an LRC (lyrics) file that has been cued to the MP3 song file. An LRC file is not required to play MP3 songs.

Songs are available for downloading on SingTheHits.com. Click on free downloads and download MP3LRC formatted songs. These downloads are in a compressed ZIP file for convenience. They must be decompressed before copying to your SD Card. In the end, each song will have 2 files: MP3 and LRC.

WORKING WITH MP3 AND LRC (LYRIC) FILES

Your player will play MP3 files with an added benefit. If a matching LRC file is provided, you can view the lyrics to your MP3 song on the player's lyric display. However, LRC files are not necessary to listen to great music or to sing along as karaoke. An LRC file is nothing more than a text file with timing marks inserted before each line of lyrics. The timing marks tell the player when to insert the line of lyrics into the display as the song is played.

MP3 and matching LRC files may be found searching the internet. Whether you decide to download, share or create your own lyrics file, you must follow one simple rule. The MP3 and LRC filenames must be exactly the same except for the extensions *.MP3 and *.LRC. If they are exactly the same, the player will know to access both automatically. You don't have to do anything extra like tell the player you have a lyrics file. It automatically searches each time an MP3 is played.

MUSIC COPYRIGHTS

Songs, music and lyrics are created by real people like musicians and song-writers. Their work is considered intellectual property. Even though MP3 files are easily accessible and shared often, you are still responsible to abide by copyright laws. We neither advertise or promote violation(s) of copyright laws.

Operation

Note

This unit designed to play MP3 music with LRC File (Lyrics) or MP3 music.

The LCD can play the lyrics on screen.

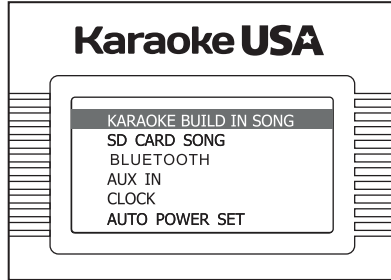

Power On/Off

Press ON/OFF key once to on or off.

* When the unit is turned on, it will display the song list.



- * Press ENTER to directly play the current selected song (default setting is 1st song)
- * Press UP or DOWN to scroll through the list
- * Then Press ENTER to play the song you have chosen.
Built in songs or SD Card song will have same operation, just go Direct from menu to SD Card song.

Operation

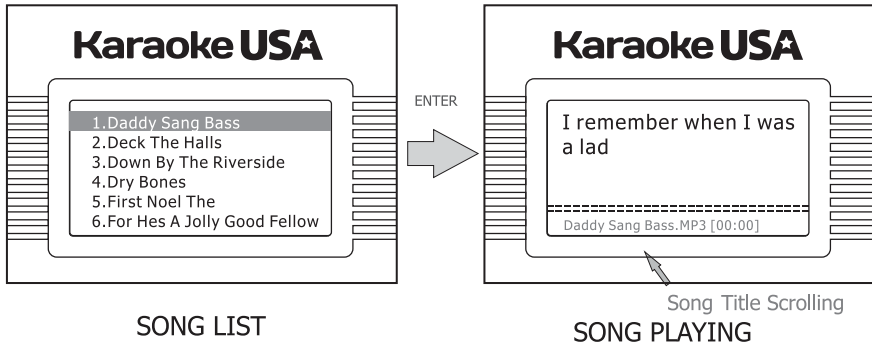

- * Lyric will be displayed on screen and scroll upward.
- * Song title or the Timer are displayed at the bottom line.
- * Press ► or ◀ to directly play next or previous songs.
- * User can sing with the microphone and their voice will be mixed with the music coming out from the speaker.

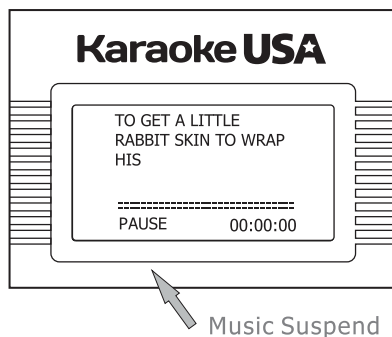

- * Press PAUSE to suspend the music and press PLAY to resume (status on LCD)

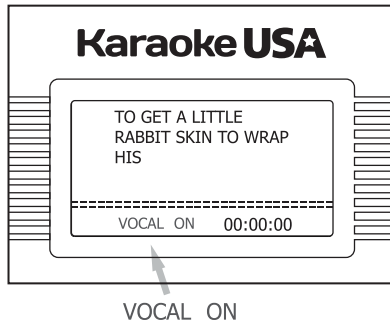

- * Press VOCAL ON/OFF to remove the vocal output of the song.
- * Press VOCAL ON/OFF again to resume vocal output(status on LCD)

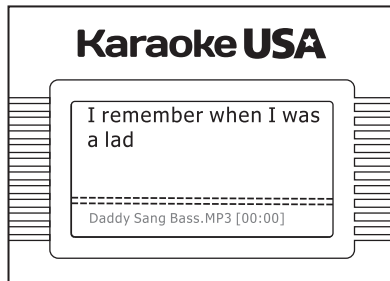

Song Title and timing Scrolling

- * Lyrics will display on screen and scroll up as the song plays.

Operation

Program

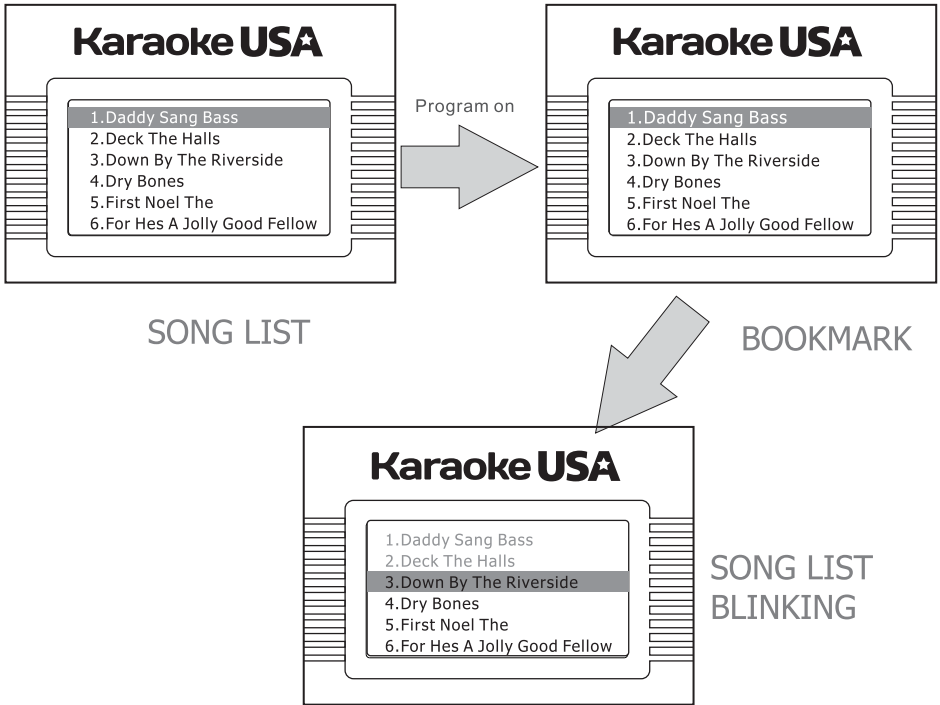

PROGRAM On/Off - – Press PROGRAM ON/OFF button to start the program in the song list. Select your favor song and Press ENTER (song bookmarked). The song you selected will be blinked on the screen. Press ▲ and ▼ to scroll through the song list and press ENTER to mark next song, Press ENTER again to remove it from bookmark list. After marking all songs, press PLAY to play those selected songs;

Operation

Play SD Card

Before you do this, make sure there are some MP3 format musics stored in your SD card.



*Insert your SD card to the SD card slot, then press MENU, press ▼ to select the SD CARD SONG, press ENTER again to go to the songs that stored in your SD card.

This machine supports up to a "maximum limit" of 999 Songs loaded from your SD Card.

Play Bluetooth Music

1. Pairing your Smart Phone using Bluetooth :
 - A. Power the machine ON and then Press MENU.
 - B. Press ▼VOL- to the BLUETOOTH mode and ENTER to select.



- When in Bluetooth mode, the screen flash : "BT".
2. Setting your Smart Device to "explore" the unit.
 - A. Activate your Bluetooth function on your smart device.
 - B. Click "Setting" and select "Bluetooth"
 3. Using your Smart Device to connect to the Machine
 - A. Your Smart Device will Discover:SD517.
 - B. Select SD517.
 - C. To accept the pairing to your smart Device .
 - D. If they are paired, the screen will shows constant: "BT" and you will hear a "beep" sound.
 - E. If they are not paired, the screen will show flash "BT".
 - F. Please repeat "Steps 1,2 & 3"above until they are paired.
 4. Play Audio via Bluetooth After Pairing:
 - A. Select the song files that you wish to play from your Smart Device.
 - B. Then play your Smart Device to start sending to the Machine by Bluetooth connection.
 - C. Always remember to use full volume to send your song files from your smart device.
 - D. Adjust the Master Volume on the Machine to a comfortable level when necessary.
 - E. Music will be put "on Hold" automatically when your Smart Device receives a phone call to let you answer. The music will resume when you end the call.
 5. Bluetooth transmits audio only. You will not see lyrics when using Bluetooth for a music source.

Play Bluetooth Music

Using a Bluetooth Device (Continued)

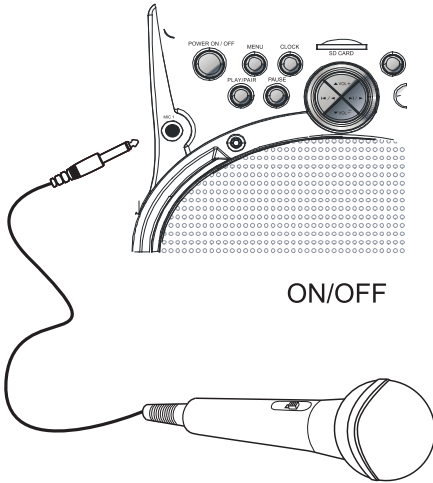

- * To control your Bluetooth device from this unit, press the **PLAY** button to start playback. Press the **PAUSE** button during playback to pause the song.
- * Adjust the volume to a comfortable level using the **VOL+** or **VOL-** control on this unit as well as the volume on your Bluetooth device.
- * **SKIP:** Advance or go back one track by pressing the **SKIP** ◀ / ▶ / **SKIP** ▶ / ▶ buttons.
- * Press the power **ON/OFF** button to turn the unit off.

Operation

AUX IN

* Plug your iPod or your portable player through the cable to the **MP3/iPOD/AUX IN** port on the back of the unit.
(cable provided in the package)

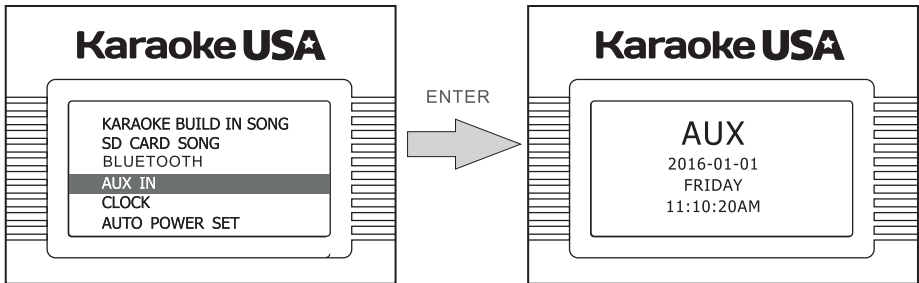

- * Press **MENU**, then press ▼ to select the **AUX IN**, press **ENTER** again to listen your external player's music.
- * Audio from your iPod or MP3/Mp4 player will be mixed with the singer's voice and be played through the player's speaker.
- * Adjust volume up or down

Operation

Time Set

- *Press MENU once to enter mode selection screen.
- *Press ▼ / VOL- to the CLOCK and ENTER to select.

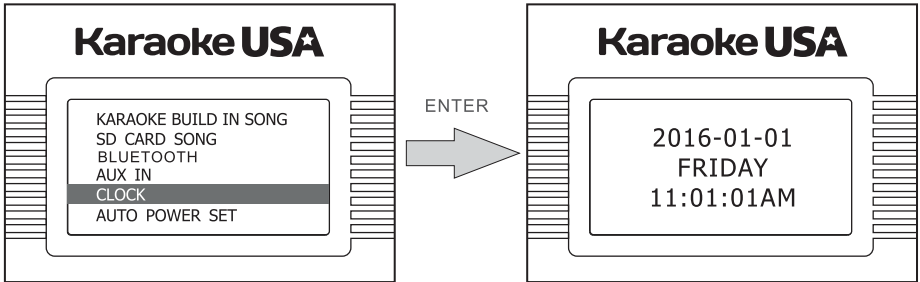

- *Press ENTER again to star time setting.



- *Press ▲ or ▼ to change the blinking digit.
- *Press ◀ or ▶ and continue with next digit.
- *The sequence is Year > Month > Day> Hour > Minute.
- *After setting all digits, Press ENTER then display return to normal clock display.

Operation

AUTO POWER SET

*Press MENU once to enter mode selection screen.

*Press ▼ VOL- or ▲ VOL+ to the AUTO POWER SET and ENTER to select.

*Press ▲ or ▼ to change auto power off time.

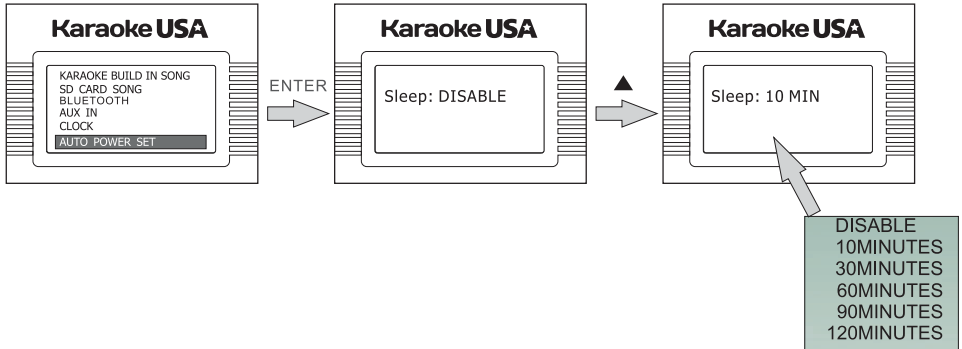

*Auto power times are available for 10 minutes, 30 minutes, 60 minutes, 90 minutes, 120 minutes.

*Press ENTER to confirm.

Connect MP3/MP4/iPod®

Connect AUX Input/iCable to Smart Device

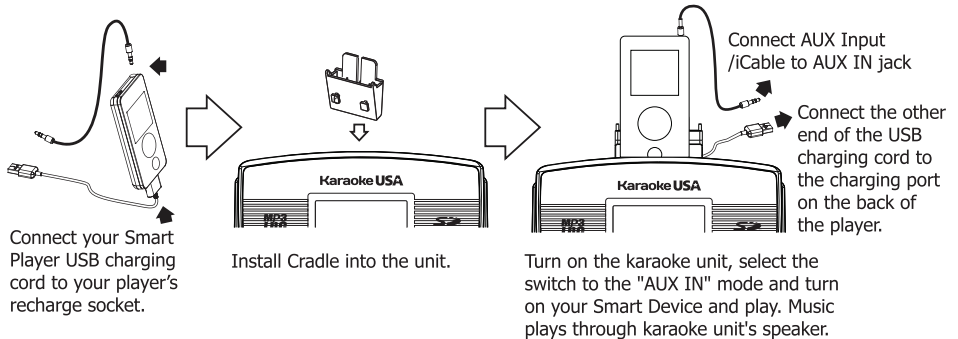

Troubleshooting

Symptom	Possible Solutions
Can't turn on.	Check Battery polarities being installed correctly
	Check if AC Adaptor is functioning.
Can't play Music.	Check if the Power is turned ON.
	Are the Music files in MP3 format?
	Check if the Music files are intact.
Music file is played but no sound output.	Adjust the Volume Control up to desire level for listening.
	Check if the music files are intact.
No sound output after iPod is hooked up	Check if the Connecting cable between iPod and Unit is damaged. Check if iPod and Unit is connected correctly. (Please refer to the Manual for proper connection) Set the unit at the proper mode.
Can't Play Music files in SD card.	Check if the SD card is inserted correctly sticker upwards. Make sure the music on your SD card is.mp3 format.
If your Unit doesn't respond or displays strange characters and symbols, you are recommended to RESET the Machine at the back with a Pin. (Note: The Time and Program setting will be lost!)	
No sound when playing audio via Bluetooth.	Your Bluetooth device has been paired property. Pairing your Bluetooth device; see page 13 or refer to the Bluetooth device user's manual.
	The volume control of your Bluetooth device is set at too low. Increase the volume of your Bluetooth device.
	The volume control of main unit is set at too low; Increase the volume of main unit to adjust to "+" level.

Troubleshooting

SD CARD

* Use the SD Card which meets SD standards. If not, it may cause the Karaoke to malfunction.

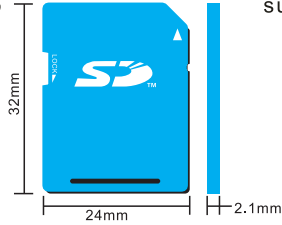

* Gently insert the SD Card label surface facing front.

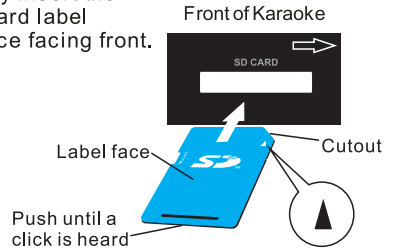

* Compliant card type: SDHC Card, SD Card, miniSD Card, miniSDHC Card, microSD Card, microSDHC Card (requiring miniSD Card/miniSDHC Card/microSD Card/microSDHC Card adapter)

* If a miniSD Card, miniSDHC Card, microSD Card or microSDHC Card is used, insert/remove it together with the adapter.

Should you still have problem operating this machine, please call us for assistance in
USA: 800-568-2000 or USA & International:(727) 209-1313

KARAOKE USA

1185 Gooden Crossing, Largo,

Florida, 33778, USA

www.KaraokeUSA.com

1-800-568-2000 ■ 727-209-1313