

Karaoke USA

CD+G KARAOKE

COMPACT
disc
DIGITAL AUDIO
(GRAPHICS)

COMPACT
disc
DIGITAL AUDIO

User's Guide

MODEL:
GQ743



Smart Device
Not Included.

Before operating this product, please read these instructions.

Contents

Warnings and Precautions	02
Important Safety Instructions	03
What's in the Box.	04
Features.	04
Introduction	05
Location Controls	06
Monitor Message	06
Setup Cradle	07
-Install Cradle into the Unit	
-Place External Device	
Setup Power.	08
Connect Ext. Device & Sound From Main Unit Speaker.	08
-AUX IN (LINE In / AUDIO In)	
Using CD+G , CDs	09
-Loading a CD	
-Playing a CD	
-Repeat Function	
-Programming a Disc up to 20 tracks	
Connect Ext. Bluetooth to Your Smartphone / Tablet.	10
Connecting to a Television / DVD / Ext. Device	10
-Composite Video Output	
-RCA Audio Output	
Using Microphones	11
Using ECHO / BALANCE	11
-ECHO	
-BALANCE	
Connect the Headphone or Earphone	12
Specification	12
Troubleshooting.	13

Warnings and Precautions

WARNING: To reduce the risk of fire or electric shock, do not expose this unit to rain or moisture.

CAUTION: Use of controls or adjustments or performance of procedures other than those specified may result in hazardous radiation exposure.

“**Caution Marking and Rating Label**” is affixed under the lid or on the bottom of the unit with a mass not exceeding 7kg.

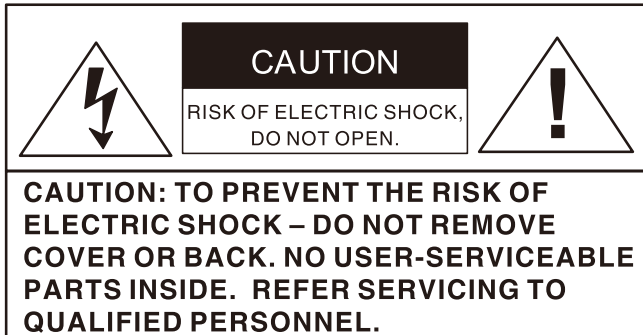

This symbol is intended to alert you to the presence of uninsulated, dangerous voltage within the unit's enclosure that might be of a sufficient magnitude to constitute a risk of electric shock. **DO NOT OPEN THE UNITS CASE.**



This symbol is intended to inform you that important operating and maintenance instructions are included in the literature accompanying this product.

SAFETY

For units with an insertable AC Power Adapter cord set:

- The power adapter should remain operable for its intended use. Disconnect the AC Power Adapter if you are not intending to use the unit for a long period of time.
- When connecting or disconnecting the AC Power Adapter Cord, grip the plug and not the cord itself. Pulling the cord may cause damage and create a hazard.

For units with a Rechargeable Battery:

- Do not expose batteries to excessive conditions – extreme cold, heat, sun or fire.

MOISTURE AND CONDENSATION

If the unit is exposed to moisture and extreme cold temperatures and moved to a warm environment, condensation may form on the units internal components. Under these circumstances, turning the power “ON” may cause damage to the unit or cause harm to the user. Allow the unit to stand in a warm environment for 1 to 3 hours and allow the unit to air dry safely.

WHEN IN USE

- Do not use this unit in conditions that are extreme – hot, cold, dusty or humid.
- Do not restrict the air flow of the unit by placing it on a soft surface like a bed, carpet or covering.

FCC INFORMATION

This unit complies with part 15 of the “FCC Rules.” Operation is subject to the following conditions:

1. This unit may not cause harmful interference.
2. This unit must accept any interference received, including interference that may cause undesirable operation.



Double insulation.
This is a Class II apparatus.

Changes or modifications not expressly approved by the party responsible for compliance could void the user's authority to operate the equipment.

This equipment has been tested and found to comply with the limits for a Class B digital device, pursuant to Part 15 of the FCC Rules. These limits are designed to provide reasonable protection against harmful interference in a residential installation. This equipment generates, uses and can radiate radio frequency energy and, if not installed and used in accordance with the instructions, may cause harmful interference to radio communications. However, there is no guarantee that interference will not occur in a particular installation.

If this equipment does cause harmful interference to radio or television reception, which can be determined by turning the equipment off and on, the user is encouraged to try to correct the interference by one or more of the following measures:

- Reorient or relocate the receiving antenna.
- Increase the separation between the equipment and receiver.
- Connect the equipment into an outlet on a circuit different from that to which the receiver is connected.
- Consult the dealer or an experienced radio/TV technician for help.

Important Safety Instructions

1. Read These Instructions: All safety and operations manual should be read before the product is operated.

2. Keep These Instructions: The safety and operations manual should be retained for future reference.

3. Heed All Warnings: All warnings applicable to the unit and in the operations manual should be adhered to.

4. Follow All Instructions: All operations manual should be followed.

5. Water and Moisture: Do not use this unit near water. For example, do not use near a bath tub, wash bowl, kitchen sink, or laundry tub. Do not use this unit in a wet basement or near a swimming pool or similar location. The unit shall not be exposed to dripping or splashing and no objects filled with liquids (ex: vases), shall be placed on or near this unit.

6. Cleaning: Clean the unit only with a dry cloth. Unit must be unplugged from the wall outlet before cleaning. Do not use liquid cleaners or aerosol cleaners on the unit.

7. Ventilation: Slots and openings in the cabinet of the unit are provided to ensure reliable operation and ventilation and to protect the unit from overheating. The openings must not be covered and should never be blocked by placing the product on a soft surface like a bed, sofa, or rug. This unit should not be placed in a built-in installation like a bookcase or rack, unless proper ventilation is provided.

8. Heat: Do not install the unit near any heat source like a radiator, heat register, stove or other device that produces heat, including amplifiers.

9. Grounding or Polarization: If applicable, do not disable or circumvent the polarized or grounding-type plug. A polarized plug has 2 blades with 1 wider than the other. A grounding-type plug has 2 blades and a 3rd grounding plug. The wide blade, or the 3rd prong, is provided for your safety. If the provided plug does not fit into an outlet, consult a qualified electrician for replacement of this outlet.

10. Power Cord Protection: Protect the power cord from being walked on, pinched or cut or damaged in any

way. If any damage occurs, consult with a trained technician for repair.

11. Accessories: Only use accessories specified and approved by the manufacturer. Do not place this unit on an unstable cart, stand, tripod, bracket or table that has not been previously approved by the manufacturer. This unit may fall, causing serious injury to a child, adult or to the unit itself. Any mounting of the unit should be done within the manufacturer's guidelines.

12. Transporting: If a pre-approved device is used to transport this unit, caution and care must be observed and practiced to avoid damages. Make sure the device and unit together are stable before moving.



PORTABLE
CART
WARNING

13. Lightning: Unplug this unit and disconnect the antenna or cable system during lightning storms or when unused for long periods of time. This will help prevent damage to the unit due to lightning and power line surges.

14. Servicing: Do not attempt to service this unit yourself. Opening or removing covers may expose you to dangerous voltage or other hazards. Refer all servicing to a qualified service technician.

15. Power Sources: Only connect to the type of household power supply as indicated in the operations manual and "Caution Marking and Rating Label." If you are not sure of the type of power supplied to your home (or location of the outlet the unit is being plugged into), consult with the local power company. For units intended to operate from battery power, or other sources, refer to the manufacturer's operations manual.

16. Overloading: Do not overload wall outlets or extension cords. This can result in a risk of fire or electric shock and may be hazardous.

17. Foreign Material: Protect this unit from intrusion of any foreign substances like dirt, water, moisture and insects. Do not force any foreign materials or chemicals into this unit. This could result in a risk of fire or electric shock and may be hazardous.

18. Replacement Parts and Safety Check: When replacement parts are required, be sure the service technician has used replacement parts specified and approved by the manufacturer. Ask the service technician to perform safety checks to ensure the proper operation to avoid possible fire, electric shock or other hazards.

19. Outdoor Antenna Grounding: If an outside antenna or cable system is connected to the unit, be sure the antenna or cable system is grounded to provide some protection against voltage surges and built-up static charges. If there is any doubt to the proper grounding of these systems, contact a qualified electrician to inspect your location.

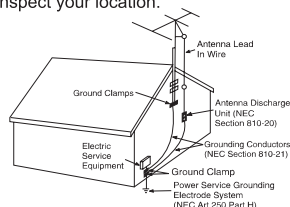

20. Wall or Ceiling Mounted: The unit should be mounted to a wall or a ceiling only as recommended by the manufacturer.

21. Disconnect Device: Make sure all disconnect devices are in proper working condition and readily available in the event of an emergency or if power "off" is needed quickly.

22. Protective Attachment Plug: If applicable, this unit may be equipped with an attachment plug having overload protection. This is a safety feature. See the operations manual for replacement or resetting of this protective device. If replacement of the plug is required, be sure the qualified service technician has used a replacement plug specified by the manufacturer that has the same overload protection as the original plug.

23. Power Lines: An outside antenna system should not be located in the vicinity of overhead power lines or other electric light or power circuits, or where it can fall into such power lines or circuits. When installing an outside antenna system, extreme care should be taken to keep from touching such power lines or circuits, as contact with them may be fatal. Always consult with your local power company before installing an outside antenna.

What's in the Box

GQ743- CD+G Karaoke System

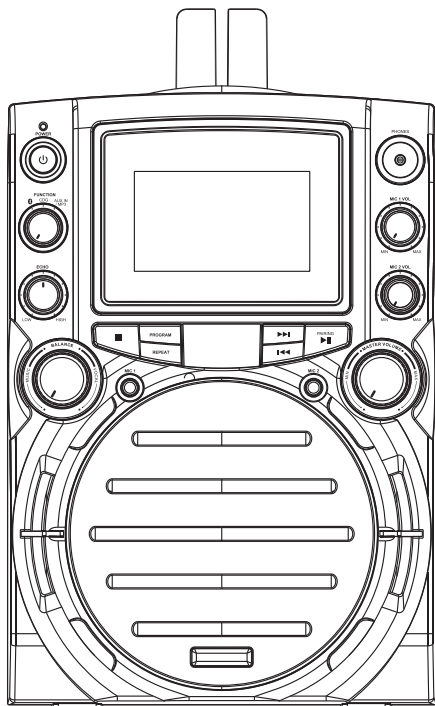

AUX IN Cable



RCA Cable



CD+G Disc

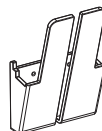

Universal Cradle



Cradle Insert



Microphone



AC/DC Adaptor



Instruction Manual
& Warranty Card

Features

- CD Player: Support CD+G, CD, CD-R/RW
- Mic Volume controls
- Echo Control
- Balance Control
- TFT Display
- 3.5mm Earphone Jack
- 2 x 6.3mm Microphone Inputs
- Audio/Video RCA Output (RCA Cable included)
- Audio 3.5 mm Jack Input (AUX IN Cable included)
- Built-in Loud Speaker
- Power: Requires AC Adapter (included) DC 12V 1.5A

Introduction

Front Control

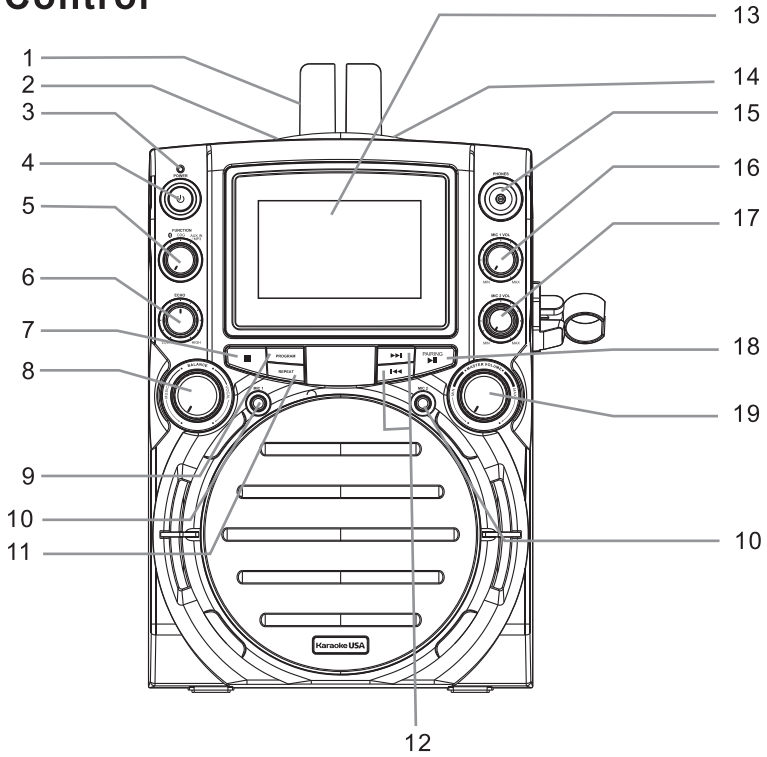

Rear Control

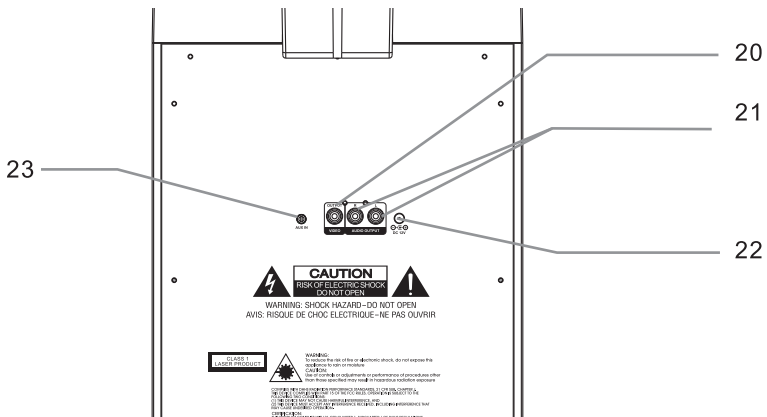

Location Controls

1. DETACHABLE CRADLE: Place your mobile / tablet on the cradle.
2. CD Door: Open the door to install disc
3. POWER Indicator: Will be light when unit turn on.
4. POWER Button: Press this button to turn on / off unit.
5. FUNCTION: Rotate to select  (Bluetooth) mode / CDG (DISC) mode / AUX IN/MP3 mode.
6. ECHO Dial: Rotate to adjust echo sound effect.
7. STOP Button: Press to stop a disc playing
8. BALANCE Dial: Rotate the dial to select vocals or music only or a standard balance function.
9. PROGRAM Button: Press to program a loaded disc to play tracks in specified order.
10. MIC Inputs: Mic 1 and Mic 2 input jack
11. REPEAT Button: Press repeatedly to set the current track or entire disc to repeat.
12. SKIP/SEARCH: Press to skip between tracks on loader disc. Press and hold to fast-forward or fast-rewind the current track on a loader disc.
13. TFT DISPLAY: Show disc tracks number & CDG graphic.
14. CD Door Open Area: Use the location area to open the CD door.
15. PHONES Jack: Connect to external headphone or earphone.
16. MIC 1 VOLUME Dial: Rotate to adjust the volume from the MIC 1 input.
17. MIC 2 VOLUME Dial: Rotate to adjust the volume from the MIC 2 input.
18. PLAY / PAUSE Button: Press to play or pause a loader disc.
19. MASTER VOLUME Dial: Rotate to adjust the main volume sound level.
20. VIDEO OUT Jack: Connect to TV video input.
21. AUDIO OUT (Line out / Aux out) Jack: Connect to external device audio input.
22. DC INPUT Jack: Connect power adapter for AC power.
23. AUX IN (Line in / Audio in): Connect to external device audio input.

Monitor Message

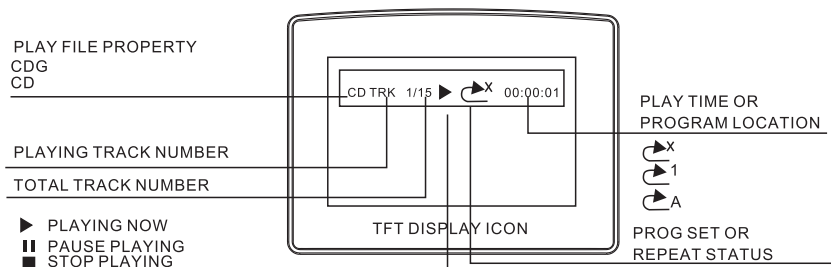

Setup Cradle

Install Cradle into the unit

Install the cradle (included) to hold the Mobile & Tablet onto unit.

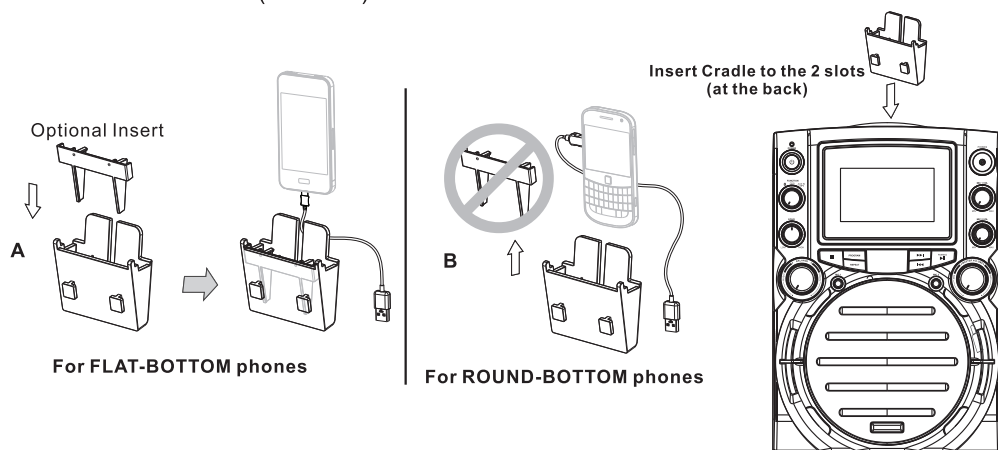

Place External Device

Insert Personal Player / Mobile Phone / Tablet with cradle onto the unit.

