

# Quick Start: Operations

---

Playing a CD, CD+G or Multiplex Karaoke disc

1. Connect the AC adaptor to rear of unit or insert 8 "C" batteries in the bottom of the unit.
2. Optional: To see lyrics on your TV screen, connect the yellow video output on the player to a yellow video input on your TV.
3. Optional: To have more audio power, connect the red and white audio outputs on your player to red and white audio inputs on your TV or stereo. (See connection on page 10)
4. Turn on the unit by **POWER ON/OFF**.
5. Open CD door.
6. Load the disc into the unit's CD-Drive located on the top of the unit. Close the CD door and Press the **SOURCE** button to CD mode.
7. Press **▶||** button to start the loaded disc. Press the **▶||** button again to pause the music. Press the **■** button to stop the disc. Press **◀◀** or **▶▶** to get the previous or next tracks.
8. Rotate the **MASTER VOLUME** to adjust the volume of the music. Rotate the **MIC VOLUME** to adjust the microphone volume.
9. Rotate the **BALANCE** knob to adjust the music & vocal in different percentages, or for Multiplex Karaoke.
10. Rotate the **ECHO** knob to get echo depth while singing.
11. Press the **REPEAT** button once to repeat the current playing song (the repeat indicator blinks); Press **REPEAT** twice to repeat all tracks on the disc (the repeat indicator lights up constant). Press **REPEAT** again to cancel the repeat function (the indicator light will be off).

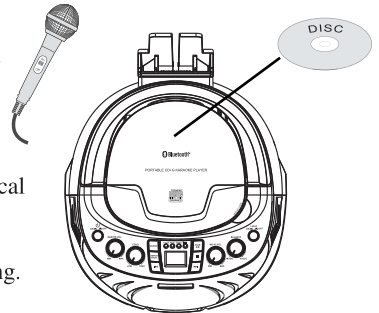

Works with MP3, MP4 and Smart Devices

## Quick Start: TV Connection (AV Out for CD+G and Multiplex Karaoke Disc Only)

The CD+G lyrics can be displayed on a connected television.

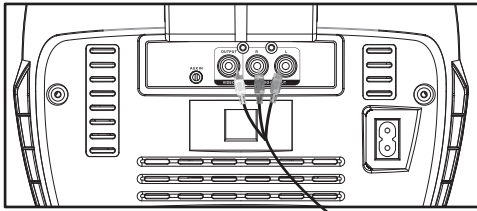

Note: Video not available when using Smart Device or MP3/MP4 player

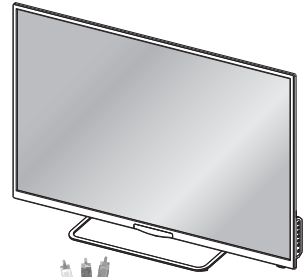

Connect to TV or TV and Stereo

1. Plug one set of the RCA cables (included) into the OUTPUT on the back of the karaoke unit;
2. Plug the other set of the RCA cables into the INPUT on the television;
3. Set the television to the appropriate video mode (Video 1, Video 2 etc.);
4. Power on the karaoke unit, insert a CD+G or Multiplex Karaoke disc and press the PLAY button;
5. Video plays on the television.

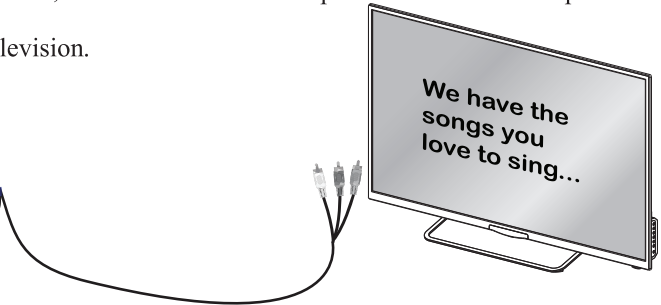
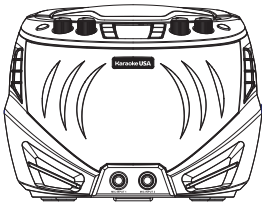

## Quick Start: Cradle for MP3/MP4/Smart Device



Use the insert for flat bottom phones.



Round bottom phones do not need the insert.

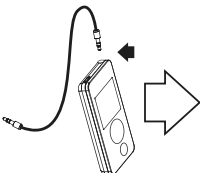

Connect AUX Input/  
iCable to Smart Device

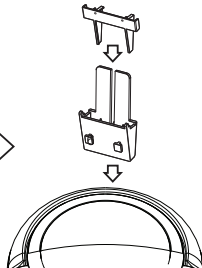

Install Cradle into the unit.  
Your Smart Device's shape will determine if an insert is needed.

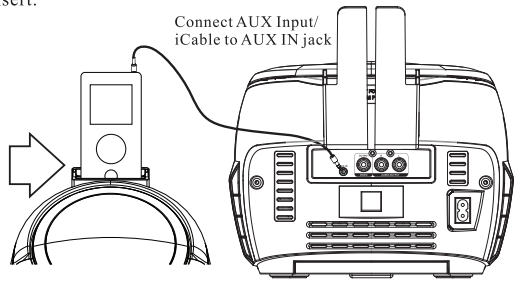

Connect AUX Input/  
iCable to AUX IN jack

Turn on the karaoke unit, Press the SOURCE to the "AUX IN" mode and turn on your Smart Device and play. Music plays through karaoke unit's speaker.

# Karaoke Glossary of Terms

---

In addition to all of the terminology associated with consumer electronics products, a few additional terms are used almost exclusively in karaoke. These terms are meant to familiarize you with the world of karaoke. The features listed below may not necessarily apply to the particular model that you have. The following are some brief explanations:

## **ECHO:**

Echo adds depth and resonance to a singer's voice without affecting the music. This echo is produced by creating minor controlled feedback in the singer's voice.

## **Multiplex:**

A multiplex CD+G is really three recordings on one CD+G. The right channel has a mono recording which allows you to sing a duet with the lead singer. The left channel has a mono recording of the same music, WITHOUT the lead singer. Multiplex control allows the singer to gradually go from left channel to right channel, thereby gradually fading out the vocal.

## **Multiplex Karaoke Disc (CD+G):**

Multiplex Karaoke Disc(CD+G) is when music is on the left balance side and vocals are on the right balance side.

## **Regular Karaoke Disc (CD+G):**

Regular karaoke CD+G only have music WITHOUT Vocals on them. Check CD+G verbiage before buying to get the correct Disc you want. All CD+G have lyrics on TV.

## **CD+G:**

This is an acronym for compact Disc plus Graphics . You will also see variations CD+G, and CD+Graphics. This is a regular CD with information stored on a data track simultaneous to music. In layment's terms, CD+G has a video output for simple graphics (not full motion video). In the case of karaoke, the graphics function is used to store song lyrics and display the lyrics in sync with music. In most cases, CD+G software displays lyrics which change color swiped as they are to be sung. A TV with a Video in RCA Jack is all that is required to display CD+G lyrics.

# Connect Ext. Device & Sound From Main Unit Speaker

---

## AUX IN (LINE IN / AUDIO IN)

To connect a MP3 Player or other Audio Device you will need a 3.5mm Auxiliary Cable.

1. Connect a 3.5 mm Auxiliary Cable to the AUX IN jack in the back of unit and to the Audio Output or Phones on the audio device you wish to play.
2. Press the SOURCE of Karaoke Machine to AUX-IN position, the screen shows : "AU".
3. Turn on both units.
4. After the connection, the external device will sound from speakers of your unit.

Please note:- If not use the this function, please unplug it.



# Play Bluetooth Music

---

## 1. Pairing your Smart Phone using Bluetooth :

Power the machine ON and then press SOURCE.

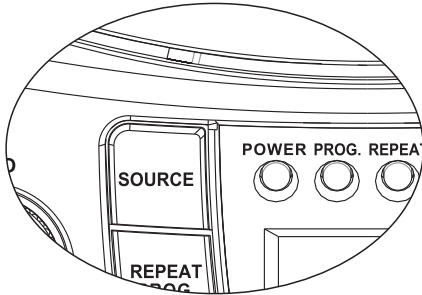

(on the Front Panel )

When in Bluetooth mode, the screen shows : “**bt**”.

## 2. Setting your Smart Device to “explore” the unit.

- A. Activate your Bluetooth function on your smart device.
- B. Click “Setting” and select “Bluetooth”

## 3. Using your Smart Device to connect to the Machine

- A. Your Smart Device will Discover:GQ263.
- B. Select GQ263.
- C. To accept the pairing to your smart Device .
- D. If they are paired, you will hear a “dididi” sound.
- E. If they are not paired, “**bt**” keeps flashing.
- F. Please repeat “Steps 1,2 & 3”above until they are paired.

## 4. Play Audio via Bluetooth After Pairing:

- A. Select and play the songs from your Smart Device.
- B. Always remember to use full volume to send your song files from your smart device.
- C. Adjust the Master Volume on the Machine to a comfortable level when necessary.
- D. Music will be put “on Hold” automatically when your Smart Device receives a phone call to let you answer. The music will resume when you end the call.

## 5. Bluetooth transmits audio only. You will not see lyrics when using Bluetooth for a music source.

# Troubleshooting Guide

Should this unit exhibit a problem, check the following before seeking service:

Symptom	Possible Cause	Solution
<b>Compact Disc Player</b>		
Disc will not play	Disc is not installed or installed upside-down.	Insert disc with label side up.
Disc skips while playing	Disc is dirty or scratched.	Wipe disc with cloth or use another disc.
<b>General</b>		
No sound.	Power cord disconnected or loose.	Check the connection or the power outlet.
	Selected the wrong music source.	Press DISC&AUX IN button to switch the music source.
	Volume on the minimum.	Turn up the Master Volume or the Microphone Volume
<b>Karaoke</b>		
Feedback is heard when singing.	Microphone is too close to unit or Microphone Volume is too high.	Move microphone away from unit or decrease Microphone Volume
Words do not appear on TV screen.	Using non-CD+G or Multiplex Karaoke disc.	Use CD+G or Multiplex Karaoke disc.
	Video cable connected improperly to TV.	Check connection, see page 10
	Source is not selected on TV.	Change source to match the location of karaoke connection to TV ( i. e VIDEO 1, CD, MP3,AUX IN. etc.).
<b>Bluetooth</b> No pairing	In the wrong mode	select the source button to Bluetooth mode.
	Unit set in AUX IN mode, or no connection	select the source button to Bluetooth mode.
	Volume setting too low on your smart device	Turn the volume up on your smart device and the unit volume,too
<b>Bluetooth</b> No music	Unit set in AUX IN mode, or no connection	select the source button to Bluetooth mode.
<b>Bluetooth</b> Music too low	Volume setting too low on your smart device	Turn the volume up on your smart device and the unit volume,too

## TECHNICAL SPECIFICATIONS

Output power : 3 watts(RMS)

Speaker : 5 watts

Input AC Power Voltage : 120V ~ 60Hz

DC Batteries: UM2 ( LR14) "C" Size x 8 PCS

Unit Dimensions: 224(L) X 234(W) X 170(H)mm

8.8"(L) X 9.25"(W) X 6.75(H)Inch

# **KARAOKE USA**

*1185 Gooden Crossing, Largo,*

*Florida, 33778, USA*

[www.KaraokeUSA.com](http://www.KaraokeUSA.com)

1-800-568-2000 ■ 727-209-1313