

# Wireless Data Recorder RTR505B User's Manual

Thank you for purchasing our product.  
To ensure safe and proper operation, please read this manual thoroughly before use.

## Overview

**RTR505B is a data logger designed to measure and record different items depending on the input module to be connected: temperature (Thermocouple, Pt), analog signal (4-20mA, DC voltage), and pulse.**

Recorded data is then automatically collected by the Base Unit via wireless communication and downloaded for archive and analysis.

**As a Remote Unit, RTR505B requires a Base Unit to carry out wireless communication.**  
(Compatible Base Units: RTR500BC, RTR500BW, RTR-500MBS-A, RTR-500DC, RTR-500, RTR-500NW/AW)  
**For the operation and configuration of the Base Unit, refer to the instruction manual attached to the Base Unit or the RTR500B Series Help available on T&D Website.**

Wireless Data Recorder RTR505B is referred to as the "(data) logger" or "device" in this manual.

**T&D CORPORATION**  
tandd.com

© Copyright T&D Corporation. All rights reserved.  
2020.09 16508210003 (1st Edition) Printed on recycled paper.

## Package Contents

- RTR505B or RTR505BL (Large Battery Type)
- Lithium Battery LS14250 (or Large Capacity Battery Adaptor Kit RTR-500B1 for L type model)
- Strap (Not included with L type model)
- Manual Set (Warranty Included)

## Part Names

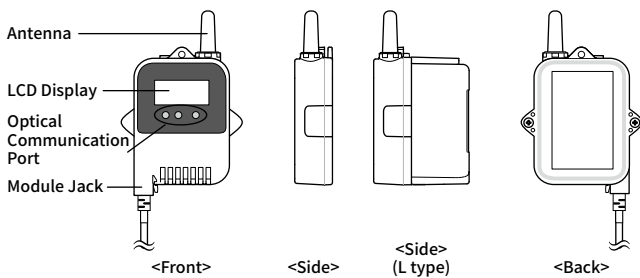

## Input Modules (Sold Separately)

Measurement Item	Input Module	LCD Displayed Items
Temperature (Type K, J, T, S)	Thermocouple Module (TCM-3010)	Measurement, Unit of Measurement, Sensor Type, Operational Status
Temperature (Pt100, Pt1000)	PT Module (PTM-3010)	Measurement, Unit of Measurement, Sensor Type, Operational Status
Voltage	Voltage Module (VIM-3010)	Measurement, Unit of Measurement, Operational Status
4-20mA	4-20mA Module (AIM-3010)	Measurement, Unit of Measurement, Operational Status
Pulse	Pulse Input Cable (PIC-3150)	Measurement, Unit of Measurement, Operational Status

- Before using the pulse input cable, it is necessary to set the measurement item to "pulse type" in the Remote Unit Settings of the application.
- In order to change the measurement item, initialize the Remote Unit without connecting the input module and then redo the Remote Unit registration and settings.

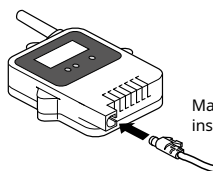

Make sure that the module is completely inserted until you hear a "click" sound.

## Installing the Battery

Recording starts automatically by inserting the battery with the default or previous settings.

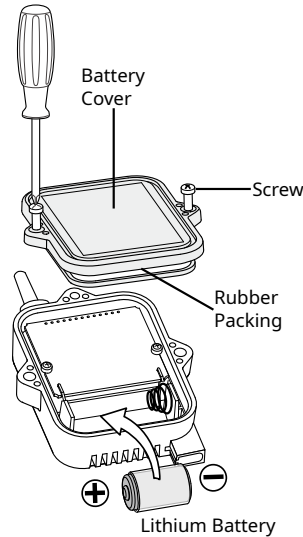

### Default Settings

Recording Mode	Endless
Recording Interval	10 minutes
Recording Start Method	Immediate Start

- Make sure to use the proper type and size screwdriver. (Phillips head #1 screwdriver is recommended.)
- Insert the supplied battery with the tube attached. When using a CR2 lithium battery, the tube is not necessary.
- Before closing the cover, check the rubber packing for dust or scratches, as they can reduce the water resistance of the rubber.
- Be sure to completely close the cover. Make sure not to over tighten the screws.
- Appropriate Tightening Torque: 20N·cm to 30N·cm (2Kg·cm to 3Kg·cm)

## Battery Replacement

When it is time for the battery to be replaced, a battery warning mark will appear. Please change the battery as soon as possible if this mark appears.

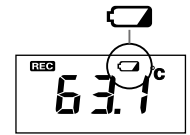

If you continue to use the logger without changing the battery, the current temperature and [bAtt] will be displayed alternately and wireless communication will stop. (Recording will continue.)



- If the battery is further left unchanged, the display will automatically shut off and all previously recorded data will be lost.
- Although the logger continues to work for a period after the battery has been removed, leaving the device without a battery until the LCD display goes blank will cause all recorded data to be lost.

## Remote Unit Registration

Using the software of the compatible Base Unit, carry out Remote Unit Registration via optical or Bluetooth.

### Optical Communication

Connect the Base Unit to a PC with a USB cable, and place the data logger face down to align the communication areas as shown below.

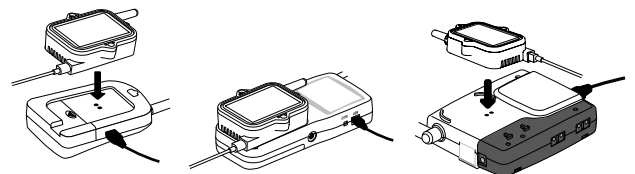

### Bluetooth® Communication

When the RTR500BW is a Base Unit, it is possible to make Base Unit and Remote Unit settings from nearby mobile devices using Bluetooth.

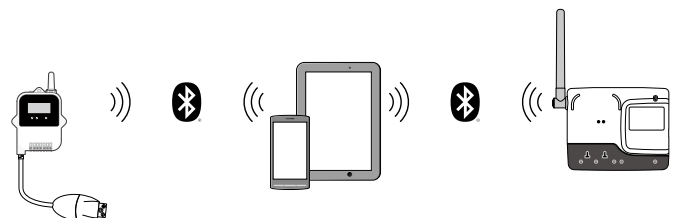

## How to Read the LCD Display

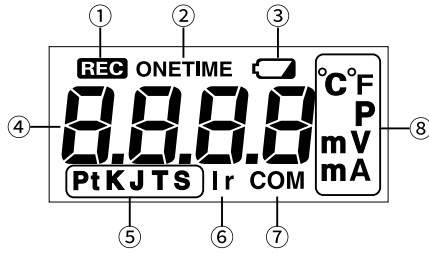

- ① [REC] Mark Shows the recording status.  
ON: Recording in progress  
BLINKING: Waiting for programmed start  
OFF: Recording stopped

---

- ② [ONETIME] Mark Shows the recording mode.  
ON: One Time  
OFF: Endless

---

- ③ Battery Warning Mark Indicates it is time for the battery to be replaced.

---

- ④ Measurement and Message Area Measurements or operational messages are shown here.  
  
The type of sensor connected to or set in the logger is shown here.

---

- ⑤ Sensor Type Thermocouple: Type K, J, T, S  
Platinum Thermal Resistance Sensor: Pt (Pt100), PtK (Pt1000)

---

- ⑥ [Ir] Mark Indicates that the logger (Remote Unit) has not been registered to the Base Unit or the wireless communication is stopped (inactive radio).

---

- ⑦ [COM] Mark Indicates that the device is in Bluetooth communication.

---

- ⑧ Unit of Measurement Shows the unit of measurement.

• When being used in very hot or cold environments the display may become difficult to read. This is not a malfunction.

## Basic Measurement Display

Display varies depending upon the input module connected.

### Temperature (Thermocouple / Pt100 / Pt1000)



Temperature measurement (Unit: °F / °C) will be displayed. Sensor type will be displayed under the measurement; the factory default setting is Type K and Pt (Pt100). The sensor type setting can be changed in the Remote Unit Settings of the application.

### Voltage



Voltage measurement (Unit: V / mV) will be displayed. Due to the wide measurement range, the device has been set by default to adjust the decimal point automatically to display the measurement in V. The unit of display can be changed in the Remote Unit Settings of the application.

### 4-20mA



4-20mA measurement (Unit: mA) will be displayed.

### Pulse

There are two display methods for the pulse measurement. The display method can be changed in the Remote Unit Settings of the application.



#### Pulse Rate (Max: 61439)

The most recent pulse count (Unit: P) for the recording interval period will be displayed. The display will be refreshed every one-sixtieth of the recording interval (at minimum of every one second). 50,500 pulse count will be displayed as [50.50P] with "K" below the measurement value. The display is in units of 10 pulses.



#### Total Pulse Count

The cumulative number of pulses (Unit: P) will be displayed from 0 to 9999. The displayed count will be refreshed every one second, and upon exceeding 9999, the count will start over again from 0.

## Other Indications on Display

### Logging Capacity FULL



When Recording Mode has been set to "One Time" and the logger reaches its logging capacity of 16,000 readings, recording will automatically stop and in the LCD the measurement and the word [FULL] will alternately appear.

#### Estimation of time until [FULL] is displayed

Rec Interval	1 second	30 seconds	1 minute	10 minutes	60 minutes
Time Period	About 4 hours	About 5 days	About 11 days	About 111 days	About 1 year and 10 months

### Data Transmission via Wireless Communication



The measurement and the word [SEnd] will alternately appear when data is being sent via wireless communication to the Base Unit. Recording will continue during wireless transmission.

### Input Module Unrecognized (factory default)



This will appear if, after purchasing, the input module has never been connected to the logger. (No unit displayed)

### Input Module Unconnected or Damaged

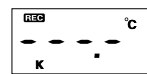

This will appear if the device cannot confirm a connection with the input module after having recognized it. (Unit of Measurement displayed)

• If nothing is displayed after reconnecting the module to the device, there is a possibility that the module or the device has been damaged.

### Sensor Unconnected or Damaged



This will be displayed when a sensor has not been connected to the module or the wire has been broken. Recording is in progress and so is battery consumption.

• If nothing appears on display after reconnecting the sensor to the device, there is a possibility that the sensor or the device has been damaged.

### Measurement Range Exceeded

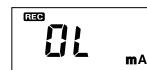

[OL] will appear if a measurement exceeds the measurement range.

### Display Range Exceeded

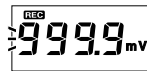

When measuring voltage in mV range, the measurement in the LCD display will flash if it exceeds the display range of the device.

## Specifications

Measurement Item	Temperature, Voltage, 4-20mA, or Pulse Count (*1)
Logging Capacity	16,000 readings
Recording Interval	1, 2, 5, 10, 15, 20, 30 sec. 1, 2, 5, 10, 15, 20, 30, 60 min. (Total of 15 choices)
Recording Mode(*2)	Endless: Overwrite oldest data when capacity is full One Time: Stop recording when capacity is full
Communication Interfaces	Short Range Wireless Communication Frequency Range: 902 to 928 MHz RF Power: 7 mW Transmission Range: About 150 m if direct and unobstructed. Bluetooth 4.2 (Bluetooth Low Energy) (*3) Optical Communication (proprietary protocol)
Power	Lithium Battery LS14250 x 1 L Type: Large Capacity Battery Adaptor Kit (RTR-500B1) x 1 (*4) External Power Adaptor Kit RTR-500A2
Battery Life (*5)	Approx. 10 months / L Type: About 4 year
Dimensions	H 62 mm x W 47 mm x D 19 mm L Type: H 62 mm x W 47 mm x D 46.5 mm (excluding protrusions and Input Module)
Weight	Approx. 50 g / L Type: Approx. 65 g
Operating Environment	-40 to 80°C (-30 to 80°C during wireless communication)
Waterproof Capacity	IP64 (splash proof / rated for use in daily life) (*6)
Compatible Base Units	RTR500BC, RTR500BW RTR-500DC, RTR-500MBS-A, RTR-500NW/AW (*7)(*8) RTR-500 (*8)

\*1: Measurement item depends on the input module (sold separately).

\*2: Only "Endless" is available when using the RTR500BW, RTR-500NW/AW or RTR-500MBS-A as a Base Unit.

\*3: Bluetooth is available when using the RTR500BW as a Base Unit and making device settings in the mobile app (T&D 500B Utility).

\*4: When using RTR-500B1 it is necessary to purchase Lithium Battery (LS26500). For details, contact your local authorized distributor.

\*5: Battery life varies depending upon the ambient temperature, radio environment, frequency of communication, recording interval, and quality of the battery being used. All estimates are based on operations carried out with a new battery and are in no way a guarantee of actual battery life.

\*6: Input module (sold separately) is not water resistant.

\*7: A firmware update is required.

\*8: A software update is required.

The specifications listed above are subject to change without notice.