

VYPAGEAR UNI-CON

for Nintendo Switch Joy-Cons
& iPhone (running iOS16 or greater)

INTRODUCTION: Uni-Con (A Unified Control System)

The Uni-Con lets games receive whatever gaming rig you are playing on, use the Uni-Con on a standalone holder for **Switch Joy-Cons** providing a comfortable grip, or go mobile with your **iPhone** while playing. Apple Arcade or MIT controller supported games, use it for **Remote-Play** from PC or favorite console, PS4/5 Xbox.

1) Nintendo Switch Gaming

The Uni-Con provides a comfortable traditional handheld gaming grip for Nintendo Switch gaming in TV Mode or extend the Uni-Con to securely grip the Nintendo Switch console screen, best fit if the rubber grips along the switch between the Joy-Con grips work. Charges both Joy-Cons with a USB Type-C adapter & cable (not supplied).

2) iPhone (iOS16) Gaming

The Uni-Con provides a comfortable grip & secure phone holder, plus wireless charging for your iPhone. Charges both Joy-Cons & your iPhone with a USB-Type-C adapter & cable (not supplied).

iOS 16 (or higher) With the launch of iOS16, Apple introduced native MFi (Made for iPhone) controller support to Nintendo Switch Joy-Cons, allowing them to connect to your iPhone via the standard Bluetooth method. The applet now allows for in-handheld "Switch" style gaming on iPhone via the Uni-Con. It was only viable before by purchasing a more expensive "Form Fitting" MFi Game Controller.

Apple Arcade: Play Apple Arcade games comfortably in the palm of your hand on your iPhone or alternatively connect your Joy-Con to an AppleTV or iPad running iOS16 or iPadOS16. Both closed the Uni-Con back to play like a regular Bluetooth controller.

NOTE: Only games that support external controllers will work, a comprehensive up-to-date list of controller supported games can be found online at www.games.com

3) Remote-Play Gaming on PS4/5, XboxOne, PC-Steam

Remote-Play allows you to stream your console or PC games from your gaming console or PC directly onto the screen of your iPhone.

With your Uni-Con & connected Joy-Con it is now possible to play your favorite games "switch style" in the palm of your hand maybe in a bed or more relaxed position instead of hunched behind a large screen TV. The ability for more casual relaxed style of gaming most games prefer.

To connect to your gaming console you will need to download the appropriate free apps to your iPhone. For your convenience scan the appropriate code below with your iPhone to link directly to the apps you require.



Guide for Remote-Play

All 3 apps above are official applications & updated by the respective 1st party companies & are not affiliated with our product. All 3 apps/links are owned by their respective parties.

Once the appropriate Apps is installed on your phone follow the setup instructions within the App on how to connect to your gaming console or PC.

Normally the app asks you to have an active account with that company. Example for Remote-Play on a Steam PC the App asks you to log into your Steam Account.

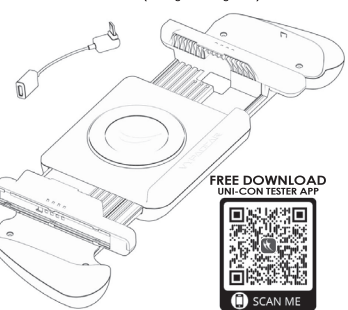

FREE DOWNLOAD
UNI-CON TESTER APP

- Download the **FREE** app from the Apple Appstore to test the device & functionality of your connected Joy-Con controllers.
- Use same or 100% of controller enabled games.
- Some user manual updates.

CHARGING FEATURES:

Keep your batteries topped up!

We all know mobile gaming consumes battery life, especially on newer 3D intensive titles, so plug in a USB Type-C cable (not supplied) to extend your gaming sessions, keeping you topped up as you play. The Uni-Con provides 3in1 charging for 2 Nintendo Joy-Cons, plus wireless charging for iPhone.

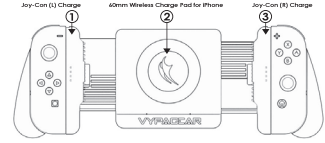

INSTALLING JOY-CONS:

- 1) Hold down the **Bluetooth sync button** on the Joy-Con until the LED's cycle (pairing mode)
- 2) The both (L & R) Joy-Con's with your iPhone via wireless (Bluetooth - iOS 16 or higher required)
- 3) Make sure that Joy-Con's are in the Uni-Con from the top down until a "click" is heard.



- 4) Hold down the **ScreenShot button** & the **Home Button** together for approx 3secs to unify both Joy-Con's into one controller for iOS16. (see <https://www.mega-games.com> "controller" menu for more info).

NOTE: It is recommended you connect both your Joy-Con to your iPhone before you install them into the Uni-Con as the Joy-Con Bluetooth sync button is covered when installed then the release button & take out the Joy-Con & reinsert it from the Uni-Con (same process as removing them from the Nintendo Switch).

UNI-CON FEATURES:

The Uni-Con security holds off Phone Mode with or without a protective case attached. Supports popular protective cases such as Otterbox Apple iDuo etc. The lockable Joy-Controls to a maximum thickness of 12mm.



Lock /Unlock Switch

To lock/unlock the Uni-Con toggle the switch on the rear of the grip. You will hear a clicking "click" sound when adjusting the size of the grip whilst it is in lock mode. It is recommended you unlock the grip & extend it to the maximum width, place your phone on the charge pad, toggle the switch to the lock position then push closed bottom arms around your phone to secure it into place. Soft rubber rubber grips ensure a snug fit and help protect the edges of your phone against damage.

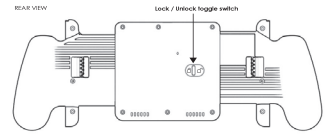

Phone Grip

NOTE: The soft rubber grips are not only designed for ensure a secure hold for your phone but also the "vertical fit" design allows for double reduction when not using headsets.

ACCESSIBILITY:

Full Lightning Port Access

We understand mobile "in the palm" gaming can be a puzzle or social affair, with many gaming sessions being played on planes, in business cars, etc. or just at home amongst family & friends. So to be respectful to those around you, many games use headsets.

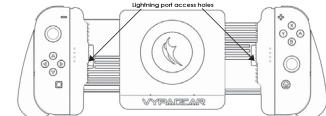

The Lightning Extension Cable

We provide a custom **Lightning Extension Cable** to allow for the use of Apple headphones or 3rd party lightning headphones. It can also be used for fast charging using your Apple charger. The Lightning Extension Cable is 30cm in length & connector type is **Lightning to Lightning**. To install: 1) Plug Extension Cable into your headphones first. 2) Insert Extension Cable upwards through an access hole. 3) Plug Extension Cable into iPhone's lightning port to **lock** headphones. 4) Toggle the switch to the locked position & push Uni-Con closed to secure your phone.

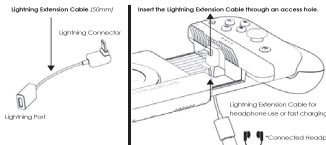

*NOTE: Cable & headphones **MUST** be connected together & then connected to iPhone.

FCC CAUTION:

The device complies with part 15 of the FCC Rules. Operation is subject to the following two conditions:

- (1) The device may not cause harmful interference, and
- (2) The device must accept any interference received, including interference that may cause undesired operation.

Any changes or modifications not expressly approved by the party responsible for compliance could void the user's authority to operate the equipment.

Note: This equipment has been tested and found to comply with the limits for a **Class B** digital device, pursuant to part 15 of the FCC Rules.

These limits are designed to provide reasonable protection against harmful interference in a residential installation. This equipment generates use and can also receive energy and, if not installed and used in accordance with the instructions, may cause harmful interference to radio communications. However, there is no guarantee that interference will not occur in a particular installation.

If this equipment does cause harmful interference to radio or television reception, which can be determined by turning the equipment off and on, the user is encouraged to try to correct the interference by one or more of the following measures:

- Reorient or relocate the receiving antenna.
- Increase the separation between the equipment and receiver.
- Connect the equipment into an outlet on a circuit different from that to which the receiver is connected.
- Consult the dealer or an experienced radio-TV technician for help.

RF warning for Mobile device

The equipment complies with FCC radiation exposure limits set forth for an uncontrolled environment. The equipment should be installed & operated with minimum distance 20cm between the radiator & your body.



Contact : [vpagear@vpagear.com](https://www.vpagear.com) or find us on most social media platforms via [vpagear@](https://www.vpagear.com)