

StreetFX™ Color Changing Kit Instructions for iPhone™

1. Download App. iLEDKITS from the Apple™ iTunes app. store.
2. Make sure the Bluetooth is enabled on your device. Tap the Bluetooth bar to open.
3. Search for discoverable devices.
4. It should find LX-LED. Select the device.
5. It will ask for a pin. Enter 0000
6. Select PAIR
7. It should show the device as “connected”
8. Open the APP.
9. Select color or operating mode to control the lights.

**Compatible with iPhone 3GS, 4, 4S and 5. iTouch 3rd and 4th Generation, and iPad.
Requires iOS4.3 or later.**

NOTE #1: Operating range for this and other Bluetooth devices is approximately 100 feet. If the operator leaves the range of operation and then comes back into range, it may take up to 1 minute for the device to automatically reconnect to the light kit. In a case where the smart phone does not reconnect, simply repeat step 7 and manually connect the kit.

NOTE #2: The Bluetooth inherently utilizes the headphone connection. It is not possible to use headphones and control the kit simultaneously. If headphones have been used recently, then the device must be selected in the Music app. See below, steps 10 and 11. Select between the headphones and LX-LED, to regain control of the light kit.

NOTE #3: The system has a low but constant standby current draw. If the bike will be sitting for extended periods of time we suggest the installation of a main power switch. SKU# 1044702

All specifications and instructions subject to change. Please see our website www.streetfxseries.com for up to the date instructions or specification changes.

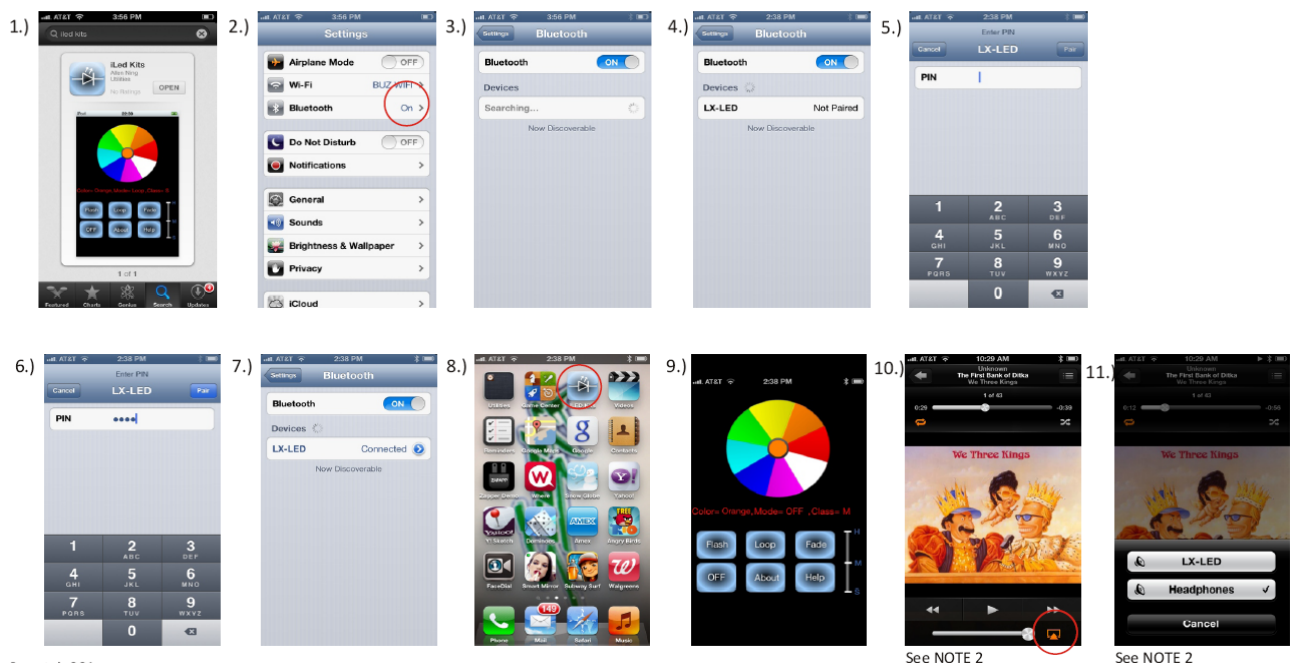

FCC Statement

Changes or modifications not expressly approved by the party responsible for compliance could void the user's authority to operate the equipment.

This equipment has been tested and found to comply with the limits for a Class B digital device, pursuant to Part 15 of the FCC Rules. These limits are designed to provide reasonable protection against harmful interference in a residential installation. This equipment generates uses and can radiate radio frequency energy and, if not installed and used in accordance with the instructions, may cause harmful interference to radio communications. However, there is no guarantee that interference will not occur in a particular installation. If this equipment does cause harmful interference to radio or television reception, which can be determined by turning the equipment off and on, the user is encouraged to try to correct the interference by one or more of the following measures:

- Reorient or relocate the receiving antenna.
- Increase the separation between the equipment and receiver.
- Connect the equipment into an outlet on a circuit different from that to which the receiver is connected.
- Consult the dealer or an experienced radio/TV technician for help

This device complies with part 15 of the FCC rules. Operation is subject to the following two conditions (1) this device may not cause harmful interference, and (2) this device must accept any interference received, including interference that may cause undesired operation