

QUICK START GUIDE



SNOWMEN BELL CHOIR

For more detailed instructions, please consult the included instruction sheet.

SETUP

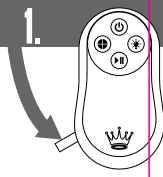

1. Remove pull tab from remote.

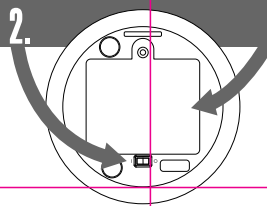

2. Install batteries in each bell. Make sure switch on bottom is set to I (on).

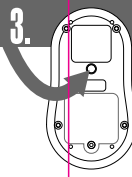

3. Press red SYNC button on back of remote and wait for bells to flash. This may take 3-5 seconds.

OPERATION

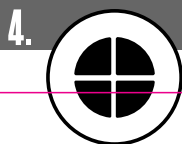

4. Press COLOR button to choose light color.



5. Press PLAY/PAUSE button to start the show.

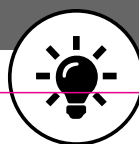

6. Press LIGHT button for continuous light without sound.

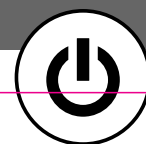

7. If Snowman Bell Choir is inactive for more than 30 seconds and lights go off, press POWER button to reactivate.

SNOWMEN BELL CHOIR INSTRUCTION SHEET

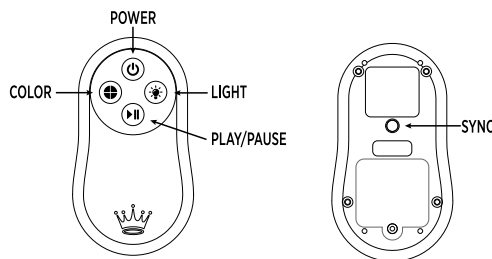
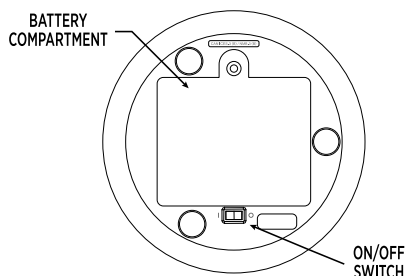

SETUP:

- Remove pull tab from remote.
- Insert 3 AA batteries (included) into the bottom of each bell.
- Make sure the switch on the bottom of each bell is set to **I** (on) to ensure that each bell is on.
- To prepare the Snowmen Bell Choir for their first use, press the red SYNC button on the back of the remote once. The bells will begin flashing. This may take three to five seconds to happen.
- Once the Snowmen Bell Choir has stopped flashing and all five have a steady glow, they are synced and ready to enjoy.

USING THE REMOTE:

POWER BUTTON:

- Press the POWER button on the remote to turn the bells on. The Snowmen Bell Choir will begin to glow.

COLOR BUTTON:

- You can choose the color that the bells glow. Press the COLOR button to cycle through one of eight color options. Your choices include:
 - White —Gold
 - Red —Magenta
 - Green —Aqua
 - Blue —Multicolor

PLAY BUTTON:

- Press the PLAY/PAUSE button to experience one of five Snowmen Bell Choir song performances.
- You are not able to change the light color of the Snowmen Bell Choir while playing a song. Pause the playing of the song by pressing the PLAY/PAUSE button, then use the COLOR button to change the light color. Press the PLAY/PAUSE button again to start the next song in the light color you choose.

LIGHT BUTTON:

- You can change the style of lighting that the bells glow. Press the LIGHT button to choose from one of two continuous ambient lighting options. Lighting options include:
 - Random fade
 - Candlelight flicker
- The ambient light modes will shut off after three hours of operation. The more frequently the Snowmen Bell Choir is in an ambient light mode, the faster the batteries will drain. If you use your bells in ambient light mode regularly, you will likely need to change the batteries more frequently.
- You are able to change the light color with the COLOR button while using ambient light mode.
- If PLAY/PAUSE button is pressed while in ambient light mode, the Snowmen Bell Choir will play one song before resuming ambient light mode.

TROUBLESHOOTING:

- In the event that one or more of the bells stops working in sync with the other bells, re-sync by pressing the SYNC button on the back of the remote. Repeat as needed.
- If bells are inactive for more than thirty seconds, they will enter sleep mode. To resume activity with the Snowmen Bell Choir, simply press POWER button on remote.
- Slide the switch on the bottom of each bell to off (O) between uses in order to conserve battery life. The Snowmen Bell Choir will need to re-sync the next time they are turned on (I).

This device complies with Part 15 of the FCC Rules. Operation is subject to the following two conditions: (1) this device may not cause harmful interference, and (2) this device must accept any interference received, including interference that may cause undesired operation.

Caution: Changes or modifications to this unit not expressly approved by the party responsible for compliance could void the user's authority to operate the equipment.

Note: This equipment has been tested and found to comply with the limits for a Class B digital device, pursuant to Part 15 of the FCC Rules. These limits are designed to provide reasonable protection against harmful interference in a residential installation. This equipment generates, uses, and can radiate radio frequency energy and, if not installed and used in accordance with the instructions, may cause harmful interference to radio communications. However, there is no guarantee that interference will not occur in a particular installation. If this equipment does cause harmful interference to radio or television reception, which can be determined by turning the equipment off and on, the user is encouraged to try to correct the interference by one or more of the following measures:

- Reorient or relocate the receiving antenna.
- Increase the separation between the equipment and receiver.
- Connect the equipment into an outlet on a circuit different from that of the receiver.
- Consult the dealer or an experienced radio/TV technician for help.

CAN ICES-3 (B)/NMB-3 (B)

© HALLMARK LICENSING, LLC

APROX. SIZE 8.5"W X 11"H