

FLUANCE®

Ai41 – Powered Bookshelf Speakers

Quick Start Guide v1.0



Important Safety Instructions

1. Read these instructions.
2. Keep these instructions.
3. Heed all warnings.
4. Follow all instructions.
5. Do not use this apparatus near water.
6. Clean only with dry cloth.
7. Do not block any ventilation openings. Install in accordance with the manufacturer's instructions.
8. Do not install near any heat sources such as radiators, heat registers, stoves, or other apparatus (including amplifiers) that produce heat.
9. Do not defeat the safety purpose of the polarized or grounding-type plug. A polarized plug has two blades with one wider than the other. A grounding type plug has two blades and a third grounding prong. The wide blade or the third prong are provided for your safety. If the provided plug does not fit into your outlet, consult an electrician for replacement of the obsolete outlet.
10. Protect the power cord from being walked on or pinched particularly at plugs, convenience receptacles, and the point where they exit from the apparatus.
11. Only use attachments/accessories specified by the manufacturer.
12. Use only with the cart, stand, tripod, bracket, or table specified by the manufacturer, or sold with the apparatus. When a cart is used, use caution when moving the cart/ apparatus combination to avoid injury from tip-over.
13. Unplug this apparatus during lightning storms or when unused for long periods of time.
14. Refer all servicing to qualified service personnel. Servicing is required when the apparatus has been damaged in anyway, such as power supply cord or plug is damaged, liquid has been spilled or objects have fallen into the apparatus, the apparatus has been exposed to rain or moisture, does not operate normally, or has been dropped.
15. The use of apparatus in moderate climates.



CAUTION

- Minimum 5cm around the apparatus for sufficient ventilation.
- The ventilation should not be impeded by covering the ventilation openings with items, such as newspapers, table-cloths, curtains, etc.
- No naked flame sources, such as lighted candles, should be placed on the apparatus.
- Should be drawn to the environmental aspects of the battery disposal.
- To reduce the risk of fire or electric shock, do not expose this apparatus to rain or moisture.
- Battery shall not be exposed to excessive heat such as sunshine, fire or the like.
- The mains plug or an appliance coupler is used as the disconnect device, the disconnect device shall remain readily operable.

Précautions De Sécurité Importantes a Lire En Premier

1. Lisez ces instructions.
2. Conservez ces instructions.
3. Tenez compte de tous les avertissements.
4. Suivez toutes les instructions.
5. N'utilisez pas cet appareil près de l'eau.
6. Nettoyer uniquement avec un chiffon sec.
7. Ne bloquez aucune ouverture de ventilation. Installez conformément aux instructions du fabricant.
8. Ne pas installer à proximité de sources de chaleur telles que des radiateurs, des registres de chaleur, des poêles ou d'autres appareils (y compris des amplificateurs) qui produisent de la chaleur.
9. Ne détournez pas le but de sécurité de la prise polarisée ou de mise à la terre. Une fiche polarisée comporte deux pales dont une plus large que l'autre. Une fiche de type à la terre a deux lames et une troisième broche de mise à la terre. La lame large ou la troisième broche sont fournies pour votre sécurité. Si la fiche fournie ne rentre pas dans votre prise, consultez un électricien pour le remplacement de la sortie obsolète.
10. Protégez le cordon d'alimentation avant d'être piétiné ou pincé en particulier sur les bouchons, les prises de courant et le point où ils sortent de l'appareil.
11. N'utilisez que des accessoires / accessoires spécifiés par le fabricant.
12. Utilisez uniquement avec le chariot, le support, le trépied, le support ou la table spécifiés par le fabricant ou vendus avec l'appareil. Lorsqu'un chariot est utilisé, soyez prudent lorsque vous déplacez la combinaison panier / appareil pour éviter les blessures causées par le renversement.
13. Débranchez cet appareil pendant les orages ou lorsqu'il n'est pas utilisé pendant de longues périodes.
14. Référez tous les services à un personnel qualifié. Un entretien est nécessaire lorsque l'appareil a été endommagé de toute façon, comme le cordon d'alimentation ou la fiche est endommagé, le liquide a été renversé ou les objets sont tombés dans l'appareil, l'appareil a été exposé à la pluie ou à l'humidité, s'il ne fonctionne pas normalement ou s'il est tombé.
15. L'utilisation d'appareils dans les climats modérés.



ATTENTION

- 5cm minimale autour de l'appareil pour une aération suffisante.
- il convient que l'aération ne soit pas gênée par l'obstruction des ouvertures d'aération par des objets tels que journaux, nappes, rideaux, etc...
- il convient de ne pas placer sur l'appareil de sources de flammes nues, telles que des bougies allumées.
- il convient d'attirer l'attention sur les problèmes d'environnement dus à la mise au déchet des piles.
- le mode d'emploi doit stipuler que l'appareil ne doit pas être exposé à des égouttements d'eau ou des éclaboussures et de plus qu'aucun objet rempli de liquide tel que des vases ne doit être placé sur l'appareil.
- Un avertissement selon lequel les batteries (bloc de batteries ou batteries installées) ne doivent pas être exposées à une chaleur excessive telle que celle du soleil, d'un feu ou d'origine similaire.
- lorsque la prise du RESEAU D'ALIMENTATION ou une prise placée sur l'appareil est utilisée comme appareil de déconnexion, cet appareil doit demeurer aisément accessible.

Introduction

Thank you for your purchase of your Fluance product. We hope you enjoy your experience. If you have any questions please visit us at www.Fluance.com/support.

Fluance believes everyone should experience audio in its truest form, recreating the performance the way the artist intended. Utilizing only superior components and expert audio engineering, their products are a testament to the performance that can be achieved when a passion for music takes center stage. The perfect complement to any audiophile's lifestyle, you'll be enjoying live performances in your home for years to come.

Break-in Period

Our speakers have a Butyl rubber ring surrounding the cone. The break-in period allows the rubber to loosen and stretch, allowing the cone a larger range of movement, resulting in better sound reproduction. We recommend 10-12 hours of play at moderate volume to achieve this.

For additional product information, please consult the manual at: Fluance.com/support

What's Included

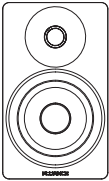

Ai41 Passive Speaker
(Left Channel)

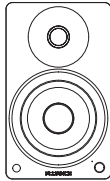

Ai41 Active Speaker
(Right Channel)

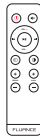

Remote Control



2 'AAA' Batteries

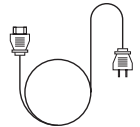

Power Cable



Speaker Wire

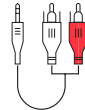

AUX-to-RCA Cable

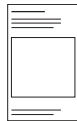

Quick Start Guide



Lifetime Customer Support



2 Year Warranty

Front & Back Panel Layout

1. Control Knob

- Volume
- Input Selection
- Power ON/OFF

2. Source LED

- Blue (Solid) - Bluetooth® Paired
- Blue (Flashing) - Bluetooth® Pairing Mode
- Yellow (Solid) - RCA
- Red (Solid) - Standby Mode
- Red (Flashing) - Mute
- Red (Flash x2) - Bass/Treb Set to -5 or +5
- Blue/Yellow (Flash x2) - Bass/Treb Set to 0

3. IR Sensor

4. Speaker Input

5. Bluetooth® Reset Pairing

6. RCA Input

7. Left Speaker Output

8. DC Input

9. Power Switch

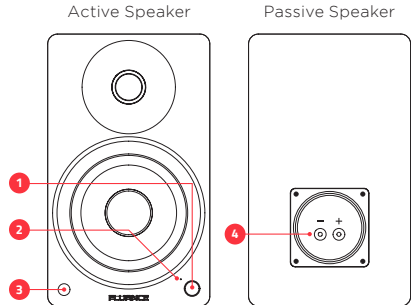

Active Speaker (Back)

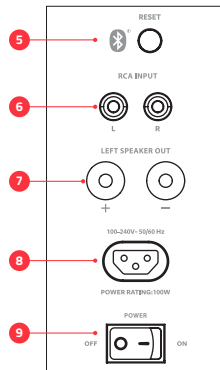

Remote Control Layout

1. Power ON/OFF

2. Volume UP/DOWN

3. Source

4. Treble UP/DOWN

5. Mute

6. Play/Pause & Bluetooth® Pairing Reset*

*To enable Bluetooth® Pairing Reset, press & hold for 3 seconds.

7. Forward/Back

8. LED Brightness - (100% > 25% > OFF)

9. Bass UP/DOWN

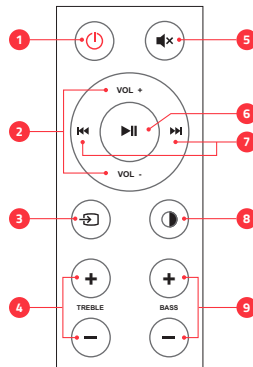

Product Setup

1. Position the speakers with the Active Speaker on the right and the Passive Speaker on the left.

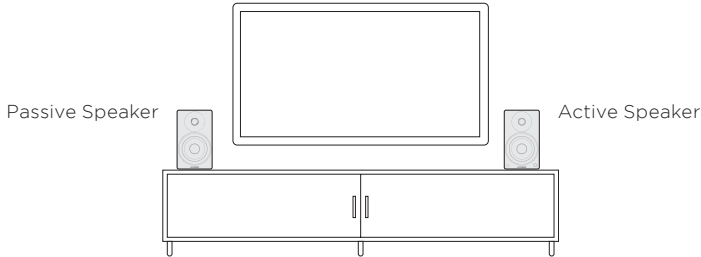

NOTE: If placing the speakers in a cabinet or on a shelf, position the front of the speakers as close as possible to the front edge of the shelf for optimum audio performance.

2. Connect one end of the speaker wire to the binding posts on the back of the Active Speaker and connect the other end of speaker wire to the binding posts on the back of the Passive Speaker.

IMPORTANT: Ensure the same wire is connected to the same color binding post on each speaker.

NOTE: The included speaker wire is 6ft. If placing your speakers further than 6ft apart it is recommended to use standard 18 gauge speaker wire to connect the speakers over the longer distance.

3. Connect the power cable to the back of the Active Speaker and set the power switch to the ON position.

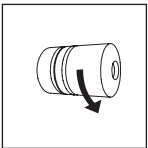

Loosen the binding post

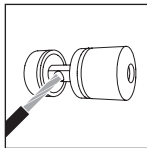

Insert speaker wire through hole

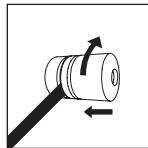

Tighten the binding post

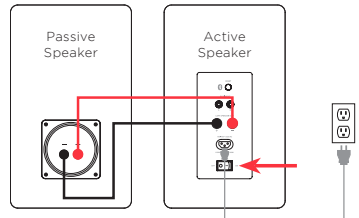

Turning On/Off Unit

Press the Control Knob to turn ON the unit. Hold to turn OFF the unit.



Press  on the Remote to turn the unit ON/OFF.

RCA Input

1. Connect the RCA cable to your source device (Turntable, Smartphone, Computer...).
2. Connect the other end of the RCA cable to back of the Active Speaker.

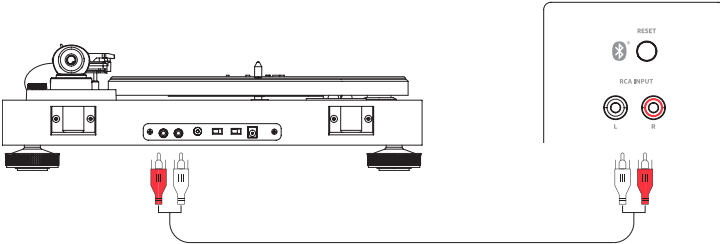

*RCA to RCA cable not included

3. Press the Control Knob to select the RCA input (Yellow LED).
4. Adjust volume on Ai41 as well as source device.

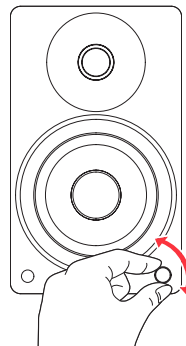
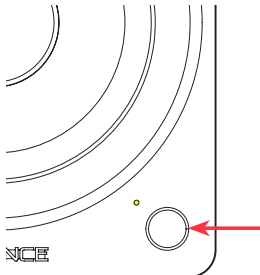

Bluetooth® Pairing

1. Press the Control Knob to select the Bluetooth® input (Blue LED).

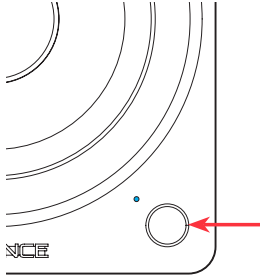

2. Pair to “Fluance Ai41” on your source device.

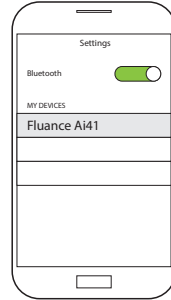

Note: Unit will attempt to auto-pair to the last paired device.

3. Use the Remote to control playback on your source device.

Note: Adjust Volume on the source device as well as the Ai41.



Note: How you access your device's Bluetooth® settings may vary from one manufacturer to another. Maximum line of sight for Power Class 2 Bluetooth® range is 33ft. Obstacles may decrease transmission distance.

4. If your device cannot find “Fluance Ai41”, you can reset Bluetooth® pairing:

- Press and hold  for 3 seconds to reset Bluetooth® pairing.

OR

- Press and hold the Bluetooth® Pairing Reset Button on the back of the unit.

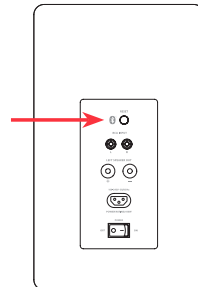

Frequently Asked Questions

What is “auto-pairing” and how does it work?

Auto-pairing is a convenient connection feature included in all Fluance Bluetooth® Speakers. If the connected Bluetooth®-enabled device leaves the connection range of the Ai41 and returns at a later time, the device will automatically connect. If the device’s Bluetooth® function is disabled and then enabled at a later time, the device will automatically connect as well.
*Note: The Fluance Ai41 will only auto-pair to the last device that it was connected to.

How do I change the source on my Fluance Ai41?

Press the Control Knob or use the Source button on the Remote Control. The LED will flash the Source LED color (Blue/Yellow).

How do I adjust the Volume on my Fluance Ai41?

Turn the Control Knob or use Volume buttons on Remote Control. The LED will flash Red at Max.

How do I adjust the Bass and Treble on my Fluance Ai41?

Use the Bass and Treble buttons on the Remote Control.

| EQ Setting | LED |
|------------|-------------------------|
| Min (-5) | Flash Red 2x |
| Mid (0) | Flash Blue or Yellow 2x |
| Max (+5) | Flash Red 2x |

Another Bluetooth® device is connected to my Fluance Ai41 and I want to connect my device.

You can reset any Bluetooth® connection by pressing and holding the Bluetooth® Pairing Reset button on the back of the Active Speaker for 1 second. You can also press and hold “Play/Pause” on the Remote for 3 seconds.

What RCA devices can be connected to the Ai41?

Any RCA device will work with the Ai41. Common devices would be TV’s, Turntables, Smartphones, or Tablets. The included Aux to RCA cable allows any device with a 3.5mm Aux output to connect to the Ai41.

How do I adjust the LED Brightness?

Use the LED Brightness Button on the Remote to cycle between 100%, 25%, and OFF brightness levels.

How can I increase the volume when using the Ai41 with a turntable?

If turntable audio is too quiet you may need to add a preamplifier. Some turntables have built in preamps which can be turned on or off. The Fluance PA10 preamplifier is a great match for Fluance powered speakers and turntables.

Certification Information

FCC Statement

This equipment has been tested and found to comply with the limits for a Class B digital device, pursuant to Part 15 of the FCC Rules. These limits are designed to provide reasonable protection against harmful interference in a residential installation. This equipment generates uses and can radiate radio frequency energy and, if not installed and used in accordance with the instructions, may cause harmful interference to radio communications. However, there is no guarantee that interference will not occur in a particular installation. If this equipment does cause harmful interference to radio or television reception, which can be determined by turning the equipment off and on, the user is encouraged to try to correct the interference by one or more of the following measures:

- Reorient or relocate the receiving antenna.
- Increase the separation between the equipment and receiver.
- Connect the equipment into an outlet on a circuit different from that to which the receiver is connected.
- Consult the dealer or an experienced radio/TV technician for help.

This device complies with part 15 of the FCC Rules. Operation is subject to the following two conditions:(1) This device may not cause harmful interference, and (2) this device must accept any interference received, including interference that may cause undesired operation. Changes or modifications not expressly approved by the party responsible for compliance could void the user's authority to operate the equipment. This equipment complies with FCC radiation exposure limits set forth for an uncontrolled environment. This equipment should be installed and operated with minimum distance 20cm between the radiator & your body. The device has been evaluated to meet general RF exposure requirement. The device can be used in portable exposure condition without restriction.

IC Warning

This device complies with Industry Canada license-exempt RSS standard(s).

Operation is subject to the following two conditions:

(1) This device may not cause interference, and (2) This device must accept any interference, including interference that may cause undesired operation of the device.

Le présent appareil est conforme aux CNR d'Industrie Canada applicables aux appareils radio exempts de licence. L'exploitation est autorisée aux deux conditions suivantes:

(1) l'appareil ne doit pas produire de brouillage, et

(2) l'utilisateur de l'appareil doit accepter tout brouillage radioélectrique subi, même si le brouillage est susceptible d'en compromettre le fonctionnement.

Changes or modifications not expressly approved by the party responsible for compliance could void the user's authority to operate the equipment. This equipment complies with IC radiation exposure limits set forth for an uncontrolled environment. This equipment should be installed and operated with minimum distance 20cm between the radiator & your body. This transmitter must not be co-located or operating in conjunction with any other antenna or transmitter.

Warranty Information

Fluance gives the following warranty to the original customer of each new Fluance product purchased from a dealer authorized by Fluance. Fluance warrants that each new product, under normal use, is free from defects, subject to the terms and conditions set forth. If a defect should occur within the warranty period, repairs will be made free of charge for parts and labor when such defects are determined by us to be attributable to faulty materials or workmanship at time of manufacture.

Warranty Period

The Fluance products listed below are warranted for parts and labor for the stated period from the date of original purchase and are subject to the terms and conditions of the warranty.

Home Audio Passive Speakers: Lifetime Warranty

Active/Powered Speakers: 2 Year Warranty

HiFi Turntables: 2 Year Warranty

Warranty Exclusions

- Products purchased from a dealer not authorized by Fluance.
- Products with the serial number defaced, altered or missing.
- Defects resulting from disaster, accident, abuse, misuse, lightning, power surges, neglect, unauthorized modification or water damage.
- Defects or damage as a result of repairs performed by a person or party not authorized by Fluance.
- Defects or damage occurring during shipping (claims should be made with the shipping company).
- Defect or damage as a result of connecting a product to an outlet with the incorrect voltage. Voltage converters must be used where applicable.

To Obtain Warranty Service

Should your Fluance product require warranty service, please contact your Fluance Authorized Dealer and send your product fully insured and freight prepaid to the nearest Fluance authorized service center. Before sending to Fluance, you will be required to get a Return Authorization Number from your dealer.

Products shipped without a valid Return Authorization Number will be refused. To avoid possible shipping damage, make sure the product is properly packaged and well protected. Include a copy of your original bill of sale as proof of warranty along with your name, home and/or work telephone number(s), a complete return address and a detailed description of the faults.

Products repaired within warranty will be returned freight prepaid. This warranty in itself is not considered a valid proof of purchase. When applying for warranty repairs, you must present the original copy of your bill of sale as proof of warranty.

FLUANCE®

Serious Performance.

Thank you for your purchase of this Fluance® product.
We hope you enjoy your experience.

Questions?

Givs us a chance to help, wer're just a click away.



[Fluance.com/resources](https://fluance.com/resources)



[Fluance.com/videos](https://fluance.com/videos)



[Fluance.com/support](https://fluance.com/support)



[Fluance.com/contact](https://fluance.com/contact)

Don't forget to register your product with us!

[Fluance.com/registration](https://fluance.com/registration)