



EXPLORE YOUR LIFE

Quick Instructions

Statement

Our company is dedicated to continuously improving our product performance and enhance our product functions.

Pictures and function descriptions contained in the Instruction Manual are subject to the actual product and factory pre-settings. Our company reserves the right to improve the product functions and human-machine interfaces stated in this manual without prior notice.

Please keep your device properly. We will assume no liability for any losses arising from misoperation of software or hardware, repair or other reasons, and any losses incurred to any third party due to leakage of personal information. Also, we will take no responsibility for any unexpected losses possibly incurred during use of this manual, or any third-party claims resulting from use of the product.

The descriptions of product functions have been carefully reviewed and checked by our staff. For errors and omissions that still may exist, we beg your understanding and correction suggestions. To learn more product introductions and value added services, please follow and visit our official website: en.jmgo.com.

Safety Instructions



- Before using the product please read the Instruction Manual carefully and keep it properly for future reference;
- During projection with the product, it is forbidden to block the air inlet or outlet of the product to avoid damage caused by overheating;
- Please prevent the product from falling from height or impact against, which may cause damage to the product;
- To avoid eye injury, DO NOT look straight at the lens of the product;
- If the product has any problem, please contact our professional after-sales personnel instead of attempting to disassemble the product by yourself.



WARNING

WARNING: It is forbidden to disassemble, impact against or squeeze the product or throw it into the fire. In case of serious swelling, DO NOT continue using the product. It is forbidden to use the product if the battery is soaked in water. Avoid placing the product in a high-temperature environment.

EXPLORER

JMGO SMART PROJECTOR

Hi,

Thank you for choosing our JMGO Explorer Smart Portable Theater!

JMGO Explorer, applying a HD projection solution, features smart chip, immersive sound quality, concise appearance design and complete functions. Portable and also suitable for domestic use, it can offer you a visual feast with a huge screen that displays clear, vivid and beautiful pictures anywhere, anytime.

Start Explorer to explore your life: The place where I am is the cinema.

Packing List



	Main Unit
	Remote Control
	Power Adapter
	Instruction Manual
	Warranty Card

- Please check whether the product and accessories received are consistent with the list; if not, please timely contact JMGO Customer Service.

Initial Use



- 1 For initial use, please open the port dust cover on the left side, and insert the adapter;
- 2 You can use the remote control or short press the POWER button on the side to power on the device;
- 3 You can adjust the projection angle by pressing and holding the revolving shaft foot pad and turning the device body.

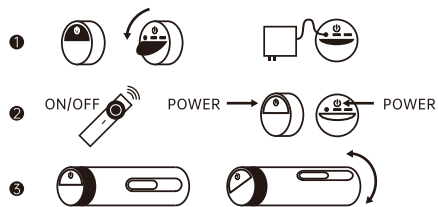

- Prior to initial use, it is suggested to power off the device and fully charge it (3h is needed) so as to ensure the battery can achieve its best performance.

Appearance of Main Unit and Function Descriptions

01

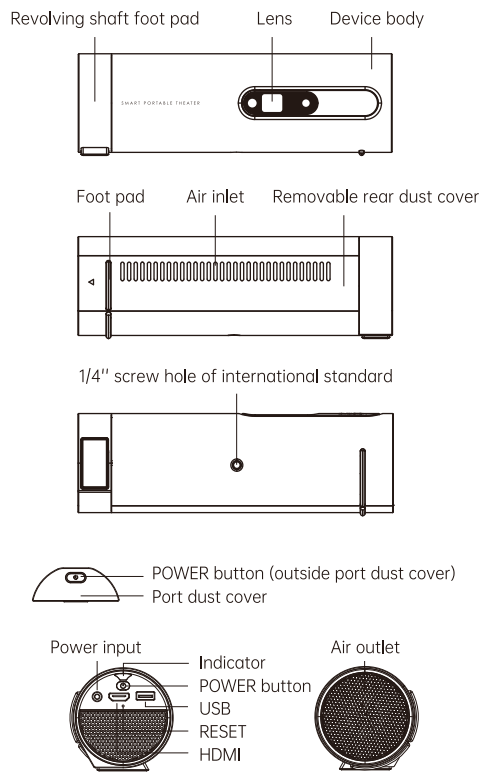

Distance and Projection Size

02

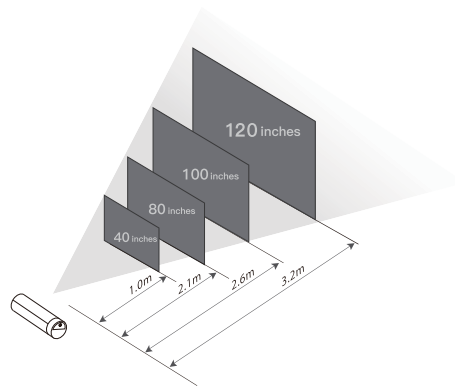

The size of projected images can be affected by the distance between the product lens and the screen, the scale setting and the video format.

The projection area is in direct proportion to the projection distance: the longer the projection distance is, the larger the projection area will be, but the corresponding display sharpness will also be reduced. You can choose a suitable projection distance based on the actual condition.

Distance between product and projection plane	1.0m	2.1m	2.6m	3.2m
Projection size	40"	80"	100"	120"

- The best projection distance of JMGO Explorer is 0.5-3m. If the distance is too long, both the brightness and the sharpness will be reduced, affecting viewing experience.
- Equipped with JMGO curtain will provide you a better viewing experience.

Button and Indicator

03

The device body only has one physical POWER button. You can directly press the POWER mark on the dust cover, or open the dust cover to press the button. With this button, you can power on/off the device or turn on/off the Bluetooth speaker:

- **Short press the button:** Power on/off the device. When the device is successfully powered on, the white indicator light will blink;
- **Long press the button:** Turn on/off the Bluetooth speaker. When the Bluetooth speaker is successfully turned on, the blue indicator light will come on.

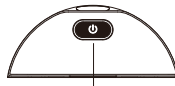

POWER button
(outside port dust cover)

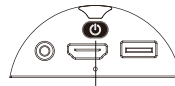

POWER button

The indicator light has three colors: white, blue and red. Different operating states of the device can be indicated by the change of color and light:

- **Charging in power-off state:** The white indicator light blinks during charging and remains on after full charging;
- **Standby mode:** The white indicator light is on
(When the adapter is not inserted, the indicator light will not turn on);
- **Power-on state:** The indicator light does not turn on; the battery level is displayed in the UI interface
- **Bluetooth speaker:** When Bluetooth is connected, the blue light will blink; upon successful connection of Bluetooth; the blue light will remain on;
- **Low battery:** If you attempt to power on the device under low battery condition, the red light will flash to alert you.



Indicator
(effect outside port dust cover)



Indicator

Remote Control

04

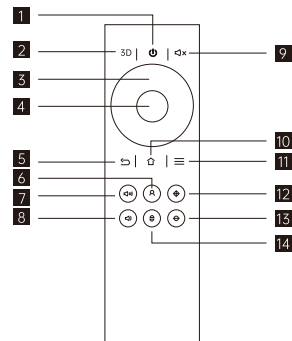

- | | | | |
|-----------|-----------|--------------|---------|
| 1 POWER | 2 3D | 3 ARROW KEYS | |
| 4 OK | 5 BACK | 6 CUSTOM | 7 VOL+ |
| 8 VOL- | 9 MUTE | 10 HOME | 11 MENU |
| 12 FOCUS+ | 13 FOCUS- | 14 JMGO | |

- When you use the remote control, there should be no obstacle between the remote control and the JMGO product; The best control experience is when the monitor directly faces the device, please do not use it with an ultra tilting angle.

Focus Adjustment

05

Explorer supports real-time autofocus. You can also use the FOCUS+/- key on the remote control to perform manual focusing so that the projected screen can reach its best sharpness.

Auto focus Setup;

- For first time use, the Autofocus function is OFF by default. To turn ON this function, you need to enter. Please follow the instructions below to turn on Auto-focus function:

Setting > Projection > Auto Focus

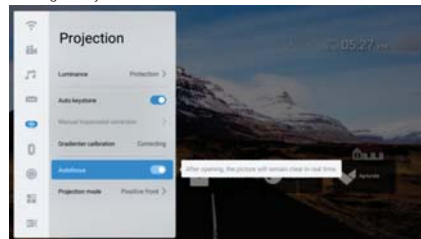

- You can also long press the JMGO key  on the remote control to trigger autofocus.
- Once the projector is moved, the internal gravity sensor will be triggered, it will automatically adjust the focus to make sure the screen clear all the time)

Manual Focus Setup:

The criteria for judging the sharpness of projected screen may vary with the personal visual impression.

You can use the FOCUS+/- key on the remote control to slightly correct and achieve the best viewing effect of projected screen.



Keystone Correction

06

Explorer supports auto vertical keystone correction. When the projection angle is within $\pm 40^\circ$, the correction function can be triggered, or you can carry out manual correction as needed.

- For first time use, the auto keystone correction is OFF by default. To turn ON this function, please follow the instructions below to turn on it)

Setting > Projection > Auto Keystone Correction

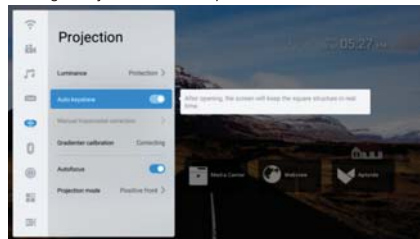

Custom Correction Setup:

Besides, Explorer also supports custom correction. You can adjust the four corners of the screen according to actual needs:"

Setting > Projection > Manual Keystone Correction

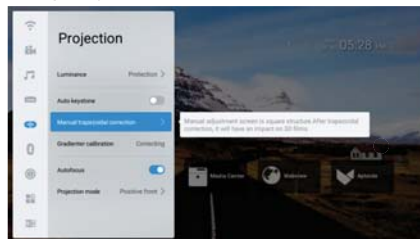

3D Playback

07

Explorer supports playback of 3D films. To play a 3D film, you can gently press the 3D key on the remote control in the Video Playback interface to call the shortcut menu where the 3D film mode can be set.

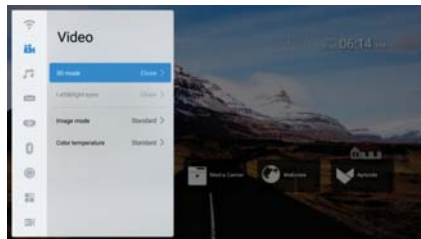

- Remark: The 3D function is unavailable during lateral projection.

Network Settings

08

This product supports connection to WiFi network:
(This device can be connected to the Internet via a wireless (Wi-Fi) connection. Please follow the instructions below:

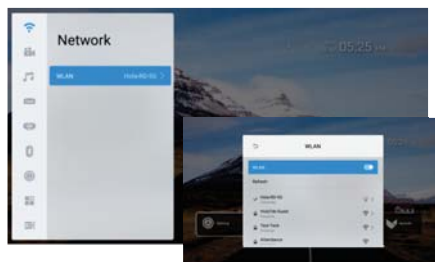

Enter **Setting > Network > WLAN > Turn on WLAN**; select an available network for WiFi connection.

Bluetooth Speaker

09

In power-off state, Explorer can be used as an independent Bluetooth speaker. In this case, you can play music by connecting the projector via Bluetooth. Here are the steps:

- **Enable Bluetooth Function:** In power-off state, long press the POWER button on the device body or press OK on the remote control to enable Bluetooth function of the device; you can search for Bluetooth devices that can be connected;
- **Bluetooth Connection:** Find "JMGO" in the device list, and carry out pairing;
- **Successful Connection:** When the blue indicator light remains on after blinking, it indicates pairing is successful, and you can play music;
- **Exit:** In Bluetooth connection mode, long press the POWER button on the device body or press OK on the remote control to disable the Bluetooth speaker function of the device.

System Version

10

You can enter **Setting > System > About the Machine** to view its current system information of the current main unit.



System Upgrade

11

This product supports online upgrade and local upgrade simultaneously:

Online Upgrade: Enter Setting > System > System Upgrade. At this moment, the system will automatically detect whether the software is in its latest version. If the current system is the latest version, the system will give you a prompt; if not, the system will ask you whether you want to do upgrade immediately:

- **Remark:** The JMGO Smart Portable Theater will continuously provide online upgrade maintenance. It is possible that system upgrade service is pushed online without prior notice in order to provide the latest software system and service content for your device.

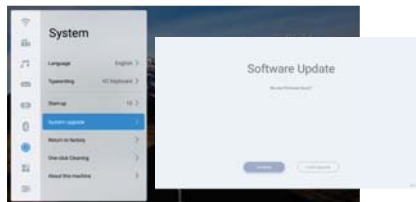

Local Upgrade: You can also download software upgrade package from the JMGO official website, copy it to the root directory in your mobile hard disk drive or USB flash drive, and insert the mobile hard disk drive or USB flash drive to the USB port. Enter Setting > System > System Upgrade > Local Upgrade. Click Local Upgrade; the system will automatically detect the upgrade package, and then carry out installation and upgrade.

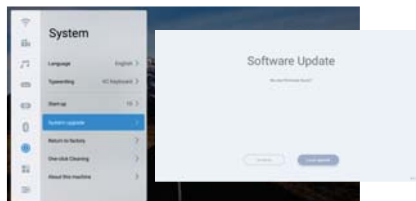

Remark: DO NOT pull out the USB flash drive or disconnect the power supply during upgrade.

Peripherals Connection

12

Explorer supports connection with various peripherals to provide more possibilities. Via the HDMI and USB ports, you can connect PC, speaker, game machine, USB flash drive and other devices with Explorer.



Switch Video Source

13

Explorer can project external audio and video sources. When an external source is input to the JMGO device via HDMI port, short press the JMGO key on the remote control to call the Shortcut menu, or click Setting > Signal Source – Source to enter the Setup interface. In this interface, you can select and switch the desired source. After switching, the device can be connected to the peripheral external equipment and project relevant content.

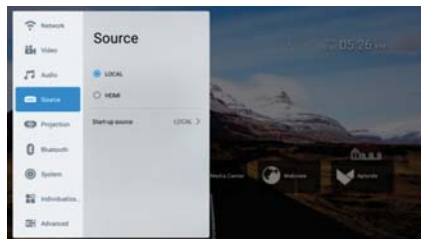

Download and Installation of "JMGO Fun Control"

14

This product supports control by mobile phone. Simply scan the QR code below to download and install the "JMGO Fun Control" app, then your mobile phone can be used as a remote control to easily operate the device.

JMGO Fun Control supports both Android and iOS devices.



Removing and Cleaning of Rear Dust Cover 15

You can regularly remove the rear dust cover of Explorer for cleaning, so as to maintain the performance and prolong the lifespan of the device.

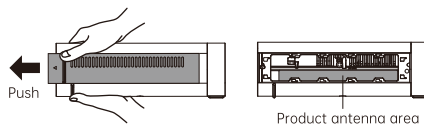

Removal: Push the foot pad in the direction marked on the rear cover to remove the rear cover.

Reinstallation: You can push the rear cover back to its home original position by aligning it with the slot position on the device body.

Note: In order not to affect use of the product, when you remove the dust cover, please do not remove the antenna of the device.

Remark: During reinstallation, you may need to press the middle part of the dust cover to align it with the slot position.

Environmental Protection Instructions 16

The environment-friendly use period (EFUP) mark indicates that the EFUP of this product is 10 years. During the period of 10 years, the traces of toxic or hazardous substances or elements contained in the product will not leak or mutate, or cause serious environmental pollution, or severe personal injury or property damage if the product is used normally.

Names and Contents of the Traces of Toxic or Hazardous Substances or Elements Contained in Each Part of the product.

Part Name	Toxic or Hazardous Substance or Element					
	Lead (Pb)	Mercury (Hg)	Cadmium (Cd)	Hexavalent Chromium (Cr(VI))	Polychlorinated Biphenyls (PCB)	Polychlorinated Dibenzodioxins (PCDD)
Battery	X	O	O	O	O	O
Recharge Control	X	O	O	O	O	O
Wires	O	O	O	O	O	O
Adapters	X	O	O	O	O	O
Packaging Material	O	O	O	O	O	O

O indicates that the content of this toxic or hazardous substance in all homogeneous materials of the corresponding part is below the limit specified in GB/T 26572-2011.
X indicates that the content of this toxic or hazardous substance in certain homogeneous material of the corresponding part is above the limit specified in GB/T 26572-2011 but conforms to the environmental requirements of the RoHS directive, and currently no mature substitute is available in the industry.

Suggestions for Use



DO NOT place the product under following environment:

that is damp, dusty or smoky; otherwise, the optical element will be contaminated, the service life of the product will be shortened and the images will be dimmed;

near fire sources;

that is poor-ventilated or where the space is narrow; keep the device at least 50cm from the wall;

where the temperature exceeds 35°C;

where the altitude is above 3000m.



One More Thing,

Your experience is very important to us!

You can contact us to offer valuable advices and suggestions.

Your opinions and suggestions are priceless to us.

Thank you again for choosing JMGO Explorer!

After-sales Service E-mail: after-sales@jmgo.com

EXPLORE YOUR LIFE

FCC Requirement

Changes or modifications not expressly approved by the party responsible for compliance could void the user's authority to operate the equipment.

This device complies with Part 15 of the FCC Rules. Operation is subject to the following two conditions:

- (1) this device may not cause harmful interference, and
- (2) this device must accept any interference received, including interference that may cause undesired operation.

Note: This equipment has been tested and found to comply with the limits for a Class B digital device, pursuant to Part 15 of the FCC Rules. These limits are designed to provide reasonable protection against harmful interference in a residential installation. This equipment generates, uses, and can radiate radio frequency energy, and if not installed and used in accordance with the instructions, may cause harmful interference to radio communications. However, there is no guarantee that interference will not occur in a particular installation. If this equipment does cause harmful interference to radio or television reception, which can be determined by turning the equipment off and on, the user is encouraged to try to correct the interference by one or more of the following measures:

- Reorient or relocate the receiving antenna.
- Increase the separation between the equipment and receiver.
- Connect the equipment into an outlet on a circuit different from that to which the receiver is connected.
- Consult the dealer or an experienced radio/TV technician for help.

This equipment complies with FCC radiation exposure limits set forth for an uncontrolled environment. This equipment should be installed and operated with a minimum distance of 20cm between the radiator & your body. This transmitter must not be co-located or operating in conjunction with any other antenna or transmitter.