

8 7 6 5 4 3 2 1

REVISIONS		
REV	DESCRIPTION	DATE
A00	ORIGINATED	02/10/09

NOTES: UNLESS OTHERWISE SPECIFIED

- 1) MATERIAL: 2 mil Gloss White Polyester (Thermal Transfer) base w/
2 mil Acrylic Adhesive UL recognized and CA certified for outdoor use that will not rub off under a 50% alcohol/water solution or equivalent process. Able to withstand outside exposure to -40C, rain and direct sunlight
- 2) Thermal Transfer printing: Resin ribbon or equivalent, Black
- 3) Font: Arial / Size: 8pt
- 4) Dimensions: 2.00 wide by .75 high

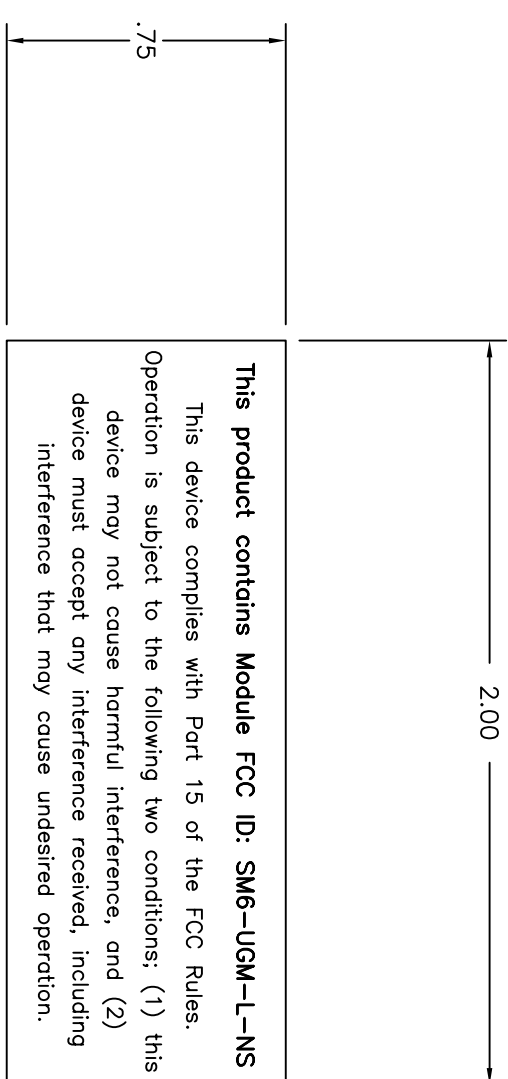

DWG file: 130-0011-005_A00

UNLESS OTHERWISE SPECIFIED, ALL DIMENSIONS ARE IN INCHES OR IN [MILLIMETERS]

TOLERANCES	
DECIMALS	ANGLES
X ± .03	± 1/2°
.XX ± .01	
.XXX ± .005	

APPROVALS	DATE
DRAWN BY: MFM	02/10/09
CHECKED BY:	
APPROVED BY:	
APPROVED BY:	

ARKION CONFIDENTIAL

THIS DRAWING CONTAINS INFORMATION OF A CONFIDENTIAL AND/OR PROPRIETARY NATURE. IT IS NOT TO BE REPRODUCED, COPIED, DISSEMINATED, OR OTHERWISE MADE PUBLIC IN ANY MANNER WITHOUT THE EXPRESS WRITTEN CONSENT OF ARKION.

Arkion Systems

FCC PART 15 ID LABEL
SmartMeter-L-NS

SIZE	PART NO.	REV.
D	130-0011-005	A00

SCALE 1:1 DO NOT SCALE DRAWING SHEET 1 OF 1

8 7 6 5 4 3 2 1

REVISIONS			
REV	DESCRIPTION	DATE	APPROVED
A00	ORIGINATED	02/10/09	

- NOTES: UNLESS OTHERWISE SPECIFIED**
- 1) Label stock: 121-0004-001 or equivalent Polyester Stock
 - 2) Font: Arial / Size: 8pt / Color: BLACK
 - 3) Dimensions: 1.00 wide by .25 high

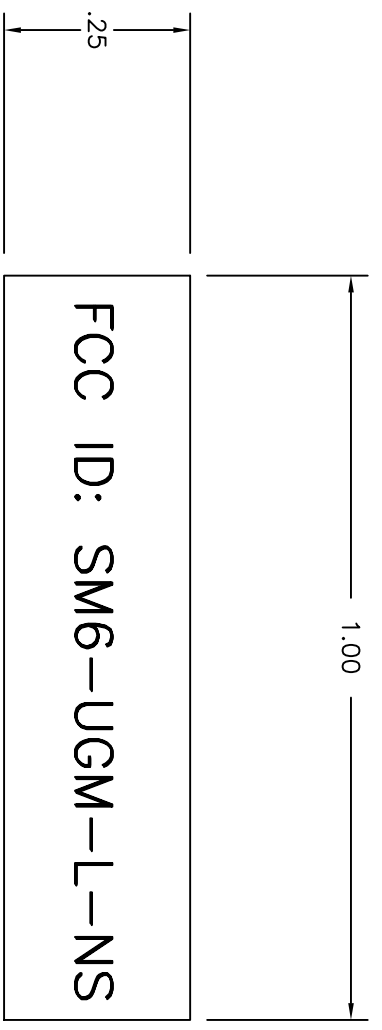

DWG file: 130-0012-005_A00

UNLESS OTHERWISE SPECIFIED, ALL DIMENSIONS ARE IN INCHES OR IN MILLIMETERS

TOLERANCES

DECIMALS	ANGLES
X ± .03	± 1/2°
.XX ± .01	
.XXX ± .005	

MATERIAL	
FINISH	

APPROVALS	DATE
DRAWN BY: MFM	02/10/09
CHECKED BY:	
APPROVED BY:	
APPROVED BY:	

SIZE	PART NO.	REV.
D	130-0012-005	A00
SCALE 1:1	DO NOT SCALE DRAWING	SHEET 1 OF 1

Arkion Systems

TITLE

FCC PART 15 ID LABEL
UGM-L-NS MODULE

ARKION CONFIDENTIAL

THIS DRAWING CONTAINS INFORMATION OF A CONFIDENTIAL AND/OR PROPRIETARY NATURE. IT IS NOT TO BE REPRODUCED, COPIED, DISCLOSED, USED, OR DISCLOSED TO OR FOR THE BENEFIT OF ANY OTHER PERSON OR ENTITY WITHOUT THE EXPRESS WRITTEN CONSENT OF ARKION.

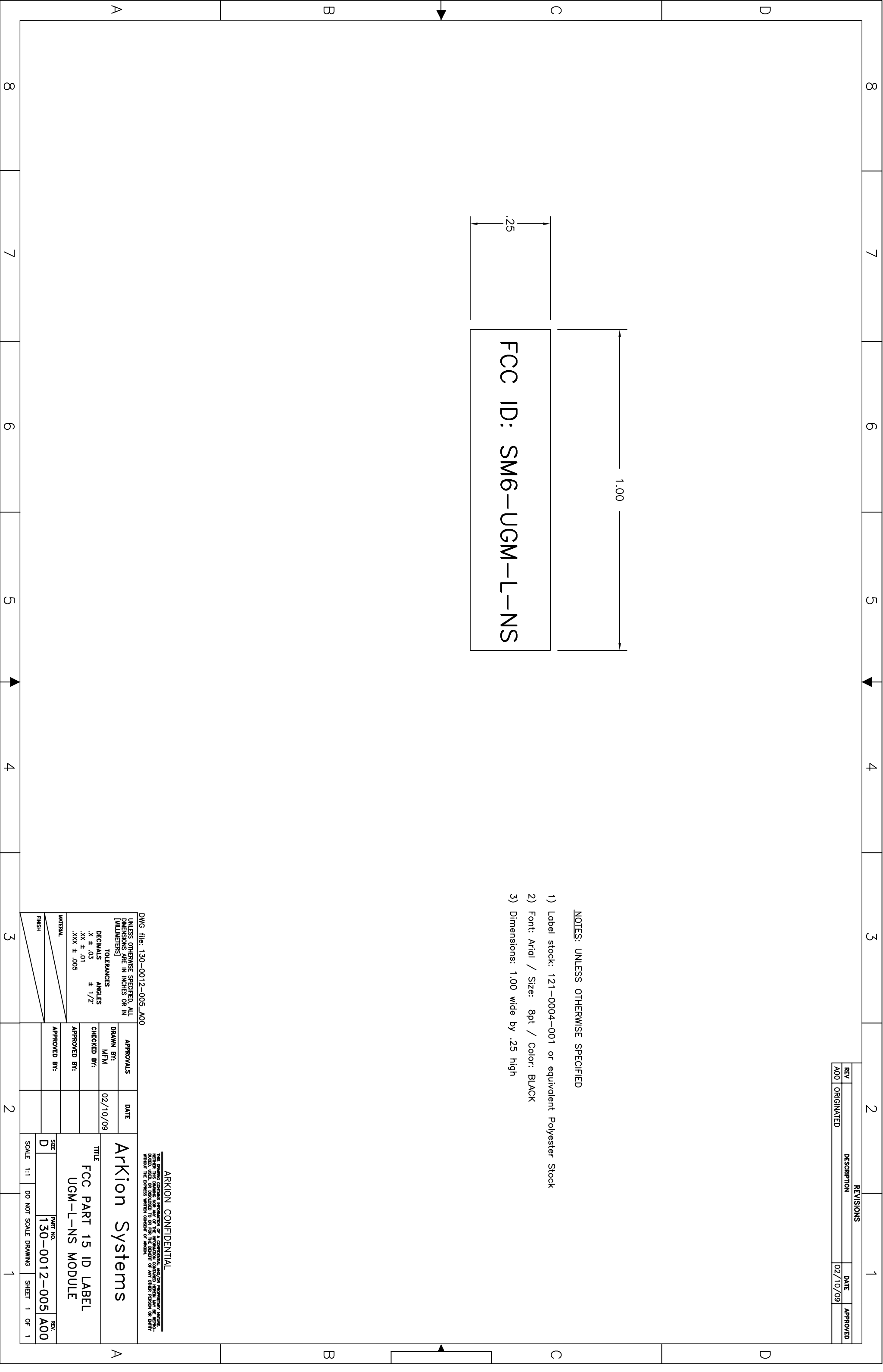

REVISIONS			
REV.	DESCRIPTION	DATE	APPROVED
G00	RELEASED PER ECN0800025	03/25/08	
G01	REVISED PER ECN0800028	05/19/08	
G02	REVISED PER ECN0800032	06/30/08	
G03	REVISED PER ECN0800040	12/03/08	
G04	REVISED PER ECN0800043	12/17/08	
G05	REVISED PER ECN0900004	02/06/09	

NOTES: UNLESS OTHERWISE SPECIFIED

- 1) THIS IS A STATIC SENSITIVE ASSEMBLY - USE STATIC ELIMINATING MEASURES DURING ASSEMBLY AND HANDLING.
- 2) MANUFACTURE TO IPC 610A CLASS 2 WORKMANSHIP STANDARDS.
- 3) COMPONENT HEIGHT MUST NOT EXCEED .xxx ON SOLDER SIDE OF PWA.
- 4) APPLY LABEL WITH THE 800- LEVEL PART NUMBER/REVISION AND SERIAL NUMBER/DATE CODE IN THE APPROX AREAS SHOWN.
- 5) MASK MOUNTING HOLES ~~EXCEPT FOR HOLES FOR THE SHIELD FENCE~~ PRE-WAVE TO PREVENT SOLDER BUILD UP ON GROUND PADS.
- 6) ~~THE POWER SUPPLY (PS1) MOUNTED ON THE SOLDER SIDE MUST BE TUNED PER THE REFERENCED TUNING INSTRUCTIONS BEFORE INSTALLATION.~~
- 7) ~~SHIELD FENCE INSTALLATION (INSTALLED POST-FMT):~~
 LINE UP THE TABS OF THE UP SHIELD FENCE (ITEM 7) WITH THE HOLES IN THAT SECTION ON THE TOP SIDE. INSERT INTO THE HOLES AND SOLDER DOWN IN PLACE. TACK ONLY IN THE CORNERS AND THE MIDDLE OF THE UP SHIELD FENCE.
- 8) ~~LINE UP THE TABS OF THE RF214 FENCE (ITEM 5) WITH THE HOLES ON THE BOARD. INSERT AND APPLY A SUFFICIENT AMOUNT OF SOLDER ALL AROUND THE EXPOSED EDGES UNDER THE SHIELD ON THE BOARD TO SECURE IT DOWN IN PLACE.~~
- 9) ~~SEE SHEET 5 FOR THE SHIELD COVER INSTALLATION INSTRUCTIONS.~~
- 10) APPLY LABEL (ITEM 7) WITH THE FCC PART 15 ID NUMBER IN THE APPROX AREA SHOWN.

TABLE OF RESERVED SHEETS		
SHEET	DESCRIPTION	EXIST
1	PWA COMPONENT SIDE	YES
2	PWA SOLDER SIDE	YES
3	COMPONENT SIDE REWORK	NO
4	SOLDER SIDE REWORK	NO
5	SHIELD INSTALLATION=NA	NO

FOR PRODUCT STRUCTURE SEE 800-0024-016

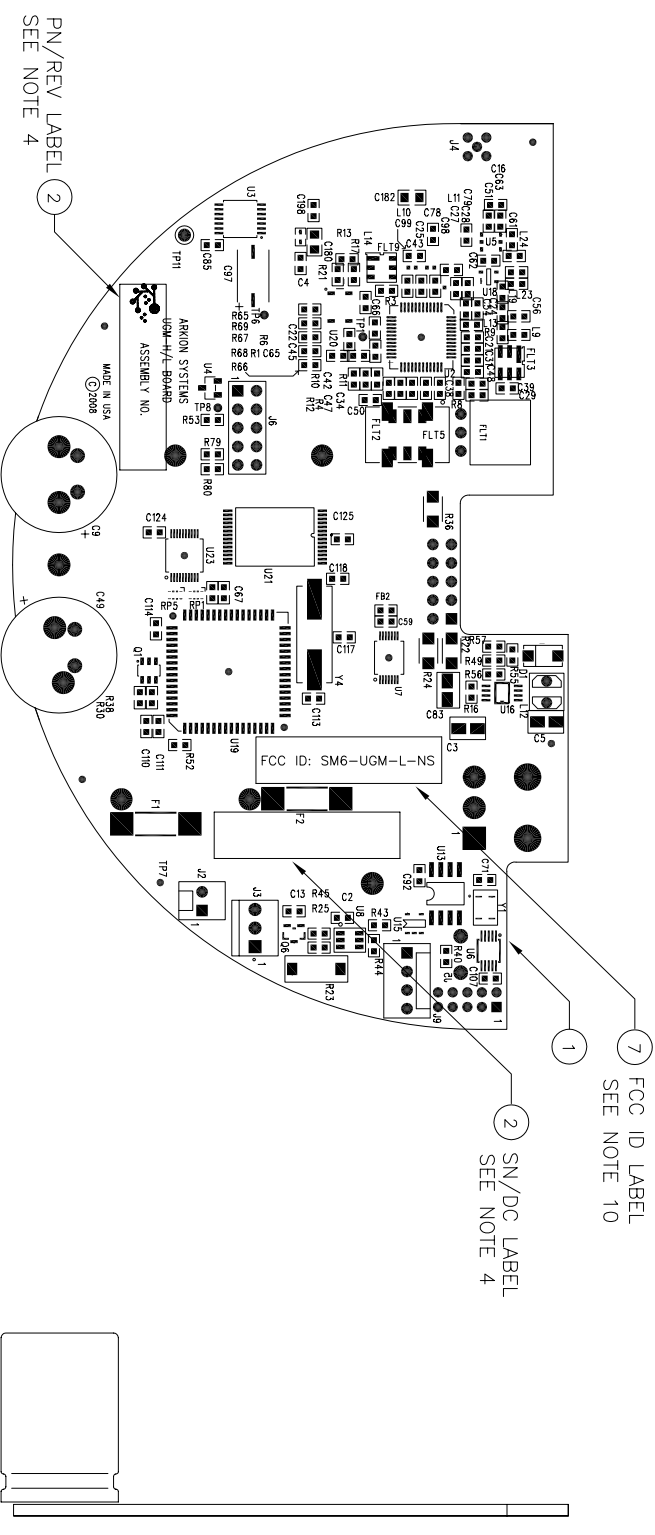

COMPONENT SIDE

DWG file: 850-0024-016-1_G05

UNLESS OTHERWISE SPECIFIED, ALL DIMENSIONS ARE IN INCHES OR IN [MILLIMETERS]

TOLERANCES
 DECIMALS ANGLES
 .X ± .03 ± 1/2°
 .XX ± .01
 .XXX ± .005

APPROVALS		DATE	TITLE	
DRAWN BY:	M/TM	03/25/08	Arktion Systems	
CHECKED BY:			DWG ASSEMBLY UGM-L	
APPROVED BY:			(WITHOUT WATER INTERFACE)	
MATERIAL			SIZE	PART NO.
FINISH			D	850-0024-016 G05
			SCALE: NONE	DO NOT SCALE DRAWING
			SHEET 1	OF 4

ARKION CONFIDENTIAL
 THIS DRAWING CONTAINS INFORMATION OF A CONFIDENTIAL AND/OR PROPRIETARY NATURE. NEITHER THIS DRAWING NOR ANY OF THE INFORMATION CONTAINED HEREIN MAY BE REPRODUCED, COPIED, OR DISCLOSED TO OR FOR THE BENEFIT OF ANY OTHER PERSON OR ENTITY WITHOUT THE EXPRESS WRITTEN CONSENT OF ARKION.

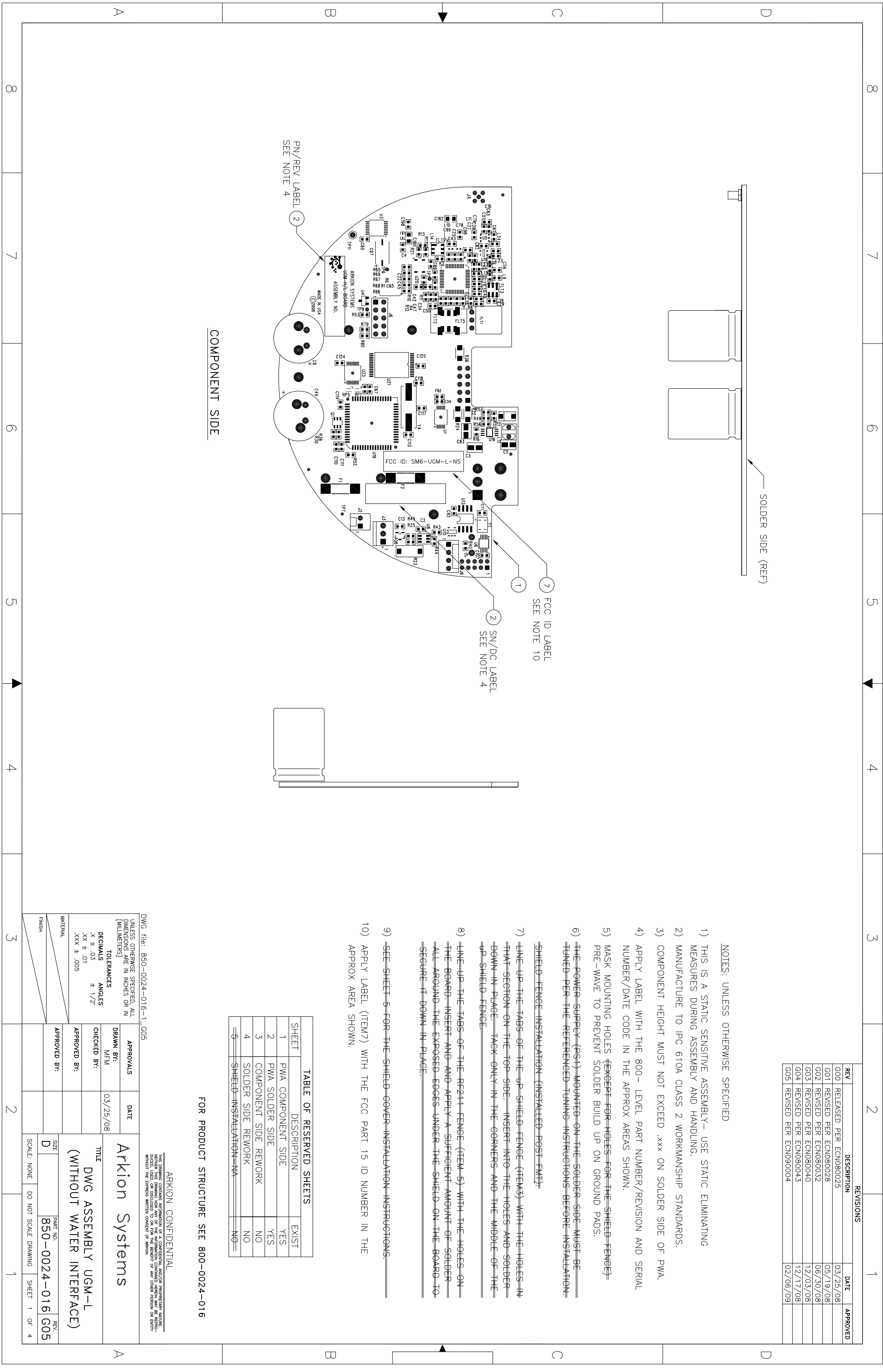

REVISIONS			
REV	DESCRIPTION	DATE	APPROVED
1	SEE SHEET 1 FOR REVISIONS		

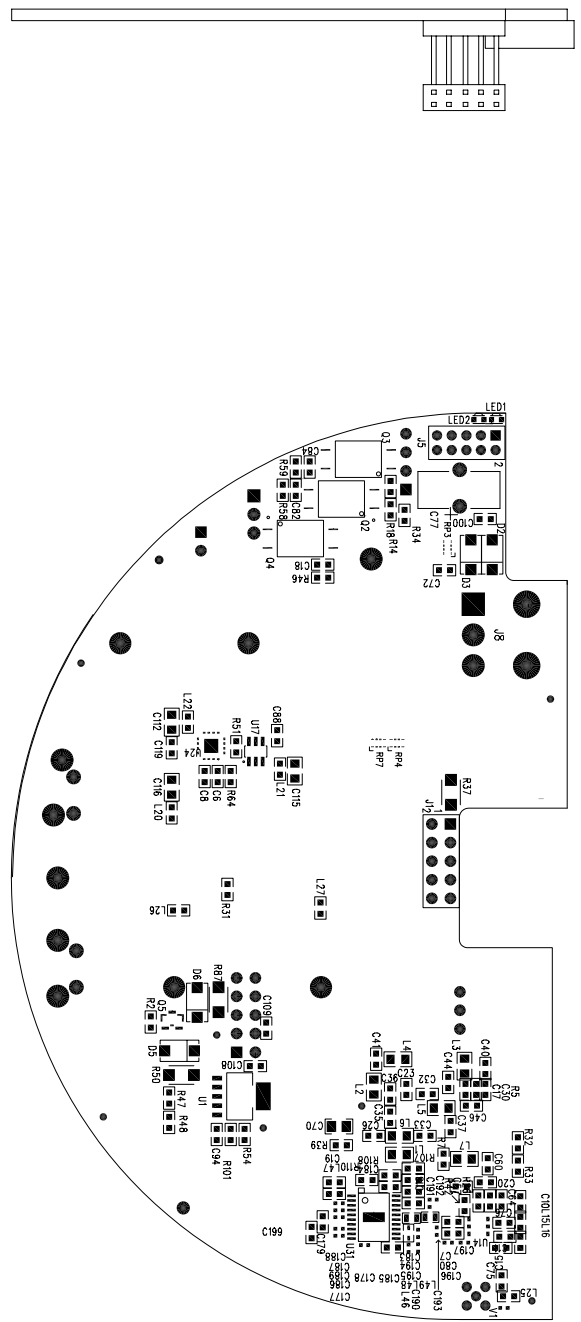
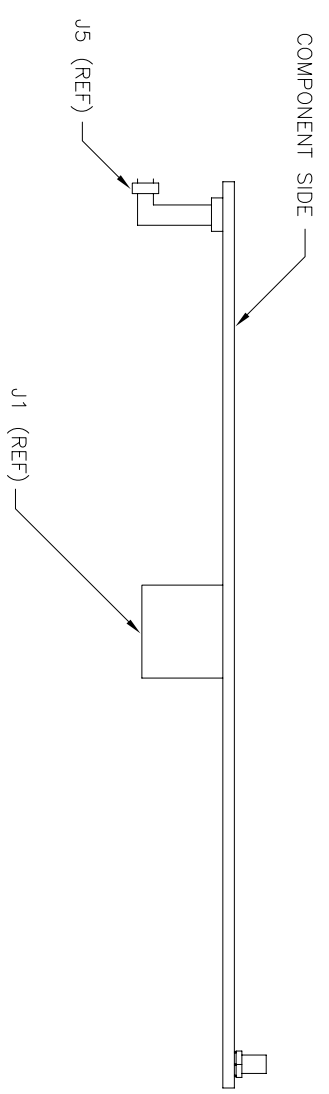

MUELLER TECH CONFIDENTIAL

THIS DRAWING CONTAINS INFORMATION OF A CONFIDENTIAL AND/OR PROPRIETARY NATURE. IT IS NOT TO BE REPRODUCED, COPIED, DISCLOSED, OR USED IN ANY MANNER WITHOUT THE EXPRESS WRITTEN CONSENT OF MUELLER TECH.

DWG file: 850-0024-016-2_G05

SIZE	PART NO.	REV.
D	850-0024-016	G05
SCALE 1:1	DO NOT SCALE DRAWING	SHEET 2 OF 4