

NOTES:

1. SPLIT BALLOONS CONTAIN ITEM NUMBER IN THE TOP PORTION AND QUANTITY IN THE BOTTOM PORTION.

2. ALIGN TAB ON EMBLEM WITH SLOT IN EMBLEM RECESS.
CENTER EMBLEM WITHIN CIRCULAR EMBLEM RECESS.

3. PRODUCT LABEL AND ALIGNMENT LABELS MUST BE INSTALLED PRIOR TO INSTALLING BRACKET ONTO UNIT.
CENTER ALIGNMENT INDICATOR LABEL BETWEEN TWO VERTICAL RIBS ON BRACKET,
DO NOT OVERLAP TOP OR BOTTOM EDGE OF BRACKET.

4. BRACKET REMOVAL LABEL ARROW MUST BE ALIGNED WITH RIB AS SHOWN.
DO NOT OVERLAP TOP OR BOTTOM EDGE OF BRACKET.

5. ALIGN BRACKET AS SHOWN AND TWIST CLOCKWISE TO LOCK IN PLACE.

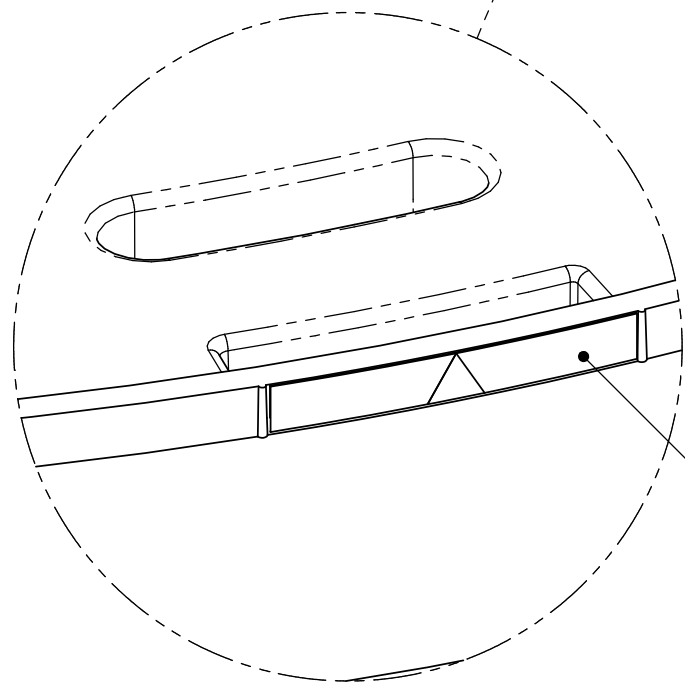
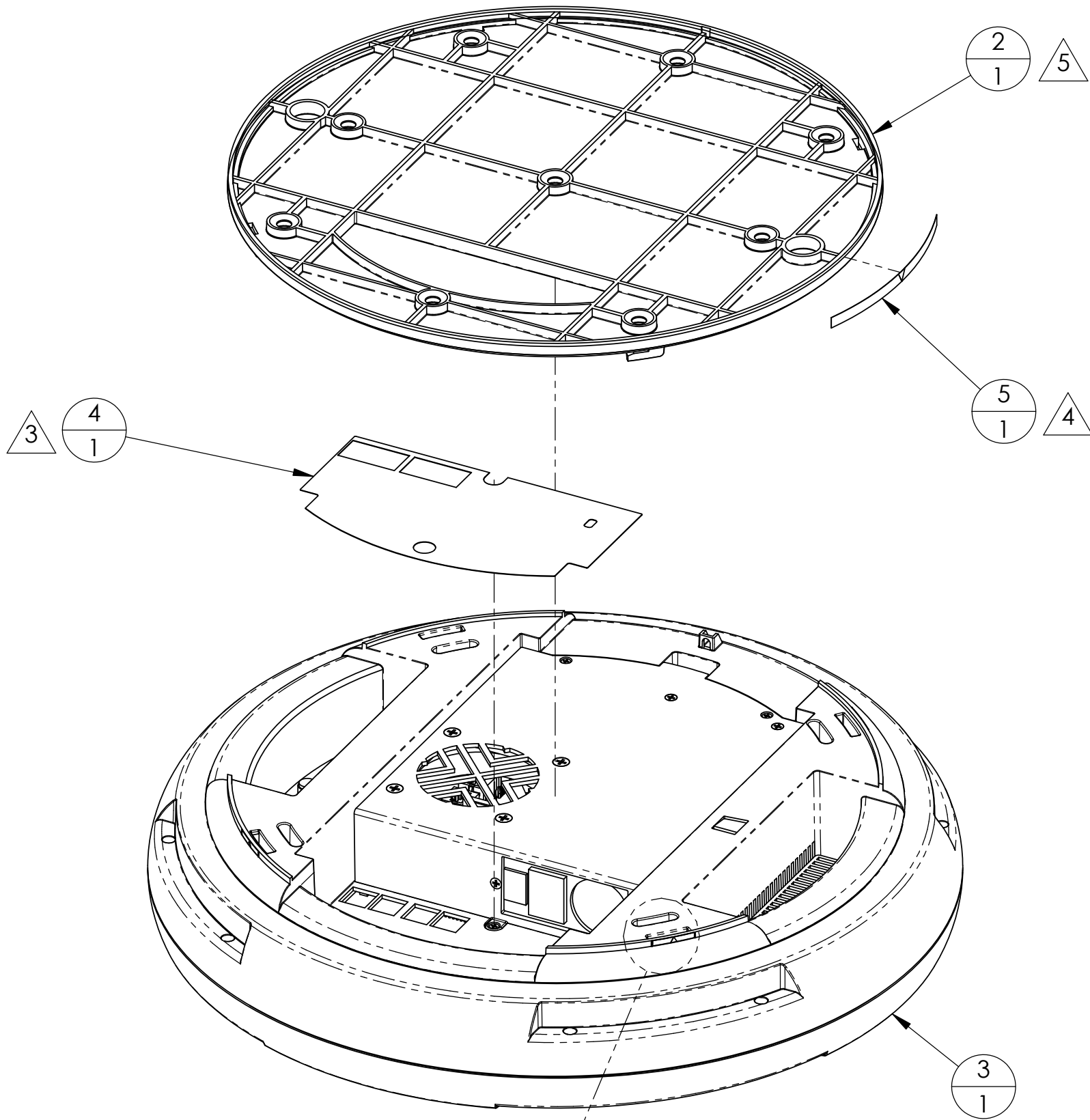
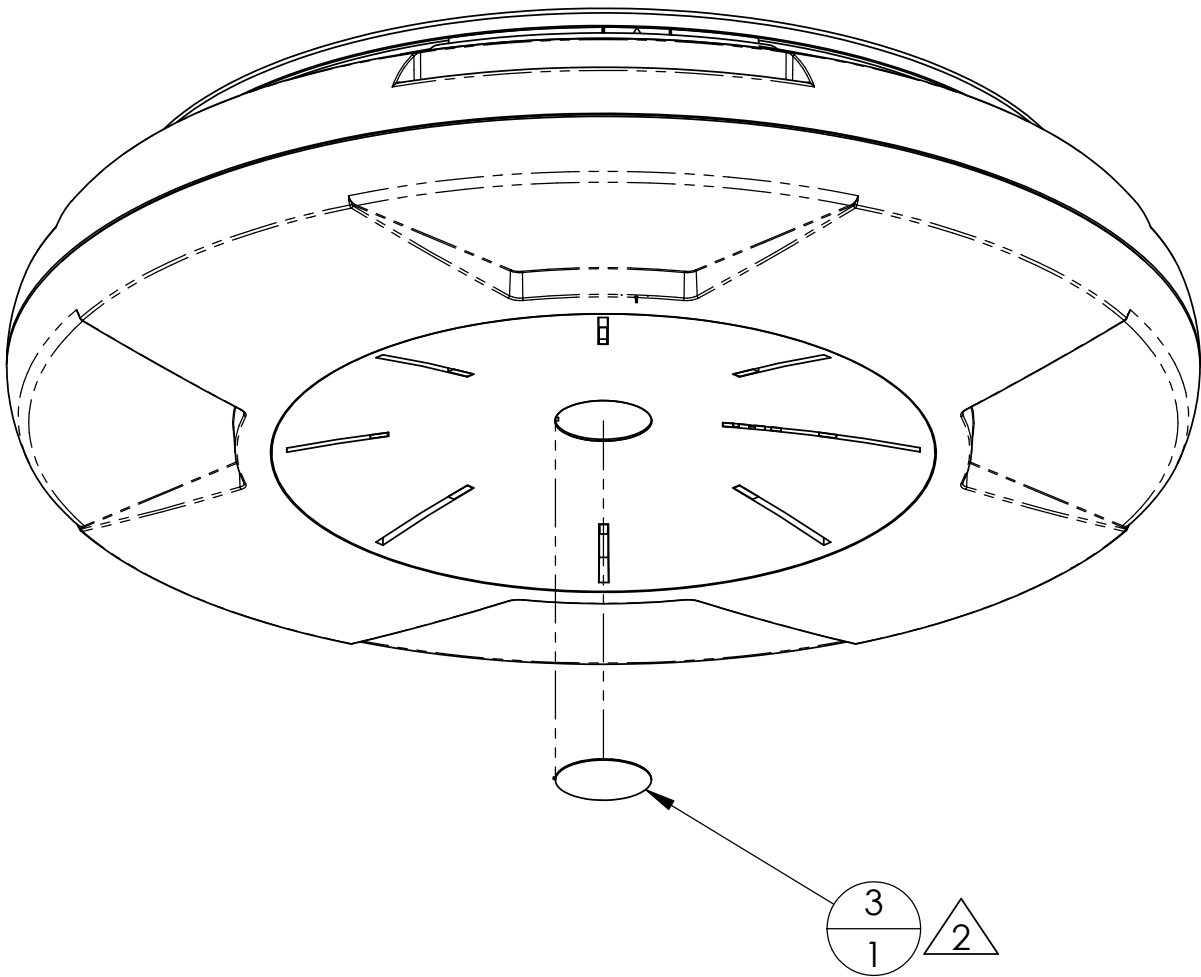

DETAIL D
SCALE 2 : 1
TYP, 4 PLACES, RADially

PROPRIETARY AND CONFIDENTIAL
THE INFORMATION CONTAINED IN THIS
DRAWING IS THE SOLE PROPERTY OF
XIRRUS. ANY REPRODUCTION IN PART
OR AS A WHOLE WITHOUT THE WRITTEN
PERMISSION OF XIRRUS IS PROHIBITED.

3		2		1	
ZONE		REV.	DESCRIPTION	DATE	APPROVED
		A	INITIAL RELEASE	2/2/2005	C. LEONARD I.LAITY

6	830-0014-001	XS3900,LABEL, ALIGNMENT INDICATOR	4
5	830-0013-001	XS3900,LABEL, BRACKET REMOVAL	1
4	830-0002-002	LABEL PRODUCT, XS3900-8	1
3	170-0001-002	TLA,XS3900-8, UNLABELED	1
2	220-0001-001	BRACKET, MOUNTING	1
1	830-0006-001	EMBLEM, 1.5, XS3900	1
ITEM NO.	PART NO.	DESCRIPTION	QTY

UNLESS OTHERWISE SPECIFIED:		NAME	DATE	<div><div>XIRRUS</div><div>370 North Westlake Blvd. Suite 200 Westlake Village, California 91362</div></div> <div>TITLE:</div> <div>TLA,XS3900-8,LABELED</div> <div><div><div>SIZE</div><div>DWG. NO.</div><div>REV</div></div><div><div>C</div><div>185-0001-002</div><div>A</div></div><div><div>PART NO. 180-0001-002</div></div></div> <div><div>SCALE: 1:3</div><div>SHEET 1 OF 1</div></div>
DIMENSIONS ARE IN INCHES		DRAWN	C. LEONARD	
TOLERANCES:		CHECKED	I. LAITY	
FRACTIONAL: ± 1/4"		ENG APPR.		
ANGULAR: MACH ± 1/4°		MFG APPR.		
BEND ± 1/4°		Q.A.		
TWO PLACE DECIMAL ± .015		COMMENTS:		
THREE PLACE DECIMAL ± .005				
INTERPRET GEOMETRIC TOLERANCING PER ASME Y14.5M				
MATERIAL				
FINISH				
DO NOT SCALE DRAWING				