

## start guide

part 1	
<b>introduction to the model 01</b>	<b>02</b>
part 2	
<b>powering up</b>	<b>04</b>
part 3	
<b>using the thumb keyboard and TrackStik</b>	<b>06</b>
part 4	
<b>using the digital pen and thumbwheel</b>	<b>08</b>
part 5	
<b>using the docking cable and desktop stand</b>	<b>10</b>
part 6	
<b>connecting to a network</b>	<b>12</b>
part 7	
<b>installing software and copying files</b>	<b>14</b>
part 8	
<b>product support</b>	<b>16</b>

## introduction to the model 01

Welcome to the OQO model 01 ultra personal computer (uPC). The model 01 is a complete, full-featured computer. Docked at your desk it is a normal PC. Undock it and have instant access to all your applications and data, wherever you go.

You can use the model 01 as a handheld computer with its own thumb keyboard, TrackStik<sup>®</sup>, thumbwheel, and digital pen. You can also use it as a desktop computer by connecting it to an external monitor, keyboard, and mouse. When in transit, simply slip the model 01 into your pocket, briefcase, or bag.

Because the model 01 uses the Microsoft<sup>®</sup> Windows<sup>®</sup> XP operating system, you can use it with all your favorite software applications and seamlessly integrate with existing networks via Ethernet, WiFi, or Bluetooth<sup>®</sup>.

This guide provides quick instructions for setting up and learning to operate your model 01. To locate more detailed instructions, see "online documentation" on page 18.

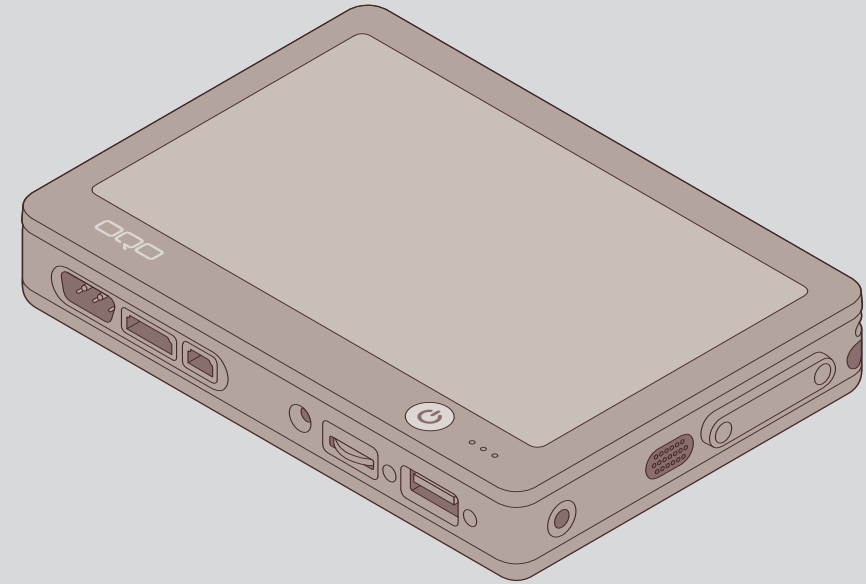

Your model 01 arrives with the battery attached. The first time you use the model 01, you must connect the power supply in order to power the computer and charge the battery. Connect the power supply to the model 01 as shown at right, then plug it into an outlet.

The battery is charging whenever the computer is connected to an outlet through the power supply, regardless of whether the computer is turned on or off. The battery fuel gauge is located on the back of the battery. While the model 01 is charging, the battery fuel gauge lights flash in sequence.

When the battery is not charging, the battery fuel gauge lights are unlit. To check the battery power level, push the battery fuel gauge button on the back of the battery.

## powering up

During normal use, the fully-charged battery can provide about three hours of operating time. (For more information about maximizing battery life, see <http://www.oqo.com/support/batterylife>).

To turn on your model 01, press the power button. The first time you do this, you must set up Windows XP. See the *Start Here* guide for Windows XP, included with your computer.

- a Power supply
- b Battery
- c Battery fuel gauge button
- d Power button

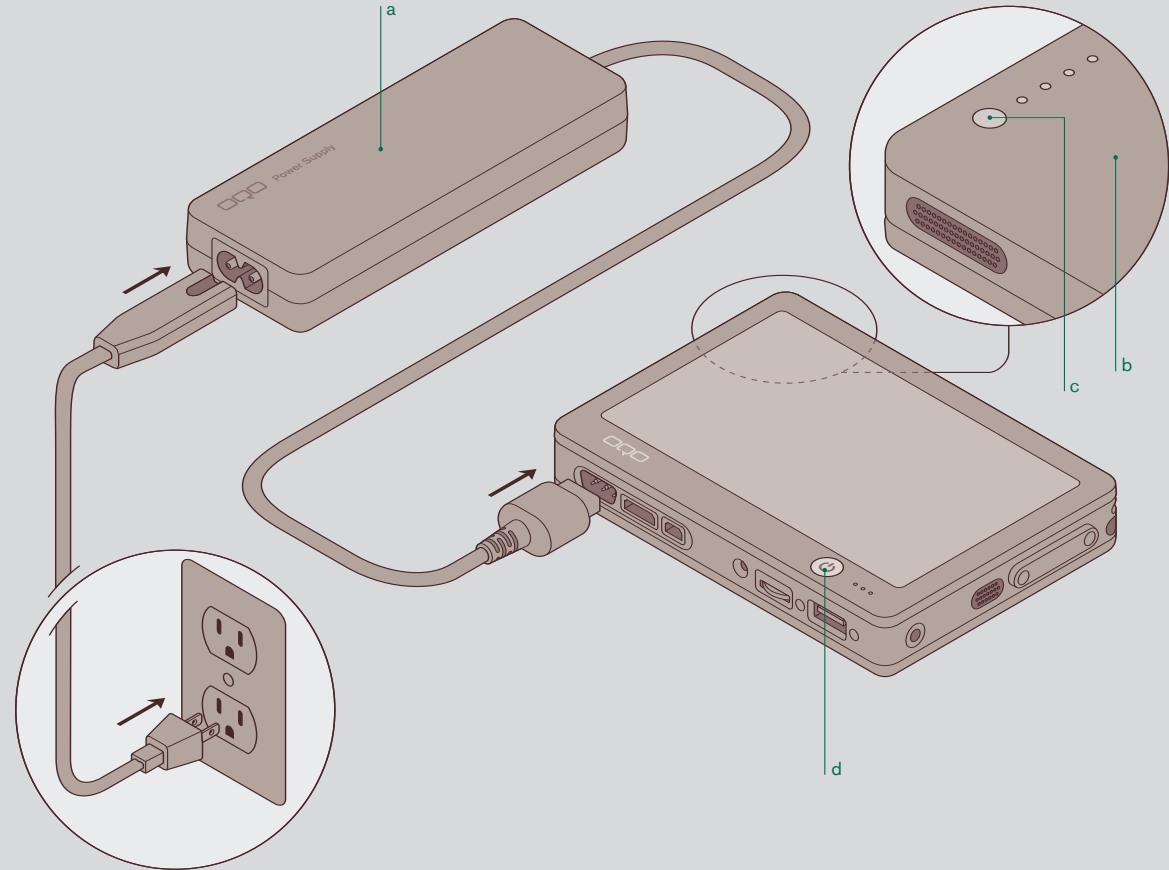

## using the thumb keyboard and TrackStik

When using your model 01 as a standalone handheld computer, you can use the thumb keyboard and TrackStik for input.

Slide the screen upward to reveal the keyboard. The mouse buttons are located on the left edge of the keyboard. The keyboard is designed to be operated with your thumbs. Move the TrackStik with your thumb to control the mouse pointer. Use the left mouse button to left-click and the right mouse button to right-click.

You can also connect an external keyboard and mouse to the model 01 via a USB port, Bluetooth, or the OQO docking cable. See "using the docking cable and desktop stand" on page 10.

Unlike on a regular keyboard, the shift (SHIFT), function (FN), control (CTL), and alt (ALT) keys are all sticky. Press once and the LED next to it will flash, and the next key you

hit will be affected. Press it twice to lock it and the LED will be on. All subsequent keys will be affected until you hit it again to unlock and the LED turns off.

Here are a few examples of operations using sticky keys:

- To activate caps lock, press the SHIFT key twice.
- To deactivate caps lock, press the SHIFT key a third time.
- To activate the Task Manager, press FN-CTL-ALT-BSP.
- To switch to an external display, press FN-L.
- To turn WiFi on and off, press FN-".

- a** Left mouse button
- b** Right mouse button
- c** Sticky keys
- d** ENTER key
- e** TrackStik
- f** Numeric keypad

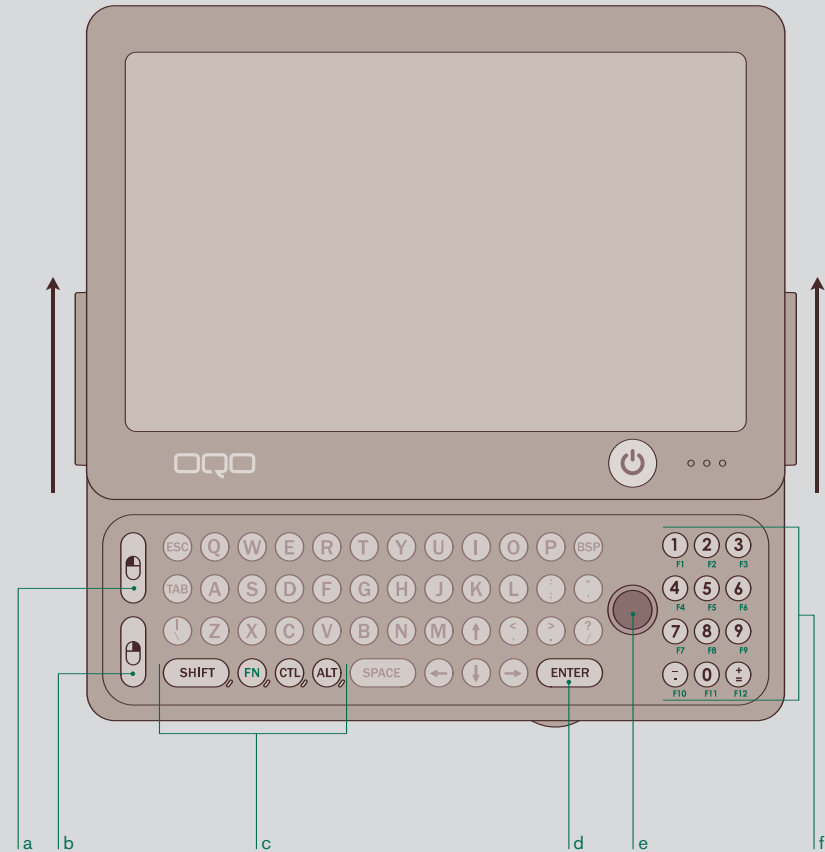

## using the digital pen and thumbwheel

The thumbwheel can be used in multiple modes. Use the OQO Settings applet found in the Control Panel to change its behavior.

By default, the thumbwheel works like this:

- Click the thumbwheel once to display the current mode, then click again to toggle among the modes.
- Double-click the thumbwheel to toggle between open applications or launch new applications.
- In volume mode, rotate the wheel to the left to decrease the volume and to the right to increase it.
- In vertical scrolling mode, rotate the wheel to the left to scroll up and to the right to scroll down.
- In horizontal scrolling mode, rotate the wheel to the left to scroll left and to the right to scroll right.

Remove the digital pen by pulling it out of the slot in the upper right corner of the OQO.

Use the digital pen like this:

- To select an object on the screen, touch it with the tip of the pen.
- To drag an object, hold the pen over it and drag across the screen. To drop the object, lift the pen.
- To double-click an object, tap it twice.
- To right-click an object, select it and click the button located on the digital pen.

Use the "Wacom Pen Settings" applet found in the Control Panel to change this behavior and calibrate the pen. It is important to calibrate your pen before you start to use it. Use only light pressure with the pen. The angle of the pen will affect its behavior. More information on the pen can be found at <http://www.oqo.com/support>.

- a** Thumbwheel
- b** Digital pen
- c** Tap to select
- d** Pen (right-click) button
- e** Audio in/out

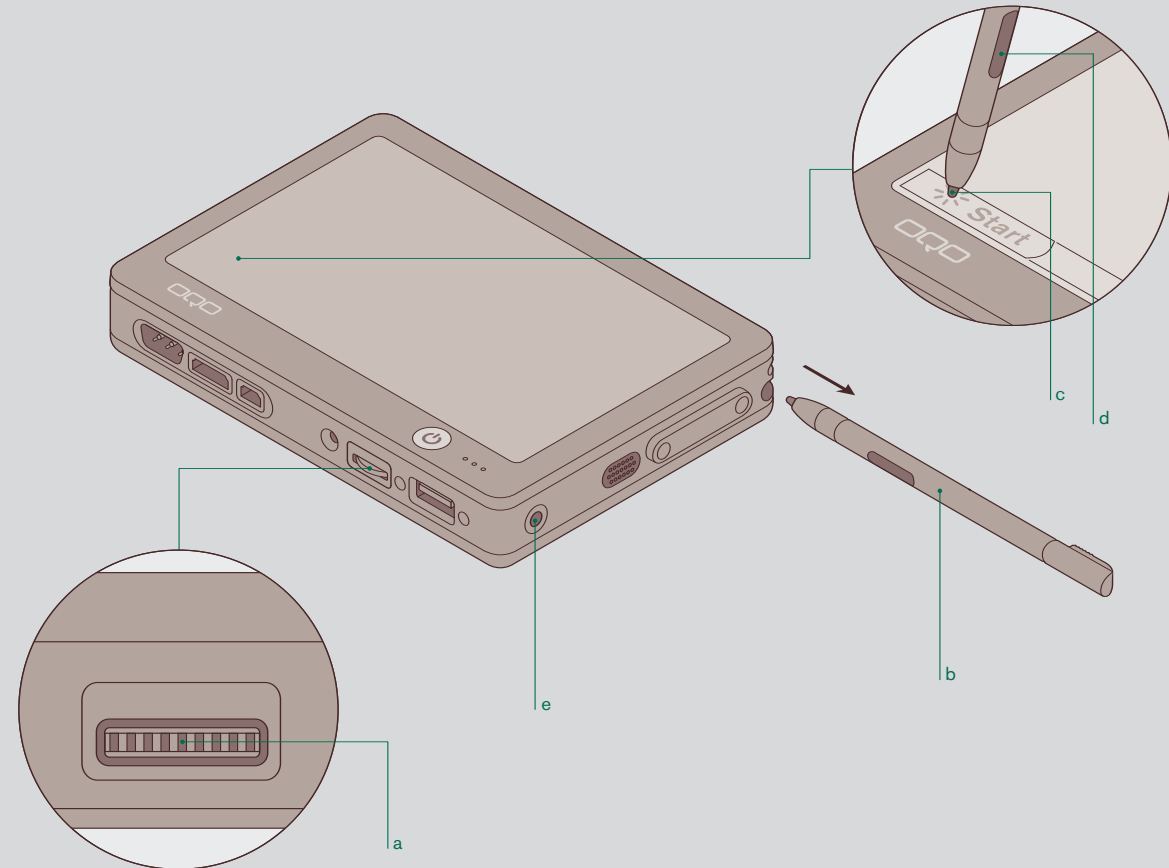

## using the docking cable and desktop stand

When using the model 01 as a desktop computer, place it on the desktop stand to hold it in a convenient, upright position.

The docking cable attaches to your model 01 as shown at right. When removing the docking cable from the docking connector, keep the cable straight, as twisting or angling it can damage the connector. It includes multiple ports that can be used simultaneously to connect a variety of peripheral devices:

- Use the VGA port to connect to an external monitor or projector. Resolutions up to 1280 x 1024 are supported. To change the resolution of your external monitor or projector, go to the "Display" applet in the Control Panel and select the "Settings" tab. The model 01 will remember the settings and automatically adjust the screen resolution when you dock and undock.
- Use the Ethernet port to connect to a Local Area Network (LAN).

- Use the USB 1.1 port to connect to USB-enabled devices, such as a keyboard or a scanner. Use a USB hub to connect multiple devices. A powered USB hub is recommended.
- Use the FireWire® (IEEE 1394) port to connect to FireWire-enabled devices such as a hard drive or camera.
- Use the audio out port to connect to headphones or external speakers. An additional audio out port is located on the body of the computer.
- Use the DC power port to connect the power supply to the cable. The power supply cannot connect directly to the computer while the docking cable is in use.

- a FireWire port
- b Power supply in
- c USB port
- d Audio out
- e Ethernet port
- f VGA out

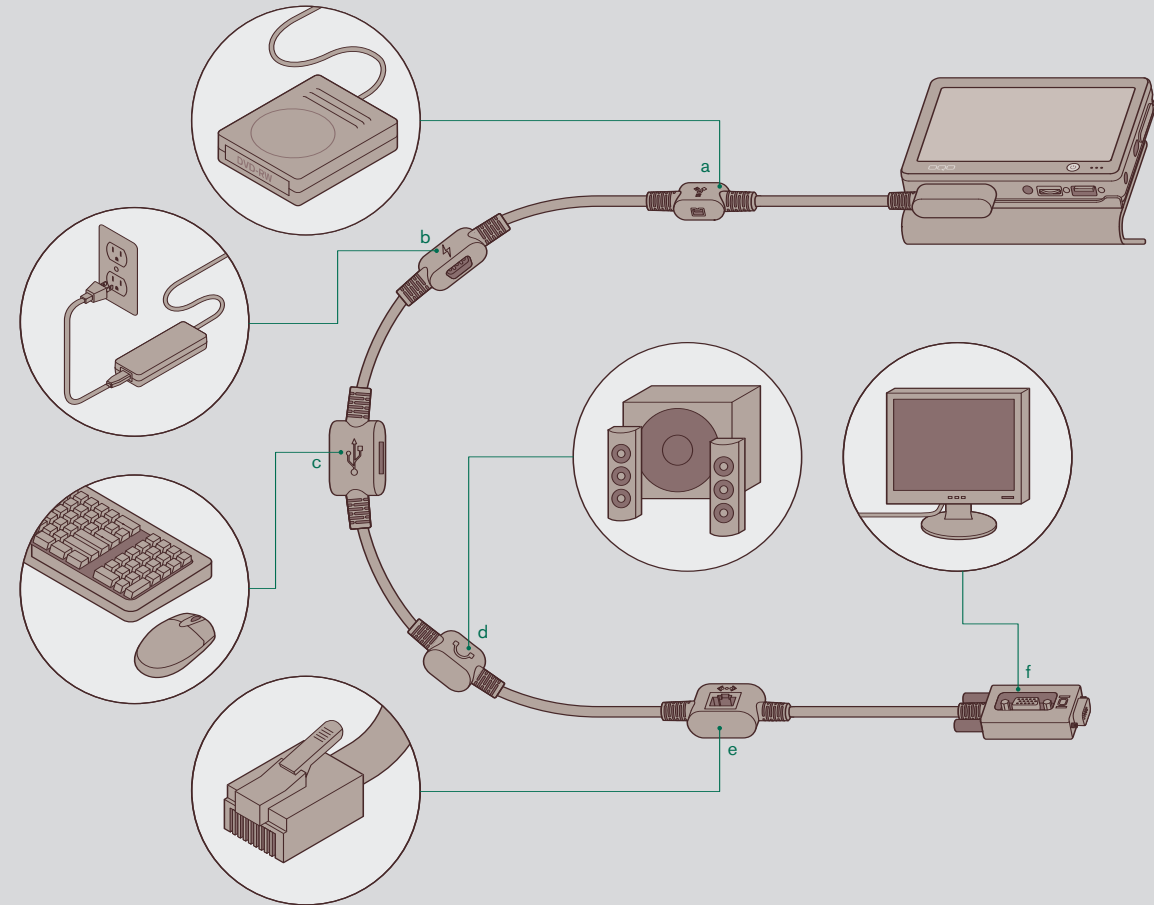

## connecting to a network

The model 01 provides several ways to connect to a network:

- Use the integrated WiFi to connect to a wireless network.
- Use the docking cable to attach an Ethernet cable and connect to a Local Area Network (LAN).
- Use the integrated Bluetooth and a Bluetooth-enabled mobile phone to connect to a wireless data network provider. (See <http://www.oqo.com/support/bluetooth> for more information).
- Use the USB port to attach a USB modem and connect to a dial-up Internet Service Provider (ISP).

For detailed information about configuring network connections, see the Microsoft Windows XP documentation.

- a WiFi antenna
- b Bluetooth antenna
- c Docking cable Ethernet port
- d USB port
- e External WiFi antenna connector (non-standard)

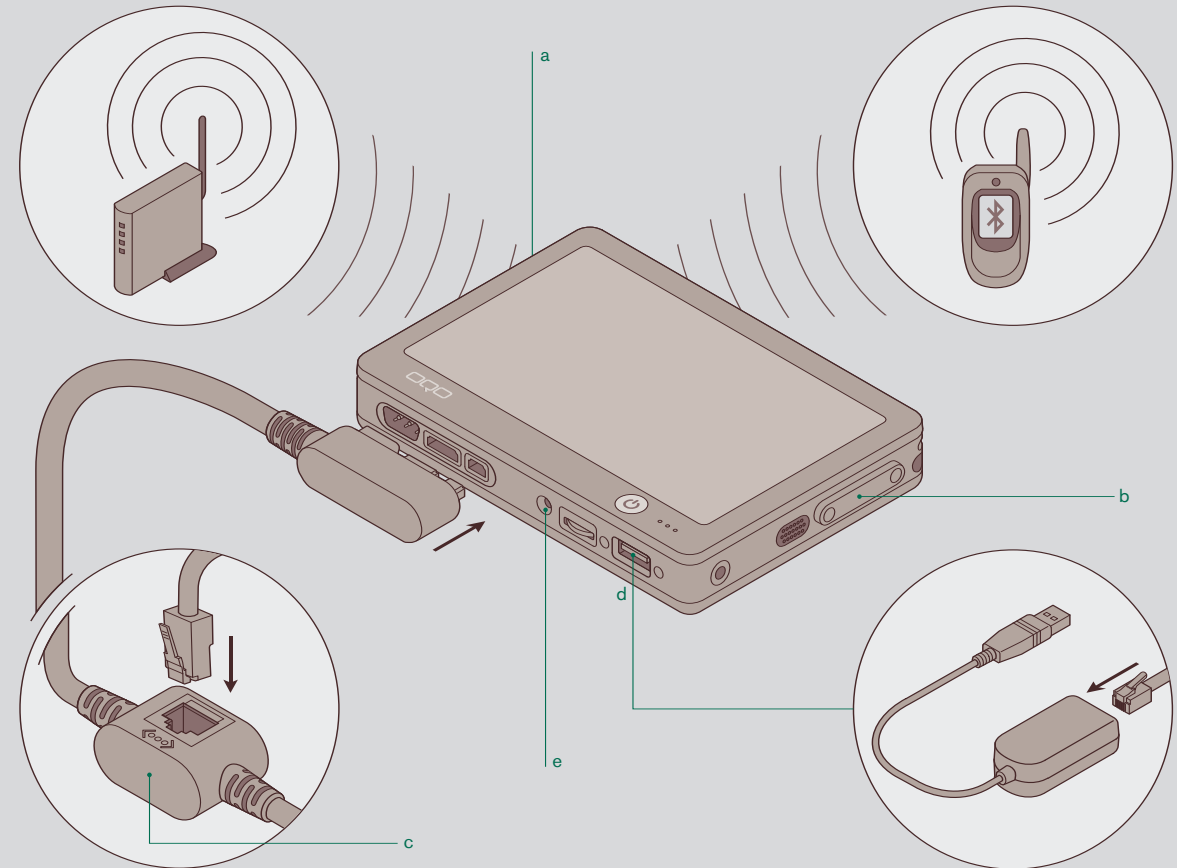

## installing software and copying files

There are several ways to copy your existing files from another computer to the model 01:

- Connect to a network and copy your files over the network.
- Burn your files on a CD, then connect an external USB 1.1 or FireWire DVD/CD drive to the computer.
- Use a portable USB "key" or external FireWire hard drive.
- Connect to another computer via FireWire.

We recommend using an external FireWire hard drive to back up the files from your model 01.

Your model 01 comes with Microsoft Windows XP. There are several ways to install your own software:

- Connect an external, USB 1.1 CD-ROM drive to install the software from a CD-ROM.
- Use a portable USB "key."
- Connect to a secure network and run the software installer from a network server.

- a** FireWire port
- b** USB port

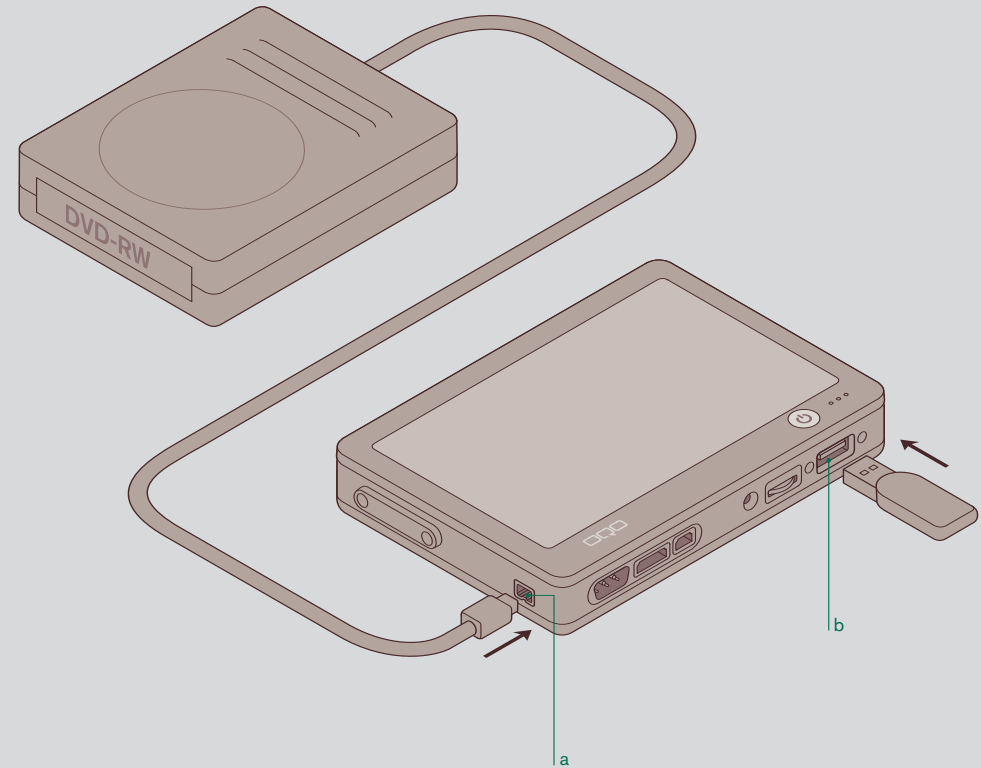



## product support

The OQO support site provides additional information, including FAQs and articles, and contact information for technical support. Access the support site at <http://www.oqo.com/support/>.

In the event that you need to contact OQO technical support for help, be sure to have your serial number and Microsoft Certificate of Authenticity (COA) number ready. They are

located under the battery, on the underside of the model 01. To remove the battery, push the small latch next to the audio port and lift the battery away from the computer.

- a Battery release button
- b Microsoft Certificate of Authenticity (COA)
- c Serial number

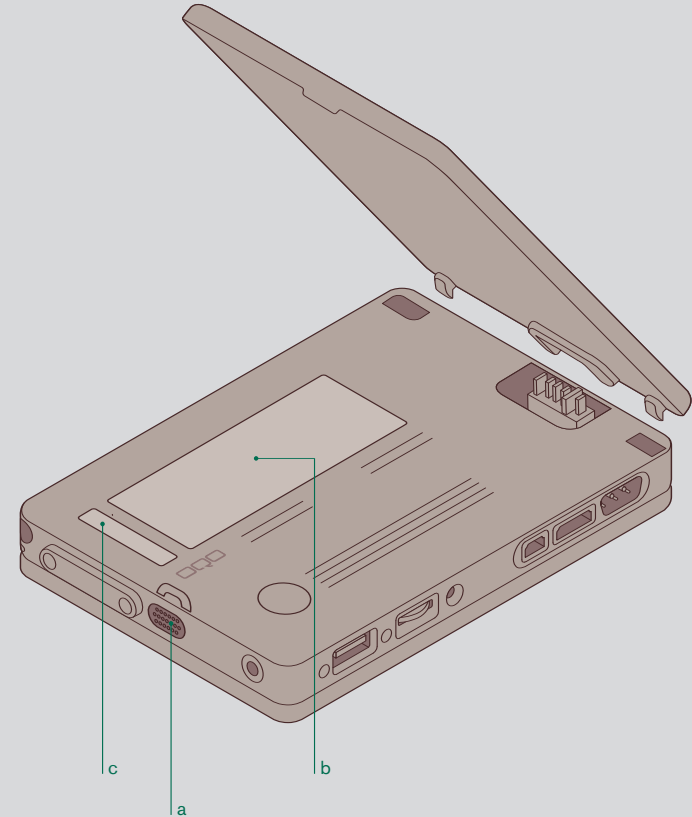

## online documentation

This guide provides a brief overview of the many features of the model 01. For more comprehensive information, see the *model 01 user's manual*, available at <http://www.oqo.com/support/documentation>.

Warranty information is available at <http://www.oqo.com/warranty>.

The OQO return policy is available at <http://www.oqo.com/returns>.

### FCC Statement

This equipment has been tested and found to comply with the limits for a Class B digital device, pursuant to Part 15 of the FCC Rules. These limits are designed to provide reasonable protection against harmful interference in a residential installation. This equipment generates, uses and can radiate radio frequency energy and, if not installed and used in accordance with the instructions, may cause harmful interference to radio communications. However, there is no guarantee that interference will not occur in a particular installation. If this equipment does cause harmful interference to radio or television reception, which can be determined by turning the equipment off and on, the user is encouraged to try to correct the interference by one or more of the following measures:

- (1) Reorient the receiving antenna
- (2) Increase the separation between the equipment and receiver
- (3) Move the computer away from the receiver
- (4) Connect the equipment into an outlet on a circuit different from that to which the receiver is connected.

This device has been evaluated for rf exposure conditions to FCC requirements. To meet rf exposure limits the UPC should not be colocated with other transmitting devices.

### Declaration of Conformity

We, OQO, Inc. 583 Shotwell Street, San Francisco, California, USA, 415 430 6200, declare under our sole responsibility that the product, OQO model 01, complies with Part 15 of FCC Rules. Operation is subject to the following two conditions:

- (1) This device may not cause harmful interference, and
- (2) This device must accept any interference received, including interference that may cause undesired operation.

Any modifications made to the UPC that are not authorized by OQO could void the user's right to operate the device.

### Information regarding cable and type of ferrite to be used

- (1) To prevent unwanted radio interference, the following type of cable may be used with the Ethernet jack:  
Manufacturer: E-MU Systems, Part Number: 70EM886106000
- (2) To prevent unwanted radio interference, the following type of ferrite may be used on the Audio cable or Headphone cable connected to the OQO model 01:  
Manufacturer: Steward, Part Number: 28A2026-0A2
- (3) To prevent unwanted radio interference, the following type of IEEE-1394 cable may be used for the FireWire jack:  
Manufacturer: Granite Digital, Part Number: 1660

Reference OQO, Inc. FCC ID number: SHD-A4YWFS

