

Wireless Entrance Alert Model CE-6880

Pack contents:

- Plug-In Doorbell
- PIR transmitter
- 2 screws and 2 wall plugs for mounting the PIR transmitter

You will require:

- A small Phillips head and Flat head screwdriver
- 3 pieces AA alkaline batteries

Installation Instructions

Please note: Installing the PIR transmitter or door bell on or near metal structures or reinforced PVC doors or doorframes may reduce the transmission range.

Install the PIR transmitter(Refer to Figure 1 & 2)

Remove PIR transmitter main body from mounting base by inserting flat blade screwdriver into one of the catches and twisting gently (Figure 1).

Open the adjustable flip 90 deg. Install Mounting base on wall or ceiling with screw (Figure 2).

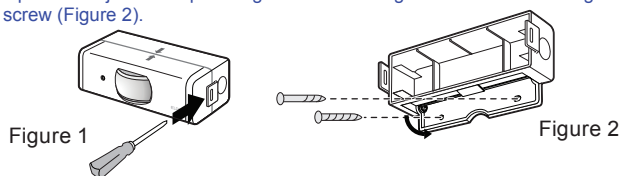

Installation the battery

Place 3pieces AA alkaline battery into the battery compartment as shown (Figure 3).



Replace Transmitter main body to Mounting base (Figure 4).
Adjust the angle as desired, from 0 to 90 degree (Figure 5).

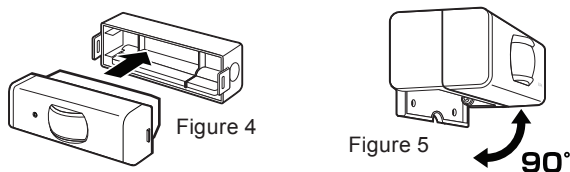

PIR Transmitter Detection area (Refer to Figure 6)

Detection range : Approx. 3 to 5m
Width : Approx. 60 deg.
Depth : Approx. 30 deg.

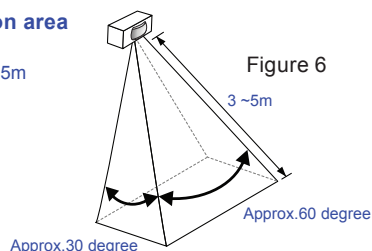

Install the Door Chime

Plug the Plug-in Chime into any electrical outlet within the house.
The chime must be within transmission range of the PIR transmitter.
The Chime will play all of the tunes that are available when it is first powered up.

Program the Chime

A signal is transmitted when PIR sensor is detected and the plug-in chime will respond with a tune.
This indicates that the pushbutton has been programmed to the plug-in chime.
You can leave this tune or change it to another by pressing button A on the plug-in chime (Figure 7).

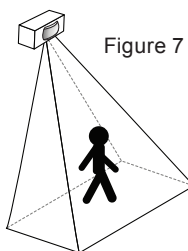

Sound Selection

Doorbell Pushbutton —Press Button A (Figure 8)
until you hear the desired chime.
NOTE: You can change the chime at any time by pressing this button.

The volume adjustment knob C (Figure 8) enables you to adjust the volume of your door chime at any time.

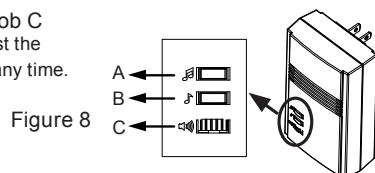

Doorbell Specification

Range..... up to 150 ft.
Electrical Load..... 1 x CR2032 Lithium Battery for Pushbutton
Operating Voltage..... 120VAC,60Hz
Standby and operating Current.....0.1A

PIR Transmitter Specification

Range..... up to 150 ft.
Electrical Load..... 3 x AA Alkaline Battery (not included)
Frequency.....313.625Mhz
ID Code.....More than 250K
WaterproofIP44

Note

This device complies with part 15 of FCC Rules. Operation is subject to the following two conditions:

- (1) This device may not cause harmful interference, and
- (2) This device must accept any interference received, including interference that may cause undesired operation.

The changes or modifications not expressly approved by the party responsible for compliance could void the user's authority to operate the equipment. To comply with FCC RF exposure requirements, this device and its antenna must not be co-located or operated in conjunction with any other antenna or transmitter.

Reset the Chime Programming

While plugged into an electrical outlet, press and hold button A and B (Fig. 8) until the chime sounds. The chime will play all of the chimes available indicating that previous programs have been erased. Return to the *Program the Chime* and repeat section.

Troubleshooting	
Chime doesn't sound	
Check that the battery has been inserted correctly.	The PIR transmitter LED light should come on when detected.
PIR transmitter may be positioned out of range of the door chime.	Move the door chime closer to the PIR transmitter. Note: During the programming cycle, the transmission range may be reduced and will resume optimum range after 2 minutes.
A metallic object may be blocking the signal to the door chime from the PIR transmitter.	Experiment with the location of the door chime to see if you can move it to a more suitable place.
Battery in the PIR transmitter may need replacing.	See instruction for Installing the Battery. Note: In cold conditions, poor location or environment, operating at maximum range it is advisable to replace the battery more frequently (i.e. every 12-18 months) to maintain optimum performance.
Your PIR transmitter and Chime haven't been programmed.	Reset the automatic programming of your chime by pressing and holding down chime selection buttons A and B (Figure 8) for 5 seconds. The chime will sound all of the sounds available indicating the programming has been erased. Program the PIR transmitter following the installation instructions.
For any other problem, call 1-800-296-1869 Mon-Fri between 9 a.m. and 5 p.m. EST.	

IQ America Two Year Warranty

This is a "Limited Warranty" which gives you specific legal rights. You may also have other rights which vary from state to state and province to province.
For a period of two years from the date of purchase, any malfunction caused by factory defective parts or workmanship will be corrected at no charge to you. To obtain a refund or replacement, return the product to the place of purchase.
NOT COVERED: Repair service, adjustment and calibration due to misuse, abuse or negligence. Unauthorized service or modification of the product or of any furnished component will void this warranty. This warranty does not include reimbursement for inconvenience, installation, setup time, loss of use or unauthorized service.
This warranty covers only IQ America products and is not extended to other equipment and components that a customer uses in conjunction with our products.
This warranty is expressly in lieu of all other warranties, express or implied, including any warranty, representation or condition of merchant ability or that the products are fit for any particular purpose or use, and specifically in lieu of all special, indirect or incidental or consequential damages.
Repair or replacement shall be the sole remedy of the customer and there shall be no liability on the part of IQ America for any special, indirect, incidental or consequential damages, including but not limited to any loss of business or profit, whether or not foreseeable. Some states or provinces do not allow the exclusion or limitation of incidental or consequential damages, so the above limitation or exclusion may not apply to you. Retain receipt for warranty claims.