

Aspectek

YACHT & RV GUARD™



Manual

About Aspectek™

Aspectek is a world leading supplier of advanced electronic products with over 20 years of experience in research and development.

Notice of Copyright

Yacht & RV Guard™ owner's manual ©October 2012 Aspectek. All rights reserved.

Disclaimer

UNLESS SPECIFICALLY AGREED TO IN WRITING,
ASPECTEK:

A. MAKES NO WARRANTY AS TO THE ACCURACY,
SUFFICIENCY OR SUITABILITY OF ANY TECHNICAL OR
OTHER INFORMATION PROVIDED IN ITS MANUALS OR
OTHER DOCUMENTATION.

B. ASSUMES NO RESPONSIBILITY OR LIABILITY FOR
LOSS OR DAMAGE, WHETHER DIRECT, INDIRECT,
CONSEQUENTIAL OR INCIDENTAL, WHICH MIGHT
ARISE OUT OF THE USE OF SUCH INFORMATION. THE
USE OF ANY SUCH INFORMATION WILL BE ENTIRELY
AT THE USER'S RISK.

Technical Support

Web: www.aspectek.com

Email: service@aspectek.com

DIAGRAM

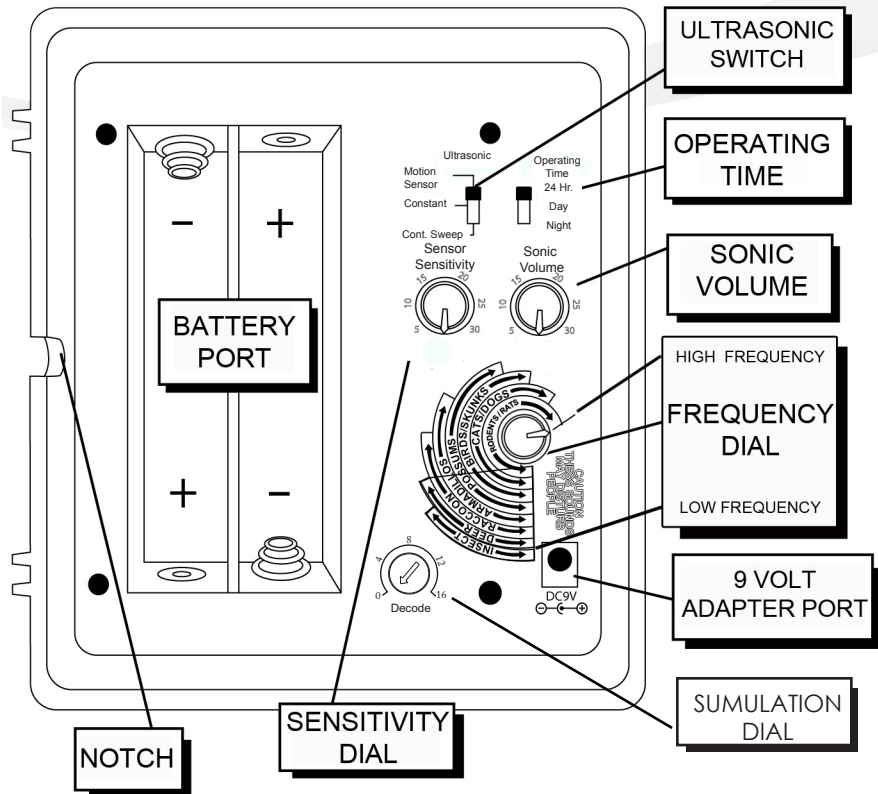

aspectek

YACHT & RV GUARD™

This manual will provide you, the user, with directions for the safe and efficient operation of the Yacht & RV Guard™. Please read this manual carefully before using this product, and keep it for future reference.

IMPORTANT!

Before you plug in your unit, it is important to understand sonic and ultrasonic signals.

The sonic signal is the alarm/harrassment sound humans can hear. Combining this sound with ultrasonic may give you better results for startling and repelling intruders and animals from your yard. However, if the sonic sound bothers your neighbours, you can turn this off using the “Sonic Volume” dial. Just turn the volume dial to zero.

The ultrasonic signal is the high-pitched frequency that only animals can hear. This sound will be emitted whenever your device is on (plugged in or on battery power). You can adjust the frequency using the Frequency dial, but you won't turn it off by adjusting either the Sonic Volume or Frequency dial.

TABLE OF CONTENTS

INTRODUCTION	3
SAFETY AND MAINTENANCE	4
QUICK SET UP	
FREQUENCY DIAL	5
MODES	5
SENSITIVITY DIAL	6
SONIC VOLUME	6
PLACEMENT	6
THE SCIENCE BEHIND IT	7
ULTRASONIC	8
INFRARED MOTION SENSOR	8
STROBE LIGHT WITH SUNDOWN SENSOR	9
OPERATING TIME	9
SONIC	10
OPERATING THE YACHT & RV GUARD	10
USING THE A/C ADAPTER	11
USING THE “CIGARETTE LIGHTER” PLUG	11
CONNECTING THE EXTENSION CORD	11
INSTALLING THE BATTERIES	11
INTELLIGENT POWER SYSTEM (IPS)	12
OPTIONAL POWER SOURCES	12
TURNING THE UNIT ON/OFF	13
SETTINGS	13
FREQUENCY DIAL	13
SENSITIVITY DIAL	14
MOUNTING TO A WALL	14
REMOTECONTROL	14
SET THE SIMULATION DIAL	15
TURBO BUTTON	15
STANDBY MODE	16
STROBE LIGHT BUTTON	16
ULTRASONIC	16
PRODUCT SPECIFICATIONS	17
9 WAYS TO KEEP PESTS AWAY!	18
CONTACT US	19
DIAGRAM	20

CONTACT US

We enjoy receiving letters and emails from our valued customers. If you have a question, comment or suggestion about the product, please write to us. If you have a success story, let us know. With your permission we may publish it on our website.

Aspectek
Langara PO Box No. 61088
571 West 57th Ave.
Vancouver, BC
V6P 6S5

Visit us at aspectek.com
Or email us at service@aspectek.com

We stand by our products with a one-year limited warranty. If you are having trouble with your product please don't return it to the merchant. Contact us, and we would be happy to help you.

Available Accesories

The Yard Sentinel RC can be connected to a 12V DC or 24V DC Sealed Lead-Acid (SLA) battery using our special extension cord with alligator clip and DC power plug. (For diagram, see page 12; Fig. 8.) Contact us for product and ordering information.

9 TIPS TO KEEP PESTS AWAY

- Here are some preventative measures you can take to keep pests out of your home and yard:
1. Keep garbage lids closed tightly.
 2. Store food in airtight containers.
 3. Don't leave pet food and water out overnight.
 4. Repair plumbing leaks and cracks.
 5. Drain all liquids and wash containers before you put them in the recycle bin.
 6. Accumulating paper products such as cardboard boxes, bags, newspapers, etc., should be avoided.
 7. Keep grass short around the foundation of the house and the trees and shrubs planted away from the house.
 8. Screen all vent opening such as crawl spaces, attics or laundry vents.
 9. Repair and adjust windows and door screens.

INTRODUCTION

The Yacht & RV Guard™ pest repellent by Aspectek is the industry's most advanced outdoor anti-pest product. The product brings together peace of mind and affordability as a result of years of research and innovation. This device allows you to rid your yard, garden or outdoor area of pests humanely and without the use of poisonous chemicals.

How does it work?

The Yacht & RV Guard uses ultrasonic technology to repel pests from your yard as well as sonic alarm/harassment noise and strobe light. The device is environmentally friendly, safe for humans and pets and won't even harm the pests you are trying to repel.

It is equipped with an infrared motion sensor that activates when pests are in range. The strobe light and sensor can also be activated by remote control.

Features

Your device is equipped with several features:

AC adapter

"Cigarette lighter" plug

10 metre (33 feet) extension cord

Battery-operational: Requires 4 C batteries (not included)

Intelligent Power System (IPS): AC power will take priority over

battery when both are installed. In the case of power failure,

device will switch to battery backup when batteries are installed

Ultrasonic: Adjustable frequencies so high that only pests can hear them

Sonic: Audible alarm and harassment noise

Strobe light: Ideal for repelling nocturnal animals

Modes: Motion Sensor, Constant or Continuous Sweep

Infrared Motion Sensor: Detects pests in range and activates device

Remote Control: Four-button remote (Stand-by, Turbo, Ultrasonic, Strobe)

SAFETY AND MAINTENANCE

1. Please read the manual before using the product.
2. Do not restrict airflow around the unit. Do not position behind furniture or curtains. For best effect, position in open areas.
3. Do not attempt to open the unit beyond its functional use.
4. This is not a toy. Do not hold up to your ears with either the ultrasonic or sonic sounds activated.
5. Please consider other people and their privacy and peaceful enjoyment of property before using the security alarm and strobe light.
6. This pest repellent is environmentally friendly, safe and harmless to pests and pets.
7. Keep the motion sensor lens clean by periodically wiping with a damp cloth.
8. Remove batteries when not in use to avoid leakage that could damage the unit.
9. Check all cables used to connect the device for cracks or damaged insulation. Do not use the device in case of defects or serious damage.
10. If repairs are required, original replacement parts should be used exclusively in order to avoid serious damage. Repairs or other work may only be carried out by authorized personnel. Please contact us for warranty information (see page 19).
11. Do not connect any power sources to 4C size battery holder except C size batteries, or it may damage the unit. Contact us for information about our special extension cord with alligator clip and DC power plug for connecting to a 12V DC or 24V DC Sealed Lead-Acid (SLA) battery.

PRODUCT SPECIFICATIONS

A/C Adapter

Input: A/C 110-240v, Output: D/C 9v/500mA x 1 (included)

DC power sources

4C size batteries (not included)

Vehicle power source by connecting cigarette lighter socket (included)

DC12V or 24V sealed lead-acid (SLA) battery (cord sold separately)

Ultrasonic Frequency

15kHz to 25kHz (adjustable)

Output Sound Pressure

0 to 110dB

Working Current

Up to 400mA

Optimum Distance

Remote control: up to 80 feet (25 metres) approximately (open space)

Infrared sensor: up to 45 feet (14 metres) approximately

Ultrasonic effective range: 5,000 sq feet (1.5 sq kilometres) or 70x70 feet (21x21 metres)

Security Alarm Sound Pressure

0-110 dB maximum (adjustable), +/-5dB

Remote control

4 button control (simulation)

Cigarette Plug: A 1.8 meter (6 feet) cord for the 12 or 24 D/Cv "cigarette lighter" vehicle power socket

Extension Cord

10 metre (33 feet) extension cord with an adaptive connector for the "cigarette plug", AC transformer cord and SLA battery cord (not included).

Lanyard

0.2x20 cm (0.8x8 in) with plastic beads; and wall hook

3 Velcro Straps: With 6 cm (2 in) length and 1.6 cm (.5 in) width for two pieces and 5 cm (2 in) width x 8 cm (3 in) width for one piece

QUICK SET UP

This mode can also be used to repel large animals when you see them enter your property.

Standby mode:

To deactivate your device, press the Standby button (top right). You will hear a long beep sound. The remote control's red light will flash continuously and all the functions, except for Turbo, will be on Standby mode. To activate the device, press the Standby button once. You will hear a shorter beep sound and the device will begin working as set by the user.

The Standby mode is helpful for switching off the device when you want to use your yard without setting off the alarm/harrassment sound or let your pet into the yard without having to unplug the device. When finished you can simply turn off the Standby mode with the remote control. You will hear a beep and the flashing LED light will turn off.

Strobe button:

This button (bottom right) activates the Strobe function. Press the button once. A light will come on to tell you that the device has been activated. The function will be activated for 20 seconds.

The strobe light is effective against birds and pests that are active at night like squirrels, mice, rats, skunks, cats and dogs.

The strobe light only functions at night or in dark places.

Ultrasonic:

The Ultrasonic button (bottom left) turns on the high frequency sound that effectively repels pests from your yard or other open area. Press the button once to activate. A light will come on. The function will be activated for 20 seconds.

Congratulations on your new Yacht & RV Guard™! You have three options to get your device started. Your unit came with an AC adapter. Remove the back cover from your device and plug in the adapter. You will see an opening at the bottom of the unit that you can run the cord through. It also came with a "cigarette lighter" plug for your vehicle.

If you don't have an electrical outlet or vehicle lighter plug available in the area, you will need four C batteries (not included).

When you install power, the unit will wait a few moments at which point a red light will turn on and stay on for about 20 seconds. Your unit is then ready to operate. All of your controls are located at the back of your device. Remove the cover to adjust the following settings as needed.

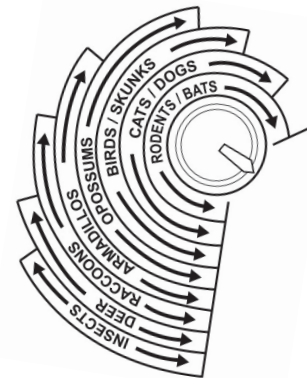

Fig. 1

Frequency Dial: You will see several types of pests listed around the Frequency dial (Fig. 1) and the ranges of frequencies that are ideal for repelling them. You can turn this dial to the setting that best suits your needs. If you are trying to repel more than one type of pest, set it somewhere within the ranges of each of them. Adjust the frequency slightly every few weeks to avoid allowing the pest to adapt to the sound.

Modes: The Yacht & RV Guard has three different modes. Try all three to see what works best on the animal you are trying to repel.

Motion Sensor: The Motion Sensor will activate the ultrasonic and sonic sounds at the frequency you set when it detects the pests are in range.

Constant: The Constant setting will activate the ultrasonic and sonic noises and cycle through them intermittently using the frequency you set. The motion detector will deactivate on this setting.

REMOTE CONTROL

Continuous Sweep: The Continuous Sweep mode will activate a range of sonic and ultrasonic frequencies at different intervals. The motion detector will deactivate on this setting. This is helpful for repelling several different types of pests.

Sensitivity dial: The Sensitivity dial adjusts the distance at which the device's motion sensor will work.

Sonic Volume: The Sonic Volume adjusts the loudness of the alarm and harassment sound. If this sound bothers you or your neighbours, turn it all the way down. The ultrasonic signal will still be effective in repelling pests.

Here are some suggested settings for common types of pests:

1. Raccoon: Turn the Frequency dial all the way to left (counter-clockwise) of the raccoon range, and blast the alarm/harassment sound.
2. Squirrels / Mice: Turn the Frequency dial to the right (clockwise). If you are not sure, start at the top of the range (right), and adjust it downwards until you find the setting that works best.
3. Rabbits: Turn the Frequency dial all the way to the left (counter-clockwise).
4. Birds / Crows: Turn the Frequency dial all the way to the left (counter-clockwise), and blast the alarm/harassment sound.
5. Dogs / Cats: Turn the Frequency dial all the way to the right of the range (clockwise), and adjust downwards until you find the setting that works best. Dogs and cats can have varying hearing sensitivities.
6. For large sized animals (deer, bears, etc.): Turn the Frequency dial all the way to the left, and blast the alarm/harassment sound.

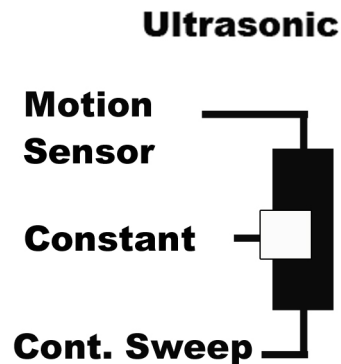

Fig. 2

The Yacht & RV Guard™ remote control is simple to use with four functions offering optimal user control over your device. It can operate up to 80 feet from the device. It has four buttons that operate the Turbo, Stand-by mode, Strobe or Ultrasonic function.

Note: The volume settings for the Turbo alarm function are located at the back of your device.

To turn on the remote control, simply plug in the Yacht & RV Guard or install batteries. A red light will come on for approximately 20 seconds.

Set the Simulation Dial:

The Simulation dial only needs to be set once. Remove the back cover of the device. Locate the Simulation dial below the Frequency dial. Press and hold the Standby button on the remote control while turning the Simulation dial until you hear a sound. Release the button. The Simulation setting is unique to your device and necessary to avoid interfering with other remote controlled devices.

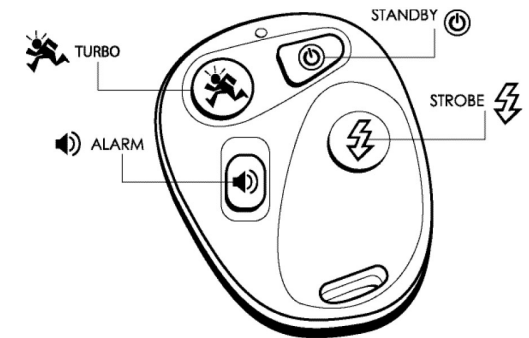

Fig. 8

Turbo Button:

The Turbo button (top left) is a safety feature to protect you and your family outdoors. When activated, the Turbo turns on all functions for 20 seconds (ultrasonic, sonic and strobe). This can startle an intruder or large animal entering your campsite or yard, giving you time to get help or leave the area. This function works even when the device is on Standby mode. To adjust the volume of the alarm, remove the back cover and adjust the Sonic Volume.

preserve battery life at intervals of not more than five minutes.)

Frequency Dial:

Various pests have different ranges of ultrasonic hearing. Sometimes you will need to experiment to find the range that best repels the pest you want to control. However, the Frequency dial illustrates a range of frequencies and the pests they are effective at repelling as a guide.

Sensitivity Dial:

The "Sensor Sensitivity" dial controls the detection range of the device's Infrared Motion Sensor. You can adjust the range from near to far (5 to 45 feet). The ideal range will vary under different environments. Try setting it to maximum and reducing it if you find the device activates when there is no motion in the area.

Mounting to a Wall:

You have three options for mounting the Yacht & RV Guard to a wall. If you choose to use the Velcro strips, remove the backing from the two narrow strips and fasten to the wall. Remove the backing from the larger piece and fasten to the device. (See Fig. 9 below.) Two screws and fasteners are included with this unit for mounting on walls. Drill the screws into a suitable wall or upright surface. Align the notches on the back cover with the screws and hang the unit.

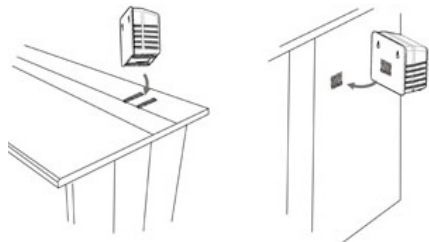

Fig. 9

You can also use the lanyard and hook, to hang the device wherever is convenient.

The unit must be aimed at the direction of the pests with no objects (e.g. windows, walls or fences) in front of it.

Placement: It's important to place the device where it will be most effective. For ground animals, like raccoons, squirrels, mice, etc., place the unit near the height of the animal you want to repel and facing the area where they most like to frequent. Don't place it on the ground as this will limit the effective range of the device. Using the lanyard, screws or the velcro strips that come with the device, you can hang the unit on a wall, tree, fence or stairs.

Ultra-sonic signals cannot penetrate solid surfaces. Make sure there are no windows, doors, fences or other items between the device and the area you want to cover. Place it at the height of the pests if possible. If not, tilt the unit downwards slightly to capture the pests in the device's effective range.

The ultrasonic sound emits in a forward direction from the device with a range of about 170 degrees horizontal and 60 degrees vertical. The ultrasonic frequency has a range of up to 70 feet, but the closer it is to the animal, the more effective it will be.

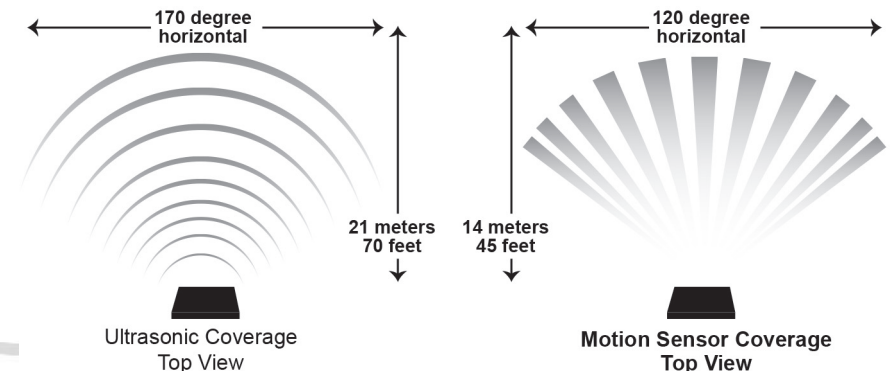

Fig. 3

THE SCIENCE BEHIND IT

The Yacht & RV Guard™ comes equipped with a variety of useful features. You will need to experiment to see which features or combination of features give you best results in ridding your yard or other open area of pests.

Ultrasonic:

The primary feature of your device is the ultrasonic signal. This is a high pressure sound that is only slightly audible to humans. However, it is very effective at startling and scaring away unwanted pests. Using a variable pulse generator, the ultrasonic emits a range of fluctuating sound waves to prevent the pest from becoming accustomed to the sound.

Using the Frequency dial: In order to use the ultrasonic signal to best effect, you will need to become familiar with the ultrasonic Frequency dial. Remove the back cover from your device. It should snap off just like a lid. The Frequency dial is located in the top middle. It is the largest dial (Fig. 4).

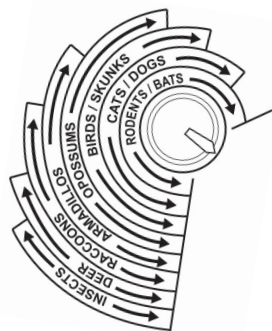

Fig 4

You will see a variety of ranges indicated around the dial. These ranges are identified by the animals they ideally repel. Choose a range that best reflects the type of animal you are trying to repel. Insects and birds are repelled by lower frequencies (counter-clockwise). Rodents are repelled by higher frequencies (clockwise).

Ultrasonic signals travel in a forward direction. You will need to point the device towards the area where you are having a pest problem. The signal will range 170 degrees horizontally and 60 degrees vertically from the device (Fig 3; page 7).

Turning the Yacht & RV Guard on and off:

The Yacht & RV Guard does not have an on/off switch. To turn it off, unplug it, remove the batteries, or use the standby mode on the remote control. To turn it on, plug it in, insert batteries or deactivate standby using the remote control.

When the unit is plugged in or batteries are installed, it will trigger a tone and red sensor light within 20 seconds and flash twice in another 20 seconds to notify the user that it is ready to go.

Settings:

You can customize your device's settings for best results in your particular situation. The ultrasonic setting control switch is located on the top left of your control panel. Remove the back cover to access the panel.

Motion Sensor: This setting will activate the ultrasonic, sonic and Strobe Light when the device senses that an animal is in range. You control the frequency using the Frequency dial.

Constant: This setting will cause the device to emit a frequency at random intervals of not more than 40 seconds on AC. The pause in between helps ensure the pest does not become accustomed to the sound. You control the frequency emitted using the frequency dial. This is a good setting to use if you only want to repel one type of animal and if the animal sometimes goes out of range of the motion sensor. (Battery saver: On battery power, the device will activate for shorter durations to preserve battery life at intervals of not more than five minutes.)

Continuous Sweep: This setting emits cycles of random frequency (approximately from 15kHz to 25kHz) with a break of not more than 40 seconds. This is the ideal setting if you want to repel two or more different types of pests. (Battery saver: On battery power, the device will activate for shorter durations to

Installing the batteries:

The Yacht & RV Guard can also operate on batteries. It uses four size C batteries. To install the batteries, remove the back panel by gently pulling it off. Install the batteries as shown on the diagram so the positive and negative poles match the poles printed on the unit. With the batteries in place, replace the back cover of the unit by pressing it until it snaps closed.

Intelligent Power System (IPS):

The Yacht & RV Guard is designed to provide uninterrupted protection even during a power failure. Install four C batteries and plug in your device. Your device will be powered through electricity. If the power fails, the device will automatically switch to battery backup.

Some of our customers choose to use their device in remote areas, or areas without traditional power outlets. The Yacht & RV Guard can be connected to a 12V DC or 24V DC Sealed Lead-Acid (SLA) battery using our special extension cord with alligator clip and DC power plug. For ordering information, see page 19.

Optional Power Sources:

Some of our customers choose to use their device in remote areas, or areas without traditional power outlets. The Yacht & RV Guard can be connected to a 12V DC or 24V DC Sealed Lead-Acid (SLA) battery using our special extension cord with alligator clip and DC power plug (Fig. 8). For ordering information, see page 19.

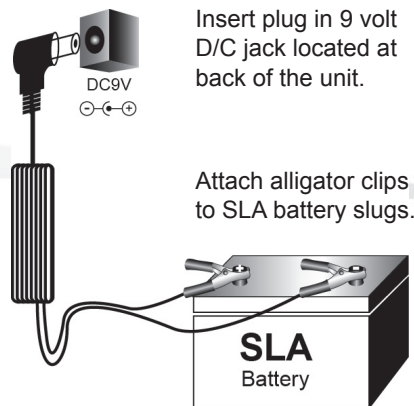

Insert plug in 9 volt D/C jack located at back of the unit.

Attach alligator clips to SLA battery slugs.

Fig. 8

Note: If you have a cat or a dog you may have to turn the device off when they are in range. This depends on the frequency you are using because cats and dogs can have very different levels of hearing depending on age or size. Other types of pets such as rodents or insects may be more sensitive. Ultrasonic waves cannot penetrate surfaces, so put them in a box or leave them behind and out of range of the device.

Infrared motion sensor:

Your device can be set to activate only when pests come into range. Set the mode switch to "Motion Sensor" to select this feature. When an animal or human enters the range of the device within 45 feet, a red light will turn on and the device will activate both the ultrasonic and sonic. The range of the sensor may vary due to ambient temperature.

Note: You can test your device to see if it is working by switching the mode to "Motion Sensor" and walking or waving your hand in front. If you see the red light, you will know the movement has been detected. If the Sonic Volume is turned up, you will also hear the alarm/harassment noise. The ultrasonic signal may also be slightly audible to some people.

The Motion Sensor is equipped with a dial that controls its sensitivity (Fig. 5). Turn it all the way up to ensure it works as well as possible (30). If you find the device activates when there are no animals or people in front of the device, turn it down to about 25.

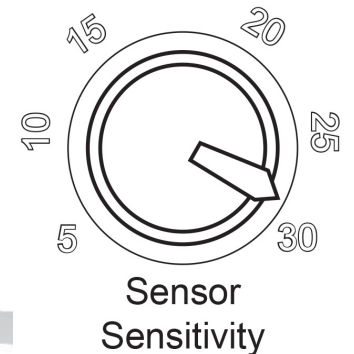

Fig. 5

Strobe Light with Sundown Sensor:

Your device is equipped with a Strobe Light to help drive away nocturnal creatures, like raccoons. The Strobe Light is designed to be disorienting and works along with the ultrasonic/sonic sound to create an audio and visual assault on the animal's senses driving them from your property. The Strobe Light flashes repeatedly in quick succession each time it is activated. The Strobe Light will only come on at night.

OPERATING THE YACHT & RV GUARD™

Operating Time:

Some pests, like birds, are active only in the daytime. Others, like raccoons, are active at night. You can choose whether to operate your device only in the daytime, nighttime or all day with the power-saving Operating Time feature (Fig. 6).

Sonic:

In addition to the inaudible ultrasonic signal, your device is equipped with a sonic signal. This helps to scare off any people or pests lurking around your property or large animals such as bears, coyotes, raccoons, skunks and birds. At full volume, the sound can be heard up to 300 feet (91 metres) away. It can also act as a security alarm for your yard.

How to use: The sonic signal is controlled by the Sonic Volume dial. To turn it up, turn the dial all the way clockwise. If you find the sonic noise bothers you or your neighbours, you can turn it off by turning the volume dial all the way down (counter clockwise) or simply lower the volume at your discretion. Adjusting the Sonic Volume will not affect the ultrasonic signal which emits at a fixed rate.

Operating Time



Fig. 6

Using the A/C Adapter:

Remove the back cover of the unit by gently pulling off. Plug one end of the A/C adapter into the 9 volt D/C jack located beside the frequency dial. Plug the other end into any standard A/C outlet. Thread the A/C adapter cord through the notch at the bottom of the unit and then replace the back cover by snapping it into place. (For diagram, see page 20.) If you do not have a weather-proof electrical outlet, the adapter should be plugged in indoors. The device and the 9-volt port are weather resistant, but it is best to protect the Yacht & RV Guard from heavy rains or snow.

Using the “cigarette lighter plug”:

Even if you don't have an electrical outlet in the area, you can still operate your device without batteries by using the cigarette lighter plug. To connect, insert one end into the 9 volt D/C jack located at the back of the Yacht & RV Guard. Plug the other end into your vehicle's “cigarette lighter” power socket.

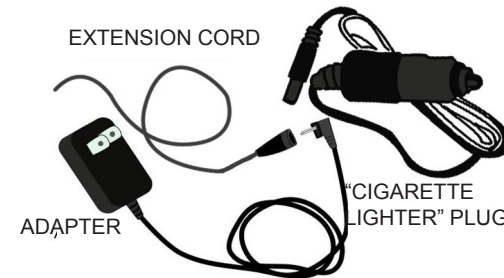

Fig. 7

Connecting the extension cord:

The extension cord can connect between the cigarette plug or the A/C adaptor. Simply plug in the small side of the extension cord at the back of the unit where it indicates DC9V, then attach the other larger plug to the cigarette plug or the A/C adaptor.

FCC ID: SFB-HR135

This device complies with Part 15 of the FCC Rules. Operation is subject to the following two conditions: (1) this device may not cause harmful interference, and (2) this device must accept any interference received, including interference that may cause undesired operation.

Changes or modifications not expressly approved by the party responsible for compliance could void the user's authority to operate the equipment.

NOTE: This equipment has been tested and found to comply with the limits for a Class B digital device, pursuant to Part 15 of the FCC Rules. These limits are designed to provide reasonable protection against harmful interference in a residential installation. This equipment generates, uses and can radiate radio frequency energy and, if not installed and used in accordance with the instructions, may cause harmful interference to radio communications. However, there is no guarantee that interference will not occur in a particular installation. If this equipment does cause harmful interference to radio or television reception, which can be determined by turning the equipment off and on, the user is encouraged to try to correct the interference by one or more of the following measures:

- Reorient or relocate the receiving antenna.
- Increase the separation between the equipment and receiver.
- Connect the equipment into an outlet on a circuit different from that to which the receiver is connected.
- Consult the dealer or an experienced radio/TV technician for help.