

MINI H2O 2

RUGGED BLUETOOTH SPEAKER

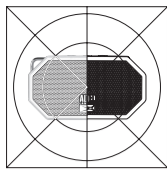

Quick Start Guide

Item # IMW258



1. Make sure the following items are included in your package.

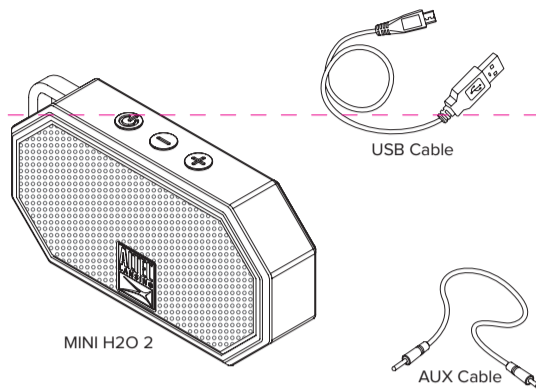

2. For a look at the various buttons on your speaker, view the graphic below.

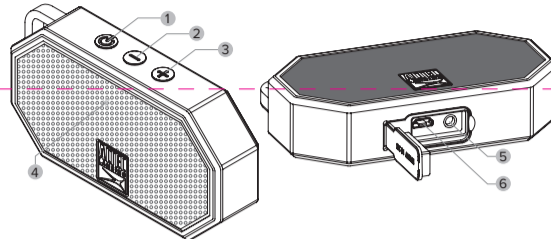

- ① Power
- ② Volume -
- ③ Volume +
- ④ LED Light Indicator
- ⑤ AUX IN Port
- ⑥ Charging Port

3. **Charging:** In order to charge your speaker's internal battery, connect one end of the included USB cable to the charging port on your speaker. Connect the other to a USB port or AC charging adapter(not included). The LED Light indicator turns red when charging, and turns blue when fully charged. Charging may take up to 3 hours.

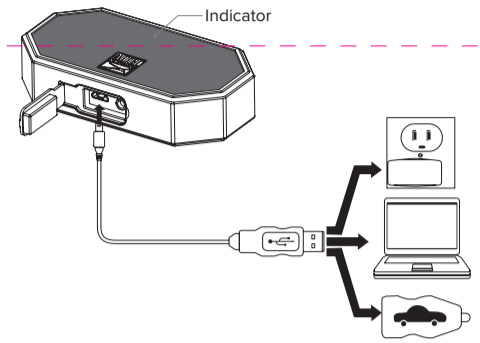

4. Pairing Your Speaker With a Bluetooth Phone

-Press and hold the Power button for around 5s. the device will power on and enter pairing mode with voice prompt "powering on, welcome to ALTEC LANSING"

-Go to the Bluetooth Manager of your Bluetooth device. Search Bluetooth devices and select "mini h2O 2" to start connecting.

-If required, enter the PIN code "0000" and confirm the entry. Once paired successful, the speaker will connect to your Bluetooth device automatically.

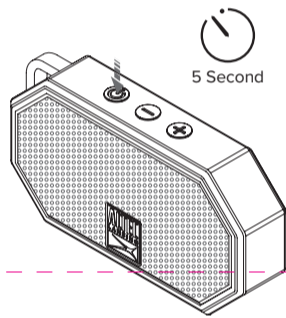

5. True Wireless Pairing

The mini h2O 2 supports to connect to the second unit to build the True Wireless Stereo speaker connection.

a. When a mini h2O 2 is paired to your phone successfully, press and hold both **Power button** and **Volume -** button for 3s to enter TWS Master pairing mode. The speaker flashes blue and red alternately.

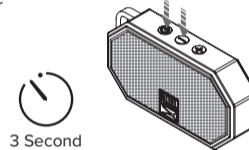

b. Turn the second mini h2O 2 on by press and hold **Power button** for 3s, and then press and hold both **Power button** and **Volume +** button to enter TWS Slave pairing mode. The speakers will pair and connect each other after few seconds. The master unit will be the left channel and slave one will be the right channel.

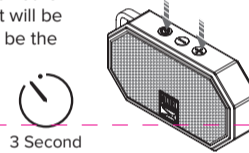

6. Listening to Music on Your Speaker

Play/Pause

Press the Power button to get music from your audio source to play or pause.

Next/Previous Song

Press and hold the Volume + or Volume- buttons for 2s to advance to the next song or go back to the previous one.

Increase/Decrease Volume

Press the Volume+ or Volume - buttons to increase or decrease the volume

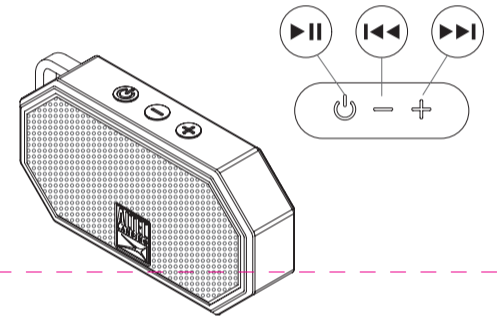

7. Using for phone call

Last number re-dialing

At standby status, double press the Power button, the last number you dialed will be re-dialed.

Answering a call

Press Power button shortly to answer the incoming call.

Ending a call

Press the Power button shortly to end a call.

Volume adjusting

Press the Volume Up and Volume Down button to adjust the volume.

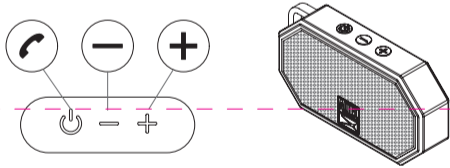

8. Wired External Audio Input

You can also use the included 3.5mm Auxiliary Cable to connect audio devices through the AUX IN port on your speaker.

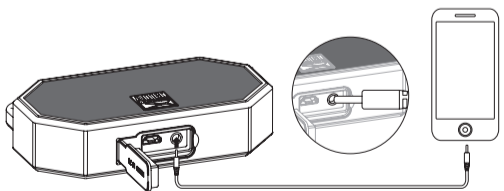

Technical Support

For technical support issues please visit our website at www.alteclansing.com. You can find manuals, software and FAQ's at the website. Can't find what you are looking for? Call 1-855-292-4087 to access our technical support information on the phone.

PRODUCT INFO

User Guide

Thank you for purchasing the Bluetooth® Speaker . Please review the quick start guide before using the Speaker.

Battery information

The device is equipped with an integrated lithium-polymer battery. The battery cannot be replaced. Do not attempt to remove the battery from the device since it would damage the device.

Safety information

1. To avoid any damage or malfunction of the device do not drop the device from high places.
2. Do not place or keep this device near any heat sources, such as, direct sunlight, radiators, stoves or other apparatus that produce heat. This may cause an explosion, degrade the performance and/or reduce battery life.
3. Do not modify, repair or disassemble device (Especially the battery). Doing this will void the warranty.
4. Do not place heavy objects on the device.
5. Use only the supplied and approved chargers.
6. Unplug this device when unused for long periods of time or during lightening storms.
7. The battery used in this device may present a risk of fire or chemical burn if mistreated.

FCC Compliance Statement

device must accept any interference received, including interference that may cause undesired operation. Operation is subject to the following two conditions: (1) This device may not cause harmful interference. And (2) This device must accept any interference received, including interference that may cause undesired operation.

Note: The manufacturer is not responsible for ANY interference, for example RADIO or TV interference, caused by unauthorized modifications to this equipment. Such modifications could void the user's authority to operate the equipment.

EC Declaration of Conformity

Hereby, We declare that this product is compliance with to the essential requirements and other relevant provisions of the R&TTE Directive.



Disposal of the product end of life

Pursuant to Article 13 of Law July 25, 2005, No. 151 "Implementation of Directive 2002/95/EC, 2002/96/EC and 2002/96/EC, relating to the use of hazardous substances in electrical and electronic equipment, as well as the smart waste "

The symbol as shown on the product indicates that the end of its useful life must be separated from other waste. The user is responsible for delivering the equipment to the appropriate recycling centers for electronic waste, or return it to the dealer when purchasing a new equivalent product, on a one to one.

Proper waste collection equipment succession to start recycling, treatment and environmentally compatible disposal contributes in preventing possible environmental and health effects negative and promote the recycling of the materials making up the product.

Illegal disposal of the product by the user includes the application of administrative penalties pursuant to Legislative Decree 22/1997 (art.50 and following).

- Modification and repair of the unit should be done by an authorized and qualified service center or returned to the manufacturer.
- This warranty gives you specific legal rights, and you may also have other rights, which vary under local laws.



IP67
WATERPROOF
SANDPROOF
EVERYTHING PROOF

6
HRS
BATTERY
LIFE
(60% Volume)

FLOATS
IN
WATER

HANDS
FREE
SPEAKERPHONE

JUST LISTEN.

