



Bluetooth® Headset BT1000

1. Notice Before Using

Thank you for purchasing the Celltronix® Bluetooth® Headset BT1000. Please check the contents of this package to verify the items listed below have been included in your package.

Please read this User's Manual completely before you use the Headset. The BT1000 has been developed using Bluetooth® wireless technology and is capable of connecting with Bluetooth® devices designed with Audio Gateway. PDAs, Desktop and Notebook computers can be connected and paired with the Headset using a USB Bluetooth® Dongle. Before using the Headset please verify your Bluetooth® device (Phone, PDA) complies with Bluetooth® V1.1/V1.2/V2.0/V2.1 and supports the Bluetooth® Headset or Hands-free profile.

2. Package Contents List

Please inspect this package and refer to the package contents list below to verify all items were included in this package:

A. BT1000 Bluetooth® headset.....	1
B. AC Travel Charger.....	1
C. DC Car Charger.....	1
D. USB Charging Cable.....	1
E. User's Manual.....	1
F. Ear Pad (Large and Small).....	2

3. BT1000 Bluetooth® Headset Overview

1. Adjustable Head Strap
2. Speaker
3. Volume(+)
4. Volume(-)
5. Flexible Arm
6. Microphone Boom(MIC)
7. On/Off Button
8. Indicator Light(LED)
9. Charging Socket(Micro USB)
10. Ear Pad

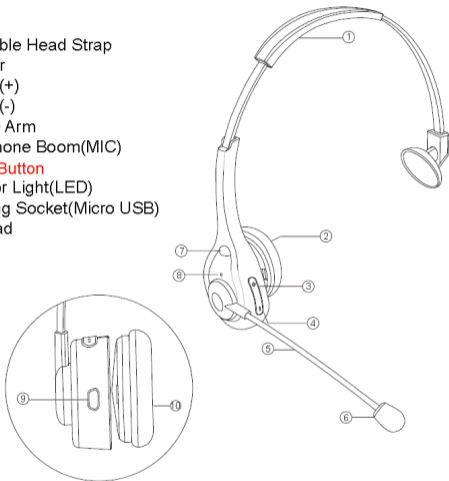

4. Battery information

The device is equipped with an integrated lithium-polymer battery. The battery cannot be replaced. Do not attempt to remove the battery from the device since it would damage the device. The full performance of a new battery is not achieved until after two or three complete charging-discharging cycles. The battery can be charged and discharged several hundred times, but it loses its capacity over time.

Disconnect the BT1000 from the power supply as soon as the battery is fully charged, since overcharging would reduce the service life of the battery. A charged battery loses its capacity if it is not used.

Important: Ensure that the battery is fully charged if you do not use the device for a longer period of time. To avoid a complete discharge of the battery, the BT1000 should be charged at least every 3 months.

5. Charging the battery

The BT1000 is operated with a rechargeable battery. Charge the battery completely before its first use. Read the section "Battery information" before starting the charging process.

- 1) Connect the charger to the correct outlet.
- 2) When the charger is connected to the headset, the red indicator light will turn on. Charging the battery fully may take up to 2 hours.
- 3) When the battery is fully charged, the red indicator light will turn blue. Disconnect the charger from the headset and the wall outlet. The headset is ready to use.

NOTE:

- For first time use, please charge the headset fully.
- The fully charged battery has power for up to 27 hours of talk-time or up to 750 hours of standby time. However, the talk and standby times may vary when used with different

mobile phones or other compatible Bluetooth® devices, usage settings, usage styles, and environments. When the battery power is low, the headset will remind you by "Beep" tone every 20 seconds, and the red indicator light starts to flash.

- For using the BT1000 with iPhone or Blackberry, a additional battery meter feature will be activated, the remaining battery capacity will display on your phone.



6. Pair to your Bluetooth® phone

Before you use your headset the first time, you must pair

the unit with a Bluetooth® enabled mobile phone. Pairing is a one-time process and required only for the first connection with the cell phone. The BT1000 can be paired with up to eight cell phones and be connected simultaneously with two cell phones.

- Hold the BT1000 within range of a Bluetooth®-ready cell phone;
- the distance should not exceed a meter.
- The BT1000 must be turned off .
- Press the On/Off button for approx. 5 seconds until you hear a short-low signal tone and the indicator light intermittently flashes red and blue. The device is in pairing mode. For first time use, when turn on the headset then enter the pairing mode automatically.
- Activate the Bluetooth® function of the cell phone and start the search for Bluetooth® devices. (For further details, please read the operating instructions of your cell phone).

- From the list of devices found, select the "BT1000".
- If required, enter the PIN code "0000" and confirm the entry. If the pairing process was successful, you will hear a signal tone and the indicator lights blue for 3 seconds. (Note: The PIN code is preprogrammed and cannot be changed.)
- After pairing, the BT1000 automatically connects with the cell phone. For some cell phones, you have to manually confirm the connection. Next, the BT1000 changes to standby mode and the indicator light flashes blue every 10 seconds.

Note: If the pairing is not completed within 2 minutes, the BT1000 turns off again. In this case, repeat the pairing procedure.

7. Multi-connection function

The multi-connection function allows the simultaneous use of the BT1000 with two cell phones. This is advantageous for users with a personal and a business cell phone.

Establishing a connection with two cell phones

There are several options of connecting the BT1000 with already paired cell phones.

- Automatic connection

When turning on the BT1000, a connection is automatically established with the two most recently connected cell phones.

- Establishing a connection via the BT1000

To manually establish a connection between the BT1000 and the two most recently connected cell phones, press the On/Off button. The BT1000 first connects itself with the most recently connected cell phone. Then it connects itself with the next most recently connected one.

- Establishing a connection via the cell phone

If the cell phone is not one of the two most recently connected cell phones with the BT1000, you have to establish the connection via the Bluetooth® menu of the

cell phone. After successful connection, you can establish another connection with a second cell phone. This allows you to determine the sequence of connections. If two cell phones are connected with the BT1000, the cell phone connected first is the first device and the other one the second device. Another connection can be established only after first disconnecting one of the two cell phones. The cell phone which is still connected afterwards becomes the first device in the sequence.

Note that voice dialing is available only for the first device and the operation for redialing the last number differs for the first and the second device. The other functions are executed the same way using the BT1000 as a connection with only one cell phone.

8. Turning headset on /off

Turning on your headset

While the headset is turned off, press and hold On/Off for 3

seconds until you hear a tone from low to high. The headset is now on. The Blue indicator light will be solid for 2 seconds.

Connecting to a Bluetooth® phone

If your headset has completed the pairing process successfully, when the headset is turned on, it will connect to the phone you last connected with automatically. Please ensure your phone's Bluetooth® function is active.

Turning off the headset

At any working state after the headset is powered on, press and hold On/Off for 5 seconds. You will hear a tone from high to low, and the Red indicator light will be solid for 2 seconds. The headset has now powered off.

Note:

To conserve power, if the headset is not connected to a device for approximately 10 minutes , the headset will turn off automatically.

9. Wearing your headset

According to your preference, you can wear the headset on your left or right ear. The adjustable head strap design allows for a comfortable wearing.



10. Using the BT1000

Making a call

- Using phone's keypad

In stand-by mode, dial the number on your phone's keypad to make a call.

- Use Voice-Dialing

In the stand-by mode, press the On/Off shortly, you will hear a short tone from the headset, and the phone will prompt you to say the voice tag which you have already attached to your contact. If the voice tag is identified by the phone, the related number will be dialed. Please insure that your mobile phone supports this voice dialing function, and voice tags have been set up on your mobile phone prior to attempting this. Refer to your mobile phone's user guide or contact your service provider.

Note: the voice dialing is available only for the first device if two cell phones are connected.

- Last number re-dialing

At the standby status, double On/Off press button, The last number you dialed will be re-dialed.

Note: If two cell phones are connected with the BT1000, hold the Volume (-) button pressed for 2 seconds to dial the last number of the cell phone connected last.

Answering a call

When you receive an incoming call, press the On/Off button shortly to answer the incoming call; you can also answer the call on your phones keypad.

Reject an incoming call

When you receive an incoming call, press and hold On/Off button for 3 seconds to reject the incoming call.

Transferring a call

While a call is in progress on your mobile phone, press and hold Volume (+) for 3 seconds. The call will be transferred from your mobile phone to your headset. Repeating the operation can transfer the call between your headset to your mobile phone.

Ending a call

While on a call, press the On/Off button shortly to end the call; you can also end the call on your mobile phone keypad.

Call-waiting (Three-Way Calling)

Before using the Call-Waiting function on your headset, please ensure that your phone supports this Hands-free profile and you have access to the service by wireless provider.

- If there is another incoming call while a call is in progress on your mobile phone, press On/Off shortly. This will accept the waiting call and end current calling.
- If there is an incoming call while a call is in progress on your mobile phone, press and hold On/Off for 3 seconds to accept the incoming call and place the current call on hold.
- While a call is on hold and you are engaged in an additional call, press On/Off shortly to end the current call and resume the call holding.
- While a call is on hold and you are engaged in an additional call, press and hold On/Off for 3 seconds to shift the current call to hold and connect you with the previously

held call.

- While you are engaged in one call with another call on hold, Double press Volume (-) button to add the held call to the current conversation for making a three-way call.

- While you engaged in a three-way call, double press On/Off to end all calls.

Volume control

While on a call, you can adjust the volume by pressing the Volume(+) and Volume(-)button or you can adjust the volume on your mobile phone keypad.

Mute

While a call is in progress press and hold Volume(-) button, for 2s, you will hear a tone from low to high. The headset's MIC is now muted. You will hear a remindful tone every 10 seconds, notifying you that your MIC is still muted and a call is still in progress. Repeat the operation and you will hear the tone from high to low. The mute function is now

cancelled.

Music streaming

The BT1000 supports A2DP profile that can streaming stereo music from the phone. The music will pause automatically while a call is dialed out/incoming, and resume while the conversation is ended.

11. Reset the BT1000

The BT1000 can be paired with up to eight cell phones. You can delete the pairing list and reset the headset to the factory settings.

- The BT1000 must be turned on and no connection may exist to a cell phone.
- Press and hold the On/Off, Volume(+) and Volume(-) buttons simultaneously for approx 5 seconds until the indicator light flashes red 3 times.
- If the pairing list was deleted, the headset will return to

stand-by mode without connection.

12. Safety and general information

- 1) Please read this User's Manual carefully and follow all instructions.
- 2) To avoid any damage or malfunction of the device do not drop the device from high places.
- 3) Keep device away from humidity, water and any other liquid. If the device is exposed to water, moisture and other liquids do not operate it to avoid any electrical shock, explosion and damage to the device or yourself.
- 4) Do not place or keep this device near any heat sources, such as, direct sun light, radiators, stoves or other apparatus which produce heat. It may cause an explosion, degrade the performance and/or reduce battery life.
- 5) Do not modify, repair or disassemble device (Especially the battery: It may cause an explosion). Doing this will

void the warranty.

- 6) Do not place heavy objects on the device.
- 7) Use only supplied and approved charger.
- 8) Replacement or service must be done by a qualified service center or manufacturer.
- 9) Unplug this device when unused for long periods of time or during lightening storms.
- 10) The battery used in this device may present a risk of fire or chemical burn if mistreated.

13. FCC & IC Statement

Operation is subject to the following two conditions:

- (1) This device may not cause harmful interference.
- (2) This device must accept any interference received, including interference that may cause undesired operation.

Note: Any changes and modifications to this unit not expressly approved by the party responsible for compliance could void the user's authority to operate this equipment

14. EC Declaration of Conformity

Operation is subject to the following two conditions:

- (1) This device may not cause harmful interference.
- (2) This device must accept any interference received, including interference that may cause undesired operation.

Note: The manufacturer is not responsible for ANY interference, for example RADIO or TV interference, caused by unauthorized modifications to this equipment. Such modifications could void the user's authority to operate the equipment. This product is CE certified according to the provision of the R&TTE Directive (99/5/EC). This declares that this product is in compliance with the essential requirements and other relevant provisions of Directive 1999/5/EC.

Please note that this product uses radio frequency bands

not harmonized within EU.

Within the EU this product is intended to be used in Austria, Belgium, Denmark, Finland, France, Germany, Greece, Ireland, Italy, Luxembourg, The Netherlands, Portugal, Spain, Sweden, and United Kingdom and within EFTA in Iceland, Norway and Switzerland.

15. Warranty

The condition of this warranty and supplier's responsibilities under this warranty are as follows:

Warranty is non-transferable and is limited to the original purchaser only.

- You must be able to prove the date of original purchase of the unit with a dated receipt.
- The warranty is not applicable if the product has been subject to physical abuse, improper installation, modification or repair by an unauthorized third party.
- Supplier's responsibility shall be limited to the repair or

replacement of the product at its sole discretion.

- Specifically exempt from any warranty are limited-life consumable components subject to normal wear and tear such as batteries, decorates and other accessories.

- Supplier is not responsible, for failure resulting from accident, abuse, misuse, or any unauthorized repair, or modification.

- Modification and repair of the unit should be done by an authorized and qualified service center or returned to the manufacturer.

- This warranty gives you specific legal rights, and you may also have other rights which vary under local laws.

Bluetooth® is a trademark owned by the Bluetooth® SIG, Inc.

Hoffco Brands, Inc.
4860 Ward Road
Wheat Ridge, CO 80033
(877) 292-6454
www.hoffcobrands.com



MADE IN CHINA