



ProShot MN67Z



EN User Manual

To ensure the best performance from your camera, please read the Operating Manual before using the camera.



BEFORE YOU START

Declaration of Conformity

Responsible Party: XXXXXXXX.

Address: XXXXXXXXXXXXXXX

Company Website: XXXXXX

For Customers in the U.S.A.

Federal Communication Commission Interference Statement

This device complies with Part 15 of the FCC Rules. Operation is subject to the following two conditions: (1) This device may not cause harmful interference, and (2) this device must accept any interference received, including interference that may cause undesired operation.

This equipment has been tested and found to comply with the limits for a Class B digital device, pursuant to Part 15 of the FCC Rules. These limits are designed to provide reasonable protection against harmful interference in a residential installation. This equipment generates, uses and can radiate radio frequency energy and, if not installed and used in accordance with the instructions, may cause harmful interference to radio communications. However, there is no guarantee that interference will not occur in a particular installation. If this equipment does cause harmful interference to radio or television reception, which can be determined by turning the equipment off and on, the user is encouraged to try to correct the interference by one of the following measures:

- Reorient or relocate the receiving antenna.
- Increase the separation between the equipment and receiver.
- Connect the equipment into an outlet on a circuit different from that to which the receiver is connected.
- Consult the dealer or an experienced radio/TV technician for help.



FCC Caution: Any changes or modifications not expressly approved by the party responsible for compliance could void the user's authority to operate this equipment.

This transmitter must not be co-located or operating in conjunction with any other antenna or transmitter.

Radiation Exposure Statement:

This product complies with the FCC portable RF exposure limit set forth for an uncontrolled environment and is safe for intended operation as described in this manual. Additional RF exposure reduction can be achieved if the product can be kept as far as possible from the user body or set the device to lower output power if such function is available.

About this Manual

Thank you for purchasing this **MINOLTA MN67Z** Digital Camera. Please read this manual carefully and keep it in a safe place for future reference.

- **XXXXX** reserves all rights of this document. No part of this published manual may be reproduced, transmitted, transcribed, stored in a retrieval system or translated into any language or computer language, in any form, by any means, without the prior written permission of **XXXXX**.
- All trademarks mentioned in this manual are used for identification purposes only and are properties of their respective owners and holders.
- This manual provides you with instructions on how to use your new **MINOLTA MN67Z** Digital Camera. Every effort has been made to ensure that the contents of this manual are accurate; however **XXXXX** reserves the right to make changes without notice.
- Throughout this manual, the following symbols are used to help you locate information quickly and easily:



Indicates useful information.

- The following symbols may be used throughout this manual to facilitate your understanding of how to operate the camera:
[Item properties] : The optional properties in the camera interface are indicated by the [] symbol.

SAFETY NOTES

Safety Notes for this Camera

- Do not drop the camera or allow it to hit solid objects.
- Do not attempt to disassemble or repair the camera.
- Do not use or store the camera in dusty places or on a beach to help prevent dust or sand from entering the camera, causing possible damage.
- Do not use or store the camera in a hot environment or in direct sunlight.
- Do not use or store the camera near powerful magnetic fields, such as a magnet or transformer.
- Avoid touching the lens of the camera.
- Do not expose the camera to direct sunlight for a long period of time.
- To prevent the camera from being damaged by moisture, do not use or store the camera in very humid environments, such as in rain or near bodies of water.
- If water accidentally comes in contact with the camera, turn the camera off immediately, remove the battery and the memory card and dry it completely within 24 hours.
- When you take the camera from a cold environment to a warmer environment, condensation may occur. Please wait for a reasonable period of time before you turn the camera on.
- Before you remove the battery and memory card, the camera should be turned off.

- When you clean the body of the camera, do not use abrasive, alcohol-based or organic cleansers or solvents.
- Use a professional lens cleaning cloth and appropriate cleaner to wipe and clean the lens.
- Download your photos and remove the memory card when you are going to store the camera for long periods of time.
- If this camera is not in use for a long period of time, please keep it in a dry and clean storage location.
- Our company will not pay compensation for any failure of playback including: pictures or videos damaged or unrecoverable by improper operation.

Safety Notes for Battery

- Please use a battery that is the same type as the one included.
- Please use the attached charger to charge the battery.
- If battery fluid leaks inside the camera, contact our customer service department immediately. If battery fluid leaks onto your skin, rinse your skin immediately with clean water and seek immediate medical attention.
- Disposal of used batteries should be carried out in accordance with your local (national or regional) regulations.
- To prevent the battery from being damaged, do not drop the battery or allow it to hit solid objects or to be scratched by foreign objects.
- Do not let the battery come in contact with metal objects (including coins) to avoid short circuiting, discharging, excessive heat or possible leakage.
- Do not attempt to disassemble the battery.
- Do not expose the battery to water. Always keep the battery contacts dry.
- Do not heat the battery or throw it into a fire to avoid a possible explosion.
- Do not store the battery in a hot environment or in direct sunlight.
- If the battery overheats during charging or use, stop charging or use immediately. Turn off the product, remove the battery carefully, and wait until it cools down.

- When the camera is stored for a long period of time, remove the battery and keep it in a safe, dry place that is not accessible to infants and children.
- In colder environments, the performance of the battery could be noticeably reduced.
- When you install the battery, align the battery markings according to the positive and negative markings inside the camera battery compartment. Never force the battery into the battery compartment.



Safety Notes for Memory Card

- We highly suggest buying only well-known, name brand memory cards to ensure peak performance and reliability.
- Format the memory card using the camera before you use it or insert a new one.
- Do not drop the memory card or allow it to hit solid objects to avoid damaging it.
- Do not attempt to disassemble or repair the memory card.
- Do not expose the memory card to water. Always keep it dry.
- Do not remove the memory card when the camera is turned on. Otherwise, the memory card and photo/video files could be permanently damaged.
- Do not directly edit the data on the memory card. Copy the data to your computer before you edit files.
- When the camera is stored for long periods of time, be sure to download your photos and remove the memory card. Store the memory card in a dry environment.
- Do not modify the name of the files or folders of the memory card using your computer. Modifying the file names may cause the files to not be recognized on the camera or a possible permanent error may occur.
- A photo taken with the camera will be stored in the folder that is automatically generated on the memory card. Do not store photos that are not taken using this camera in these folders as the pictures cannot be recognized during playback.
- When you insert the memory card, make sure the notch of the card matches the markings on the top of the camera card slot.

Other Safety Notes

- Do not disconnect the power or turn the camera off during the update process. Doing so may cause incorrect data to be written and the camera may not power on later.
- Do not hang the neck strap of the camera around the neck of a child.
- When using your camera on an airplane, observe the relevant rules specified by the airline and FAA regulations.
- Due to the limitations of manufacturing technology, the LCD may have a few dead or bright pixels. These pixels do not affect the quality or performance of the camera, photos or video.
- Do not expose the camera's LCD to water. In a humid environment, only wipe it with a soft, dry, cleaning cloth.
- If the LCD is damaged and the liquid crystal comes into contact with your skin, wipe your skin with a dry cloth immediately and rinse it with clean water. If liquid crystal comes into contact with your eyes, wash them with clean water at least for 15 minutes and seek immediate medical attention. If you accidentally swallow liquid crystal, rinse your mouth immediately and seek medical attention.

CONTENTS

BEFORE YOU START.....	1	MODE OVERVIEW	27
SAFETY NOTES	4	LCD Display	27
CONTENTS.....	10	Overview of the Screen Icons in Shooting Mode.....	27
GETTING READY	14	Overview of the Screen Icons in Movie Mode	29
Accessories Included	14	Overview of the Screen Icons in Playback Mode	30
Installing Lens Cap and Neck Strap..	15	How to Take Pictures	31
Part Names	16	Using the Mode Dial.....	32
Installing Battery and Memory Card..	19	Face Beautifier 	35
Charging the Battery	21	Wi-Fi Mode 	36
Vari-Angle LCD	22	Scene Mode SCN	43
Turning Camera On and Off.....	23	Custom Settings (CS)	49
Set your Language, Date/Time after the First Power-On.....	24	BASIC OPERATION.....	51
Set your Language, Date/Time	24	Using EVF (Electronic View Finder) ..	51
Resetting your Language.....	25	Using the Zoom Function	52
Resetting Date/Time	26	Display Setting	53



AF Area	55
Macro Mode	56
Self-Timer Mode	57
Flash Mode	58
WB (White Balance) Mode	60
Continuous Shot Mode.....	62
Exposure Compensation Functions Setting	64
EV Adjustment	64
ISO Adjustment.....	65
Shutter Speed Adjustment	65
Aperture Adjustment	66
Using Quick Recording	66
“i” Button Function Menu.....	67
Using the Lens Function Ring	68
Zoom/AF Mode.....	68
Function Ring (Smart) Mode.....	69
MF(Manual Focus) Mode.....	70

PLAYBACK.....71

Viewing Photos and Videos	71
Thumbnail View.....	72
Using Zoom Playback (for still pictures only)	73
Continuous Shot Group Playback.....	74
Animation Panorama Play.....	75
Slideshow.....	76
Deleting Photos and Videos.....	77

USING THE MENUS78

Shooting Menu	78
Expo Metering.....	79
OIS (Optical Image Stabilization) ..	79
Beautifier.....	80
Select Scene.....	80
Shoot Setting1.....	81
Image Size.....	82

Movie Size	83	Touch-Up 	96
Quality.....	84	Resize 	97
MF (Manual Focus) Assist	85	Playback Settings	97
AF Assist Beam	86	Protect	98
Digital Zoom.....	86	Delete	98
Shoot Setting 2.....	87	DPOF (Digital Print Order Format)	99
Date Imprint	88	Trim.....	100
Quick Review.....	88	Play Slide Show.....	100
Continuous AF	89	General Settings	101
Face Detection.....	89	Sound Settings	102
Custom Settings	90	Power Saver	102
Function Ring (Smart).....	91	Language.....	103
Playback Menu.....	92	World Time.....	103
Menu 	92	Date & Time.....	103
Display Mode 	93	LCD Brightness.....	103
Rotate 	93	File Settings	104
Color 	94	Format	105
HDR 	95		

Copy to Card.....	106
File Numbering	106
Reset Settings	107
Version.....	107

Exit.....	115
Video System	116
Supported HDMI Connections	117
Connecting HDMI-Ready TV	117
HDMI CEC Control.....	118

CONNECTION SETTINGS . 108

Connecting to a Computer	108
Setting the USB Mode	108
Transferring Files to your Computer	109
Connecting to a PICTBRIDGE™ Compatible Printer	110
Setting the USB Mode	110
Connecting to your Printer	111
Using the PICTBRIDGE™ Menu	112
Print (with Date)	112
Print (without Date)	113
Print Index.....	114
Print DPOF Images.....	115

APPENDICES 123

Product Specifications.....	123
Prompts and Warning Messages	127
Troubleshooting	132

GETTING READY

Accessories Included

Your camera box should contain the camera model you purchased along with the following accessories. If anything is missing or appears to be damaged, please contact your retailer first or our customer service center (Based on sales in different countries or regions, the shape of the AC adapter will vary. Please subject to the actual product will prevail.)

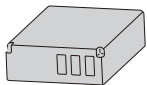

Rechargeable
Li-ion Battery

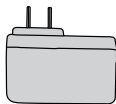

AC Adapter

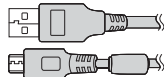

Micro USB Cable



Neck Strap

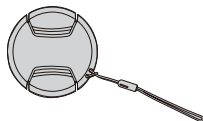

Lens Cap With Strap

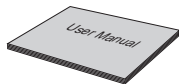

User Manual



Quick Start Guide



Warranty Card

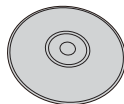

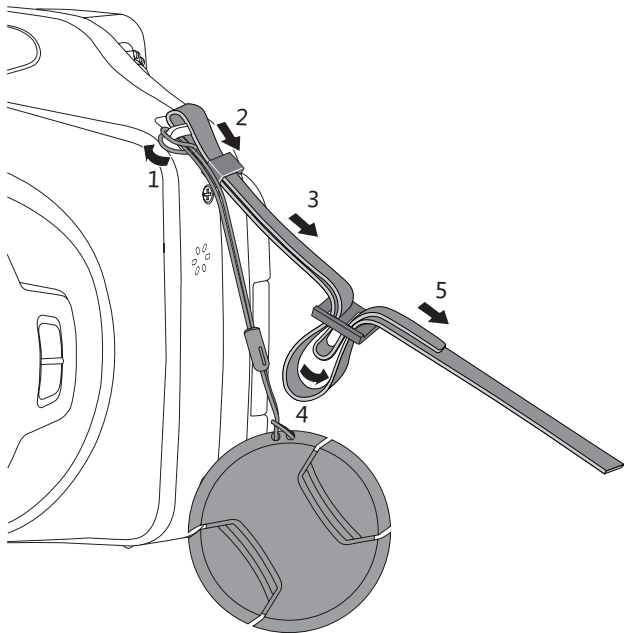

CD-ROM

Installing Lens Cap and Neck Strap

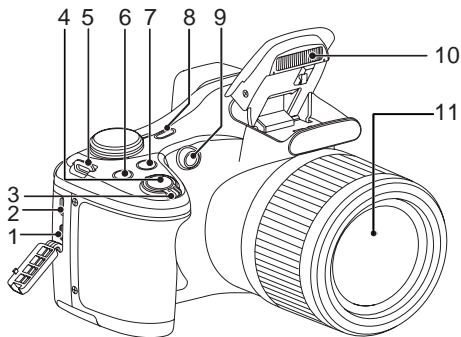

Part Names



1. Micro HDMI Port
2. Micro USB Port
3. Zoom Lever
4. Shutter Button
5. Strap Eyelet
6.  Exposure Compensation Button
7.  Continuous Shot Button
8. Power Button
9. AF Assist Beam/Self-Timer Lamp
10. Flash Lamp
11. Lens

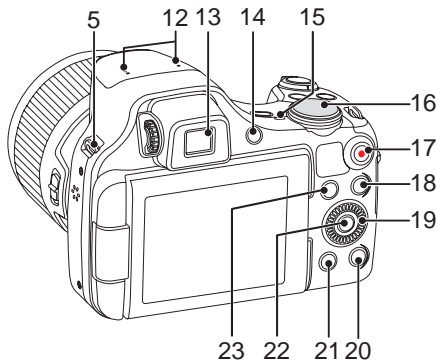

- 12. Microphone
- 13. Electronic View Finder (EVF)
- 14. EVF / LCD Switch Button
- 15. Indicator Lamp
- 16. Mode Dial
- 17. Fast Video Recording Button
- 18. Menu Button
- 19. Jog Dial
 - [**AF**] AF Button/Up Button
 - [] Delete Button/Self-Timer Button/Down Button
 - [] Macro Button/Left Button
 - [] Flash Button/Right Button
- 20. Display Button
- 21. Playback Button
- 22. SET Button
- 23. "i" Button

Rolling the jog dial can be for fast selection instead of pressing the up/down/left/right button.

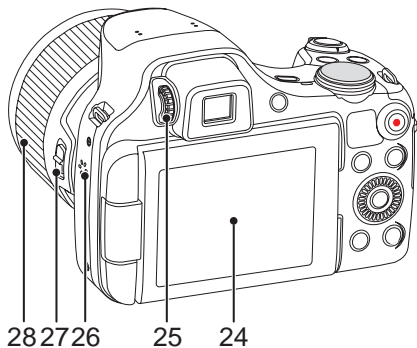

- 24. Vari-angle LCD
- 25. Diopter Adjustment Knob
- 26. Speaker
- 27. Lens Function Ring Lever
- 28. Lens Function Ring

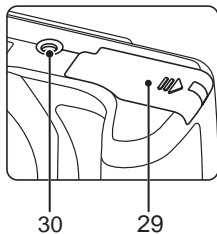

- 29. Battery Cover
- 30. Tripod Socket

Installing Battery and Memory Card

1. Open the battery cover door.

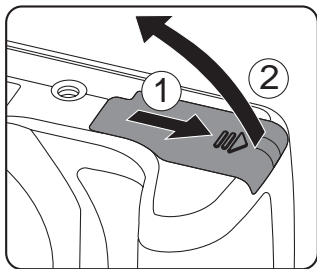

2. Insert the battery into the battery compartment according to the negative and positive directions as illustrated in the picture. Push the battery down until it locks in place.

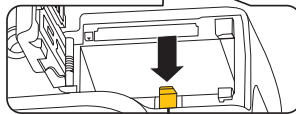
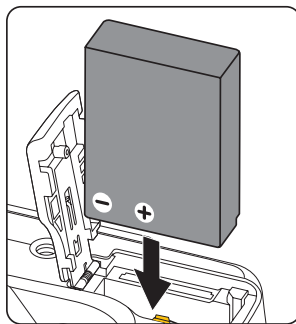

Battery Lock Knob

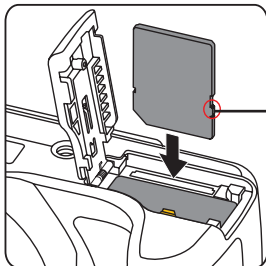

3. Insert the memory card into the memory card slot as shown in the diagram:

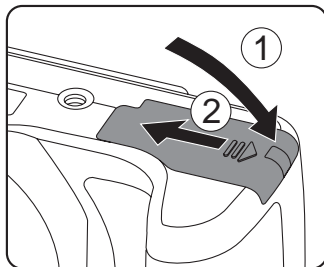

Write Protection
Toggle Switch

4. Close the battery cover door.





-  A standard SD memory card is not included in the camera packaging and needs to be purchased separately. This camera takes a standard (SD/SDHC) memory card. We recommend using a name brand memory card that is Class 4 or higher and has a capacity of 4GB to 32GB. The camera is not compatible with Micro SD, Ultra, Ultra Plus, Extreme, XC, or adapters for any of these other memory cards.
-  To remove your memory card, open the battery cover door, gently press the memory card to eject it and remove it carefully.

Charging the Battery

Before you charge the battery, you should turn the camera off and insert the battery.

1. Connect the camera to the power charger using the supplied Micro USB cable.
2. Insert the plug of the power charger into the power outlet to charge the battery.

 After the battery is stored for long periods of time, use the supplied power charger to charge the battery prior to use.

 **Charging indicator:**
Steady orange: Charging
Steady green: Charging complete
To maximize battery life, charge the battery for at least 4 hours the first time.

 Please charge the battery indoors between 0°C and 40°C (32°F and 104°F).

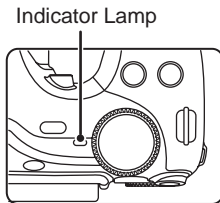
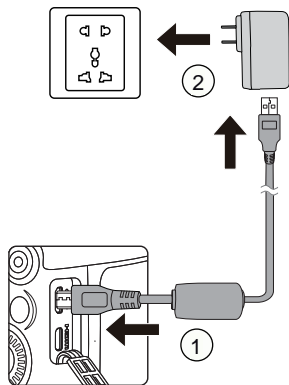

Vari-Angle LCD

The LCD is housed in the camera's body. You may follow the directions shown below to move it as needed:

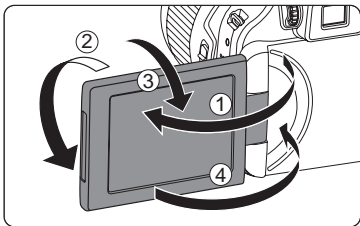

1. Open the LCD panel along the direction shown by arrow ①.
2. Rotate up to 180° along the direction shown by arrow ②.
3. Rotate up to 90° along the direction shown by arrow ③.
4. Close the LCD along the direction shown by arrow ④.



Please don't rotate the LCD with excessive force to prevent damages.



Please close the LCD along the direction shown by arrow ④ after use to protect it from scratches.

Turning Camera On and Off



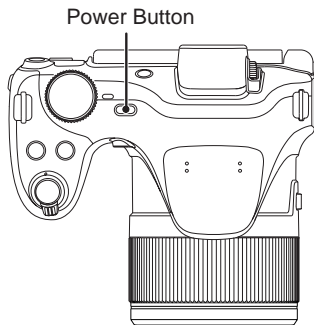



Press the Power button to turn the camera on. To turn the camera off, press the Power button again.



When the power is off, press and hold the playback (⏮) button to power on and enter Playback mode.

Set your Language, Date/Time

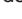



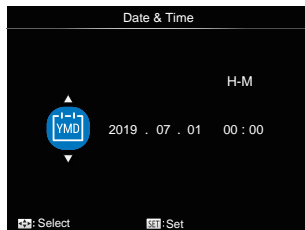







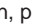
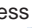







Set your Language, Date/Time after the First Power-On

1. When you turn the camera on for the first time, the language selection screen appears.
2. Press the [**▲ AF**]/[**▼**  ] button to select your desired language.
3. After you press the **(SET)** button to confirm your language selection, the Date/Time settings screen will appear.
4. Press the [**◀** ]/[**▶** ] button to select the Date/Time to be adjusted: Time is displayed in YYYY.MM.DD/HH:MM.
5. Press the [**▲ AF**]/[**▼**  ] button to adjust the value for the desired Date/Time.
6. Press the **(SET)** button to confirm the time settings and the shooting screen will appear.

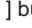

Resetting your Language

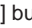



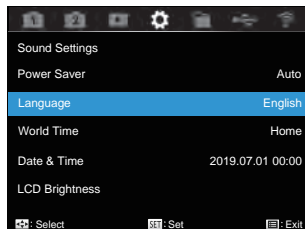





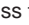













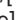

After you set your language for the first time, follow the instructions below to reset your language.

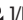
1. Press the  button, press the [ AF] / [  ] button to select  and press the  button to enter the menu.
2. Press the [ ] / [ ] button to select .
3. Press the [ AF] / [  ] button to select [Language] and press the  button to enter the menu.
4. Press the [ AF] / [  ] button to select your desired language and press the  button to confirm.
5. Press the  button and the shooting screen will appear.



Resetting Date/Time

After you set your Date/Time for the first time, follow the instructions below to reset date and time.

1. Press the  button, press the [ **AF**] / [  ] button to select , and press the  button to enter the menu.
2. Press the [ ] / [ ] button to select .
3. Press the [ **AF**] / [  ] button to select [Date & Time] and press the  button to enter the menu.
4. Press the [ ] / [ ] button to select the Date/Time to be adjusted: Time is displayed in YYYY.MM.DD/HH:MM.
5. Press the [ **AF**] / [  ] button to press the value for your selected entry. After you finish your settings, press the  button to confirm.
6. Press the  button and the shooting screen will appear.

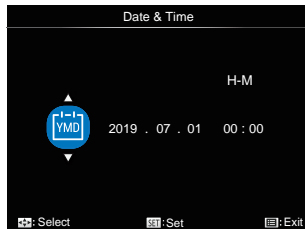
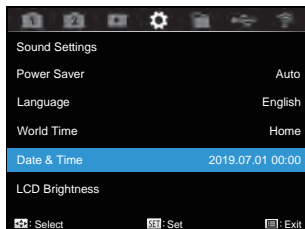

MODE OVERVIEW

LCD Display

Overview of the Screen Icons in Shooting Mode

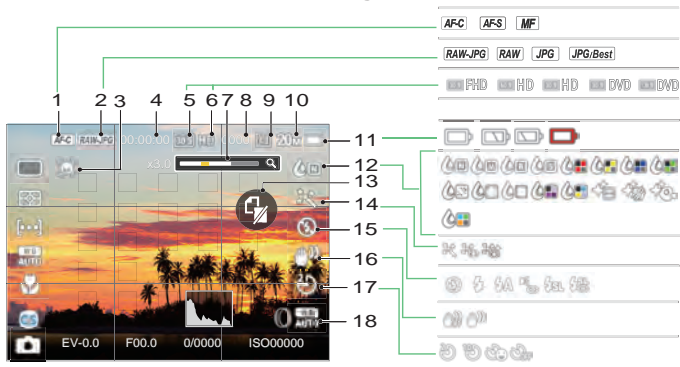

1	Focus Mode	7	Zoom Display(By turning the Zoom Lever)	13	No Memory Card
2	Quality	8	Number of Pictures in Static Mode	14	Beautifier
3	Face Detection	9	Ratio of Shooting Pixels	15	Flash Mode
4	Maximum Record Time	10	Image Size	16	OIS
5	Recording Speed (fps)	11	Battery Status	17	Self-Timer
6	Video Pixels	12	Color Effect	18	Lens Function Ring Custom Settings

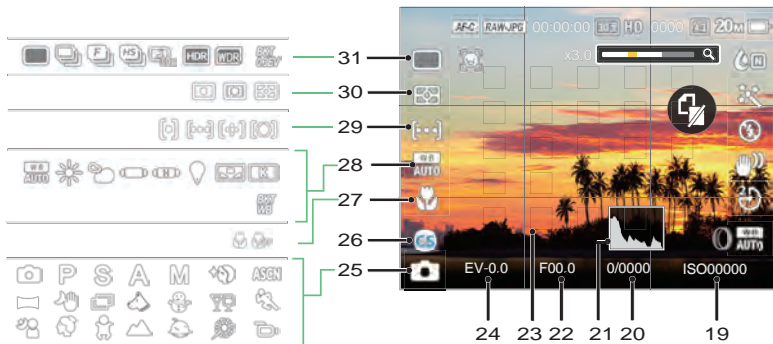

19	ISO Value	24	Exposure Compensation Value	29	AF Area
20	Shutter Speed	25	Shooting Mode	30	Expo Metering
21	Histogram	26	Custom Settings	31	Single / Continuous Shot / HDR / WDR / AE Bracketting
22	Aperture Value	27	Macro Mode		
23	Focus Frame	28	White Balance		

Overview of the Screen Icons in Movie Mode



1	Battery Status
2	Number of Videos Captured
3	Continuous Recording Time
4	Movie Mode

Overview of the Screen Icons in Playback Mode

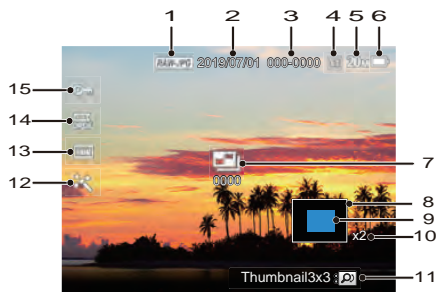

1	Quality	9	Zoom Magnification Area
2	Capture Date	10	Image Zoom Ratio
3	File Name	11	Index Prompt
4	Shooting Pixel Ratio	12	Touch-Up
5	Image Size	13	HDR
6	Battery Status	14	DPOF File Icon
7	Continuous Shot Group Playback	15	File Protection Icon
8	Image Area		

How to Take Pictures

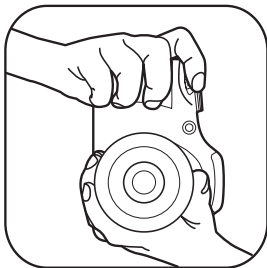
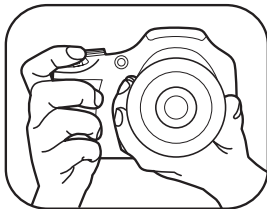



1. Hold the camera with both hands, being careful to not block the flash and lens with fingers.
2. Point the lens toward the object you want to take a picture of, and then frame it with the LCD.
3. Use the Zoom button to select Tele or Wide positions to zoom in or out on your subject.
4. Press the shutter button halfway to focus on the subject. When the focus frame turns green, press the shutter button down completely to take the picture.

Using the Mode Dial











This camera provides a convenient Mode dial that allows you to manually switch between different modes with ease. The available modes are listed below:

Mode Name	Icon	Description
Auto Mode		In this mode, the optimal conditions for taking pictures will be set based on the subject and environment. It is the most commonly used mode for taking pictures.
Program AE	P	Under different scenes, the user can switch the ISO and EV value according to personal preference, the camera can automatically set the shutter speed and aperture value.
Shutter Priority	S	Setting allows you to adjust the shutter speed / EV value and ISO value. The camera automatically sets the aperture value based on the shutter speed and ISO value to get the most appropriate exposure value.
Aperture Priority	A	In this mode, you can adjust the aperture size, EV and ISO values. The large aperture is to highlight the object focused through blurring the background, while the small aperture is for clear focus on both the background and the object.

Manual Mode	M	This mode is for manually setting the aperture, shutter speed and ISO value.
Face Beautifier		This mode automatically enhances facial features with skin softening touches and eye brightening capabilities.
Wi-Fi Mode		Enable image transmission and remote control by connecting smart device with Wi-Fi.
Scene Mode	SCN	Choose from 14 different pre-set scene types and effects for your photos.
Movie Mode		Record videos.
Custom Settings	CS	The user can store frequently used shooting modes and parameters. Switching to this mode enables quick adjustment.

Please refer to the table below if any nonadjustable options in **PSAM** mode:
(O: Available X: Not available)









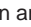
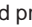

Options Mode	Aperture	Shutter	EV	ISO
P	X	X	O	O
S	X	O	O	O
A	O	X	O	O
M	O	O	X	O

1. Turn the mode dial to select the **PSAM** mode you want.
2. Press the  button to configure settings.
3. Press the [ ]/[ ] button to select an adjustment setting.
4. Press the [ **AF**]/[  ] button to adjust the parameters.
5. Press the  button to confirm the settings and enter the shooting screen.



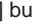

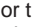
Please note that even if an option is not able to be adjusted in a particular mode, its value will still be displayed on the shooting screen.

Face Beautifier

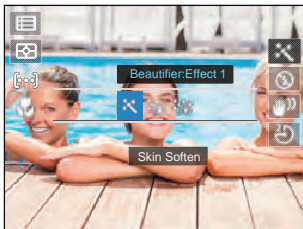
1. Turn the Mode dial to select Face Beautifier Mode ().
2. Press the  button and press the [ AF]/[  ] button to select .
3. Press the [ ]/[ ] button or turn the  jog dial to select an option and press the  button to confirm and enter the shooting screen.



-  Effect 1: Skin Soften
-  Effect 2: Skin Soften + Eye Brightening
-  Effect 3: Skin Soften + Eye Brightening + Eye Enlargement

Wi-Fi Mode



Enable image transmission and remote control by connecting smart device with Wi-Fi.





Before utilizing Wi-Fi Mode, please review the following:

- Your smart device operating system version needs to be iOS 10 or higher, or ANDROID 5.0 or higher. If not, please upgrade your smart device before using the APP.
- Please do not use in places that have a high intensity magnetic field, electrostatic and electric wave interference (for example near a microwave oven), which may cause failure in receiving signals.
- To maintain a connection, please keep the camera within 10 meters (32.8 feet) without signal shielding interference.
- Please do not use Wi-Fi connection functionality on a plane.
- The camera and the smart device can only be connected one to one.



Downloading the APP package:

Download a dedicated installation package from the application store (APP name: **XXXXXX** ) and then install it.

- ANDROID devices : Search and download the APP “**XXXXXXX**”  in Google play, and install it following the instructions on the interface.
- iOS devices : Search and download the APP “**XXXXXXX**”  in APP store, and install it following the instructions on the interface.

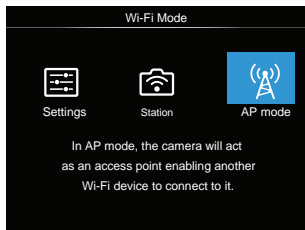
1. Rotate the mode dial to  and then enter the Wi-Fi selection interface.
2. Press the [ ]/[ ] button to select and set options.



-  [Settings] :
Customize the Wi-Fi settings for the camera system.
-  [Station] :
Use the Station Mode to connect to a “Personal Hotspot” created by your mobile device.
-  [AP Mode] :
In AP mode, the camera will act as an access point enabling another Wi-Fi device to connect to it.







Rotate the mode dial to disconnect.

AP Mode

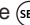
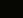
This camera may connect with your smart device through Wi-Fi.

Settings of Camera:

1. Select the  and press the  button to enter the setting interface.
2. Press the [ **AF**]/[  ] button to select options to be adjusted, and press the  button to enter the option setting interface.

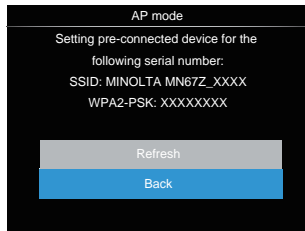

- Refresh: Create a new WPA2 PSK password.
- Back: Back to previous page.

Settings of Smart Device:







1. Enable the Wi-Fi of smart device and then search surrounding wireless devices.
2. Select the name of camera SSID to be connected and then input the eight-digit number password after WPA2-PSK on the camera.
3. Click the icon of the APP  to enable the APP.

Set up completion:

Once the APP is connected to the camera, functional operations can be enabled on the smart device.

Station

Enable image transmission and remote control by connecting the camera with a Wi-Fi access point created by your smart device.

1. Enable the Wi-Fi access point of smart device.
2. Select the  on camera and then press the  button to confirm connection with smart device.
3. Press the [ **AF**]/[  ] button to select the name of smart device to be connected and then press the  button to confirm. Then, the camera enters the password input interface.



Press the []/[] button to select:

- Scan: Search again surrounding wireless devices.
 - : Select the name of device to be connected.
 - Back: Back to Wi-Fi mode select screen.
4. Press the []/[]/[]/[] button or turn the jog dial to select and then press the button to confirm your selection. You will enter the completion of WPA2- PSK after the password is saved.

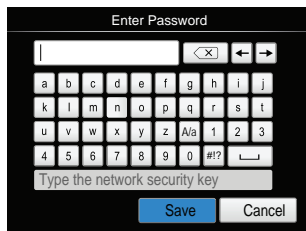

Meanings of Interface Icons:

Icon	Description
	Delete the last letter
	Switch the display of letters in capital and lowercase
	Move the Cursor
	Switch the symbol input
	Input Space

5. Connect to network after saving the password.
 - If connected, the LCD will display as shown below:

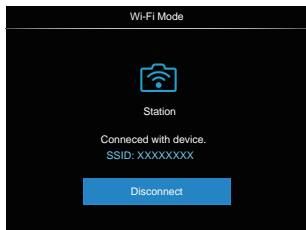

- If connection failed, please check Wi-Fi device and try again.
6. After connecting, click the icon of the APP  on the smart device.

Display of Wi-Fi Connection Status:

The Wi-Fi has successfully connected but APP is not enabled.

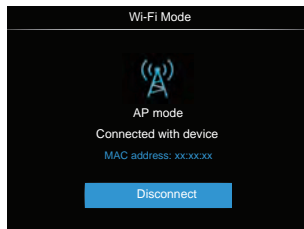

The Wi-Fi has successfully connected and APP is enabled.

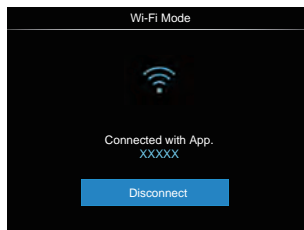

To disconnect from Wi-Fi:

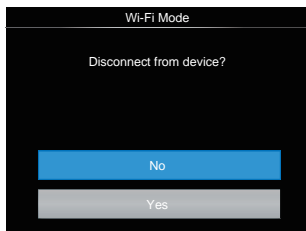

- No: Keep Wi-Fi connected and back to previous page.
- Yes: Disconnect and back to Wi-Fi connection screen.



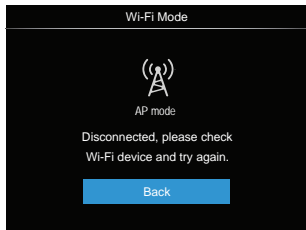



Disconnected from smart device Wi-Fi:





- Back: Back to the SSID interface.

Setting

The name of this camera can be changed under Wi-Fi settings.

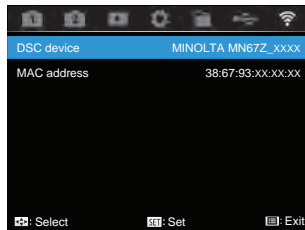
1. Select the  and then press the  button to enter the setting interface.
2. Press the  **▲ AF** /    button to select options to be adjusted and then press the  button to enter the menu.



3. Press the  button to confirm settings and then skip the menu.

DSC Device

The default name of DSC device is [MINOLTA MN67Z_XXXX]. Change the name of DSC device through typing.



For the method of input, please refer to the introduction on password input on page 39.

MAC address

Check the wireless MAC address of this camera.

APP Operating Instructions

Refer to the "XXXXXXXX User Manual" located on the web:

Americas



XXXXXXXXXXXX

Europe



XXXXXXXXXXXX















Scene Mode SCN

You can select an appropriate mode from the 14 scene modes according to the type of environment you are shooting in. The camera then automatically configures the most appropriate settings for the best possible photos.

1. Rotate the Mode dial to **SCN**, then the LCD will display as below:









2. Press the [◀🌻]/[▶⚡] button to select a scene, and press the (SET) button to confirm.
3. If any need of changing the scene, please press the (MENU) button and then the (SET) button and finally the [◀🌻]/[▶⚡] button to reselect the scene.

Scene	Description
 Auto Scene	The camera automatically detects the type of scene.
 Panorama Mode	For shooting up to 360-degrees of landscape.
 Handheld Night	Reduce blur when shooting low light/ illuminated scenes.
 Multi Exposure	Take several shots and overlap as a single image.
 Cat/Dog	The camera automatically takes a picture when a dog or cat face is detected.
 Snow	For subjects in the snow. Reduce underexposure.
 Party	For subjects at night without using a tripod. Capture sharp shots without blur.
 Sport	For fast-moving subjects. Capture sharp action shots without blur.
 Night Portrait	For portraits against night time scenery.
 Portrait	Most suitable for capturing people, focusing on their face.
 Children	For kids and pets. Flash is disabled for eye protection.
 Landscape	Speed adjusted for brilliant images.
 Sunset	For sunsets. Capture subjects in strong sunlight.
 Fireworks	For fireworks at night. Slow shutter speed adjusted for brilliant images. The use of a tripod is recommended with this setting.

Auto Scene (ASCN)

In “ASCN” scene mode, the camera can intelligently detect different environments and automatically select the best scene and photo settings for you.





“ASCN” can intelligently detect the following scenes:

Mode Name	Description
 Auto	The camera automatically adjusts the exposure and focus to ensure the best possible pictures.
 Landscape	For landscapes, automatically adjusts the exposure to match the background.
 Backlit Portrait	When the sun or any other light source is behind you, automatically adjusts the foreground exposure to produce the best pictures possible.
 Macro	The Macro setting is ideal for shooting small objects or close-up photos.
 Night Landscape	For night scenes, automatically increases the ISO value to compensate for low light.
 Portrait	Most suitable for capturing people with focus on their faces.
 Night Portrait	When you take portraits at night or in low light conditions, automatically adjusts the exposure for people and night scenes.

Panorama Mode

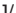

This feature allows you to capture a panoramic view that will have significantly more content than a single photograph. Follow the arrow while keeping the camera steady to seamlessly shoot an ultra-wide scene of up to 360 degrees.

Follow the steps below:

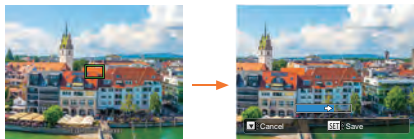
1. Select the Panorama Mode () and then press the **(SET)** button to confirm.
2. Press the [**▲ AF**]/[**▼**  ]/[**◀** ]/[**▶** ] button to select a shooting direction. (Should you not select a direction, the default shooting direction is “right”.) 2 seconds later, the camera will be ready to take pictures. You can also press the **(SET)** button or press the shutter button halfway down to be ready to take pictures.
3. Compose your shot on the LCD and half press the shutter button to focus on the subject. After focusing, fully press the shutter button down to take the first picture. At this time, the process dialog of panorama mode stitching appears on the screen.



4. Pan the camera according to the set direction. When the range of motion does not exceed the range that the camera can detect, the progress bar behind the arrow partially turns blue. When it completely turns blue, panorama mode shooting is finished.

-  Panoramic image can be played back by the method of flash playing. Please see the animation panoramic playback on page 75.
-  In Panorama Mode, the Flash, Self-Timer, Macro Modes and Exposure Compensation are not available. Focus adjustment is also not available at this time.

 During panorama mode shooting, press the **(SET)** button to interrupt shooting and save the current pictures taken. Press the [**▼** **🗑️** **🕒**] button to cancel shooting and not to save the previously taken pictures.

 During panorama mode shooting, when the moving direction of the camera is wrong or the angle deviates from the internal settings, the LCD shows a warning message [Improper alignment. Please try again.] and the current pictures taken are saved.

Multi Exposure

Suitable for shooting moving objects (as many as 6) in the same background.

 Keep camera steady before shooting. Press and hold the shutter button to take 6 photos continuously when it will stop automatically. To stop shooting, release the shutter button in the midway.

 Objects shall be moved only from left to the right in order to be recorded. Objects moving from other directions would not be recorded.

 Shooting effect will be influenced if object is moving too fast or too close.

Cat/Dog

1. It defaults to enabling the auto shoot after entering the Cat/Dog mode. When a face of cat or dog is detected, the camera will take photos automatically. Meanwhile, you also may press down the shutter button to shoot.
2. Press the [**▼** **🗑️** **🕒**] button to enter Auto Shoot menu. If this function is disabled, you may only take photos manually.

 At most, 10 cat /dog faces can be detected at one time.

Functions that can be adjusted in each scene are as below:

Scene	Adjustable Functions
Auto Scene	Flash* ¹ /Self-Timer
Panorama Mode	None
Handheld Night	Expo Metering/Self-Timer* ²
Multi Exposure	Expo Metering
Cat/Dog	Auto Shooting/Continuous Shot/Expo Metering/Macro
Snow	Continuous Shot/Expo Metering/Flash/Self-Timer
Party	Continuous Shot/HDR/Expo Metering/Flash/Self-Timer/Macro
Sport	Continuous Shot/Expo Metering
Night Portrait	HDR/Expo Metering/Self-Timer
Portrait	Continuous Shot/HDR/Expo Metering/Flash/Self-Timer/Macro
Children	Continuous Shot/Expo Metering
Landscape	Expo Metering/Self-Timer* ²
Sunset	HDR/WDR/Expo Metering/Flash/Self-Timer* ²
Fireworks	Continuous Shot/Expo Metering/Self-Timer* ²

*¹ Means the flash as an option of Night Landscape mode in Auto Scene is non-adjustable.

*² Means Self-Timer smile is not included in the Self-Timer.

For continuous shot, there are only [Continuous Shot] and [Time-Lapse] for selection.

Custom Settings (CS)

The user can store frequently used shooting modes; and parameters and switch to this mode for a quick adjustment.

Settings under **CS** mode (unset state or state after reset):

1. Turn the Mode dial to select the **CS** mode, and enter the setup screen, as shown in the figure below:

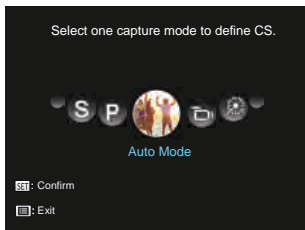

2. As shown in the figure above, press the [◀👉]/[▶⚡] button to select a capture mode that you want to define as **CS**, and press the (SET) button to enter the shooting screen.
3. As shown in the figure, press the (MENU) button, and choose whether to continue the **CS** mode setting or rotate the Mode dial to skip.

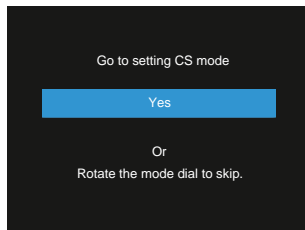

For setting under other modes (use this method to select a different custom setting):

1. Select any mode to be stored.
2. Set your desired parameters in the current mode.
3. Press the (MENU) button, press the [▲AF] / [▼🗑️🕒] button to select (MENU), and press the (SET) button to enter the menu.
4. Press the [◀👉]/[▶⚡] button to select **2**.

5. Press the [▼ 🗑️ 🔄] button select [Custom Settings] and press the (SET) button to enter the menu.

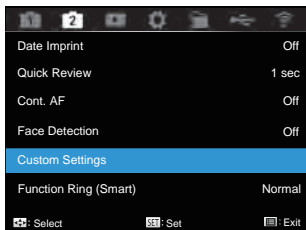

6. Select [Yes] to save or [No] to cancel.

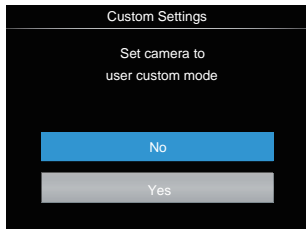

7. Turn the mode dial to switch to the custom settings (**CS**).
8. The photo settings you stored the last time are used.

When the **CS** mode is used for the first time, there is no preset parameter stored in the **CS** mode.

If you want to remove the parameter setting of [Custom Settings], please see the reset function on page 107 to operate.

BASIC OPERATION

Using EVF (Electronic View Finder)



EVF functions as the LCD, which can be used to observe the scene and objects and for playback, preview and menu operations.

EVF has the following advantages:

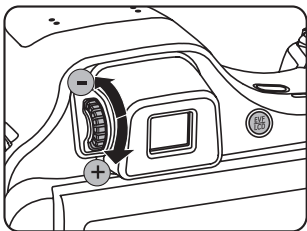
It will not be affected by ambient light and may avoid poor composition due to light reflection on the LCD.

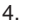

Follow the steps below:

1. Turn the camera on and press the  button to switch to the EVF display. At this time, the LCD will become black.
 2. View the scenes and objects through the EVF.
 3. When the screen display is not clear, rotate the dioptic adjustment knob to adjust the screen sharpness.
 4. Press the  button again or restart the camera to switch back to the LCD display.
-  The bending of light that takes place in a lens is referred to as refraction. The strength of refraction is measured in diopters.
-  Diopter adjustment is aimed to help nearsighted (-300 or less) or farsighted (+100) individuals see clearly through the viewfinder (EVF).

Using the Zoom Function

Your camera is equipped with two types of zoom functions: Optical Zoom and Digital Zoom. Toggle the Zoom Lever of the camera to zoom in or out on the subject while taking pictures.

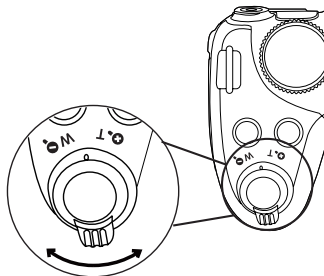

Zoom Lever

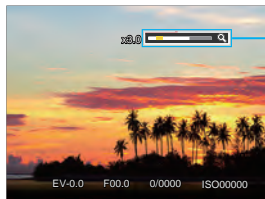

Zoom Indicator

When the Optical Zoom reaches the threshold as Digital Zoom, release and turn the Zoom lever to T to switch between the Optical Zoom and Digital Zoom.

Display Setting

Mode: PSAM SCN CS

Press the button to switch among 4 screens.

Function Message Display



No Message Display

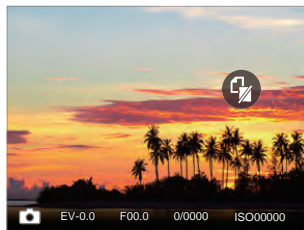

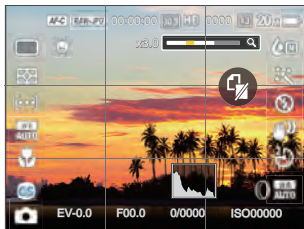

Display with Grid and Histogram

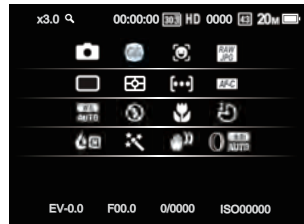

Message Display



Mode: 

Press the  button to display the playback screen, press the  button to switch among 3 screens.

Function Message Display

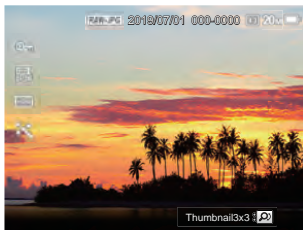

No Message Display

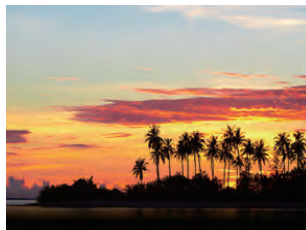

Detailed Message Display

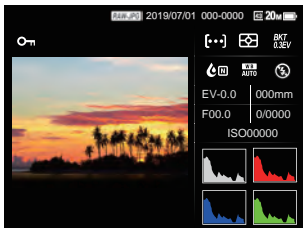

AF Area

In different photo shooting modes, you can select different focus methods.
(Adjustable in **PSAM** mode)

1. Press the [**▲ AF**] button to display the settings screen.



2. Press the [**◀**]/[**▶**] button to select the following 4 modes:

[**○**] Center-AF
The focus frame appears on the center of the LCD to focus on the subject.

[**□**] Multi-AF
The camera automatically focuses the subject in a wide area to find the focus point.

[**+**] Spot Focus
Choose the single-point focus position within the scope of focus.

[**○**] Object Tracking:
Smart tracking of the object in motion under the focusing shooting.

3. Press the [**SET**] button to confirm the settings and enter the shooting screen.

[**○**] After enabling spot focus, turn the [**⊙**] jog dial to adjust the position of focus point in the screen.

[**○**] Object Tracking cannot be enabled until the camera is focused. For tracking the focus, you need to keep the shutter semi-pressed.

Macro Mode

The Macro Setting is ideal for shooting small objects or close-up photos. This mode allows you to focus on subjects very close to the camera.

1. Press the [◀ 🌿] button to enter the Macro Menu.

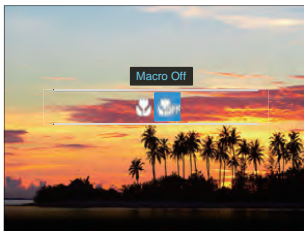



2. Press the [◀ 🌿]/[▶ ⚡] button to select the following 2 modes:
 - 🌿 Macro On
Select this option to focus on the object closer to the lens (At the W side, the shooting distance should be more than 1 cm).
 - 🌿⚡ Macro Off
Select this option to disable Macro.
3. Press the (SET) button to confirm the settings and enter the shooting screen.

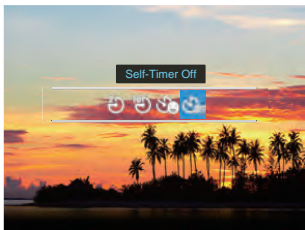

Self-Timer Mode

Using this function to take pictures at pre-set intervals. The camera can be set to shoot after 2 seconds, 10 seconds after pressing the shutter or when a smile is detected.

1. Press the [▼ 🗑️ ⏸️] button to enter the Self-Timer menu.



2. Press the [◀️ 🗑️]/[▶️ ⚡] button to select the following 4 modes:
 -  Self-Timer 10 sec
A single picture is shot 10 seconds after the Shutter button is pressed.

-  Self-Timer Smile
Press the shutter button and a picture will be taken immediately after a smile is detected.
-  Self-Timer 2 sec
A single picture is shot 2 seconds after the Shutter button is pressed.
-  Self-Timer Off
Disables the Self-Timer.

3. Press the (SET) button to confirm the settings and enter the shooting screen.

-  When enabling the Self-Timer, pressing the shutter or the [▼ 🗑️ ⏸️] button can disable the Self-Timer and return to the shooting screen while keeping the Self-Timer setting.

When enabling the Smile Detection, pressing the shutter or the **SET** button can disable the Self-Timer and return to the shooting screen while keeping the Self-Timer smile setting.

Self-Timer settings will remain after completion of shooting with the Self-Timer. They can be canceled by switching modes or by turning the camera off and then on again.



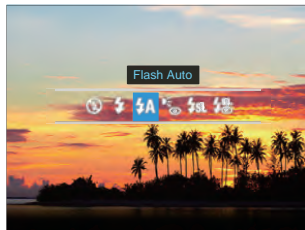

Flash Mode

The flash provides supplemental light for the scene. The flash is usually used when shooting against the light to highlight the object; it is also suitable for metering and shooting in darker scenes to improve the exposure.

1. Press the [▶⚡] button to enter the flash settings menu.



2. Press the [◀⚡]/[▶⚡] button to select the following 6 modes:
 -  Force Off
Flash is turned off.

-  **Fill Flash**
The flash goes off when a picture is taken, supplementing the existing light in a scene and helping to eliminate shadows.
-  **Flash Auto**
Camera flash goes off automatically based on existing light conditions.
-  **Red-Eye Reduction**
The camera emits a brief pre-flash before the picture is taken to reduce red-eye effects.
-  **Slow Sync.**
This allows you to take pictures of people at night that clearly show both your subjects and the night time backdrop. The use of a tripod is recommended when shooting with this setting.
-  **Slow Sync.+Red-Eye Reduction**
Use this mode for slow synchrony shots with red-eye reduction.

3. Press the  button to confirm the settings and enter the shooting screen.

 After pressing the shutter button half way to achieve focus lock, the flash will automatically pop up if needed.

WB (White Balance) Mode

The white balance function allows adjustment of the color temperature for different light sources. (Adjustable in **PSA M** Mode)

Follow the steps below to set white balance of the camera:

1. Press the **(SET)** button to enter white balance menu.



2. Press the **[◀☼]/[▶⚡]** button to select the following 9 modes:

- **WB AUTO** AWB
Set WB according to the current light source, press the **(M)** button to set.
 - **Daylight**
 - **Cloudy**
 - **Fluorescent**
 - **Fluorescent H**
 - **Incandescent**
 - **Manual WB**
Set WB according to the current light source, press the **(M)** button to set.
 - **K** Color Temp. (1900K~10000K)
Press the **(SET)** button to enter and turn the **(DIAL)** jog dial to adjust the color temperature value.
 - **WB** WB Bracketing
Press the shutter button once to take three photos with different WB settings.
3. Press the **(SET)** button to confirm the settings and enter the shooting screen.