

S41



Guides > S41



Overview



S41 is the mid-tier smart speaker designed for immersive listening—

- Stream content over WiFi or Bluetooth.
- Two separate microphone controls for convenience and privacy.
- Easy voice control with Sonos Voice Control (US and France), Amazon Alexa, and other compatible voice services built right in.
- Use two S41s as surrounds with a Sonos Arc or Beam (Gen 2), or pair four S41s as front and rear surrounds for the ultimate home theater experience.
- Compatible with all your other Sonos speakers for multi-room listening.

Controls and lights

Button

Control

Description



Volume control

- Volume up (slide right, or tap +)
- Volume down (slide left, or tap -)

Press and hold + or - to quickly change the volume.



Play/Pause

- Press once to play or pause audio.
- Press and hold to add the audio that's playing in another room.



Next/Previous

Press > to skip to the next song.

Press < to go to the previous song.

Note: You can't skip forward or go back when listening to a radio station.



Voice services on/off

Press the microphone icon to turn voice services on or off.

- When the indicator light is on, voice control is available (the microphone switch on the back must also be on).
- When the indicator light is off, voice control is off.



Status light

Displays the product's connection to WiFi, indicates when the volume is muted, and signals errors. [Learn more](#)

Connector panel

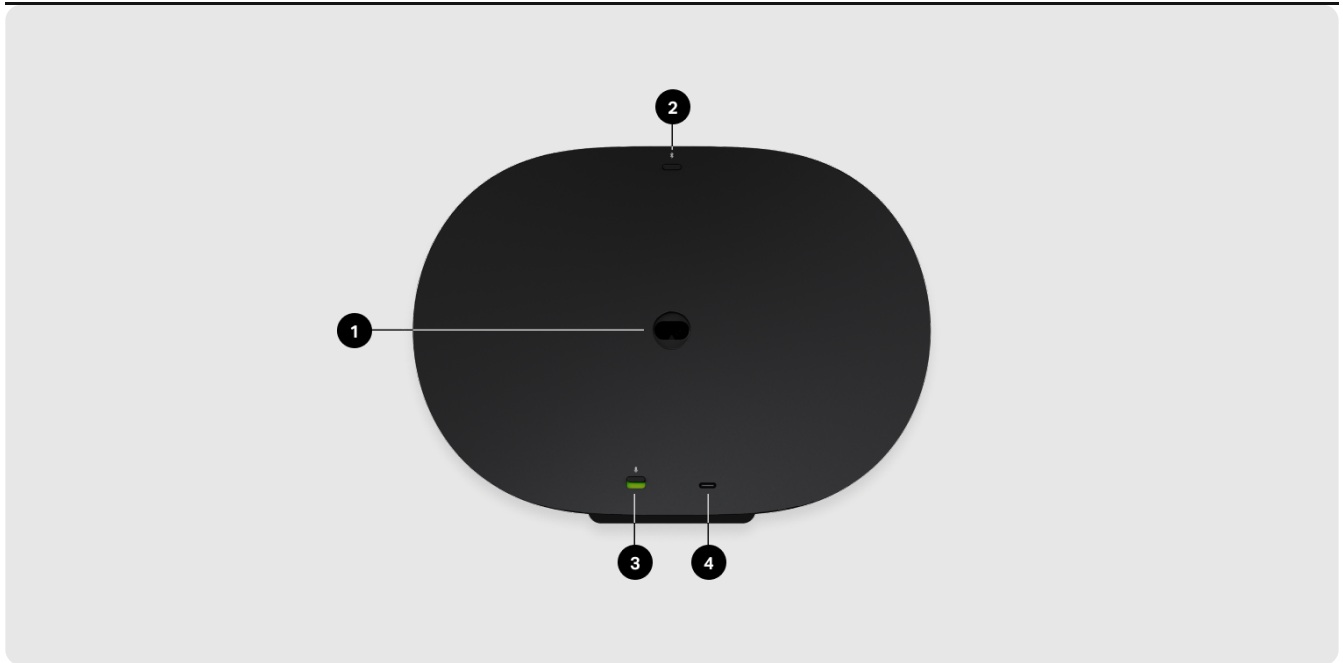

1

AC power (mains) input

Use only the supplied power cord (using a third-party power cord will void your warranty).

Note: Insert the power cord firmly until it is flush with the bottom of the speaker.

2

Bluetooth button

Press and hold to pair a new device.
Press once to reconnect.

3

Universal microphone switch

Toggle to turn all product microphones on or off.

- When the switch is off (down), the microphones are disabled and all microphone-dependent features like Trueplay and voice services are unavailable.
- When the switch is on (up), microphone-dependent features like Trueplay are available.

Note: To use voice services, both the microphone switch and the voice services indicator light must be on.

4

USB-C port

Using a Sonos Ethernet 3.5 combo adapter, you can connect a Sonos product directly to your router if your WiFi is unstable (sold separately).

Select a location

You can put your speaker just about anywhere. For the best performance, here's a few guidelines:

- S41 is made to give you powerful sound anywhere—Trueplay tuning balances the sound for wherever you are and whatever you're listening to.
- S41 sounds great, even when placed next to a wall or on a shelf. For best performance, leave at least 1" (2.5 cm) of space around the back of the speaker. If you're mounting it within 2 ft (.61 m) of a ceiling, place it upside down for the best sound.
- If you're using S41s as surrounds, leave at least 8" (203 mm) clearance around each speaker.

Note: Don't position it vertically or at an angle or the audio will stop.

Bluetooth pairing

1. Turn Bluetooth on in your device settings.
2. Press and hold the Bluetooth button on the back on the speaker until you hear the pairing tone, then release. The status light blinks blue when the speaker is ready to pair.
3. Choose **S41** from the list of available devices in your Bluetooth settings. Your mobile device will automatically connect next time.

Microphone on/off

There are two ways to control the microphones on S41:

A universal microphone switch on the back of S41 turns all microphones on and off.

A voice services button on top of S41 turns voice services on and off without affecting the microphones needed for Trueplay and other microphone-dependent features.

- When both the universal microphone switch and the voice services light are on, voice control and all microphone-dependent features are available.
- When both the universal microphone switch and the voice services light are off, voice control is off and all microphone-dependent features are unavailable.
- When the universal microphone switch is on and the voice services light is off, voice control is off, but Trueplay and other microphone-dependent features are available.

Trueplay™

Trueplay tuning measures how sound reflects off walls, furnishings, and other surfaces in a room, then fine tunes your Sonos speaker to make sure it sounds great no matter where you place it.

During setup, choose the best Trueplay option available to you.

Note: Trueplay tuning isn't available if VoiceOver is enabled on your iOS device. Turn VoiceOver off in your device settings before tuning your speakers.

Quick Tuning

Available for iOS and Android. Quick tuning uses the microphone on your product to detect the environment and automatically tune your speakers. Go to **Settings** > **System**, pick a room, and select **Trueplay** to get started. Takes about 1 minute.

Note: Quick tuning may be the best option for customers with mobility issues.

Advanced Tuning

Available for iOS. As you move around the room, Trueplay uses the microphone on your iOS device to optimize the sound for your space. Go to **Settings** > **System**, pick a room, and select **Trueplay** to get started. This tuning option is the best choice for large rooms. Open concept spaces may experience less precise tuning. Takes about 5 minutes.

Auto Trueplay

Portable Sonos products like Sonos Roam and Move can tune themselves automatically. Auto Trueplay uses your speaker's microphone to detect the environment and make periodic tuning adjustments so you get great sound wherever your speaker is and whatever you're listening to.

Go to  > **System**, and select your portable speaker to turn on auto Trueplay.

Set up stereo pair

Pair two Sonos speakers in the same room for a wider, stereo experience. One speaker serves as the left channel and one serves as the right channel.

Note: The Sonos speakers in a stereo pair must be the same type.

1. Place the speakers 8 to 10 feet apart. Your favorite listening position should be 8 to 12 feet from the paired speakers—less distance increases bass, more distance improves stereo imaging.
2. Go to  > **System**.
3. Select one of the speakers you want to use in the stereo pair, then choose **Set Up Stereo Pair** to get started. [Learn more](#)

Set up surrounds

It's easy to turn two Sonos speakers (same model), or a Sonos Amp and your favorite non-Sonos speakers, into separate right and left channels for your home theater.

1. Place each surround speaker about 10ft from your favorite listening position, angling them toward the seating area.
2. Go to  > **System**.
3. Select a room with a soundbar and choose **Add Surrounds** to get started.

Note: If you group the rooms or create a stereo pair instead, you won't have surround sound.

[Learn more](#)

Surround audio settings

During setup, surround sound is optimized for your room. These settings are adjustable:

Surrounds

Turn surround sound **On** or **Off**.

TV Level

Adjust surround volume for TV audio.

Music Level

Adjust surround volume for music.

Music Playback

Ambient (subtle) or **Full** (louder, full range). Doesn't apply to Dolby Atmos Music playback.

Line-in

Connect an audio device, like a CD player or a turntable with a built-in phono preamp, to the line-in port on a Sonos product (Amp, Port or Five).

Note: Some products require a USB-C to 3.5 mm line-in adapter.

[Learn more](#)

Accessories

Find the perfect accessory for your Sonos system—tailored to perfectly fit your Sonos products.

For a full selection of Sonos-compatible stands, wall mounts, chargers and cables, see [Accessories](#) on our website.

Sonos S41 Stand

Custom designed stand for Sonos S41 holds speaker securely in place.

- Indentation in the stem hides the speaker's power cable for simple cable management.
- Fixed height, optimal for home theater surrounds.
- Easy assembly.

Note: For the full selection of Sonos-compatible stands, wall mounts, and cables, see [Accessories](#) on our website.

What's in the box?

Each stand assembly includes:

- 1 stand base
- 1 stand pole
- 1 speaker platform
- 1 stand pole cap
- Mounting kit with 4 screws (2 long, 2 short), 1 washer

Note: Sonos speakers sold separately.

What you'll need

- Phillips-head screwdriver

Set it up

1

Take everything out of the box and place the base in the packaging slot to stabilize it for the next few steps. Thread the end of the Sonos S41 power cord that attaches to the speaker through the opening in the stand base and into the pole channel.

Caution: This stand is intended only for use with Sonos S41.

2

Position the washer with the alignment pins facing in. Then align the stand pole with the base, using the alignment pins to guide you.

3

Fasten the base (with the washer) to the stand pole using 1 long screw (included) and a Phillips-head screwdriver. Make sure the cord can still slide freely.

4

Attach the speaker platform to the bottom of the speaker using 2 short screws (included).

5

Attach the speaker platform to the stand pole using 1 long screw (included). Then plug the power cord into the speaker. You may need someone to hold the speaker for this step.

6

Snap the pole cap onto the top of the pole to hide the power cord. Be careful to not pinch the cable. Then working from top to bottom, neatly press the power cord into the cable channel on the pole.

7

Plug the speaker into a power outlet, then tuck the excess cord under the base.

Sonos S41 Mount

- The easy-to-install mount for Sonos One, One SL and Play:1.
- Holds speaker normally, upside-down, or even horizontally.
- Speaker can pivot up to 45 degrees.
- Allows access to ports, buttons, and touch controls.
- Cleanly routes your speaker's cables.

Important: This mount is intended for use only with Sonos One, One SL, and Play:1.

What's in the box?

- Mount
- Wall bracket
- Top cap
- Mounting kit

Note: Sonos speakers sold separately.

What you'll need

- Pencil
- Level
- Phillips-head screwdriver
- Power drill (if needed for installation location)

Wall mount	Pre-drill	Use wall anchors	Use screws
Wood stud	1/8" / 3mm bit	No	Yes
Drywall (no stud)	5/16" / 8mm bit	Yes	Yes

**Hard wallboard or
double board**

5/16" / 8mm bit

Yes

Yes

Plaster

5/16" / 8mm bit

Yes

Yes

Concrete or brick

5/16" / 8mm bit

Yes

Yes

Set it up

1

Place the wall mount bracket against the wall using a level to make sure it is vertical and mark the screw holes.

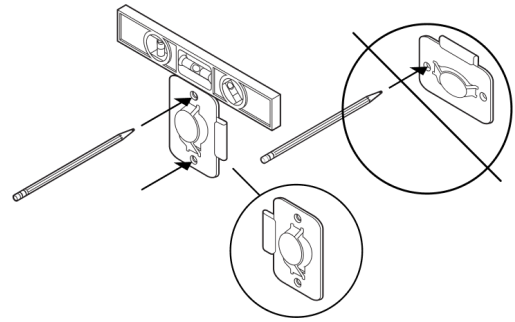

2

If you're using wall anchors, use a 5/16" drill bit to drill 2 pilot holes and then insert the wall anchors.

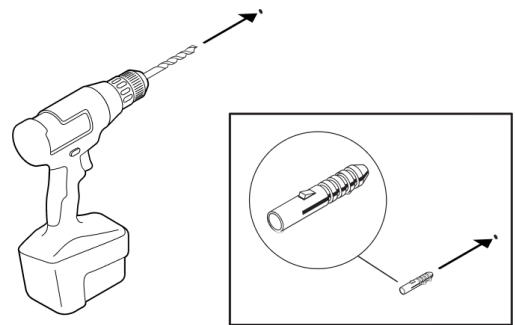

3

Use a Phillips-head screwdriver or power drill to screw in the wall mount bracket.

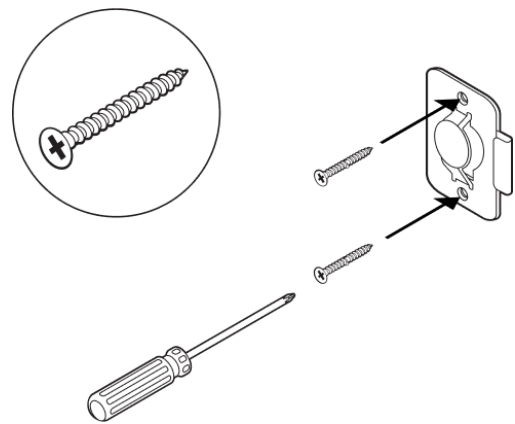

4

Feed the speaker's power cord through the Mount opening and plug it into the speaker. Place it down onto the Mount.

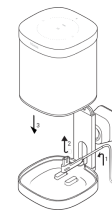

5

Press the top band down firmly onto the speaker and use a Phillips-head screwdriver to screw in the top band fastener on the back.

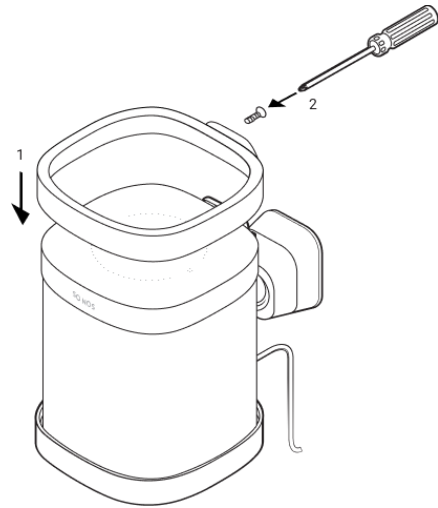

6

Slide the Mount down onto the wall bracket.

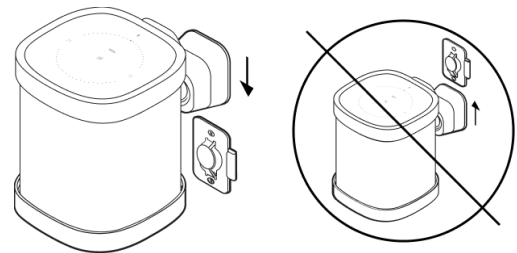

7

Twist the speaker to position it in place, then turn it right to lock it in securely.

Turn left to unlock.

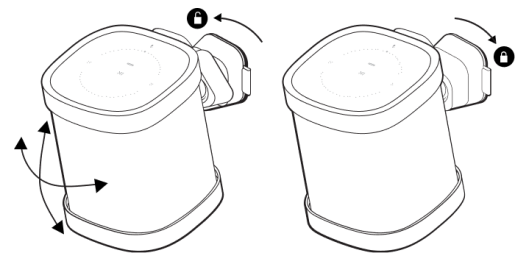

8

Route the power cable into the side hook and plug the speaker into power.

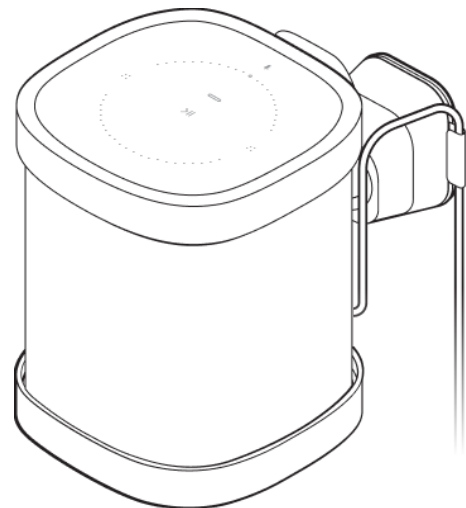

Specifications

Feature	Description
---------	-------------

AUDIO

Amplifier	Six Class-D digital amplifiers have been perfectly tuned to the speaker's unique acoustic architecture.
------------------	---

Tweeter	Three mid tweeters ensure faithful playback of high and mid-range frequencies, with one forward-firing to provide a smooth and wide center image and two side-firing to create a stereo image. An additional up-firing tweeter is loaded into a directional horn to provide energy off the ceiling for a Dolby Atmos 3D experience.
----------------	---

Woofers	Two woofers maximize low-end output and are angled left and right to support stereo playback.
----------------	---

Home theater	Add two S41 speakers as surrounds for a true surround sound experience.
---------------------	---

Microphones	<ul style="list-style-type: none">• Far-field microphone array.• You can turn off all microphones using the microphone switch on the back of the speaker.
--------------------	--

NETWORKING*

Wireless connectivity

Connects to WiFi network with any 802.11a/b/g/n 2.4 or 5GHz broadcast-capable router.

Bluetooth

Bluetooth 5.0 supports audio streaming from your smartphone and other devices.

USB-C port

One USB-C port.
Using a Sonos Ethernet 3.5 combo adapter, you can connect a Sonos product directly to your router if your WiFi is unstable (adapter sold separately).

SOFTWARE

Sonos S2

Set up and control S41 with the latest generation of the Sonos app.

Apple AirPlay 2

Works with AirPlay 2 on Apple devices iOS 11.4 and higher.

Voice

Works with Amazon Alexa and Sonos Voice Control.

Trueplay™

This tuning technology uses spatial awareness to smartly adjust the sound for the speaker's orientation (vertical/horizontal), location, and the content that's playing. Works on WiFi and Bluetooth. Microphone switch must be on.

Dolby Atmos

Maps specific sounds in 3D space for a 360° effect.

GENERAL

Power supply

Auto-switching 100 - 240VAC, ~ 50/60 Hz
1A AC universal input.

Dimensions (W x H x D)

10.23 in x 7.28 in x 6.3 in (260 mm x 185 mm x 160 mm)

Weight

9.7 lb (4.4 kg)

Operating temperature

32°F to 104°F (0°C to 40°C)

Storage temperature

-4° to 158°F (-20° to 70°C)

Product finish

- White with white grille
 - Black with black grille
-

Package contents

* Specifications subject to change without notice.

- Sonos S41
- power cord
- quickstart guide
- legal booklet

Important safety information

1. Read these instructions.
2. Keep these instructions.
3. Heed all warnings.
4. Follow all instructions.
5. Do not use this apparatus near water.
6. Clean only with dry soft cloth. Household cleaners or solvents can damage the finish on your Sonos products.
7. Do not block any ventilation openings. Install in accordance with the manufacturer's instructions.
8. Do not install near any heat sources such as radiators, heat registers, stoves, or other apparatus that produce heat.
9. Protect the power cable from being walked on or pinched, particularly at plugs, convenience receptacles, and the point where they exit from the apparatus.
10. Only use attachments/accessories specified by the manufacturer.
11. Unplug this apparatus during lightning storms or when unused for long periods of time.
12. This product does not have any user-serviceable parts. Do not open or disassemble or attempt to repair it or replace any components. Refer all servicing to Sonos qualified service personnel. Servicing is required when the apparatus has been damaged in any way, such as power-supply cable or plug is damaged, liquid has been spilled or objects have fallen into the apparatus, the apparatus has been exposed to rain or moisture, does not operate normally, or has been dropped.
13. The Mains plug should be readily available to disconnect the equipment.
14. **Warning:** To reduce the risk of fire or electric shock, do not expose this apparatus to rain or moisture.
15. Do not expose apparatus to dripping or splashing and do not place objects filled with liquids, such as vases, on the apparatus.